

DRAINAGE CATCHMENT PLAN

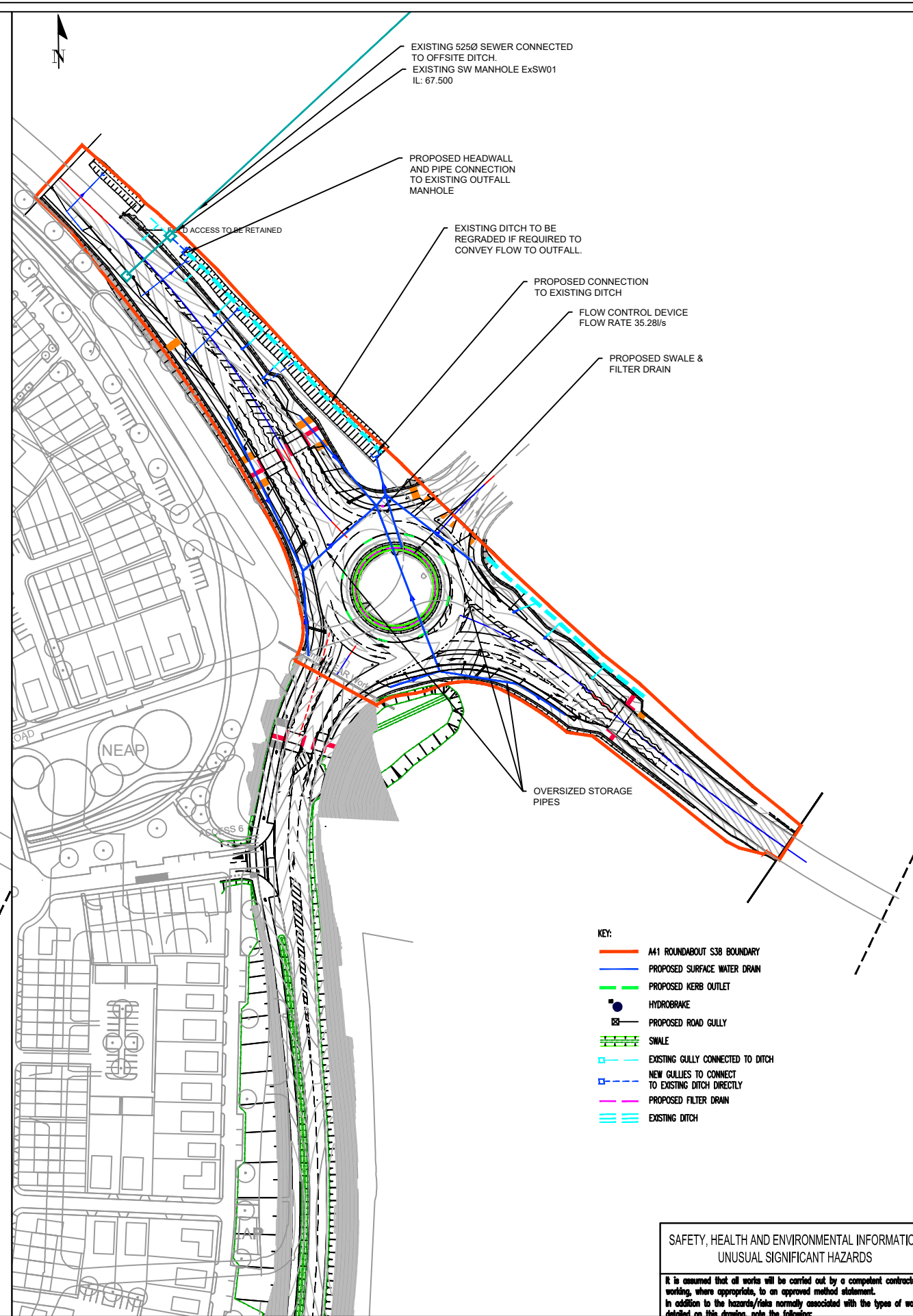

DRAINAGE STRATEGY PLAN

This drawing should not be scaled. Dimensions to be verified on site. Any discrepancies should be referred to the Engineer prior to work being put in hand.

This drawing is the property of Waterman Infrastructure & Environment Limited, and the drawing is issued on the condition that it is not copied, reproduced, retained or disclosed to any unauthorised person, either wholly or in part without the consent in writing of Waterman Infrastructure & Environment Limited. Pickfords Wharf, Clerk Street, London SE1 9DG. 1 020 7928 7888 1 020 7902 0992

### GENERAL NOTES

- THIS DRAWING IS TO BE READ IN CONJUNCTION WITH ALL ENGINEER'S, ARCHITECT'S OR OTHER RELEVANT DRAWINGS AND SPECIFICATIONS.
- ALL DIMENSIONS AND LEVELS ARE TO BE CHECKED ON SITE BY THE CONTRACTOR PRIOR TO PREPARING ANY WORKING DRAWINGS OR COMMENCING ON SITE.
- THE CONTRACTOR MUST ENSURE AND WILL BE HELD RESPONSIBLE FOR THE OVERALL STABILITY OF THE BUILDING/STRUCTURE/EXCAVATION AT ALL STAGES OF THE WORK.
- ALL WORK BY THE CONTRACTOR MUST BE CARRIED OUT IN SUCH A WAY THAT ALL REQUIREMENTS UNDER THE HEALTH AND SAFETY AT WORK ACT ARE SATISFIED.
- ALL WORK IS TO BE CARRIED OUT IN COMPLIANCE WITH THE REQUIREMENTS OF THE RELEVANT STATUTORY AUTHORITIES AND REGULATIONS.
- OS DATA, TOPOGRAPHICAL SURVEY AND LIDAR DATA PROVIDED BY GLENN HOWELLS ARCHITECTS ON 3RD OCTOBER 2013
- ADDITIONAL DRAINAGE SURVEY INFORMATION PROVIDED BY MK SURVEYS ON 18TH DECEMBER 2014
- LAND TRANSFER AREA 1&2 BOUNDARY BASED ON GLENN HOWELLS ARCHITECTS DRAWING NO: 1982-A-L-573 REV V
- NORTHERN AREA MASTERPLAN PROVIDED BY GLENN HOWELLS, DRAWING NO: 1982-A-L-011-AA
- EMPLOYMENT AREA MASTERPLAN PROVIDED BY INC DESIGN, DRAWING NO: INC-SA[20]020 REV. P08
- CHOICE OF SURFACE WATER ATTENUATION FUTURE SUBJECT TO PROPOSED ROUNDABOUT FINISHED LEVELS.
- INVERT LEVELS OF PIPE SHOWN HERE ARE INDICATIVE MINIMUM INVERT LEVELS SUBJECT TO FINAL ROUNDABOUT DESIGN LEVELS.
- DRAINAGE PROPOSAL IS SUBJECT TO APPROVAL BY OXFORDSHIRE COUNTY COUNCIL HIGHWAYS/DRAINAGE ENGINEERS.

Rev	Date	Description	By
A04	03.09.21	DISCHARGE RATE AMENDED	KP
A03	25.05.21	GULLY LOCATION AND CATCHMENT AMENDED	KP
A02	21.04.21	DISCHARGE RATE REISED AND OVERSIZED PIPES USED FOR ATTENUATION	KP
A01	19.06.20	PLANNING ISSUE	KP

Amendments

Project: **GRAVEN HILL, BICESTER**

Title: **A41 ROUNDABOUT SURFACE WATER DRAINAGE STRATEGY**

Client: **Graven Hill Village Development Company Limited**

**Waterman**  
Office Address: Telephone & Fax numbers: 1 020 7928 7888 / 1 020 7902 0992. Email: mail@watermanigroup.com. www.watermanigroup.com

Drawing Status: **PLANNING**

Designed by: KP. Checked by: NJH. Project No: WIE11386

Drawn by: KP. Date: 18.06.2020

Scalors @ A1: NTS. Computer File No: WIE11386-4542-000 Roundabout Drainage Strategy A04.dwg

Publisher	Zone	Category	Number	Revision
WIE	145	92	500	A04

SAFETY, HEALTH AND ENVIRONMENTAL INFORMATION  
UNUSUAL SIGNIFICANT HAZARDS

It is assumed that all works will be carried out by a competent contractor working, where appropriate, to an approved method statement. In addition to the hazards/risks normally associated with the types of work defined on this drawing, note the following:

CONSTRUCTION  
1. 2. 3.

MAINTENANCE / CLEANING  
1. 2. 3.

DECOMMISSIONING / DEMOLITION  
1. 2. 3.

1:1  
0 10 20 30 40 50 60 70 80 90 100