

This drawing should not be scaled. Dimensions to be verified on site. Any discrepancies should be referred to the Engineer prior to work being put in hand.

This drawing is the property of Waterman Infrastructure & Environment Limited, and the drawing is issued on the condition that it is not copied, reproduced, retained or disclosed to any unauthorised person, either wholly or in part without the consent in writing of Waterman Infrastructure & Environment Limited  
Pickfords Wharf, Clink Street, London SE1 9DG 1 020 7928 7888 1 020 7902 0992

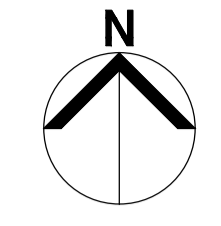

**GENERAL NOTES**

1. THIS DRAWING IS TO BE READ IN CONJUNCTION WITH ALL ENGINEER'S, ARCHITECT'S OR OTHER RELEVANT DRAWINGS AND SPECIFICATIONS.
2. ALL DIMENSIONS AND LEVELS ARE TO BE CHECKED ON SITE BY THE CONTRACTOR PRIOR TO PREPARING ANY WORKING DRAWINGS OR COMMENCING ON SITE.
3. THE CONTRACTOR MUST ENSURE AND WILL BE HELD RESPONSIBLE FOR THE OVERALL STABILITY OF THE BUILDING/STRUCTURE/EXCAVATION AT ALL STAGES OF THE WORK.
4. ALL WORK BY THE CONTRACTOR MUST BE CARRIED OUT IN SUCH A WAY THAT ALL REQUIREMENTS UNDER THE HEALTH AND SAFETY AT WORK ACT ARE SATISFIED.
5. ALL WORK IS TO BE CARRIED OUT IN COMPLIANCE WITH THE REQUIREMENTS OF THE RELEVANT STATUTORY AUTHORITIES AND REGULATIONS.
6. ROAD LAYOUT AND HIGHWAY WORKS SHALL BE IN ACCORDANCE WITH DMRB AND OXFORD COUNTY COUNCIL (OCC) STANDARDS.

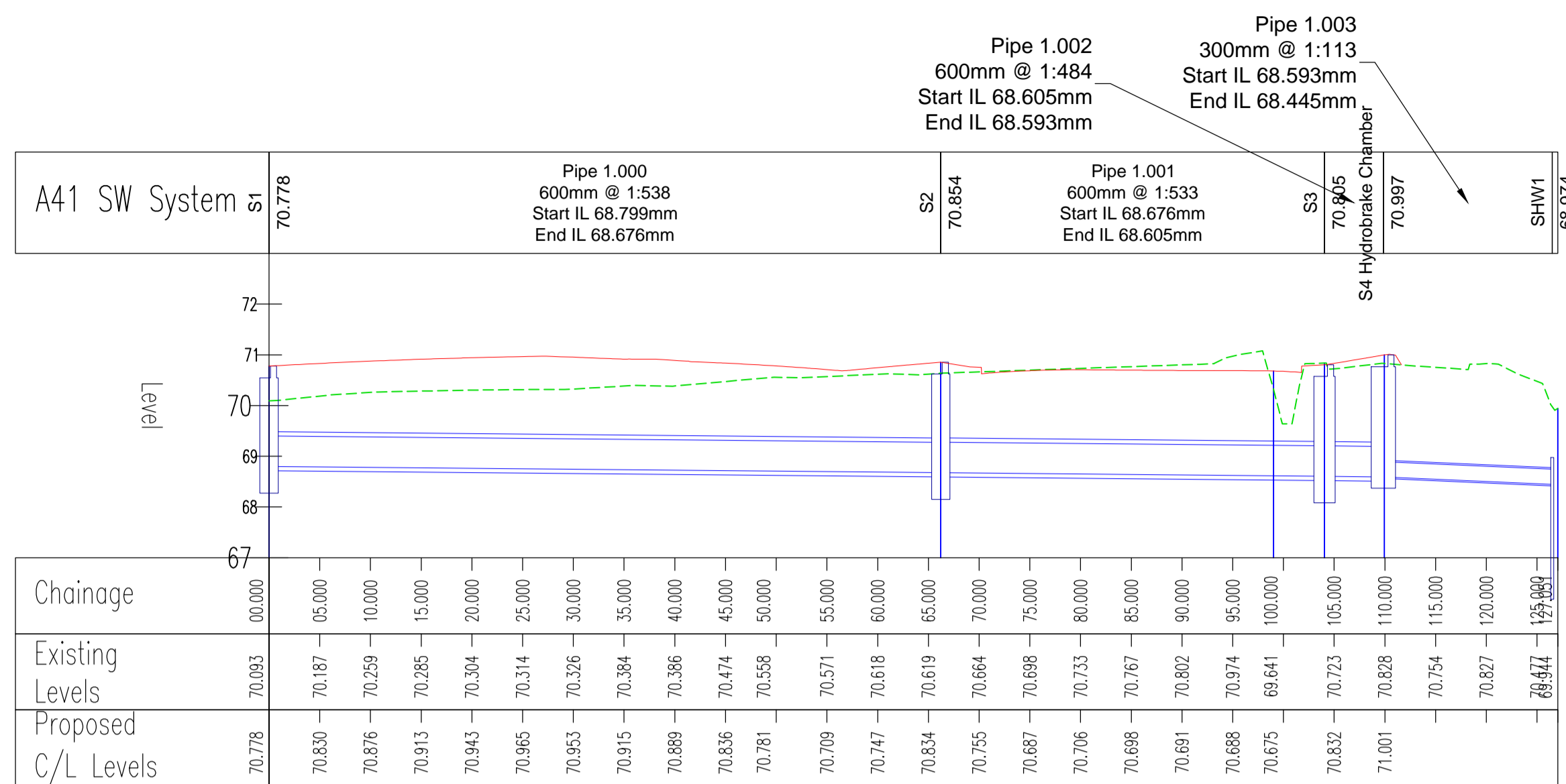

RUN 1  
SCALE: H 1:500,V 1:100. DATUM: 67.000

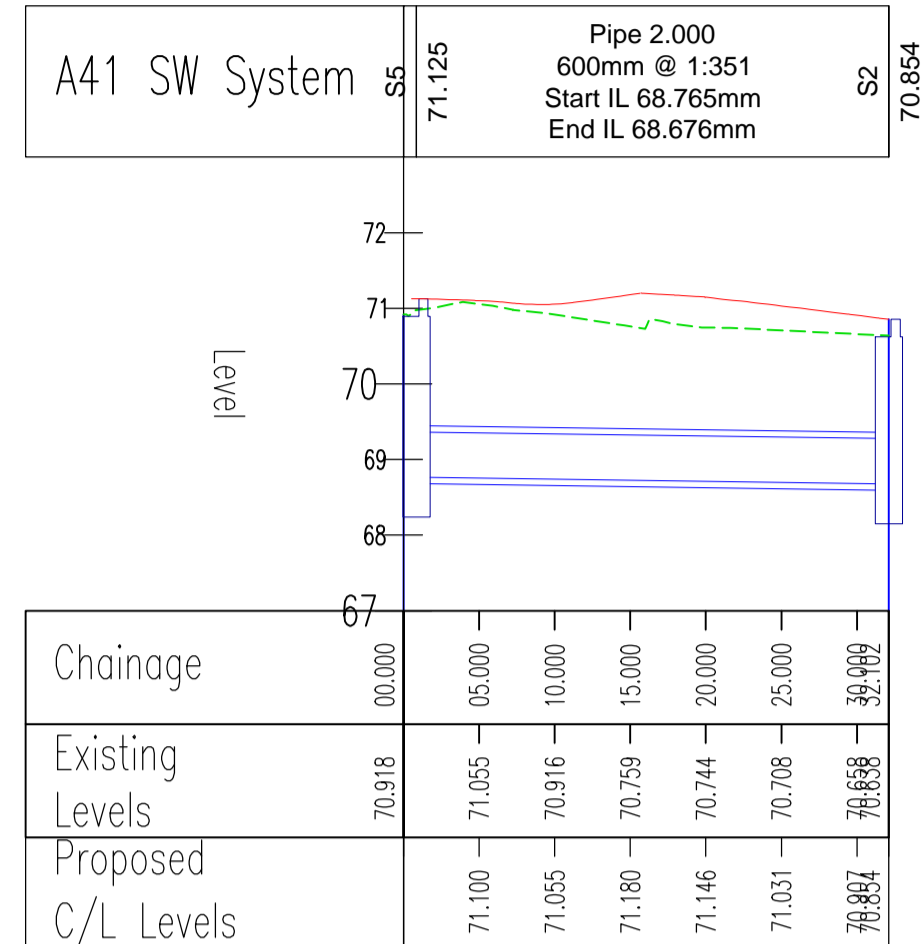

RUN 2  
SCALE: H 1:500,V 1:100. DATUM: 67.000

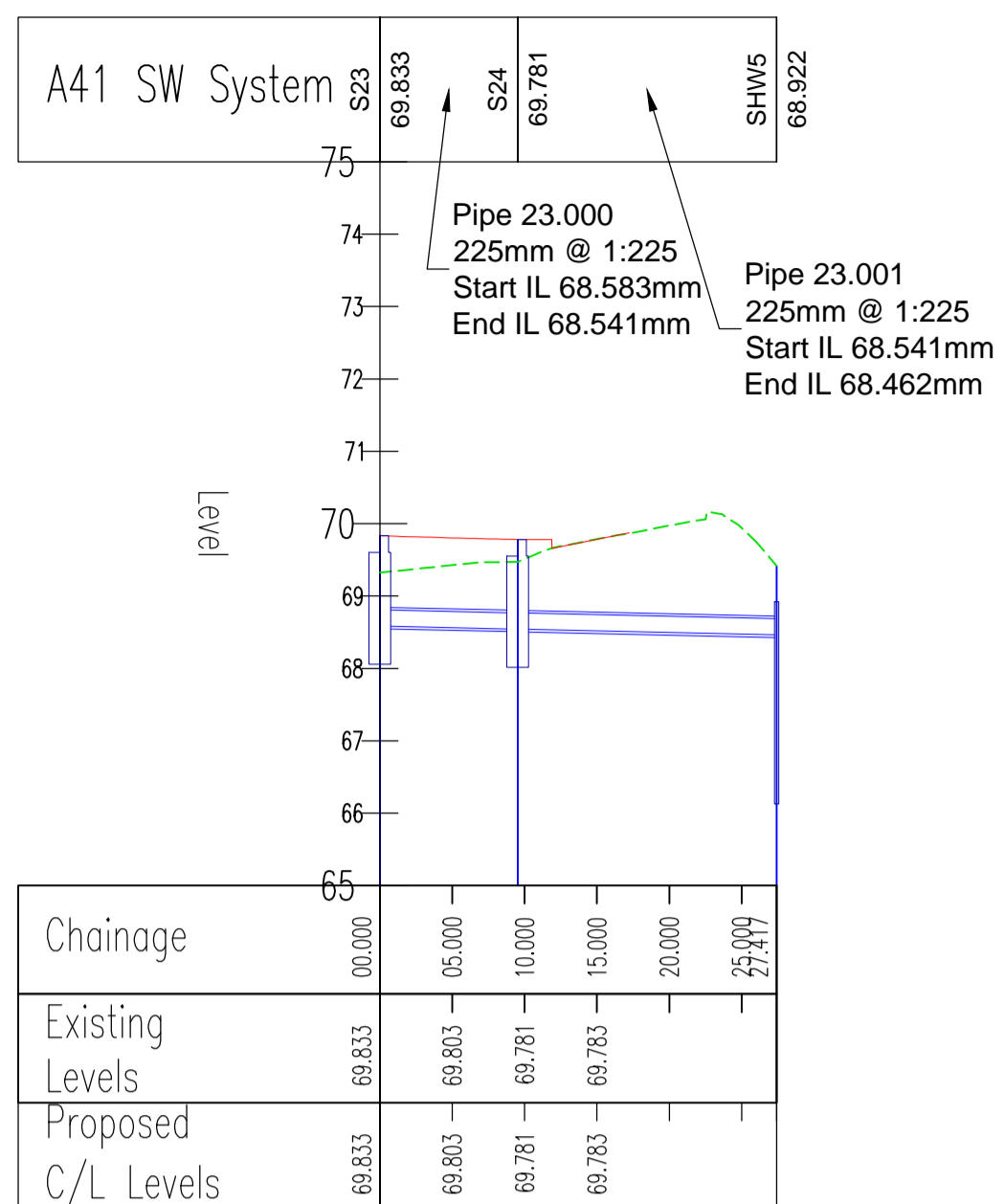

SW RUN 23  
SCALE: H 1:500,V 1:100. DATUM: 65.000

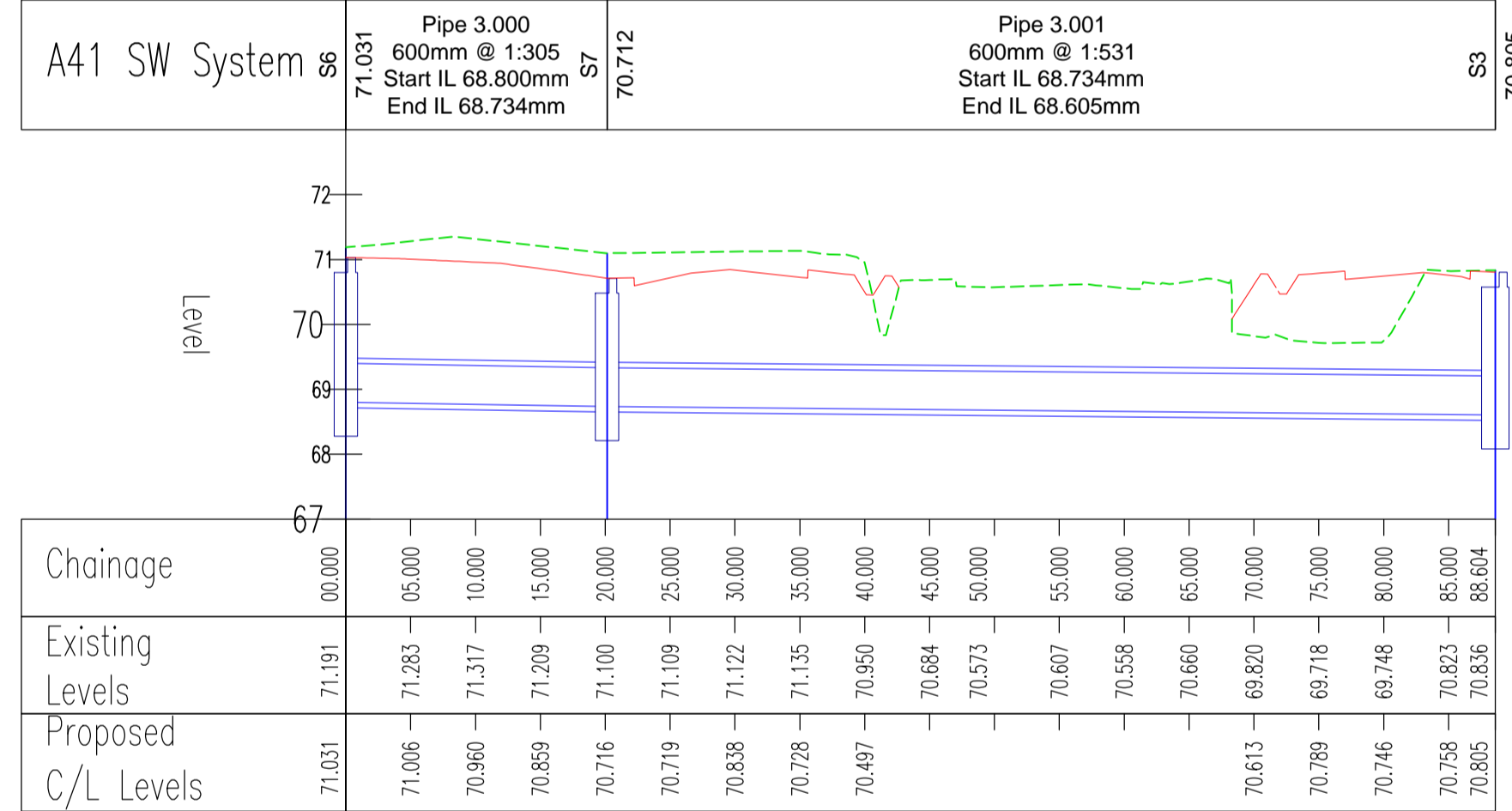

RUN 3  
SCALE: H 1:500,V 1:100. DATUM: 67.000

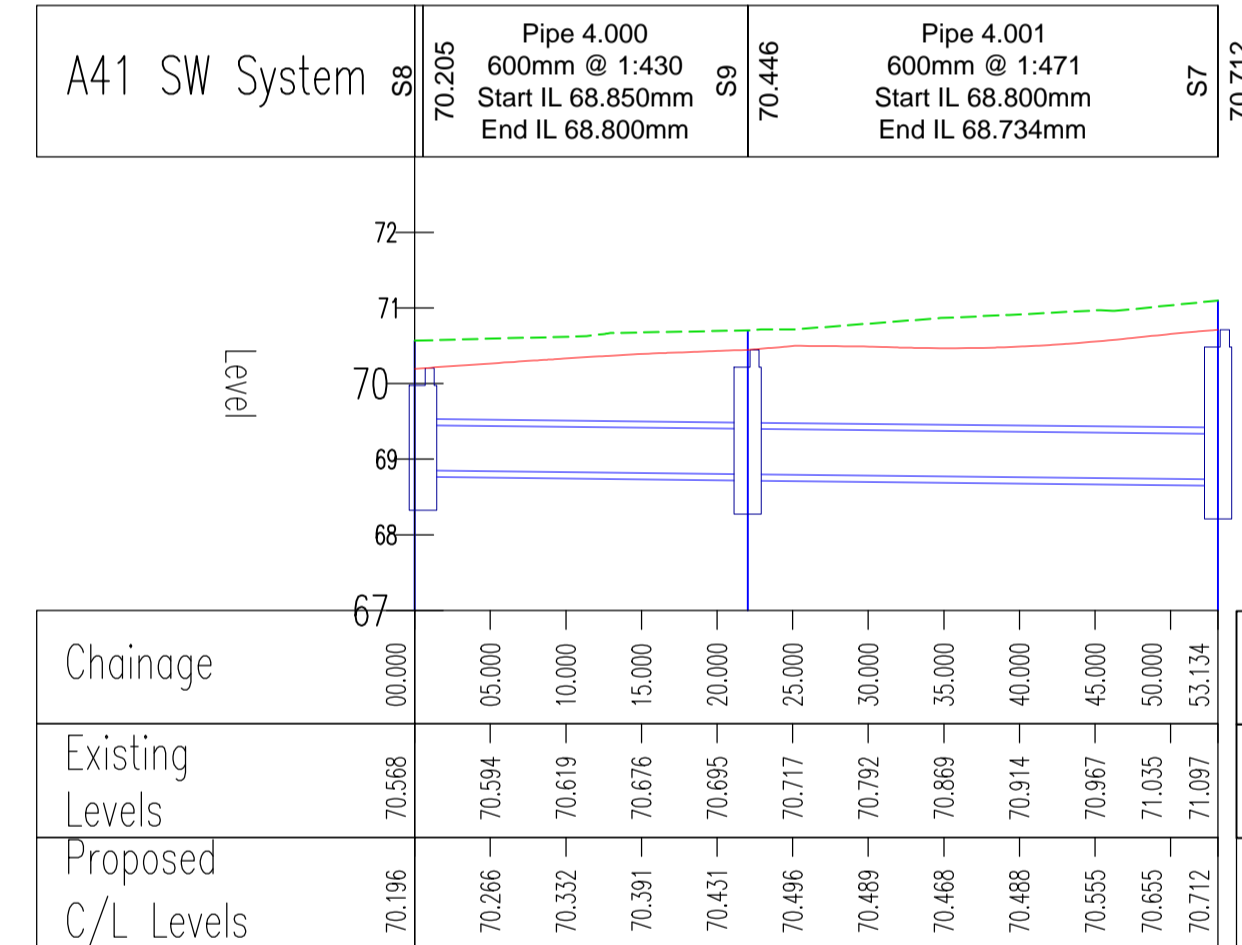

RUN 4  
SCALE: H 1:500,V 1:100. DATUM: 67.000

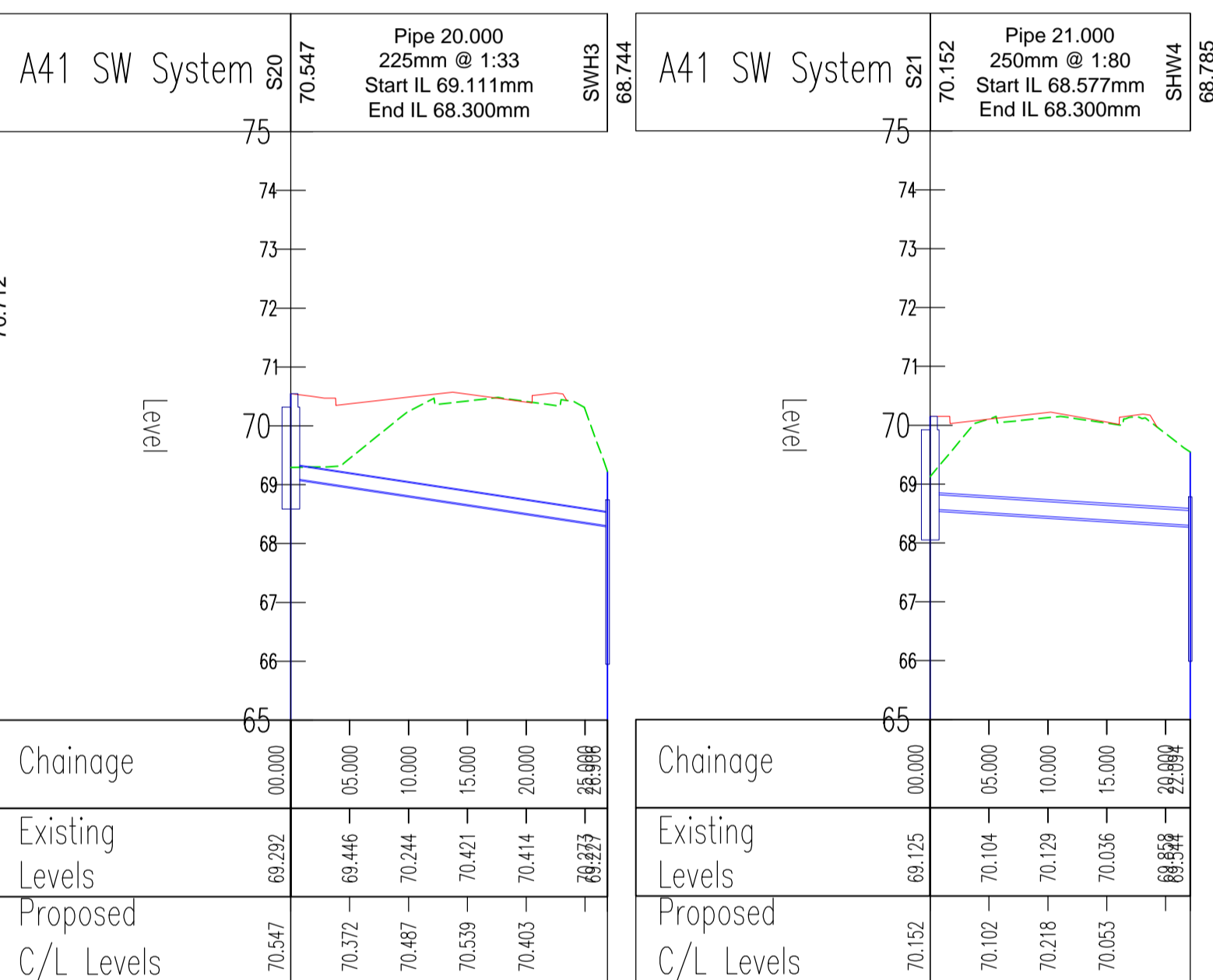

SW RUN 20  
SCALE: H 1:500,V 1:100. DATUM: 65.000

SW RUN 21  
SCALE: H 1:500,V 1:100. DATUM: 65.000

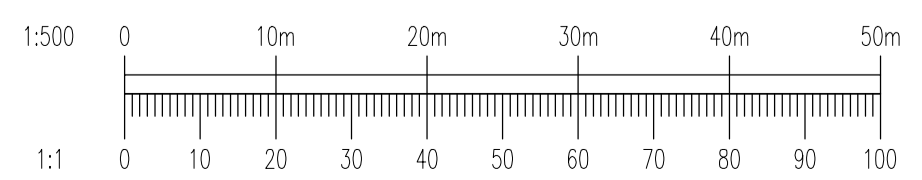
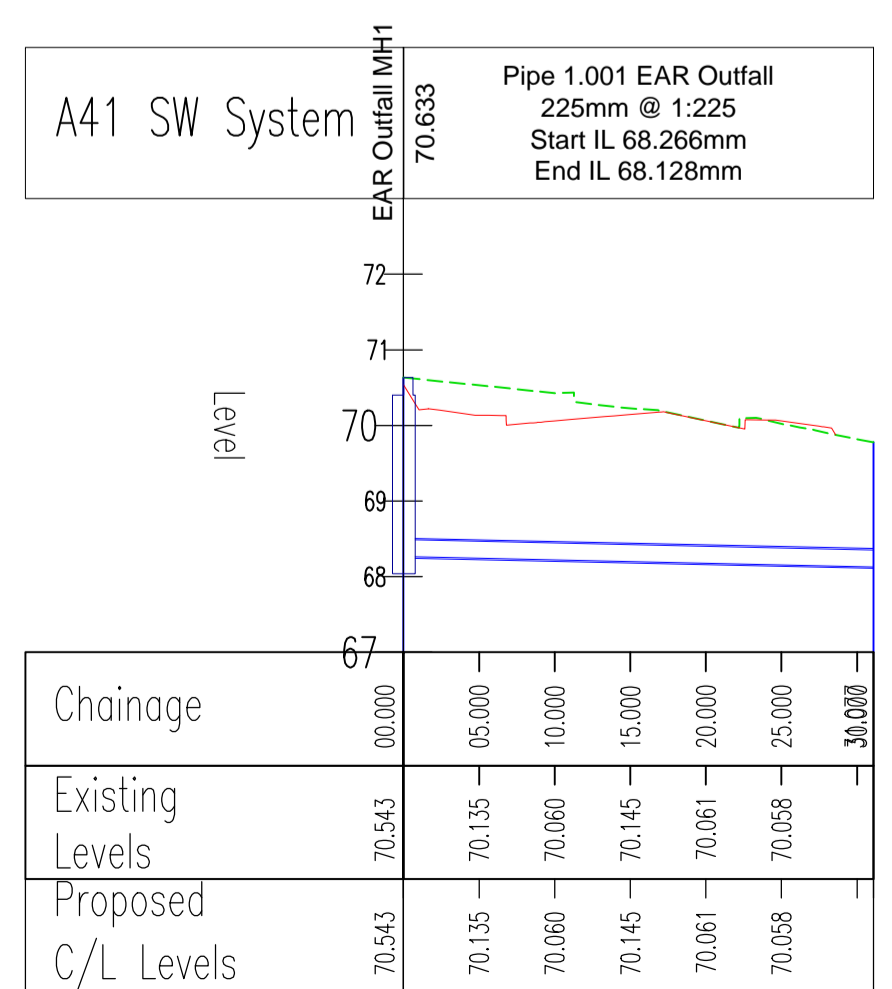
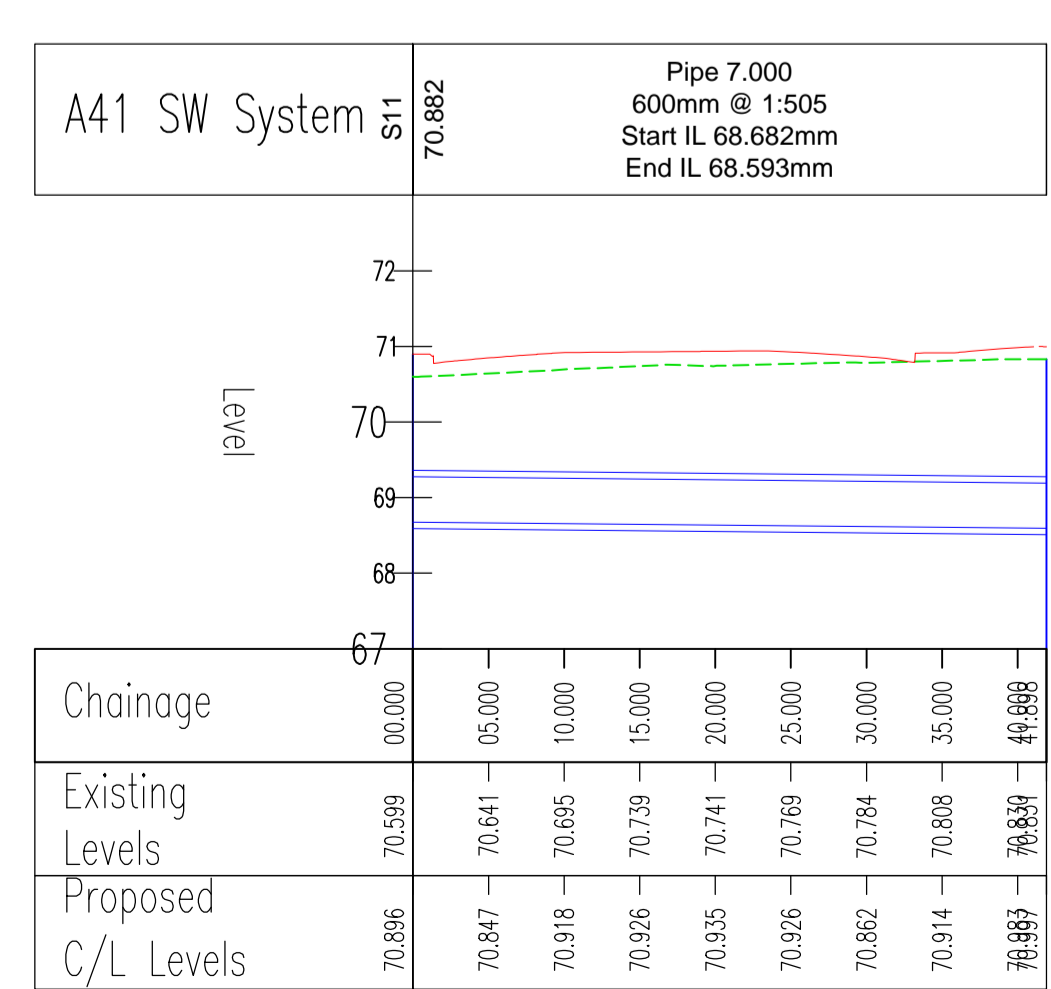
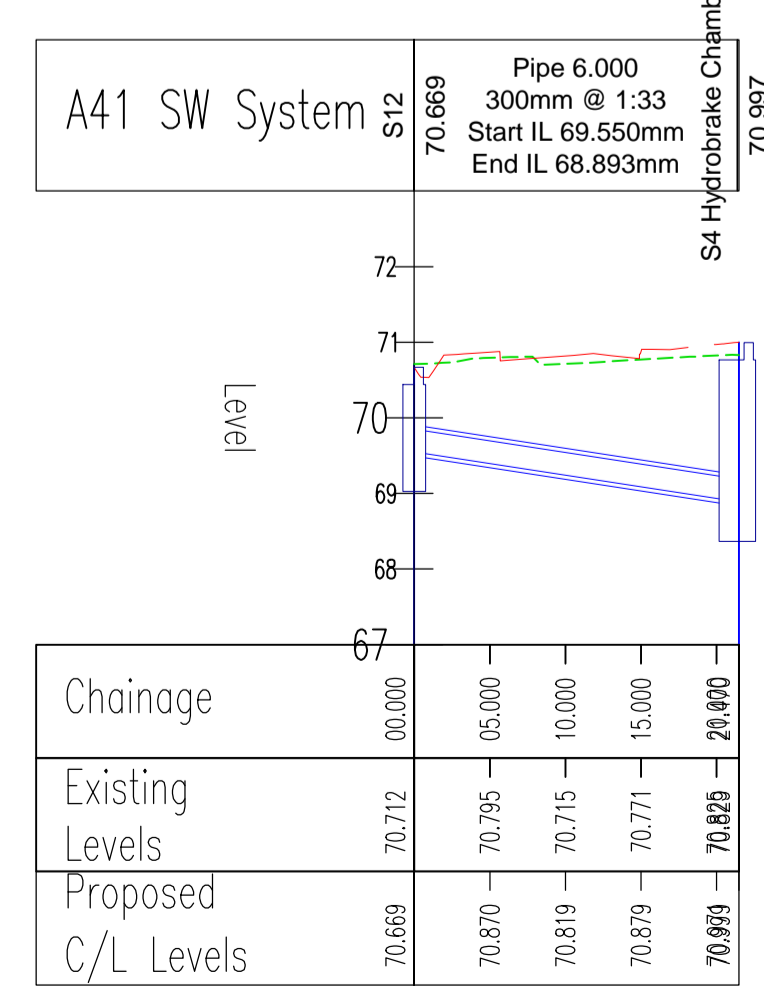
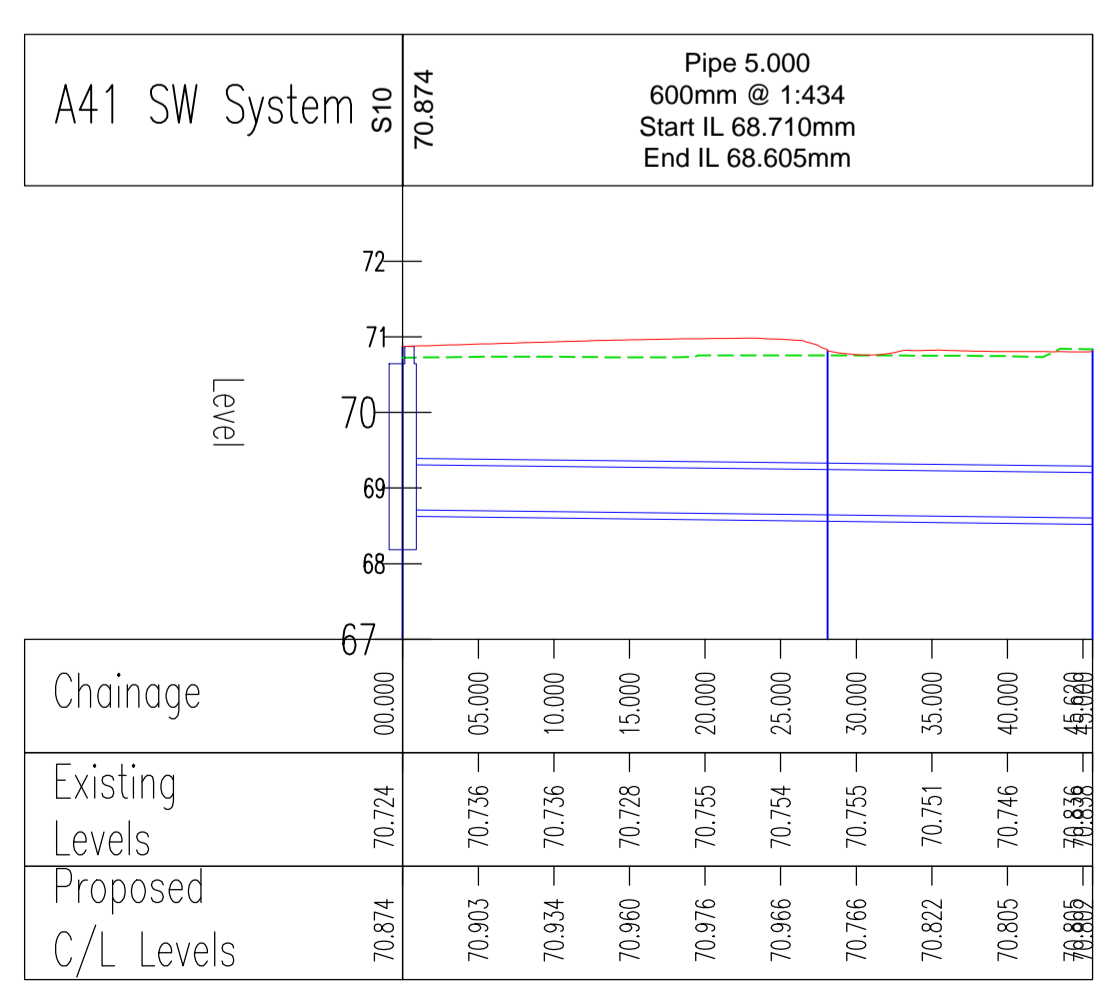

Rev	Date	Description	By
A03	21.05.21	ADDITIONAL DRAINAGE RUNS ADDED	DP
A02	20.04.21	LONG SECTION AMENDED TO SUIT DRAINAGE NETWORK CHANGES	KP
A01	05.03.21	FIRST ISSUE	ST

Amendments	
Project	GRAVEN HILL, BICESTER
Title	A41 PIONEER ROUNDABOUT DRAINAGE LONGSECTIONS
Client	Graven Hill Village Development Company Limited

5th Floor One Cornwall Street Birmingham B3 2DX  
1 0121 212 7700  
mail@watermangroup.com www.watermangroup.com

Drawing Status				
<b>PRELIMINARY</b>				
Designed by	JG	Checked by	DP	Project No
Drawn by	AN	Date	MAR 2021	WIE11386
Scales @ A1		Computer File No		
work to figured dimensions only		WIE11386-A41-90-551 - Drainage - A03.dwg		
Publisher	Zone	Category	Number	Revision
WIE	A41	90	552	A03

File Path: N:\Projects\WIE11386\_A41\Drawings\_Series\_CadPO\_Sw\W0490\_CadPO.dwg