

Plant Schedule

Trees						
Number	Species	Common Name	Girth	Height	Specification	Pot Size
590 -	Fagus sylvatica	Common Beech		60-80cm	BR :Whip	
4 -	Carpinus betulus	Common Hornbeam	12-14cm		3x :Heavy Standard :Clear Stem 175-200 :RB	
4 -	Acer campestre	Common Maple	12-14cm		3x :Heavy Standard :Clear Stem 175-200 :RB	
5 -	Quercus robur	Common Oak	12-14cm		3x :Heavy Standard :Clear Stem 175-200 :RB	
10 -	Sorbus aucuparia	Rowan	10-12cm		2x :Selected Standard :Clear Stem 175-200 :RB	
3 -	Betula pendula 'Purpurea'		10-12cm		2x :Selected Standard :Clear Stem 175-200 :RB	
3 -	Malus 'Evereste'	Crab Apple 'Evereste'	10-12cm		2x :Selected Standard :Clear Stem 175-200 :RB	
5 -	Malus domestica		10-12cm		2x :Selected Standard :Clear Stem 175-200 :RB	
4 -	Prunus avium	Wild Cherry	10-12cm		2x :Selected Standard :Clear Stem 175-200 :RB	
1 -	Acer campestre	Common Maple	10-12cm		2x :Selected Standard :Clear Stem 175-200 :RB	
1 -	Prunus spinosa	Sloe	10-12cm		2x :Selected Standard :Clear Stem 175-200 :RB	
2 -	Sorbus aria	Whitebeam	12-14cm		3x :Heavy Standard :Clear Stem 175-200 :RB	
3 -	Carpinus betulus	Common Hornbeam	10-12cm		2x :Selected Standard :Clear Stem 175-200 :RB	
1 -	Malus sylvestris	Common Crab Apple	10-12cm		2x :Selected Standard :Clear Stem 175-200 :RB	

Shrubs						
Number	Species	Common Name	Pot Size	Height	Specification	Density
5 -	Corylus avellana	Common Hazel	3L	3L	CG : C3 :Bushy	1/m ²

Mixed Species hedges						
Number	Species	Common Name	Height	Specification	Density	
590 -	Fagus sylvatica	Common Beech	60-80cm	BR :Whip	1Ctr Double Staggered at 1m offset	
6 -	Fagus sylvatica	Common Beech	BR	60-80cm BR :Whip		

Native Hedgerow						
Number	Species	Specification	Density	Percentage Contribution	Pot Size	
10 -	Carpinus betulus	Tansplant : 1+1 : BR	6/m	3%	BR	
16 -	Corylus avellana	Tansplant : 1+1 : BR	6/m	5%	BR	
201 -	Crataegus monogyna	Tansplant : 1+1 : BR	6/m	70%	BR	
30 -	Lonicera periclymenum	Branched :3/4 brks	6/m	10%	BR	
18 -	Prunus spinosa	Tansplant : 1+1 : BR	6/m	6%	BR	
10 -	Rhamnus cathartica	Tansplant : 1+1 : BR	6/m	3%	BR	
10 -	Rosa arvensis	Transplant :1+1 :BR	6/m	3%	BR	
Total :295 -						

Native Scrub Mix						
Number	Species	Specification	Density	Percentage Contribution	Pot Size	
58 -	Acer campestre	BR :Whip	5/m ²	15%	BR	
39 -	Corylus avellana	BR :Whip	5/m ²	10%	BR	
58 -	Crataegus monogyna	BR :Whip	5/m ²	15%	BR	
58 -	Euonymus europaeus	BR :Whip	5/m ²	15%	BR	
58 -	Ilex aquifolium	BR :Whip	5/m ²	15%	BR	
58 -	Viburnum lantana	BR :Whip	5/m ²	15%	BR	
58 -	Viburnum opulus	BR :Whip	5/m ²	15%	BR	
Total :387 -						

Ornamental Shrub Bed 1						
Number	Species	Specification	Density	Percentage Contribution	Pot Size	
68 -	Ceanothus thyrsiflorus repens	CG	5/m ²	30%	2L	
46 -	Hypericum calycinum	CG	5/m ²	20%	5-7.5L	
68 -	Lavandula angustifolia 'Hidcote'	C	5/m ²	30%	5-7.5L	
46 -	Salix repens argentea	CG	5/m ²	20%	5-7.5L	
Total :228 -						

Ornamental Shrub Bed 2						
Number	Species	Specification	Density	Percentage Contribution	Pot Size	
33 -	Allium 'Purple Sensation'	Grade 5+	5/m ²	20%	1-1.5L	
46 -	Buxus sempervirens 'Glencoe'	1+2: C5	5/m ²	30%	10L	
40 -	Galanthus nivalis	Grade 4/5	5/m ²	25%	1-1.5L	
40 -	Trillium grandiflorum	Grade 6/7	5/m ²	25%	1-1.5L	
Total :159 -						

Ornamental Shrub Bed 3						
Number	Species	Specification	Density	Percentage Contribution	Pot Size	
69 -	Euonymus fortunei 'Emerald 'n' Gold'	2yr : CG : C2 : Bushy	5/m ²	40%	5-7.5L	
54 -	Lavandula angustifolia 'Hidcote'	2yr : CG : C2 : Bushy	5/m ²	30%	5-7.5L	
54 -	Rosmarinus offi.'Miss Jessop's Upright'	2yr : CG : C2 : Bushy	5/m ²	30%	5-7.5L	
Total :177 -						

Shrubs and Perennials Mix						
Number	Species	Specification	Density	Percentage Contribution	Pot Size	
131 -	Allium sphaerocephalon	Grade 4 : 5/6cm	5/m ²	20%		
100 -	Dahlia 'Lisa'	3 yr : CG : C5 : Full pot	5/m ²	15%	5L.5L	
68 -	Hebe diosmifolia	2 yr : CG : C3 : Bushy	5/m ²	10%	3L	
36 -	Phormium 'Platt's Black'	2 yr : CG : C3 : Upright	5/m ²	5%	3L	
223 -	Stipa barbata	3 yr : CG : C5 : Clumped	5/m ²	35%	5L	
100 -	Verbena 'Homestead Purple'	2yr : CG : C3 : Spreading	5/m ²	15%	3L	
Total :658 -						

Ground Cover Shrub Mix						
Number	Species	Specification	Density	Percentage Contribution	Pot Size	
11 -	Hebe 'Carnea'	3 yr : CG : C5 : Bushy	5/m ²	20%	5L	
8 -	Hebe 'Charming White'	3 yr : CG : C5 : Bushy	5/m ²	15%	5L	
6 -	Hebe 'Emerald Green'	3 yr : CG : C5 : Bushy	5/m ²	10%	5L	
11 -	Hebe 'Lisa'	3 yr : CG : C5 : Bushy	5/m ²	20%	5L	
11 -	Hebe 'Raven'	3 yr : CG : C5 : Bushy	5/m ²	20%	5L	
8 -	Hebe pinguifolia 'Sutherlandii'	3 yr : CG : C5 : Bushy	5/m ²	15%	5L	
Total :55 -						

Ornamental Shrub Mix 2						
Number	Species	Specification	Density	Percentage Contribution	Pot Size	
49 -	Deutzia compacta	2yr : CG : C2 : Bushy	5/m ²	10%	2L	
68 -	Genista lydia	2yr : CG : C2 : Bushy	5/m ²	15%	2L	
68 -	Hebe 'Red Edge'	2yr : CG : C2 : Bushy	5/m ²	15%	2L	
68 -	Hebe rakaiensis	2yr : CG : C2 : Bushy	5/m ²	15%	2L	
49 -	Hypericum moserianum	2yr : CG : C2 : Bushy	5/m ²	10%	2L	
49 -	Lavandula angustifolia 'Hidcote Pink'	2yr : CG : C2 : Bushy	5/m ²	10%	2L	
49 -	Potentilla fruticosa 'Tangerine'	2yr : CG : C2 : Bushy	5/m ²	10%	2L	
68 -	Prunus cistena 'Crimson Dwarf'	2yr : CG : C2 : Bushy	5/m ²	15%	2L	
Total :468 -						

Ornamental Shrub Mix 3						
Number	Species	Specification	Density	Percentage Contribution	Pot Size	
26 -	Cotinus coggygia 'Golden Spirit'	C :Bushy	5/m ²	30%	5L	
30 -	Hydrangea paniculata	C :Bushy	5/m ²	35%	5L	
30 -	Rosa 'Apfelblüte'	C :Bushy	5/m ²	35%	5L	
Total :86 -						

Bulbs Mix 1						
Number	Species	Specification	Density	Percentage Contribution	Pot Size	
58 -	Crocus chrysanthus 'Blue Pearl'		6/m ²	25%	1-1.5L	
58 -	Galanthus nivalis		6/m ²	25%	1-1.5L	
58 -	Narcissus pseudonarcissus lobularis		6/m ²	25%	1-1.5L	
58 -	Tulipa 'Double early'	C	6/m ²	25%	1-1.5L	
Total :232 -						

Bulbs Mix 2						
Number	Species	Specification	Density	Percentage Contribution	Pot Size	
23 -	Galanthus nivalis		6/m ²	25%	1-1.5L	
19 -	Hyacinthoides non-scripta		6/m ²	20%	1-1.5L	
19 -	Narcissus 'Peeping Tom'		6/m ²	20%	1-1.5L	
14 -	Tulipa 'Daydream'		6/m ²	15%	1-1.5L	
19 -	Tulipa 'Spring Greens'		6/m ²	20%	1-1.5L	
Total :94 -						

Seed Mixes					
Supplier	Seed Mix	Description	Density	Total Area	Total kg
Emorsgate	EH1	Hedgerow Mix	4g/m ²	2,182.11 m ²	9
Emorsgate	EN8	Wetland Meadow Mix	4g/m ²	267.57m ²	2

NOTE: all shrub beds to be managed to ensure that no species encroaches on the growth and establishment of other species (e.g. ceanothus adjacent to lavender)

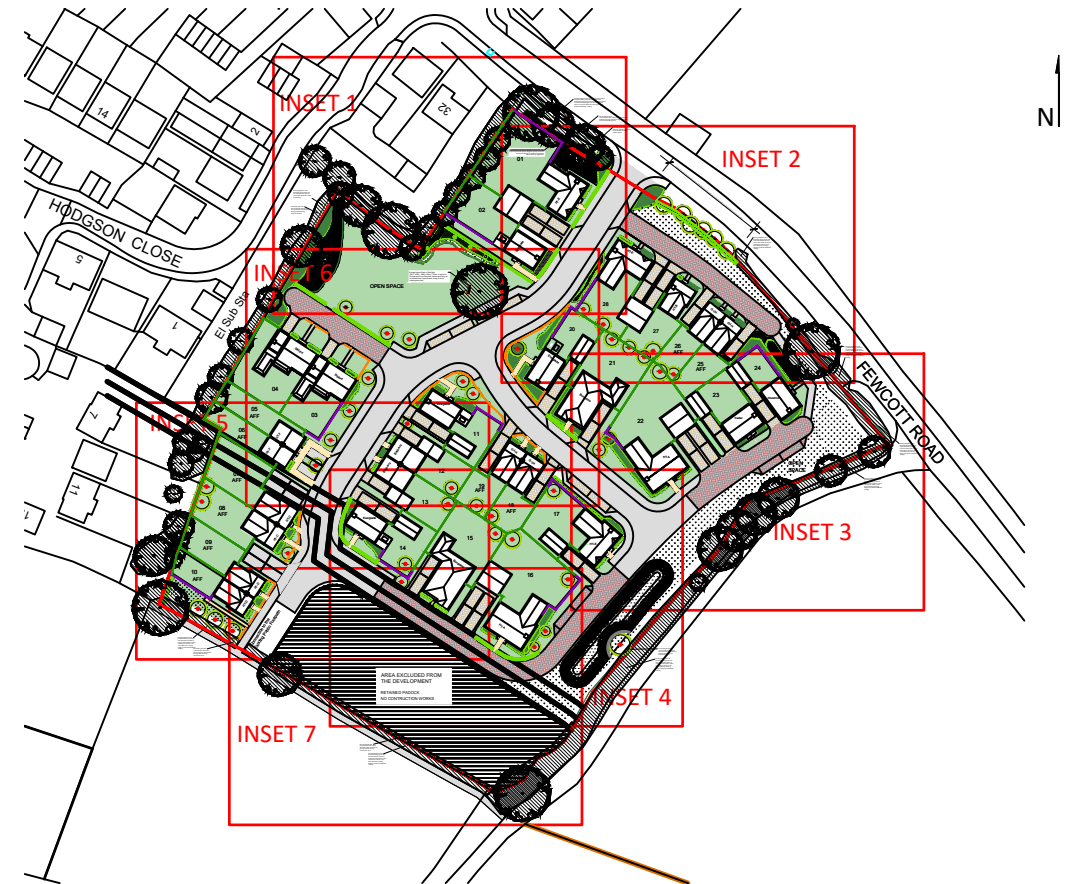

REVISIONS:		
DATE:	VERSION:	INITIALS:
NICHOLSONS LOCKHART GARRATT		
<i>Leading solutions for the natural environment</i>		
TITLE: Plant Schedule and Overview		
PROJECT/SITE: Fewcott Road, Fritwell		
CLIENT: CALA Homes		
MAP REF: 20-4772		
REVISION: V12		
DATE: 27/07/22	SCALE: N/A	
APPROVED BY: RF	PRODUCED BY: JHA	
<small>Reproduction with the permission of The Controller of Her Majesty's Stationery Office Crown Copyright (c) Licence number: AL 52281A000 Lockhart Garratt Ltd 8 Melbourne House, Corbygate Business Park, Weldon, Corby, Northants NN17 5JG. Not to be reproduced without the permission of Lockhart Garratt Ltd.</small>		
7 - 8 Melbourne House Corbygate Business Park Weldon, Corby Northamptonshire NN17 5JG 01536 408840 www.nicholsonsgb.com		The Park North Aston Bicester Oxfordshire OX25 6HL 01869 340342 www.lockhart-garratt.co.uk