



Key
 Proposed area of native woodland
 0.56ha of native woodland offset to achieve Biodiversity Net Gain (BNG).

- 109 No Acer campestre
 - 119 No Crataegus monogyna
 - 109 No Fagus sylvatica
 - 109 No Prunus avium
 - 109 No Quercus robur
 - 109 No Rosa canina
 - 109 No Salix caprea
 - 109 No Sambucus nigra
 - 109 No Viburnum opulus
- To be planted in groups at 2m centres

REFER TO GRAVEN HILL PHASE B DEVELOPMENT PLANS

REFER TO GRAVEN HILL PHASE B DEVELOPMENT PLANS

GRAVEN HILL WOOD

Notes:

- Drawing only to be used for the purpose it was created.
- All dimensions are shown in millimeters unless otherwise specified.

Drawing to be read in conjunction with:

- External Works Specification.
- Landscape & Ecological Management Plan.
- Softworks Schedule and Details.
- Arboricultural Documentation including Tree Protection and Removal Plan.

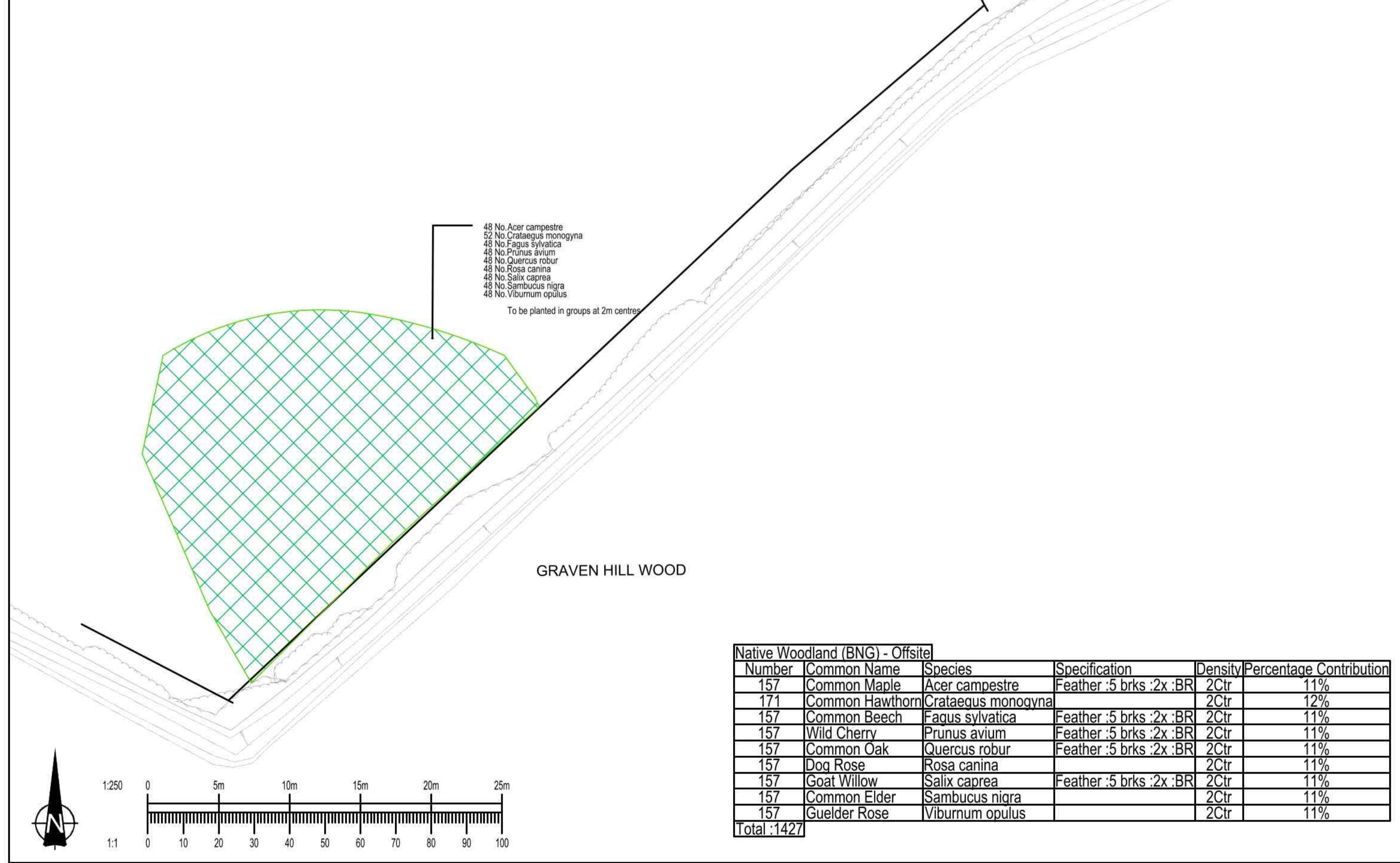

- 48 No Acer campestre
 - 52 No Crataegus monogyna
 - 48 No Fagus sylvatica
 - 48 No Prunus avium
 - 48 No Quercus robur
 - 48 No Rosa canina
 - 48 No Salix caprea
 - 48 No Sambucus nigra
 - 48 No Viburnum opulus
- To be planted in groups at 2m centres

GRAVEN HILL WOOD

Native Woodland (BNG) - Offsite					
Number	Common Name	Species	Specification	Density	Percentage Contribution
157	Common Maple	Acer campestre	Feather .5 brks .2x .BR	2Ctr	11%
171	Common Hawthorn	Crataegus monogyna		2Ctr	12%
157	Common Beech	Fagus sylvatica	Feather .5 brks .2x .BR	2Ctr	11%
157	Wild Cherry	Prunus avium	Feather .5 brks .2x .BR	2Ctr	11%
157	Common Oak	Quercus robur	Feather .5 brks .2x .BR	2Ctr	11%
157	Dog Rose	Rosa canina		2Ctr	11%
157	Goat Willow	Salix caprea	Feather .5 brks .2x .BR	2Ctr	11%
157	Common Elder	Sambucus nigra		2Ctr	11%
157	Gelder Rose	Viburnum opulus		2Ctr	11%
Total					1427

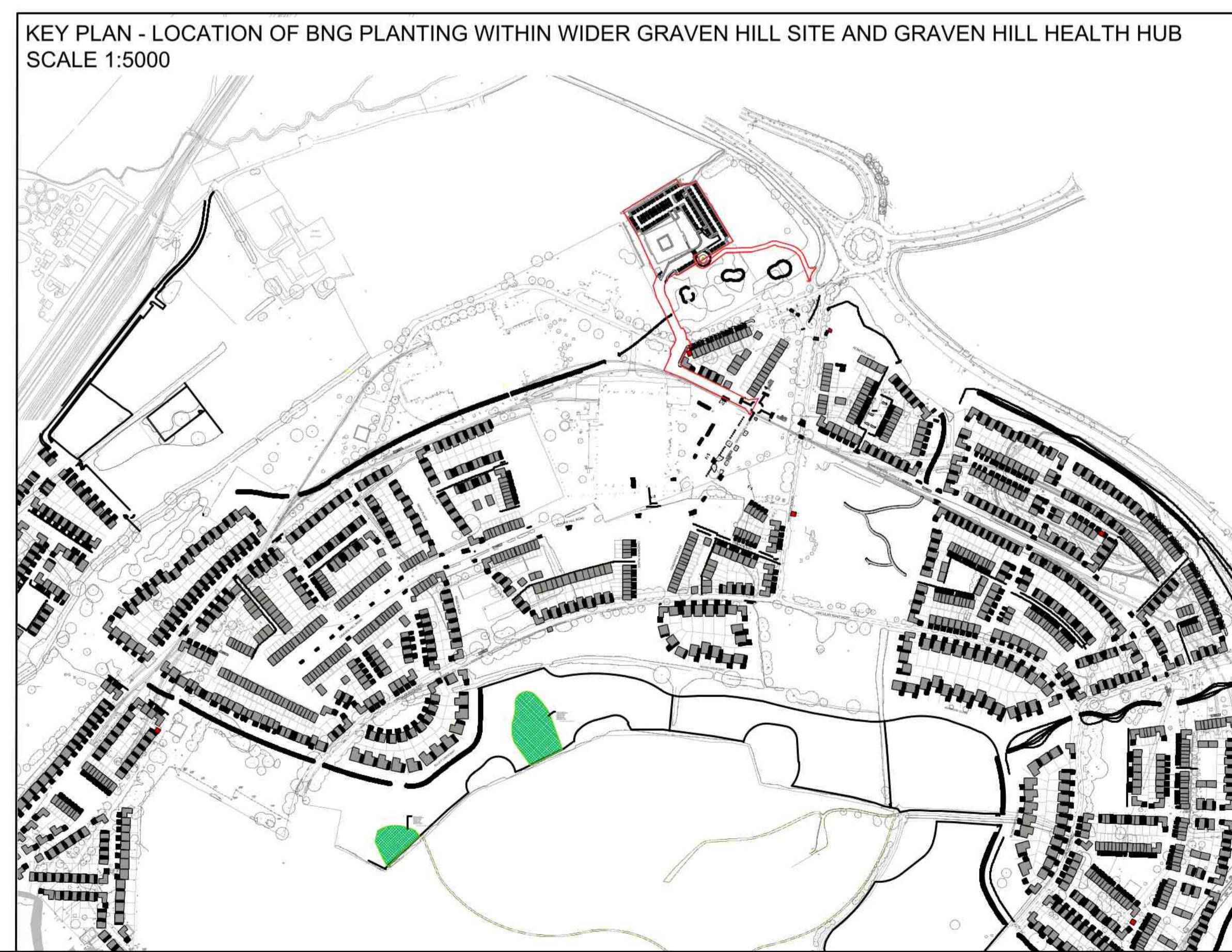

KEY PLAN - LOCATION OF BNG PLANTING WITHIN WIDER GRAVEN HILL SITE AND GRAVEN HILL HEALTH HUB
 SCALE 1:5000

T02	S2	12.04.22	ISSUED FOR TENDER	AB	TH
T01	S2	08.04.22	ISSUED FOR TENDER	AB	TH
Status	Date	Description		By	CHK

Amendments

Project: **GRAVEN HILL HEALTH HUB**

Title: **BIODIVERSITY NET GAIN OFFSET LOCATION PLAN**

Client: **ASSURA PLC**



Merchants House | Wapping Road | Bristol BS1 4RW
 1 0117 937 8200
 mail@watermangroup.com www.watermangroup.com

INFORMATION				S2
Designed By	AB	Director	TH	Waterman Ref
Drawn By	AB	Date	March 2022	Scales @ A1
Project - Originator - Volume - Level - Type - Role - Number				Revision
WIE16470-ZZ-XX-DR-L-74-101				T02

