



LEGEND

- TOPSOIL PLACEMENT (200mm where reused)
- FILL MATERIAL (Min 600mm cover over Marlstone rock volumes)
- CUT MATERIAL
- MARLSTONE ROCK (Placed in Insp & sports pitch A)
- EXISTING GROUND
- TOPSOIL STRIP

NOTES

LEAP

Total fill available = 51084m³
 Fill volume consists of: 3870m³ Marlstone Rock deposits, 2385m³ Topsoil, 44826m³ Suitable Material

Topsoil reuse volume = 2385m³ assuming 0.2m thickness

For Sports Pitch A sections refer to drawing: WPF-HYD-XX-XX-DR-C-0210
 For Sports Pitch B sections refer to drawing: WPF-HYD-XX-XX-DR-C-0211
 For site wide Cut & Fill Analysis refer to drawing: WPF-HYD-XX-XX-DR-C-2400

NOTES

REVISIONS

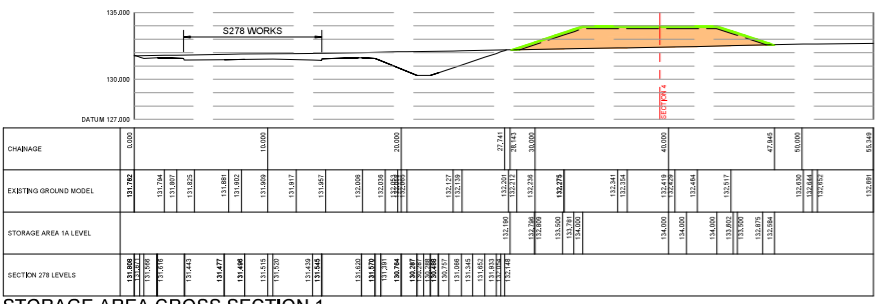

STORAGE AREA CROSS SECTION 1
SCALE 1:200

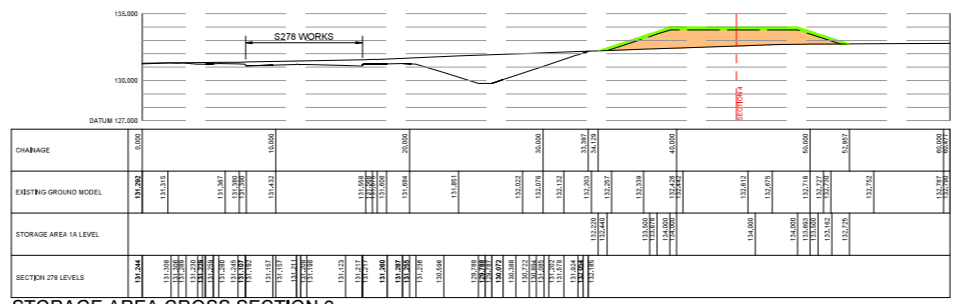

STORAGE AREA CROSS SECTION 2
SCALE 1:200

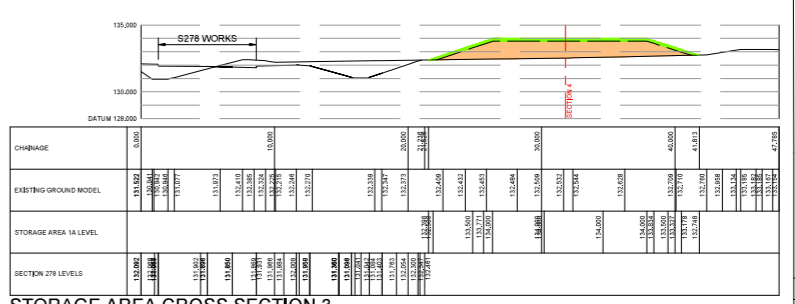

STORAGE AREA CROSS SECTION 3
SCALE 1:200

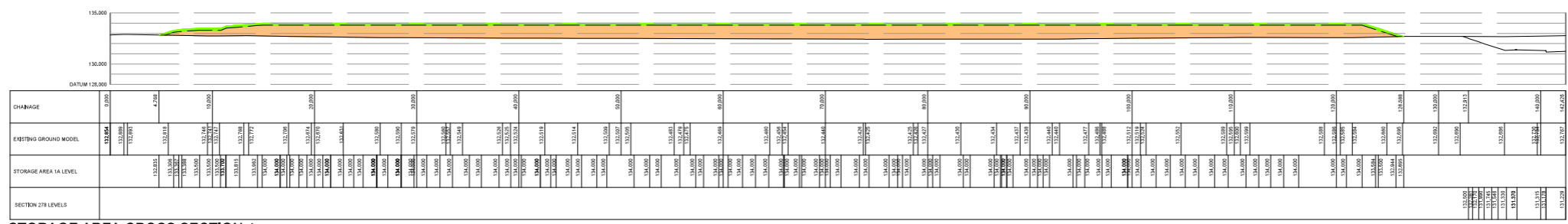

STORAGE AREA CROSS SECTION 4
SCALE 1:200

Rev	Date	Description	By	CHK	APP
P03	14/05/20	Updated swathe profiles	MF	SM	SM
P02	27/04/20	Add grey scale layout	MF	SM	SM
P01	10/04/20	First issue	MF	SM	SM

Hydrock
 OVER COURT BAYNS
 OVER LAKE
 PLANTING/SCULPTURE
 DESIGN
 8532 5TH
 1-48 800 354 028533
 h@hydrock.com

CLIENT
 L & Q ESTATES

PROJECT
 WYKHAM PARK FARM
 BANBURY

TITLE
 CUT AND FILL ANALYSIS
 STORAGE AREA 1A

HYDROCK PROJECT NO. C-04841-C	SCALE @ A0 1:1000	STATUS DESCRIPTION INFORMATION	STATUS S2
DRAWING NO. / PROJECT CODE OR DRAWING ZONE LEVEL / TYPE / ROLE NUMBER WPF-HYD-XX-XX-DR-C-0209		REVISION P03	

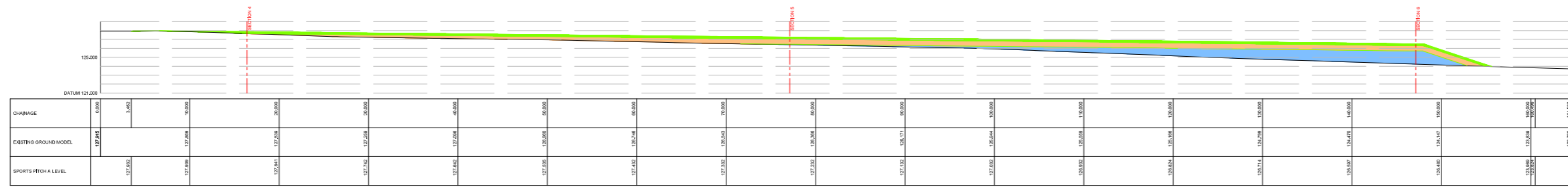

SPORTS PITCH A CROSS SECTION 1
SCALE 1:200

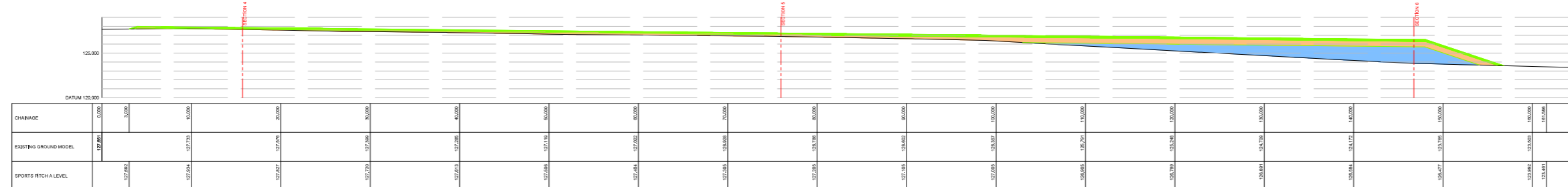

SPORTS PITCH A CROSS SECTION 2
SCALE 1:200

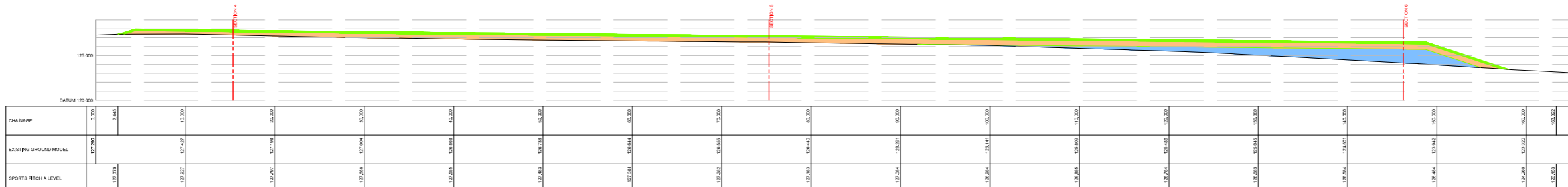

SPORTS PITCH A CROSS SECTION 3
SCALE 1:200

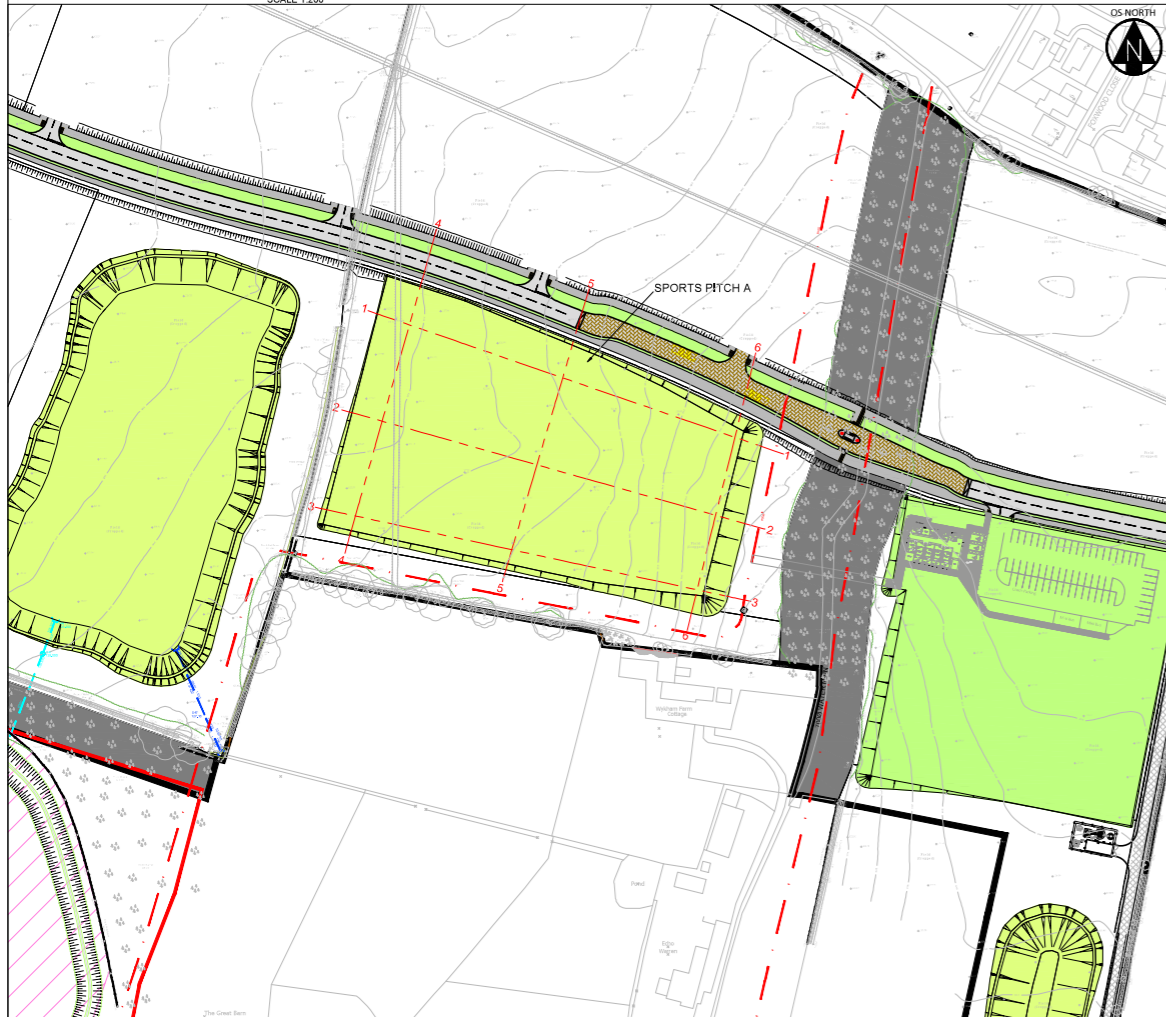

KEY PLAN

NOTES

Sports pitch A
 Total fill required = 11657m³
 Fill volume consists of:- 4125m³ of Marlstone Rock deposits, 2474m³ Topsoil, 5058m³ Sustainable Fill
 Topsoil reuse volume = 2474m³ assuming 0.2m thickness
 No topsoil strip has been assumed beneath the extent of Sports Pitch A
 For Sports Pitch B sections refer to drawing: WPF-HYD-XX-XX-DR-C-0211
 For LEAP sections refer to drawing: WPF-HYD-XX-XX-DR-C-0212
 For site wide Cut & Fill Analysis refer to drawing: WPF-HYD-XX-XX-DR-C-2400

LEGEND

	TOPSOIL PLACEMENT (200mm thickness where reused)
	FILL MATERIAL (Min 600mm cover over marlstone rock volumes)
	CUT MATERIAL
	MARLSTONE ROCK (Placed in leap & sports pitch A)
	EXISTING GROUND
	SPORTS PITCH A LEVEL
	THAMES WATER MAIN

NOTES (CONTINUED)

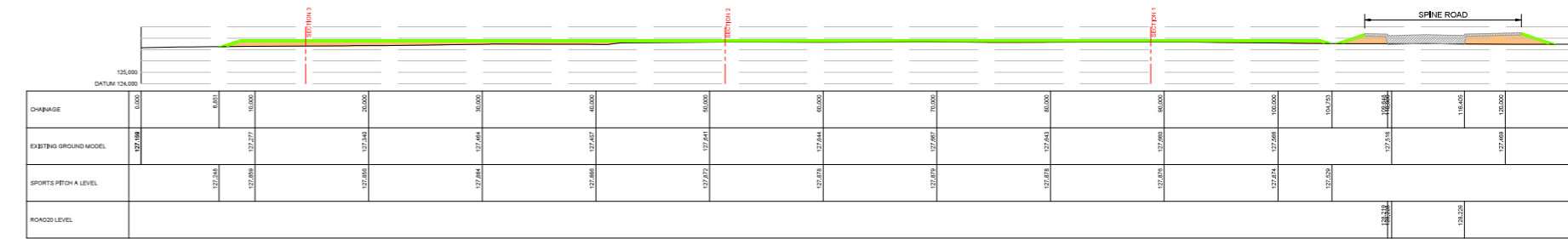

SPORTS PITCH A CROSS SECTION 4
SCALE 1:200

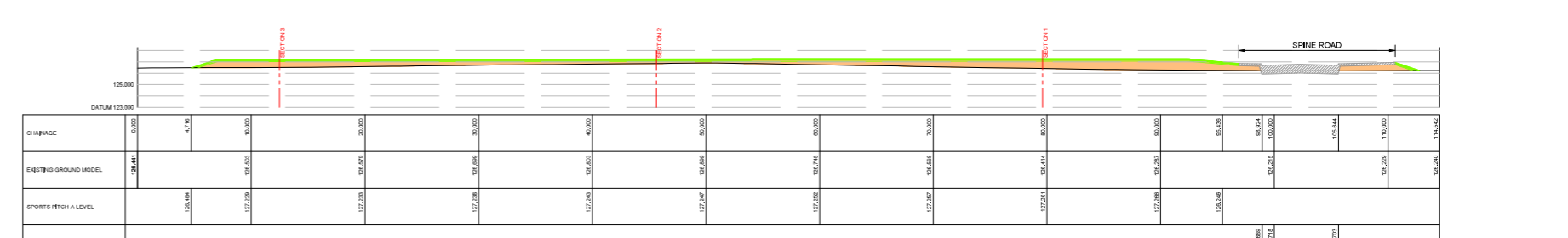

SPORTS PITCH A CROSS SECTION 5
SCALE 1:200

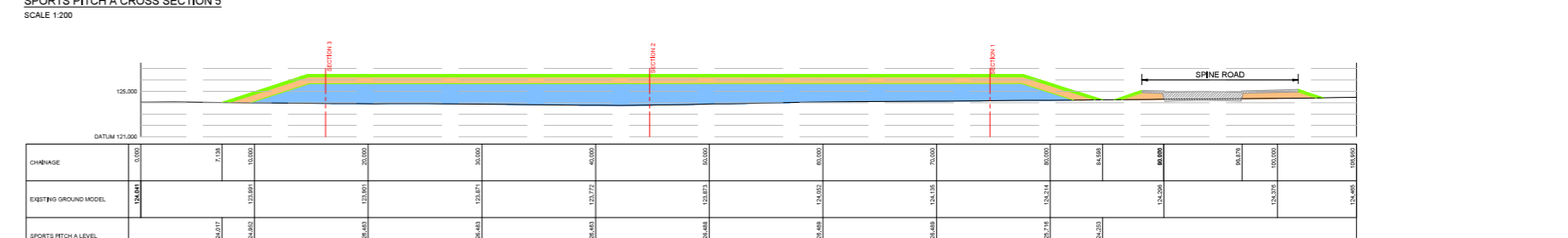

SPORTS PITCH A CROSS SECTION 6
SCALE 1:200

REVISIONS (CONTINUED)

REVISIONS

REV	NO	DATE	DESCRIPTION	BY	CHK	APP
P04	14/09/20		Basin shapes updated.	MF	SM	DM
P03	27/04/20		Added Greywacke Plan	MF	MF	DM
P02	02/03/20		Updated sports pitch area to avoid water main easement	MF	MF	DM
P01	21/10/19		First issue	MF	MF	DM

Hydrock
 OVER COURT BARS
 OVER LAKE
 ALMONDBURY
 BRIDGE
 B33 4EP
 T: +44 (0) 1454 61933
 e: bristol@hydrock.com

CLIENT
L & Q ESTATES

PROJECT
WYKHAM PARK FARM

TITLE CUT AND FILL ANALYSIS - SPORTS PITCH A SECTIONS	
HYDROCK PROJECT NO. C-04841-C	SCALE @ AD AS SHOWN
STATUS DESCRIPTION INFORMATION	STATUS S2
DRAWING NO. (PROJECT CODE ORIGINATOR 2D/3D LEVEL TYPE ROLE NUMBER) WPF-HYD-XX-XX-DR-C-0210	REVISION P04

