

### Temporary Diversion of PRoW 120-47 for duration of Onsite Infrastructure Works

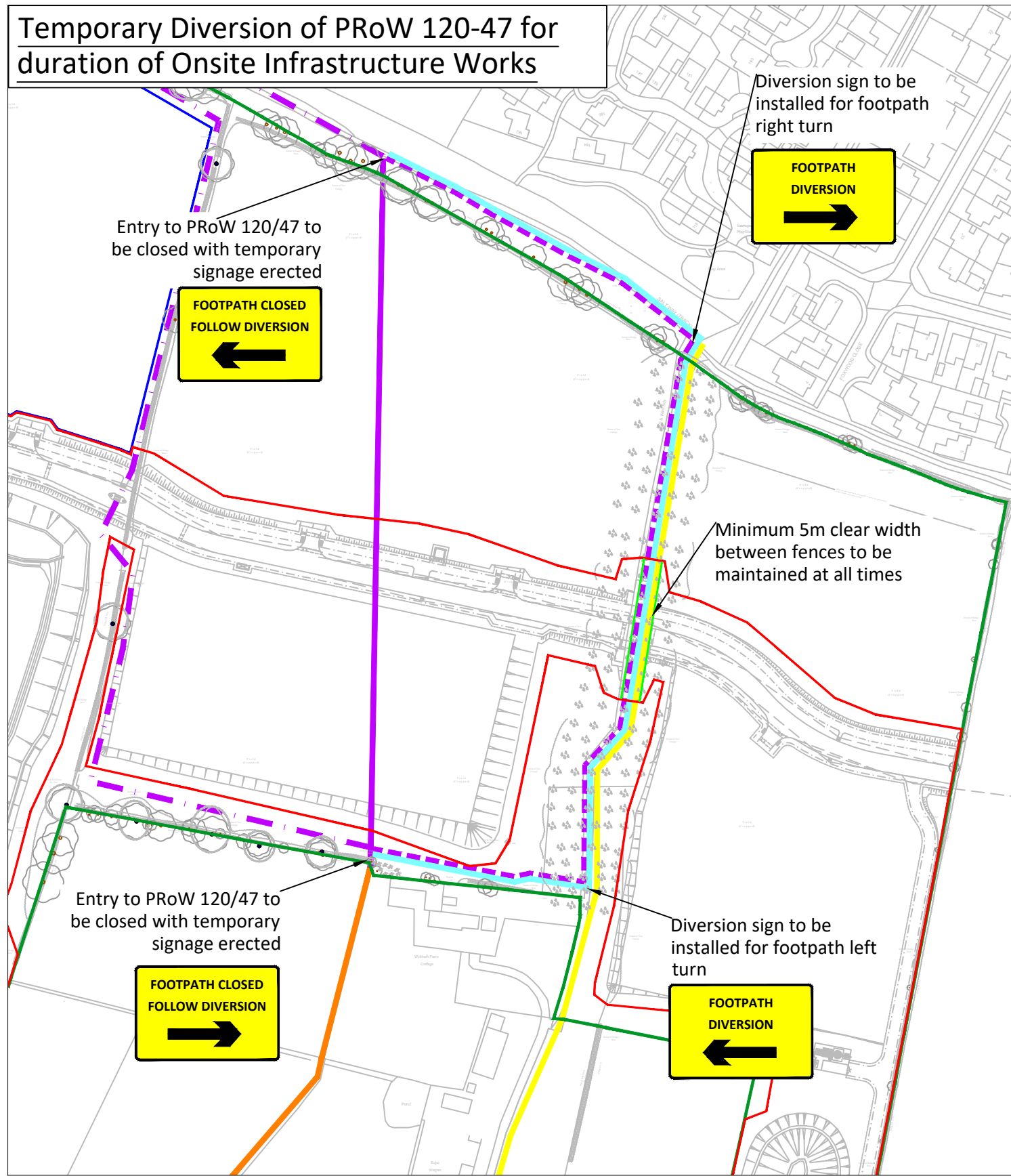

### Temporary Diversion East

Contractor to manage footpath diversions on site to suit construction programme

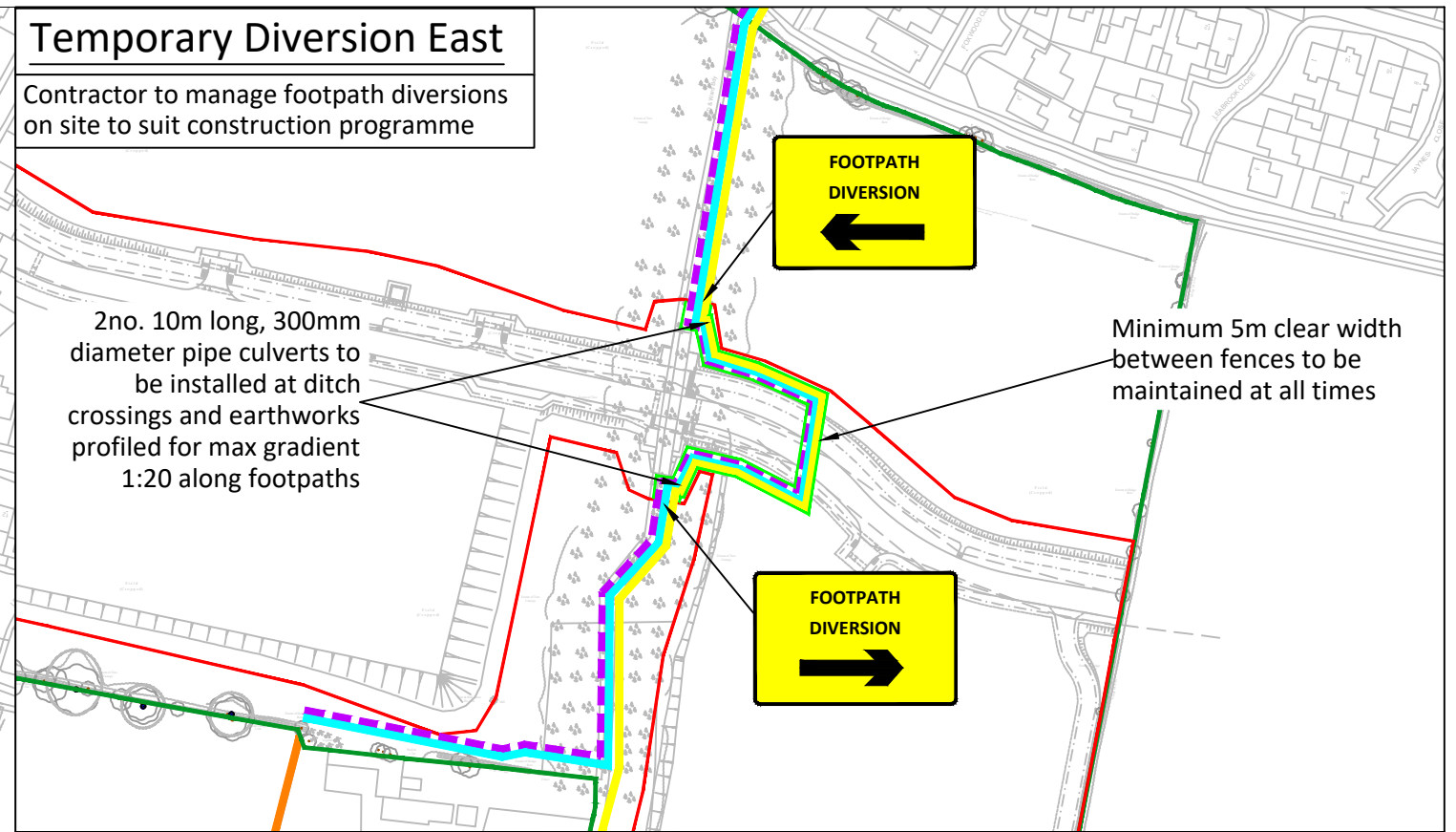

### Temporary Diversion West

Contractor to manage footpath diversions on site to suit construction programme

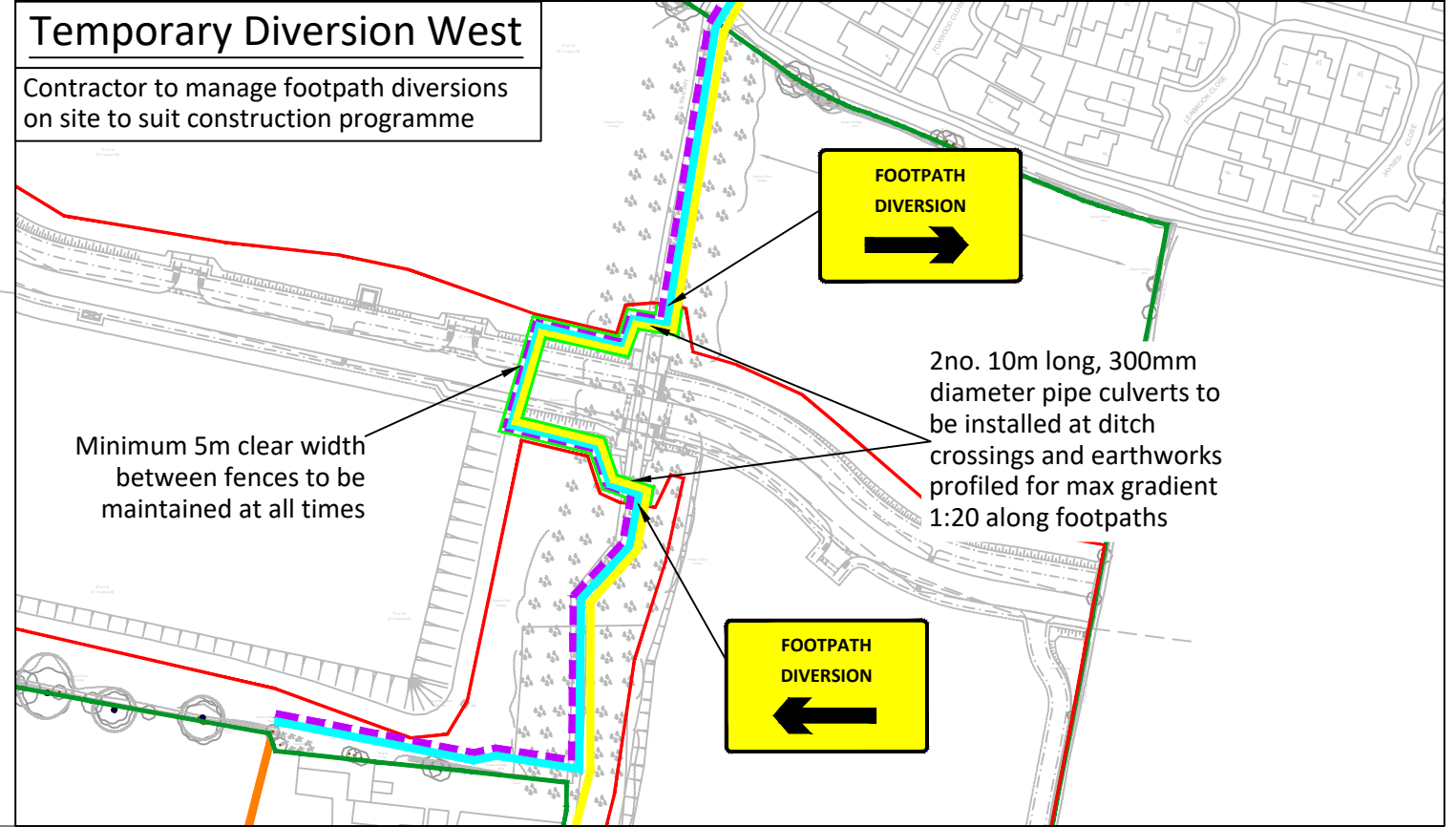

#### KEY

- PRoW 120-47 (existing)
- - - PRoW 120-47 (permanent diversion)
- · - · - PRoW 120-47 (temporary diversion)
- PRoW 120-49
- PRoW 120-46
- PRoW 137-11 (Bridleway)
- PRoW 136-16

- Works Boundary
- Planning Boundary
- Heras fencing to be installed around PRoW

NOTE: Place stone or chippings from tree clearance along footpath diversions to maintain clean paths. Where required ramps to be created with max gradient 1:20 along diversion routes.

Only figured dimensions are to be taken from this drawing. Do not scale. Any discrepancies must be reported to the Company before proceeding. The location of statutory undertakers apparatus is for guidance only. No guarantee is given as to its accuracy. This drawing is copyright and shall not be reproduced nor used in any form except by written permission. Crown Copyright. All rights reserved. Licence number 100020449 and 100027072.

REV	DATE	DESCRIPTION
	dd-mm-yyyy	

PROJECT - Wykham Park Farm, Banbury		
TITLE - Temporary Footpath Diversions		
SCALE - 1:1000 @ A3	DATE - 27-07-2021	DRAWN - KS
STATUS - DRAFT	DRAWING No - 8686-115	REVISION - -

# GALLAGHER ESTATES

Part of the L&Q Group

Gallagher House, Gallagher Way, Warwick CV34 6AF  
 e: mail@gallagherestates.com  
 w: www.gallagherestates.com  
 t: 01926 339339