

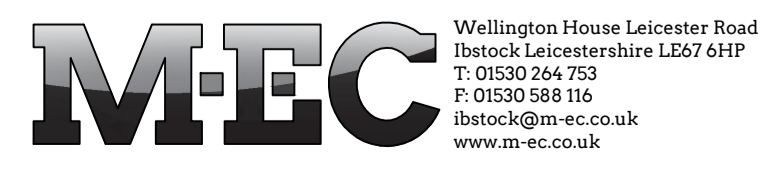

- ### General Notes
- Do not scale this drawing.
 - This drawing is to be read in conjunction with all other relevant Engineers, Architects and specialist design drawings and details.
 - All dimensions are in metres unless noted otherwise. All levels are in metres unless noted otherwise.
 - Any discrepancies noted on site are to be reported to the Engineer immediately.
 - All drainage works shall be carried out in accordance with Sewers for Adoption 8th edition.
 - The Contractor shall check all tie-ins for line and level with existing before commencing any works. The Engineer shall be notified immediately in writing, should any errors be found.
 - It is the responsibility of the Contractor to locate any service apparatus in the vicinity of the works. The client will not be liable for any loss or damage caused in respect of such apparatus, however caused.
 - It is the responsibility of the Contractor to execute the works at all times in strict accordance with the requirements of the Health and Safety at Work Act 1974, and the C.D.M. Regulations 2007. The Contractor will be deemed to have allowed for full compliance, including full liaison with the CDM Co-ordinator, within his rates.
 - The Contractor is responsible for ensuring that all works are to the satisfaction of the Engineer, and shall be deemed to have included within his rates for any necessary testing.
 - The Contractor will be responsible for providing all necessary de-watering and trench support to execute the works in a satisfactory manner, and shall be deemed to have allowed for the same within his rates.
 - All buried concrete products and mortar shall be made using sulphate resisting cement.
 - All materials for use in the contract must be BS kitemarked.
 - All lifting eyes in P.C.C. products shall be pointed smooth after fixing.
 - For highway & drainage longitudinal sections refer to drg no. 20488_02_157 - 162.
 - All guttering assumed to be polypropylene or similar. Max roof area drained to be no more than 120m² for end pipes and 240m² for center pipes. Guttering to have 1:600 fall.
 - House type working drawings for plots 1-3 currently unavailable, plot drainage omitted.

- ### Key
- S27 SIL 115.975 (225ø) 1.2m² MH Adoptable surface water sewer, S104 Water Industry Act (manhole ref, invert level, pipe diameter and manhole diameter shown)
 - F23 SIL 116.370 (150ø) 1.2m² MH Adoptable foul sewer, Section 104 Water Industry Act (manhole ref, invert level, pipe diameter and manhole diameter shown)
 - S2 SIL 115.975 (225ø) 1.2m² MH Adoptable foul rising main, Section 104 Water Industry Act
 - S27 SIL 115.975 (225ø) 1.2m² MH Adoptable highway drain (S38 Highways Act) (manhole ref, invert level, pipe diameter and manhole diameter shown)
 - Private lateral connection to adoptable sewer (connect soffit to soffit)
 - 450mm dia x 900mm deep trapped road gully grating and 150mm² gully connection (see drg no. 20488_02_166)
 - Private surface water drain & 460ø inspection chamber (invert levels and pipe diameters shown where not 100ø)
 - Private yard gully and drain
 - Private rodding eye (invert level shown)
 - Aco type linear drainage channel to garage
 - Filter trench
 - Private foul drain & 460ø inspection chamber (invert levels and pipe diameters shown where not 100ø)
 - 300mm² inspection chamber, max 0.6m deep and max 3 incoming connections
 - External wall where showing more than 150mm brickwork (eg. 4c = maximum of 4 courses plus 150mm)
 - External wall protected by means of tanking face brickwork to 150mm above retention level
 - Proposed level
 - Site boundary
 - Slab on edge, or gravel board beneath fencing (example shows max. height of 0.30m)
 - Tree planting within S38 area, refer to drawing 5205 ASP 1.5 for tree pit details
 - Water butts added to some Barnatt plots DWM JF 07.05.14
 - Taylor Wimpey plots amended, filter trench added DWM JF 07.02.14
 - C Trees show, parking Rd 6&10 amended DWM JF 15.01.14
 - B Bovis plots updated & foul to 27, 45-48 amended DWM JF 10.12.13
 - A Water butts added, favour updated DWM EM 02.12.13

PROJECT:	LONGFORD PARK BODICOTE BANBURY		
DRAWING TITLE:	PHASE 1 ENGINEERING LAYOUT SHEET 1 OF 6		
CLIENT:	BARRATT HOMES, BOVIS HOMES TAYLOR WIMPEY		
DRAWING NUMBER:	20488_02_150		
REVISION:	E	SHEET SIZE:	A1
		DATE:	04.10.13
DRAWN BY:	MJK	CHECKED BY:	EM
		SCALE:	1:200



THIS DRAWING IS BASED ON PLANNING LAYOUT
C1618 POD1 REV P. BOVIS HOMES DRAWING 0099-2-2018
AND 5205 ASP 1.5

Proposed haul road
CITC specification
Sales area (temporary feature)

Future Employment Use Development

Indicative location
of landmark building
(subject to separate
planning application)

Limit of Phase 1
Highway Works
Limit of S278
Highway Works

2 3 4 5 6 7 8

LAP

LEAP

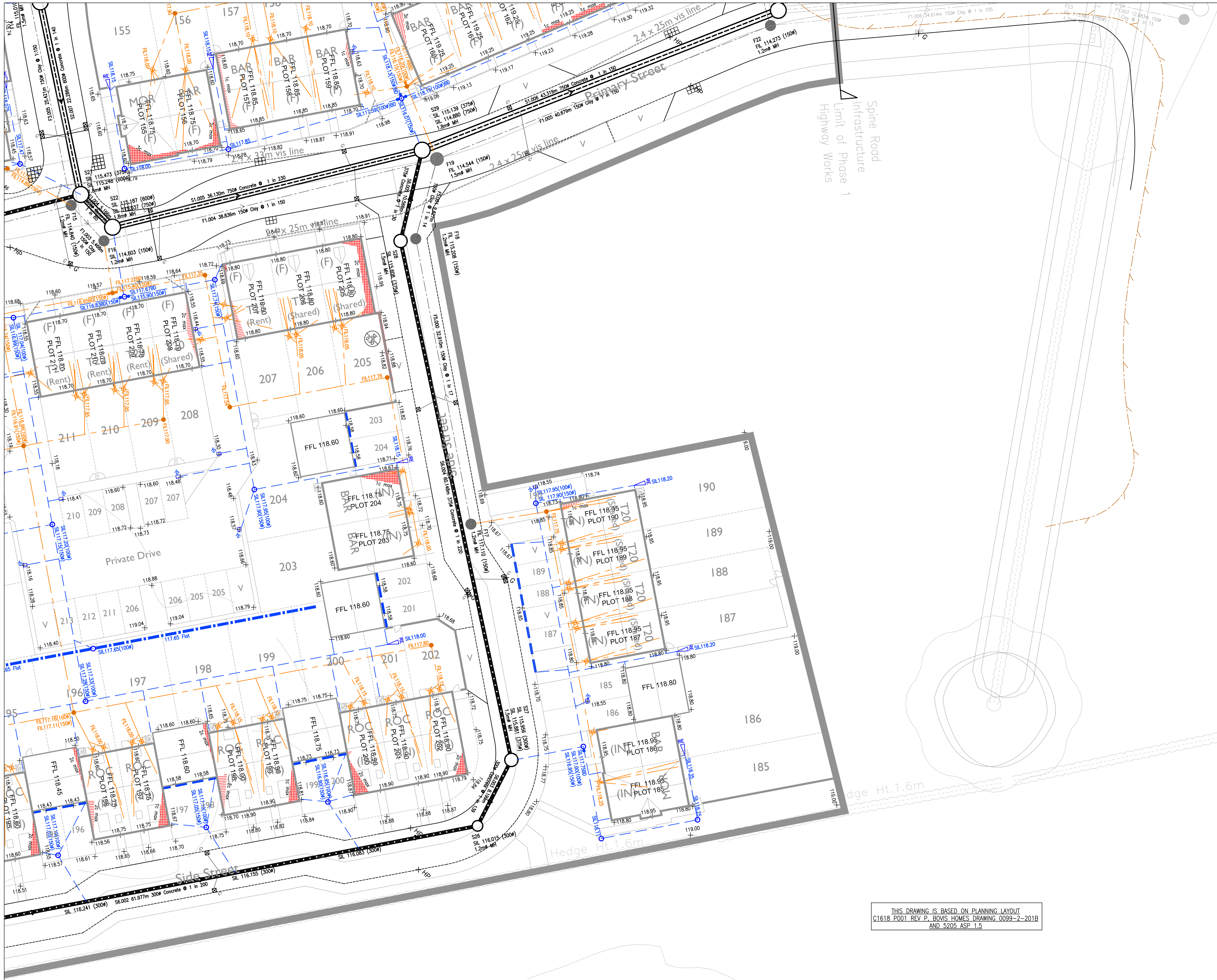

- ### General Notes
- Do not scale this drawing.
 - This drawing is to be read in conjunction with all other relevant Engineers, Architects and specialist design drawings and details.
 - All dimensions are in metres unless noted otherwise. All levels are in metres unless noted otherwise.
 - Any discrepancies noted on site are to be reported to the Engineer immediately.
 - All drainage works shall be carried out in accordance with Sewers for Adoption 8th edition.
 - The Contractor shall check all tie-ins for line and level with existing before commencing any works. The Engineer shall be notified immediately in writing, should any errors be found.
 - It is the responsibility of the Contractor to locate any service apparatus in the vicinity of the works. The client will accept no claims whatsoever in respect of any losses or damage caused in respect of such apparatus, however caused.
 - It is the responsibility of the Contractor to execute the works at all times in strict accordance with the requirements of the Health and Safety at Work Act 1974, and the C.D.M. Regulations 2007. The Contractor will be deemed to have allowed for full compliance, including full liaison with the CDM Co-ordinator, within his rates.
 - The Contractor is responsible for ensuring that all works are to the satisfaction of the Engineer, and shall be deemed to have included within his rates for any necessary testing.
 - The Contractor will be responsible for providing all necessary de-watering and trench support to execute the works in a satisfactory manner, and shall be deemed to have allowed for the same within his rates.
 - All buried concrete products and mortar shall be made using sulphate resisting cement.
 - All materials for use in the contract must be BS kitemarked.
 - All lifting eyes in P.C.C. products shall be pointed smooth after fixing.
 - For highway & drainage longitudinal sections refer to drg no. 20488_02_157 - 162.
 - All guttering assumed to be polypropylene polyflow or similar. Max roof area drained to be no more than 120m² for end pipes and 240m² for center pipes. Guttering to have 1:600 fall.

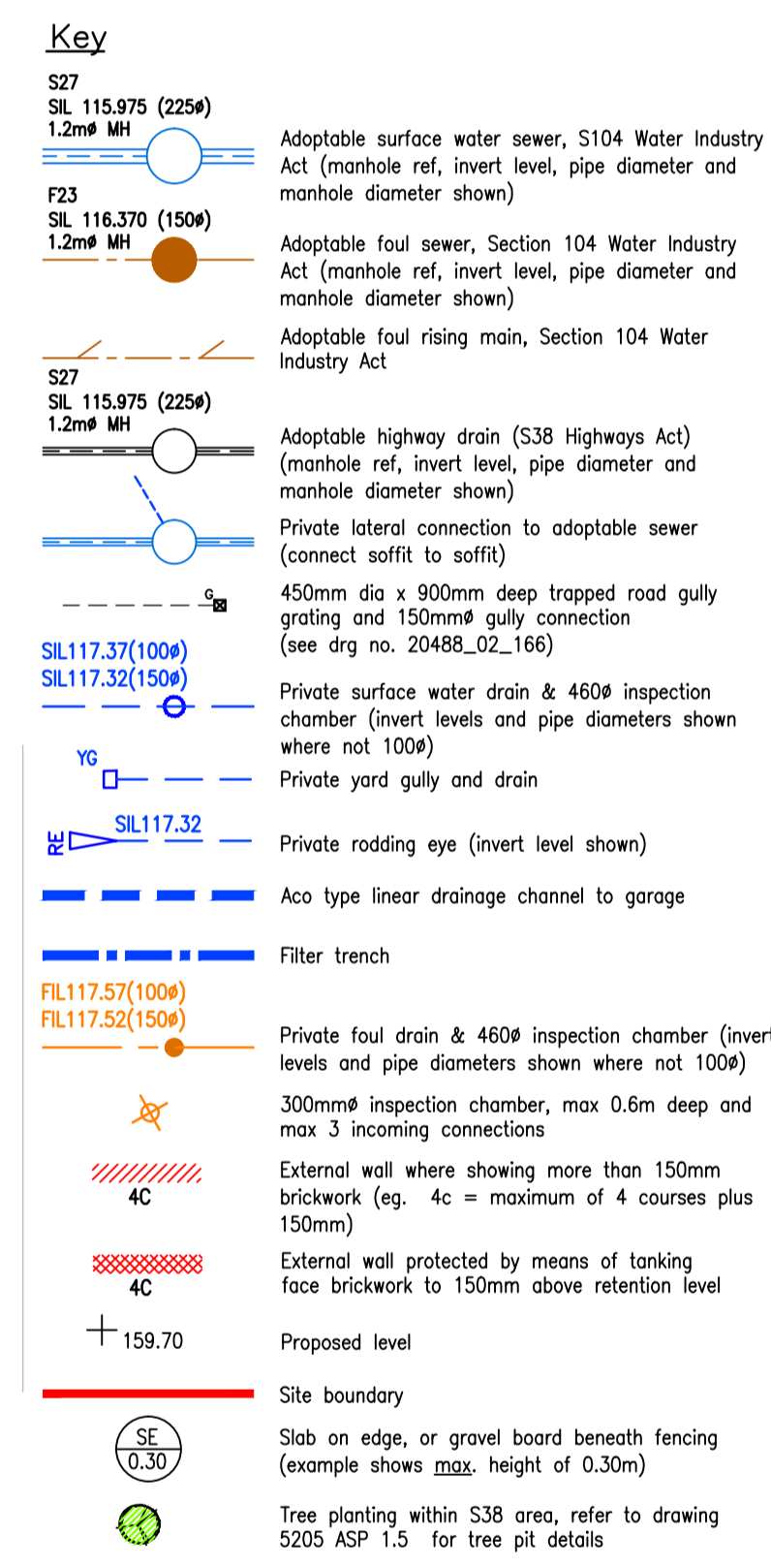

E	Water butts added to some Barnatt plots	DWM	JF	07.05.14
D	Taylor Wimpey plots amended, filter trench added	DWM	JF	21.02.14
C	Trees show, parking Rd 6&10 amended	DWM	JF	15.01.14
B	Bovis plots updated & foul to 27, 45-48 amended	DWM	JF	10.12.13
A	Water butts added, layout updated	DWM	EM	02.12.13

REV:	AMENDMENTS:	DRN:	CHK:	DATE:
PROJECT: LONGFORD PARK BODICOTE BANBURY				
DRAWING TITLE: PHASE 1 ENGINEERING LAYOUT SHEET 2 OF 6				
CLIENT: BARRATT HOMES, BOVIS HOMES TAYLOR WIMPEY				
DRAWING NUMBER: 20488_02_151				
REVISION:	E	SHEET SIZE:	A1	DATE:
				04.10.13
DRAWN BY:	MJK	CHECKED BY:	EM	SCALE:
				1:200

THIS DRAWING IS BASED ON PLANNING LAYOUT C1618_P001 REV P, BOVIS HOMES DRAWING 0099-2-201B AND 5205 ASP 1.5





- General Notes**
- Do not scale this drawing.
 - This drawing is to be read in conjunction with all other relevant Engineers, Architects and specialist design drawings and details.
 - All dimensions are in metres unless noted otherwise. All levels are in metres unless noted otherwise.
 - Any discrepancies noted on site are to be reported to the Engineer immediately.
 - All drainage works shall be carried out in accordance with Sewers for Adoption 8th edition.
 - The Contractor shall check all tie-ins for line and level with existing before commencing any works. The Engineer shall be notified immediately in writing, should any errors be found.
 - It is the responsibility of the Contractor to locate any service apparatus in the vicinity of the works. The client will accept no claims whatsoever in respect of any losses or damage caused in respect of such apparatus, however caused.
 - It is the responsibility of the Contractor to execute the works at all times in strict accordance with the requirements of the Health and Safety at Work Act 1974, and the C.D.M. Regulations 2007. The Contractor will be deemed to have allowed for full compliance, including full liaison with the CDM Co-ordinator, within his rates.
 - The Contractor is responsible for ensuring that all works are to the satisfaction of the Engineer, and shall be deemed to have included within his rates for any necessary testing.
 - The Contractor will be responsible for providing all necessary de-watering and trench support to execute the works in a satisfactory manner, and shall be deemed to have allowed for the same within his rates.
 - All buried concrete products and mortar shall be made using sulphate resisting cement.
 - All materials for use in the contract must be BS kitemarked.
 - All lifting eyes in P.C.C. products shall be pointed smooth after fixing.
 - For highway & drainage longitudinal sections refer to drg no. 20488_02_157 - 162.
 - All guttersing assumed to be polypropylene or similar. Max roof area drained to be no more than 120m² for end pipes and 240m² for center pipes. Guttersing to have 1:600 fall.

Key

- Adoptable surface water sewer, S104 Water Industry Act (manhole ref, invert level, pipe diameter and manhole diameter shown)
- Adoptable foul sewer, Section 104 Water Industry Act (manhole ref, invert level, pipe diameter and manhole diameter shown)
- Adoptable foul rising main, Section 104 Water Industry Act
- Adoptable highway drain (S38 Highways Act) (manhole ref, invert level, pipe diameter and manhole diameter shown)
- Private lateral connection to adoptable sewer (connect soffit to soffit)
- 450mm dia x 900mm deep trapped road gully grating and 150mm gully connection (see drg no. 20488_02_166)
- Private surface water drain & 460 inspection chamber (invert levels and pipe diameters shown where not 100%)
- Private yard gully and drain
- Private rodding eye (invert level shown)
- Aco type linear drainage channel to garage
- Private foul drain & 460 inspection chamber (invert levels and pipe diameters shown where not 100%)
- 300mm inspection chamber, max 0.6m deep and max 3 incoming connections
- External wall where showing more than 150mm brickwork (eg. 4c = maximum of 4 courses plus 150mm)
- External wall protected by means of tanking face brickwork to 150mm above retention level
- Proposed level
- Site boundary
- Slab on edge, or gravel board beneath fencing (example shows max height of 0.30m)
- Tree planting within S38 area, refer to drawing 5205 ASP 1.5 for tree pit details

E	Water butts added to some Barnatt plots	DWM	JF	07.05.14
D	Taylor Wimpey plots amended	DWM	JF	21.02.14
C	Trees show, parking Rd 6&10 amended	DWM	JF	21.01.14
B	Bovis plots updated & foul to 27, 45-48 amended	DWM	JF	10.12.13
A	Water butts added, layout updated	DWM	EM	02.12.13

PROJECT: LONGFORD PARK BODICOTE BANBURY			
DRAWING TITLE: PHASE 1 ENGINEERING LAYOUT SHEET 3 OF 6			
CLIENT: BARRATT HOMES, BOVIS HOMES TAYLOR WIMPEY			
DRAWING NUMBER: 20488_02_152			
REVISION: E	SHEET SIZE: A1	DATE: 04.10.13	
DRAWN BY: MJK	CHECKED BY: EM	SCALE: 1:200	

M-EC Wellington House Leicester Road
Ibstock Leicestershire LE27 6HP
T: 01530 264 753
P: 01530 268 116
ibstock@m-ec.co.uk
www.m-ec.co.uk

THIS DRAWING IS BASED ON PLANNING LAYOUT C1618 POOT REV P, BOVIS HOMES DRAWING 0099-2-2018 AND 5205 ASP 1.5

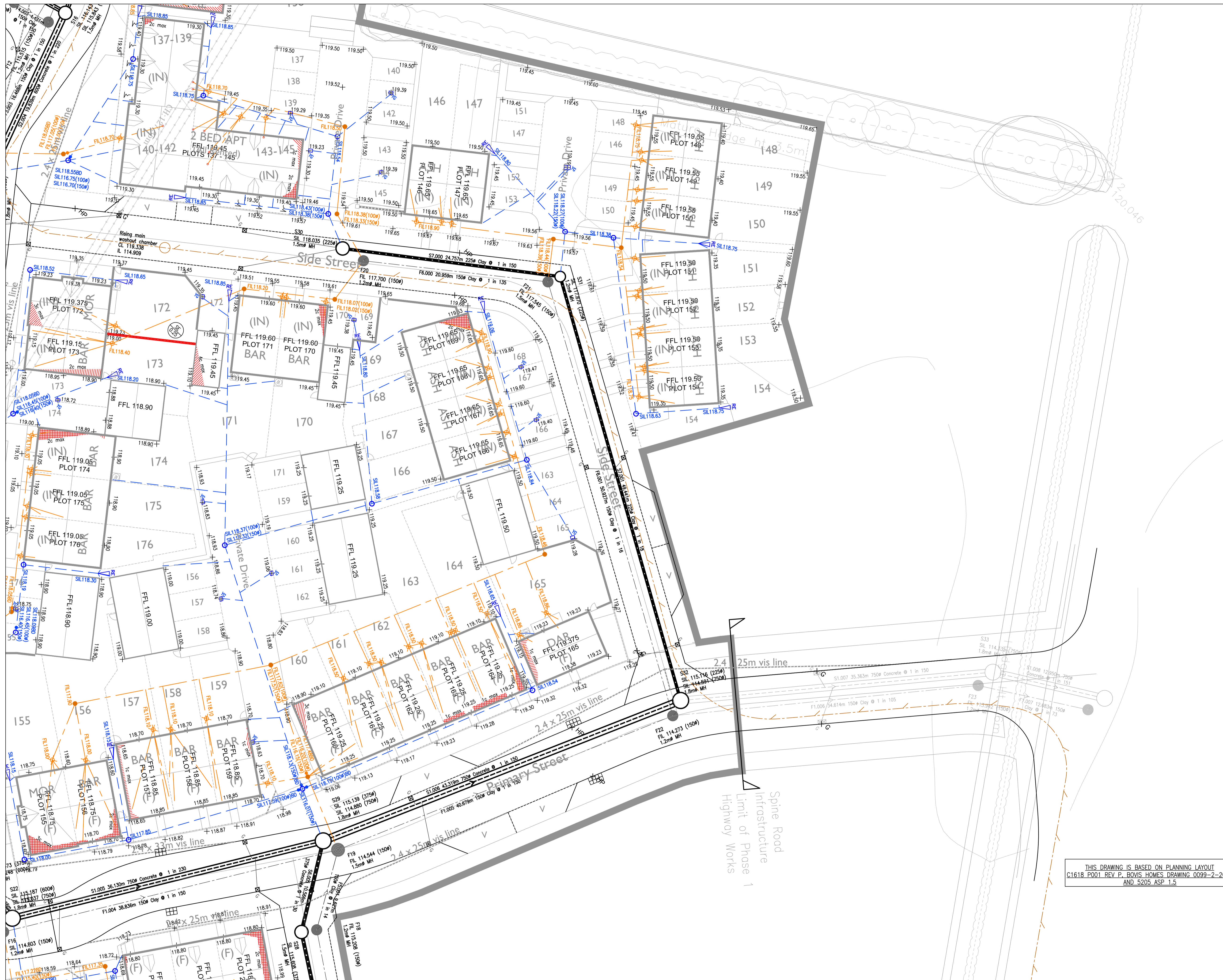

- General Notes**
- Do not scale this drawing.
 - This drawing is to be read in conjunction with all other relevant Engineers, Architects and specialist design drawings and details.
 - All dimensions are in metres unless noted otherwise. All levels are in metres unless noted otherwise.
 - Any discrepancies noted on site are to be reported to the Engineer immediately.
 - All drainage works shall be carried out in accordance with Sewers for Adoption 8th edition.
 - The Contractor shall check all tie-ins for line and level with existing before commencing any works. The Engineer shall be notified immediately in writing, should any errors be found.
 - It is the responsibility of the Contractor to locate any service apparatus in the vicinity of the works. The client will accept no claims whatsoever in respect of any losses or damage caused in respect of such apparatus, however caused.
 - It is the responsibility of the Contractor to execute the works at all times in strict accordance with the requirements of the Health and Safety Act of Work Act 1974, and the C.D.M. Regulations 2007. The Contractor will be deemed to have allowed for full compliance, including full liaison with the CDM Co-ordinator, within his rates.
 - The Contractor is responsible for ensuring that all works are to the satisfaction of the Engineer, and shall be deemed to have included within his rates for any necessary testing.
 - The Contractor will be responsible for providing all necessary de-watering and trench support to execute the works in a satisfactory manner, and shall be deemed to have allowed for the same within his rates.
 - All buried concrete products and mortar shall be made using sulphate resisting cement.
 - All materials for use in the contract must be BS kitemarked.
 - All lifting eyes in P.C.C. products shall be pointed smooth after fixing.
 - For highway & drainage longitudinal sections refer to drg no. 20488_02_157 - 162.
 - All guttering assumed to be polypropylene polyflow or similar. Max roof area drained to be no more than 120m² for end pipes and 240m² for center pipes. Guttering to have 1:600 fall.

Key

S27 SIL 115.975 (225#) 1.2m ² MH	Adoptable surface water sewer, S104 Water Industry Act (manhole ref, invert level, pipe diameter and manhole diameter shown)
F23 SIL 116.370 (150#) 1.2m ² MH	Adoptable foul sewer, Section 104 Water Industry Act (manhole ref, invert level, pipe diameter and manhole diameter shown)
S27 SIL 115.975 (225#) 1.2m ² MH	Adoptable foul rising main, Section 104 Water Industry Act
S27 SIL 115.975 (225#) 1.2m ² MH	Adoptable highway drain (S38 Highways Act) (manhole ref, invert level, pipe diameter and manhole diameter shown)
Private lateral connection to adoptable sewer (connect soffit to soffit)	
450mm dia x 900mm deep trapped road gully grating and 150mm ² gully connection (see drg no. 20488_02_166)	
SIL 117.37 (100#) SIL 117.32 (150#)	Private surface water drain & 460# inspection chamber (invert levels and pipe diameters shown where not 100#)
YG	Private yard gully and drain
SIL 117.32	Private rodding eye (invert level shown)
Ac type linear drainage channel to garage	
Private foul drain & 460# inspection chamber (invert levels and pipe diameters shown where not 100#)	
300mm ² inspection chamber, max 0.6m deep and max 3 incoming connections	
4C	External wall where showing more than 150mm brickwork (eg. 4c = maximum of 4 courses plus 150mm)
4C	External wall protected by means of tanking face brickwork to 150mm above retention level
+ 159.70	Proposed level
SE 0.30	Site boundary
Tree planting within S38 area, refer to drawing 5205 ASP 1.5 for tree pit details	

E	Water butts added to some Barnatt plots	DWM	JF	07.05.14
D	Taylor Wimpey plots amended	DWM	JF	21.02.14
C	Trees show, parking Rd 6&10 amended	DWM	JF	15.01.14
B	Bovis plots updated & foul to 27, 45-48 amended	DWM	JF	10.12.13
A	Water butts added, layout updated	DWM	EM	02.12.13

REV:	AMENDMENTS:	DRN:	CHK:	DATE:
PROJECT: LONGFORD PARK BODICOTE BANBURY				
DRAWING TITLE: PHASE 1 ENGINEERING LAYOUT SHEET 4 OF 6				
CLIENT: BARRATT HOMES, BOVIS HOMES TAYLOR WIMPEY				
DRAWING NUMBER: 20488_02_153				
REVISION:	E	SHEET SIZE:	A1	DATE:
				04.10.13
DRAWN BY:	MJK	CHECKED BY:	EM	SCALE:
				1:200

THIS DRAWING IS BASED ON PLANNING LAYOUT C1618_P001_REV_P_BOVIS HOMES DRAWING 0099-2-2018 AND 5205 ASP 1.5





- General Notes**
1. Do not scale this drawing.
 2. This drawing is to be read in conjunction with all other relevant Engineers, Architects and specialist design drawings and details.
 3. All dimensions are in metres unless noted otherwise. All levels are in metres unless noted otherwise.
 4. Any discrepancies noted on site are to be reported to the Engineer immediately.
 5. All drainage works shall be carried out in accordance with Sewers for Adoption 8th Edition.
 6. The Contractor shall check all tie-ins for line and level with existing before commencing any works. The Engineer shall be notified immediately in writing, should any errors be found.
 7. It is the responsibility of the Contractor to locate any service apparatus in the vicinity of the works. The client will accept no claims whatsoever in respect of any losses or damage caused in respect of such apparatus, however caused.
 8. It is the responsibility of the Contractor to execute the works at all times in strict accordance with the requirements of the Health and Safety at Work Act 1974, and the C.D.M. Regulations 2007. The Contractor will be deemed to have allowed for full compliance, including full liaison with the CDM Co-ordinator, within his rates.
 9. The Contractor is responsible for ensuring that all works are to the satisfaction of the Engineer, and shall be deemed to have included within his rates for any necessary testing.
 10. The Contractor will be responsible for providing all necessary de-watering and trench support to execute the works in a satisfactory manner, and shall be deemed to have allowed for the same within his rates.
 11. All buried concrete products and mortar shall be made using sulphate resisting cement.
 12. All materials for use in the contract must be BS kitemarked.
 13. All lifting eyes in P.C.C. products shall be pointed smooth after fixing.
 14. For highway & drainage longitudinal sections refer to drg no. 20488_02_157 - 162.
 15. All guttering assumed to be polypropylene or similar. Max roof area drained to be no more than 120m² for end pipes and 240m² for center pipes. Guttering to have 1:600 fall.

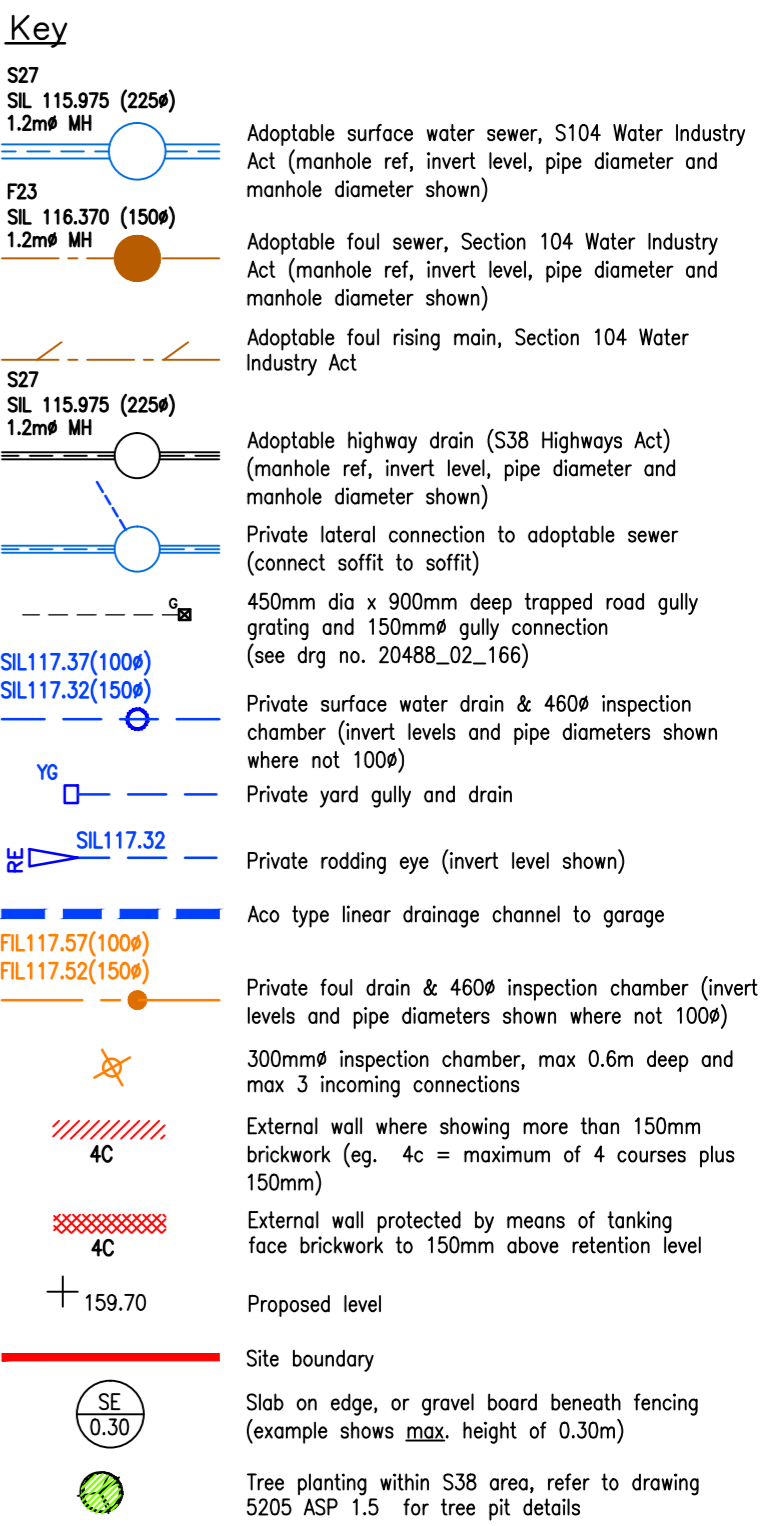

THIS DRAWING IS BASED ON PLANNING LAYOUT C1618 P001 REV P. BOVIS HOMES DRAWING 0099-2-2018 AND 5205 ASP 1.5

PROJECT:		LONGFORD PARK BODICOTE BANBURY	
DRAWING TITLE:		PHASE 1 ENGINEERING LAYOUT SHEET 5 OF 6	
CLIENT:		BARRATT HOMES, BOVIS HOMES, TAYLOR WIMPEY	
DRAWING NUMBER:		20488_02_154	
REVISION:	SHEET SIZE:	DATE:	
E	A1	04.10.13	
DRAWN BY:	CHECKED BY:	SCALE:	
MJK	EM	1:200	

M-EC

Wallington House Leicester Road
Ibstock Leicestershire LE267 6HP
T: 01530 264 753
F: 01530 588 116
ibstock@m-ec.co.uk
www.m-ec.co.uk



- ### General Notes
- Do not scale this drawing.
 - This drawing is to be read in conjunction with all other relevant Engineers, Architects and specialist design drawings and details.
 - All dimensions are in metres unless noted otherwise. All levels are in metres unless noted otherwise.
 - Any discrepancies noted on site are to be reported to the Engineer immediately.
 - All drainage works shall be carried out in accordance with Sewers for Adoption 6th edition.
 - The Contractor shall check all tie-ins for line and level with existing before commencing any works. The Engineer shall be notified immediately in writing, should any errors be found.
 - It is the responsibility of the Contractor to locate any service apparatus in the vicinity of the works. The client will accept no claims whatsoever in respect of any losses or damage caused in respect of such apparatus, however caused.
 - It is the responsibility of the Contractor to execute the works at all times in strict accordance with the requirements of the Health and Safety at Work Act 1974, and the C.D.M. Regulations 2007. The Contractor will be deemed to have allowed for full compliance, including full liaison with the CDM Co-ordinator, within his roles.
 - The Contractor is responsible for ensuring that all works are to the satisfaction of the Engineer, and shall be deemed to have included within his rates for any necessary testing.
 - The Contractor will be responsible for providing all necessary de-watering and trench support to execute the works in a satisfactory manner, and shall be deemed to have allowed for the same within his rates.
 - All buried concrete products and mortar shall be made using sulphate resisting cement.
 - All materials for use in the contract must be BS kitemarked.
 - All lifting eyes in P.C.C. products shall be pointed smooth after fixing.
 - For highway & drainage longitudinal sections refer to drg no. 20488_02_157 - 162.
 - All guttering assumed to be polypropylene flow or similar. Max roof area drained to be no more than 120m² for end pipes and 240m² for center pipes. Guttering to have 1:600 fall.

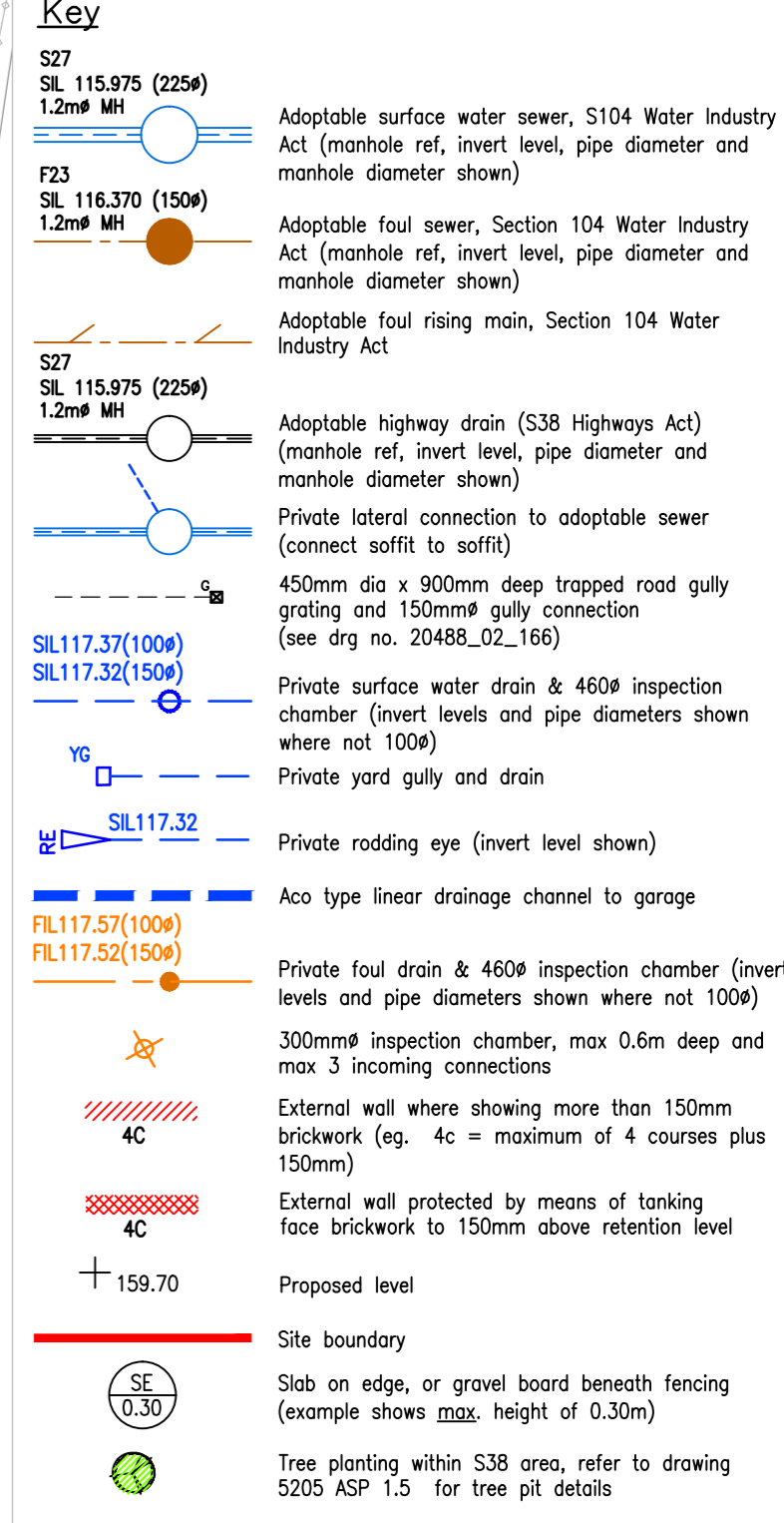

THIS DRAWING IS BASED ON PLANNING LAYOUT C1618 P001 REV P. BOVIS HOMES DRAWING 0099-2-2018 AND 5205 ASP 1.5

PROJECT: LONGFORD PARK BODICOTE BANBURY			
DRAWING TITLE: PHASE 1 ENGINEERING LAYOUT SHEET 6 OF 6			
CLIENT: BARRATT HOMES, BOVIS HOMES, TAYLOR WIMPEY			
DRAWING NUMBER: 20488_02_155			
REVISION:	SHEET SIZE:	DATE:	
E	A1	04.10.13	
DRAWN BY:	CHECKED BY:	SCALE:	
MJK	EM	1:200	

M-EC

Wallington House Leicester Road
Ibstock Leicestershire LE127 6HP
T: 01530 264753
P: 01530 588116
ibstock@m-ec.co.uk
www.m-ec.co.uk

REV:	AMENDMENTS:	DRN:	CHK:	DATE:
E	Water butts added to some Barratt plots	DWM	JF	07.05.14
D	Taylor Wimpey plots amended	DWM	JF	21.02.14
C	Trees show, parking Rd & 10 amended	DWM	JF	15.01.14
B	Bovis plots updated & foul to 27, 45-48 amended	DWM	JF	10.12.13
A	Water butts added, layout updated	DWM	EM	02.12.13