

**INSET BOX 1**

Scale = 1:500

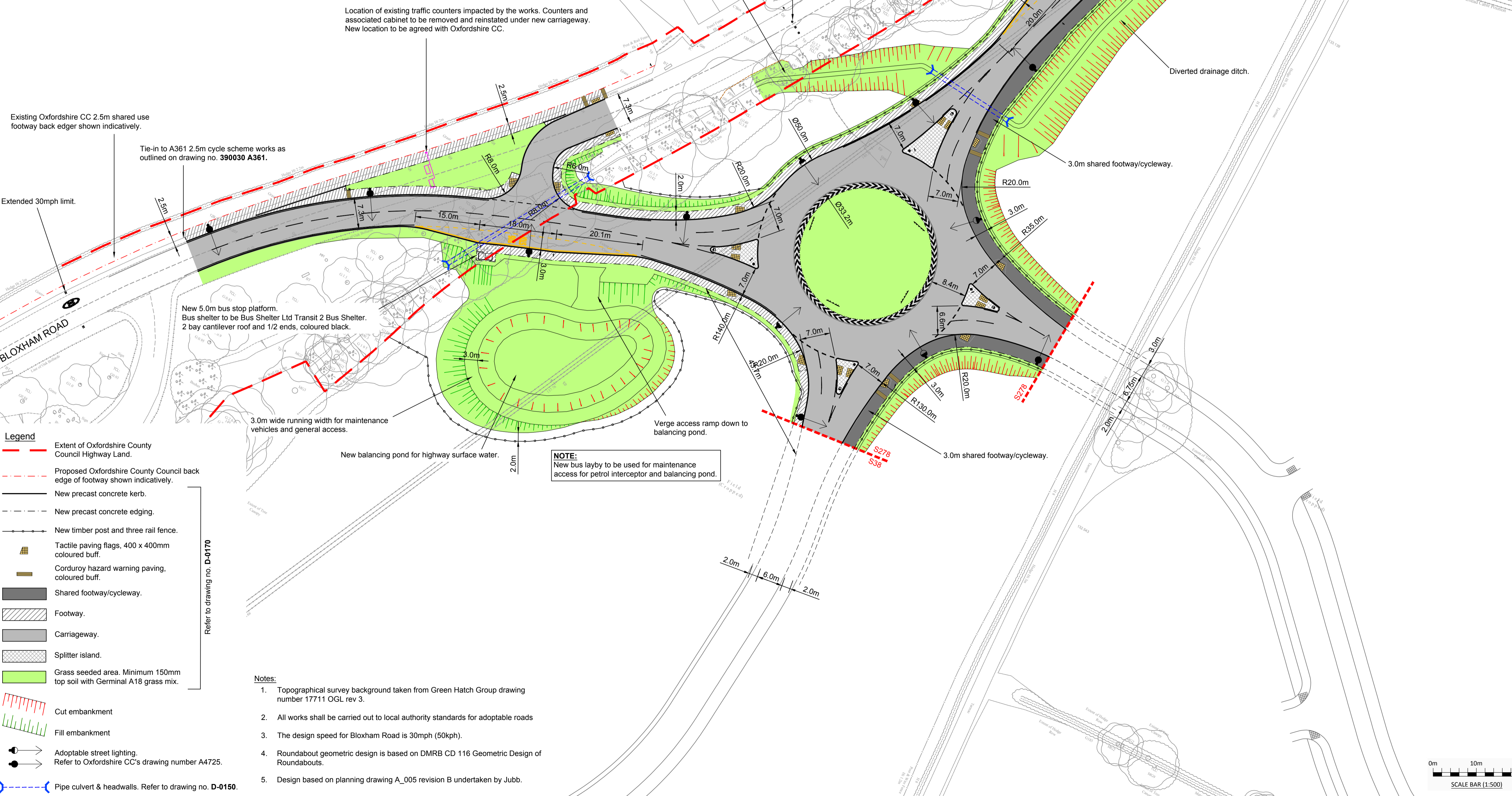

- Legend**
- Extent of Oxfordshire County Council Highway Land.
  - Proposed Oxfordshire County Council back edge of footway shown indicatively.
  - New precast concrete kerb.
  - New precast concrete edging.
  - New timber post and three rail fence.
  - Tactile paving flags, 400 x 400mm coloured buff.
  - Corduroy hazard warning paving, coloured buff.
  - Shared footway/cycleway.
  - Footway.
  - Carriageway.
  - Splitter island.
  - Grass seeded area. Minimum 150mm top soil with Germinol A18 grass mix.
  - Cut embankment
  - Fill embankment
  - Adoptable street lighting. Refer to Oxfordshire CC's drawing number A4725.
  - Pipe culvert & headwalls. Refer to drawing no. D-0150.

- Notes:**
1. Topographical survey background taken from Green Hatch Group drawing number 17711 OGL rev 3.
  2. All works shall be carried out to local authority standards for adoptable roads.
  3. The design speed for Bloxham Road is 30mph (50kph).
  4. Roundabout geometric design is based on DMRB CD 116 Geometric Design of Roundabouts.
  5. Design based on planning drawing A\_005 revision B undertaken by Jubb.

Rev	Date	Description	By	Ckd
P8	30/06/2020	Following OCC comments, corduroy paving added.	JD	RJP
P7	01/05/2020	Following OCC comments, DMRB reference amended. Carriageway realigned to provide 4m cycle clearances adj. island refuge. Footway link removed adjacent priority junction access.	JD	RJP
P6	15/01/2020	South-East footway widened to 3.0m. Western ditch alignment amended. Pond access narrowed and specified as grass verge. Northern emergency access extension of carriageway amended.	FR	JD
P5	28/10/2019	Approx location of OCC traffic counter loops added, southern ditch realigned, back edge of OCC footway assumed. Bloxham Road cyclepath arrangement amended.	JD	RJP
P4	08/10/2019	OCC widened footway shown indicatively and downgraded section of Bloxham Road amended. S278/S38 boundary limit shown. OCC street lighting added and fence line positions adjusted.	JD	RJP
P3	03/09/2018	Bus stops relocated to back of footway, footway leading to northern bus stop extended to meet old A361. Old A361 reduced to 3.0m width. Pedestrian crossing refuge added on northern arm.	JD	NH
P2	12/05/2017	Added balancing pond.	NH	RP
P1	22/02/2017	First issue for street lighting quote.	NH	RP

**Hydrock**

Over Court Barns, Over Lane, Almondsbury, Bristol, BS32 4DF.  
 TEL: 01454 619 533 FAX: 01454 614 125 or visit [www.hydrock.com](http://www.hydrock.com)

This drawing is the copyright of Hydrock Ltd. No liability will be accepted for any amendments to this drawing either printed or digital by parties other than Hydrock.

**GALLAGHER ESTATES**

Project: **WYKHAM PARK FARM BANBURY**

Project Number: **C-04841-C**

Drawing Title: **S278 WORKS ROUNDABOUT GENERAL ARRANGEMENT**

Drawn: NH	Checked: RJP	Scale @ A1: 1:500	Drawn Date: 30/01/2017	First Issue: 22/02/2017
-----------	--------------	-------------------	------------------------	-------------------------

Status: **D2** Purpose of Issue: **TENDER**

Drawing No. **WPF-HYD-XX-XX-DR-D-0100** Revision **P8**

