

WENDLEBURY ROAD

LANDSCAPING SPECIFICATION AS WEDDLES DWG. No. DLBI 01B;

KEY:

- Existing Tree Retained
Existing Hedge Retained
Vegetation to be removed
Extra Heavy Standard Trees
Ornamental Shrub
Ornamental Shrub and Perennials
Native Shrub
Hedging
Plant Mixes
Meadow
Existing Levels
Proposed Levels
Distance from base of tree to nearest edge of excavation

OUTLINE SPECIFICATION:

GENERAL: All works to be in accordance with all relevant British Standards and the Landscape Consultant's planting plans and specification (to be issued) and in compliance with the National Landscape Specification (NLS) 1996, latest revision.

SETTING OUT: All dimensions and levels should be checked and adjusted on site. Contractor responsible for care around all services. Do not scale from this drawing.

SITE PREPARATION: Building rubble in excess of 50mm dimension to be removed, compacted ripped 150mm deep or broken out by JCB back-actor leaving surface rough. Ensure free drainage.

TOPSOIL: Multipurpose topsoil BS:3882 medium loam, not more than slightly stony, pH 5.7-7.5. Depth 450mm all planting areas. 150mm to all other areas. Provide Declaration of Analysis of topsoil to Employer's Agent.

TOPSOIL - MEADOW: Specific purpose topsoil to BS:3882, low fertility, 150mm depth to be used. Supplier to provide certification of testing.

TREE PIT: Extra Heavy Standard 1200mm x 750mm depth.

PREPARATORY HERBICIDE: Weed allowed to grow and treated with up to three applications of weed killer prior to cultivation or planting during the fallow period.

GRASSING: Grassing between April-October. Cultivate to prepare seed bed. Finished seed bed levels 25mm above pavings and kerb edges. Stones pick to 25mm. Pre-seeding fertiliser 50g/m2. Grass mix chosen for low maintenance requirements.

PLANTS: Plant material in accordance with the HTA's National Plant Specification 1997. All plants container grown, well formed and free from disease. Plant handling to CPSE Plant Handling Code.

Planting: Plant November to March. Planting areas cultivated 150 mm deep and stone picked of material greater than 50mm. Plant material pit planted 300 x 300 x 200 minimum. Approved planting compost incorporated into the soil during planting.

Backfill mix: Enmag P4 Compost. Shrubs 35g 5g 10 litres. Extra Heavy Standard 75g 50g 75 litres.

TREE STAKING: Extra Heavy Standard -Short Double Staking. Preserved softwood 100mm min diameter. Driven vertically 450mm into base of pit on either side.

MULCH: Total cover coarse bark mulch to shrub areas, Melcourt Bark Nuggets 75mm deep.

GEOTEXTILE: Geotextile beneath mulch within Spa and Terrace garden, pinned down and planting through cross cuts.

AFTERCARE: 24 months aftercare by planting contractor. Including grass and meadow cutting, weed, pest and disease control, pruning and watering. Weed control by residual herbicide or hand weeding as necessary to achieve a weed free condition.

EFFECTS LIABILITY: Twenty-four months on plant material and grass. Replacements in November in year of loss.

ONGOING MAINTENANCE: Continue to maintain for five years from completion of planting by hand weeding and spot treatment of weed killer to any weed in planted areas until plants close canopy. Replace failures for 5 years.

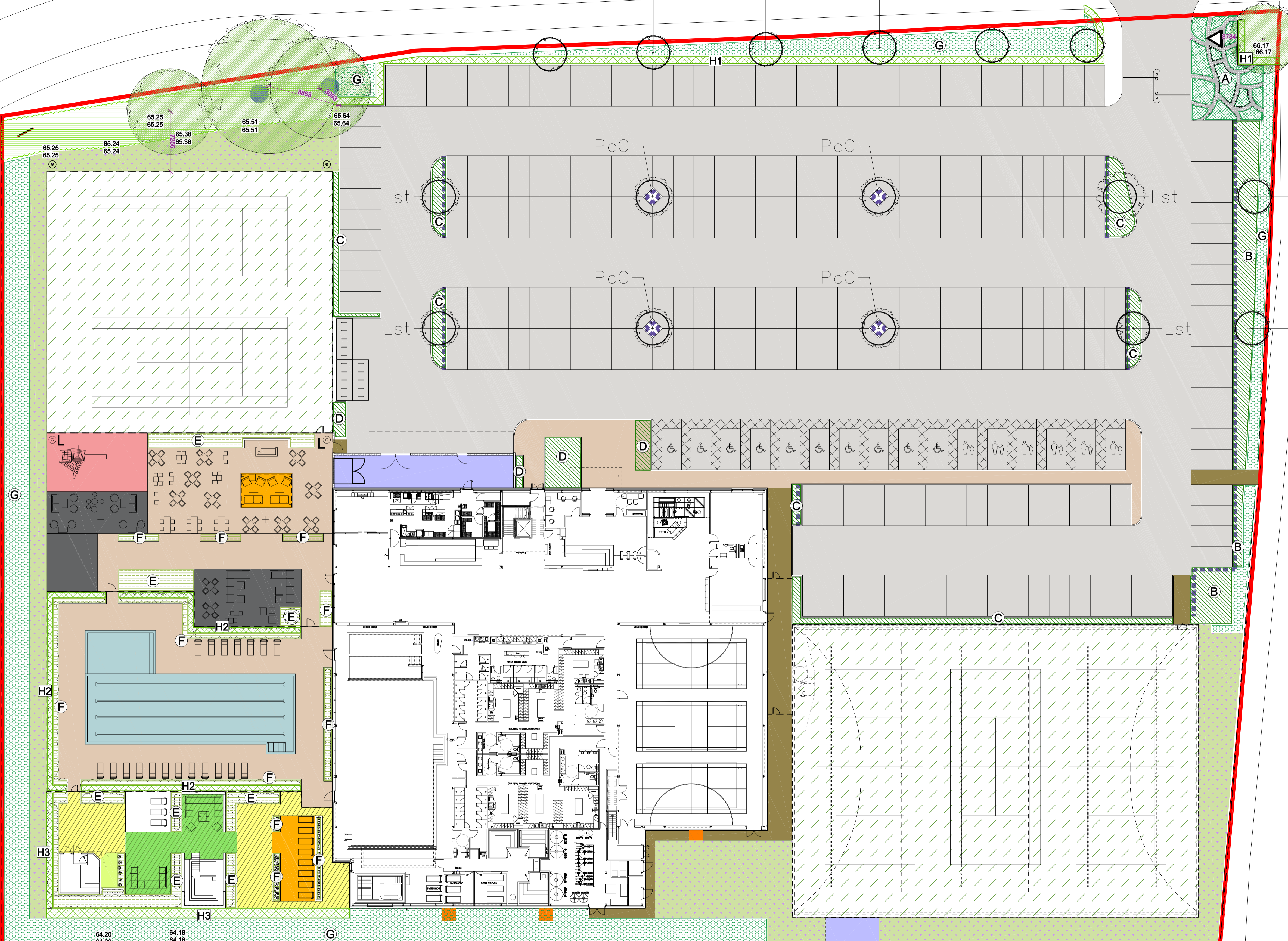

- RED LINE SITE AREA 4.1 acres
KEY: GENERAL VEHICULAR, PLANT DELIVERY AREA, COURTS - Tennis, PEDESTRIAN ZONES, PAVING SLABS, DECKING, KIDS PLAY, LIGHTING

REVISION P06 BY: CM CHECKED: DATE: 08/04/2021
REVISION P05 BY: ARB CHECKED: DATE: 23/02/2021
REVISION P04 BY: ARB CHECKED: DATE: 26/03/2020
REVISION P03 BY: JAH CHECKED: CM DATE: 30/01/2020
REVISION P02 BY: JAH CHECKED: CM DATE: 22/01/2020
REVISION P01 BY: JAH CHECKED: ARB DATE: 22/07/2019
REVISION: BY: AJ CHECKED: CM DATE: 07/06/2019

PLANNING

PLT DATE:



CLIENT:

CATALYST BICESTER

PROPOSED SURFACING & LANDSCAPE PLAN

SCALE: 1:250 @ A1 DATE: MAY 2019

TH

Hadfield Cawkwell Davidson

Broomgrove Lodge, 13 Broomgrove Rd, Sheffield, S10 2LZ T 0114 266 8181 www.hcd.co.uk

Architecture | Engineering | Interior Design | Masterplanning | Urban Design
2018-260 | A-PL-95-100 | P06

Table with 4 columns: Name, Height, Root Zone, Specification. Lists various plant species and their details.

Table with 4 columns: Name, Height, Root Zone, Specification. Lists various plant species and their details.

Table with 4 columns: Name, Height, Root Zone, Specification. Lists various plant species and their details.

Table with 4 columns: Name, Height, Root Zone, Specification. Lists various plant species and their details.

Table with 4 columns: Name, Height, Root Zone, Specification. Lists various plant species and their details.

Table with 4 columns: Name, Height, Root Zone, Specification. Lists various plant species and their details.

Table with 4 columns: Name, Height, Root Zone, Specification. Lists various plant species and their details.

Table with 4 columns: Name, Height, Root Zone, Specification. Lists various plant species and their details.

Table with 4 columns: Name, Height, Root Zone, Specification. Lists various plant species and their details.

Table with 4 columns: Name, Height, Root Zone, Specification. Lists various plant species and their details.

IMPLEMENTATION PROGRAMME: First planting season following construction.

LANDSCAPE MANAGEMENT: Site Owner to implement 5 year management plan to cover the following regular, seasonal and annual maintenance operations.

Notes: Water monthly April to September in periods of drought. Inspect trees annually in winter. Undertake formative pruning of young trees to encourage good growth and shape.

Statute: Wildlife and Countryside Act 1981. Section 199. It is an offence to cut down or pull up a tree without the consent of the Secretary of State.