

Listed Building Application 20/02076/LB - Condition clearance submission

Condition 5 – drainage

Attached please find a sketch diagram of the changes proposed

1. There is no planned external drainage work or alteration to the exterior of the property.
2. The toilet will be moved approx. 70 cm from its existing position in the WC area. It will be connected inside the building to the existing foul drain.
3. New appliances will be located close to their existing positions. Piping for sink, dishwasher, washing machine and dryer will be connected internally to the existing waste water pipe. There is no net increase in the volume of waste water.
4. Ventilation from the WC will be unchanged, via the existing Ventaxia into the chimney stack.

These are minor alterations to the current internal pipe layout, and have no impact on the historic fabric of the building.

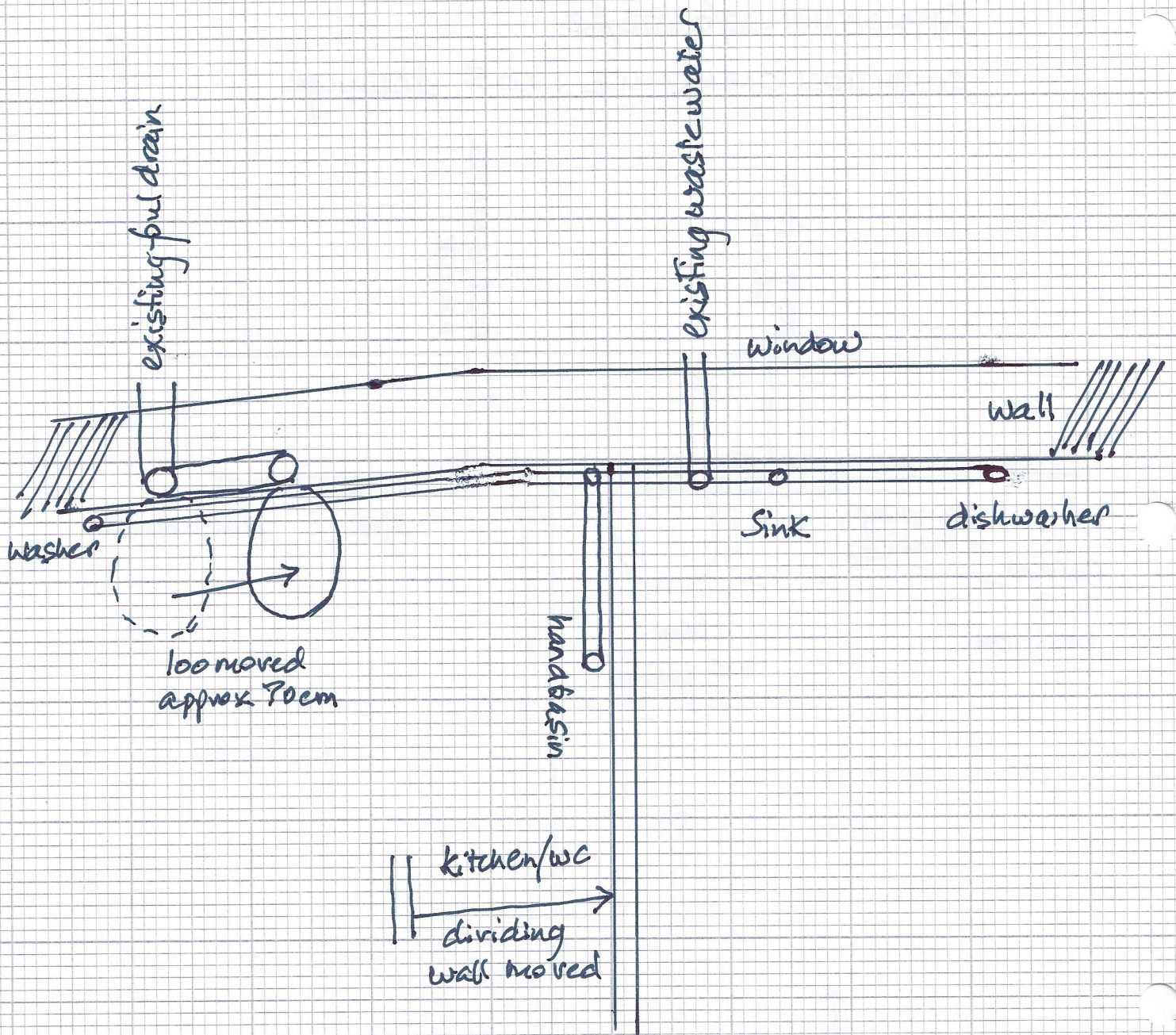

20/02076/LB Stickley's House OX15 5RT
 Condition 5 clearance submission
 new plumbing layout