

All gas mains, services and ducts that shall contain gas pipes, must be overlaid with gas identifiable marker tape 150mm above the apparatus. Gas mains and services should have a minimum of 250mm clearance from other utilities.

PROPOSED GAS KEY:

- PROPOSED GAS EASEMENT: [Symbol]
- PROPOSED MP GAS MAIN: [Symbol]
- PROPOSED LP GAS MAIN: [Symbol]
- PROPOSED IP GAS MAIN: [Symbol]
- EXISTING MP GAS MAIN: [Symbol]
- EXISTING LP GAS MAIN: [Symbol]
- EXISTING IP GAS MAIN: [Symbol]
- PROPOSED GAS MAIN IN DUCT: [Symbol]
- REDUCER: [Symbol]
- VALVE: [Symbol]
- CAPPED END: [Symbol]
- TRENCH CROSS SECTION MARKER: [Symbol]

90mmPE(LP) 63mmPE(LP)

POSITION NODE: (11)

GAS DUCTS

GAS PIPE OUTSIDE Ø	DUCT INSIDE Ø
20mm, 25mm & 32mm	50mm
63mm	100mm
90mm	150mm
125mm & 180mm	225mm
250mm	350mm
315mm	450mm

GAS PIPE DETAIL

MATERIALS	DESCRIPTION
DI	Ductile Iron Main
CI	Cast Iron Main
ST	Steel main or service
MDPE (17.6)	Medium Density Polyethylene (SDR Rating) main or service
HDPE (11)	High Density Polyethylene (SDR Rating) main or service
SIZE	DESCRIPTION
12"	Metallic main or service - Imperial (nominal bore)
150mm	Metallic main or service - Metric (nominal bore)
3"	Polyethylene main or service - Imperial (nominal bore)
90	Polyethylene main or service - Metric (outside Ø)

PRESSURE

DESCRIPTION
LP Low Pressure - up to 75 millibar gauge
MP Medium Pressure - between 75 millibar and 2 bar gauge
IP Intermediate Pressure - between 2 bar and 7 bar gauge
HP High Pressure - above 7 bar gauge

PE

Type of Main	Diameter of Main (mm)	Minimum Building Proximity Distance (m)
PE Non-Inserted	Up to 125	>75 mbar >2 bar >5.5 bar >7 bar
	128-355	1 2 4 6
	356-500	1 2 4 8
	501-1000	1 5 13 15
PE Inserted	Up to 125	0.25 1 2 3
	128-355	0.5 1 2 3
	356-500	0.5 1 2 3
	501-1000	0.5 1 3 3

STEEL

Type of Main	Wall Thickness of Main (mm)	Minimum Building Proximity Distance (m)
Steel	Up to 125	>75 mbar >2 bar >7 bar >7 bar >7 bar >7 bar
	128-355	0.25 1 3 13
	356-500	0.25 1 3 6
	501-1000	0.25 1 3 3

PIPE PRINCIPLE QUANTITIES

250mm PE 80 SDR 17.6	123m
----------------------	------

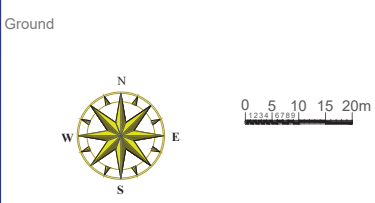
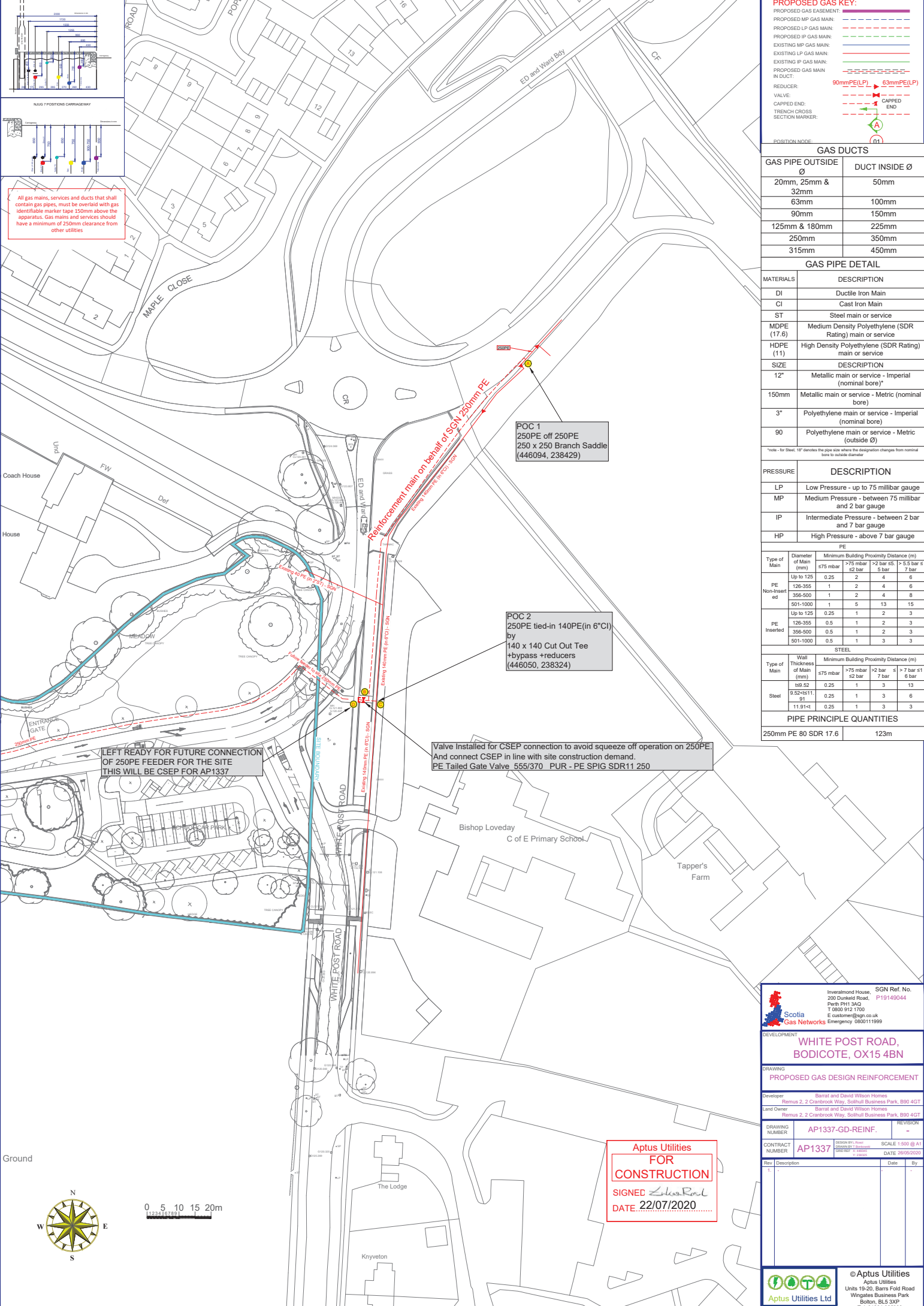

Aptus Utilities FOR CONSTRUCTION
 SIGNED *[Signature]*
 DATE 22/07/2020

Scotia Gas Networks Inverathol House, 200 Dorkwell Road, Perth PH1 3AD, T 0800 912 1700, E customer@sgn.co.uk, Emergency 0800111999

WHITE POST ROAD, BODICOTE, OX15 4BN

PROPOSED GAS DESIGN REINFORCEMENT

Developer: Barrat and David Wilson Homes
 Remus 2, 2 Cranbrook Way, Solihull Business Park, B90 4GT

Land Owner: Barrat and David Wilson Homes
 Remus 2, 2 Cranbrook Way, Solihull Business Park, B90 4GT

DRAWING NUMBER: AP1337-GD-REINF. REVISION: -

CONTRACT NUMBER: AP1337 SCALE: 1:500 @ A1 DATE: 20/07/2020

Rev	Description	Date	By

© Aptus Utilities
 Units 19-20, Batts Fold Road
 Wingates Business Park
 Bolton, BL5 3XP
 Tel: 01204 325000