

Location Plan 1:1250

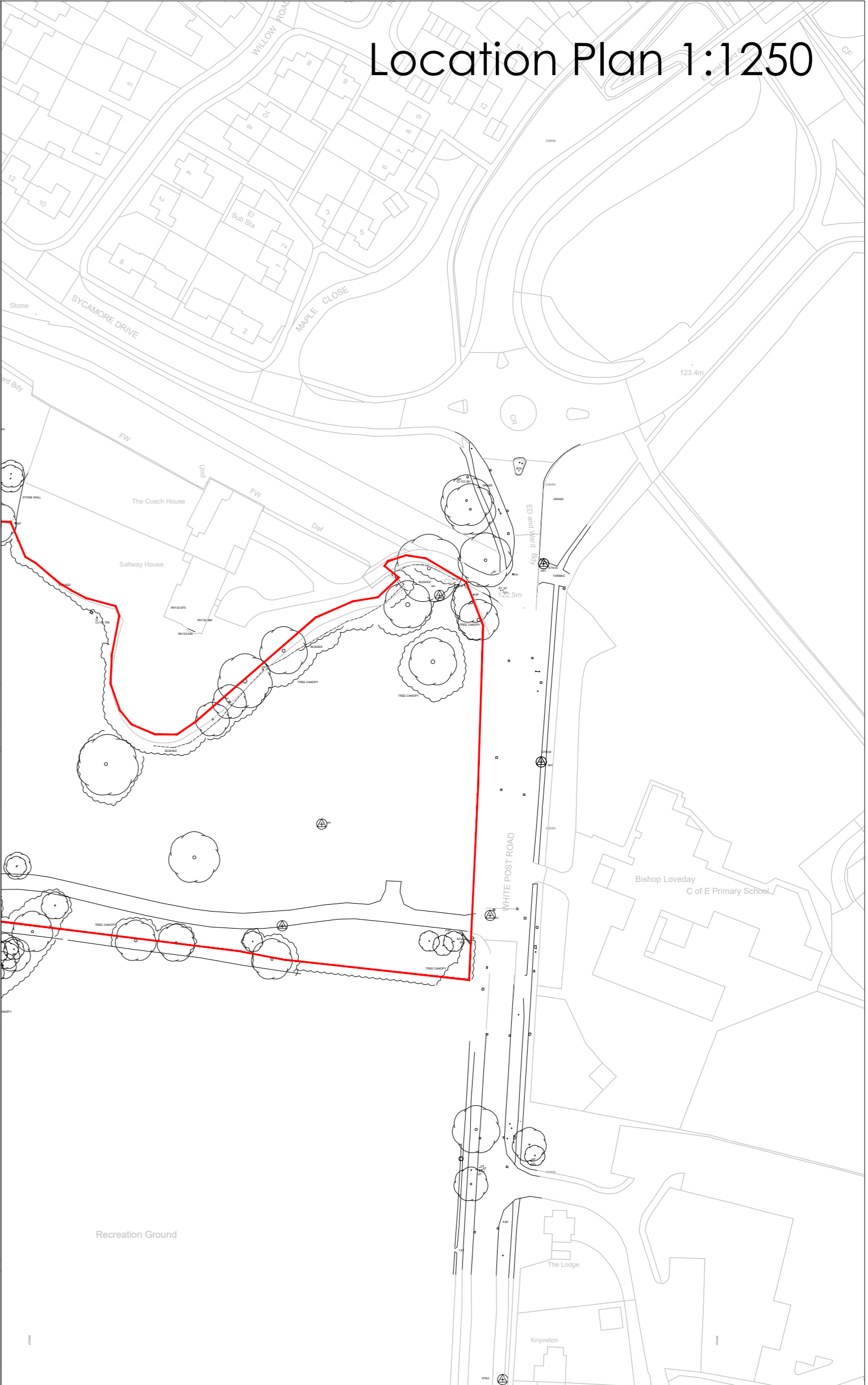
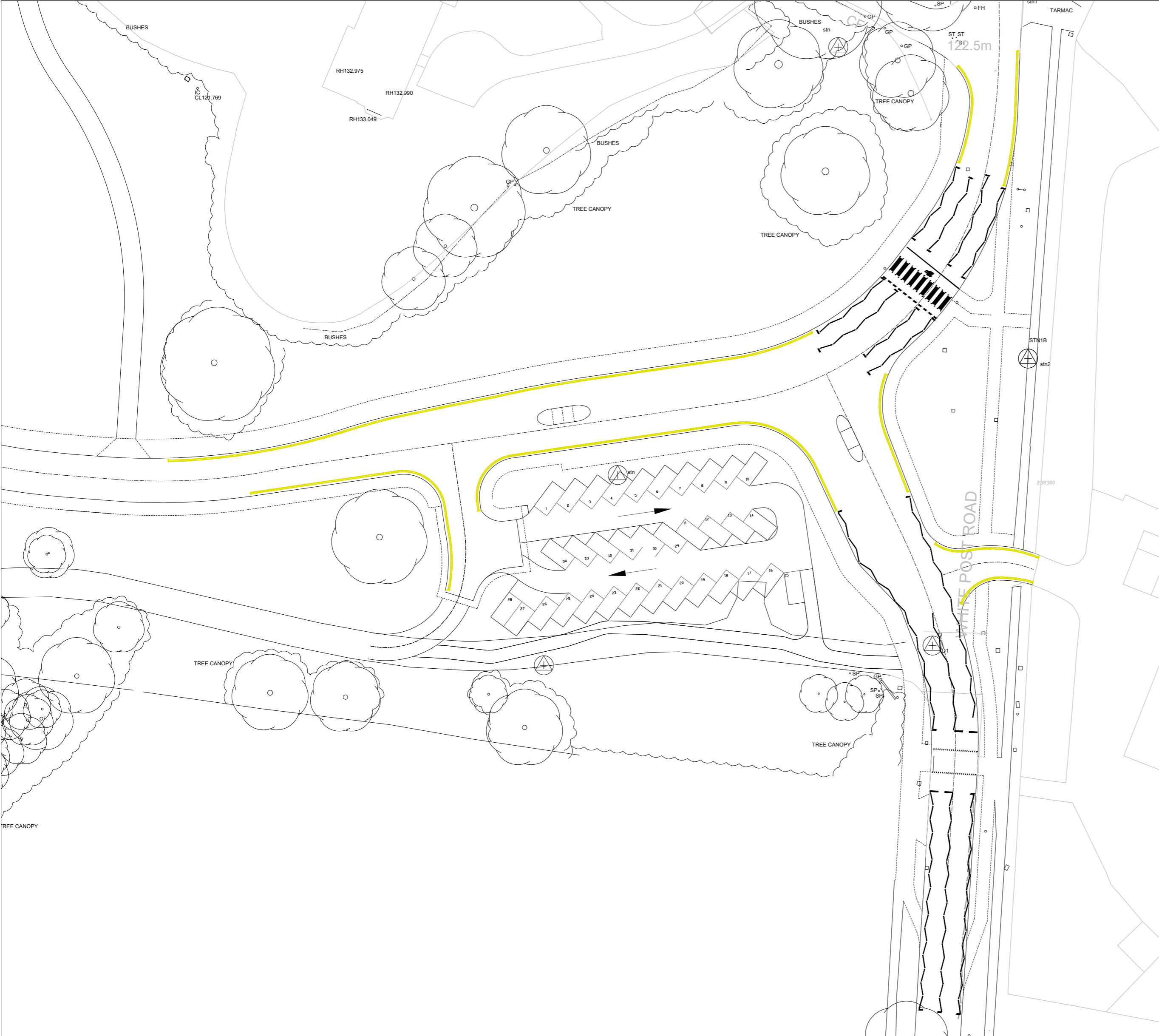

DAVID WILSON HOMES
 David Wilson Mercia
 Remus 2
 2 Cranbrook Way
 Solihull Business Park
 Solihull
 B90 4GT

REV	DESCRIPTION	DATE

Key

1018.1
 Continuous line
 100 wide

--	--

STATUS:	
SCALE:	1:500 @ A2
DATE:	Nov 2020
DRAWN:	LB

TITLE:	Section 278 Adoptable Highway Traffic Restriction Plan
PROJECT:	White Post Road, Bodicote
DRG. No:	957-278-20

iD LTD
 INFRASTRUCTURE DESIGN LIMITED

33 The Point
 Rockingham Road
 Market Harborough
 Leicestershire LE16 7QU
 Tel: 01858 411570 Fax: 01858 411751
 Email: info@infrades.co.uk URL: www.infrades.co.uk