

**Proposed Access works on Wendlebury Road 1:100**

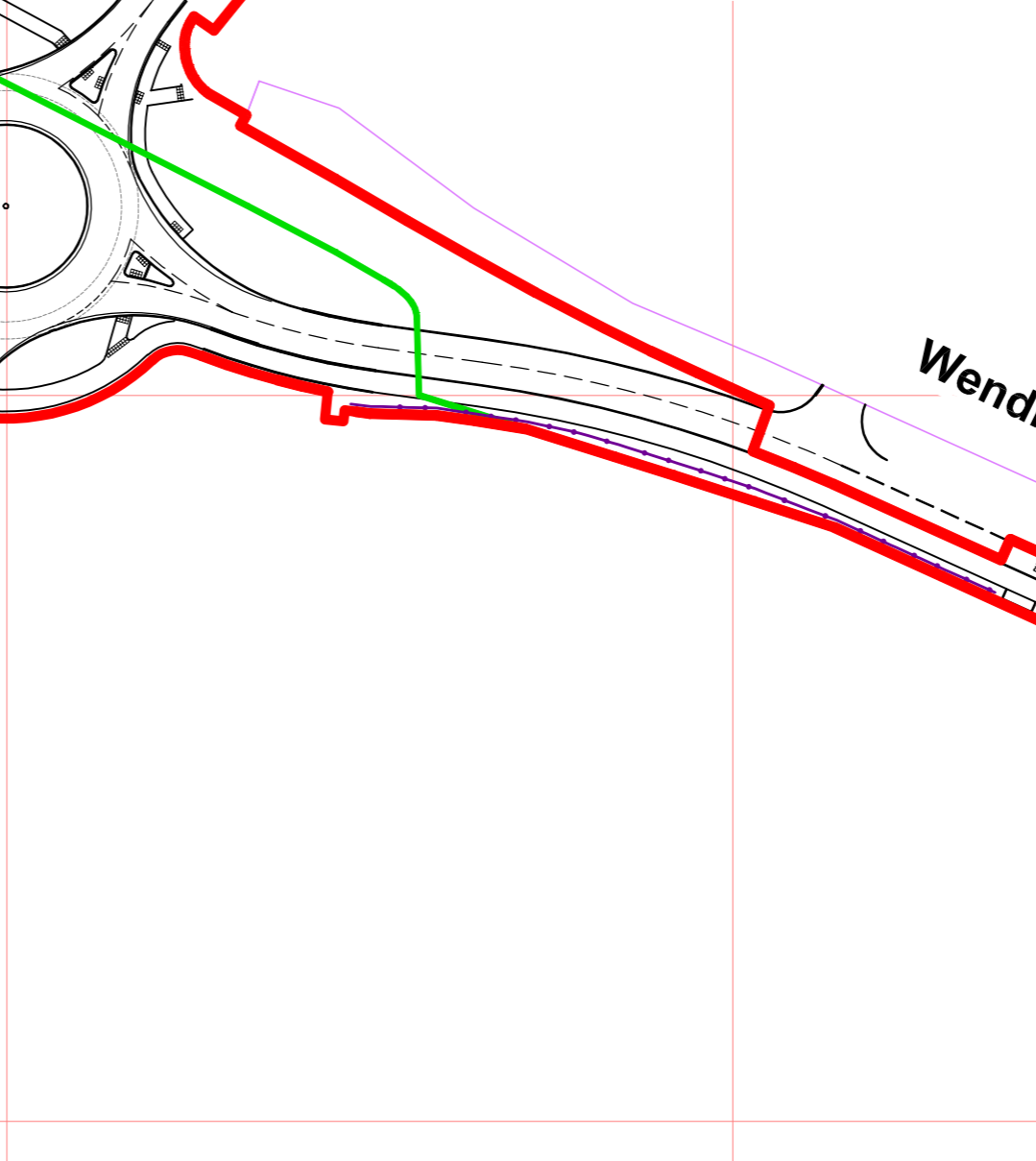

**NOTE:**  
FOR ROAD MARKING DETAILS SEE BJH GENERAL DETAILS DRAWING NO. S1358-S278-21 FOR FURTHER SIGN, POST & FOUNDATION DETAILS SEE BJH SIGN SCHEDULE (ISSUE 3).

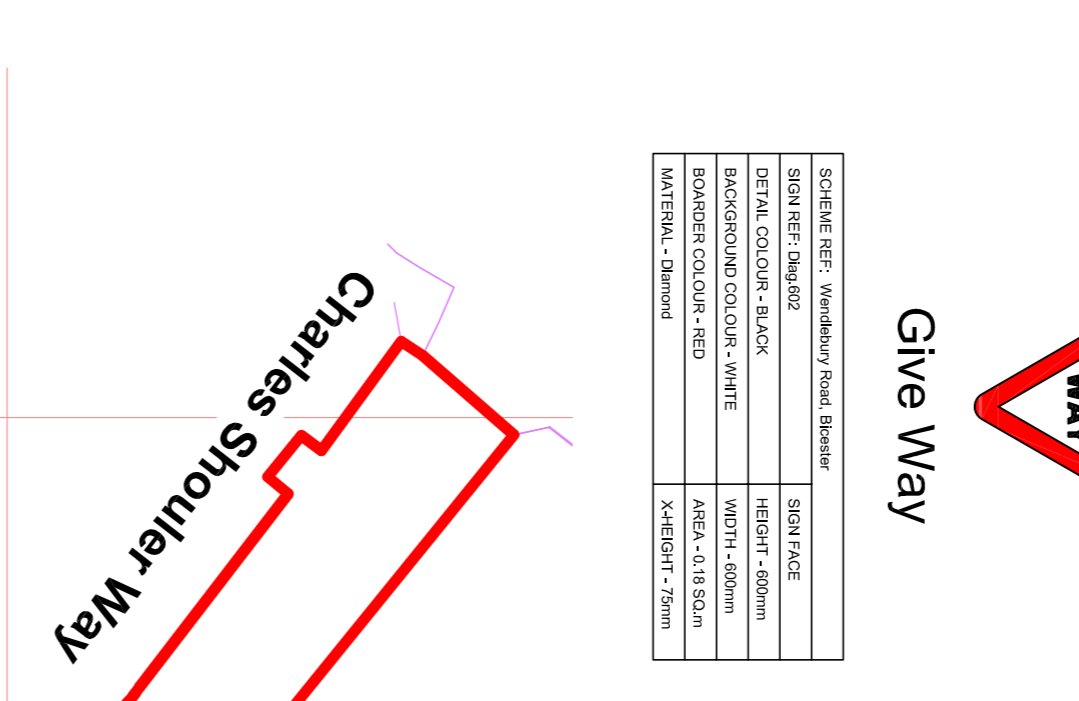
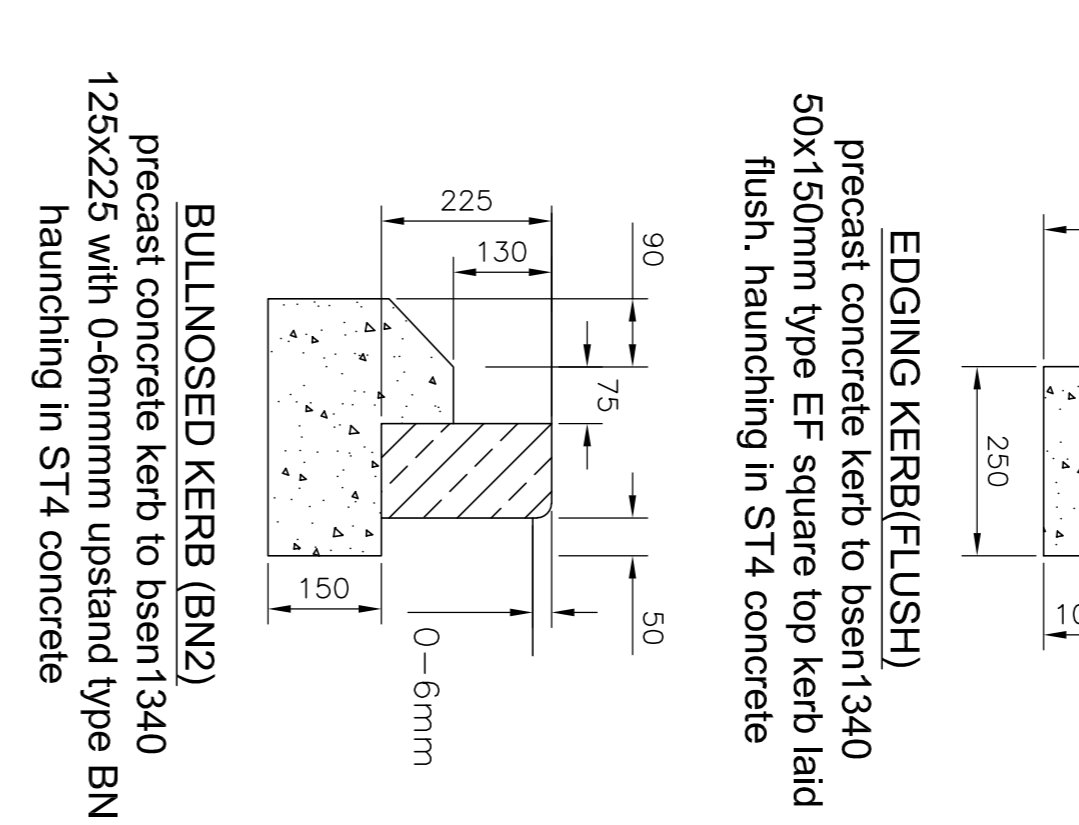
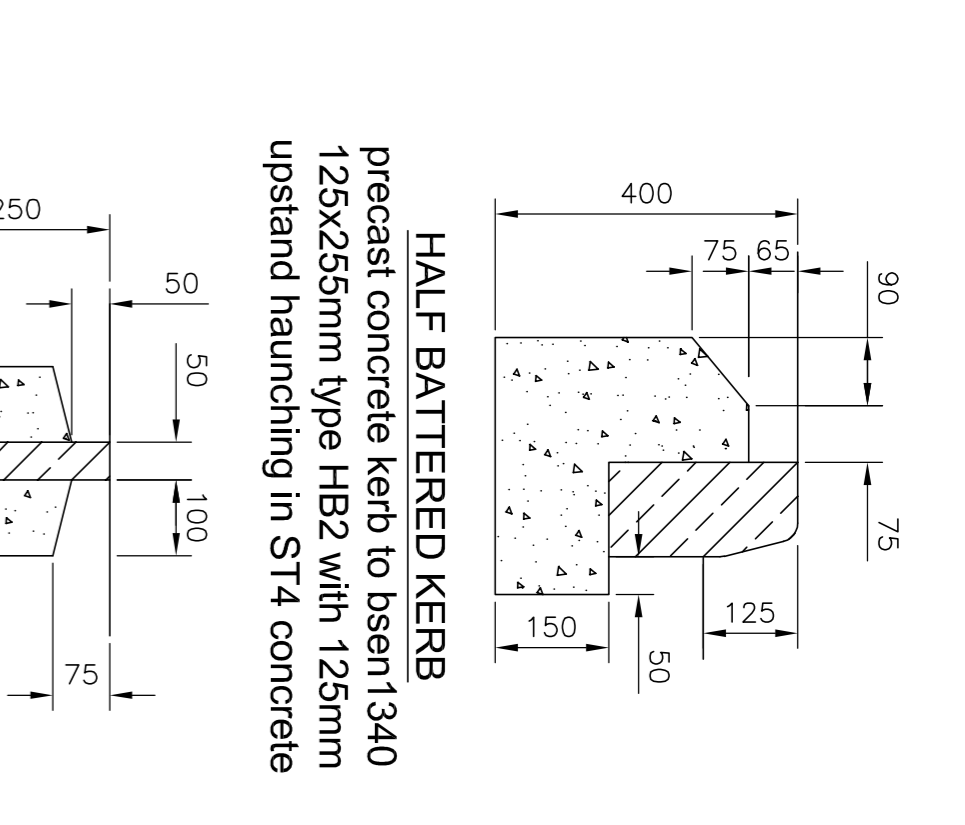
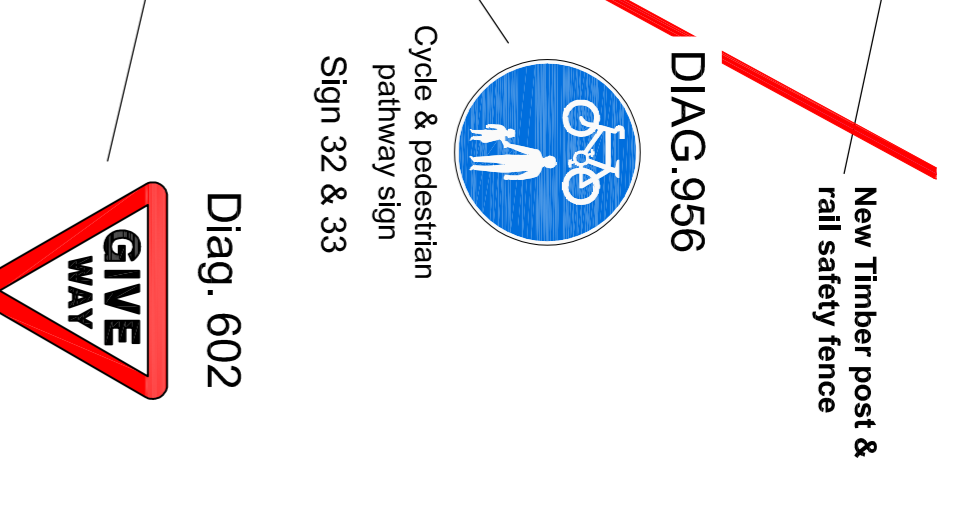
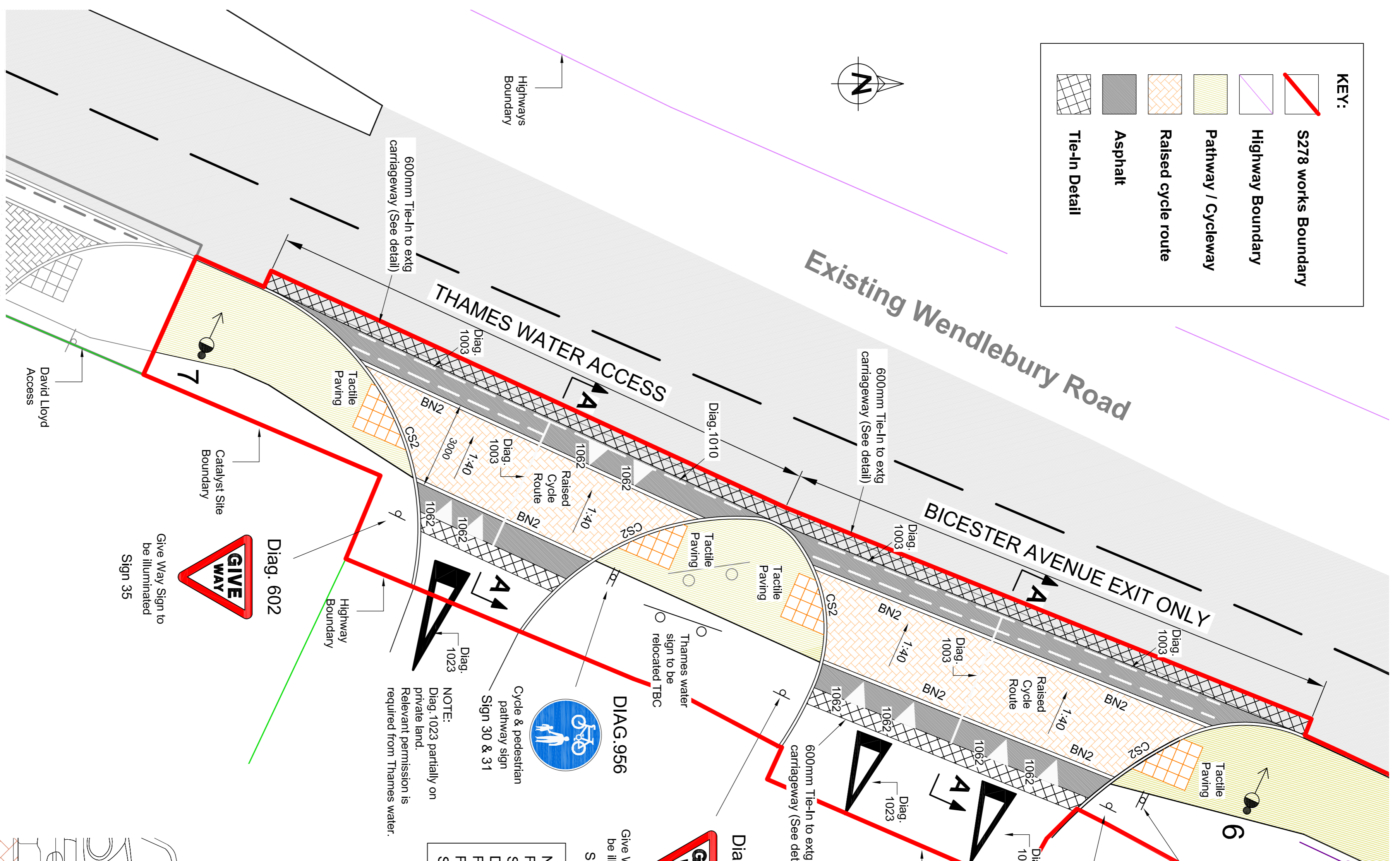
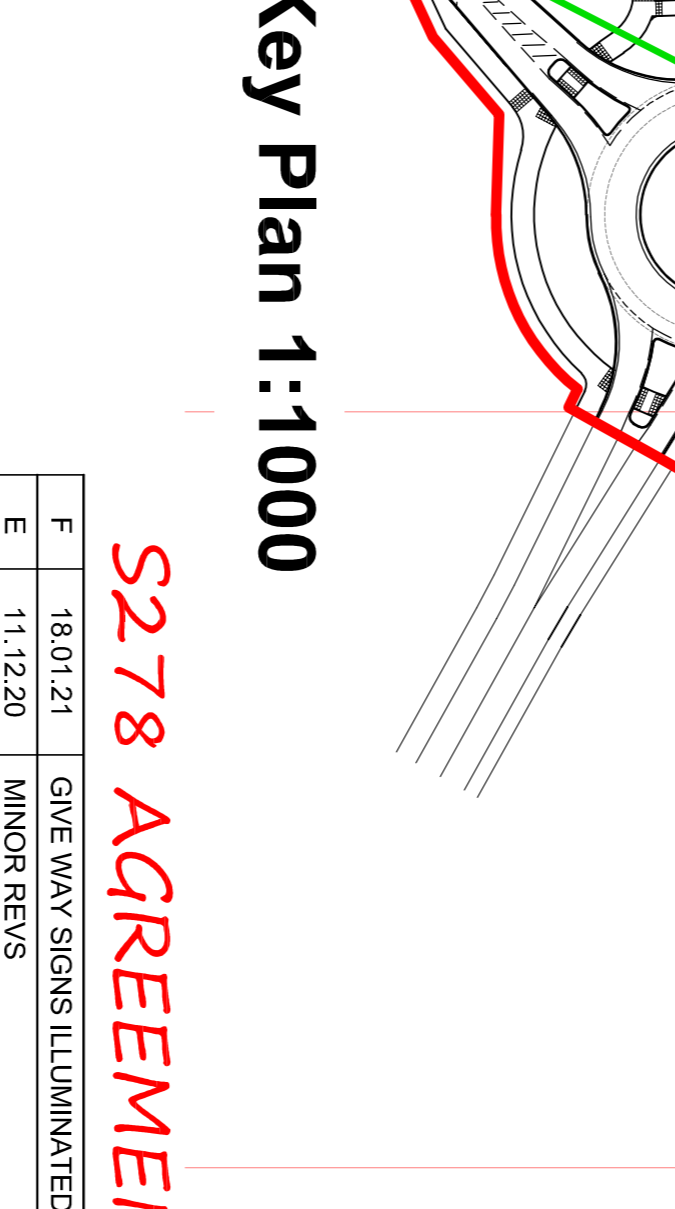
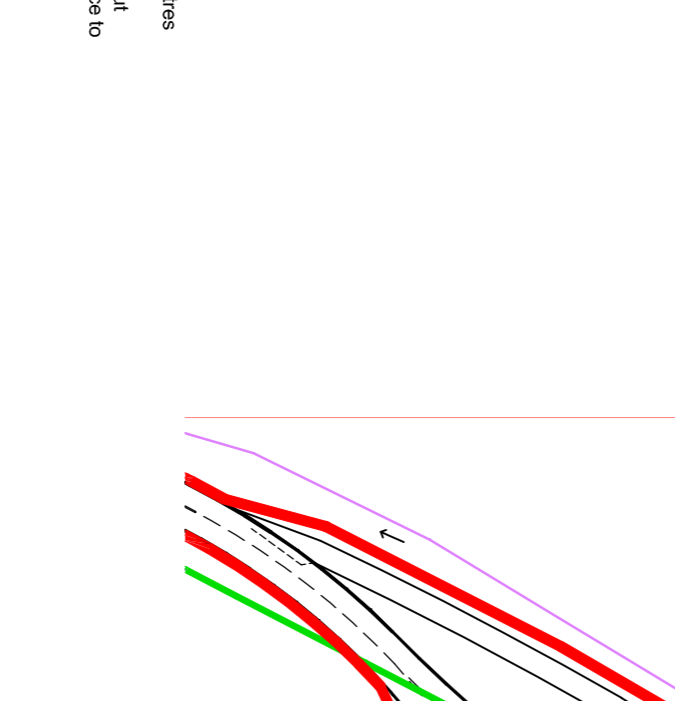
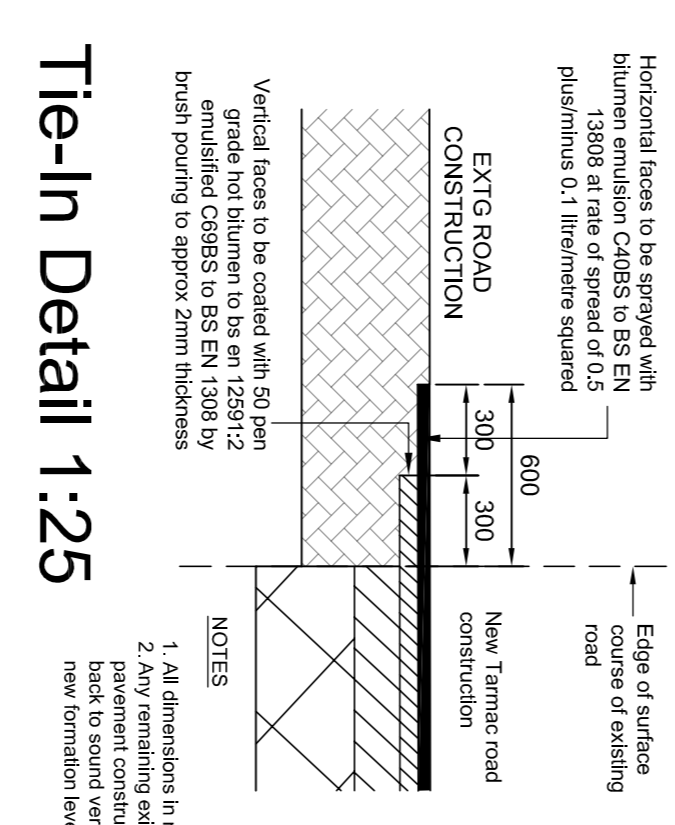

| Rev | Date     | Description                |
|-----|----------|----------------------------|
| F   | 18.01.21 | GIVE WAY SIGNS ILLUMINATED |
| E   | 11.12.20 | MINOR REVS                 |
| D   | 24.11.20 | TECHNICAL AUDIT RESPONSE   |
| C   | 22.10.20 | RSA STAGE 2 RESPONSE       |
| B   | 21.09.20 | TECHNICAL SUBMISSION       |
| A   | 07.07.20 | ISSUED FOR S278 APPROVAL   |

**Revision Schedule**

Client: **Albion Land Plc.**

SECTION 278 WORKS  
THAMES WATER ACCESS &  
BICESTER AVENUE EXIT WORKS

**BAILEY JOHNSON HAYES**  
Consulting Engineers

STABAINS: Suite 4, Phoenix House, 83 Campfield Rd, STABAINS, Here, AL1 5PL  
MANCHESTER: George House, John Dalton Street, MANCHESTER, M2 6PW

Scale: 1:100, 25 @A1  
Date: 28.03.20  
Drawn: DJC

**S1358-S278-15F**