

Road A 1:250(H) 1:125(V)

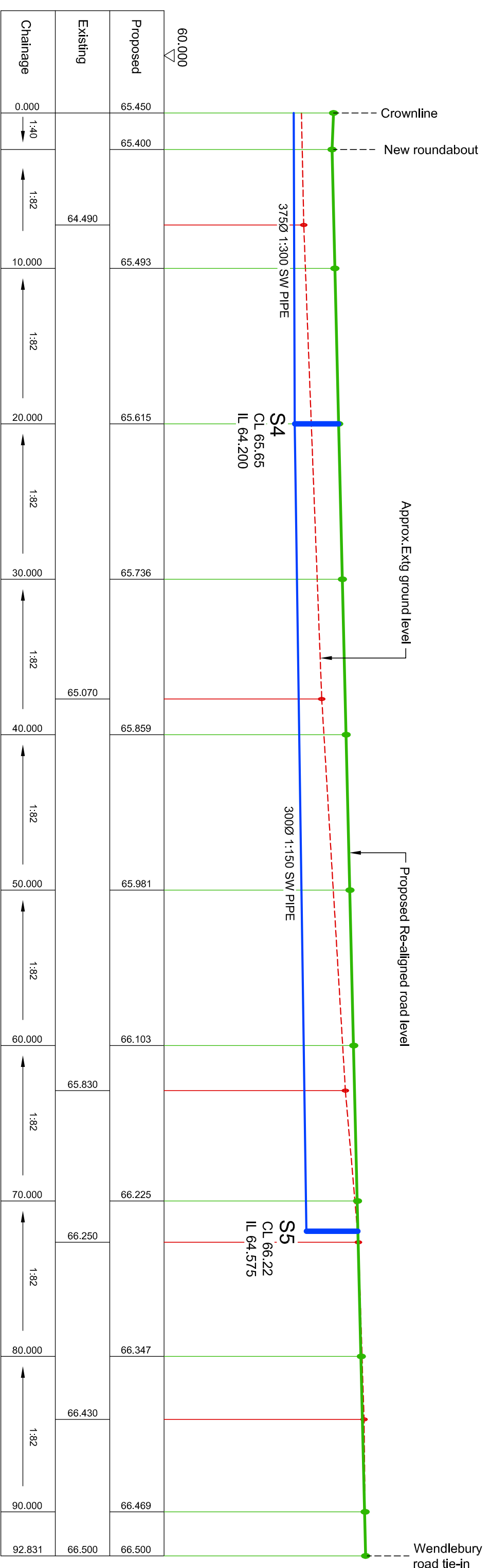

Road B 1:250(H) 1:125(V)

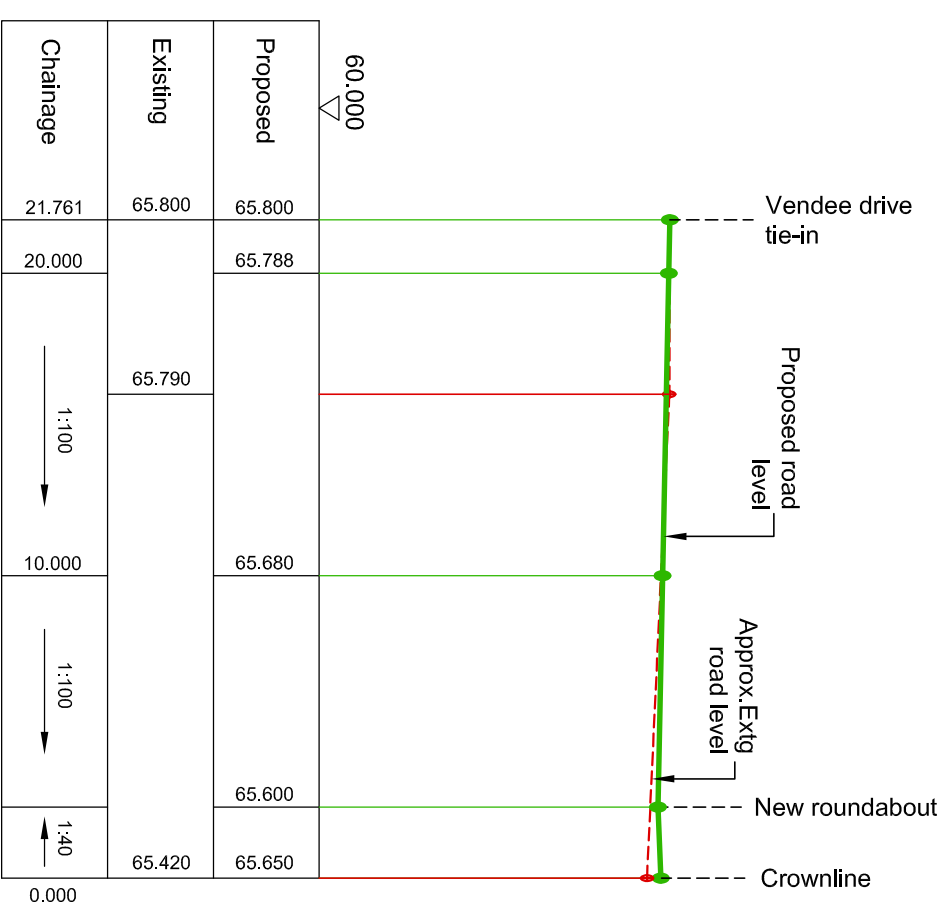

Road C 1:250(H) 1:125(V)

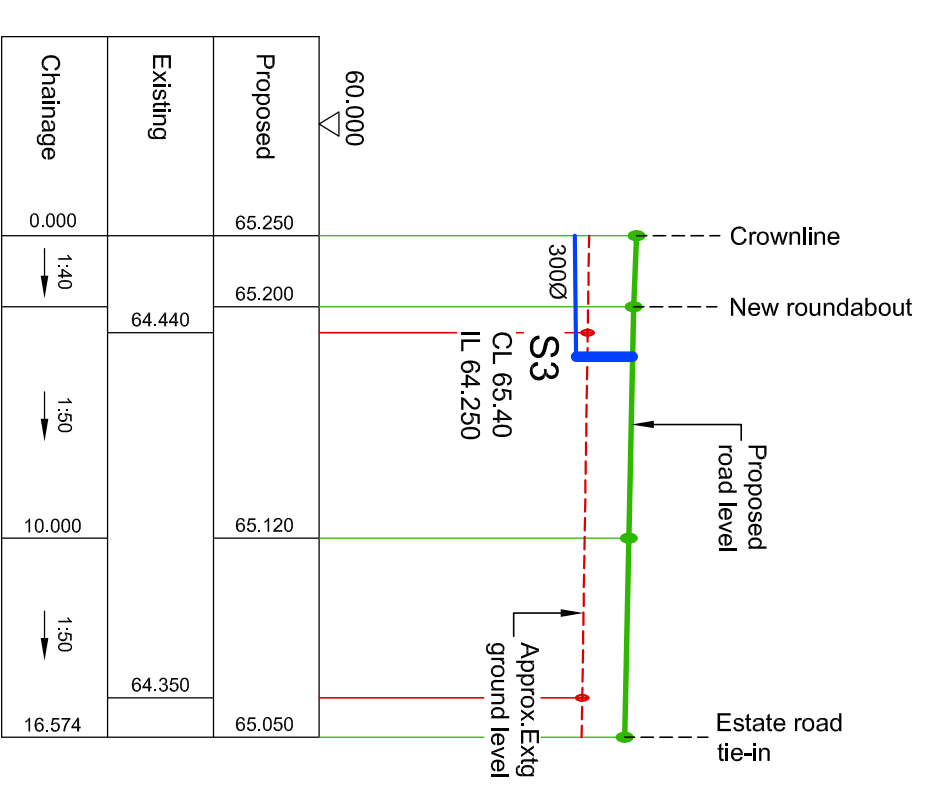

Road D 1:250(H) 1:125(V)

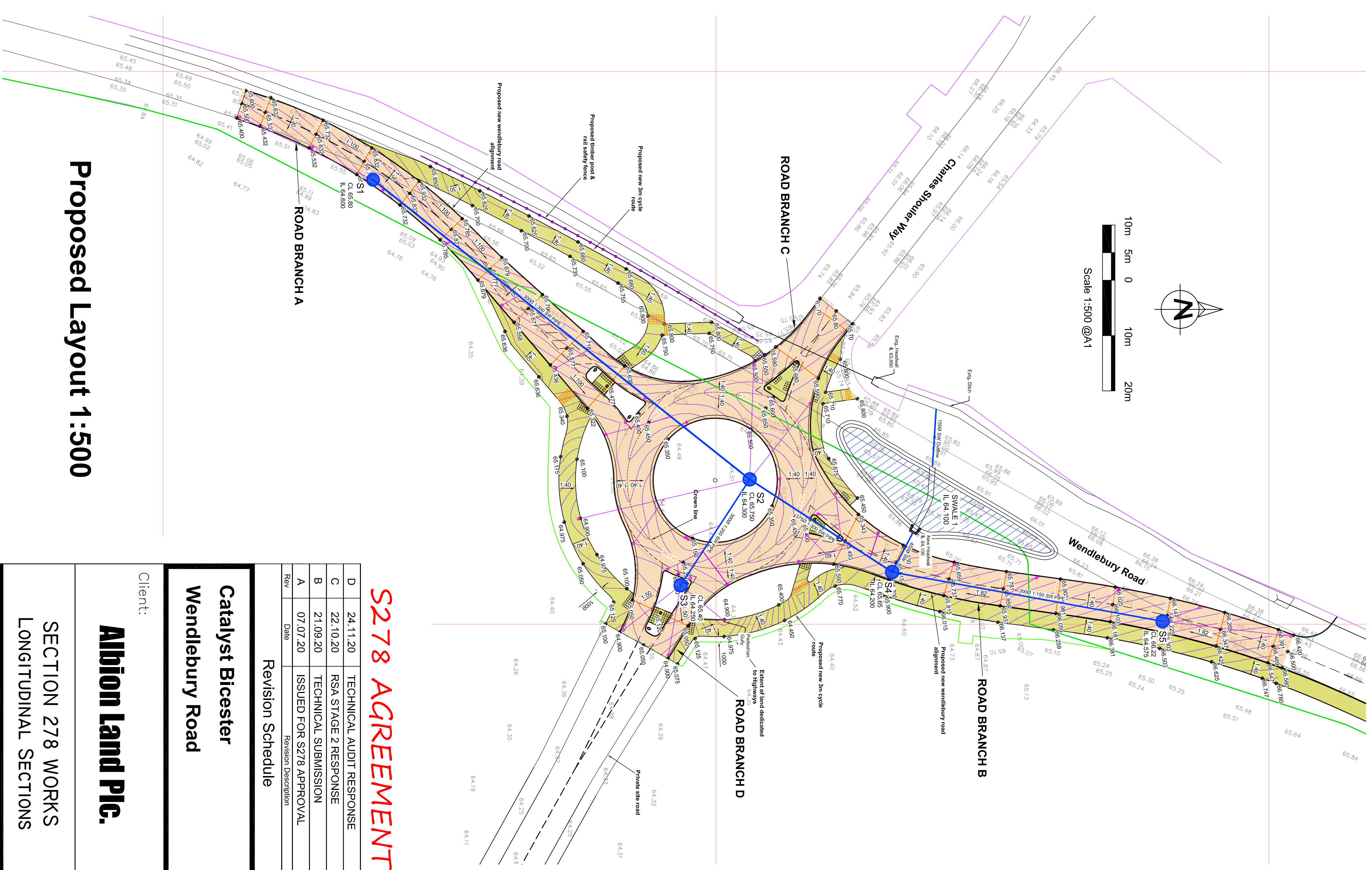

Proposed Layout 1:500

S278 AGREEMENT

Rev	Date	Description
D	24.11.20	TECHNICAL AUDIT RESPONSE
C	22.10.20	RSA STAGE 2 RESPONSE
B	21.09.20	TECHNICAL SUBMISSION
A	07.07.20	ISSUED FOR S278 APPROVAL

Catalyst Bicester
Wendlebury Road

Albion Land Plc.

Client:
Albion Land Plc.
SECTION 278 WORKS
LONGITUDINAL SECTIONS

BAILEY JOHNSON HAYES
Consulting Engineers
STALBANS: Suite 4, Phoenix House, 83 Campfield Rd, STALBANS, Hants AL1 5PL
MANCHESTER: Granada House, John Dalton Street, MANCHESTER, M2 6JW
Scale: AS SHOWN
Date: 24.03.20
Drawn: DJC
S1358-S278-13D