

- Key:**
- Proposed Buildings
 - Site Boundary
 - Existing Adopted Foul Pumped Main
 - New Catalyst Bicester Pumped Main route
 - New Foul Pumping Station
 - New Foul Water Flow Paths
 - Existing Foul Pumping Station
 - Existing Gravity Foul Drainage

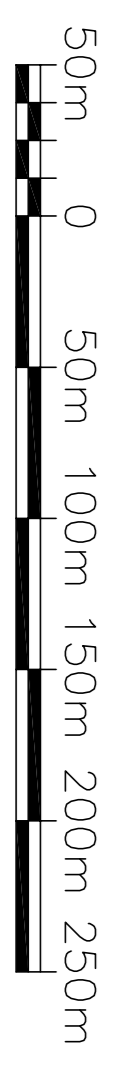

1:2500 @ A1

FW Drainage Pump Main Route 1:2500

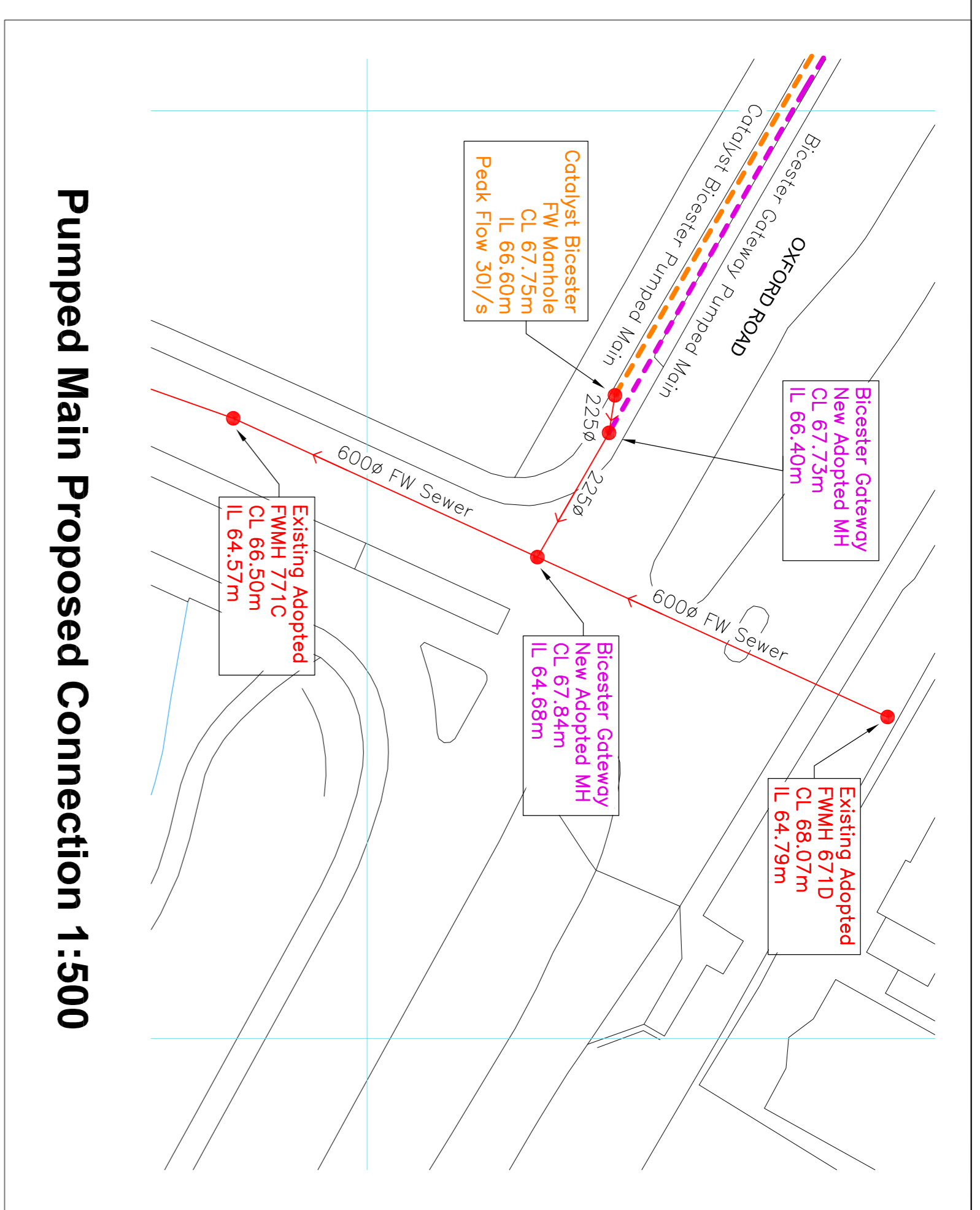
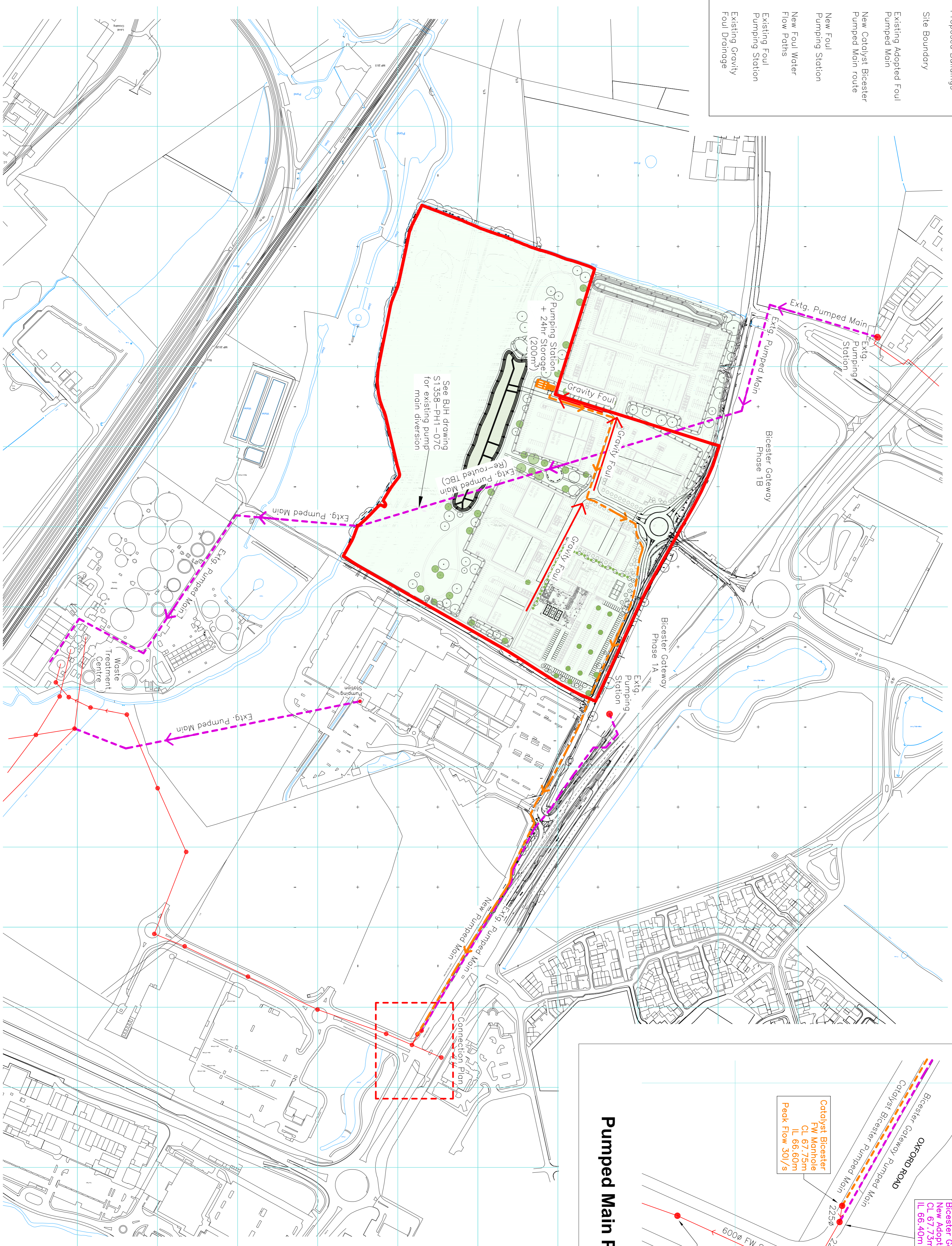

PRELIMINARY

RM A1 29.09.20

NOTES
 MK Surveys
 Topographical Survey (June 2018)
 Cornish Architects
 'Phase 1 Proposed Site Plan Option 3'
 Plan Ref: 18022 - SK - 117(C) (July 2020)

Rev	Date	Revision Description
A	29.09.20	PHASE 1 RMA1 APPLICATION

Catalyst Bicester
Wendlebury Road

Client:
Albion Land Plc.

PHASE 1 - PACKAGE 2
FW DRAINAGE PUMP MAIN ROUTE

BAILEY JOHNSON HAYES
 Consulting Engineers
 STABAINS: Site 4, Phoenix House, 83 Campfield Rd, STABAINS, Herts AL1 5PL
 MANCHESTER: George House, John Dalton Street, MANCHESTER, M2 6JW
 Scale: 1:500 @ A0
 Date: 17.09.20
 Drawn: JNG
S1358-PH1-18A