

# **APPENDIX A**

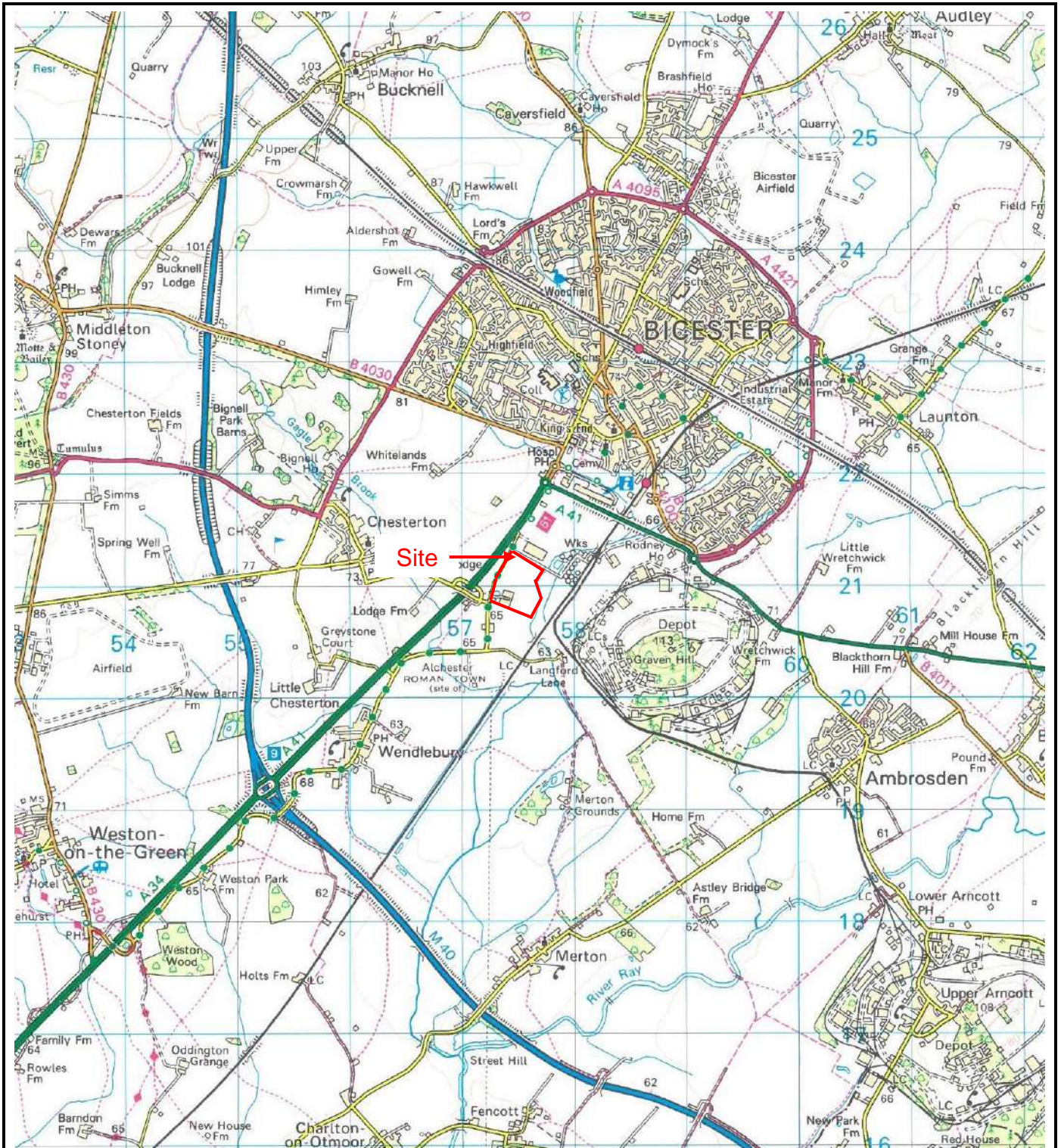

Reproduced from the Ordnance Survey Map with permission of the Controller of Her Majesty's Stationery Office, Crown Copyright\* LICENCE No: 100055022

<b>APPLIED GEOLOGY</b> Unit 23 Abbey Park Stareton Kenilworth CV8 2LY Tel: 02476 511822 email: admin@appliedgeology.co.uk			Client:	ALBION LAND LTD
			Project:	CATALYST BICESTER, WENDLEBURY ROAD
Drawn By:	Checked By:	Paper Size:	Title:  SITE LOCATION PLAN	
JS	FHJ	A4		
Scale: 1:50,000	Date: 06.07.2020	NGR: 457226 220693		
Drawing No: AG2875A-20-01		Revision: 0		



KEY:

-  Trial Pit (undertaken in 2018)  
TP1
-  Trial Pit  
TP101
-  Cable Percussion Borehole  
BH01
-  Driven Continuous Sampling Borehole  
DCS1

Drawing based on MK Surveys drawing number 2564R1 dated June 2018.

1	Base Plan changed.	25.08.2020	FHJ
Rev	Notes	Date	By

# APPLIED GEOLOGY

Unit 23  
Abbey Park  
Stareton  
Kenilworth  
CV8 2LY

Tel: 02476 511822  
email: admin@appliedgeology.co.uk

Client:  
ALBION LAND LTD

Project:  
CATALYST BICESTER, WENDLEBURY ROAD

Title:  
EXPLORATORY HOLE LOCATION PLAN

Drawn By: FD	Checked By: KM	Paper Size: A3
--------------	----------------	----------------

Scale: 1:2500	Date: 01.07.2020
---------------	------------------

Drawing No: AG2875A-20-02	Revision: 1
---------------------------	-------------

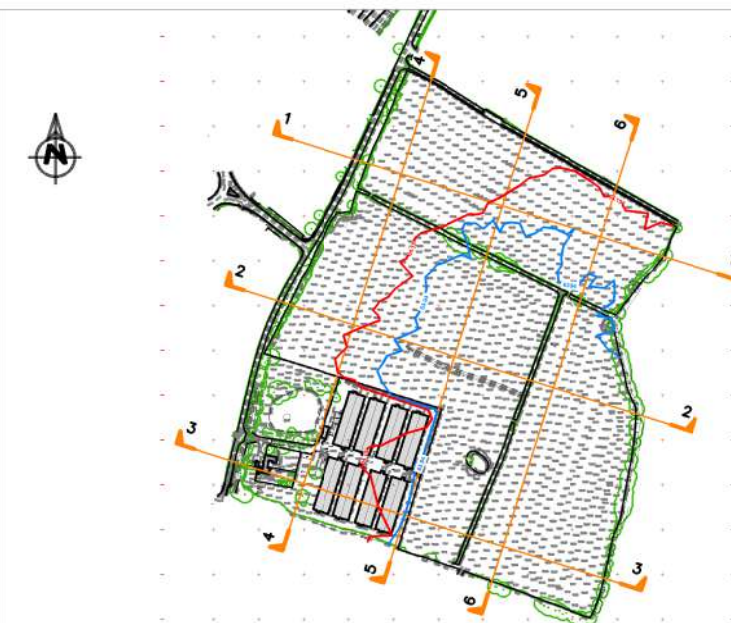
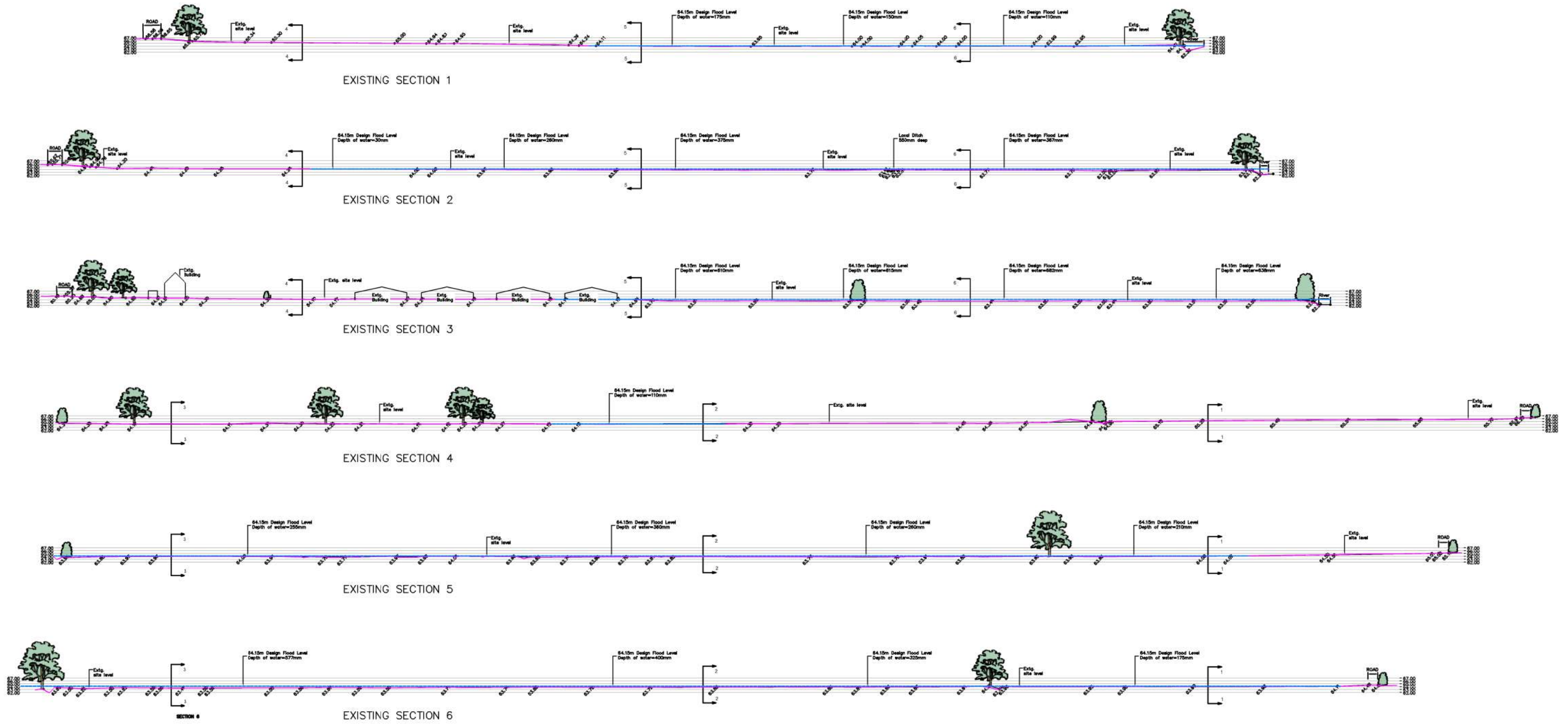

**PRELIMINARY**

Rev	Date	Revised Description
A	13.06.19	Updated to latest design flood levels

Revision Schedule

**Catalyst Bicester**  
Wendlebury Road, Bicester

Client:  
**Albion Land Plc.**

EXISTING SITE SECTIONS SHOWING  
DESIGN FLOOD LEVEL

**BAILEY JOHNSON HAYES**  
Consulting Engineers

ST ALBANS: Suite 4, Phoenix House, 63 Church End, ST ALBANS, Herts AL1 1PL  
MANCHESTER: Orange House, John Dalton Street, MANCHESTER, M2 5PU

Scale: 1:500  
Date: 10.10.18  
Drawn: DJC

**S1358-Ext-09A**

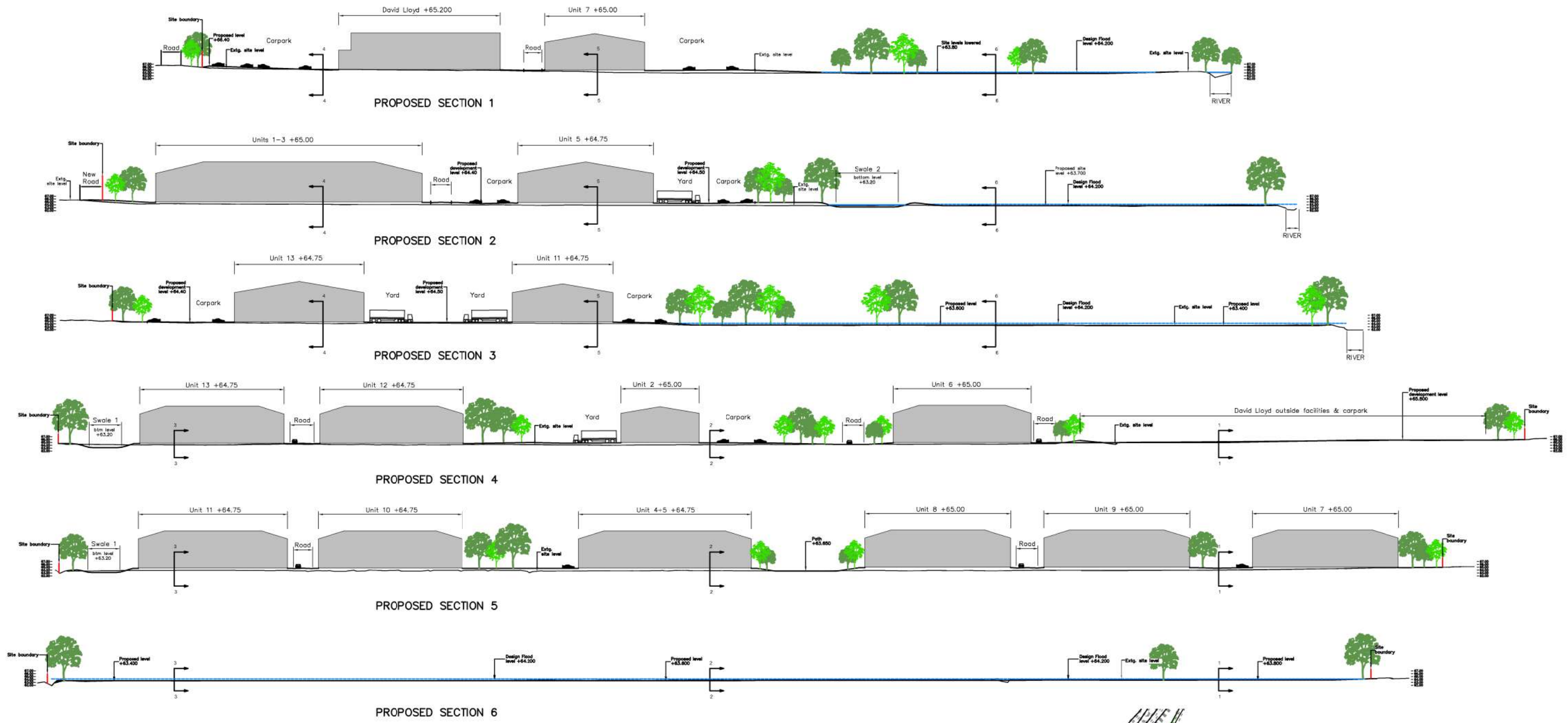

Site Layout 1:2500

**PRELIMINARY**

Rev	Date	Revised Description
A	03.06.19	Sections updated for new scheme

Revision Schedule

**Catalyst Bicester**  
**Wendlebury Road**

Client:  
**Albion Land Plc.**

SITE SECTIONS SHOWING  
PROPOSED DEVELOPMENT

**BAILEY JOHNSON HAYES**  
Consulting Engineers

ST ALBANS: Suite 4, Phoenix House, 83 Church End, ST ALBANS, Herts AL1 9PL  
MANCHESTER: Orange House, 10th Floor, 10th Floor, MANCHESTER, M2 4PR

Scale: 1:500  
Date: 11.10.18  
Drawn: DJC

**S1358-Ext-10A**



10m 0 10m 20m 30m 40m 50m

1:500 @ A0



**KEY:**

- FOOTPATH
- PERMEABLE BLOCK PAVING CAR PARKING
- REINFORCED CONCRETE ROAD/YARD SLAB
- ASPHALT ROAD SURFACE
- SWALE
- NEW UNITS

### Proposed External Works Plan 1:500

**PRELIMINARY**

Rev	Date	Description
A	10.06.19	Updated to latest Architects Layout

Revision Schedule

**Catalyst Bicester**  
Wendlebury Road, Bicester

Client:  
**Albion Land Plc.**

TECH SCHEME OPTION 8  
PROPOSED EXTERNAL FINISHES

**BAILEY JOHNSON HAYES**  
Consulting Engineers

Scale: 1:500 @ A0  
Date: 19.03.19  
Drawn: JNG

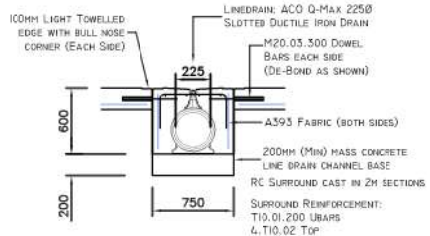

ACO QMAX 225 LINE DRAIN 1:25

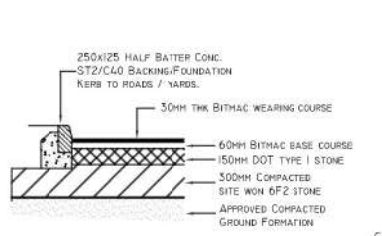

BITMAC ROAD SURFACE 1:25

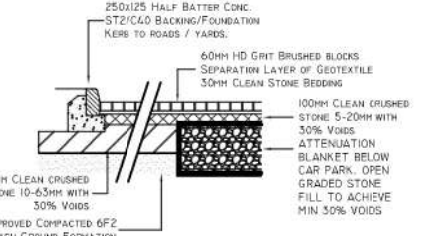

PERMEABLE BLOCK CARPARK 1:25

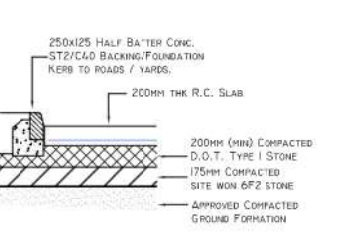

RC YARD KERB DETAIL 1:25

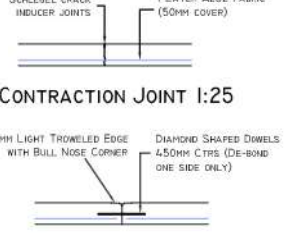

LONGITUDINAL JOINT 1:25

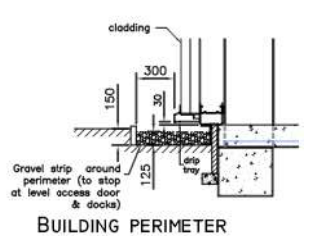

BUILDING PERIMETER GRAVEL STRIP DETAIL 1:25

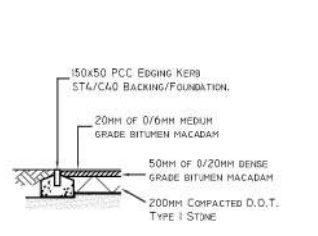

PATH EDGING DETAIL 1:25