

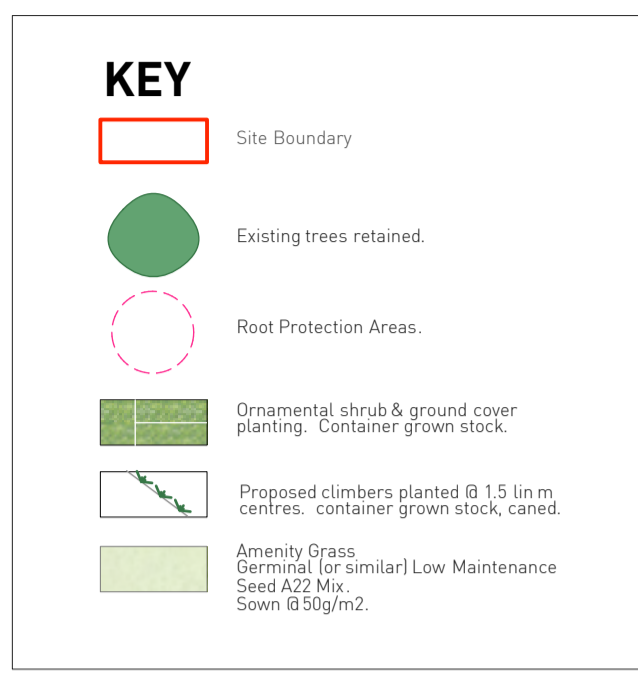

**PLANTING SPECIFICATION**

These implementation and maintenance guidelines are for planning purposes only to indicate the level of workmanship to be specified and do not constitute a detailed specification.

- GENERAL**
  - All landscape operatives will be appropriately trained, certified and qualified to undertake the tasks required. When required, the relevant certificates will be made available for inspection. All work is to be carried out in accordance with the relevant British Standards, Codes of Practice and Legislation.
  - All plants shall conform to BS 3936 and be in accordance with the National Plant Specification. Supplying nurseries shall be registered under the NPS Nursery Certification Scheme. All plants shall be packed and transported in accordance with the Code of Practice for Plant Handling as produced by CPSE.
  - Planting shall not be carried out when the ground is waterlogged, frost bound or during periods of cold drying winds. All bare root planting stock will be kept covered until actually planted in order to minimise water-loss and prevent the roots from drying out. Tree handling, storage and planting shall be in accordance with BS 8545 Chapters 9 to 10 and Annexes E to F.
  - The landscape contractor shall maintain all areas of new planting for a period of 12 months following practical completion. All stock deemed to be dead, dying or diseased within the defects period shall be replaced by the contractor at his own cost.
  - A minimum intervention approach will be used in terms of weed control. This is to be achieved by using mulch mats and hand-weeding. Weed killer and other chemicals will be used as little as possible on site. Spot removal of weeds will be carried out by hand removal as necessary.



**PLANTING SCHEDULE**

SHRUBS/HERBACEOUS	Height (cm)	Specification	Pot Size	Density	TOTAL
Bergenia 'Bressingham Ruby'	20-30	Full pot	3L	5/m <sup>2</sup>	217
Cistus x pulverulentus 'Sunset'	20-30	Bushy; 4 breaks	3L	4/m <sup>2</sup>	199
Cornus alba 'Kesselringii'	40-60	Branched; 4 breaks	3L	3/m <sup>2</sup>	172
Hebe albicans 'Red Edge'	30-40D	Bushy; 7 breaks	5L	3/m <sup>2</sup>	76
Lavandula angustifolia 'Munstead'	30-40	Bushy; 7 breaks	5L	4/m <sup>2</sup>	118
Philadelphus 'Manteau d'Hermine'	30-40	Branched; 4 breaks	3L	4/m <sup>2</sup>	160
Pittosporum tenuifolium 'Tom Thumb'	30-40	Bushy; 5 breaks	3L	4/m <sup>2</sup>	196
Sarcococca humilis	20-30	Bushy; 4 breaks	3L	4/m <sup>2</sup>	44
Spiraea japonica 'Anthony Waterer'	30-40	Branched; 6 breaks	3L	3/m <sup>2</sup>	104

ORNAMENTAL GRASSES	Specification	Pot Size	Density	TOTAL
Carex 'Red Rooster'	Full Pot	5L	4/m <sup>2</sup>	84
Deschampsia cespitosa 'Goldtau'	Full Pot	5L	5/m <sup>2</sup>	210
Stipa tenuissima	Full Pot	5L	5/m <sup>2</sup>	184

CLIMBERS	Height (cm)	Specification	Pot Size	Density	TOTAL
Clematis montana 'Rubens'	60-80	Caned; several shoots; 2 breaks	3L	1.5 /m <sup>2</sup>	10

- SHRUB/HERBACEOUS PLANTING**
  - Shrubs/herbaceous plants are to be set out as shown on the drawing and pit planted into the prepared soil at the specified densities with minimal disturbance to the rootball and well firmed in.
  - Multi-purpose topsoil depths shall be 450mm for shrubs/herbaceous. Before receiving topsoil, subsoils should be loosened using ripping equipment; this shall be done when the subsoil is dry to encourage soil chattering. All stones and other objects larger than 50 mm shall be removed from the prepared surface.
  - Within the day of planting shrub/herbaceous plants should be saturated to field capacity; this shall be done before applying the below bark mulch.
  - Spread ornamental pine bark mulch to a depth of 50mm across all new planted areas, taking care not to bury groundcover plants.
- CLIMBER PLANTING**
  - Climber plants are to be set out as shown on the drawing and pit planted into the prepared soil with minimal disturbance to the rootball and well firmed in.
  - Multi-purpose topsoil depths shall be 450mm. Before receiving topsoil, subsoils should be loosened using ripping equipment; this shall be done when the subsoil is dry to encourage soil chattering. All stones and other objects larger than 50 mm shall be removed from the prepared surface.
  - All climbing shrubs shall be planted 150mm clear of the supporting structure (i.e. fence / wall) with roots spread outward. All climbers should be supplied and tied to a cane; this should be guided towards the supporting structure. A supporting structure should be provided, such as a timber frame or wires and vine eyes.
  - Within the day of planting climber plants should be saturated to field capacity; this shall be done before applying the below bark mulch.
- GENERAL MAINTENANCE**
  - The Landscape contractor shall maintain all areas of new planting for a period of 12 months following practical completion. All stock deemed to be dead, dying or diseased within the defects period shall be replaced by the contractor at his own cost. The site is to be visited monthly throughout the year to undertake the following operations:
    - Weed clearance: All planting areas to be kept weed free by hand weeding or herbicide treatment.
    - Litter clearance: All litter is to be removed from planting beds.
    - Watering: All planted areas are to be watered for the first two years from May to September following any dry periods of 7 days.

- Shrubs**
- All shrubs are to be watered for the first two years from May to September following any dry periods of 7 days. Plants are to be pruned in accordance with good horticultural practice to maintain healthy, well-shaped specimens.
- AMENITY GRASS**
- Preparation**
- Areas to be turfed or seeded shall be sprayed out with a glyphosate herbicide and cultivated to a depth of 100mm removing all weeds, debris and stones over 25mm diameter. The surface shall be raked to smooth flowing contours with a fine tith. Amenity grass areas will receive pre-seeding fertiliser at 70 g/m<sup>2</sup>.
  - Minimum 150mm depth of topsoil to be applied in preparation of seeding/turfing. Before receiving topsoil, subsoils should be loosened using ripping equipment; this shall be done when the subsoil is dry to encourage soil chattering. All stones and other objects larger than 50 mm shall be removed from the prepared surface.
  - Grass/turf finish levels will be 25mm above surrounding kerbs, paving and plant bed edges.
- Turf**
- Turf shall be supplied in accordance with BS3969. It shall be close textured and green in colour and be sufficiently fibrous to withstand handling. Turves shall be regular in shape, 300mm wide and of uniform thickness (minimum 25mm). The grass shall be closely mown and shall not exceed 25mm in height. Turf shall be stacked in piles of up to 1 metre. It shall not be laid in frosty or waterlogged conditions and shall not be stacked in rolls for more than three days. Turfing operations shall be in accordance with BS 4428. Whole turves shall be laid around the perimeter of the area to be turfed. The central area shall be laid in rows with staggered joints, well butted together, working from planks positioned on turves already laid. The turf shall be watered on completion. Any unevenness shall be made good by lifting the turf and adjusting the levels. Should shrinkage occur, line topsoil shall be brushed into the joints.
- Seeding**
- Grass seed (Germinal A22 Low Maintenance Mix) shall be sown either in April/May or September/October during calm weather and not when the ground is frost bound or waterlogged. Seed shall be sown in two equal sowings in transverse directions at 50 g/m<sup>2</sup> for amenity grass. After sowing the contractor shall lightly rake the seed into intimate contact with the soil.
- Initial Cut**
- When newly seeded amenity grass areas reach 50mm they should be lightly rolled and cut to a height of 25mm. All arisings shall be removed. Any bare patches shall be made good at this time. Amenity grass shall be regularly maintained between 25 and 50mm during the first season after sowing.

Revisions:  
First Issue - 21/07/2020 RL

**Soft Landscape Proposals  
Building 457, Heyford Park**

Client: Dorchester Living Ltd  
Stage: Planning

DRWG No: **D.0371\_20** REV: -  
Drawn by: RL Approved by: NHA

Date: 21/07/2020  
Scale: 1:200 @ A1

