

< Existing ground level to be graded back towards rear garden >

New stone walls to rear and side of garage, reuse of existing stone where possible in construction of new garage walls

concrete planks to rear of garage dressed with stone to inner face
Car port with mezzanine over

5859.3mm [19'-3"]

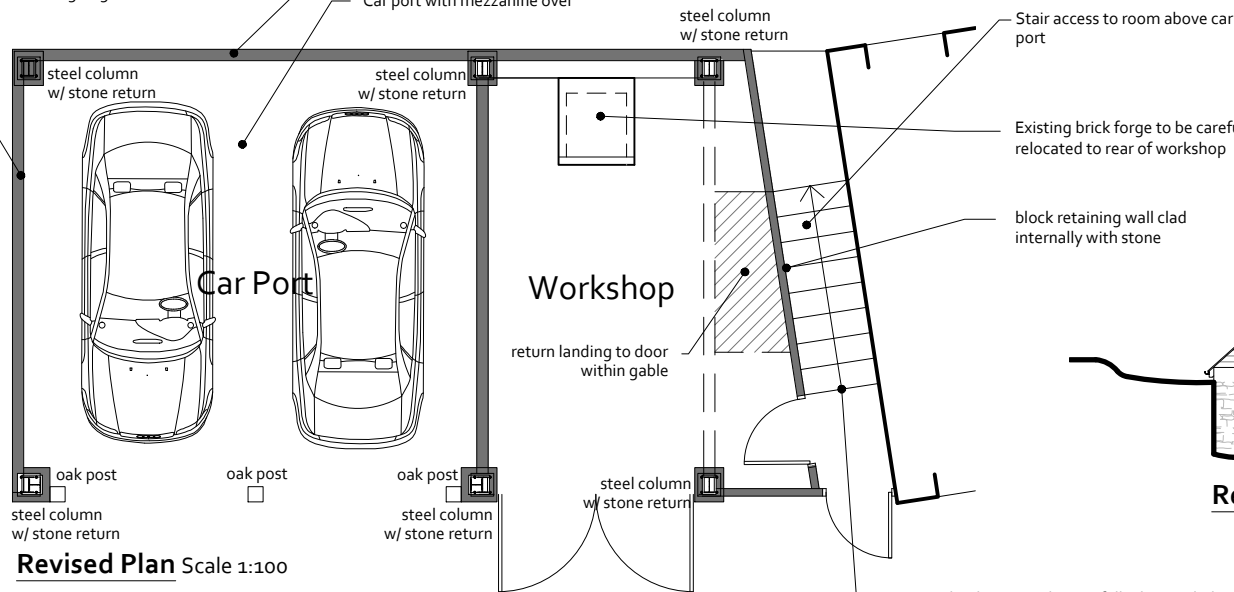

Revised Plan Scale 1:100

9299.1mm [30'-6"]

Existing brick steps to be carefully dismantled, renovated & replaced once garage has been erected - top of stairs to be reduced

Materials:

- Walls: Locally sourced stone and oak timber cladding
- Roof: Slate to match existing
- Windows: White timber casements to match existing
- Doors: Oak
- Rainwater goods: Black iron rainwater goods to match existing

