

TRANSPORT AND WORKS ACT 1992 THE NETWORK RAIL (EAST WEST RAIL BICESTER TO BEDFORD IMPROVEMENTS) ORDER

Key and Location Plan Sheet i of ii

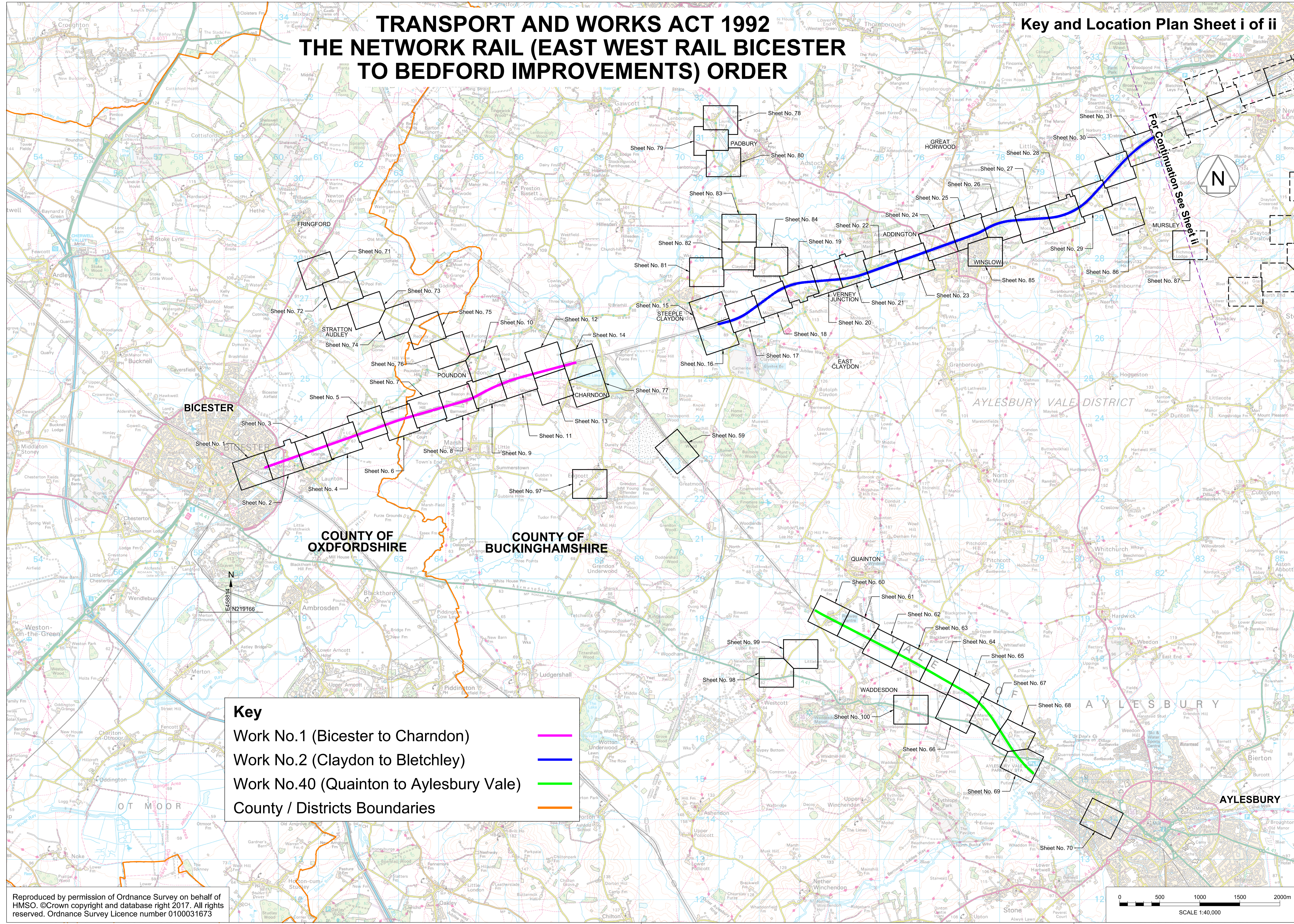

Key

- Work No.1 (Bicester to Charndon) —
- Work No.2 (Claydon to Bletchley) —
- Work No.40 (Quanton to Aylesbury Vale) —
- County / Districts Boundaries —

Reproduced by permission of Ordnance Survey on behalf of HMSO. ©Crown copyright and database right 2017. All rights reserved. Ordnance Survey Licence number 0100031673

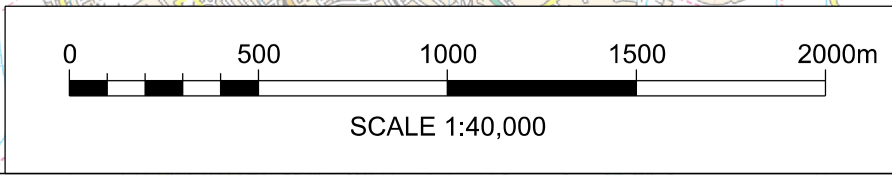

THE NETWORK RAIL
(EAST WEST RAIL BICESTER TO
BEDFORD IMPROVEMENTS)
ORDER

Sheet No. 1 of 136

Work No.1 (RAILWAY)

UNRESTRICTED POWERS TO ACQUIRE LAND

No. on plan:
0007, 0009, 0022

POWERS LIMITED TO TEMPORARY USE OF LAND

No. on plan:
0001, 0003, 0004, 0005, 0006, 0011

POWERS LIMITED TO TEMPORARY USE OF LAND
AND ACQUISITION OF RIGHTS

No. on plan:
None

POWERS LIMITED TO ACQUISITION OF RIGHTS

No. on plan:
None

POWERS LIMITED TO EXTINGUISHMENT OF RIGHTS

No. on plan:
None

HIGHWAYS TO BE STOPPED UP TEMPORARILY

Footpath 129/18/10 between points T1 and P2 (on sheet 2)

KEY

- CENTRE LINE OF WORK
- - - - - LIMIT OF DEVIATION
- - - - - LIMIT OF LAND TO BE ACQUIRED OR USED
- • • • • COUNTY / BOROUGH / DISTRICT BOUNDARY
- + + + + + PARISH BOUNDARY
- COMMENCEMENT OF WORK
- TERMINATION OF WORK
- Ⓐ NEW / IMPROVED ACCESS
- EXISTING OR ALLEGED PUBLIC RIGHT OF WAY
- PUBLIC RIGHT OF WAY OR ALLEGED PUBLIC RIGHT OF WAY TO BE STOPPED UP
- NEW PUBLIC RIGHT OF WAY
- TEMPORARY PUBLIC RIGHT OF WAY DIVERSION
- HS2 ACT LIMITS
- - - - - CUT LINE OF A SHEET OR INSET

Note: The area enclosed by any limit of deviation or by any limit of land to be acquired or used is the area extending to the outer edge of the line marking those limits.

OS map data reproduced by permission of Ordnance Survey on behalf of HMSO. © Crown copyright 2015. All rights reserved. Ordnance Survey licence number 0100040692

Alternative Reference
Sheet No. 1
Drawing Number

Revision
A01

133735_2A-EWR-OXD-TWAO-DR-T-000001

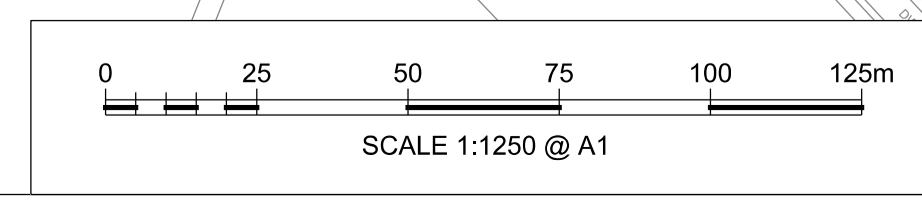
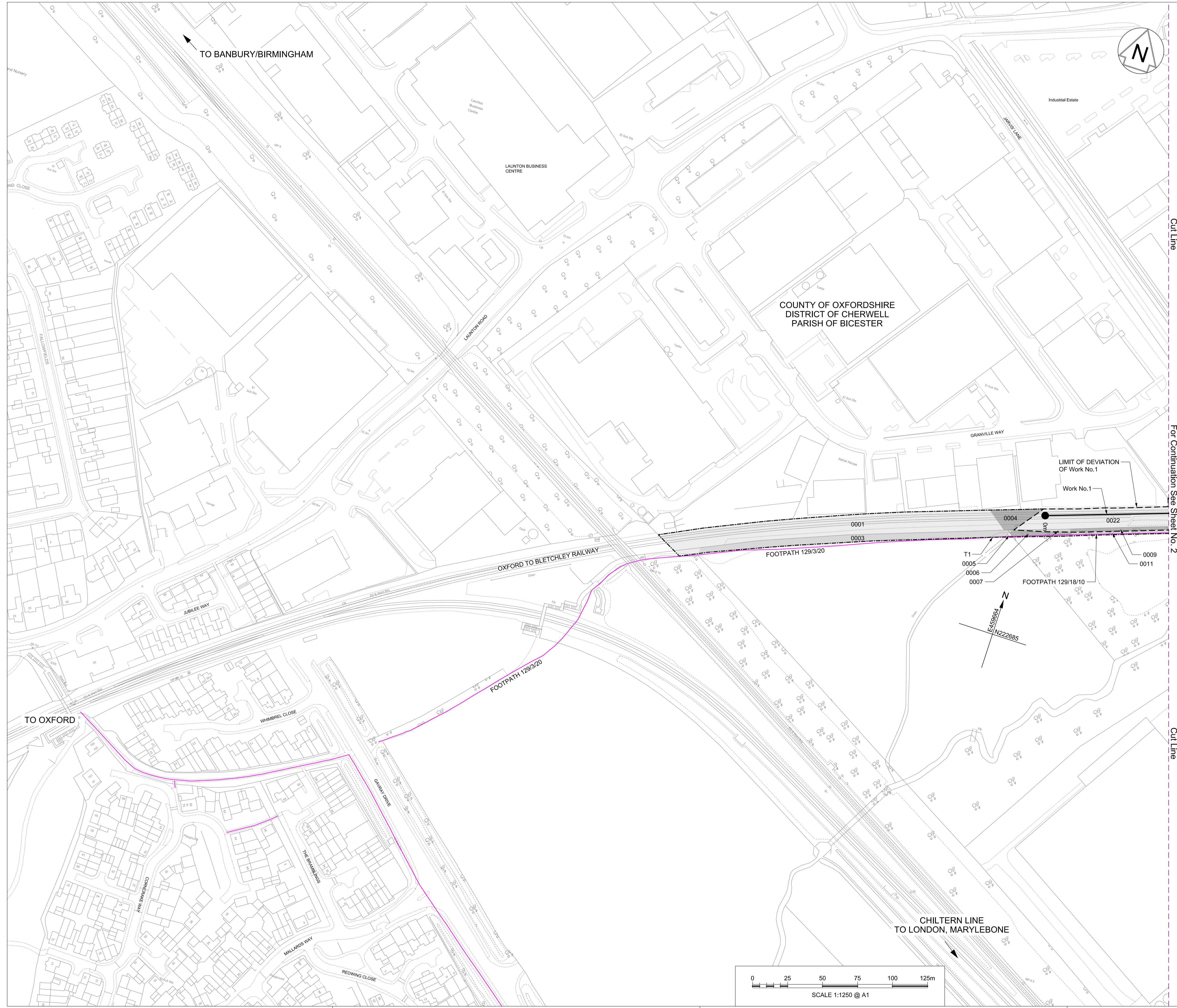

INSET A

COUNTY OF OXFORDSHIRE
DISTRICT OF CHERWELL
PARISH OF BICESTER

For Continuation See INSET A

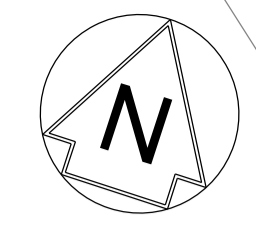

THE NETWORK RAIL
(EAST WEST RAIL BICESTER TO
BEDFORD IMPROVEMENTS)
ORDER

Sheet No. 2 of 136

- Work No.1 (RAILWAY)
- Work No.4 (FOOTBRIDGE)
- Work No.5 (ROAD)
- Work No.6 (ACCESS ROAD)
- Work No.7 (TEMPORARY ROAD)
- Work No.8 (TEMPORARY ROAD)
- Work No.9 (ACCESS ROAD)

UNRESTRICTED POWERS TO ACQUIRE LAND

No. on plan:
0009, 0013, 0014, 0019, 0022, 0023, 0025, 0025a, 0029, 0036, 0041,
0042, 0045, 0048, 0052, 0053, 0054, 0056, 0059, 0061, 0062, 0069,
0071, 0073, 0076, 0082, 0084, 0096, 0109, 0113, 0115, 0126, 0127,
0128, 0130, 0133, 0136, 0138, 0139, 0141, 0144, 0148, 0149, 0157, 0158,
0162, 0164, 0165, 0170, 0199

POWERS LIMITED TO TEMPORARY USE OF LAND

No. on plan:
0008, 0010, 0011, 0012, 0015, 0016, 0017, 0017a, 0028, 0033, 0058,
0085, 0095, 0110, 0124, 0125, 0150, 0151, 0153, 0154, 0155, 0156, 0159

POWERS LIMITED TO TEMPORARY USE OF LAND AND ACQUISITION OF RIGHTS

No. on plan:
0043, 0046, 0091, 0092, 0104, 0162a, 0162b, 0168

POWERS LIMITED TO ACQUISITION OF RIGHTS

No. on plan:
0033a, 0037

POWERS LIMITED TO EXTINGUISHMENT OF RIGHTS

No. on plan:
None

HIGHWAYS TO BE STOPPED UP PERMANENTLY (WITH POWER TO STOP UP TEMPORARILY DURING CONSTRUCTION OF WORKS)

HIGHWAY TO BE STOPPED UP	NEW HIGHWAY TO BE PROVIDED
Jarvis' Lane Footpath not on the definitive map between points P1 and P2	Footpath between point P3, P4, Work No.4 and point P5
A4421 Charbridge Lane between points P6 and P7	Work No.5
Bicester Road (eastern verge) within order limits	None

HIGHWAYS TO BE STOPPED UP TEMPORARILY

Jarvis' Lane Footpath not on the definitive map between points P2, P1 and P3	
Footpath 129/18/10 between points T1 (on sheet 1) and point P2	
Footpath 129/18/20 between points P2 and T2	
Charbridge Way within Order limits	
A4421 Charbridge Lane within Order limits	
Footpath 272/7/10 within Order limits	
Bicester Road between points T3 and T4	

KEY

- CENTRE LINE OF WORK
- LIMIT OF DEVIATION
- LIMIT OF LAND TO BE ACQUIRED OR USED
- COUNTY / BOROUGH / DISTRICT BOUNDARY
- PARISH BOUNDARY
- COMMENCEMENT OF WORK
- TERMINATION OF WORK
- NEW / IMPROVED ACCESS
- EXISTING OR ALLEGED PUBLIC RIGHT OF WAY
- PUBLIC RIGHT OF WAY OR ALLEGED PUBLIC RIGHT OF WAY TO BE STOPPED UP
- NEW PUBLIC RIGHT OF WAY
- TEMPORARY PUBLIC RIGHT OF WAY DIVERSION
- HS2 ACT LIMITS
- CUT LINE OF A SHEET OR INSET

Note: The area enclosed by any limit of deviation or by any limit of land to be acquired or used is the area extending to the outer edge of the line marking those limits.

OS map data reproduced by permission of Ordnance Survey on behalf of HMSO. © Crown copyright 2015. All rights reserved. Ordnance Survey licence number 0100040692

Alternative Reference
Sheet No. 2
Drawing Number

Revision
A02

133735_2A-EWR-OXD-TWAO-DR-T-000002

Sheet Size A1 594 x 841

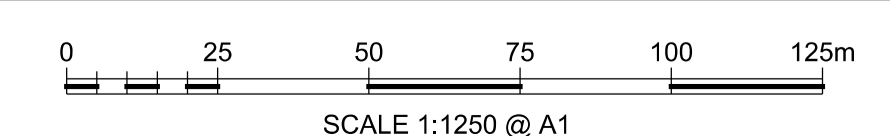
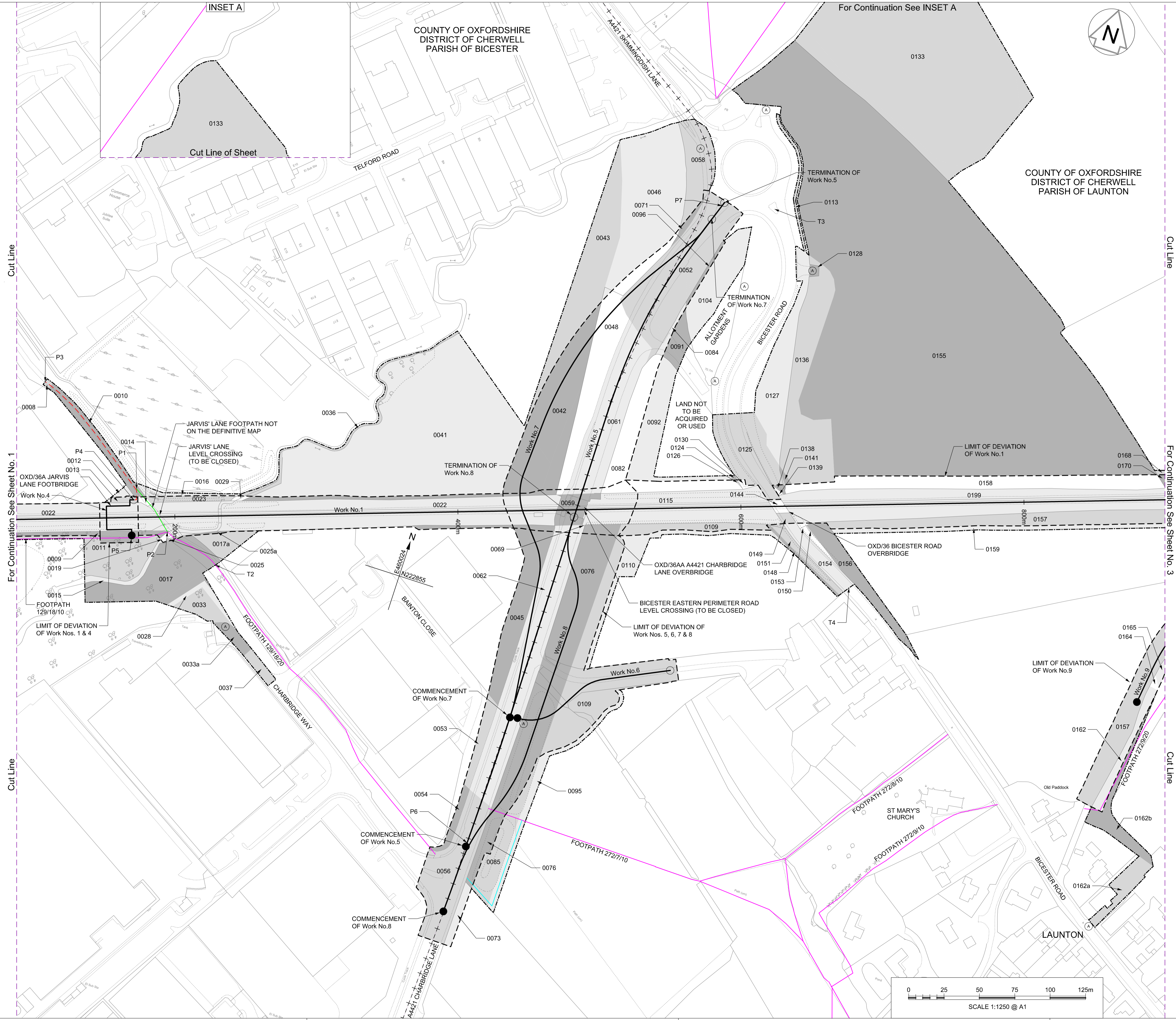

THE NETWORK RAIL
(EAST WEST RAIL BICESTER TO
BEDFORD IMPROVEMENTS)
ORDER

Sheet No. 3 of 136

Work No.1 (RAILWAY)
Work No.9 (ACCESS ROAD)
Work No.10 (FOOTBRIDGE)

UNRESTRICTED POWERS TO ACQUIRE LAND

No. on plan:
0157, 0165, 0166, 0167, 0169, 0170, 0171, 0173, 0177, 0178, 0183,
0185, 0190, 0192, 0196, 0199, 0201

POWERS LIMITED TO TEMPORARY USE OF LAND

No. on plan:
0159, 0182, 0188, 0194, 0195, 0197, 0200, 0203

POWERS LIMITED TO TEMPORARY USE OF LAND
AND ACQUISITION OF RIGHTS

No. on plan:
0168, 0184, 0198, 0198a

POWERS LIMITED TO ACQUISITION OF RIGHTS

No. on plan:
None

POWERS LIMITED TO EXTINGUISHMENT OF RIGHTS

No. on plan:
None

HIGHWAYS TO BE STOPPED UP PERMANENTLY (WITH POWER TO
STOP UP TEMPORARILY DURING CONSTRUCTION OF WORKS)

HIGHWAY TO BE STOPPED UP	NEW HIGHWAY TO BE PROVIDED
Footpath 272/11/10 between points P1 and P4	Footpath between points P1, P2, Work No.10, point P3 and P4
Footpath 272/12/10 between points P5 and P7 (on sheet 4)	Footpath between points P5, P3, Work No.10, points P2 and P8 (on sheet 4)

HIGHWAYS TO BE STOPPED UP TEMPORARILY

Footpath 272/12/10 between points T1, P5 and P7 (on sheet 4)
Footpath 272/11/10 within Order limits

KEY

- CENTRE LINE OF WORK
- - - - - LIMIT OF DEVIATION
- - - - - LIMIT OF LAND TO BE ACQUIRED OR USED
- • • • • COUNTY / BOROUGH / DISTRICT BOUNDARY
- + + + + + PARISH BOUNDARY
- COMMENCEMENT OF WORK
- TERMINATION OF WORK
- ⊙ NEW / IMPROVED ACCESS
- EXISTING OR ALLEGED PUBLIC RIGHT OF WAY
- PUBLIC RIGHT OF WAY OR ALLEGED PUBLIC RIGHT OF WAY TO BE STOPPED UP
- - - - - NEW PUBLIC RIGHT OF WAY
- TEMPORARY PUBLIC RIGHT OF WAY DIVERSION
- - - - - HS2 ACT LIMITS
- - - - - CUT LINE OF A SHEET OR INSET

Note: The area enclosed by any limit of deviation or by any limit of land to be acquired or used is the area extending to the outer edge of the line marking those limits.

OS map data reproduced by permission of Ordnance Survey on behalf of HMSO. © Crown copyright 2015. All rights reserved. Ordnance Survey licence number 0100040692

Alternative Reference
Sheet No. 3
Drawing Number

Revision
A01

133735_2A-EWR-OXD-TWAO-DR-T-000003

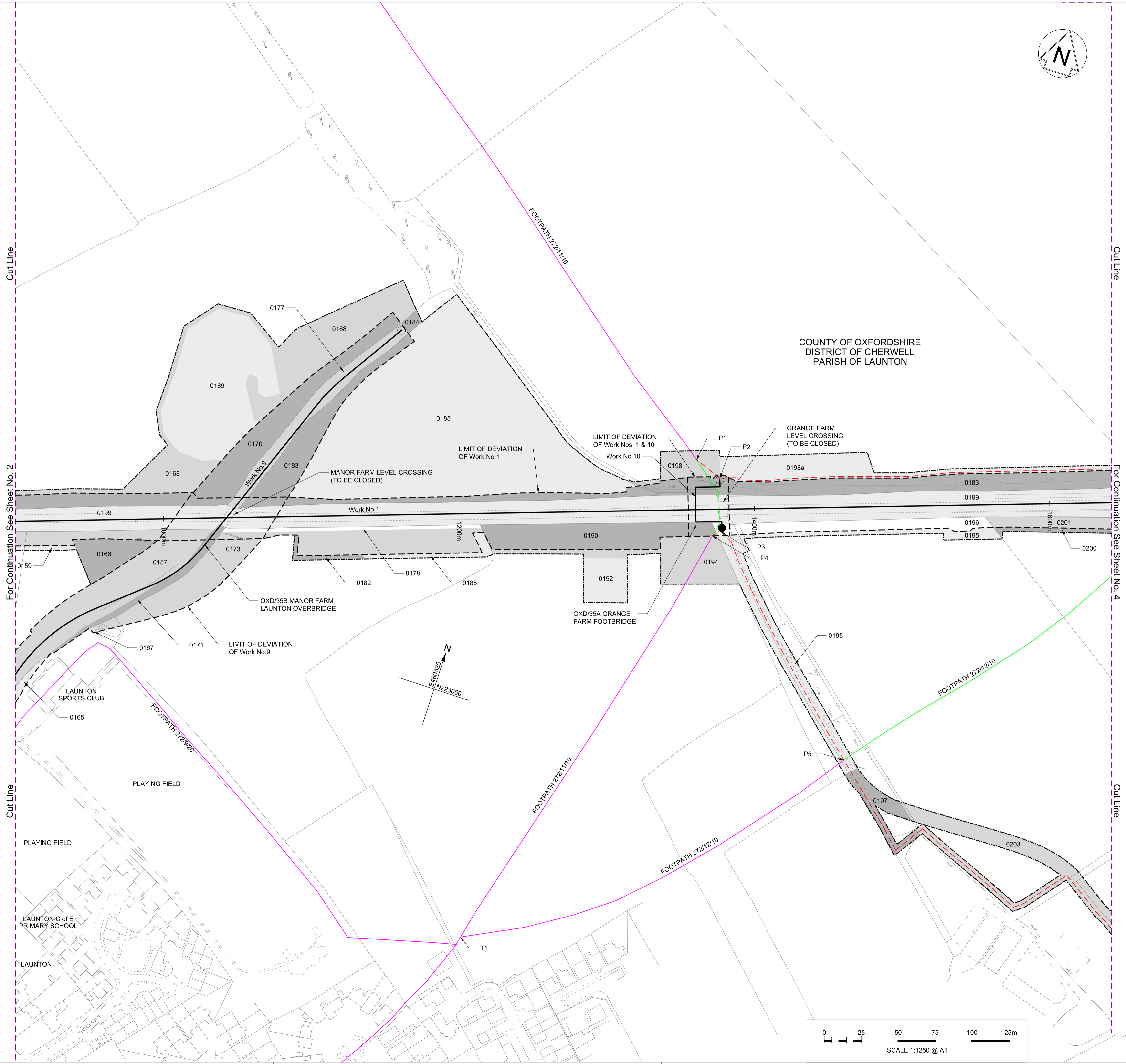
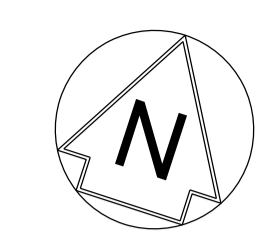

COUNTY OF OXFORDSHIRE
DISTRICT OF CHERWELL
PARISH OF LAUNTON

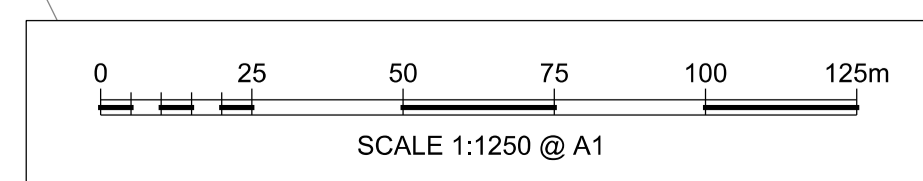
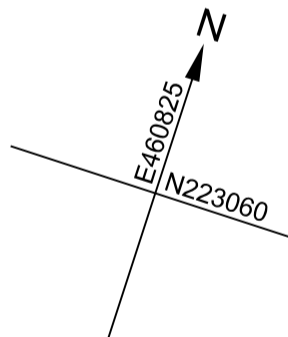

Cut Line

For Continuation See Sheet No. 2

Cut Line

Cut Line

For Continuation See Sheet No. 4

Cut Line

THE NETWORK RAIL
(EAST WEST RAIL BICESTER TO
BEDFORD IMPROVEMENTS)
ORDER

Sheet No. 4 of 136

Work No.1 (RAILWAY)
Work No.11 (ROAD)
Work No.12 (ACCESS ROAD)
Work No.13 (ACCESS ROAD)

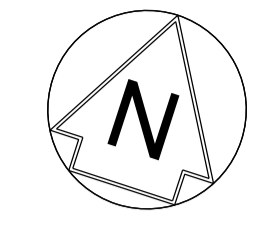

UNRESTRICTED POWERS TO ACQUIRE LAND

No. on plan:
0163, 0199, 0201, 0204, 0205, 0207, 0209, 0210, 0211, 0212, 0213,
0214, 0217, 0218, 0219, 0223, 0224, 0226, 0227, 0228, 0231, 0241,
0242, 0243, 0254, 0269

POWERS LIMITED TO TEMPORARY USE OF LAND

No. on plan:
0200, 0203, 0221, 0234, 0253, 0229, 0235, 0237, 0238, 0240

POWERS LIMITED TO TEMPORARY USE OF LAND
AND ACQUISITION OF RIGHTS

No. on plan: 0198a, 0216

POWERS LIMITED TO ACQUISITION OF RIGHTS

No. on plan:
None

POWERS LIMITED TO EXTINGUISHMENT OF RIGHTS

No. on plan:
None

HIGHWAYS TO BE STOPPED UP PERMANENTLY (WITH POWER TO
STOP UP TEMPORARILY DURING CONSTRUCTION OF WORKS)

HIGHWAY TO BE STOPPED UP	NEW HIGHWAY TO BE PROVIDED
Footpath 272/12/10 between points P5 (on sheet 3) and P7	Footpath between point P11, along Station Road to point P6, point P5 (on sheet 3), P3 (on sheet 3), Work No.10, point P2 (on sheet 3), P8 and P10
Footpath 272/13/10 between points P7 and P8	
Footpath 272/21/10 and path not on definitive map between points P10 and P11	
Footpath 272/20/50 between points P7 and P9	Footpath between points P8, P10 and along Footpath 272/21/10 to point P9
Station Road between points P12 and P13 and between points P14 and P15 (on sheet 5)	Work No. 11

HIGHWAYS TO BE STOPPED UP TEMPORARILY

Footpath 272/13/10 within Order limits

Footpath 272/21/10 within Order limits

Footpath 272/12/10 between points T1 (on sheet 3), P5 (on sheet 3) and P7

Station Road between points T2 and T3 (on sheet 5)

KEY

- CENTRE LINE OF WORK
- - - - - LIMIT OF DEVIATION
- - - - - LIMIT OF LAND TO BE ACQUIRED OR USED
- • • • • COUNTY / BOROUGH / DISTRICT BOUNDARY
- + + + + + PARISH BOUNDARY
- COMMENCEMENT OF WORK
- TERMINATION OF WORK
- Ⓐ NEW / IMPROVED ACCESS
- EXISTING OR ALLEGED PUBLIC RIGHT OF WAY
- PUBLIC RIGHT OF WAY OR ALLEGED PUBLIC RIGHT OF WAY TO BE STOPPED UP
- NEW PUBLIC RIGHT OF WAY
- TEMPORARY PUBLIC RIGHT OF WAY DIVERSION
- - - - - HS2 ACT LIMITS
- - - - - CUT LINE OF A SHEET OR INSET

Note: The area enclosed by any limit of deviation or by any limit of land to be acquired or used is the area extending to the outer edge of the line marking those limits.

OS map data reproduced by permission of Ordnance Survey on behalf of HMSO. © Crown copyright 2015. All rights reserved. Ordnance Survey licence number 0100040692

Alternative Reference Sheet No. 4	Revision A01
Drawing Number 133735_2A-EWR-OXD-TWAO-DR-T-000004	

133735_2A-EWR-OXD-TWAO-DR-T-000004

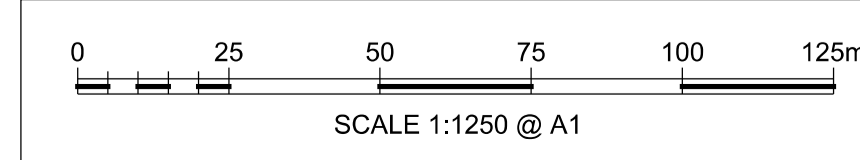
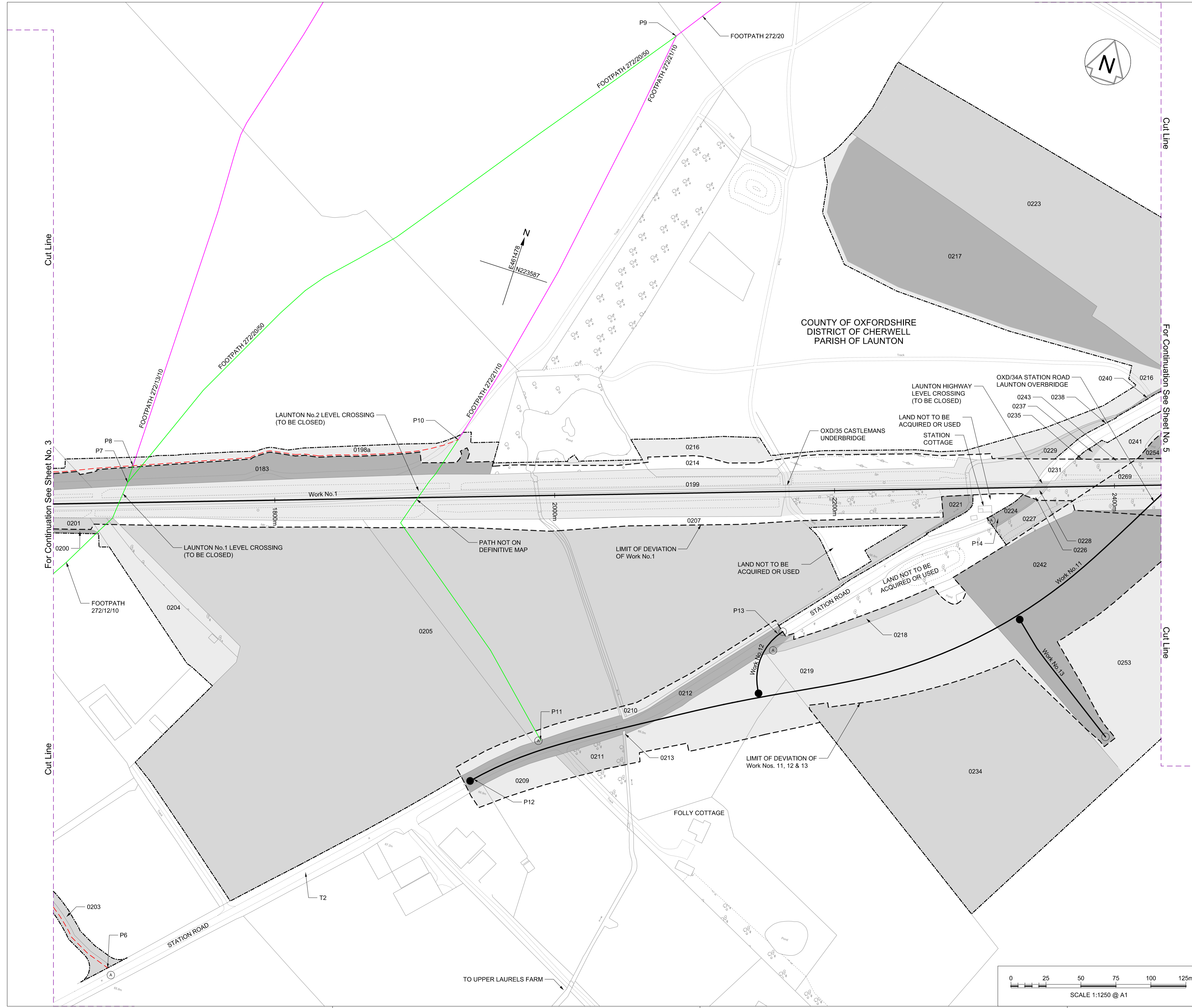

THE NETWORK RAIL
(EAST WEST RAIL BICESTER TO
BEDFORD IMPROVEMENTS)
ORDER

Sheet No. 5 of 136

Work No.1 (RAILWAY)
Work No.11 (ROAD)

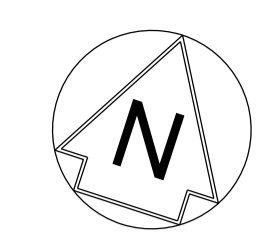

UNRESTRICTED POWERS TO ACQUIRE LAND

No. on plan:
0217, 0223, 0241, 0242, 0243, 0247, 0248, 0249, 0254, 0256, 0258, 0261,
0262, 0284, 0267, 0269, 0270, 0271, 0273, 0274, 0276, 0277, 0281, 0283,
0284, 0286, 0292

POWERS LIMITED TO TEMPORARY USE OF LAND

No. on plan:
0240, 0253, 0263, 0268, 0272, 0275, 0278, 0279, 0280, 0282, 0285, 0289

POWERS LIMITED TO TEMPORARY USE OF LAND
AND ACQUISITION OF RIGHTS

No. on plan:
0216, 0245, 0252, 0255, 0259, 0260

POWERS LIMITED TO ACQUISITION OF RIGHTS

No. on plan:
None

POWERS LIMITED TO EXTINGUISHMENT OF RIGHTS

No. on plan:
None

HIGHWAYS TO BE STOPPED UP PERMANENTLY (WITH POWER TO
STOP UP TEMPORARILY DURING CONSTRUCTION OF WORKS)

HIGHWAY TO BE STOPPED UP	NEW HIGHWAY TO BE PROVIDED
Station Road between points P14 (on sheet 4) and P15	Work No.11

HIGHWAYS TO BE STOPPED UP TEMPORARILY

Station Road between points T2 (on sheet 4) and T3

KEY

- CENTRE LINE OF WORK
- LIMIT OF DEVIATION
- LIMIT OF LAND TO BE ACQUIRED OR USED
- COUNTY / BOROUGH / DISTRICT BOUNDARY
- PARISH BOUNDARY
- COMMENCEMENT OF WORK
- TERMINATION OF WORK
- NEW / IMPROVED ACCESS
- EXISTING OR ALLEGED PUBLIC RIGHT OF WAY
- PUBLIC RIGHT OF WAY OR ALLEGED PUBLIC RIGHT OF WAY TO BE STOPPED UP
- NEW PUBLIC RIGHT OF WAY
- TEMPORARY PUBLIC RIGHT OF WAY DIVERSION
- HS2 ACT LIMITS
- CUT LINE OF A SHEET OR INSET

Note: The area enclosed by any limit of deviation or by any limit of land to be acquired or used is the area extending to the outer edge of the line marking those limits.

OS map data reproduced by permission of Ordnance Survey on behalf of HMSO. © Crown copyright 2015. All rights reserved. Ordnance Survey licence number 0100040692

Alternative Reference
Sheet No. 5
Drawing Number

Revision
A01

133735_2A-EWR-OXD-TWAO-DR-T-000005

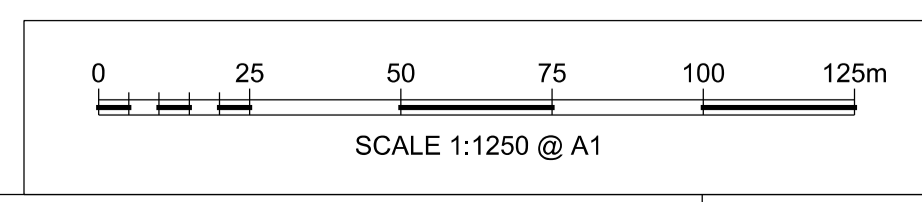
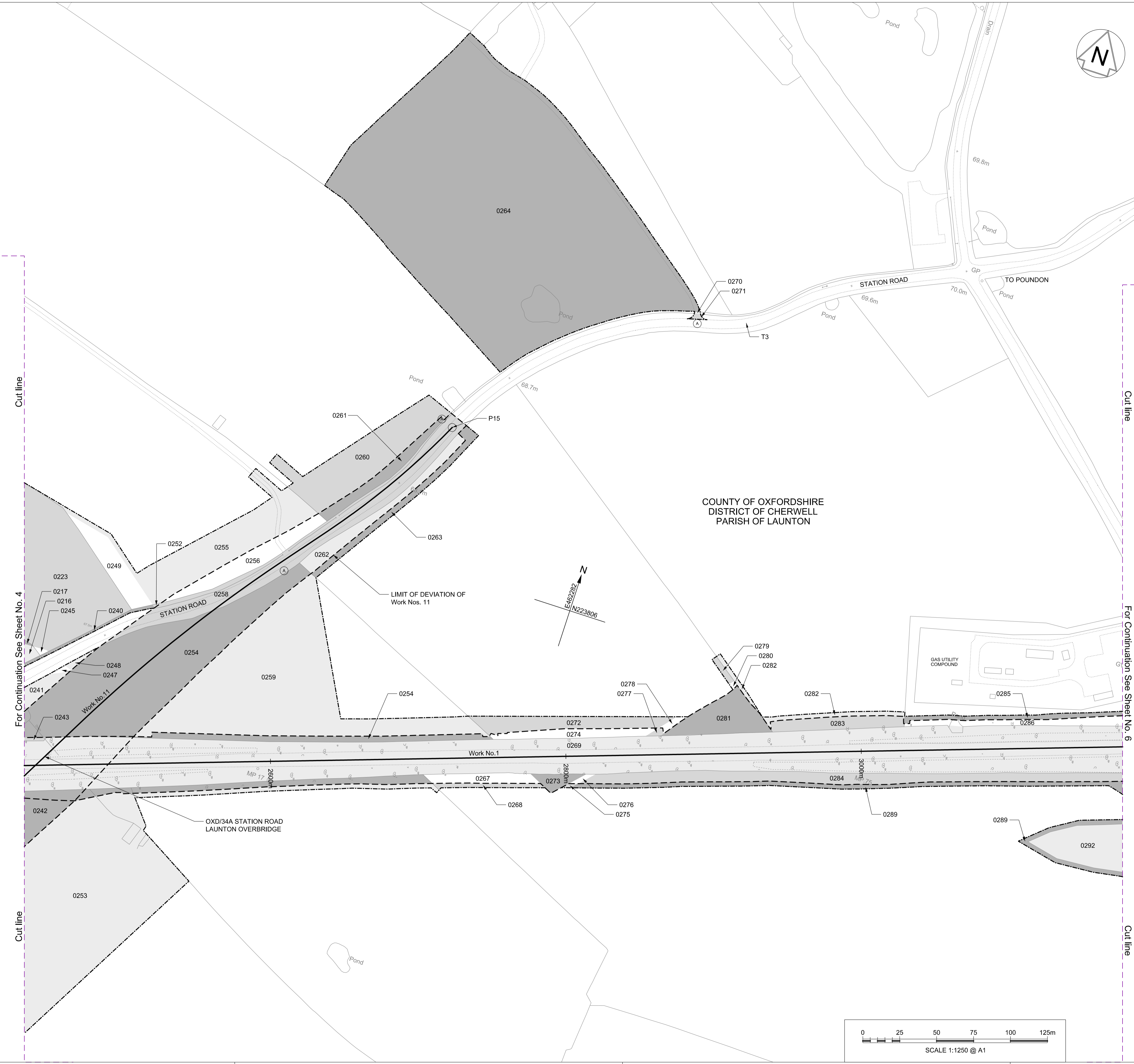

THE NETWORK RAIL
(EAST WEST RAIL BICESTER TO
BEDFORD IMPROVEMENTS)
ORDER

Sheet No. 6 of 136

Work No.1 (RAILWAY)

UNRESTRICTED POWERS TO ACQUIRE LAND

No. on plan:
0269, 0284, 0286, 0292, 0294, 0295, 0296, 0297, 0298, 0300,
0300A, 0302, 0304, 0305, 0306, 0311, 0313, 0314, 0321

POWERS LIMITED TO TEMPORARY USE OF LAND

No. on plan:
0285, 0289, 0293, 0299, 0301, 0303, 0312

POWERS LIMITED TO TEMPORARY USE OF LAND
AND ACQUISITION OF RIGHTS

No. on plan:
None

POWERS LIMITED TO ACQUISITION OF RIGHTS

No. on plan:
None

POWERS LIMITED TO EXTINGUISHMENT OF RIGHTS

No. on plan:
None

HIGHWAYS TO BE STOPPED UP TEMPORARILY

Bicester Road within Order limits

KEY

- CENTRE LINE OF WORK
- - - - - LIMIT OF DEVIATION
- - - - - LIMIT OF LAND TO BE ACQUIRED OR USED
- • • • • COUNTY / BOROUGH / DISTRICT BOUNDARY
- + + + + + PARISH BOUNDARY
- COMMENCEMENT OF WORK
- TERMINATION OF WORK
- Ⓐ NEW / IMPROVED ACCESS
- EXISTING OR ALLEGED PUBLIC RIGHT OF WAY
- PUBLIC RIGHT OF WAY OR ALLEGED PUBLIC RIGHT OF WAY TO BE STOPPED UP
- NEW PUBLIC RIGHT OF WAY
- TEMPORARY PUBLIC RIGHT OF WAY DIVERSION
- HS2 ACT LIMITS
- - - - - CUT LINE OF A SHEET OR INSET

Note: The area enclosed by any limit of deviation or by any limit of land to be acquired or used is the area extending to the outer edge of the line marking those limits.

OS map data reproduced by permission of Ordnance Survey on behalf of HMSO. © Crown copyright 2015. All rights reserved. Ordnance Survey licence number 0100040692

Alternative Reference Sheet No. 6	Revision A01
Drawing Number 133735_2A-EWR-OXD-TWAO-DR-T-000006	

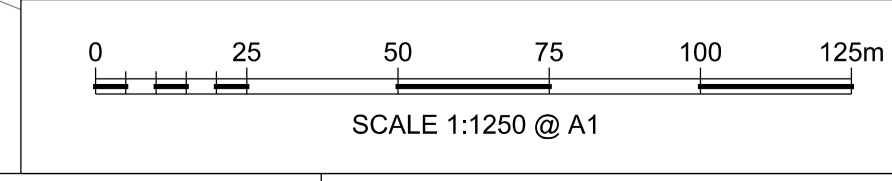
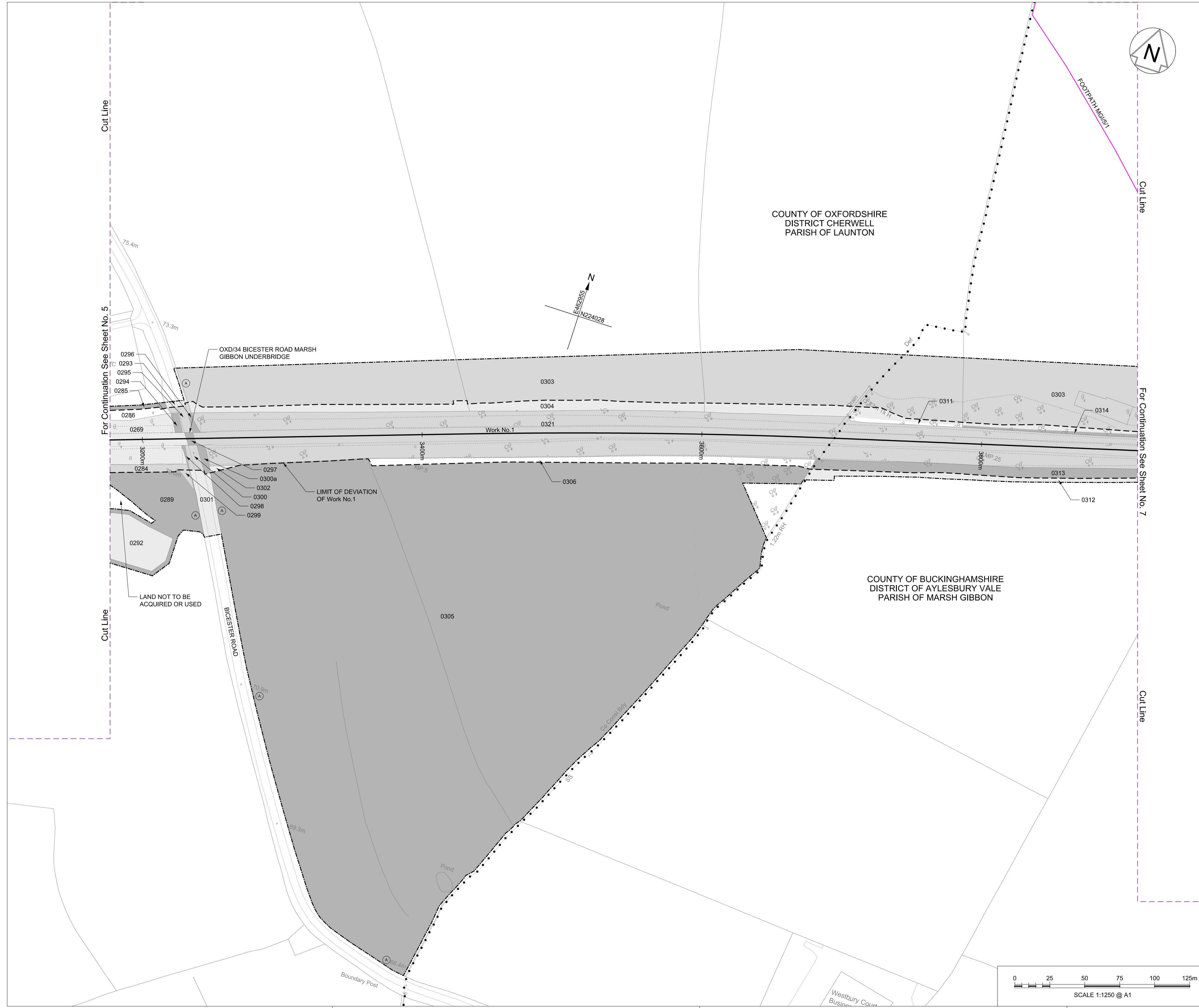

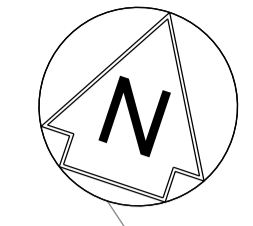

UNRESTRICTED POWERS TO ACQUIRE LAND

No. on plan:
None

POWERS LIMITED TO TEMPORARY USE OF LAND

No. on plan:
0375a

POWERS LIMITED TO TEMPORARY USE OF LAND AND ACQUISITION OF RIGHTS

No. on plan:
None

POWERS LIMITED TO ACQUISITION OF RIGHTS

No. on plan:
None

POWERS LIMITED TO EXTINGUISHMENT OF RIGHTS

No. on plan:
None

HIGHWAYS TO BE STOPPED UP TEMPORARILY

Fringford Footpath 9 between points T5 and T6

A4221 Roman Road between points T1, T2 and T3

Unnamed Road (between A4421 Roman Road and Mill Road) between points T2 and T4 (on sheet 72)

KEY

- CENTRE LINE OF WORK
- - - - - LIMIT OF DEVIATION
- - - - - LIMIT OF LAND TO BE ACQUIRED OR USED
- • • • • COUNTY / BOROUGH / DISTRICT BOUNDARY
- + + + + + PARISH BOUNDARY
- COMMENCEMENT OF WORK
- TERMINATION OF WORK
- Ⓐ NEW / IMPROVED ACCESS
- EXISTING OR ALLEGED PUBLIC RIGHT OF WAY
- PUBLIC RIGHT OF WAY OR ALLEGED PUBLIC RIGHT OF WAY TO BE STOPPED UP
- - - - - NEW PUBLIC RIGHT OF WAY
- TEMPORARY PUBLIC RIGHT OF WAY DIVERSION
- [] HS2 ACT LIMITS
- - - - - CUT LINE OF A SHEET OR INSET

Note: The area enclosed by any limit of deviation or by any limit of land to be acquired or used is the area extending to the outer edge of the line marking those limits.

OS map data reproduced by permission of Ordnance Survey on behalf of HMSO. © Crown copyright 2015. All rights reserved. Ordnance Survey licence number 0100040692

Alternative Reference Sheet No. 71	Revision A01
Drawing Number 133735_RW-EWR-XX-TWAO-DR-T-000071	

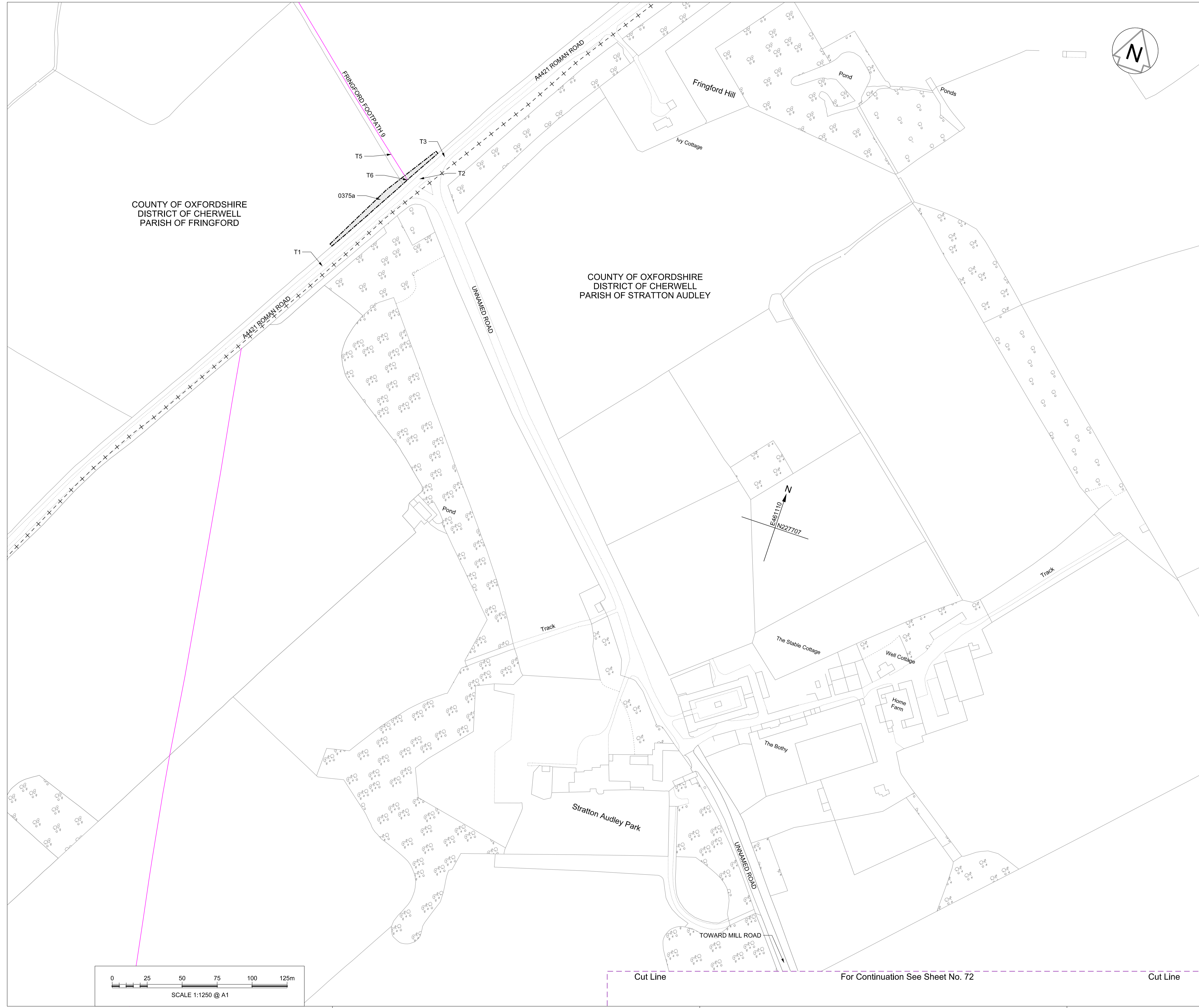

COUNTY OF OXFORDSHIRE
DISTRICT OF CHERWELL
PARISH OF FRINGFORD

COUNTY OF OXFORDSHIRE
DISTRICT OF CHERWELL
PARISH OF STRATTON AUDLEY

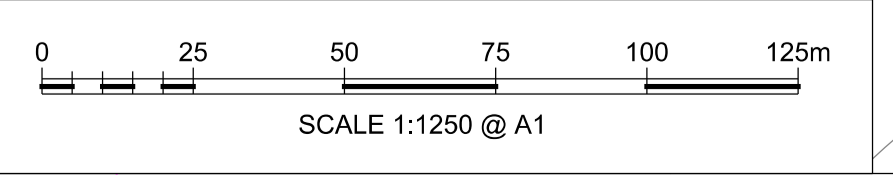

Cut Line For Continuation See Sheet No. 72 Cut Line

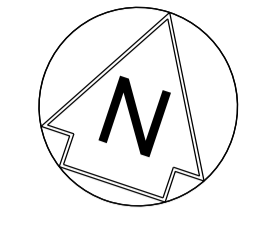

UNRESTRICTED POWERS TO ACQUIRE LAND

No. on plan:
None

POWERS LIMITED TO TEMPORARY USE OF LAND

No. on plan:
0375b, 0375c

POWERS LIMITED TO TEMPORARY USE OF LAND AND ACQUISITION OF RIGHTS

No. on plan:
None

POWERS LIMITED TO ACQUISITION OF RIGHTS

No. on plan:
None

POWERS LIMITED TO EXTINGUISHMENT OF RIGHTS

No. on plan:
None

COUNTY OF OXFORDSHIRE
DISTRICT OF CHERWELL
PARISH OF STRATTON AUDLEY

HIGHWAYS TO BE STOPPED UP TEMPORARILY

Unnamed Road (between A4421 Roman Road and Mill Road) between points T2 (on sheet 71) and T4

Mill Road between points T5 and T4

Unnamed Road (between Mill Road and Main Street) between points T4 and T5 (on sheet 76)

KEY

- CENTRE LINE OF WORK
- - - - - LIMIT OF DEVIATION
- - - - - LIMIT OF LAND TO BE ACQUIRED OR USED
- • • • • COUNTY / BOROUGH / DISTRICT BOUNDARY
- + + + + + PARISH BOUNDARY
- COMMENCEMENT OF WORK
- TERMINATION OF WORK
- Ⓐ NEW / IMPROVED ACCESS
- EXISTING OR ALLEGED PUBLIC RIGHT OF WAY
- PUBLIC RIGHT OF WAY OR ALLEGED PUBLIC RIGHT OF WAY TO BE STOPPED UP
- NEW PUBLIC RIGHT OF WAY
- TEMPORARY PUBLIC RIGHT OF WAY DIVERSION
- HS2 ACT LIMITS
- - - - - CUT LINE OF A SHEET OR INSET

Note: The area enclosed by any limit of deviation or by any limit of land to be acquired or used is the area extending to the outer edge of the line marking those limits.

OS map data reproduced by permission of Ordnance Survey on behalf of HMSO. © Crown copyright 2015. All rights reserved. Ordnance Survey licence number 0100040692

Alternative Reference Sheet No. 72	Revision A01
Drawing Number 133735_RW-EWR-XX-TWAO-DR-T-000072	

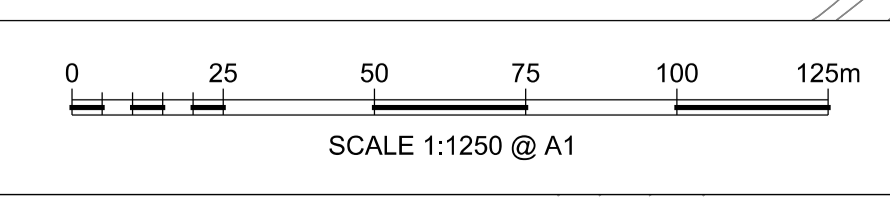
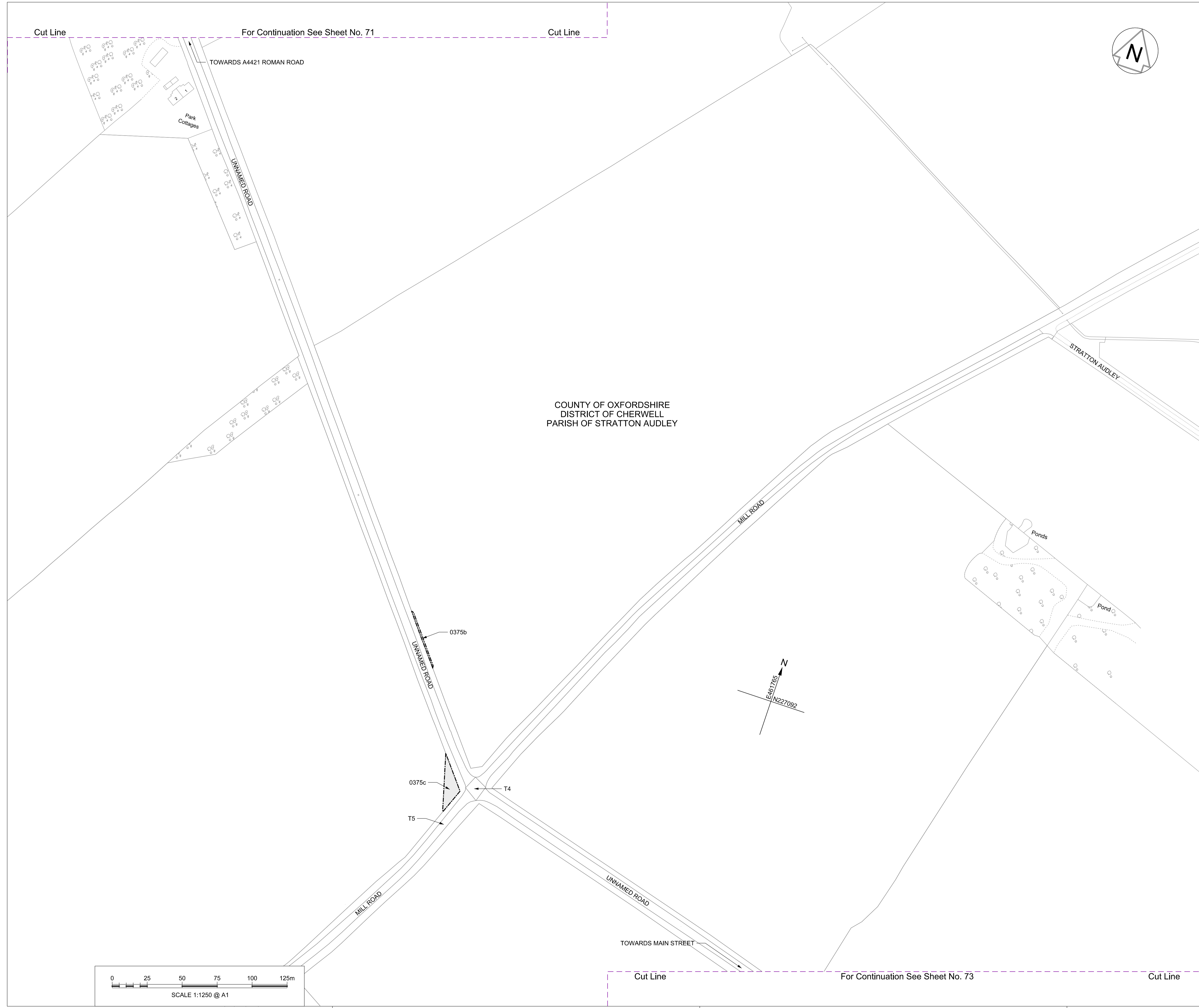

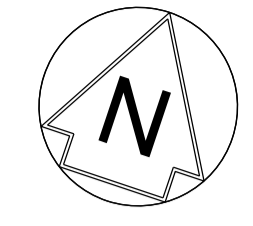

UNRESTRICTED POWERS TO ACQUIRE LAND

No. on plan:
None

POWERS LIMITED TO TEMPORARY USE OF LAND

No. on plan:
None

POWERS LIMITED TO TEMPORARY USE OF LAND AND ACQUISITION OF RIGHTS

No. on plan:
None

POWERS LIMITED TO ACQUISITION OF RIGHTS

No. on plan:
None

POWERS LIMITED TO EXTINGUISHMENT OF RIGHTS

No. on plan:
None

COUNTY OF OXFORDSHIRE
DISTRICT OF CHERWELL
PARISH OF STRATTON AUDLEY

COUNTY OF OXFORDSHIRE
DISTRICT OF CHERWELL
PARISH OF GODINGTON

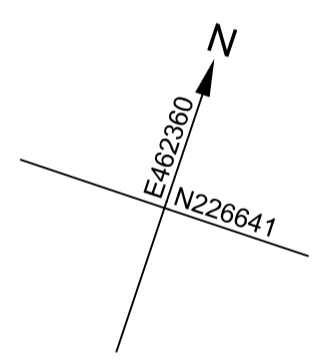

HIGHWAYS TO BE STOPPED UP TEMPORARILY

Unnamed Road (between Mill Road and Main Street) between points T4 (on sheet 72) and T5 (on sheet 76)

KEY

- CENTRE LINE OF WORK
- - - - - LIMIT OF DEVIATION
- - - - - LIMIT OF LAND TO BE ACQUIRED OR USED
- • • • • COUNTY / BOROUGH / DISTRICT BOUNDARY
- + + + + + PARISH BOUNDARY
- COMMENCEMENT OF WORK
- TERMINATION OF WORK
- Ⓐ NEW / IMPROVED ACCESS
- — — — — EXISTING OR ALLEGED PUBLIC RIGHT OF WAY
- — — — — PUBLIC RIGHT OF WAY OR ALLEGED PUBLIC RIGHT OF WAY TO BE STOPPED UP
- - - - - NEW PUBLIC RIGHT OF WAY
- — — — — TEMPORARY PUBLIC RIGHT OF WAY DIVERSION
- — — — — HS2 ACT LIMITS
- - - - - CUT LINE OF A SHEET OR INSET

Note: The area enclosed by any limit of deviation or by any limit of land to be acquired or used is the area extending to the outer edge of the line marking those limits.

OS map data reproduced by permission of Ordnance Survey on behalf of HMSO. © Crown copyright 2015. All rights reserved. Ordnance Survey licence number 0100040692

Alternative Reference Sheet No. 73	Revision A01
Drawing Number 133735_RW-EWR-XX-TWAO-DR-T-000073	

Cut Line For Continuation See Sheet No. 72 Cut Line

TOWARDS MILL ROAD

UNNAMED ROAD

TOWARDS MAIN STREET

For Continuation See Sheet No. 74

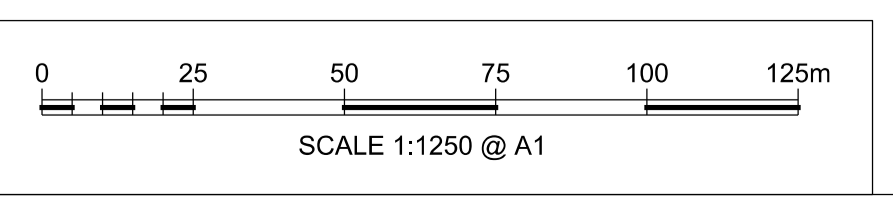

UNRESTRICTED POWERS TO ACQUIRE LAND

No. on plan:
None

POWERS LIMITED TO TEMPORARY USE OF LAND

No. on plan:
None

**POWERS LIMITED TO TEMPORARY USE OF LAND
AND ACQUISITION OF RIGHTS**

No. on plan:
None

POWERS LIMITED TO ACQUISITION OF RIGHTS

No. on plan:
None

POWERS LIMITED TO EXTINGUISHMENT OF RIGHTS

No. on plan:
None

HIGHWAYS TO BE STOPPED UP TEMPORARILY

Unnamed Road (between Mill Road and Main Street) between points T4 (on sheet 72) and T5 (on sheet 76)

KEY

- CENTRE LINE OF WORK
- - - - - LIMIT OF DEVIATION
- - - - - LIMIT OF LAND TO BE ACQUIRED OR USED
- • • • • COUNTY / BOROUGH / DISTRICT BOUNDARY
- + + + + - PARISH BOUNDARY
- COMMENCEMENT OF WORK
- TERMINATION OF WORK
- Ⓐ NEW / IMPROVED ACCESS
- EXISTING OR ALLEGED PUBLIC RIGHT OF WAY
- PUBLIC RIGHT OF WAY OR ALLEGED PUBLIC RIGHT OF WAY TO BE STOPPED UP
- - - - - NEW PUBLIC RIGHT OF WAY
- TEMPORARY PUBLIC RIGHT OF WAY DIVERSION
- HS2 ACT LIMITS
- - - - - CUT LINE OF A SHEET OR INSET

Note: The area enclosed by any limit of deviation or by any limit of land to be acquired or used is the area extending to the outer edge of the line marking those limits.

OS map data reproduced by permission of Ordnance Survey on behalf of HMSO. © Crown copyright 2015. All rights reserved. Ordnance Survey licence number 0100040692

Alternative Reference Sheet No. 74	Revision A01
Drawing Number 133735_RW-EWR-XX-TWAO-DR-T-000074	

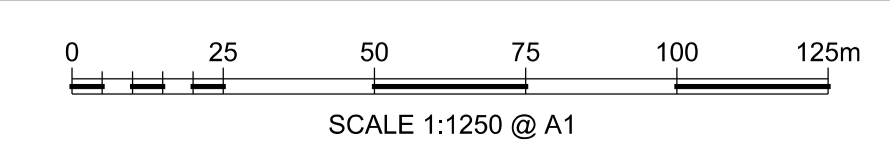
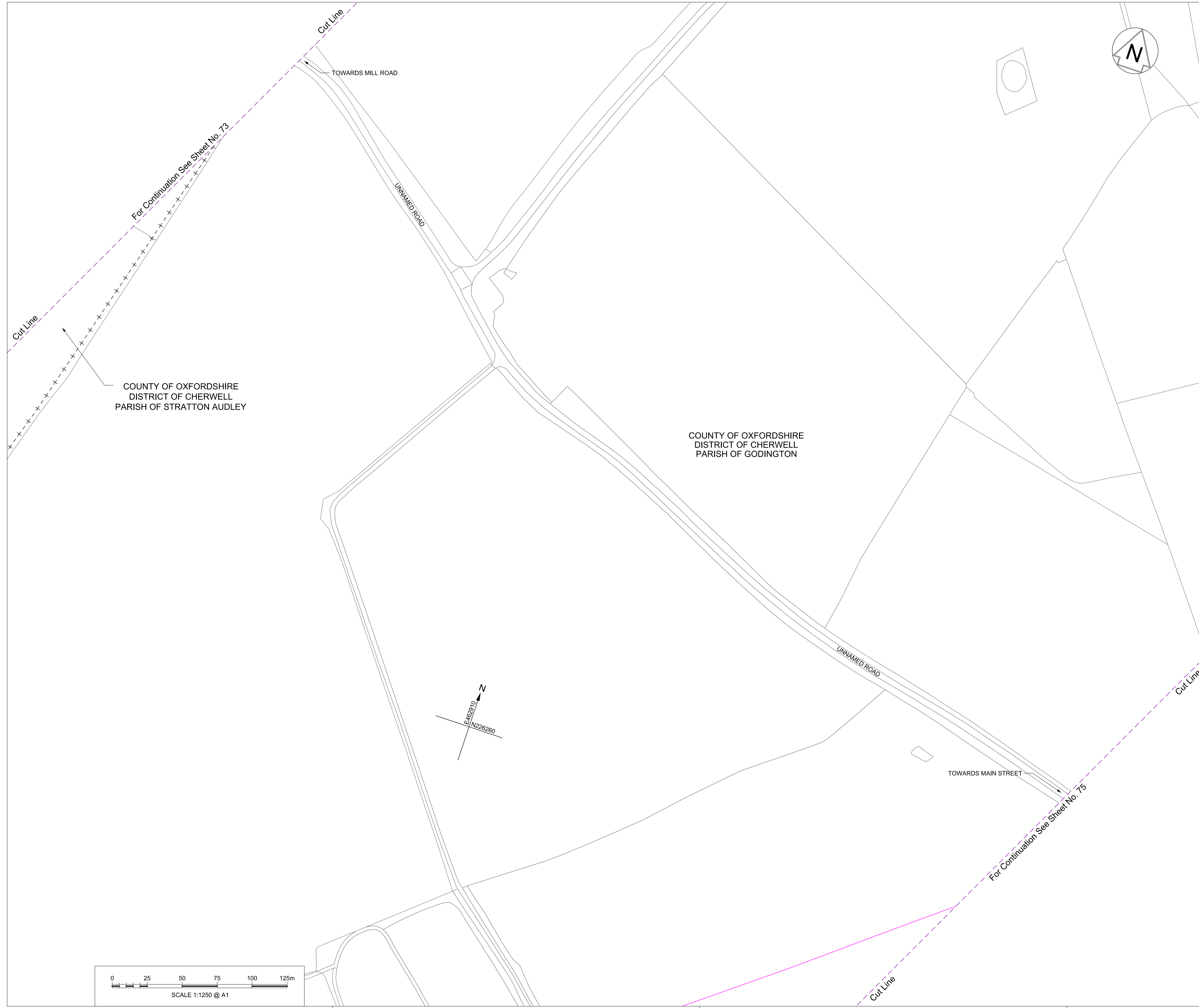

Cut Line For Continuation See Sheet No. 75 Cut Line

TOWARDS MILL ROAD

UNNAMED ROAD

COUNTY OF BUCKINGHAMSHIRE
DISTRICT OF AYLESBURY VALE
PARISH OF POUNDON

UNNAMED ROAD

N
E148573
N225609

TOWARDS MAIN STREET

For Continuation See Sheet No. 10

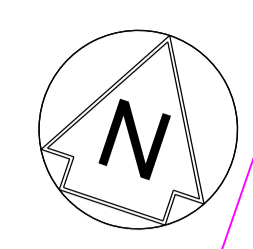

THE NETWORK RAIL
(EAST WEST RAIL BICESTER TO
BEDFORD IMPROVEMENTS)
ORDER
Sheet No. 76 of 136

UNRESTRICTED POWERS TO ACQUIRE LAND

No. on plan:
None

POWERS LIMITED TO TEMPORARY USE OF LAND

No. on plan:
None

**POWERS LIMITED TO TEMPORARY USE OF LAND
AND ACQUISITION OF RIGHTS**

No. on plan:
None

POWERS LIMITED TO ACQUISITION OF RIGHTS

No. on plan:
None

POWERS LIMITED TO EXTINGUISHMENT OF RIGHTS

No. on plan:
None

HIGHWAYS TO BE STOPPED UP TEMPORARILY

Unnamed Road (between Mill Road and Main Street) between points T4 (on sheet 72) and T5

KEY

- CENTRE LINE OF WORK
- - - - - LIMIT OF DEVIATION
- - - - - LIMIT OF LAND TO BE ACQUIRED OR USED
- COUNTY / BOROUGH / DISTRICT BOUNDARY
- + - + - + - PARISH BOUNDARY
- COMMENCEMENT OF WORK
- TERMINATION OF WORK
- Ⓐ NEW / IMPROVED ACCESS
- EXISTING OR ALLEGED PUBLIC RIGHT OF WAY
- PUBLIC RIGHT OF WAY OR ALLEGED PUBLIC RIGHT OF WAY TO BE STOPPED UP
- - - - - NEW PUBLIC RIGHT OF WAY
- TEMPORARY PUBLIC RIGHT OF WAY DIVERSION
- - - - - HS2 ACT LIMITS
- - - - - CUT LINE OF A SHEET OR INSET

Note: The area enclosed by any limit of deviation or by any limit of land to be acquired or used is the area extending to the outer edge of the line marking those limits.

OS map data reproduced by permission of Ordnance Survey on behalf of HMSO. © Crown copyright 2015. All rights reserved. Ordnance Survey licence number 0100040692

Alternative Reference Sheet No. 76	Revision A01
--	------------------------

Drawing Number
133735_RW-EWR-XX-TWAO-DR-T-000076

