



Oxfordshire

Published 1885 - 1886

Source map scale - 1:10,560

The historical maps shown were reproduced from maps predominantly held at the scale adopted for England, Wales and Scotland in the 1840's. In 1854 the 1:2,500 scale was adopted for mapping urban areas; these maps were used to update the 1:10,560 maps. The published date given therefore is often some years later than the surveyed date. Before 1938, all OS maps were based on the Cassini Projection, with independent surveys of a single county or group of counties, giving rise to significant inaccuracies in outlying areas. In the late 1940's, a Provisional Edition was produced, which updated the 1:10,560 mapping from a number of sources. The maps appear unfinished - with all military camps and other strategic sites removed. These maps were initially overprinted with the National Grid. In 1970, the first 1:10,000 maps were produced using the Transverse Mercator Projection. The revision process continued until recently, with new editions appearing every 10 years or so for urban areas.

Map Name(s) and Date(s)

00600	1885	1:10,560
01000	1886	1:10,560

Historical Map - Slice A

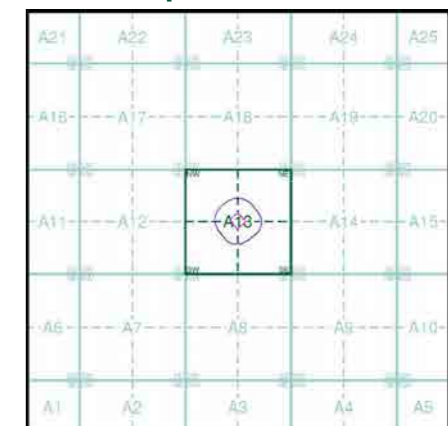

Order Details

Order Number: 183076277_1_1
 Customer Ref: JER1600
 National Grid Reference: 446820, 237490
 Slice: A
 Site Area (Ha): 0.53
 Search Buffer (m): 1000

Site Details

Cotefield Farm, Oxford Road, Bodicote, BANBURY



Tel: 0844 844 9952
 Fax: 0844 844 9951
 Web: www.envirocheck.co.uk

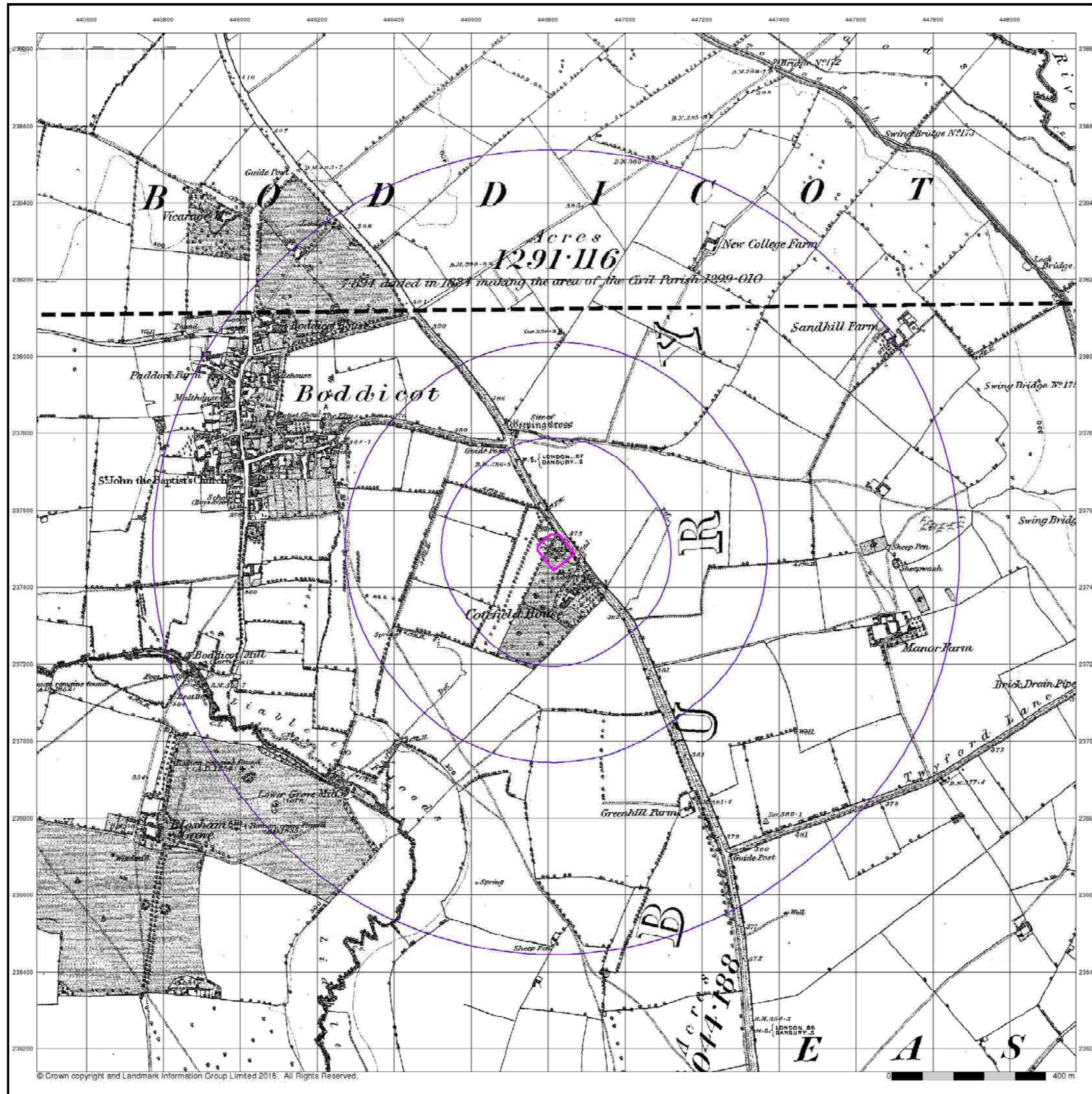



Oxfordshire

Published 1900

Source map scale - 1:10,560

The historical maps shown were reproduced from maps predominantly held at the scale adopted for England, Wales and Scotland in the 1840's. In 1854 the 1:2,500 scale was adopted for mapping urban areas; these maps were used to update the 1:10,560 maps. The published date given therefore is often some years later than the surveyed date. Before 1938, all OS maps were based on the Cassini Projection, with independent surveys of a single county or group of counties, giving rise to significant inaccuracies in outlying areas. In the late 1940's, a Provisional Edition was produced, which updated the 1:10,560 mapping from a number of sources. The maps appear unfinished - with all military camps and other strategic sites removed. These maps were initially overprinted with the National Grid. In 1970, the first 1:10,000 maps were produced using the Transverse Mercator Projection. The revision process continued until recently, with new editions appearing every 10 years or so for urban areas.

Map Name(s) and Date(s)

006SW	1900	1:10,560
010NW	1900	1:10,560

Historical Map - Slice A

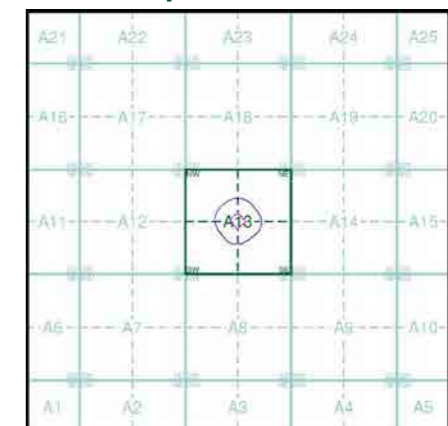

Order Details

Order Number: 183076277_1_1
 Customer Ref: JER1600
 National Grid Reference: 446820, 237490
 Slice: A
 Site Area (Ha): 0.53
 Search Buffer (m): 1000

Site Details

Cotefield Farm, Oxford Road, Bodicote, BANBURY



Tel: 0844 844 9952
 Fax: 0844 844 9951
 Web: www.envirocheck.co.uk

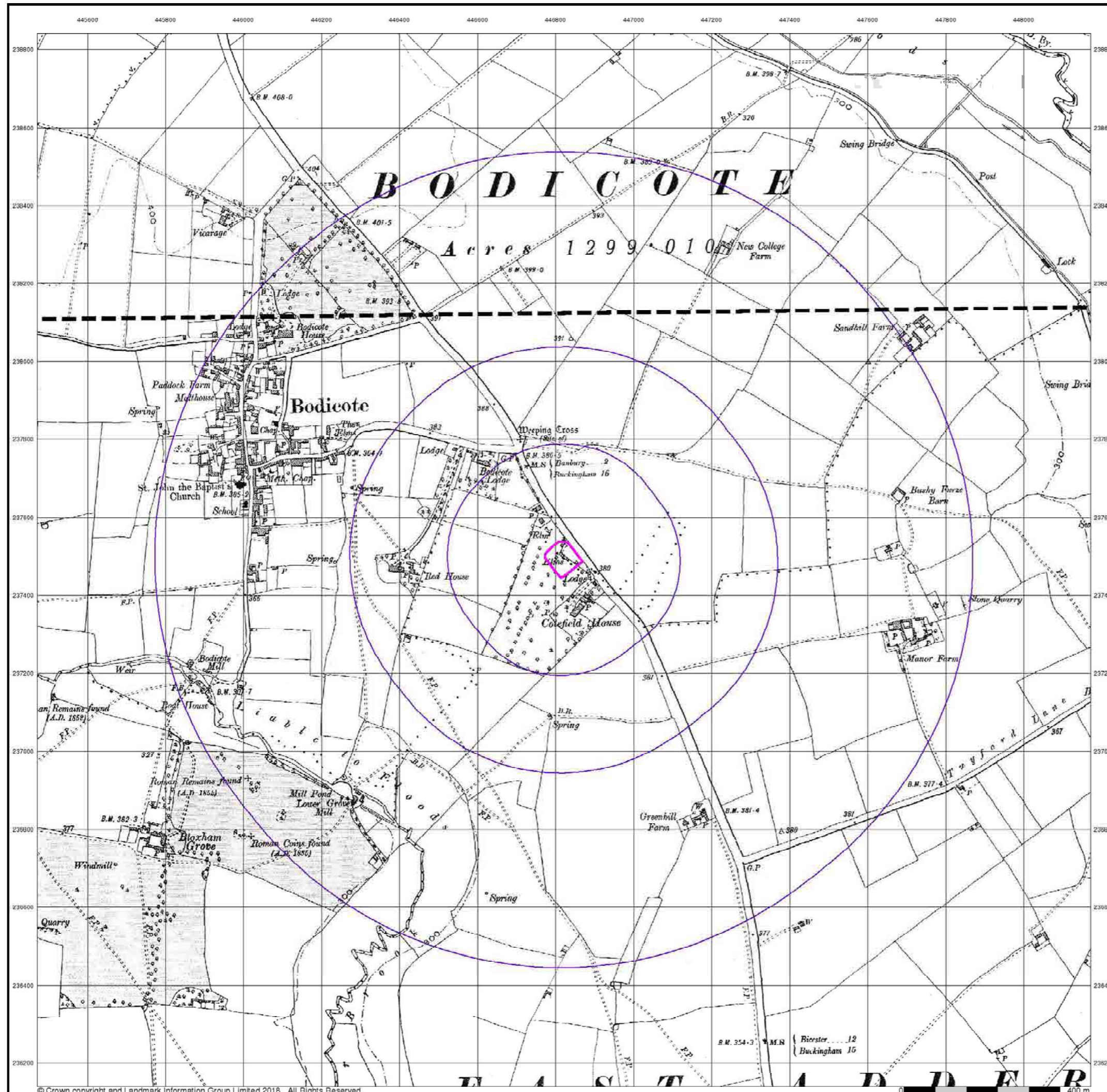



Northamptonshire

Published 1923

Source map scale - 1:10,560

The historical maps shown were reproduced from maps predominantly held at the scale adopted for England, Wales and Scotland in the 1840's. In 1854 the 1:2,500 scale was adopted for mapping urban areas; these maps were used to update the 1:10,560 maps. The published date given therefore is often some years later than the surveyed date. Before 1938, all OS maps were based on the Cassini Projection, with independent surveys of a single county or group of counties, giving rise to significant inaccuracies in outlying areas. In the late 1940's, a Provisional Edition was produced, which updated the 1:10,560 mapping from a number of sources. The maps appear unfinished - with all military camps and other strategic sites removed. These maps were initially overprinted with the National Grid. In 1970, the first 1:10,000 maps were produced using the Transverse Mercator Projection. The revision process continued until recently, with new editions appearing every 10 years or so for urban areas.

Map Name(s) and Date(s)

058SW	1923	1:10,560
062NW	1923	1:10,560

Historical Map - Slice A

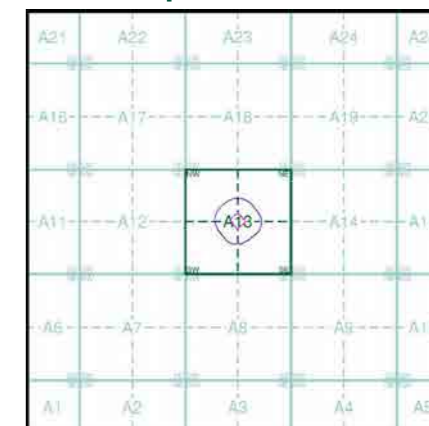

Order Details

Order Number: 183076277_1_1
 Customer Ref: JER1600
 National Grid Reference: 446820, 237490
 Slice: A
 Site Area (Ha): 0.53
 Search Buffer (m): 1000

Site Details

Cotefield Farm, Oxford Road, Bodicote, BANBURY



Tel: 0844 844 9952
 Fax: 0844 844 9951
 Web: www.envirocheck.co.uk

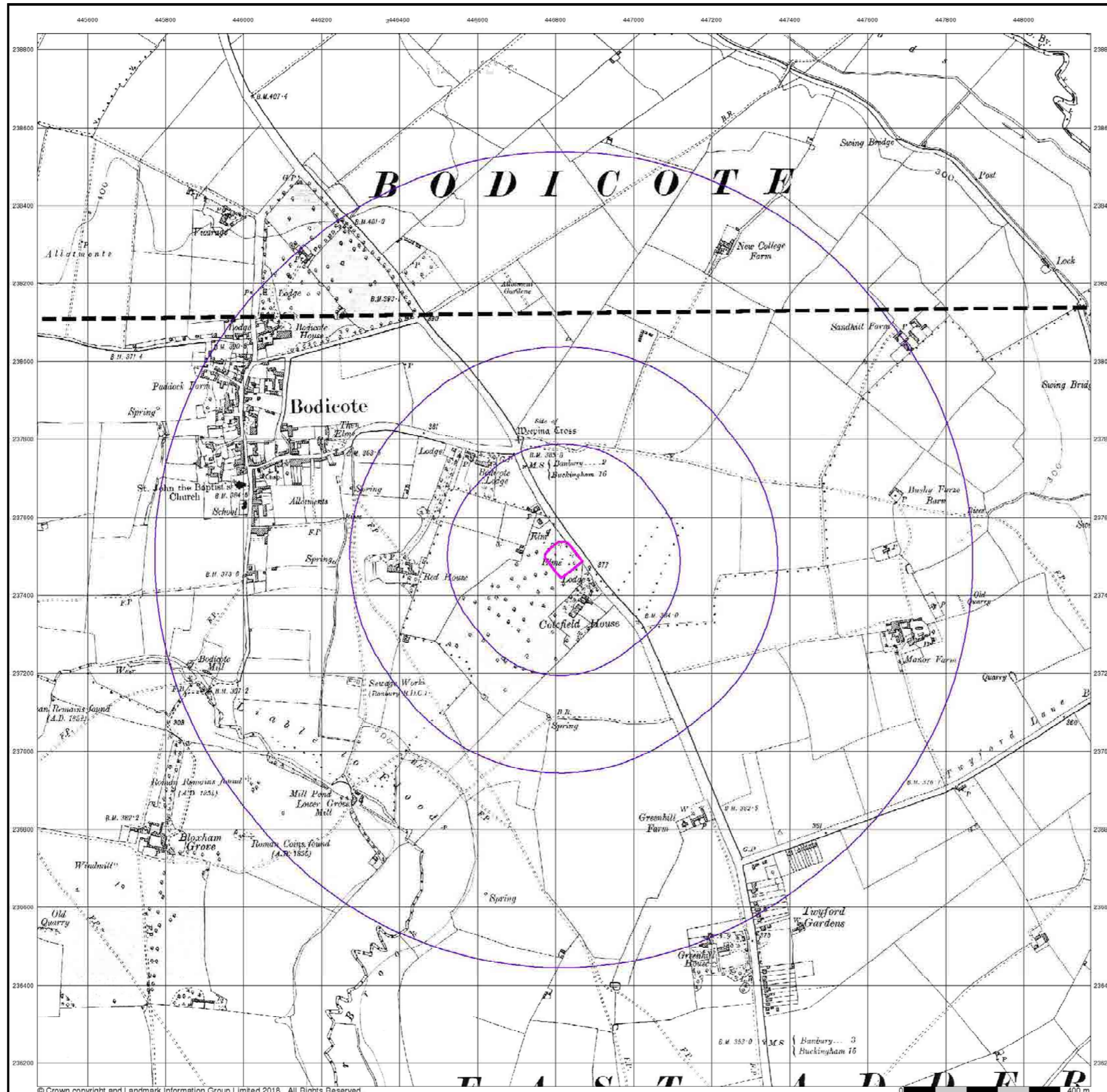



Ordnance Survey Plan

Published 1955

Source map scale - 1:10,000

The historical maps shown were reproduced from maps predominantly held at the scale adopted for England, Wales and Scotland in the 1840's. In 1854 the 1:2,500 scale was adopted for mapping urban areas; these maps were used to update the 1:10,560 maps. The published date given therefore is often some years later than the surveyed date. Before 1938, all OS maps were based on the Cassini Projection, with independent surveys of a single county or group of counties, giving rise to significant inaccuracies in outlying areas. In the late 1940's, a Provisional Edition was produced, which updated the 1:10,560 mapping from a number of sources. The maps appear unfinished - with all military camps and other strategic sites removed. These maps were initially overprinted with the National Grid. In 1970, the first 1:10,000 maps were produced using the Transverse Mercator Projection. The revision process continued until recently, with new editions appearing every 10 years or so for urban areas.

Map Name(s) and Date(s)

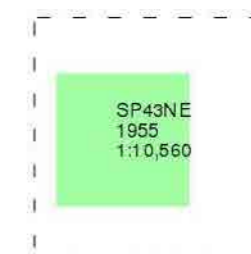

Historical Map - Slice A

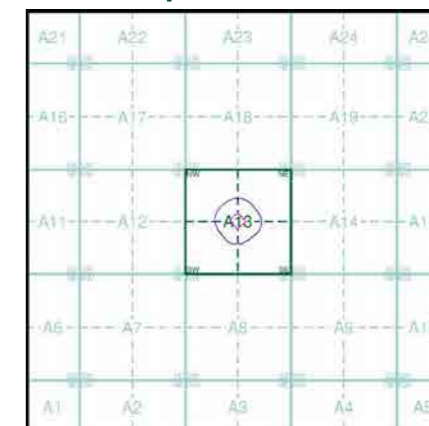

Order Details

Order Number: 183076277_1_1
Customer Ref: JER1600
National Grid Reference: 446820, 237490
Slice: A
Site Area (Ha): 0.53
Search Buffer (m): 1000

Site Details

Cotefield Farm, Oxford Road, Bodicote, BANBURY



Tel: 0844 844 9952
Fax: 0844 844 9951
Web: www.envirocheck.co.uk

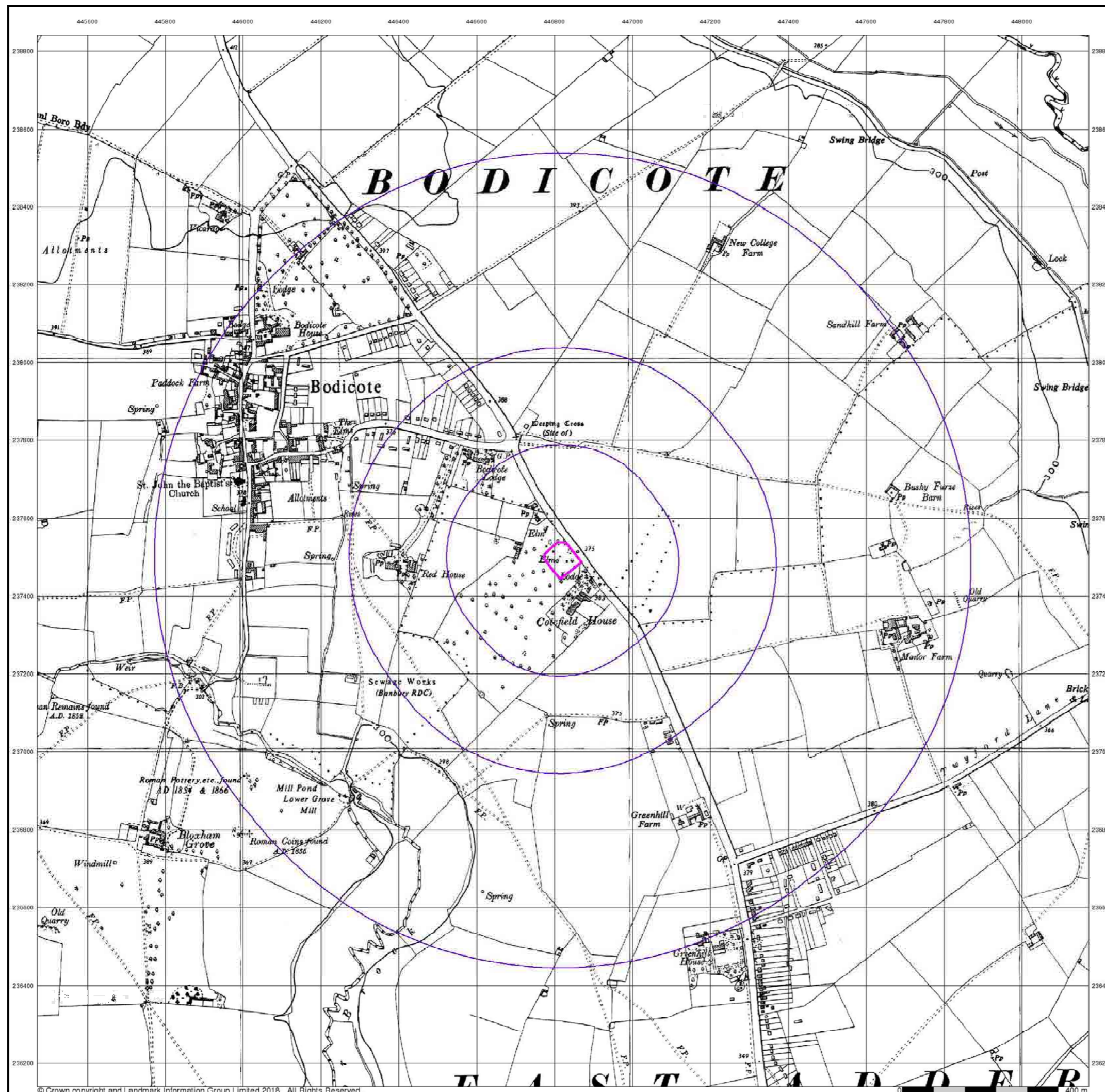



Ordnance Survey Plan

Published 1977

Source map scale - 1:10,000

The historical maps shown were reproduced from maps predominantly held at the scale adopted for England, Wales and Scotland in the 1840's. In 1854 the 1:2,500 scale was adopted for mapping urban areas; these maps were used to update the 1:10,560 maps. The published date given therefore is often some years later than the surveyed date. Before 1938, all OS maps were based on the Cassini Projection, with independent surveys of a single county or group of counties, giving rise to significant inaccuracies in outlying areas. In the late 1940's, a Provisional Edition was produced, which updated the 1:10,560 mapping from a number of sources. The maps appear unfinished - with all military camps and other strategic sites removed. These maps were initially overprinted with the National Grid. In 1970, the first 1:10,000 maps were produced using the Transverse Mercator Projection. The revision process continued until recently, with new editions appearing every 10 years or so for urban areas.

Map Name(s) and Date(s)

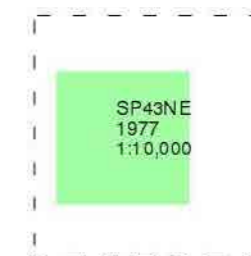

Historical Map - Slice A

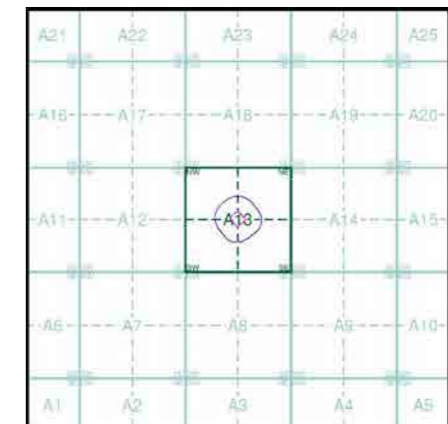

Order Details

Order Number: 183076277_1_1
Customer Ref: JER1600
National Grid Reference: 446820, 237490
Slice: A
Site Area (Ha): 0.53
Search Buffer (m): 1000

Site Details

Cotefield Farm, Oxford Road, Bodicote, BANBURY



Tel: 0844 844 9952
Fax: 0844 844 9951
Web: www.envirocheck.co.uk

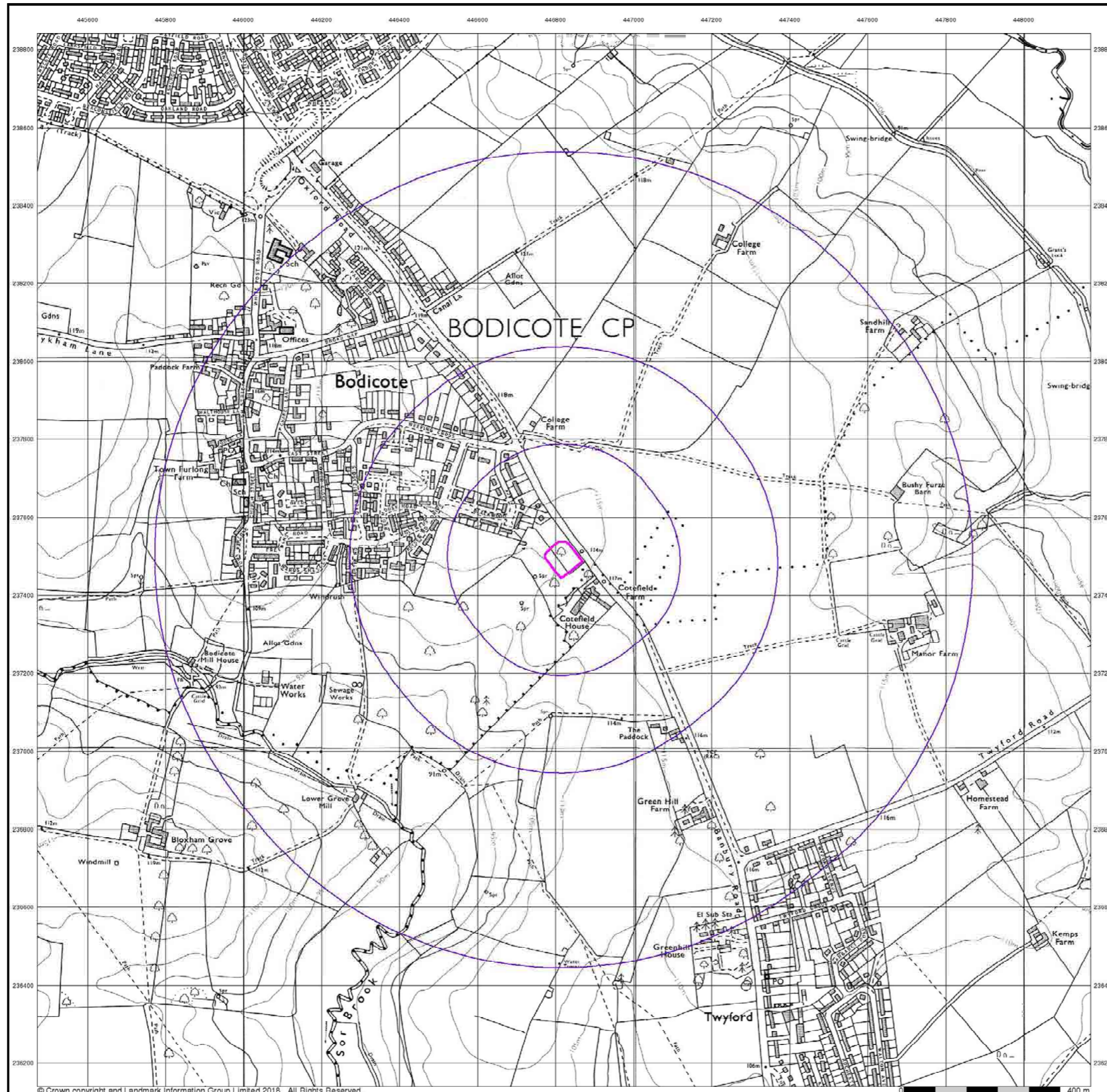



Ordnance Survey Plan

Published 1993

Source map scale - 1:10,000

The historical maps shown were reproduced from maps predominantly held at the scale adopted for England, Wales and Scotland in the 1840's. In 1854 the 1:2,500 scale was adopted for mapping urban areas; these maps were used to update the 1:10,560 maps. The published date given therefore is often some years later than the surveyed date. Before 1938, all OS maps were based on the Cassini Projection, with independent surveys of a single county or group of counties, giving rise to significant inaccuracies in outlying areas. In the late 1940's, a Provisional Edition was produced, which updated the 1:10,560 mapping from a number of sources. The maps appear unfinished - with all military camps and other strategic sites removed. These maps were initially overprinted with the National Grid. In 1970, the first 1:10,000 maps were produced using the Transverse Mercator Projection. The revision process continued until recently, with new editions appearing every 10 years or so for urban areas.

Map Name(s) and Date(s)

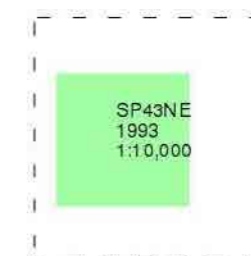

Historical Map - Slice A

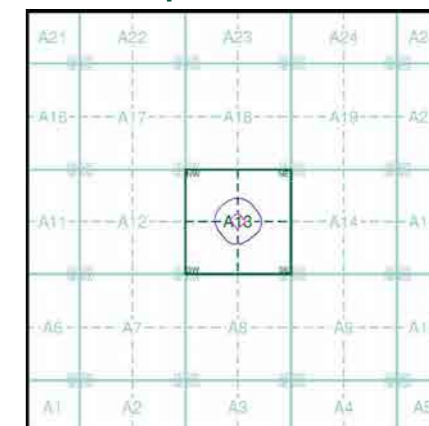

Order Details

Order Number: 183076277_1_1
Customer Ref: JER1600
National Grid Reference: 446820, 237490
Slice: A
Site Area (Ha): 0.53
Search Buffer (m): 1000

Site Details

Cotefield Farm, Oxford Road, Bodicote, BANBURY



Tel: 0844 844 9952
Fax: 0844 844 9951
Web: www.envirocheck.co.uk

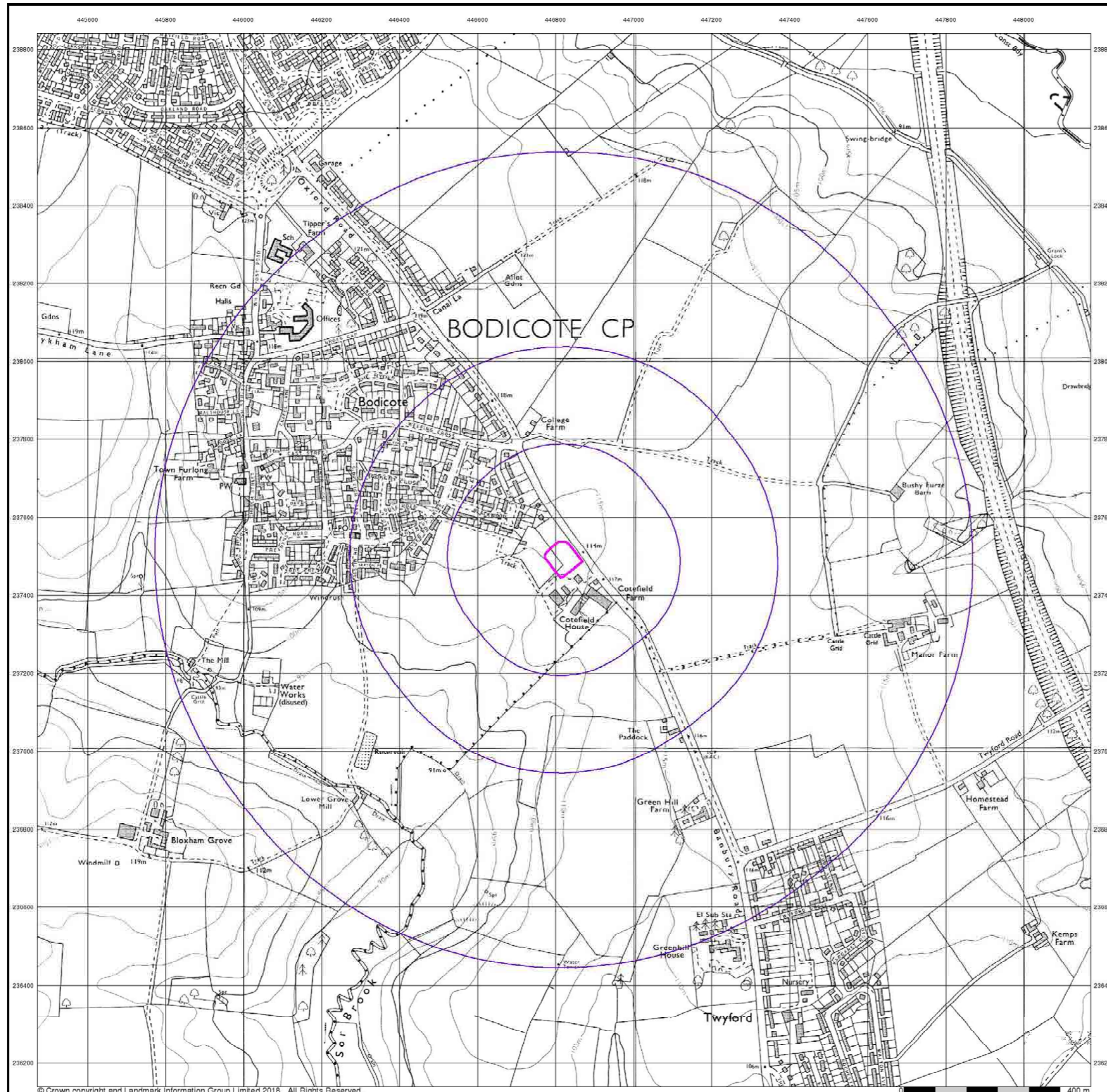



10k Raster Mapping

Published 1999

Source map scale - 1:10,000

The historical maps shown were produced from the Ordnance Survey's 1:10,000 colour raster mapping. These maps are derived from Landplan which replaced the old 1:10,000 maps originally published in 1970. The data is highly detailed showing buildings, fences and field boundaries as well as all roads, tracks and paths. Road names are also included together with the relevant road number and classification. Boundary information depiction includes county, unitary authority, district, civil parish and constituency.

Map Name(s) and Date(s)



Historical Map - Slice A

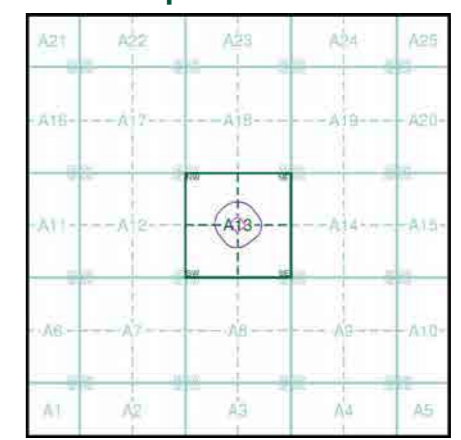

Order Details

Order Number: 183076277_1_1
Customer Ref: JER1600
National Grid Reference: 446820, 237490
Slice: A
Site Area (Ha): 0.53
Search Buffer (m): 1000

Site Details

Cotefield Farm, Oxford Road, Bodicote, BANBURY



Tel: 0844 844 9952
Fax: 0844 844 9951
Web: www.envirocheck.co.uk

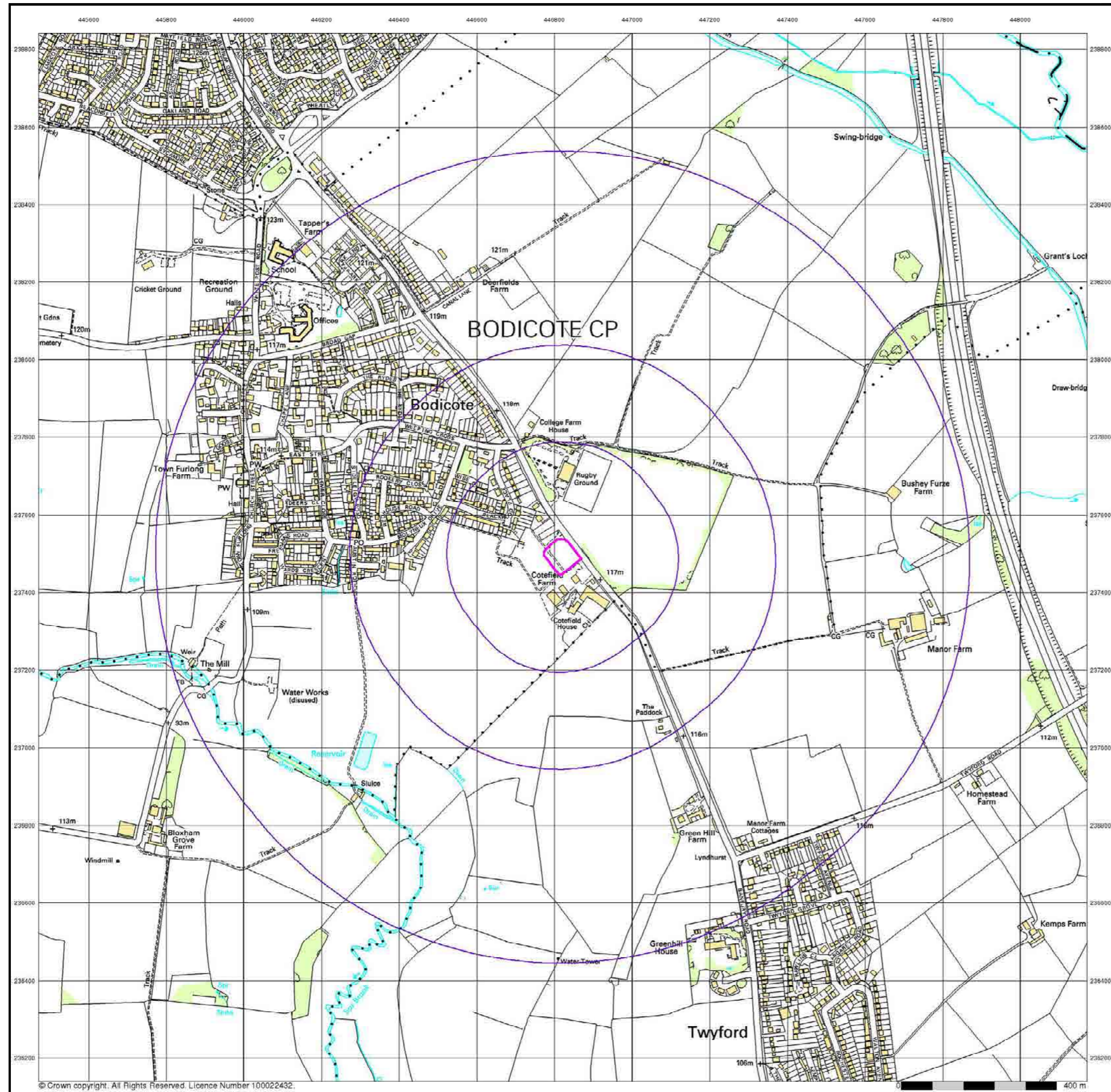

© Crown copyright. All Rights Reserved. Licence Number 100022432.



10k Raster Mapping

Published 2006

Source map scale - 1:10,000

The historical maps shown were produced from the Ordnance Survey's 1:10,000 colour raster mapping. These maps are derived from Landplan which replaced the old 1:10,000 maps originally published in 1970. The data is highly detailed showing buildings, fences and field boundaries as well as all roads, tracks and paths. Road names are also included together with the relevant road number and classification. Boundary information depiction includes county, unitary authority, district, civil parish and constituency.

Map Name(s) and Date(s)



Historical Map - Slice A

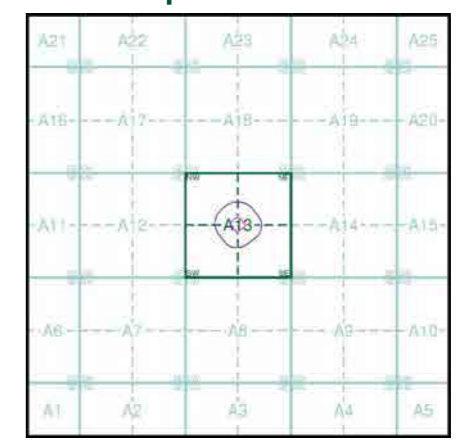

Order Details

Order Number: 183076277_1_1
Customer Ref: JER1600
National Grid Reference: 446820, 237490
Slice: A
Site Area (Ha): 0.53
Search Buffer (m): 1000

Site Details

Cotefield Farm, Oxford Road, Bodicote, BANBURY



Tel: 0844 844 9952
Fax: 0844 844 9951
Web: www.envirocheck.co.uk

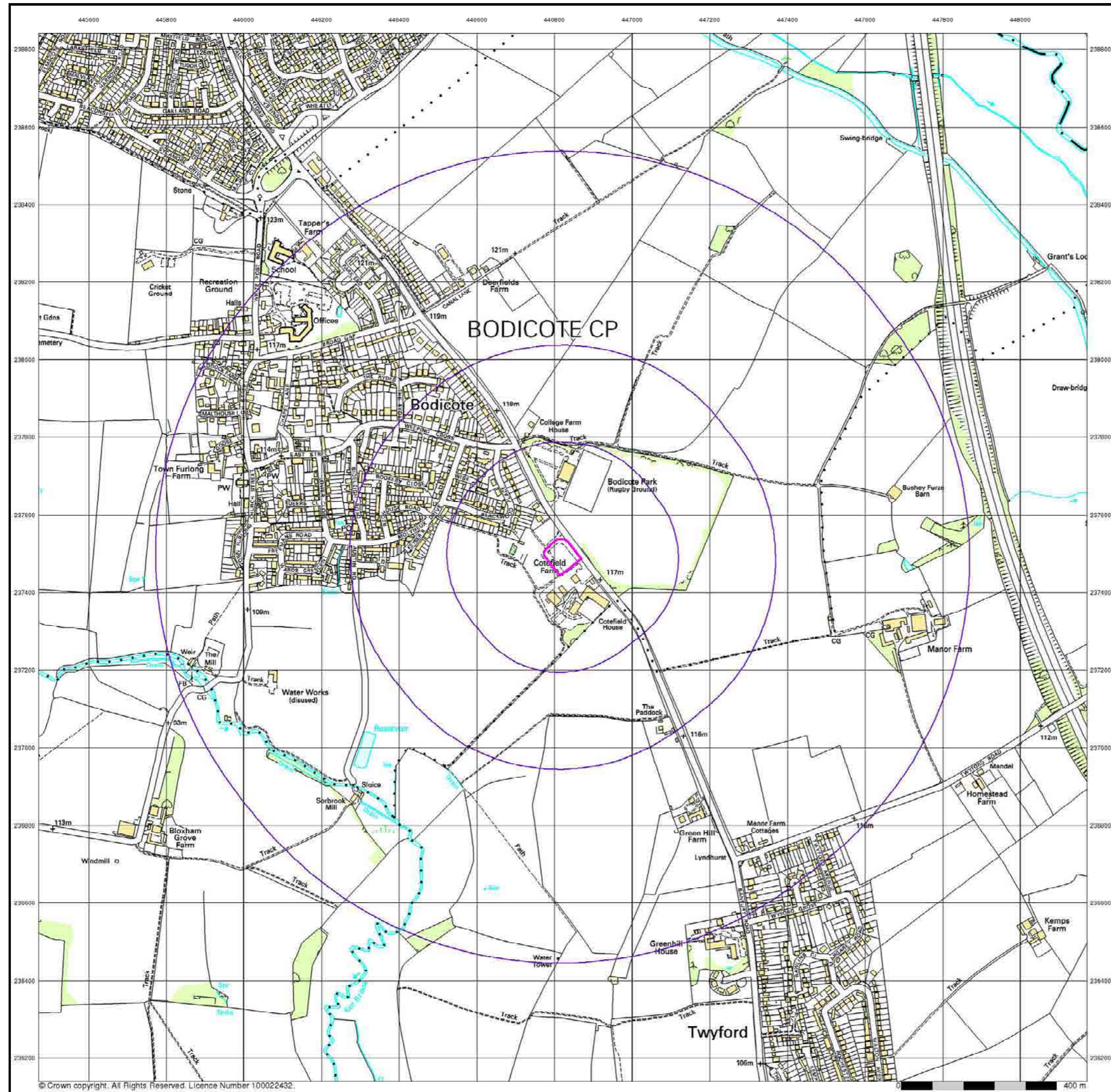

© Crown copyright. All Rights Reserved. Licence Number 100022432.

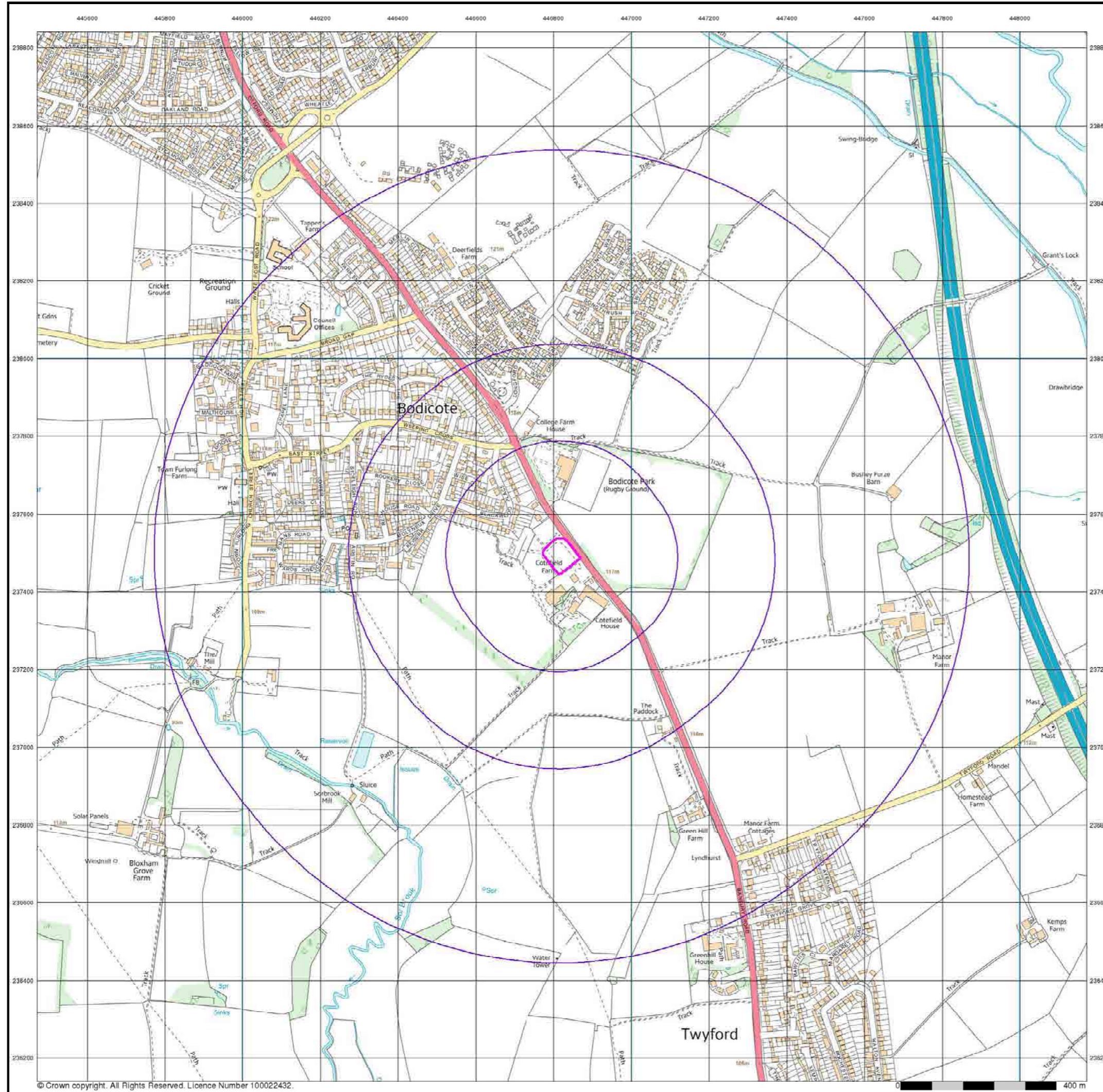

VectorMap Local
Published 2018
Source map scale - 1:10,000

VectorMap Local (Raster) is Ordnance Survey's highest detailed 'backdrop' mapping product. These maps are produced from OS's VectorMap Local, a simple vector dataset at a nominal scale of 1:10,000, covering the whole of Great Britain, that has been designed for creating graphical mapping. OS VectorMap Local is derived from large-scale information surveyed at 1:1250 scale (covering major towns and cities), 1:2500 scale (smaller towns, villages and developed rural areas), and 1:10 000 scale (mountain, moorland and river estuary areas).

Map Name(s) and Date(s)



Historical Map - Slice A

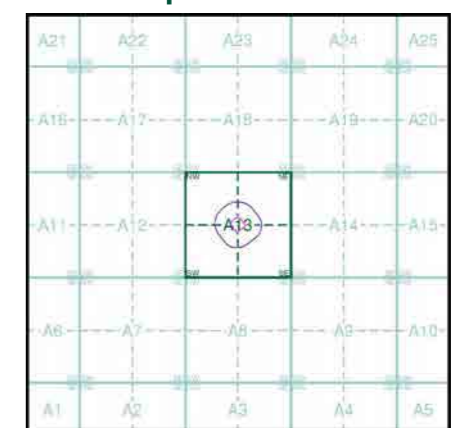

Order Details

Order Number: 183076277_1_1
 Customer Ref: JER1600
 National Grid Reference: 446820, 237490
 Slice: A
 Site Area (Ha): 0.53
 Search Buffer (m): 1000

Site Details

Cotefield Farm, Oxford Road, Bodicote, BANBURY



Tel: 0844 844 9952
 Fax: 0844 844 9951
 Web: www.envirocheck.co.uk

© Crown copyright. All Rights Reserved. Licence Number 100022432.

Appendix 3

BGS Borehole Record



British Geological Survey
NATURAL ENVIRONMENT RESEARCH COUNCIL

BGS ID: 331337 : BGS Reference: SP43NE254
British National Grid (27700) : 446800,237500

[Report an issue with this borehole](#)

Eastern h.s. Thames NRA. COTEFIELD FARM, BODICOTE		218 SP 43/56.			
Owner MR. R.T. BRATT CoteField Fm.	Licence No.	Nat. Grid Ref. SP 468 375			
Occupier	IGS Ref. No.	Status			
Ground Level	112 m OD	ft. OD	Aquifer		
Level of Well Top	112 m OD	ft. OD			
Rest Water Level	13 m bwt	ft. bwt	Summary of Geological Section		
(Date Aug 1990)	m · OD	ft. OD		Thickness	
Construction		Depth			
Depth bwt	Dia.	Linings (below well top)			
		From	To	Dia.	Type
35m	150mm	0	2m	150mm	Plastic
		0	35m	100mm	Slotted
Abstraction Rates		Type of Pump			
gph		Chem./Bact. Anal.		YES NO	
gpd		Well Driller		WCB Steeman	
If insufficient space has been allowed, continue in 'Notes' overleaf.					



<p>British Geological Survey</p> <p>Site Plan</p> <p>British Geological Survey</p> <p>British Geological Survey</p> <p>British Geological Survey</p> <p>British Geological Survey</p> <p>British Geological Survey</p> <p>British Geological Survey</p> <p>British Geological Survey</p>	<p>British Geological Survey</p> <p>Notes</p> <p>Depth to pump suction - 25m . Water strike - 18m . Pumping Test 13/7/91 for 120 hrs Yield = 4.55 m³/hr . RWL = 12.96 mbwt PWL = 16.30 mbwt .</p> <p>British Geological Survey</p> <p>British Geological Survey</p> <p>British Geological Survey</p> <p>British Geological Survey</p> <p>British Geological Survey</p>
---	--

