

ROOF PLAN 1:50

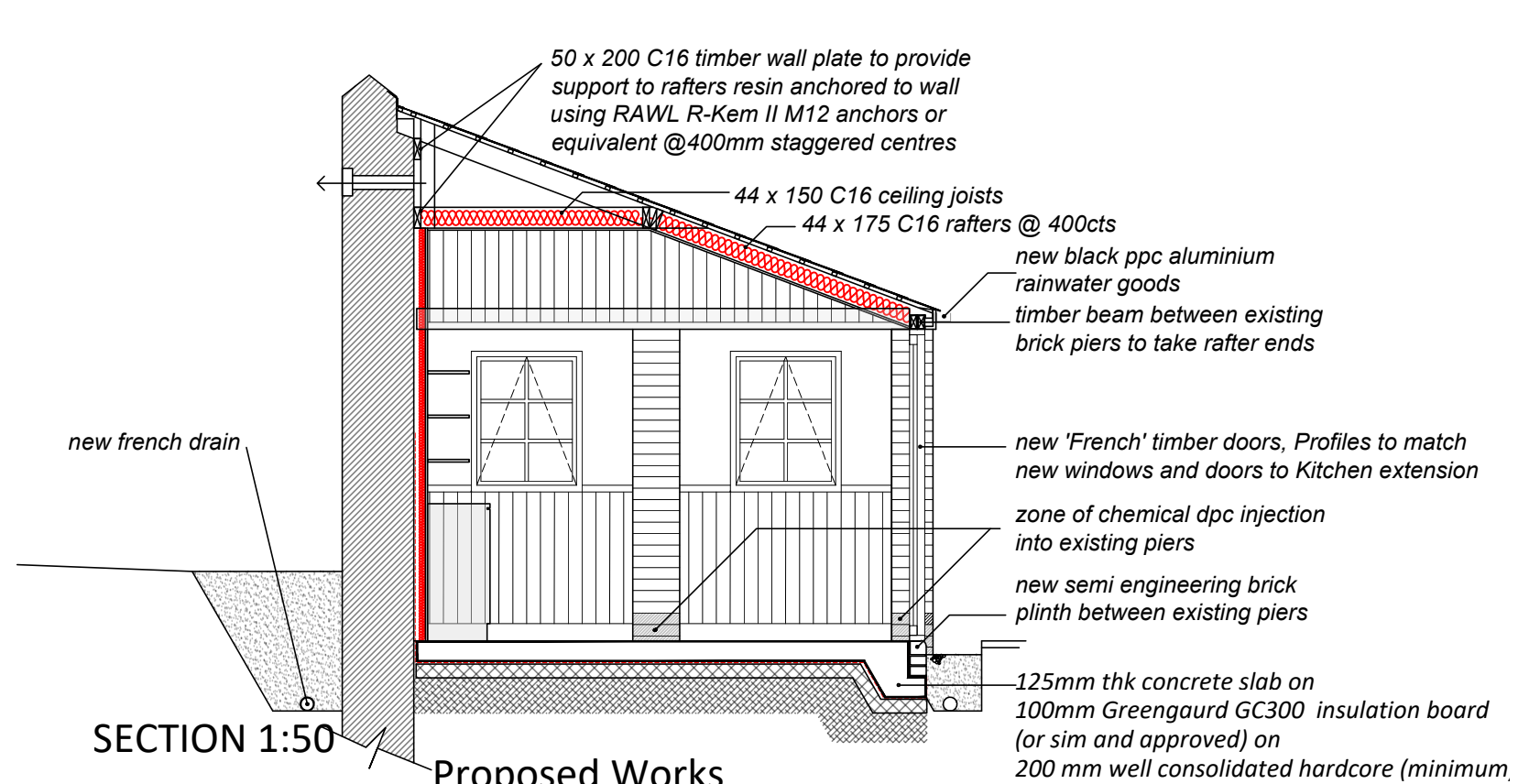

SECTION 1:50

Proposed Works

- Remove existing dividing timber infill window/doors
- Remove and dispose existing roof timbers
- Remove existing asbestos based 'diamond' format roof tiles and dispose.
- Existing multi type floor surface removed and disposed
- New damp proof solution injected into existing walls by specialist sub contractor
- Construct new french drain as indicated and connect to yard drainage
- Construct new 100mm dia foul sewer to connect to existing foul sewer to the east.
- reduce external ground level where indicated
- Construct new cavity brickwork wall under existing door openings
- Overhaul existing loose door and frame and fix door into the frame.
- Construct new floor slab on dpm and insulation boards
- Lap dpm with internal vertical tanking to be taken up wall to 1000mm above existing outside level
- Construct new roof with treated softwood joists, insulation boards, vapour barriers etc and cover in new blue grey slate with Code 4 lead flashings where required. Allow for above insulation ventilation at eaves and high level. Allow for brick padstone insertion
- New black metal profiled guttering installed and connect to existing surface water drain
- Install between brick piers new insulated timber frames / cladding / windows / doors on matching brickwork plinths
- Construct new wc partition and door, complete with ironmongery. install acoustic insulation between studs.
- Dry line back and side wall with insulated plasterboard' 65mm thk Knauf PIR or similar
- install new back to the wall wc and connect to foul sewer
- Construct boxing out to rear of wc, install new semi recessed whb onto framing. ensure access to concealed cistern is maintained.
- Lay new flooring through out,
- install new kitchen units and basin complete with undersink hot water boiler and install all necessary supply and waste pipework
- Install all electrical fittings as directed
- Decorate throughout as directed.

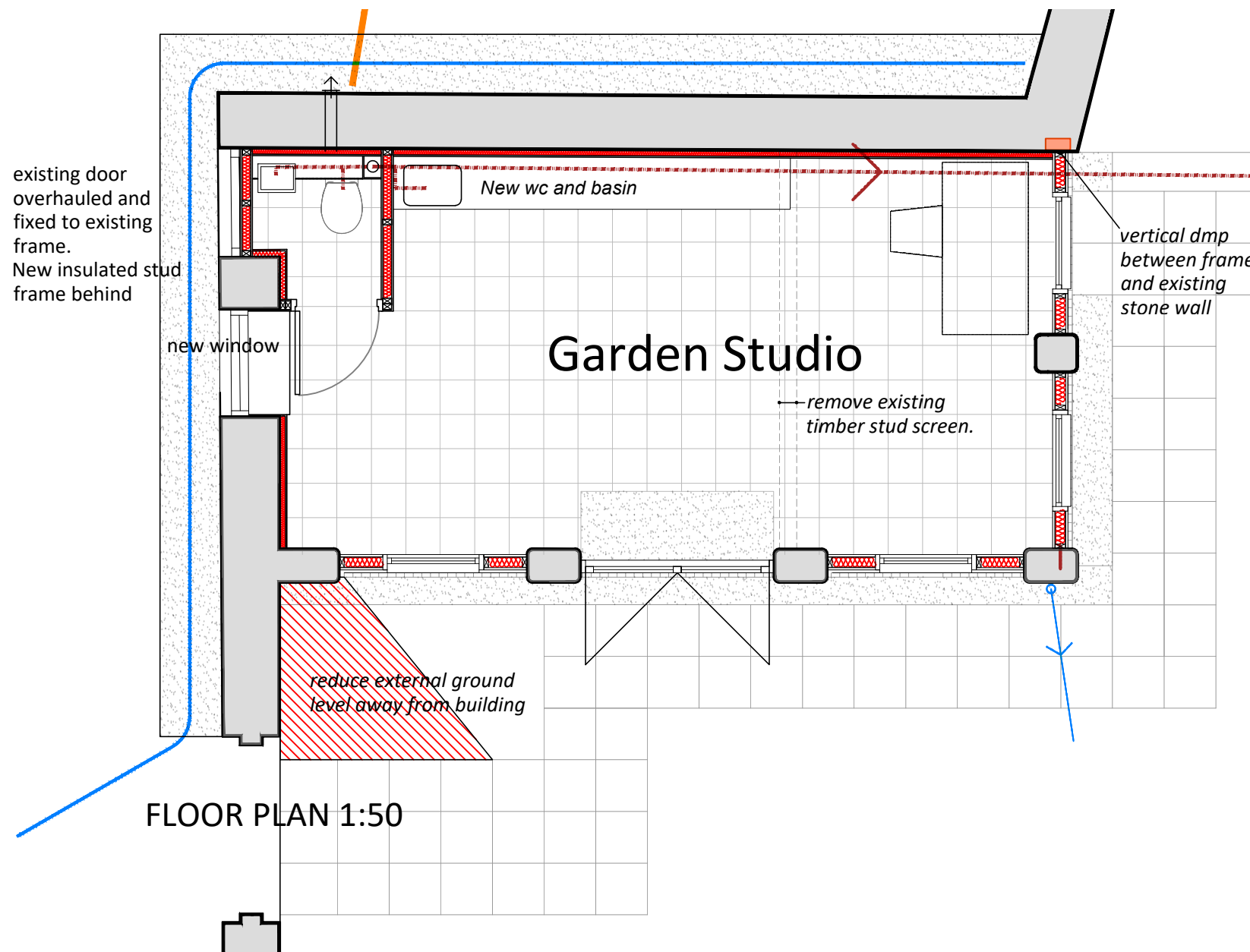

FLOOR PLAN 1:50

B BReg Issue 03/09 tw
A Tender Issue 27/06 tw

David J Stewart Associates
Chartered Architects
Architects • Interior Design • Town Planning • Project Management
Stable Barn
Acacia Cottage
South Side
Steeple Aston
Oxfordshire
OX25 4RT
T: 01295 267565
E: djs@djsa.co.uk

Constructionline
RIBA #
Chartered Practice

rev.	description	date	dm	ckd
project Cedar Lodge, North Side Steeple Aston OX25 3SE				
site Works to Potting Shed to form home office				
first issue	06.06.2019	checked	djs	
scale	1:50@ A3	drawn	TW	
dep. no.				
2018-1014-GA10				B