

# **APPENDIX K**

## **BAILEY JOHNSON HAYES MISCALLENOUS PLANS**

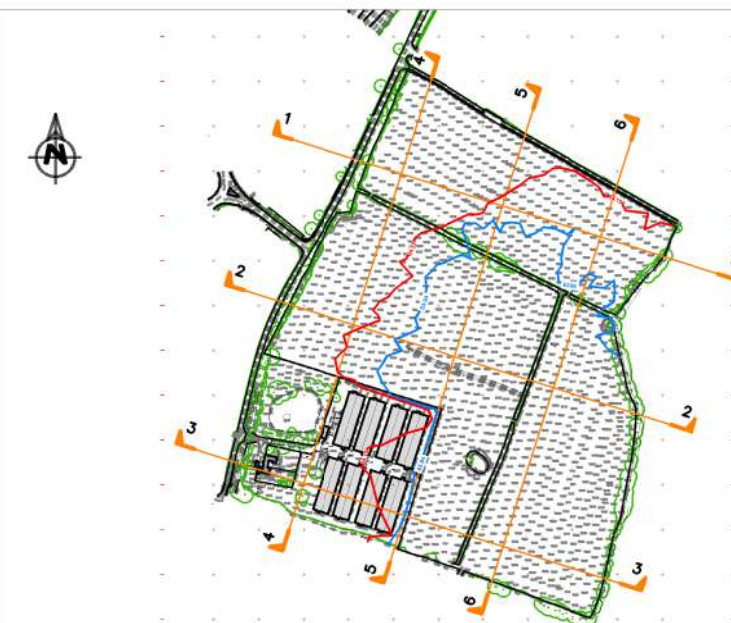
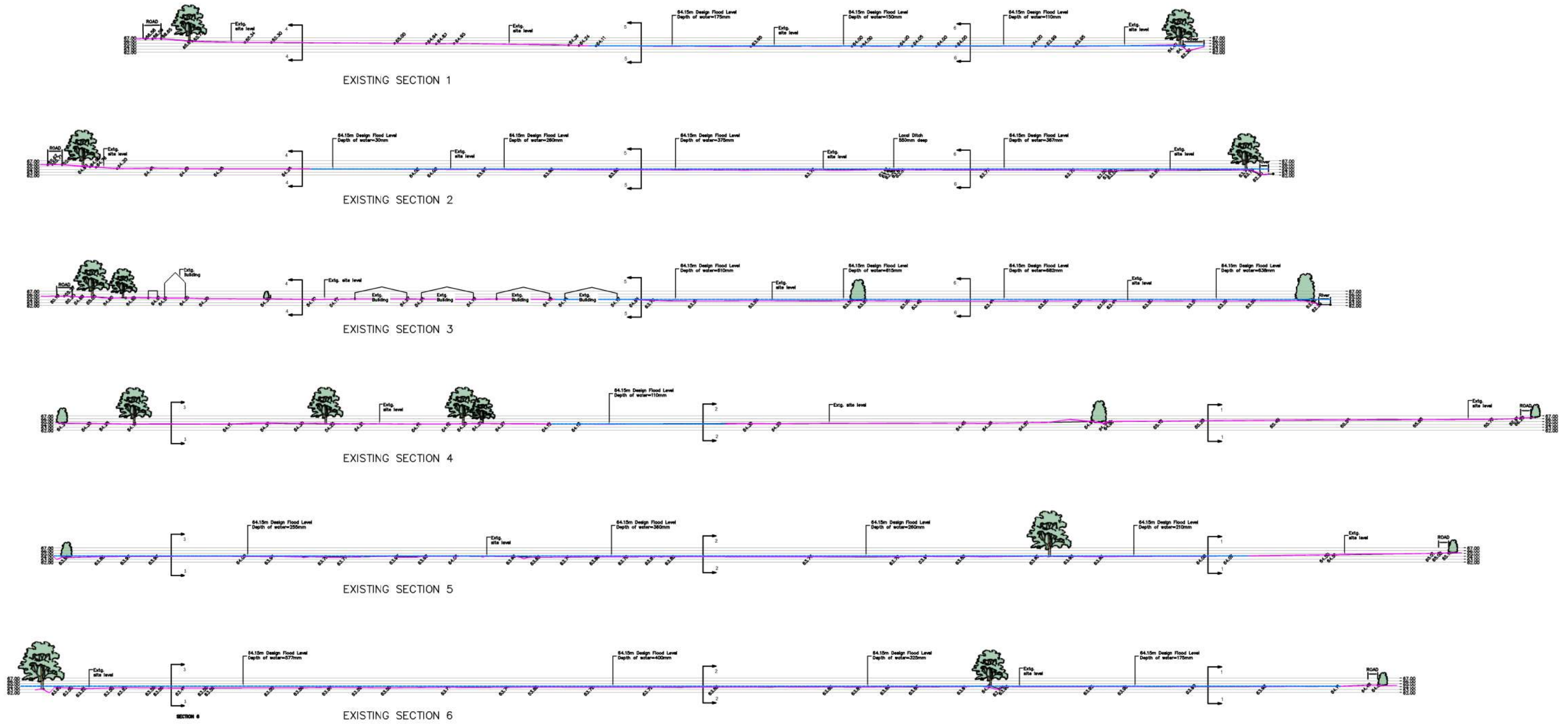

**PRELIMINARY**

Rev	Date	Revised Description
A	13.06.19	Updated to latest design flood levels

Revision Schedule

**Catalyst Bicester**  
Wendlebury Road, Bicester

Client:  
**Albion Land Plc.**

EXISTING SITE SECTIONS SHOWING  
DESIGN FLOOD LEVEL

**BAILEY JOHNSON HAYES**  
Consulting Engineers

ST ALBANS: Suite 4, Phoenix House, 63 Church End, ST ALBANS, Herts AL1 1PL  
MANCHESTER: Orange House, John Dalton Street, MANCHESTER, M2 5PU

Scale: 1:500  
Date: 10.10.18  
Drawn: DJC

**S1358-Ext-09A**

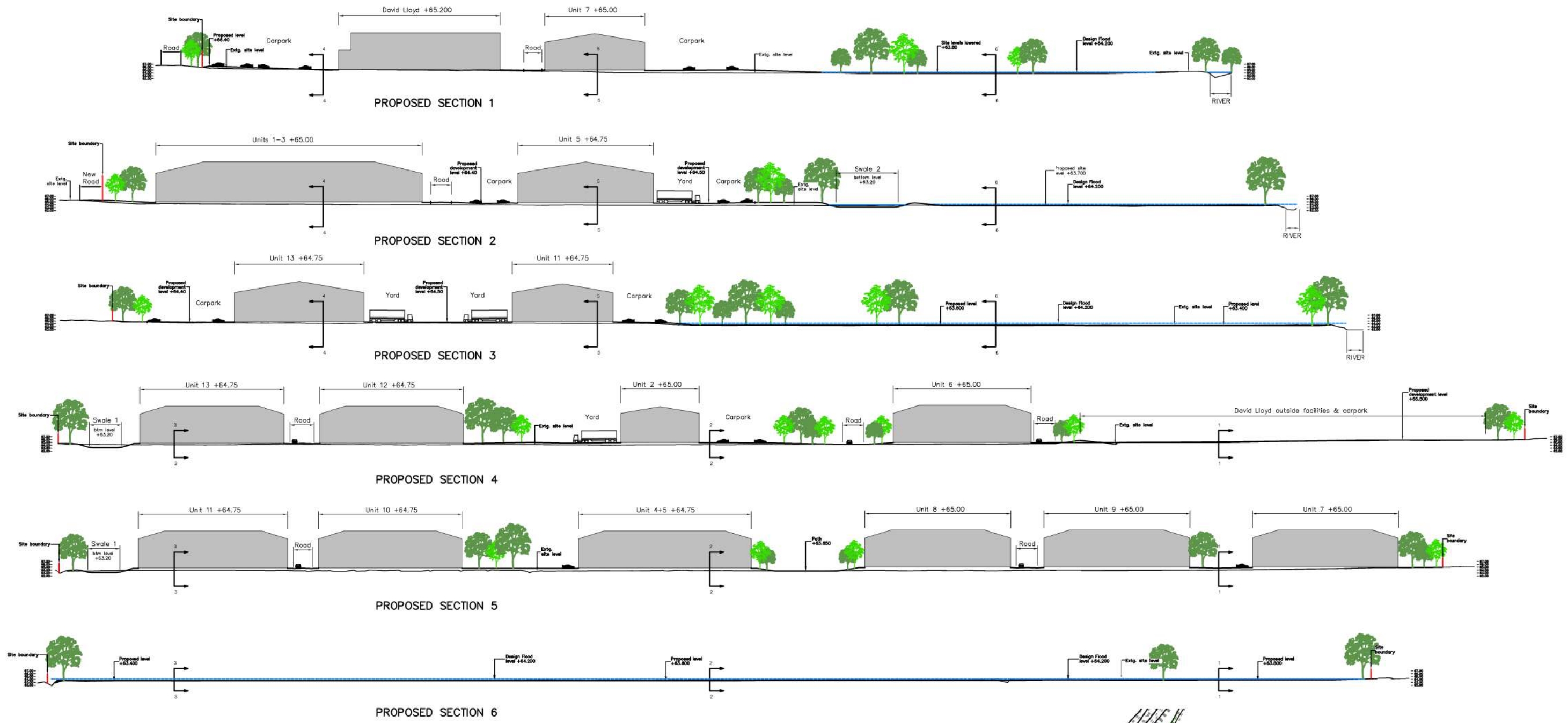

Site Layout 1:2500

**PRELIMINARY**

Rev	Date	Revised Description
A	03.06.19	Sections updated for new scheme

Revision Schedule

**Catalyst Bicester**  
**Wendlebury Road**

Client:  
**Albion Land Plc.**

SITE SECTIONS SHOWING  
PROPOSED DEVELOPMENT

**BAILEY JOHNSON HAYES**  
Consulting Engineers

ST ALBANS: Suite 4, Phoenix House, 83 Church End, ST ALBANS, Herts AL1 9PL  
MANCHESTER: Orange House, 10th Floor, 10th Floor, MANCHESTER, M2 4PR

Scale: 1:500  
Date: 11.10.18  
Drawn: DJC

**S1358-Ext-10A**





10m 0 10m 20m 30m 40m 50m

1:500 @ A0



**KEY:**

- FOOTPATH
- PERMEABLE BLOCK PAVING CAR PARKING
- REINFORCED CONCRETE ROAD/YARD SLAB
- ASPHALT ROAD SURFACE
- SWALE
- NEW UNITS

### Proposed External Works Plan 1:500

**PRELIMINARY**

Rev	Date	Description
A	10.06.19	Updated to latest Architects Layout

Revision Schedule

**Catalyst Bicester**  
Wendlebury Road, Bicester

**Client:**  
**Albion Land Plc.**

TECH SCHEME OPTION 8  
PROPOSED EXTERNAL FINISHES

**BAILEY JOHNSON HAYES**  
Consulting Engineers

Scale: 1:500 @ A0  
Date: 19.03.19  
Drawn: JNG

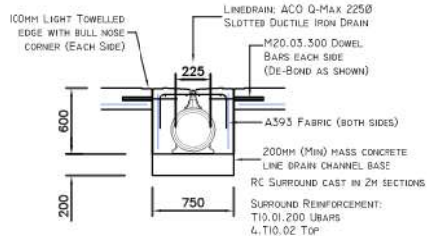

ACO QMAX 225 LINE DRAIN 1:25

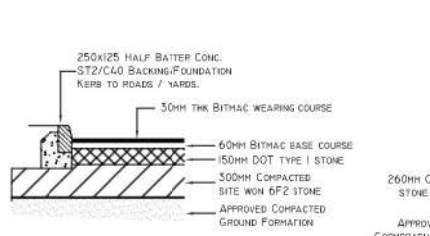

BITMAC ROAD SURFACE 1:25

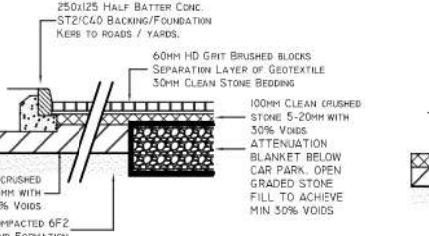

PERMEABLE BLOCK CARPARK 1:25

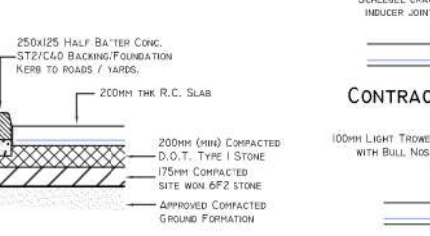

RC YARD KERB DETAIL 1:25

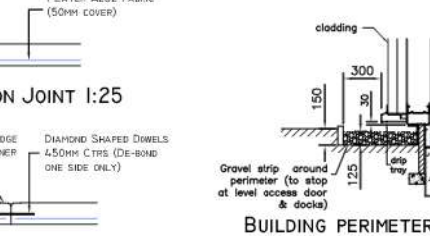

LONGITUDINAL JOINT 1:25

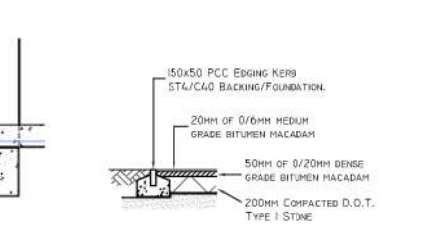

PATH EDGING DETAIL 1:25

CONTRACTION JOINT 1:25

BUILDING PERIMETER GRAVEL STRIP DETAIL 1:25



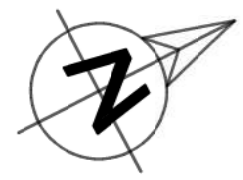

S278 DRAINAGE DETAILED SEPARATELY

10m 0 10m 20m 30m 40m 50m

1:500 @ A0

Wendlebury Road

S278 DRAINAGE DETAILED SEPARATELY

125x220x40m ATTENUATION BLANKETS  
OPEN GRADED STONE 30% VOIDS, IL 63.800m,  
225 DIA 1,200 PERFORATED DISTRIBUTION  
PIPE WRAPPED 2 LAYERS OF TERRAM.

75x160x40m ATTENUATION BLANKETS  
OPEN GRADED STONE 30% VOIDS, IL 64.150m,  
300 DIA 1,200 PERFORATED DISTRIBUTION  
PIPE WRAPPED 2 LAYERS OF TERRAM.

58x20x40m ATTENUATION BLANKETS  
OPEN GRADED STONE 30% VOIDS, IL 64.150m,  
300 DIA 1,200 PERFORATED DISTRIBUTION  
PIPE WRAPPED 2 LAYERS OF TERRAM.

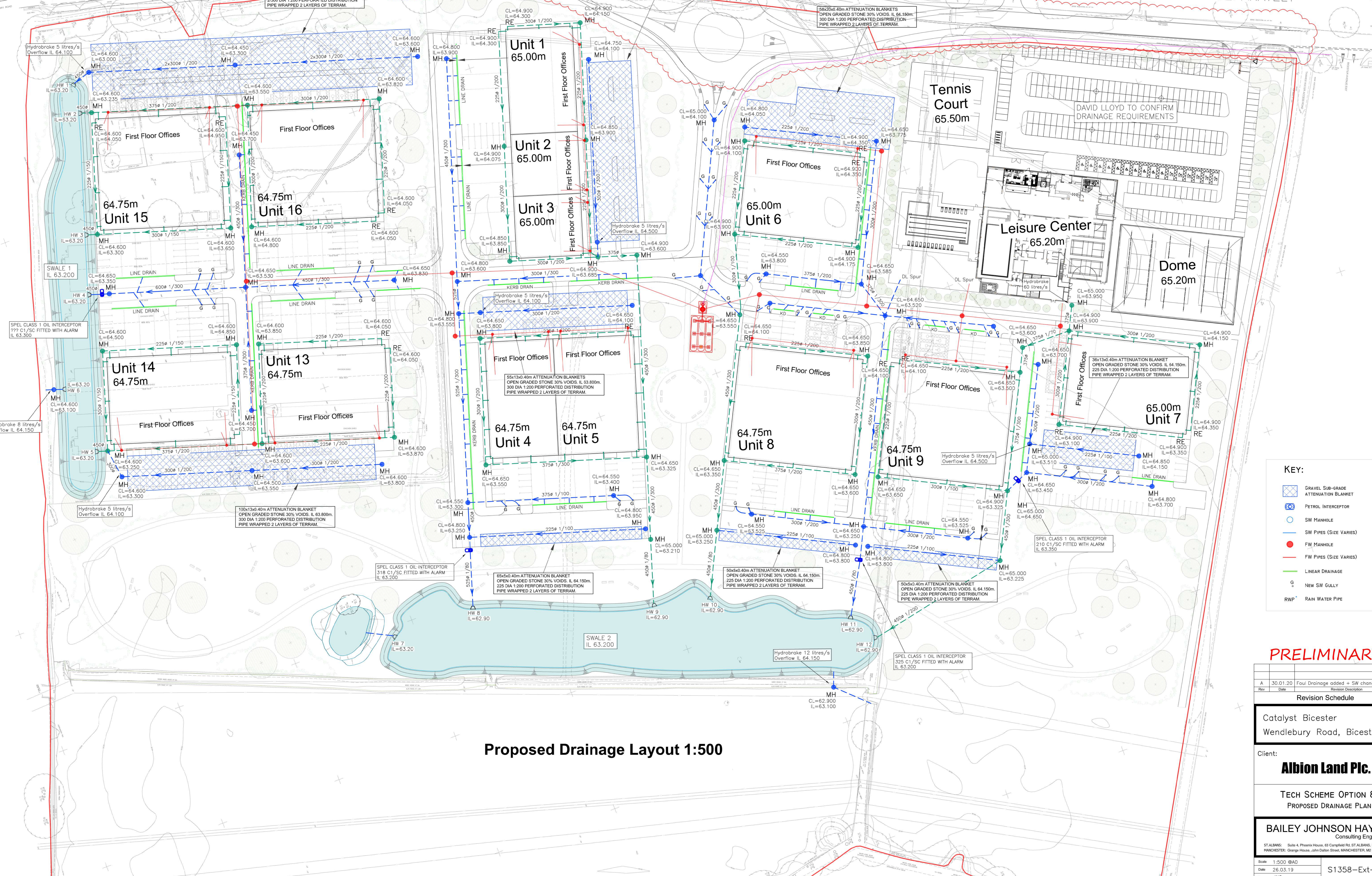

**KEY:**

- GRAVEL SUB-GRADE ATTENUATION BLANKET
- PETROL INTERCEPTOR
- SW MANHOLE
- SW PIPES (SIZE VARIES)
- FW MANHOLE
- FW PIPES (SIZE VARIES)
- LINEAR DRAINAGE
- NEW SW GULLY
- RWP RAIN WATER PIPE

**PRELIMINARY**

Rev	Date	Revision Description
A	30.01.20	Foul Drainage added + SW changes

Revision Schedule

Catalyst Bicester  
Wendlebury Road, Bicester

Client:  
**Albion Land Plc.**

TECH SCHEME OPTION 8  
PROPOSED DRAINAGE PLAN

**BAILEY JOHNSON HAYES**  
Consulting Engineers

ST. ALBANS: Suite 4, Phoenix House, 63 Campfield Rd, ST. ALBANS, Herts AL1 1FL  
MANCHESTER: Orange House, John Dalton Street, MANCHESTER, M2 6PW

Scale: 1:500 @A0  
Date: 26.03.19  
Drawn: JNC

Proposed Drainage Layout 1:500

S1358-Ext-34A





# Development site

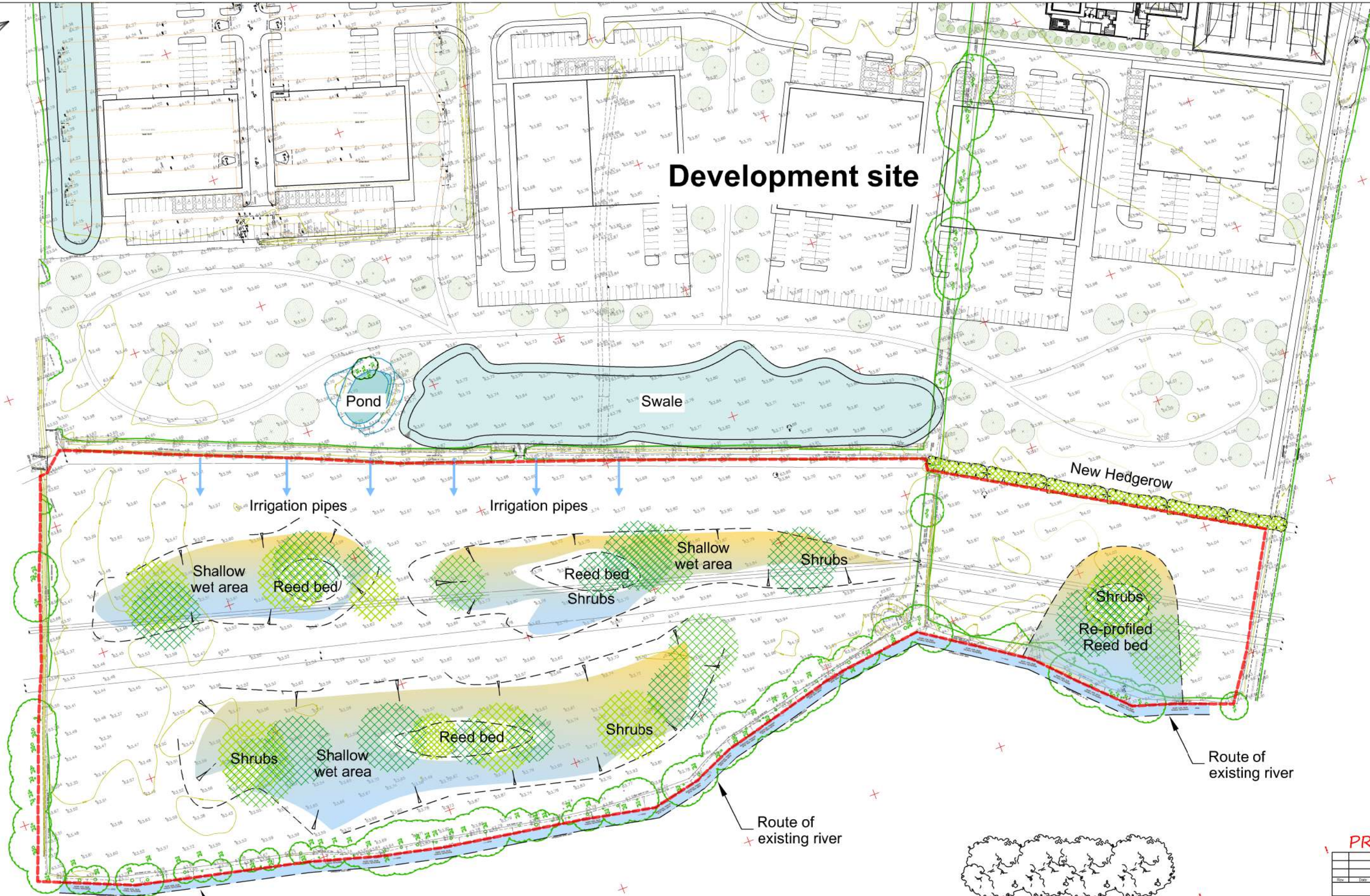

## ZONE DEDICATED TO CONSERVATION 1:500

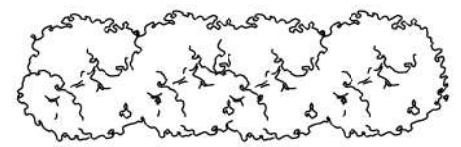

Hedgerow



Reed bed

**PRELIMINARY**

Rev	Date	Revision Description

Revision Schedule

**Catalyst Bicester**  
Wendlebury Road, Bicester

Client:  
**Albion Land Plc.**

CONSERVATION ZONE

**BAILEY JOHNSON HAYES**  
Consulting Engineers  
ST ALBANS: Suite 4, Prospero House, 63 Campbell Rd, ST ALBANS, Herts AL1 5PL  
MANCHESTER: Grange House, John Dalton Street, MANCHESTER, M2 6FW

Scale: 1:500 @A0  
Date: 15.07.19  
Drawn: DC

**S1358-Ext-37**



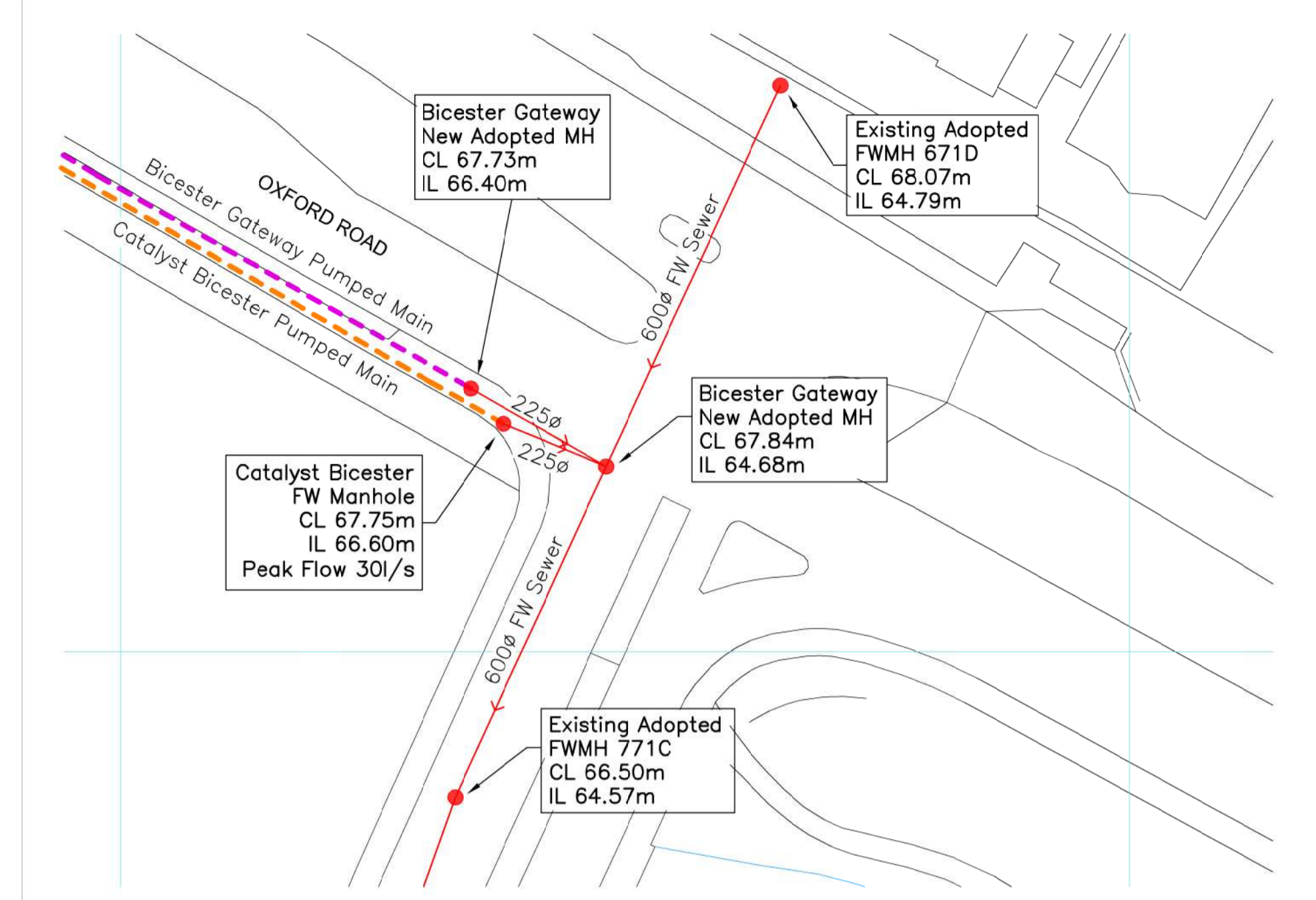
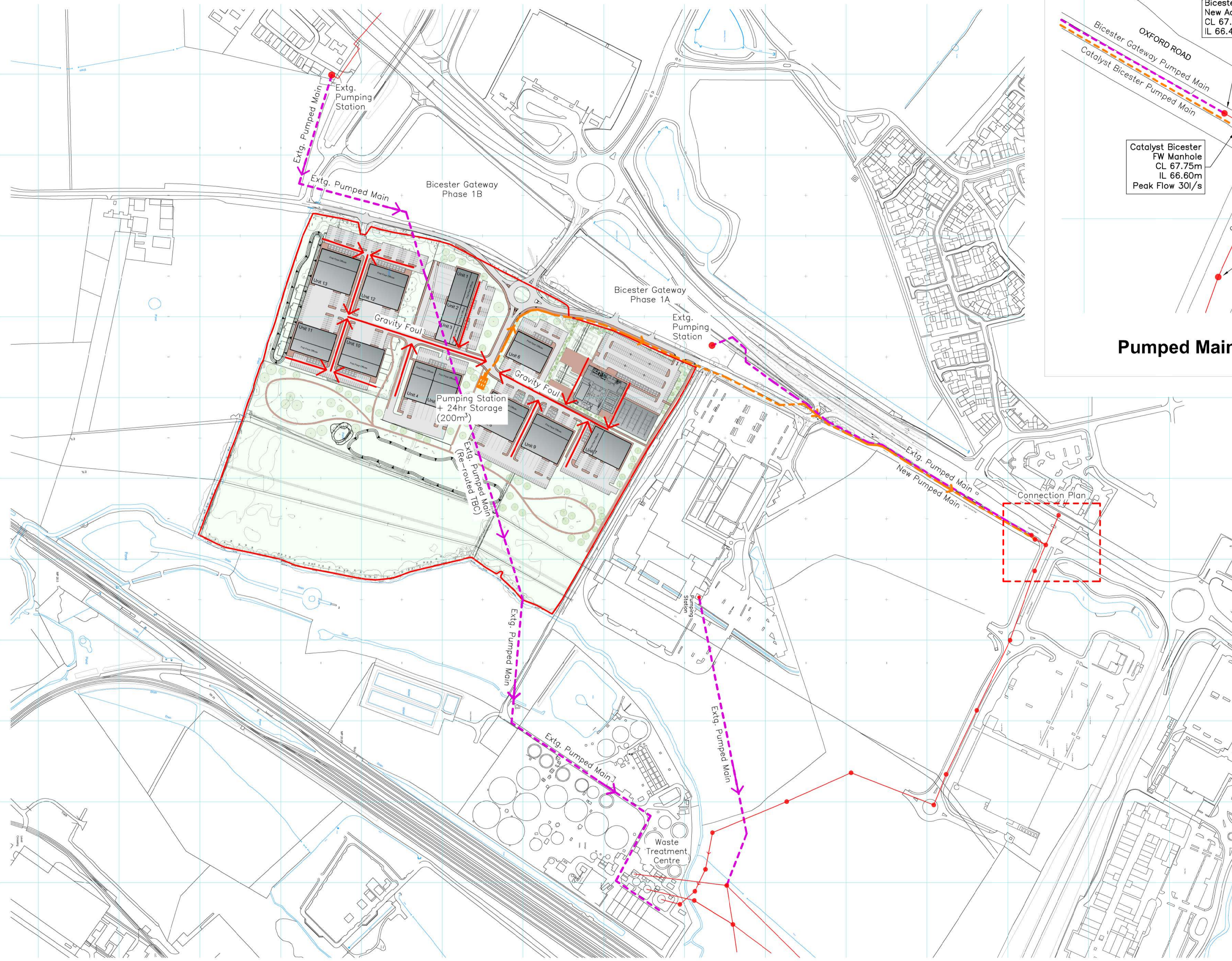

**Pumped Main Proposed Connection 1:500**

- Key:
- Proposed Buildings
  - Site Boundary
  - Existing Adopted Foul Pumped Main
  - New Catalyst Bicester Pumped Main route
  - New Foul Pumping Station
  - New Foul Water Flow Paths
  - Existing Foul Pumping Station
  - Existing Gravity Foul Drainage

**PRELIMINARY**

Rev	Date	Revision Description
A	04.11.19	Minor Revs

**Revision Schedule**

Catalyst Bicester  
Wendlebury Road, Bicester

Client:  
**Albion Land Plc.**

**CONCEPT FOUL DRAINAGE SCHEME**

**BAILEY JOHNSON HAYES**  
Consulting Engineers  
ST. ALBANS: Suite 4, Phoenix House, 63 Campfield Rd, ST. ALBANS, Herts AL1 5FL  
MANCHESTER: Grange House, John Dalton Street, MANCHESTER, M2 6FW

Scale	1:2500 @A1	S1358-Ext-38A
Date	22.10.19	
Drawn	JNG	

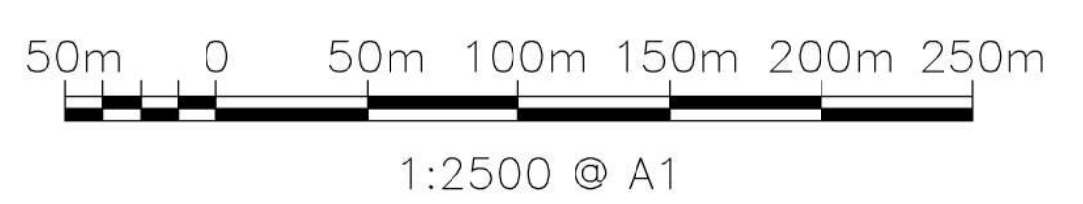

**Concept FW Drainage Layout 1:2500**





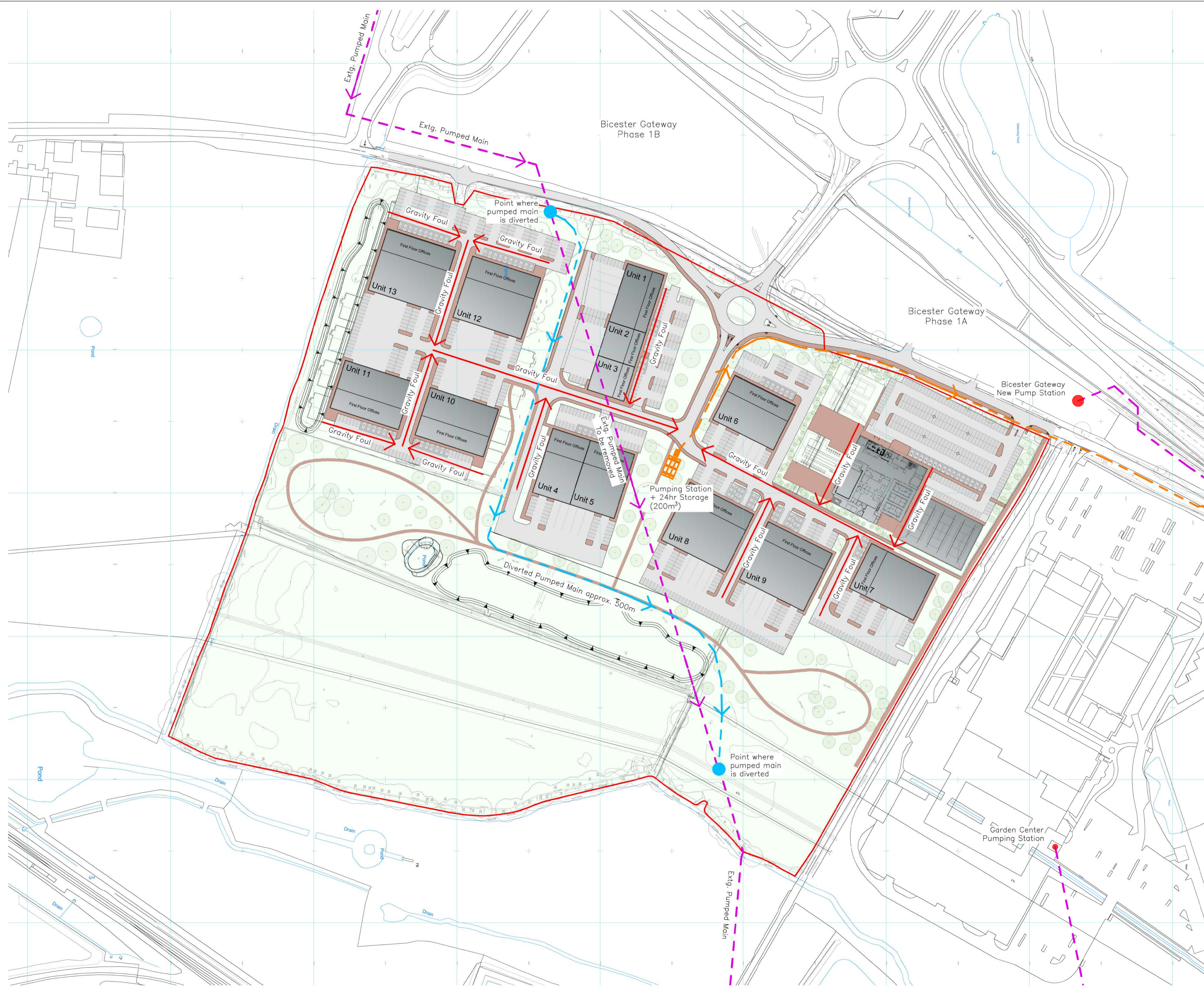

**Key:**

- Proposed Buildings
- Site Boundary
- Existing Foul Pumped Main
- New Catalyst Bicester Pumped Main route
- New Foul Pumping Station
- New Foul Water Flow Paths
- Extg. Pump main diversion point
- Diverted Pumped Main Route

PRELIMINARY

Rev	Date	Revision Description
<b>Revision Schedule</b>		

Catalyst Bicester  
Wendlebury Road, Bicester

Client:  
**Albion Land Plc.**

DIVERTED PUMPED MAIN PLAN

BAILEY JOHNSON HAYES  
Consulting Engineers

ST. ALBANS: Suite 4, Phoenix House, 63 Campfield Rd, ST. ALBANS, Herts AL1 5FL  
MANCHESTER: Grange House, John Dalton Street, MANCHESTER, M2 6FW

Scale: 1:2500 @A1	S1358-Ext-50
Date: 15.01.20	
Drawn: JNG	