

# Bunkers Hill, Oxon

Design copyright is vested in the Company below from whom consent must be obtained for copying or reproducing this drawing.

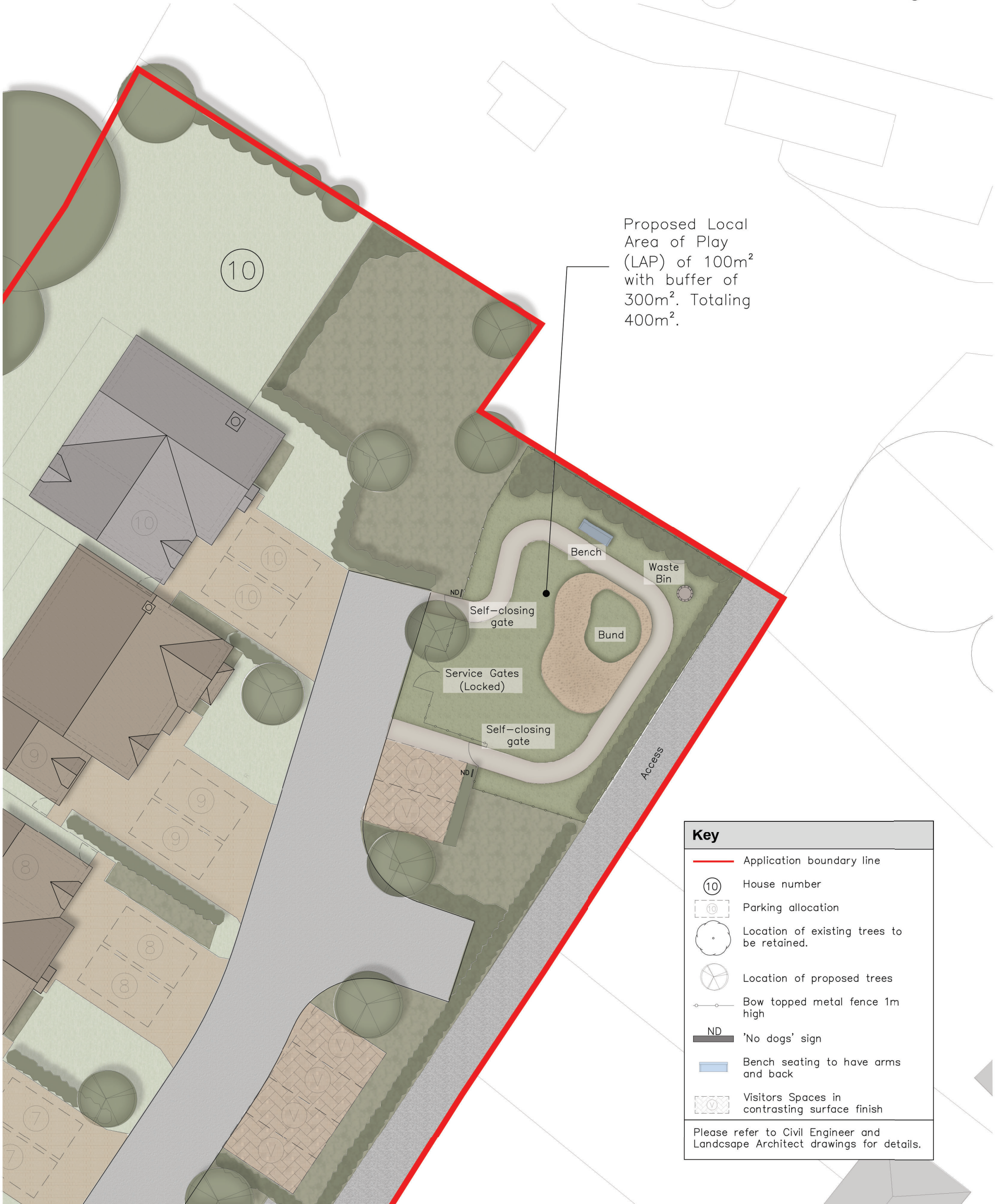

Planning



A Waste bin moved, gates to open outwards, bench seating to have arms and back, 19/09/19 AM visitors spaces to have contrasting surface finish, fence to be bow topped metal and 1m high.



Bunkers Hill, Oxon  
Kidlington

Title  
Proposed Local Area of Play  
Scale 1:200 @ A3

Date  
March '19

Drawn  
CP

Checked  
SRH

Drawing No.  
392/19/PL1002

Revision  
A

13 ARM & SWORD LANE  
OLD HATFIELD HERTS AL9 5EH  
T 01707 270 077 W www.ashbydesign.co.uk

## Proposed LAP