

EXISTING GROUND FLOOR PLAN

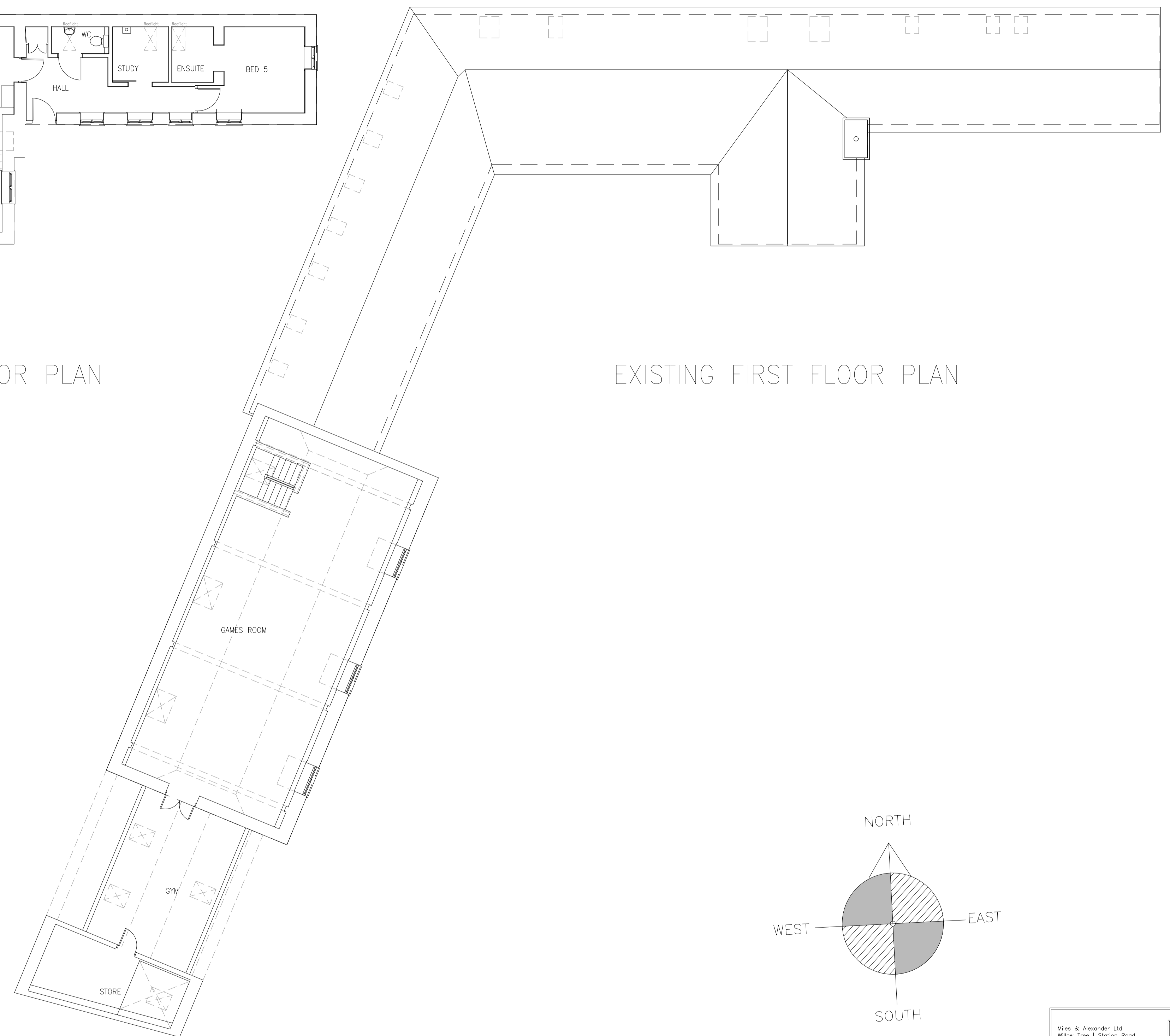

EXISTING FIRST FLOOR PLAN

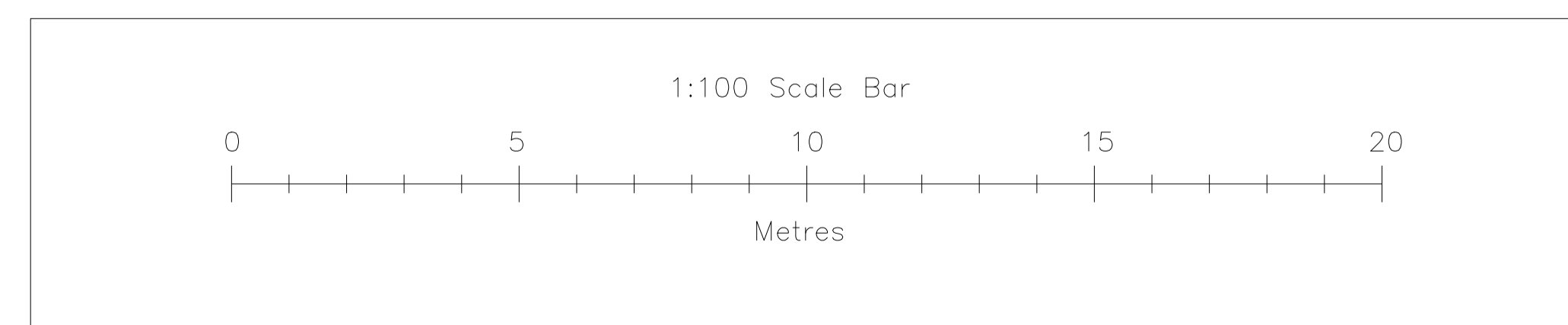
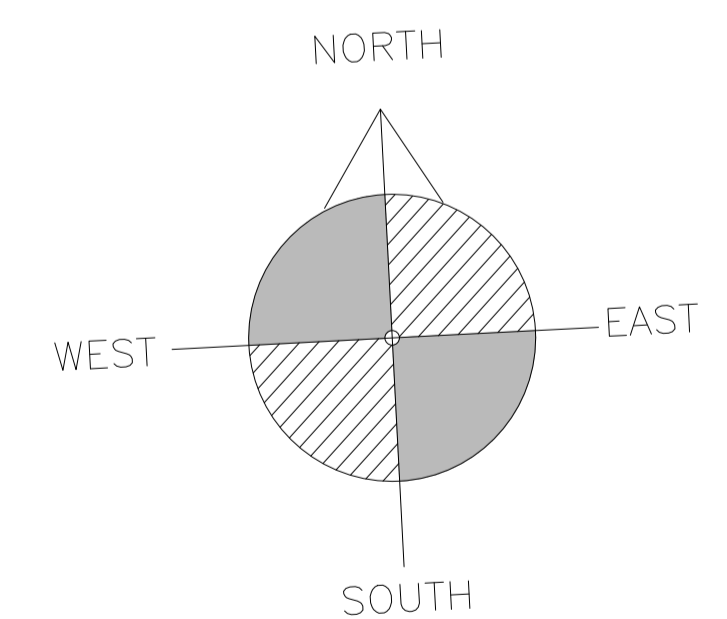

Miles & Alexander Ltd
 Willow Tree | Station Road
 Kirtlington | Oxfordshire | OX5 3HE
 M: 07795052483
 E: store@milesandalexander.co.uk



MILES & ALEXANDER LTD
 Architectural Design

Client:
 Mr & Mrs M. Lewis
 The Bathy
 Brashfield House
 Coversfield
 Oxfordshire, OX27 8RE

Project:
 Creation of two dwellings from
 existing house with associated
 proposed extensions

Drawing:
 EXISTING FLOOR PLANS

Date: JULY 2018	Scale: 1:100 @ A1	Drawn by: SPW
Dwg No: MA-191018-20		Rev: -

Sheet Size: A1