

**Appendix A – Proposed Development (x1 page)**

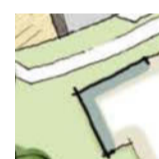

- A Site access
- B Existing hedges and trees to be retained and enhanced.
- C New Pedestrian Link to connect site to West Hawthorne Road.
- D Potential play/recreational facilities
- E Potential attenuation feature
- F Main spine road to have street tree planting
- G Pedestrian Link to Ploughley Road
- H Development around the edges of the site to be more informal to provide a rural edge character.
- I Primary street to have greater formality with emphasis on structured landscape and tree planting to front gardens
- J Extensive green spaces that interconnect to provide green corridors and enhance the rural feel of the development as well as potential for biodiversity enhancement.
- K A mix of 2, 3 & 4 bedroom houses with an emphasis on smaller family homes.
- L North West boundary to have new hedge planting and potential ditch feature
- M Indicative Pumping Station Location

-  Site boundary
-  Primary frontage
-  Secondary frontage
-  Shared Surface Road
-  Existing trees and hedges
-  Proposed tree planting to open space areas.

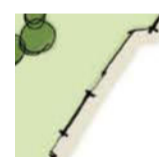
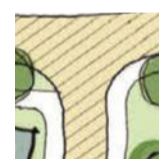
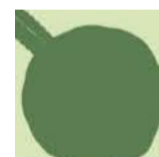
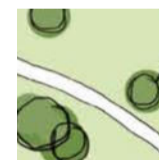
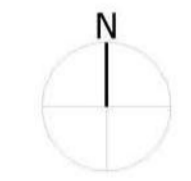

Project  
**Ploughley Road, Ambrosden**

Drawing Title  
**Framework Plan**

Date 09.06.2022	Scale 1:1000@A1	Drawn by BW	Check by JT
Project No 32948	Drawing No FP-01	Revision	

**BARTON WILLMORE** now **Stantec**

Town Planning • Master Planning & Urban Design • Architecture •  
Landscape Planning & Design • Infrastructure & Environmental Planning •  
Heritage • Graphic Communication •  
Communications & Engagement • Development Economics

bartonwillmore.co.uk

Offices at Birmingham Bristol Cambridge Cardiff Ebbw Vale Edinburgh  
Glasgow Leeds London Manchester Newcastle Reading Southampton

clarkebond

**Appendix B – Topographic Survey (x8 page)**



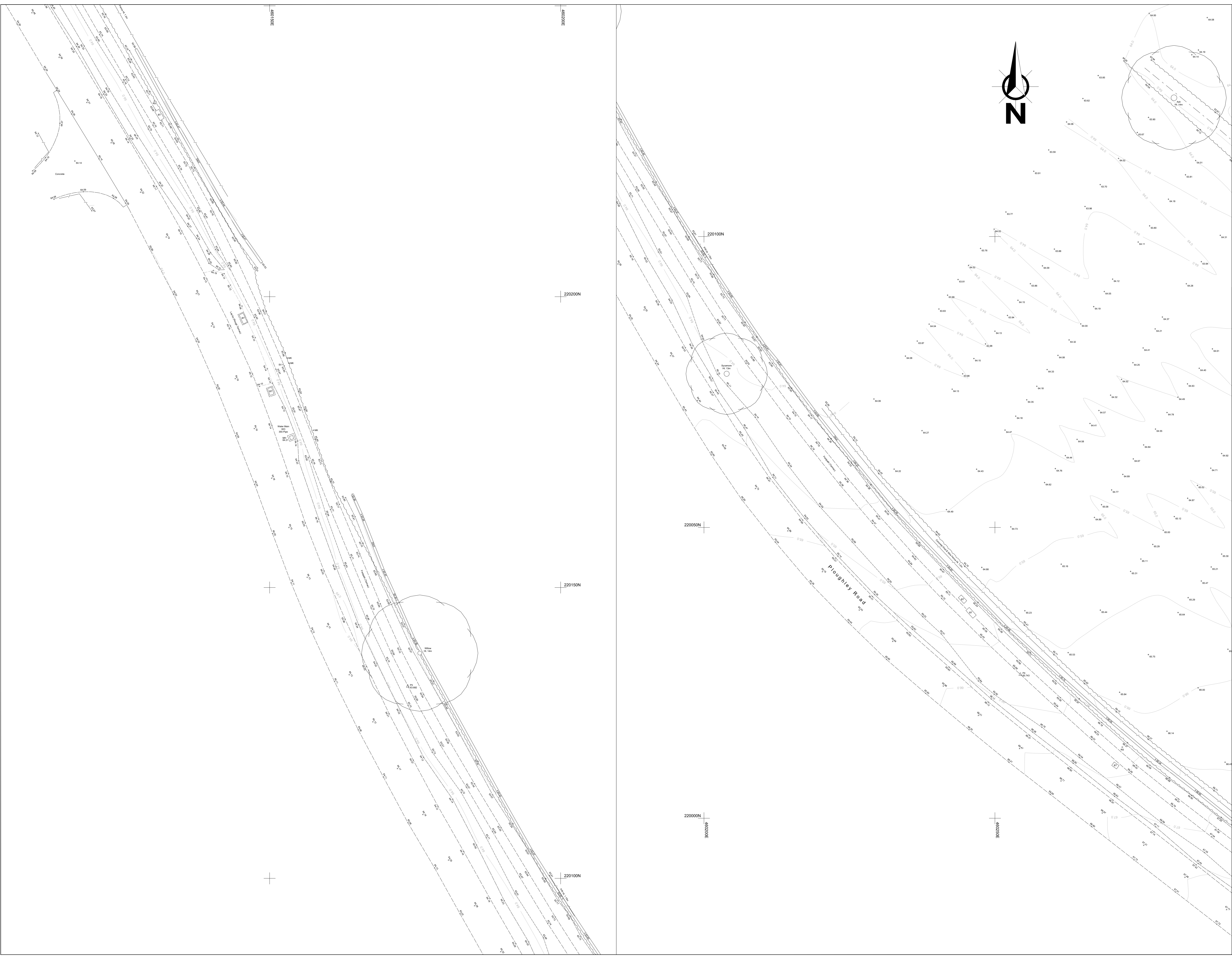

**Abbreviations:**

AU	Air Conditioning Unit	P	Pipe
AV	Ar Vapor	PC	Pipe
B	Bolt	PM	Parking Meter
BH	Borrhus	RE	Roading Eye
BL	Bl Level	RL	Ridge Level
BS	Bus Stop	RP	Reflector Post
CB	Cable Telecom Cover	SC	Staircase
B/P/W	Block Retaining Wall	RM	Retaining Wall
CS	Control Box	RMF	Road Meter Pipe
CTV	Cable TV Cover	ST	Stump
CCTV	Cable CCTV	SL	Spill Level
CL	Cover Level	SN	Sign
COL	Column	SNV	Soil Valve
Conc	Concrete	SVP	Soil & Vent Pipe
CP	Concrete Paving Slabs	S/W	Stone Retaining Wall
CPK	Chimney Pot Course	S/W	Surface Water
CPK	Down Pipe	SB	Surface Boundary
CP	Cover Plate	TB	Tank Bottom
CS	Cover Slab	TL	Traffic Light
CS	Cover Slab	TL	Traffic Light
EP	Electricity Pole	TW	Top of Wall Level
EP	Iron Post	US	Underpass
F1	Floor Level	USL	Unable To Lift
F1/HT	Front Height	VP	Vent Pipe
FM	Fuel Meter	M	Water Level
GD	Ground Drain	MM	Water Meter
G	Gully	WO	Wash Out
GP	Gas Pipe	W	Water Top
CP	Cast Post	Ø	Diameter
AL	Height		
C	Inspection Chamber		
I	Invert Level		
KS	Kern Cuttle	B/W	Barbed Wire
LD	Latter	C/P	Cable Pipe
LF	Letter Box	C/B	Crane Board
L	Lamp Post	C/S	Corrosion
M	Mains	C/L	Chain Line
MS	Mains Box	C/P	Chimney Pot
M	Monitor Post	I/W	Iron Ring
M	Mains	F/W	Foot & Nail
NP	Name Plate	P/W	Post & Wire
OSM	Ordnance Survey Bench Mark		
OH	Overhead		

**General Notes:**

1. Man entry to sewers has not been undertaken. Depths, size sizes and quantity of pipes are measured from the surface. We therefore cannot guarantee the completeness or accuracy of the sewer data which should be checked with the local authority or sdn/in site.
2. All tree heights and spreads are approximate. The area position of trunks are taken at ground level. Girth measurements are taken at a 1.5m height. We have attempted to identify tree species, however if tree species are critical specialist advice should be sought.
3. This drawing has been prepared in accordance with the scope of AHP's appointment, with its client and is subject to the terms and conditions of that appointment. AHP accepts no liability for any use of this document other than by client and only for the purposes for which it was prepared and provided.
4. If received electronically it is the recipient's responsibility to print to the correct scale. Only written dimensions should be used.

**CONTROL**

Name	Eastings	Northings	Height	Remarks
P1	462516.623	219791.315	73.690	Pk. Nail
P2	462522.962	219845.240	73.524	Pk. Nail
P3	462531.112	219845.293	69.094	Pk. Nail
P4	46254.366	22024.211	65.143	Pk. Nail
P5	46173.737	220133.015	63.882	Pk. Nail
P6	46267.266	220133.015	64.379	Pk. Nail
P7	46263.300	220448.094	67.101	Pk. Nail
P8	46262.064	220133.015	67.949	Pk. Nail
P10	46254.754	219868.006	75.083	Timber Peg
P11	46262.464	219818.453	75.808	Timber Peg
P12	46265.904	219878.267	76.124	Timber Peg
P13	46268.288	22029.892	75.201	Timber Peg
P14	46233.836	220261.287	77.327	Timber Peg
P15	46253.351	220235.669	77.906	Timber Peg
P16	46261.594	220062.226	76.322	Timber Peg

**Notes:**

Grid & Levels are related to Ordnance Survey National Grid & Datum using multiple real time GPS observations.  
 A Scale Factor of 0.9999976 has been applied.  
 Full tree computer & Sd information are on frozen layers.

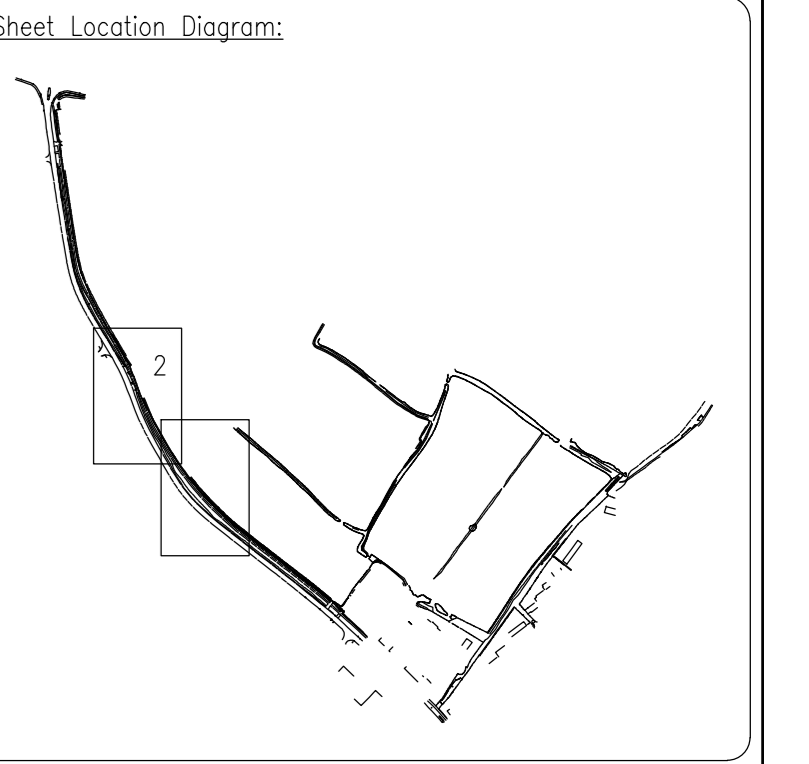

REV NO	REV NOTE	DATE	SIGNED

Client: BELLWAY HOMES LTD  
 Project: PLOUGHLEY ROAD  
 AMBROSDEN  
 BICESTER OX25 2RB  
 Title: TOPOGRAPHICAL SURVEY  
 Dwg. No: HS1102\_2 Revision: A  
 Date: 05.04.22 Scale: 1:200 @ A0  
 Status: FINAL Sheet: 2 of 8

**AHP Surveys**  
 90 Wolverton Road, Haversham, Bucks, MK19 7AB  
 Tel: 07522 540529 Email: alexis.h.pons@outlook.com



**Abbreviations:**

ACU	Air Conditioning Unit	P	Pipe
AV	Air Valve	PC	Pipe
B	Bench Mark	PA	Parking Meter
BR	Burrows	RE	Retaining Wall
BL	Bed Level	RL	Right Level
BS	Bus Stop	RP	Reflector Post
CB	Block Access Cover	RC	Reinforcing Concrete
B/W	Block Retaining Wall	RM	Retaining Wall
CD	Center Drive	RMP	Right Meter Pipe
CTV	Cable TV Cover	ST	Slump
CCTV	Close Circuit TV	SL	Soil Level
CL	Cover Level	SV	Stop Valve
COL	Column	SV	Stop Valve
Conc.	Concrete	S/W	Soil & Vent Pipe
CPC	Concrete Paving Slabs	S/W	Stone Retaining Wall
DPC	Damp Proof Course	SW	Surface Water
DR	Down Pipe	SW	Surface Water
EP	Eaves Pipe	TB	Traffic Bank
EL	Eaves Level	TL	Traffic Light
EN	Engraving	TR	Telephone
EP	Electricity Pole	TW	Top of Wall Level
FP	Fire Hydrant	US	Underpass
FL	Floor Level	UL	Unable to Lift
F/LIGHT	Front Light	VP	Vent Pipe
FM	Ford Motor	W	Water Level
GD	Ground Drain	WM	Water Meter
GY	Gully	WO	Wash Out
CA	Gas Appliance	WT	Water Top
CP	Gate Post	Ø	Diameter
AL	Height		
C	Inspection Chamber		
L	Invert Level		
KC	Kerb Curb	B/W	Barbed Wire
LD	Lamp Post	C/P	Crane Boarded
LMP	Lamp Post	C/P	Crane Boarded
MB	Mulch-Run Tree	C/S	Chain Link Fence
M	Masonry	C/P	Chain Link Fence
MP	Motor Post	I/W	Iron Rolling
MS	Metal Sign	F/W	Fork & Nail
NP	Name Plate	P/W	Post & Wire
OSM	Ordnance Survey Bench Mark		
OH	Overhead		

- General Notes:**
1. No entry to sewers has not been undertaken. Depths, size and quantity of pipes are measured from the surface. We therefore cannot guarantee the completeness or accuracy of the sewer data which should be checked with the local authority or sdn/in site.
  2. All tree heights and spreads are approximate. The true position of trunks are taken at ground level. Girth measurements are taken at a 1.5m height. We have attempted to identify tree species, however if tree species are critical specialist advice should be sought.
  3. This drawing has been prepared in accordance with the scope of the appointment, with the client and is subject to the terms and conditions of that appointment. All accept no liability for any use of this document other than by client and only for the purposes for which it was prepared and provided.
  4. If received electronically it is the recipient's responsibility to print to the correct scale. Only written dimensions should be used.

Name	Eastings	Northings	Height	Remarks
P1	480518.623	219791.315	73.890	PK Nail
P2	480520.002	219845.240	73.524	PK Nail
P3	480533.112	219845.293	69.094	PK Nail
P4	480524.586	220024.211	65.743	PK Nail
P5	480737.737	220133.015	63.882	PK Nail
P6	480695.586	220011.633	64.379	PK Nail
P7	480663.300	220448.094	63.101	PK Nail
P8	480602.064	220335.616	63.949	PK Nail
P10	480674.754	219868.006	75.083	PK Nail
P11	480602.444	219818.643	75.898	Timber Peg
P12	480655.904	219978.267	76.124	Timber Peg
P13	480608.288	220029.892	75.521	Timber Peg
P14	480737.636	220081.287	77.322	Timber Peg
P15	480753.351	220125.969	77.906	Timber Peg
P16	480691.594	220062.226	76.322	Timber Peg

**Notes:**  
Grid & Levels are related to Ordnance Survey National Grid & Datum using multiple real time GPS observations.  
A Scale Factor of 0.9999076 has been applied.  
Full tree canopy & 5% information are on frozen layers.

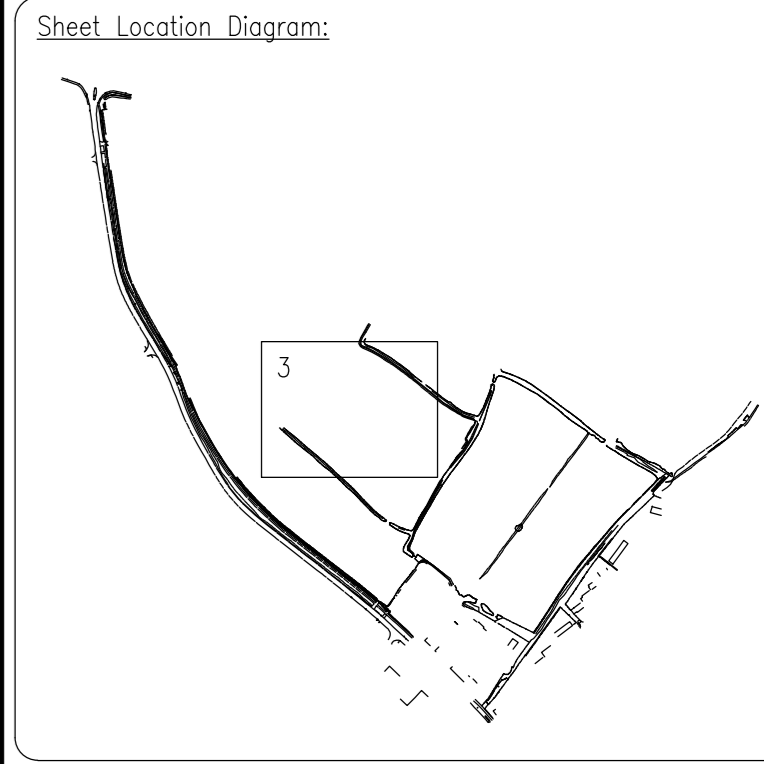

REV NO	REV NOTE	DATE	SIGNED
--------	----------	------	--------

Client: BELLWAY HOMES LTD

Project: PLOUGHLEY ROAD  
AMBROSDEN  
BICESTER OX25 2RB

Title: TOPOGRAPHICAL SURVEY

Dwg. No: HS1102\_3 Revision: A

Date: 05.04.22 Scale: 1:200 @ A0

Status: FINAL Sheet: 3 of 8

**AHP Surveys**  
90 Wolverton Road, Eynsham, Bucks, MK19 7AB  
Tel: 07522 540529 Email: alexis.h.pons@outlook.com



**Abbreviations:**

AU	Air Conditioning Unit	P	Pipe
AV	Air Valve	PC	Pipe
B	Blank	PM	Pressure Meter
BA	Barricade	RF	Roofing Eave
BL	Blank Level	RL	Ridge Roof
BS	Bus Stop	RP	Reflector Post
B/W	Black & White Cover	RS	Road Sign
B/W	Black Retaining Wall	RW	Road Water Pipe
CD	Control Box	SB	Spot Level
CTV	Cable TV Cover	ST	Stump
CCTV	Cable TV	SL	Spot Level
CL	Clear Level	SV	Spot Valve
CL	Column	SW	Soil & Vent Pipe
Conc.	Concrete	S/W	Stone Retaining Wall
CPC	Concrete Paving Slabs	SUR	Surface Water
D	Damp Proof Course	TA	Tank
DA	Damp Area	TR	Trench
DE	Down Pipe	TL	Traffic Light
EL	Eaves Level	TS	Telephone Cabinet
EN	Electric Pole	US	Underpass
EP	Electric Pole	UV	Up to Wall Level
FR	From Height	UW	Underpass
FL	Floor Level	UL	Unable to Lift
F/HT	Front Height	UP	Up
FM	Ford Meter	W	Water Level
FD	Ford Drain	WM	Water Meter
GT	Gully	WO	Wash Out
GV	Gully Valve	W	Water Top
CP	Gully Post	Ø	Diameter
AL	Height		
C	Inspection Chamber		
IC	Invert Level		
IC	Iron Casing	B/W	Barbed Wire
LF	Lamp Post	C/P	Chain Buried
LP	Lamp Post	C/S	Corroded Iron
MB	Mud-Bank	C/L	Chain Line
MB	Mud-Bank	C/P	Chain Piling
M	Mortar Post	I/R	Iron Ring
M	Mortar Post	P/W	Post & Rail
NS	Name Plate	P/W	Post & Wire
OSM	Ordnance Survey Bench Mark		
OH	Overhead		

**General Notes:**

1. No entry to sewers has not been undertaken. Depths, size and quantity of pipes are measured from the surface. We therefore cannot guarantee the completeness or accuracy of the sewer data which should be checked with the local authority or end/user site.
2. All tree heights and spreads are approximate. The plan position of trunks are taken at ground level. Girth measurements are taken at a 1.5m height. We have attempted to identify tree species, however if tree species are critical specialist advice should be sought.
3. This drawing has been prepared in accordance with the scope of work's agreement with the client and is subject to the terms and conditions of this agreement. We accept no liability for any use of this drawing other than by the client and only for the purposes for which it was prepared and provided.
4. If received electronically it is the recipient's responsibility to print to the correct scale. Only written dimensions should be used.

Name	Eastings	Northings	Height	Remarks
P1	46516.623	219791.315	73.690	PK Nail
P2	46516.622	21985.240	73.524	PK Nail
P3	46516.621	21984.793	69.094	PK Nail
P4	46516.620	22024.211	65.143	PK Nail
P5	46516.619	22013.015	65.882	PK Nail
P6	46516.618	22011.833	64.379	PK Nail
P7	46516.617	22048.094	67.101	PK Nail
P8	46516.616	22033.516	67.948	PK Nail
P9	46516.615	21988.026	75.083	Timber Peg
P10	46516.614	21978.267	75.088	Timber Peg
P11	46516.613	22029.892	75.021	Timber Peg
P12	46516.612	22001.267	77.322	Timber Peg
P13	46516.611	22025.069	77.926	Timber Peg
P14	46516.610	22002.226	76.322	Timber Peg

**Notes:**  
Grid & Levels are related to Ordnance Survey National Grid & Datum using multiple real time GPS observations.  
A Scale Factor of 0.9999976 has been applied.  
Full tree complete & 1/2 information are on frozen layers.

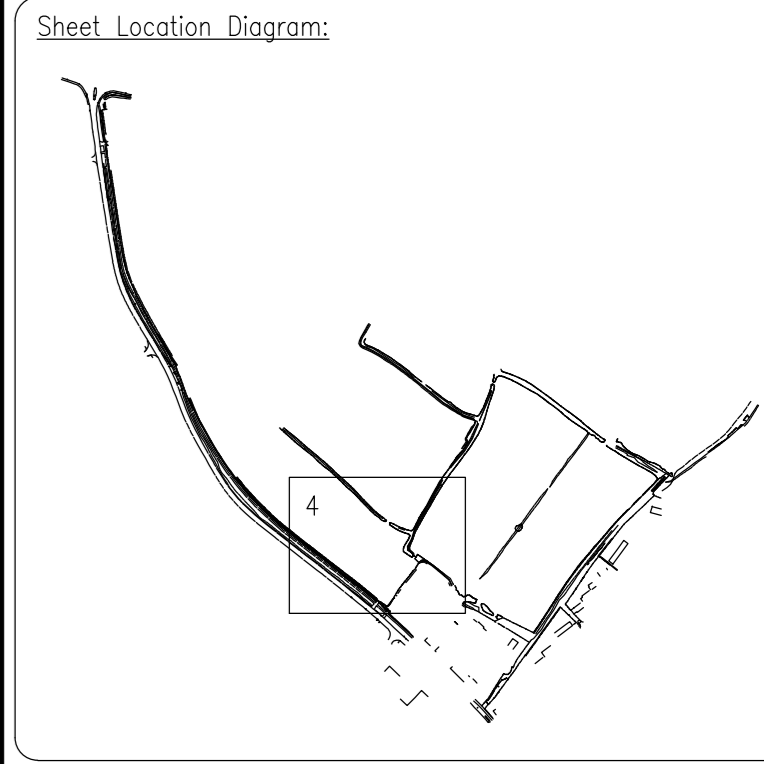

REV NO	REV NOTE	DATE	SIGNED

Client: BELLWAY HOMES LTD  
 Project: PLOUGHLEY ROAD  
 AMBROSDEN  
 BICESTER OX25 2RB  
 Title: TOPOGRAPHICAL SURVEY  
 Dwg. No: HS1102\_4 Revision: A  
 Date: 05.04.22 Scale: 1:200 @ A0  
 Status: FINAL Sheet: 4 of 8

**AHP Surveys**  
 90 Wolverton Road, Eversham, Bucks, MK19 7AB  
 Tel: 07522 540529 Email: alex.h.pond@outlook.com

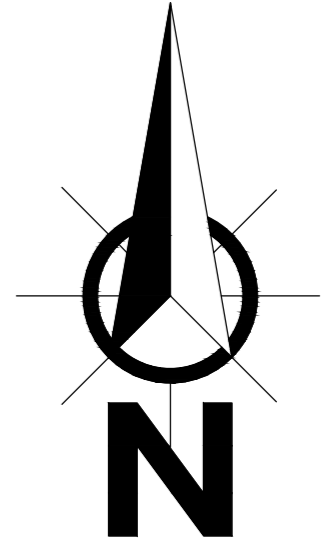

**Abbreviations:**

ACU	Air Conditioning Unit	P	Pipe
AV	Air Valve	PC	Pipe
Bl	Blind	PM	Parking Meter
BH	Bornhole	RF	Roading Eye
BL	Blind Level	RL	Ridge Level
BS	Bus Stop	RP	Reflector Post
BS	British Telecom Cover	RS	Road Sign
B/W	Block Retaining Wall	RM	Retaining Wall
CB	Control Box	RMP	Road Meter Pipe
CTV	Cable TV Cover	ST	Stump
CCTV	Close Circuit TV	SL	Soil Level
CL	Clear Level	SV	Stop Valve
COL	Column	SV	Stop Valve
Comp.	Concrete	SWP	Soil & Vent Pipe
CPC	Concrete Paving Slabs	SWR	Stone Retaining Wall
DPC	Damp Proof Course	SZ	Surface Water
DR	Down Pipe	TC	Tarred Road
DP	Drip Pipe	TB	Telephone Call Box
EL	Eaves Level	TL	Traffic Light
EP	Electric Pole	TS	Terrace
EP	Electric Pole	TW	Top of Wall Level
EP	Iron Post	US	Underpass
FL	Floor Level	UL	Unable to Lift
FLIGHT	Flight	UP	Underpass
FM	Fuel Meter	W	Water Level
GD	Ground Drain	WM	Water Meter
GY	Gully	WO	Wash Out
GV	Gully Valve	WT	Water Top
CP	Gas Post	Ø	Diameter
AL	Height		
C	Inspection Chamber		
I	Invert Level		
KS	Keel Cut	B/W	Barbed Wire
LD	Latent Drain	C/B	Cable Buried
LF	Latent Flow	C/P	Corroded Iron
LP	Leaky Pipe	C/L	Chlorine Line
M	Manhole	C/P	Chlorine Piping
MB	Mini-Bus Stop	I/R	Iron Railing
M	Manhole	P/S	Post & Rail
MP	Motor Post	P/W	Post & Wire
MS	Main Sewer		
NP	Name Plate		
OSM	Ordnance Survey Bench Mark		
OH	Overhead		

**General Notes:**

1. No entry to sewers has not been undertaken. Depths, size and quantity of pipes are measured from the surface. We therefore cannot guarantee the completeness or accuracy of the sewer data which should be checked with the local authority or sdn/in site.
2. All tree heights and spreads are approximate. The plan position of trunks are taken at ground level. Girth measurements are taken at a 1.5m height. We have attempted to identify tree species, however if tree species are critical specialist advice should be sought.
3. This drawing has been prepared in accordance with the scope of the agreement with the client and is subject to the terms and conditions of that agreement. All clients accept liability for any use of this document other than by the client and only for the purposes for which it was prepared and provided.
4. If received electronically it is the recipient's responsibility to print to the correct scale. Only written dimensions should be used.

**CONTROL**

Name	Eastings	Northings	Height	Remarks
P1	462516.623	219791.115	73.690	PK. Nail
P2	462520.002	219845.340	73.524	PK. Nail
P3	462533.112	219845.793	69.094	PK. Nail
P4	462524.886	220324.211	65.743	PK. Nail
P5	462733.237	220333.015	63.682	PK. Nail
P6	462625.266	220313.633	64.379	PK. Nail
P7	462623.300	220448.094	67.101	PK. Nail
P8	462625.264	220333.016	67.946	PK. Nail
P10	462624.754	219848.026	75.083	Timber Peg
P11	462623.444	219818.643	75.898	Timber Peg
P12	462625.804	219978.267	76.124	Timber Peg
P13	462628.288	220229.892	75.521	Timber Peg
P14	462733.636	220061.267	77.322	Timber Peg
P15	462733.351	220325.669	77.926	Timber Peg
P16	462691.594	220062.226	76.322	Timber Peg

**Notes:**  
Grid & Levels are related to Ordnance Survey National Grid & Datum using multiple real time GPS observations.  
A Scale Factor of 0.9999976 has been applied.  
Full tree compass & 3d information are on frozen layers.

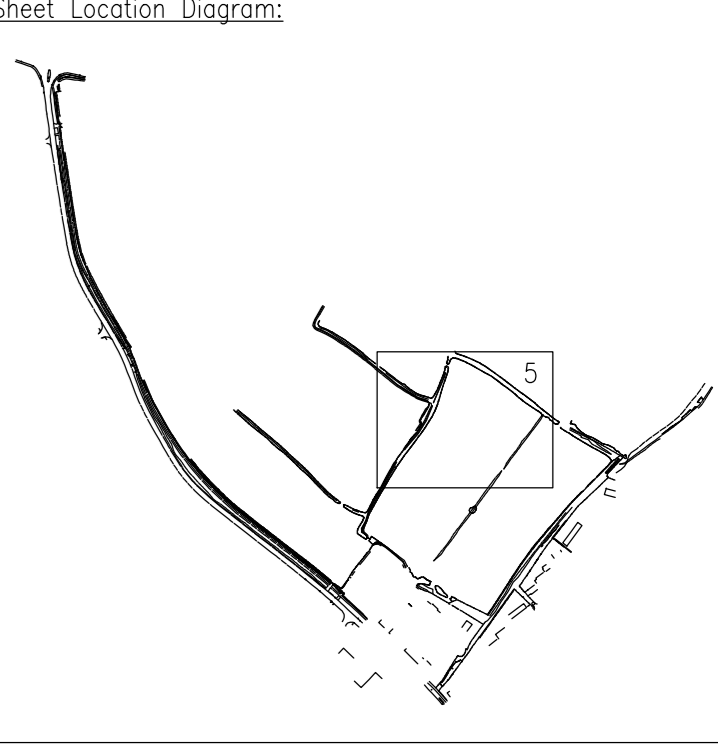

REV NO/REV NOTE	DATE	SIGNED

Client: BELLWAY HOMES LTD  
 Project: PLOUGHLEY ROAD  
 AMBROSDEN  
 BICESTER OX25 2RB  
 Title: TOPOGRAPHICAL SURVEY  
 Dwg. No: HS1102\_5 Revision: A  
 Date: 05.04.22 Scale: 1:200 @ A0  
 Status: FINAL Sheet: 5 of 8

**AHP Surveys**  
 90 Wolverton Road, Haversham, Bucks, MK19 7AB  
 Tel: 07522 540529 Email: alex.h.p@outlook.com





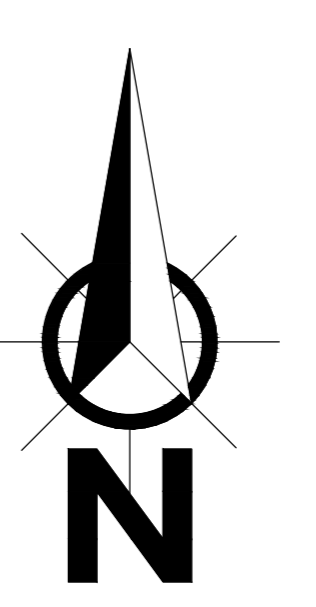
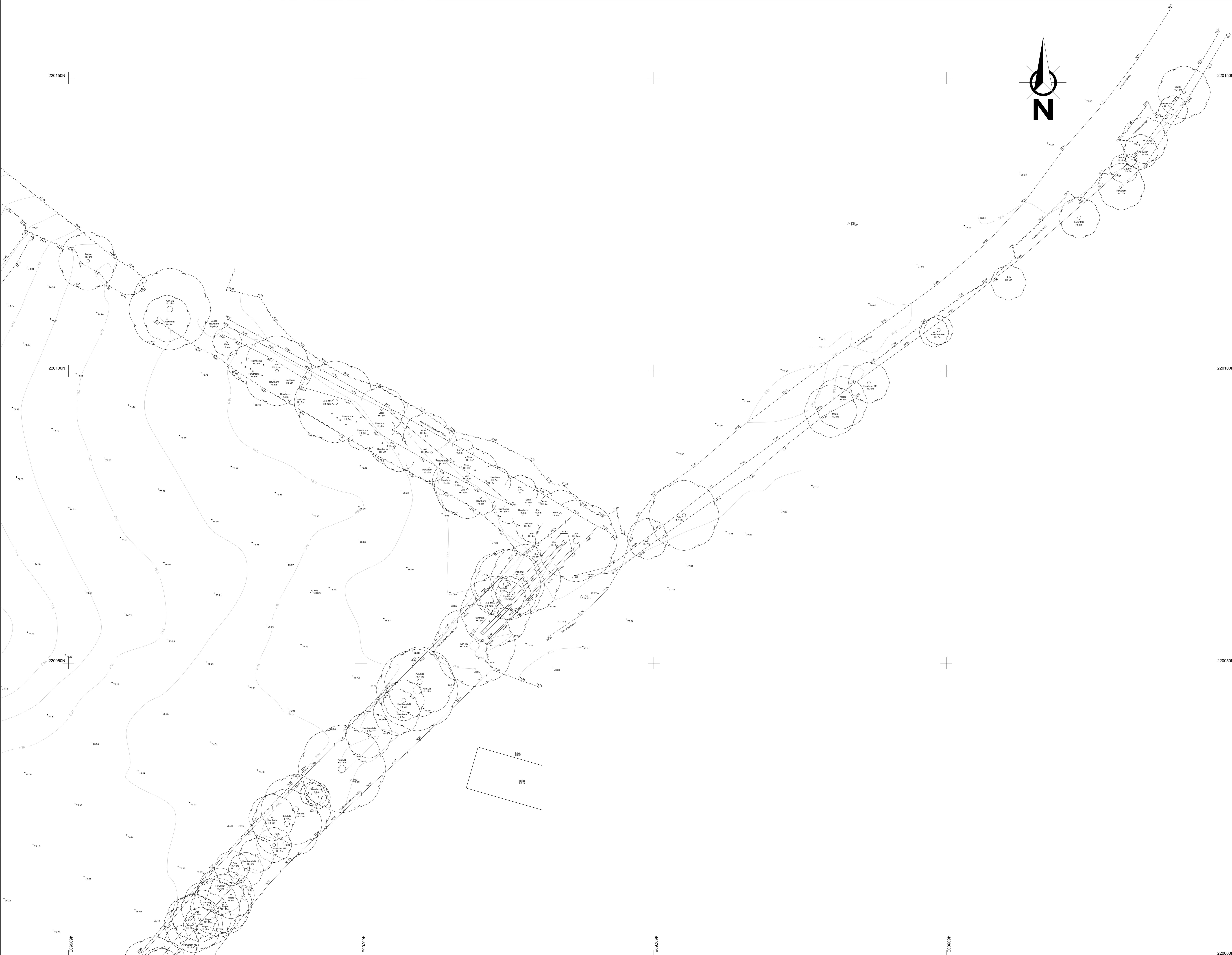

**Abbreviations:**

A/CU	Air Conditioning Unit	P	Pipe
AV	Air Valve	PC	Pipe
B	Boundary	PM	Parking Meter
BH	Bornhus	RF	Roofing Eye
BL	Bell Level	RL	Ridge Level
BS	Bus Stop	R	Reflector Post
BS	Bracon Access Cover	RS	Round Sign
B/W	Brick Retaining Wall	RW	Roofing Water
CB	Control Box	RWF	Roof Water Pipe
CD	Close Circuit TV	ST	Stump
CL	Cable TV Cover	SL	Soil Level
CL	Cover Level	SV	Stop Valve
CL	Column	SV	Stop Valve
Comp	Concrete	SW	Soil & Vent Pipe
CP	Concrete Paving Slabs	SW	Stone Retaining Wall
DPC	Damp Proof Course	S/W	Surface Water
D/W	Down Pipe	SH	Surface Handicap
D/S	Down Rise	SS	Structural Steel Box
EL	Eaves Level	TL	Traffic Light
EP	Electric Pole	US	Understand
EP	Iron Post	UL	Under Level
EP	Electric Pole	UL	Under Level
FL	Floor Level	UL	Under Level
F/L	Flange Light	UP	Under Level
FM	Fuel Meter	M	Water Level
GD	Ground Crane	MM	Water Meter
GT	Gully	MO	Wash Out
GV	Gas Valve	MT	Water Top
GP	Gully Post	D	Diameter
H	Height		
I	Inspection Chamber		
I	Invert Level		
IC	Iron Cistern	B/W	Barbed Wire
IC	Iron Cistern	C/P	Chain Boarding
L	Light	C	Corrosion
LP	Light Post	C/P	Chain Boarding
L	Light	C/P	Chain Boarding
LP	Light Post	C/P	Chain Boarding
M	Masonry	C/P	Chain Boarding
M	Masonry	C/P	Chain Boarding
M	Masonry	C/P	Chain Boarding
M	Masonry	C/P	Chain Boarding
M	Masonry	C/P	Chain Boarding
M	Masonry	C/P	Chain Boarding
M	Masonry	C/P	Chain Boarding
M	Masonry	C/P	Chain Boarding
M	Masonry	C/P	Chain Boarding
M	Masonry	C/P	Chain Boarding

**General Notes:**

1. Man entry to sewers has not been undertaken. Depths, size sizes and quantity of pipes are measured from the surface. We therefore cannot guarantee the completeness or accuracy of the sewer data which should be checked with the local authority or sdn/ln site.
2. All tree heights and spreads are approximate. The plan position of trunks are taken at ground level. Girth measurements are taken at a 1.5m height. We have attempted to identify tree species, however if tree species are critical specialist advice should be sought.
3. This drawing has been prepared in accordance with the scope of work's appointment with it's client and is subject to the terms and conditions of that appointment. We accept no liability for any use of this document other than by the client and only for the purposes for which it was prepared and provided.
4. If required electronically it is the recipient's responsibility to print to the correct scale. Only written dimensions should be used.

Name	Eastings	Northings	Height	Remarks
P1	460516.623	219791.315	73.690	PK Nod
P2	460402.002	219845.240	73.524	PK Nod
P3	460503.112	219845.293	69.094	PK Nod
P4	460254.866	220024.211	65.743	PK Nod
P5	460737.727	220133.015	63.682	PK Nod
P6	460295.466	220133.015	64.379	PK Nod
P7	460263.300	220448.094	63.101	PK Nod
P8	460202.064	220333.016	63.949	PK Nod
P10	460274.754	219848.026	75.083	PK Nod
P11	460272.444	219818.643	75.898	Timber Peg
P12	460255.904	219778.267	76.124	Timber Peg
P13	460268.288	220029.892	75.501	Timber Peg
P14	460737.636	220061.287	73.302	Timber Peg
P15	460730.351	220125.969	73.908	Timber Peg
P16	460691.594	220062.226	76.322	Timber Peg

**Notes:**  
 Grid & Levels are related to Ordnance Survey National Grid & Datum using multiple real time GPS observations.  
 A Scale Factor of 0.9999976 has been applied.  
 Full tree complex & 50 information are on frozen layers.

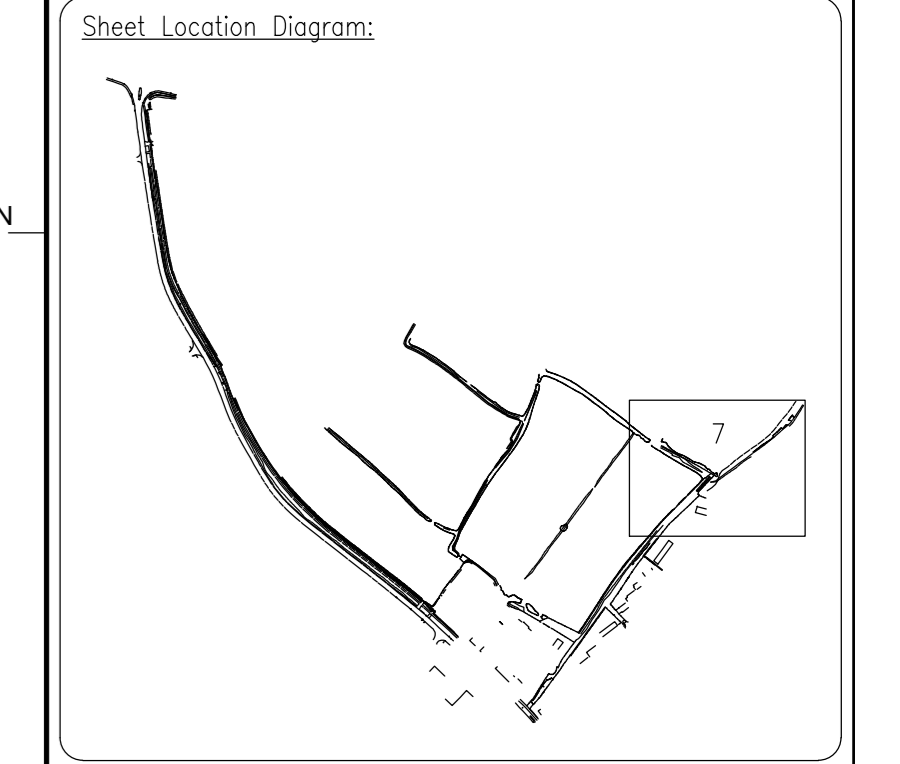

REV NO	REV NOTE	DATE	SIGNED

Client: BELLWAY HOMES LTD

Project: PLOUGHLEY ROAD  
 AMBROSDEN  
 BICESTER OX25 2RB

Title: TOPOGRAPHICAL SURVEY

Dwg. No: HS1102\_7 Revision: A

Date: 05.04.22 Scale: 1:200 @ A0  
 Status: FINAL Sheet: 7 of 8



