

BMD.19.010.DR.P101 LANDSCAPE GA (SHEET 1 OF 4)
 BMD.19.010.DR.P301 PLANTING PLAN (SHEET 1 OF 4)

BMD.19.010.DR.P102 LANDSCAPE GA (SHEET 2 OF 4)
 BMD.19.010.DR.P302 PLANTING PLAN (SHEET 2 OF 4)

BMD.19.010.DR.P104 LANDSCAPE GA (SHEET 4 OF 4)
 BMD.19.010.DR.P304 PLANTING PLAN (SHEET 4 OF 4)

BMD.19.010.DR.P103 LANDSCAPE GA (SHEET 3 OF 4)
 BMD.19.010.DR.P303 PLANTING PLAN (SHEET 3 OF 4)

This drawing is the property of Bradley Murphy Design Ltd. Copyright is reserved by them and the drawing is issued on the condition that it is not copied, reproduced, retained nor disclosed to any unauthorized person either wholly or in part without the consent of Bradley Murphy Design Ltd.

NOTES:

1. THIS DRAWING IS BASED ON THE FOLLOWING DOCUMENTS:
 - OS DRAWING: (10875-EPR-00-00-M2-A-01-0001-OSmap)
 - EPR BUILDING LAYOUT: (01-0201-PROPOSED SITE PLAN)
 - WSP TREE SURVEY: (705584-TOP-EV-01)
2. THIS DRAWING SHOULD BE READ IN CONJUNCTION WITH ALL OTHER LANDSCAPE DRAWINGS AND DOCUMENTS
3. THIS DRAWING IS NOT INTENDED FOR CONSTRUCTION
4. DO NOT SCALE FROM THIS DRAWING
5. ANY DISCREPANCIES WITHIN THIS DRAWING OR BETWEEN THIS DRAWING AND ANY OTHER INFORMATION IS TO BE REPORTED TO BMD FOR CLARIFICATION

 **SITE BOUNDARY**
 FOR FURTHER INFORMATION ON SOFT AND HARD LANDSCAPE DETAILS, REFER TO LANDSCAPE GENERAL ARRANGEMENT DRAWINGS BMD.19.010.DR.P101-104 & PLANTING PLANS BMD.19.010.DR.P301-304

Rev	Description	Date
E	MINOR UPDATE FOLLOWING COMMENTS	08.11.19
D	UPDATED TO ARCHITECTS BASE	01.11.19
C	HMP APPENDIX A UPDATE	14.10.19
B	CYCLESTANDS & EV POINTS ADDED	03.10.19
A	UPDATES FOLLOWING TEAM COMMENTS	01.10.19

PLANNING
 Purpose of Issue
 Bradley Murphy Design Ltd
 6 The Courtyard
 Hatton Technology Park
 Dark Lane
 Hatton
 Warwickshire
 CV35 8XB
 t: 01926 676496
 e: info@bradleymurphydesign.co.uk
 www.bradleymurphydesign.co.uk
 Client



GREAT LAKES UK LIMITED

Project
 PROPOSED GREAT WOLF LODGE, CHESTERTON, BICESTER

Drawing Title
 OVERALL LANDSCAPE GENERAL ARRANGEMENT

Drawn	Checked	Approved	Date
AW	MP	RW	22/08/2019

Job No.	Scale	Sheet Size	Revision
19.010	1:1250	A1	E

Drawing Number
 BMD.19.010.DR.P001

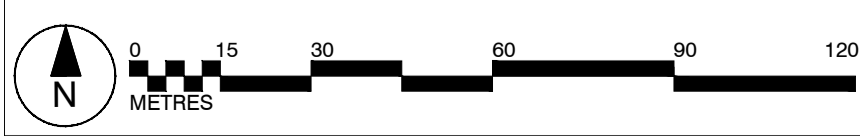

This drawing is the property of Bradley Murphy Design Ltd. Copyright is reserved by them and the drawing is issued on the condition that it is not copied, reproduced, retained nor disclosed to any unauthorized person either wholly or in part without the consent of Bradley Murphy Design Ltd.

NOTES:
 1. THIS DRAWING IS BASED ON BMD.19.010.DR.P001 OVERALL GA
 2. THIS DRAWING SHOULD BE READ IN CONJUNCTION WITH ALL OTHER LANDSCAPE DRAWINGS AND DOCUMENTS
 3. THIS DRAWING IS NOT INTENDED FOR CONSTRUCTION
 4. DO NOT SCALE FROM THIS DRAWING
 5. ANY DISCREPANCIES WITHIN THIS DRAWING OR BETWEEN THIS DRAWING AND ANY OTHER INFORMATION IS TO BE REPORTED TO BMD FOR CLARIFICATION

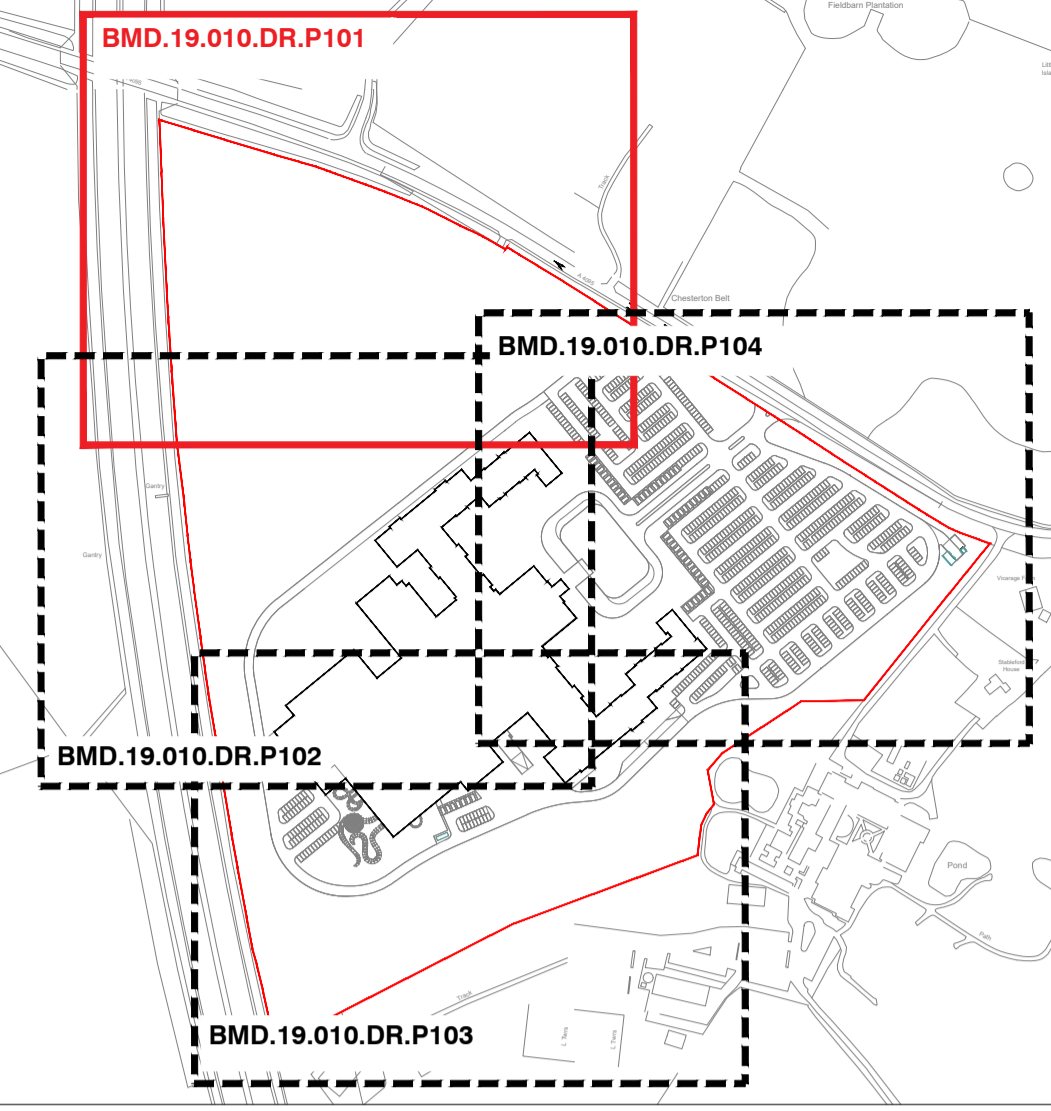

LEGEND

- FINGER POSTS / WAYFINDING BOLLARDS
WOODSCAPE FRAMEPOST SIGN OR SIMILAR / WOODSCAPE WAYFINDING TIMBER BOLLARDS OR SIMILAR
- FIRE HYDRANT LOCATION
FOR FURTHER DETAILS REFER TO HOME LEA INFORMATION
- LIFEBLOOM RING AROUND EXISTING & PROPOSED PONDS
FURTHER HEALTH & SAFETY ASSESSMENT TO BE CARRIED OUT AT A LATER STAGE BY A SUITABLY QUALIFIED ORGANISATION (SUCH AS A RSPB) TO DETERMINE ANY OTHER SAFETY MEASURES THAT MAY BE REQUIRED AROUND THE WATERBODIES
- ECOLOGICAL FEATURES**
 HEDGECOGS / BEE BANK
FOR BIODIVERSITY ENHANCEMENT / MASON BEES
 BRUSH PILES
FOR GREAT SPURTS
 SWIFT NEST CAVITY
NO 11 SCHAFFLER SHIPT NEST BOX
 HOUSE MARTIN NEST BOX
NO 11 SCHAFFLER HOUSE MARTIN TERRACE
 SPARROW TERRACE
NO 11 SCHAFFLER SPARROW TERRACE
 OTHER HUNG BIRD BOX
SCHAFFLER NO 11 85 1/2 1/2
 OTHER HUNG BAT BOX
SCHAFFLER NO 11 1/2 1/2 WOODEN BOX
 BADGER SIZE GAP IN FENCE (80CM-30CM)
 HEDGECOG / OTHER FAUNA GAP IN FENCE
SCHAFFLER NO 11 1/2 1/2 WOODEN BOX
- BOUNDARY TREATMENT**
 ACOUSTIC BARRIER (TO HOME LEA DETAILS)
 1.2M HIGH TIMBER BALUSTRADE (TO ENTRANCE POND)
 1.2M TIMBER POST & 4 RAIL
 TIMBER GATE
 1.8M WELDMESH FENCE
 ACCESS BARRIER
 EXISTING POST AND RAIL FENCE
- EXTERNAL LIGHTING**
 FOR FURTHER DETAILS REFER TO HOME LEA DOCUMENT LIGHTING DESIGN REFER: OC-181818-20190800-SA LIGHTING DESIGN CONCEPTS-03
 LIGHTING COLUMNS
 LIGHTING BOLLARDS
 LIGHTING TO BUILDING FACADE
 FOR DETAILS OF FEATURE LIGHTING (I.E. TREE LIGHTING) REFER TO HOME LEA DOCUMENT LIGHTING DESIGN REFER: OC-181818-20190800-SA LIGHTING DESIGN CONCEPTS-03
- SOFT LANDSCAPE**
 FOR FURTHER DETAILS REFER TO PLANTING PLANS & SCHEDULE (REFERENCE BMD.19.010.DR.P001-005)
 EXISTING TREES & WOODLAND TO BE RETAINED
 EXISTING TREES & WOODLAND TO BE REMOVED
 BOULEVARD TREES
 FEATURE PARKLAND TREES
 ORNAMENTAL FEATURE TREES
 CAR PARK TREES
 PARKLAND TREES
 WOODLAND PLANTING
 AMENITY SHRUB PLANTING
 NATIVE HEDGEROW
 SINGLE SPECIES HEDGEROW
 EXISTING MARGINAL PLANTING
 PROPOSED MARGINAL PLANTING
 AMENITY GRASS MIX
 MEADOW GRASS MIX
 WET MEADOW GRASS MIX
- HARD LANDSCAPE**
 MACADAM SURFACE
 REINFORCED GRASS
GRASSCOTE OR SIMILAR
 RESIN BOUND GRAVEL FOOTPATH
SURRESET RESIN BOUND GRAVEL OR SIMILAR
 SELF BOUND GRAVEL FOOTPATH
BREEDON SELF-BINDING GRAVEL OR SIMILAR
 BLOCK PAVING
WINDRESOR TUMBLED CLAY PAVERS OR SIMILAR
 PERMEABLE PAVING
MARSHALLS TESULA PERMEABLE PAVING OR SIMILAR
 TIMBER BRIDGE
BEAVER BRIDGES BOARDWALK OR SIMILAR
 TIMBER PICNIC BENCHES
WOODSCAPE STANDARD TAMPER PICNIC OR SIMILAR / WOODSCAPE AIRSHIRE PICNIC SET OR SIMILAR
 TIMBER BENCHES
WOODSCAPE CHAIR BACKREST SEAT OR SIMILAR / WOODSCAPE TOOTING BACKREST SEAT OR SIMILAR
 BINS
WOODSCAPE ROUND LOCKABLE LITTER BIN OR SIMILAR
 SCULPTURE LOCATION
GREAT WOLF SCULPTURE TO BE DETAILED AT A LATER STAGE
 ROCKS / BOULDERS
 MAIN ENTRANCE SIGNAGE
GREAT WOLF ENTRANCE SIGN TO BE DETAILED AT A LATER STAGE
 TIMBER BOLLARDS
WOODSCAPE TIMBER BOLLARDS OR SIMILAR
 ELECTRIC VEHICLE CHARGING POINTS
@ SPACES INCLUDING IN DISABLED BAYS REFER TO HOME LEA INFORMATION FOR FURTHER DETAILS

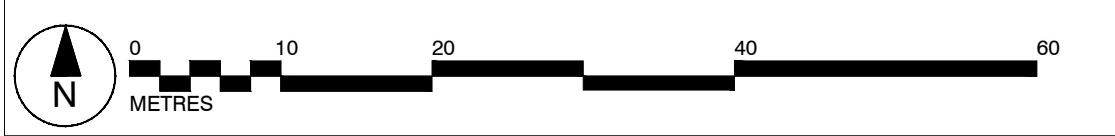

B	UPDATED TO LATEST ARCHITECTS LAYOUT	08.11.19
A	CYCLE PARKING AND EV POINTS ADDED	02.10.19
Rev	Description	Date

PURPOSE OF ISSUE
PLANNING
 Bradley Murphy Design Ltd
 6 The Courtyard
 Hatton Technology Park
 Dark Lane
 Hatton
 Warwickshire
 CV35 8XB
 t: 01926 676496
 e: info@bradlaimurphydesign.co.uk
 www.bradlaimurphydesign.co.uk
 Client



GREAT LAKES UK LIMITED

Project
 PROPOSED GREAT WOLF LODGE, CHESTERTON, BICESTER

Drawing Title
 LANDSCAPE GENERAL ARRANGEMENT SHEET 1 OF 4

Drawn	Checked	Approved	Date
AW	MP	RW	15/08/2019
Job No.	Scale	Sheet Size	Revision
19.010	1:500	A1	B
Drawing Number BMD.19.010.DR.P101			

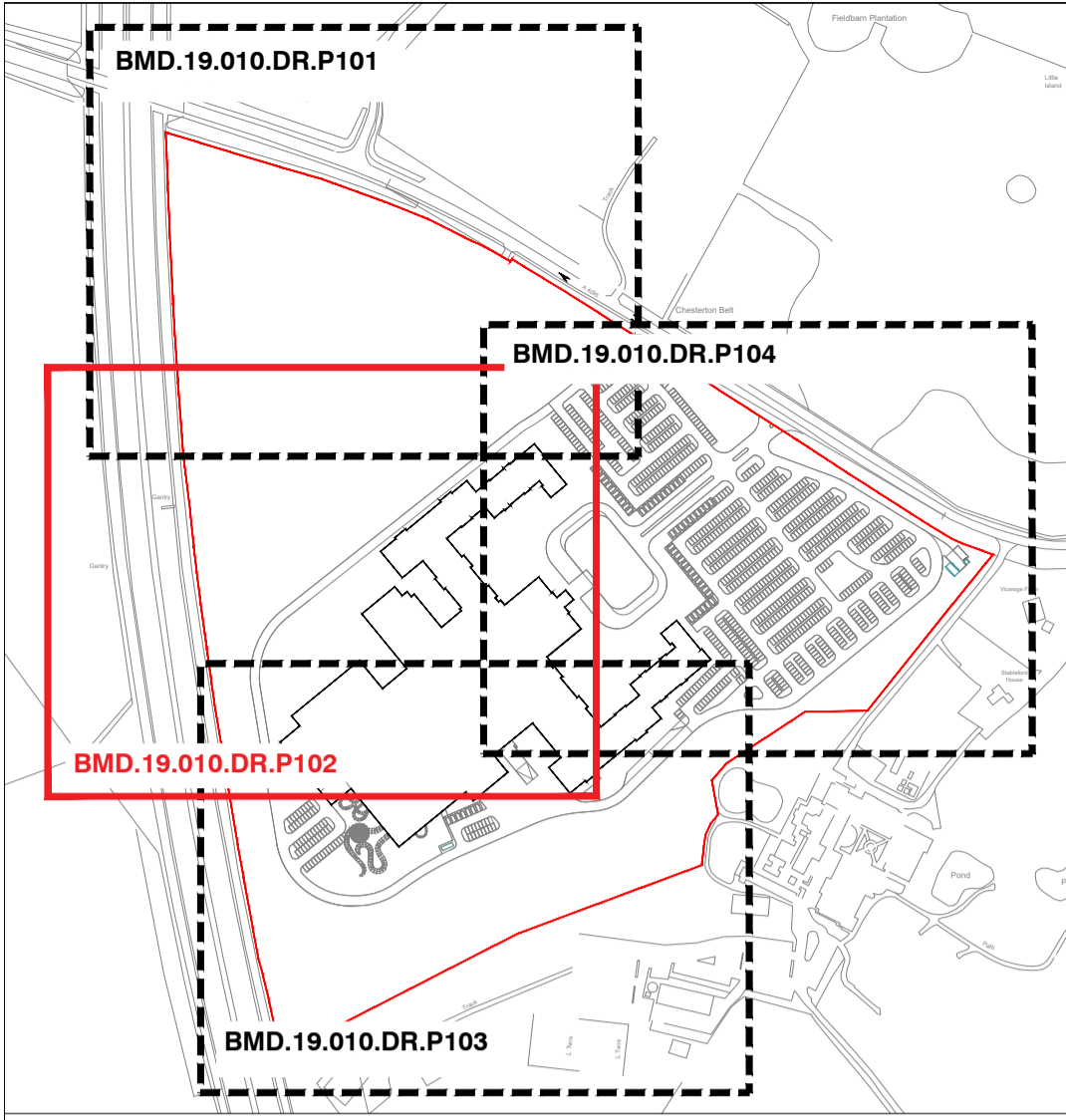

LOCATION PLAN 1:5000@A1

This drawing is the property of Bradley Murphy Design Ltd. Copyright is reserved by them and the drawing is issued on the condition that it is not copied, reproduced, retained nor disclosed to any unauthorized person either wholly or in part without the consent of Bradley Murphy Design Ltd.

NOTES:

- THIS DRAWING IS BASED ON BMD.19.010.DR.P001 OVERALL GA
- THIS DRAWING SHOULD BE READ IN CONJUNCTION WITH ALL OTHER LANDSCAPE DRAWINGS AND DOCUMENTS
- THIS DRAWING IS NOT INTENDED FOR CONSTRUCTION
- DO NOT SCALE FROM THIS DRAWING
- ANY DISCREPANCIES WITHIN THIS DRAWING OR BETWEEN THIS DRAWING AND ANY OTHER INFORMATION IS TO BE REPORTED TO BMD FOR CLARIFICATION

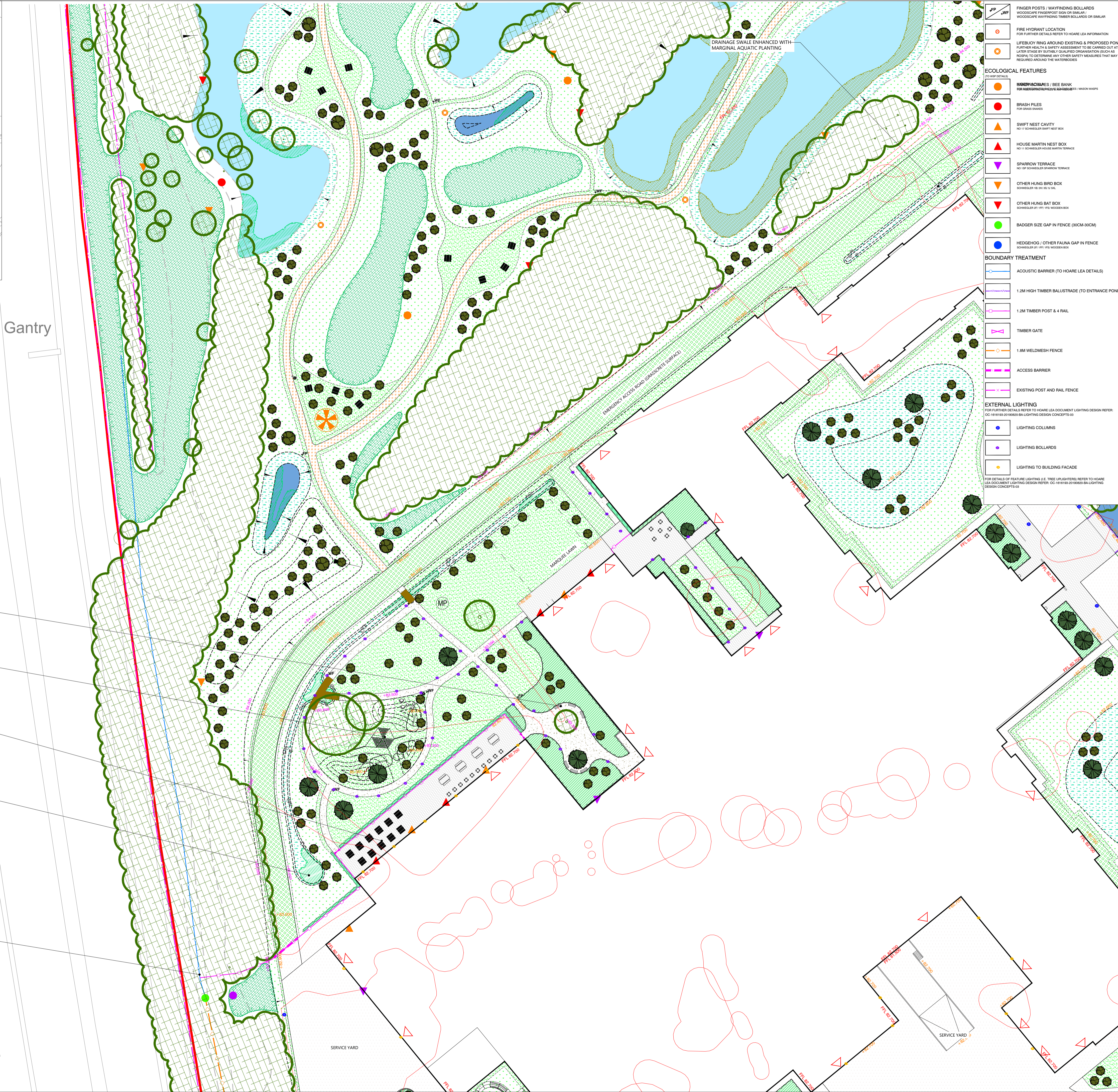

LEGEND

- ECOLOGICAL FEATURES**
 - FINGER POSTS / WAYFINDING BOLLARDS: WOODSCAPE FRAMEPOST SIGN OR SIMILAR / WOODSCAPE WAYFINDING: TIMBER BOLLARDS OR SIMILAR
 - FIRE HYDRANT LOCATION: FOR FURTHER DETAILS REFER TO HOME LEA INFORMATION
 - LIFEBLOOM RING AROUND EXISTING & PROPOSED PONDS: FURTHER HEALTH & SAFETY ASSESSMENT TO BE CARRIED OUT AT A LATER STAGE BY SUITABLY QUALIFIED ORGANIZATION (SUCH AS RSPB) TO DETERMINE ANY OTHER SAFETY MEASURES THAT MAY BE REQUIRED AROUND THE WATERBODIES
 - SIBERIAN/SCALES / BEE BANK: FOR FURTHER DETAILS REFER TO HOME LEA INFORMATION
 - BRUSH PILES: FOR BRUSH REMOVAL
 - SWIFT NEST CAVITY: NO 11 SCHWELLER SWIFT NEST BOX
 - HOUSE MARTIN NEST BOX: NO 11 SCHWELLER HOUSE MARTIN TERRACE
 - SPARROW TERRACE: NO 10 SCHWELLER SPARROW TERRACE
 - OTHER HUNG BIRD BOX: SCHWELLER NO. 101-101-101
 - OTHER HUNG BAT BOX: SCHWELLER NO. 101-101-101
 - BADGER SIZE GAP IN FENCE (80CM-30CM)
 - HEDGEHOG / OTHER FAUNA GAP IN FENCE: SCHWELLER NO. 101-101-101
- BOUNDARY TREATMENT**
 - ACOUSTIC BARRIER (TO HOARE LEA DETAILS)
 - 1.2M HIGH TIMBER BALUSTRADE (TO ENTRANCE POND)
 - 1.2M TIMBER POST & 4 RAIL
 - TIMBER GATE
 - 1.8M WELDMESH FENCE
 - ACCESS BARRIER
 - EXISTING POST AND RAIL FENCE
- EXTERNAL LIGHTING**
 - FOR FURTHER DETAILS REFER TO HOME LEA DOCUMENT LIGHTING DESIGN REFER: OC-181818-20190800-BA LIGHTING DESIGN CONCEPTS-03
 - LIGHTING COLUMNS
 - LIGHTING BOLLARDS
 - LIGHTING TO BUILDING FACADE
 - FOR DETAILS OF FEATURE LIGHTING, I.E. TREE LIGHTING REFER TO HOME LEA DOCUMENT LIGHTING DESIGN REFER: OC-181818-20190800-BA LIGHTING DESIGN CONCEPTS-03
- SITE BOUNDARY**
- EXISTING EARTHWORKS**
- EARTHWORKS CONTOURS**
- EXISTING LEVELS**
- PROPOSED FLOOR LEVELS / FINISHED FLOOR LEVELS**
- SLOPE DIRECTION**
- EXISTING WATER BODIES**
- PROPOSED WATER BODIES**
- MUSTER POINTS**
- SOFT LANDSCAPE**
 - FOR FURTHER DETAILS REFER TO PLANTING PLANS & SCHEDULE (REFERENCE BMD.19.010.DR.P301-305)
 - EXISTING TREES & WOODLAND TO BE RETAINED
 - EXISTING TREES & WOODLAND TO BE REMOVED
 - BULEVARD TREES
 - FEATURE PARKLAND TREES
 - ORNAMENTAL FEATURE TREES
 - CAR PARK TREES
 - PARKLAND TREES
 - WOODLAND PLANTING
 - AMENITY SHRUB PLANTING
 - NATIVE HEDGEROW
 - SINGLE SPECIES HEDGEROW
 - EXISTING MARGINAL PLANTING
 - PROPOSED MARGINAL PLANTING
 - AMENITY GRASS MIX
 - MEADOW GRASS MIX
 - WET MEADOW GRASS MIX
- HARD LANDSCAPE**
 - MACADAM SURFACE
 - REINFORCED GRASS: GRASS/CONCRETE OR SIMILAR
 - RESIN BOUND GRAVEL FOOTPATH: SURFSET RESIN BOUND GRAVEL OR SIMILAR
 - SELF BOUND GRAVEL FOOTPATH: BREEDON SELF-BINDING GRAVEL OR SIMILAR
 - BLOCK PAVING: WINDENBERG TUMBLER CLAY PAVERS OR SIMILAR
 - PERMEABLE PAVING: MARSHALLS TESULA PERMEABLE PAVING OR SIMILAR
 - TIMBER BRIDGE: BEAVER BRIDGES BOARDWALK OR SIMILAR
 - TIMBER PICNIC BENCHES: WOODSCAPE STANDARD FABRIC PICNIC OR SIMILAR / WOODSCAPE AIRSHIRE PICNIC SET OR SIMILAR
 - TIMBER BENCHES: WOODSCAPE GREAT BACKREST SEAT OR SIMILAR / WOODSCAPE TOOTING BACKREST SEAT OR SIMILAR
 - BINS: WOODSCAPE ROUND LOCKABLE LITTER BIN OR SIMILAR
 - SCULPTURE LOCATION: GREAT WOLF SCULPTURE TO BE DETAILED AT A LATER STAGE
 - ROCKS/ BOULDERS
 - MAIN ENTRANCE SIGNAGE: GREAT WOLF ENTRANCE SIGN TO BE DETAILED AT A LATER STAGE
 - TIMBER BOLLARDS: WOODSCAPE TIMBER BOLLARDS OR SIMILAR
 - ELECTRIC VEHICLE CHARGING POINTS: 20 SPACES INCLUDING 4 DISABLED BAYS REFER TO HOME LEA INFORMATION FOR FURTHER DETAILS

SEATING BELOW NATIVE TREES AND SET WITHIN SEMI-ORNAMENTAL PLANTING OUTSIDE FAMILY ENTERTAINMENT CENTRE

WOLF DEN PLAY GROUND: NATURAL PLAY AREA OUTSIDE FAMILY ENTERTAINMENT CENTRE. PLAY EQUIPMENT SHOWN INDICATIVELY. DETAILS TO COME FORWARD AT A LATER STAGE

SEATING TERRACE OUTSIDE WATER PARK / FAMILY ENTERTAINMENT CENTRE

DRAINAGE SWALE ENHANCED WITH MARGINAL-AQUATIC PLANTING

EXTENT OF ACOUSTIC BARRIER REFER TO HOARE LEA- INFORMATION FOR DETAILS

B	UPDATED TO LATEST ARCHITECTS LAYOUT	08.11.19
A	CYCLE PARKING AND EV POINTS ADDED	02.10.19
Rev	Description	Date

PURPOSE OF ISSUE
PLANNING
 Bradley Murphy Design Ltd
 6 The Courtyard
 Hatton Technology Park
 Dark Lane
 Hatton
 Warwickshire
 CV35 8XB
 t: 01926 676496
 e: info@bradleymurphydesign.co.uk
 www.bradleymurphydesign.co.uk
 Client



GREAT LAKES UK LIMITED

Project
 PROPOSED GREAT WOLF LODGE, CHESTERTON, BICESTER

Drawing Title
 LANDSCAPE GENERAL ARRANGEMENT SHEET 2 OF 4

Drawn AW	Checked MP	Approved RW	Date 15/08/2019
Job No. 19.010	Scale 1:500	Sheet Size A1	Revision
Drawing Number BMD.19.010.DR.P102			B



- SITE BOUNDARY
- EXISTING EARTHWORKS
- EARTHWORKS CONTOURS
- EXISTING LEVELS
- PROPOSED GROUND LEVELS / FINISHED FLOOR LEVELS
- SLOPE DIRECTION
- EXISTING WATER BODIES
- PROPOSED WATER BODIES
- MUSTER POINTS
- SOFT LANDSCAPE**
FOR FURTHER DETAILS REFER TO PLANTING PLANS & SCHEDULE (REFERENCE BMD.19.010.DR.P301-305)
- EXISTING TREES & WOODLAND TO BE RETAINED
- EXISTING TREES & WOODLAND TO BE REMOVED
- BOULEVARD TREES
- FEATURE PARKLAND TREES
- ORNAMENTAL FEATURE TREES
- CAR PARK TREES
- PARKLAND TREES
- WOODLAND PLANTING
- AMENITY SHRUB PLANTING
- NATIVE HEDGEROW
- SINGLE SPECIES HEDGEROW
- EXISTING MARGINAL PLANTING
- PROPOSED MARGINAL PLANTING
- AMENITY GRASS MIX
- MEADOW GRASS MIX
- WET MEADOW GRASS MIX
- HARD LANDSCAPE**
- MACADAM SURFACE
- REINFORCED GRASS GRASSCOTE OR SIMILAR
- RESIN BOUND GRAVEL FOOTPATH SUBJECT RESIN BOUND GRAVEL OR SIMILAR
- SELF BOUND GRAVEL FOOTPATH BREEDON SELF-BINDING GRAVEL OR SIMILAR
- BLOCK PAVING WARRINGTONS Tumbled CLAY PAVES OR SIMILAR
- PERMEABLE PAVING MARSHALLS TESSA PERMEABLE PAVING OR SIMILAR
- TIMBER BRIDGE BEAVER BRIDGES BOARDWALK OR SIMILAR
- TIMBER PICNIC BENCHES WOODSCAPE STANDARD TAMBER PICNIC OR SIMILAR / WOODSCAPE CRIB BACKREST PICNIC SET OR SIMILAR
- TIMBER BENCHES WOODSCAPE CRIB BACKREST SEAT OR SIMILAR / WOODSCAPE TOTTING BACKREST SEAT OR SIMILAR
- BINS WOODSCAPE ROUND LOCKABLE LITTER BIN OR SIMILAR
- SCULPTURE LOCATION GREAT WOLF SCULPTURE TO BE DETAILED AT A LATER STAGE
- ROCKS/BOULDERS
- MAIN ENTRANCE SIGNAGE GREAT WOLF ENTRANCE SIGN TO BE DETAILED AT A LATER STAGE
- TIMBER BOLLARDS WOODSCAPE TIMBER BOLLARDS OR SIMILAR
- ELECTRIC VEHICLE CHARGING POINTS 30 SPACES INCLUDING 11 DISABLED BAYS REFER TO HOME LEA INFORMATION FOR FURTHER DETAILS

LOCATION PLAN 1:5000@A1

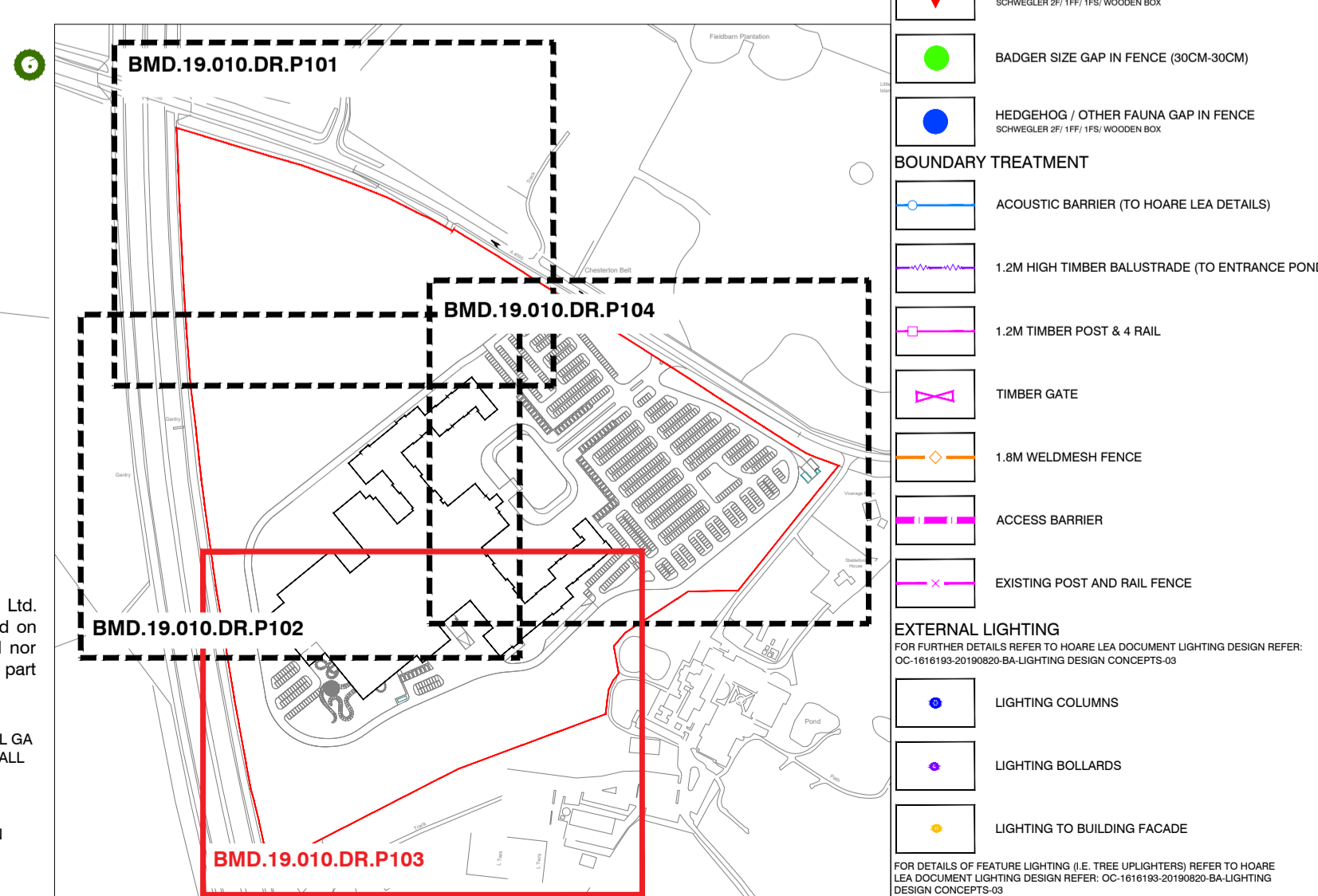

- FINGER POSTS / WAINWINGING BOLLARDS WOODSCAPE FINGERPOST SIGN OR SIMILAR / WOODSCAPE WAINWINGING TIMBER BOLLARDS OR SIMILAR
- FIRE HYDRANT LOCATION FOR FURTHER DETAILS REFER TO HOME LEA INFORMATION
- LIFELINE RING AROUND EXISTING & PROPOSED PONDS LIFELINE TO BE BY DETAIL QUALIFIED ORGANISATION (SUCH AS BSCIPA) TO DETERMINE ANY OTHER SAFETY MEASURES THAT MAY BE REQUIRED AROUND THE WATERBODIES
- ECOLOGICAL FEATURES**
(FOR REF DETAILS)
- MOUNDING/SCALES / BEE BANK FOR MOUNDING/SCALES/BANKS/BEEHIVES / MOUND MARKS
- BRASH PILES FOR OPEN SPACES
- SWIFT NEST CAVITY NO 17 SCHWELGER SWIFT NEST BOX
- HOUSE MARTIN NEST BOX NO 11 SCHWELGER HOUSE MARTIN TERRACE
- SPARROW TERRACE NO 16 SCHWELGER SPARROW TERRACE
- OTHER HUNG BIRD BOX SCHWELGER NO 24 85 5 19L
- OTHER HUNG BAT BOX SCHWELGER NO 19F 19S WOODEN BOX
- BADGER SIZE GAP IN FENCE (80CM-30CM)
- HEDGEHOG / OTHER FAUNA GAP IN FENCE SCHWELGER NO 19F 19S WOODEN BOX
- BOUNDARY TREATMENT**
- ACOUSTIC BARRIER (TO HOARE LEA DETAILS)
- 1.2M HIGH TIMBER BALUSTRADE (TO ENTRANCE POND)
- 1.2M TIMBER POST & 4 RAIL
- TIMBER GATE
- 1.8M WELDMESH FENCE
- ACCESS BARRIER
- EXISTING POST AND RAIL FENCE
- EXTERNAL LIGHTING**
FOR FURTHER DETAILS REFER TO HOME LEA DOCUMENT LIGHTING DESIGN REFER. (C/O: 191818-191819) (SEE LIGHTING DESIGN CONCEPTS)
- LIGHTING COLUMNS
- LIGHTING BOLLARDS
- LIGHTING TO BUILDING FACADE

This drawing is the property of Bradley Murphy Design Ltd. Copyright is reserved by them and the drawing is issued on the condition that it is not copied, reproduced, retained nor disclosed to any unauthorized person either wholly or in part without the consent of Bradley Murphy Design Ltd.

NOTES:

- THIS DRAWING IS BASED ON BMD.19.010.DR.P001 OVERALL GA
- THIS DRAWING SHOULD BE READ IN CONJUNCTION WITH ALL OTHER LANDSCAPE DRAWINGS AND DOCUMENTS
- THIS DRAWING IS NOT INTENDED FOR CONSTRUCTION
- DO NOT SCALE FROM THIS DRAWING
- ANY DISCREPANCIES WITHIN THIS DRAWING OR BETWEEN THIS DRAWING AND ANY OTHER INFORMATION IS TO BE REPORTED TO BMD FOR CLARIFICATION

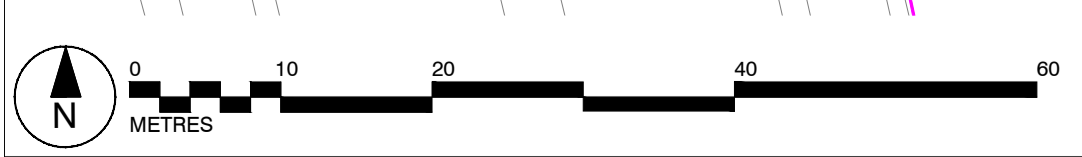

B	UPDATED TO LATEST ARCHITECTS LAYOUT	08.11.19	
A	CYCLE PARKING AND EV POINTS ADDED	02.10.19	
Rev	Description	Date	
Purpose of Issue			
PLANNING			
Bradley Murphy Design Ltd 6 The Courtyard Hatton Technology Park Dark Lane Hatton Warwickshire CV35 8XB			
t: 01926 676496 e: info@bradleymurphydesign.co.uk www.bradleymurphydesign.co.uk			
Client			
GREAT LAKES UK LIMITED			
Project			
PROPOSED GREAT WOLF LODGE, CHESTERTON, BICESTER			
Drawing Title			
LANDSCAPE GENERAL ARRANGEMENT SHEET 3 OF 4			
Drawn	Checked	Approved	Date
AW	MP	RW	15/08/2019
Job No.	Scale	Sheet Size	Revision
19.010	1:500	A1	B
Drawing Number			
BMD.19.010.DR.P103			

This drawing is the property of Bradley Murphy Design Ltd. Copyright is reserved by them and the drawing is issued on the condition that it is not copied, reproduced, retained nor disclosed to any unauthorized person either wholly or in part without the consent of Bradley Murphy Design Ltd.

NOTES:

1. THIS DRAWING IS BASED ON BMD 19.010.DR.P001 OVERALL GA
2. THIS DRAWING SHOULD BE READ IN CONJUNCTION WITH ALL OTHER LANDSCAPE DRAWINGS AND DOCUMENTS
3. THIS DRAWING IS NOT INTENDED FOR CONSTRUCTION
4. DO NOT SCALE FROM THIS DRAWING
5. ANY DISCREPANCIES WITHIN THIS DRAWING OR BETWEEN THIS DRAWING AND ANY OTHER INFORMATION IS TO BE REPORTED TO BMD FOR CLARIFICATION

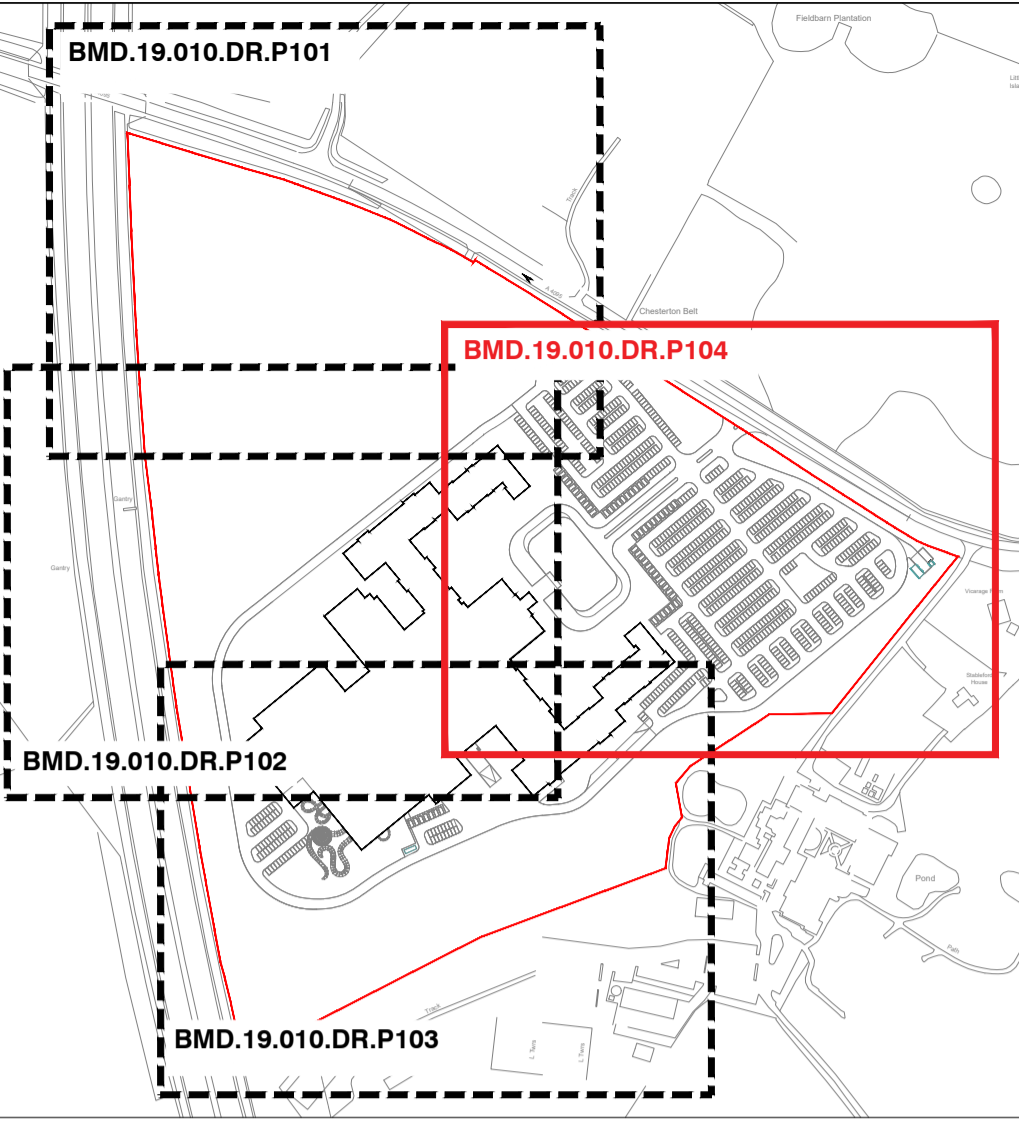

LOCATION PLAN 1:5000@A1

LEGEND

- SYMBOLS:**
 - FINGER POSTS / WAYFINDING BOLLARDS
 - FIRE HYDRANT LOCATION
 - LIFEBLOK RING AROUND EXISTING & PROPOSED PONDS
 - BRUSH PILES
 - SWIFT NEST CAVITY
 - HOUSE MARTIN NEST BOX
 - SPARROW TERRACE
 - OTHER HUNG BIRD BOX
 - OTHER HUNG BAT BOX
 - BADGER SIZE GAP IN FENCE
 - HEDGEHOG / OTHER FAUNA GAP IN FENCE
 - BOUNDARY TREATMENT: 1.2M HIGH TIMBER BALUSTRADE, 1.2M TIMBER POST & 4 RAIL, TIMBER GATE, 1.8M WELDMESH FENCE, ACCESS BARRIER, EXISTING POST AND RAIL FENCE
 - EXTERNAL LIGHTING: LIGHTING COLUMNS, LIGHTING BOLLARDS, LIGHTING TO BUILDING FACADE
 - HARD LANDSCAPE: MACADAM SURFACE, REINFORCED GRASS, RESIN BOUND GRAVEL FOOTPATH, BLOCK PAVING, PERMEABLE PAVING, TIMBER BRIDGE, TIMBER PICNIC BENCHES, TIMBER BENCHES, BINS, SCULPTURE LOCATION, ROCKS / BOLLARDS
- ECOLOGICAL FEATURES:**
 - HIBERNIAN/SHRUBS / BEE BANK
 - BRUSH PILES
 - SWIFT NEST CAVITY
 - HOUSE MARTIN NEST BOX
 - SPARROW TERRACE
 - OTHER HUNG BIRD BOX
 - OTHER HUNG BAT BOX
 - BADGER SIZE GAP IN FENCE
 - HEDGEHOG / OTHER FAUNA GAP IN FENCE
- SOFT LANDSCAPE:**
 - EXISTING TREES & WOODLAND TO BE RETAINED
 - EXISTING TREES & WOODLAND TO BE REMOVED
 - BOULEVARD TREES
 - FEATURE PARKLAND TREES
 - ORNAMENTAL FEATURE TREES
 - CAR PARK TREES
 - PARKLAND TREES
 - WOODLAND PLANTING
 - AMENITY SHRUB PLANTING
 - NATIVE HEDGEROW
 - SINGLE SPECIES HEDGEROW
 - EXISTING MARGINAL PLANTING
 - PROPOSED MARGINAL PLANTING
 - AMENITY GRASS MIX
 - MEADOW GRASS MIX
 - WET MEADOW GRASS MIX
- SOFT LANDSCAPE:**
 - EXISTING TREES & WOODLAND TO BE RETAINED
 - EXISTING TREES & WOODLAND TO BE REMOVED
 - BOULEVARD TREES
 - FEATURE PARKLAND TREES
 - ORNAMENTAL FEATURE TREES
 - CAR PARK TREES
 - PARKLAND TREES
 - WOODLAND PLANTING
 - AMENITY SHRUB PLANTING
 - NATIVE HEDGEROW
 - SINGLE SPECIES HEDGEROW
 - EXISTING MARGINAL PLANTING
 - PROPOSED MARGINAL PLANTING
 - AMENITY GRASS MIX
 - MEADOW GRASS MIX
 - WET MEADOW GRASS MIX
- SOFT LANDSCAPE:**
 - EXISTING TREES & WOODLAND TO BE RETAINED
 - EXISTING TREES & WOODLAND TO BE REMOVED
 - BOULEVARD TREES
 - FEATURE PARKLAND TREES
 - ORNAMENTAL FEATURE TREES
 - CAR PARK TREES
 - PARKLAND TREES
 - WOODLAND PLANTING
 - AMENITY SHRUB PLANTING
 - NATIVE HEDGEROW
 - SINGLE SPECIES HEDGEROW
 - EXISTING MARGINAL PLANTING
 - PROPOSED MARGINAL PLANTING
 - AMENITY GRASS MIX
 - MEADOW GRASS MIX
 - WET MEADOW GRASS MIX

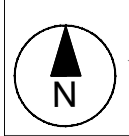
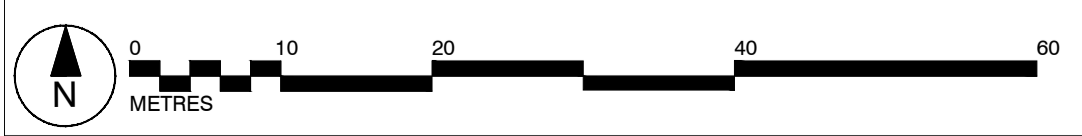

BEECH HEDGES PLANTED BETWEEN PARKING ROWS TO DEFINE EDGE OF PARKING AND SOFTEN VIEWS ACROSS THE CAR PARK AT GROUND LEVEL FLUSH KERBS THROUGHOUT CAR PARK (ASIDE FROM PERIMETER, WHICH IS EDGED WITH 125MM SPLAYED KERB WITH DROPS EVERY 25M TO ALLOW GCN TO EXIT CAR PARK)

NATIVE SPECIES-RICH HEDGEROW PROVIDED AROUND SOUTH EAST AND NORTH EAST PERIMETER OF CAR PARK

VISITOR CYCLE AREA: TIMBER CLAD STRUCTURE WITH SPACE FOR UP TO 40 BIKES

ENTRANCE BOULEVARD, TO COMPRISE LARGE DISEASE RESISTANT ELM (NEW HORIZON) IF AVAILABLE, ALTERNATIVELY LARGE PIN OAK

BEECH HEDGES PLANTED BETWEEN PARKING ROWS TO DEFINE EDGE OF PARKING AND SOFTEN VIEWS ACROSS THE CAR PARK AT GROUND LEVEL FLUSH KERBS THROUGHOUT CAR PARK (ASIDE FROM PERIMETER, WHICH IS EDGED WITH 125MM SPLAYED KERB WITH DROPS EVERY 25M TO ALLOW GCN TO EXIT CAR PARK)

EXISTING TREES RETAINED WITHIN AND AROUND THE CAR PARK WHERE POSSIBLE

BAGGAGE TROLLEY STORAGE

EXISTING POND EXTENDED TO FORM FOCAL FEATURE ON ENTRANCE TO HOTEL, PERIMETER PLANTED WITH SEMI-ORNAMENTAL NATIVE MARGINAL AQUATIC PLANTING. POND SERVES AS A BARRIER BETWEEN VEHICLES ON ENTRANCE BOULEVARD AND PORT COCHERE ADJACENT TREE PLANTING POSITIONED TO FRAME VIEWS OF HOTEL ENTRANCE ON ARRIVAL ALONG BOULEVARD

BAGGAGE TROLLEY STORAGE

WOLF SCULPTURE POSITIONED TO PROVIDE PHOTO OPPORTUNITY FROM A RANGE OF DIRECTIONS

ABOVE GROUND SHALLOW SURFACE WATER-STORAGE BASIN WITH TREES PROVIDE SOFTENING OF FACADE AND VIEWS TO PARKING AREA, WHILST MINIMISING SHADING TO FACING ROOMS

NATIVE SPECIES-RICH HEDGEROW PROVIDED AROUND SOUTH EAST AND NORTH EAST PERIMETER OF CAR PARK

MOUNDING UP TO 3M HIGH ALONG SOUTH EAST BOUNDARY. ELEVATING NATIVE BROADLEAVED WOODLAND WITH SCATTERED CONIFEROUS SPECIES TO SOFTEN VIEWS OF RESORT FROM SOUTH EAST

EXISTING VEGETATION RETAINED TO SOFTEN VIEWS OF RESORT AND CAR PARK FROM SOUTH EAST

SWALES EXTENDED THROUGH CAR PARK, BETWEEN HEDGEROWS WHERE REQUIRED

NATIVE SPECIES-RICH HEDGEROW PLANTED BETWEEN BEECH HEDGES WHERE SPACE ALLOWS, TO INCREASE

MOUNDING UP TO 4M HIGH ALONG SOUTH EAST BOUNDARY. ELEVATING NATIVE BROADLEAVED WOODLAND WITH SCATTERED CONIFEROUS SPECIES TO SOFTEN VIEWS OF RESORT FROM SOUTH EAST

HORNBEAM TREES PLANTED ACROSS SOUTHERN PART OF CAR PARK TO SOFTEN VIEWS ACROSS CAR PARK (TIGHT CROWN LIMITS VIEWS IN WINTER, WITH MANY BROWN LEAVES RETAINED UNTIL SPRING)

Vicarage Farm

Stableford House

B	UPDATED TO LATEST ARCHITECTS LAYOUT	08.11.19	
A	CYCLE PARKING AND EV POINTS ADDED	02.10.19	
Rev	Description	Date	
Purpose of Issue			
PLANNING			
Bradley Murphy Design Ltd 6 The Courtyard Dark Lane Hatton Warwickshire CV35 8XB			
t: 01926 676496 e: info@bradleymurphydesign.co.uk www.bradleymurphydesign.co.uk			
Client			
GREAT LAKES UK LIMITED			
Project			
PROPOSED GREAT WOLF LODGE, CHESTERTON, BICESTER			
Drawing Title			
LANDSCAPE GENERAL ARRANGEMENT SHEET 4 OF 4			
Drawn	Checked	Approved	Date
AW	MP	RW	15/08/2019
Job No.	Scale	Sheet Size	Revision
19.010	1:500	A1	B
Drawing Number			
BMD.19.010.DR.P104			

A 4095

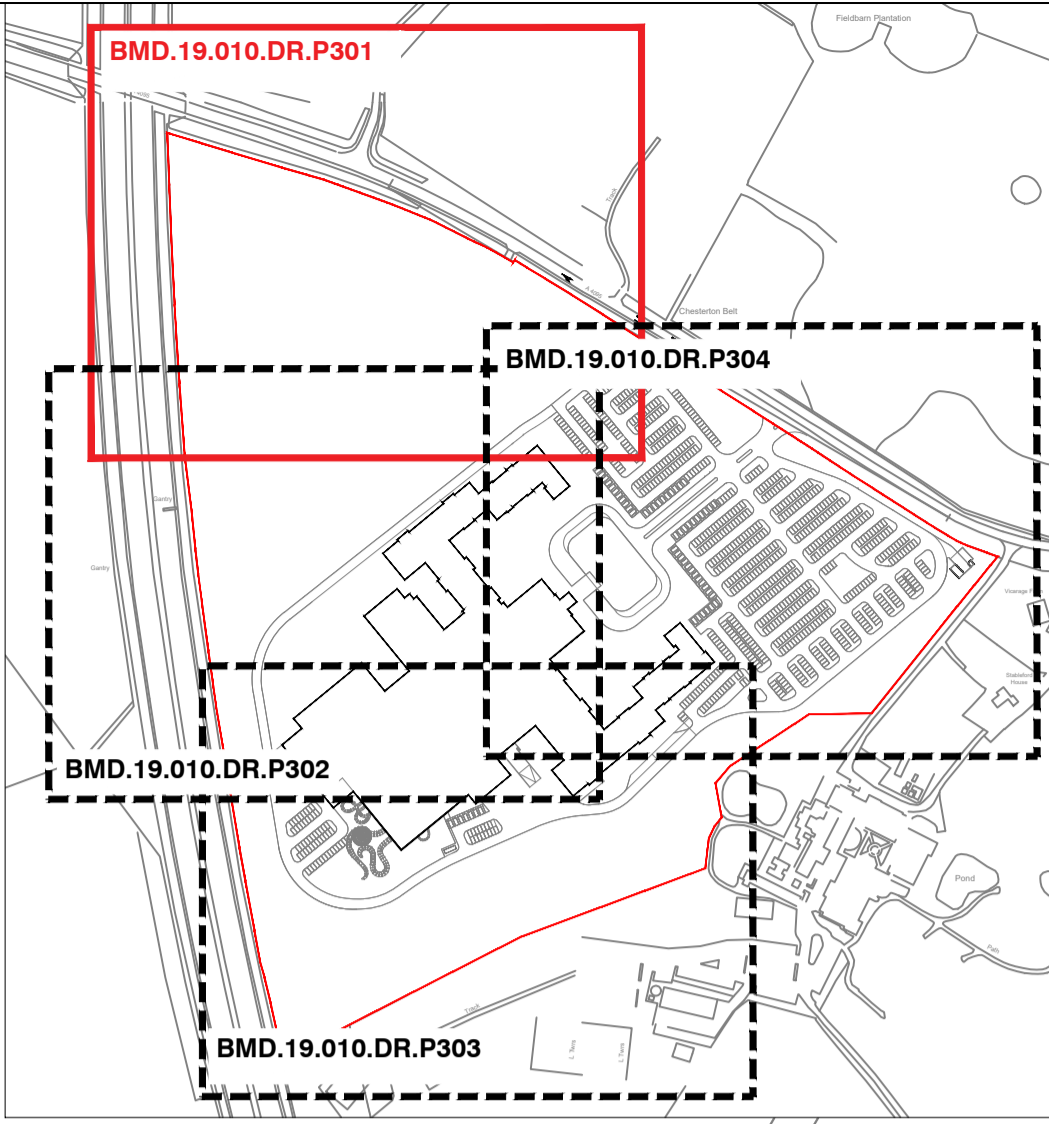

This drawing is the property of Bradley Murphy Design Ltd. Copyright is reserved by them and the drawing is issued on the condition that it is not copied, reproduced, retained nor disclosed to any unauthorized person either wholly or in part without the consent of Bradley Murphy Design Ltd.

NOTES:

- THIS DRAWING IS BASED ON BMD 19.010.DR.P001 OVERALL GA
- THIS DRAWING SHOULD BE READ IN CONJUNCTION WITH ALL OTHER LANDSCAPE DRAWINGS AND DOCUMENTS
- THIS DRAWING IS NOT INTENDED FOR CONSTRUCTION
- DO NOT SCALE FROM THIS DRAWING
- ANY DISCREPANCIES WITHIN THIS DRAWING OR BETWEEN THIS DRAWING AND ANY OTHER INFORMATION IS TO BE REPORTED TO BMD FOR CLARIFICATION

- SITE BOUNDARY
- EXISTING EARTHWORKS
- EARTHWORKS CONTOURS
- SLOPE DIRECTION
- EXISTING WATER BODIES
- PROPOSED WATER BODIES

- SOFT LANDSCAPE**
- EXISTING TREES & WOODLAND TO BE RETAINED
 - BOULEVARD TREES
 - FEATURE PARKLAND TREES
 - ORNAMENTAL FEATURE TREES
 - CAR PARK TREES
 - PARKLAND TREES
 - WOODLAND EDGE AND CORE PLANTING
 - AMENITY SHRUB PLANTING
 - NATIVE HEDGEROW
 - SINGLE SPECIES HEDGEROW
 - EXISTING MARGINAL PLANTING
 - PROPOSED MARGINAL PLANTING
 - AMENITY GRASS MIX
EMBRIGATE EG01 STRONG LAWN GRASS MIXTURE OR SIMILAR
 - MEADOW GRASS MIX
EMBRIGATE EG01 STRONG LAWN GRASS MIXTURE OR SIMILAR
 - WET MEADOW GRASS MIX
EMBRIGATE EG01 STRONG LAWN GRASS MIXTURE OR SIMILAR

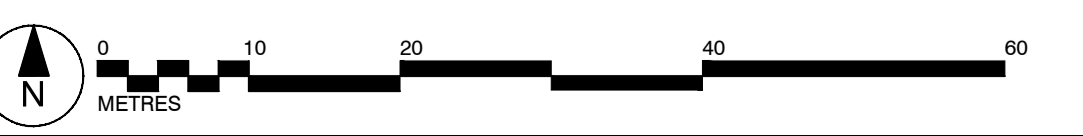

A	UPDATED TO LATEST ARCHITECTS BASE	08.11.19
Rev	Description	Date

INFORMATION

Bradley Murphy Design Ltd
6 The Courtyard
Dark Lane
Hatton
Warwickshire
CV35 8XB

t: 01926 676496
e: info@bradleymurphydesign.co.uk
www.bradleymurphydesign.co.uk

Client



GREAT LAKES UK LIMITED

Project PROPOSED GREAT WOLF LODGE, CHESTERTON, BICESTER			
Drawing Title PLANTING PLAN (SHEET 1 OF 4)			
Drawn AW	Checked MP	Approved RW	Date 14/10/2019
Job No. 19.010	Scale 1:500	Sheet Size A1	Revision A
Drawing Number BMD.19.010.DR.P301			

This drawing is the property of Bradley Murphy Design Ltd. Copyright is reserved by them and the drawing is issued on the condition that it is not copied, reproduced, retained nor disclosed to any unauthorized person either wholly or in part without the consent of Bradley Murphy Design Ltd.

NOTES:

- THIS DRAWING IS BASED ON BMD 19.010 DR.P001 OVERALL GA
- THIS DRAWING SHOULD BE READ IN CONJUNCTION WITH ALL OTHER LANDSCAPE DRAWINGS AND DOCUMENTS
- THIS DRAWING IS NOT INTENDED FOR CONSTRUCTION
- DO NOT SCALE FROM THIS DRAWING
- ANY DISCREPANCIES WITHIN THIS DRAWING OR BETWEEN THIS DRAWING AND ANY OTHER INFORMATION IS TO BE REPORTED TO BMD FOR CLARIFICATION

- SITE BOUNDARY
- EXISTING EARTHWORKS
- EARTHWORKS CONTOURS
- SLOPE DIRECTION
- EXISTING WATER BODIES
- PROPOSED WATER BODIES

- SOFT LANDSCAPE**
- EXISTING TREES & WOODLAND TO BE RETAINED
 - BOULEVARD TREES
 - FEATURE PARKLAND TREES
 - ORNAMENTAL FEATURE TREES
 - CAR PARK TREES
 - PARKLAND TREES
 - WOODLAND EDGE AND CORE PLANTING
 - AMENITY SHRUB PLANTING
 - NATIVE HEDGEROW
 - SINGLE SPECIES HEDGEROW
 - EXISTING MARGINAL PLANTING
 - PROPOSED MARGINAL PLANTING
 - AMENITY GRASS MIX
EMERGENT EGG STRONG LAWN GRASS MIXTURE OR SIMILAR
 - MEADOW GRASS MIX
EMERGENT EGG STRONG LAWN GRASS MIXTURE OR SIMILAR
 - WET MEADOW GRASS MIX
EMERGENT EGG STRONG LAWN GRASS MIXTURE OR SIMILAR

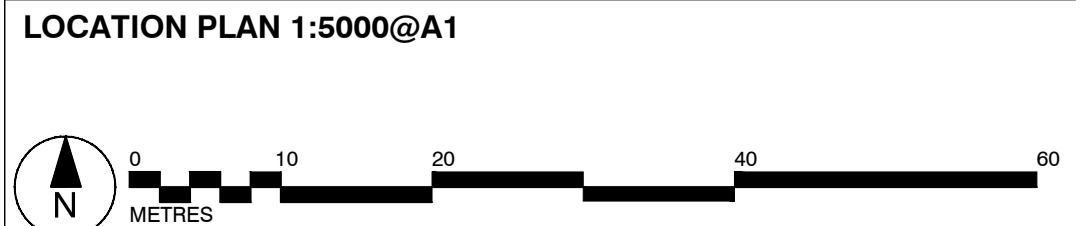
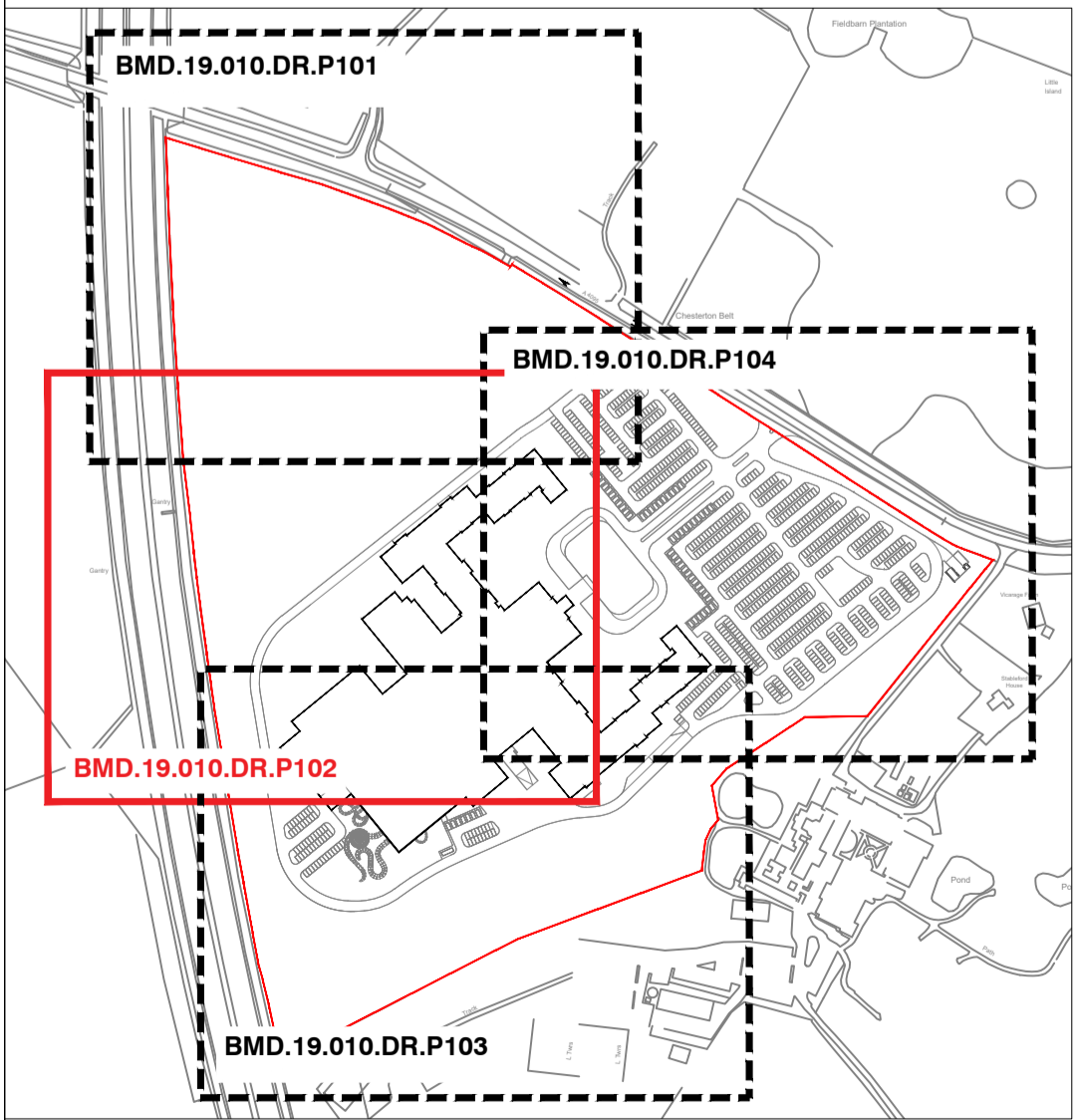
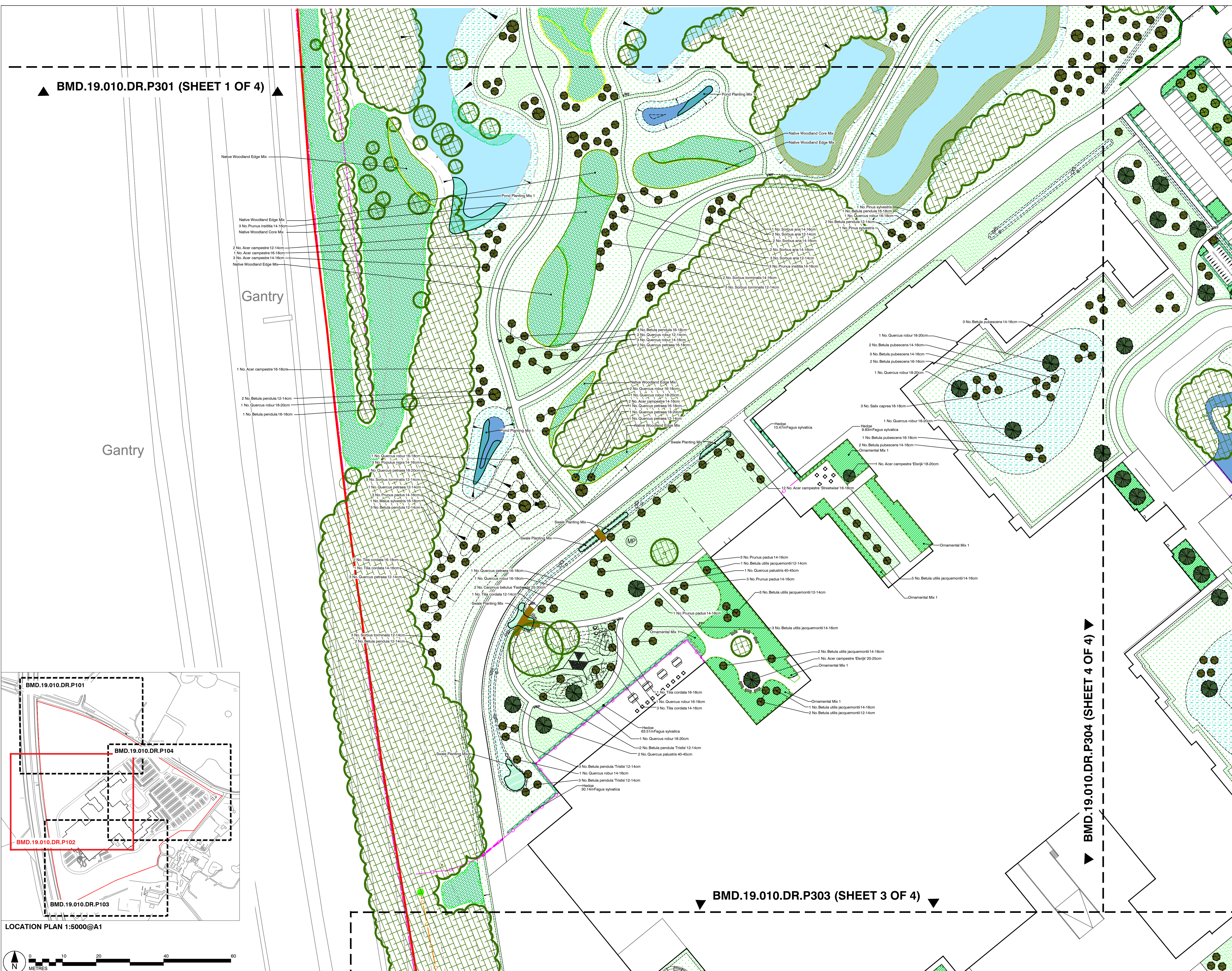

A	UPDATED TO LATEST ARCHITECTS BASE	08.11.19
Rev	Description	Date
PURPOSE OF ISSUE		
PLANNING		
Bradley Murphy Design Ltd 6 The Courtyard Dark Lane Hatton Warwickshire CV35 8XB		
t: 01226 676496 e: info@bradleymurphydesign.co.uk www.bradleymurphydesign.co.uk		
Client		
GREAT LAKES UK LIMITED		
Project		
PROPOSED GREAT WOLF LODGE, CHESTERTON, BICESTER		
Drawing Title		
PLANTING PLAN SHEET 2 OF 4		
Drawn	Checked	Approved
AW	MP	RW
Job No.	Scale	Sheet Size
19.010	1:500	A1
Revision	Date	
	14/10/2019	
Drawing Number	Date	
BMD.19.010.DR.P302	A	

This drawing is the property of Bradley Murphy Design Ltd. Copyright is reserved by them and the drawing is issued on the condition that it is not copied, reproduced, retained nor disclosed to any unauthorized person either wholly or in part without the consent of Bradley Murphy Design Ltd.

NOTES:

1. THIS DRAWING IS BASED ON BMD 19.010.DR.P001 OVERALL GA
2. THIS DRAWING SHOULD BE READ IN CONJUNCTION WITH ALL OTHER LANDSCAPE DRAWINGS AND DOCUMENTS
3. THIS DRAWING IS NOT INTENDED FOR CONSTRUCTION
4. DO NOT SCALE FROM THIS DRAWING
5. ANY DISCREPANCIES WITHIN THIS DRAWING OR BETWEEN THIS DRAWING AND ANY OTHER INFORMATION IS TO BE REPORTED TO BMD FOR CLARIFICATION

LEGEND

- SITE BOUNDARY
- EXISTING EARTHWORKS
- EARTHWORKS CONTOURS
- SLOPE DIRECTION
- EXISTING WATER BODIES
- PROPOSED WATER BODIES

SOFT LANDSCAPE

- EXISTING TREES & WOODLAND TO BE RETAINED
- BOULEVARD TREES
- FEATURE PARKLAND TREES
- ORNAMENTAL FEATURE TREES
- CAR PARK TREES
- PARKLAND TREES
- WOODLAND EDGE AND CORE PLANTING
- AMENITY SHRUB PLANTING
- NATIVE HEDGEROW
- SINGLE SPECIES HEDGEROW
- EXISTING MARGINAL PLANTING
- PROPOSED MARGINAL PLANTING
- AMENITY GRASS MIX
EMERGATE EGG STRONG LAWN GRASS MIXTURE OR SIMILAR
- MEADOW GRASS MIX
EMERGATE EGG STRONG LAWN GRASS MIXTURE OR SIMILAR
- WET MEADOW GRASS MIX
EMERGATE EGG STRONG LAWN GRASS MIXTURE OR SIMILAR



▲ BMD.19.010.DR.P302 (SHEET 2 OF 4) ▲

▲ BMD.19.010.DR.P304 (SHEET 4 OF 4) ▲

LOCATION PLAN 1:5000@A1

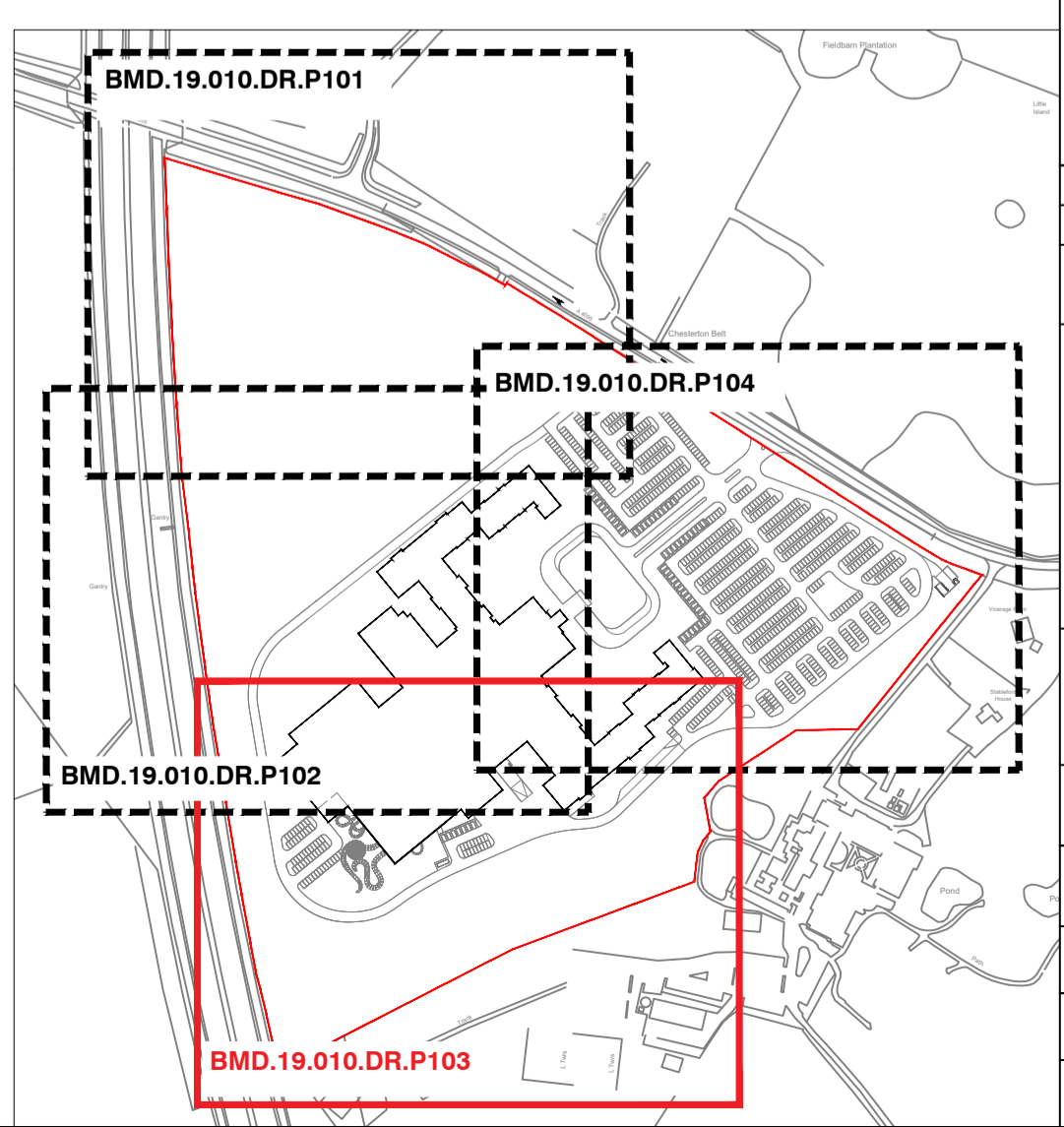

Rev	Description	Date	
A	UPDATED TO LATEST ARCHITECTS BASE	08.11.19	
Purpose of Issue			
PLANNING			
Bradley Murphy Design Ltd 6 The Courtyard Dark Lane Hatton Warwickshire CV35 8XB			
t: 01926 676496 e: info@bradleymurphydesign.co.uk www.bradleymurphydesign.co.uk			
Client			
GREAT LAKES UK LIMITED			
Project			
PROPOSED GREAT WOLF LODGE, CHESTERTON, BICESTER			
Drawing Title			
PLANTING PLAN SHEET 3 OF 4			
Drawn	Checked	Approved	Date
AW	MP	RW	14/10/2019
Job No.	Scale	Sheet Size	Revision
19.010	1:500	A1	A
Drawing Number			
BMD.19.010.DR.P303			



This drawing is the property of Bradley Murphy Design Ltd. Copyright is reserved by them and the drawing is issued on the condition that it is not copied, reproduced, retained nor disclosed to any unauthorized person either wholly or in part without the consent of Bradley Murphy Design Ltd.

- NOTES:**
- THIS DRAWING IS BASED ON BMD 19.010.DR.P001 OVERALL GA
 - THIS DRAWING SHOULD BE READ IN CONJUNCTION WITH ALL OTHER LANDSCAPE DRAWINGS AND DOCUMENTS
 - THIS DRAWING IS NOT INTENDED FOR CONSTRUCTION
 - DO NOT SCALE FROM THIS DRAWING
 - ANY DISCREPANCIES WITHIN THIS DRAWING OR BETWEEN THIS DRAWING AND ANY OTHER INFORMATION IS TO BE REPORTED TO BMD FOR CLARIFICATION

- SITE BOUNDARY
- EXISTING EARTHWORKS
- EARTHWORKS CONTOURS
- SLOPE DIRECTION
- EXISTING WATER BODIES
- PROPOSED WATER BODIES

- SOFT LANDSCAPE**
- EXISTING TREES & WOODLAND TO BE RETAINED
 - BOULEVARD TREES
 - FEATURE PARKLAND TREES
 - ORNAMENTAL FEATURE TREES
 - CAR PARK TREES
 - PARKLAND TREES
 - WOODLAND EDGE AND CORE PLANTING
 - AMENITY SHRUB PLANTING
 - NATIVE HEDGEROW
 - SINGLE SPECIES HEDGEROW
 - EXISTING MARGINAL PLANTING
 - PROPOSED MARGINAL PLANTING
 - AMENITY GRASS MIX
EMBRACE EGG STRONG LAWN GRASS MIXTURE OR SIMILAR
 - MEADOW GRASS MIX
EMBRACE EGG STRONG GENERAL PURPOSE MEADOW OR SIMILAR
 - WET MEADOW GRASS MIX
EMBRACE EGG STRONG MEADOW MIXTURES FOR WETLANDS OR SIMILAR

A	UPDATED TO LATEST ARCHITECTS BASE	08.11.19
Rev	Description	Date

PURPOSE OF ISSUE

PLANNING

Bradley Murphy Design Ltd
6 The Courtyard
Dark Lane
Hatton
Warwickshire
CV35 8XB

t: 01926 676496
e: info@bradleymurphydesign.co.uk
www.bradleymurphydesign.co.uk

Client



GREAT LAKES UK LIMITED

Project	PROPOSED GREAT WOLF LODGE, CHESTERTON, BICESTER		
Drawing Title	PLANTING PLAN SHEET 4 OF 4		
Drawn	Checked	Approved	Date
AW	MP	RW	14/10/2019
Job No.	Scale	Sheet Size	Revision
19.010	1:500	A1	A
Drawing Number	BMD.19.010.DR.P304		

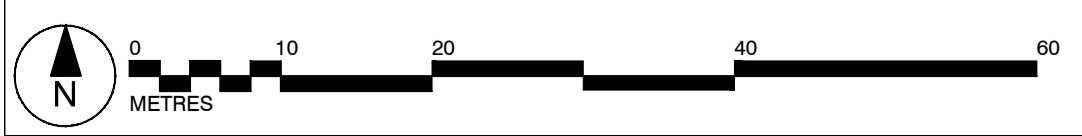



PROPOSED GREAT WOLF LODGE, CHESTERTON, BICESTER

PLANTING SCHEDULES



BMD.19.010.DR.P305

DATE: NOVEMBER - 2019

Project No: 19.10		Document Reference: BMD.19.010.DR.P305			
Revision	Purpose of Issue	Originated	Checked	Approved	Date
-	DRAFT PLANNING	AW	MP	RW	11/09/19
A	FOR PLANNING	AW	MP	RW	08/11/19

BRADLEY MURPHY DESIGN LTD

6 The Courtyard, Hatton Technology Park, Dark Lane, Hatton, Warwickshire, CV35 8XB
 Company No: 7788475

This report is the property of Bradley Murphy Design Ltd and is issued on the condition it is not reproduced, retained or disclosed to any unauthorised person, either wholly or in part without the written consent of Bradley Murphy Design Ltd.

Trees

Species	Girth	Height	Specification
Acer campestre	16-18cm	400-450cm	Extra Heavy Standard: 3x: RB: Clear Stem min. 200cm
Acer campestre	14-16cm	400-450cm	Extra Heavy Standard: 3x: RB: Clear Stem min. 200cm
Acer campestre	12-14cm	350-425cm	Extra Heavy Standard: 3x: RB: Clear Stem min. 200cm
Acer campestre 'Elsrijk'	18-20cm	450-500cm	Extra Heavy Standard: 3x: RB: Clear Stem min. 200cm
Acer campestre 'Elsrijk'	20-25cm	500-550cm	3x :Semi-Mature :Clear Stem min. 200 :RB
Acer campestre 'Streetwise'	16-18cm	400-450cm	3x :Extra Heavy Standard :Clear Stem min. 2m :RB
Acer griseum	14-16cm	400-450cm	Extra Heavy Standard: 3x: RB: Clear Stem min. 200cm
Betula nigra	25-30cm	550-600cm	4x :Semi-Mature :Clear Stem min. 200 :RB
Betula pendula	12-14cm	350-425cm	Extra Heavy Standard: 3x: RB: Clear Stem min. 200cm
Betula pendula	16-18cm	400-450cm	Extra Heavy Standard: 3x: RB: Clear Stem min. 200cm
Betula pendula	14-16cm	400-450cm	Extra Heavy Standard: 3x: RB: Clear Stem min. 200cm
Betula pendula 'Tristis'	12-14cm	350-400cm	Heavy Standard :2m clear stem :RB
Betula pendula 'Tristis'	14-16cm	400-450cm	3x :Extra Heavy Standard :2m clear stem :RB
Betula pubescens	14-16cm	400-450cm	Extra Heavy Standard: 3x: RB: Clear Stem min. 200cm
Betula pubescens	16-18cm	400-450cm	Extra Heavy Standard: 3x: RB: Clear Stem min. 200cm
Betula utilis jacquemontii	14-16cm	400-450cm	3x :Extra Heavy Standard :Clear Stem min. 200 :RB
Betula utilis jacquemontii	12-14cm	350-425cm	3x :Heavy Standard :Clear Stem min. 200 :RB
Carpinus betulus	12-14cm	350-425cm	Extra Heavy Standard: 3x: RB: Clear Stem min. 200cm
Carpinus betulus 'Fastigiata'	25-30cm	500-550cm	Semi-Mature :3x :Clear Stem min. 2m :RB
Corylus colurna	25-30cm	500-550cm	Semi-Mature :3x :Clear Stem min. 2m :RB
Malus sylvestris	14-16cm	450-500cm	Extra Heavy Standard: 3x: RB: Clear Stem min. 200cm
Malus sylvestris	16-18cm	450-500cm	Extra Heavy Standard: 3x: RB: Clear Stem min. 200cm
Malus sylvestris	12-14cm	425-600cm	Extra Heavy Standard: 3x: RB: Clear Stem min. 200cm
Populus nigra	14-16cm	425-600cm	Extra Heavy Standard: 3x: RB: Clear Stem min. 200cm
Populus nigra	12-14cm	350-425cm	Extra Heavy Standard: 3x: RB: Clear Stem min. 200cm
Populus nigra	16-18cm	min. 450cm	Extra Heavy Standard: 3x: RB: Clear Stem min. 200cm
Populus tremula	12-14cm	350-425cm	Extra Heavy Standard: 3x: RB: Clear Stem min. 200cm
Prunus 'Sunset Boulevard'	16-18cm	400-450cm	3x :Extra Heavy Standard :2m clear stem :RB
Prunus avium	12-14cm	350-425cm	Extra Heavy Standard: 3x: RB: Clear Stem min. 200cm
Prunus avium	14-16cm	400-450cm	Extra Heavy Standard: 3x: RB: Clear Stem min. 200cm
Prunus avium 'Plena'	40-45cm	700-900cm	5x :Semi-Mature :Clear Stem min. 200 :RB
Prunus avium 'Plena'	25-30cm	500-550cm	Semi-Mature :3x :Clear Stem min. 2m :RB
Prunus insititia	14-16cm	400-450cm	Extra Heavy Standard: 3x: RB: Clear Stem min. 200cm
Prunus padus	14-16cm	400-450cm	Extra Heavy Standard: 3x: RB: Clear Stem min. 200cm
Prunus padus	12-14cm	350-425cm	Extra Heavy Standard: 3x: RB: Clear Stem min. 200cm
Prunus padus	16-18cm	400-450cm	Extra Heavy Standard: 3x: RB: Clear Stem min. 200cm
Prunus serrula	14-16cm	400-450cm	3x :Extra Heavy Standard :2m clear stem :RB
Prunus serrula	12-14cm	350-400cm	3x :Extra Heavy Standard :2m clear stem :RB
Prunus yedoensis	12-14cm	350-400cm	3x :Extra Heavy Standard :2m clear stem :RB
Prunus yedoensis	14-16cm	400-450cm	3x :Extra Heavy Standard :2m clear stem :RB
Pyrus calleryana 'Chanticleer'	25-30cm	500-550cm	Semi-Mature :3x :Clear Stem min. 2m :RB
Quercus palustris	40-45cm	700-900cm	5x :Semi-Mature :Clear Stem min. 200 :RB
Quercus petraea	20-25cm	500-550cm	3x :Semi-Mature :Clear Stem min. 200 :RB
Quercus petraea	16-18cm	400-450cm	Extra Heavy Standard: 3x: RB: Clear Stem min. 200cm
Quercus petraea	12-14cm	350-425cm	Extra Heavy Standard: 3x: RB: Clear Stem min. 200cm
Quercus petraea	18-20cm	450-500cm	Extra Heavy Standard: 3x: RB: Clear Stem min. 200cm
Quercus petraea	14-16cm	400-450cm	Extra Heavy Standard: 3x: RB: Clear Stem min. 200cm
Quercus robur	18-20cm	450-500cm	Extra Heavy Standard: 3x: RB: Clear Stem min. 200cm
Quercus robur	14-16cm	400-450cm	Extra Heavy Standard: 3x: RB: Clear Stem min. 200cm
Quercus robur	16-18cm	400-450cm	Extra Heavy Standard: 3x: RB: Clear Stem min. 200cm
Quercus robur	12-14cm	350-425cm	Extra Heavy Standard: 3x: RB: Clear Stem min. 200cm
Salix alba	12-14cm	350-425cm	Extra Heavy Standard: 3x: RB: Clear Stem min. 200cm
Salix alba	14-16cm	400-450cm	Extra Heavy Standard: 3x: RB: Clear Stem min. 200cm
Salix alba	16-18cm	400-450cm	Extra Heavy Standard: 3x: RB: Clear Stem min. 200cm
Salix caprea	16-18cm	400-450cm	Extra Heavy Standard: 3x: RB: Clear Stem min. 200cm
Salix x sepulcralis 'Chrysocoma'	30-35cm	min. 450cm	4x :Semi-Mature :Clear Stem min. 200 :RB
Sorbus 'Sunshine'	14-16cm	400-450cm	Extra Heavy Standard: 3x: RB: Clear Stem min. 200cm
Sorbus aria	12-14cm	350-425cm	Extra Heavy Standard: 3x: RB: Clear Stem min. 200cm
Sorbus aria	14-16cm	400-450cm	Extra Heavy Standard: 3x: RB: Clear Stem min. 200cm
Sorbus aria	16-18cm	400-450cm	Extra Heavy Standard: 3x: RB: Clear Stem min. 200cm
Sorbus aria 'Lutescens'	25-30cm	500-550cm	Semi-Mature :3x :Clear Stem min. 2m :RB
Sorbus aucuparia	16-18cm	400-450cm	Extra Heavy Standard: 3x: RB: Clear Stem min. 200cm
Sorbus aucuparia	14-16cm	400-450cm	Extra Heavy Standard: 3x: RB: Clear Stem min. 200cm
Sorbus aucuparia	12-14cm	350-425cm	Extra Heavy Standard: 3x: RB: Clear Stem min. 200cm
Sorbus aucuparia 'Cardinal Royal'	14-16cm	400-450cm	Extra Heavy Standard: 3x: RB: Clear Stem min. 200cm
Sorbus torminalis	12-14cm	350-425cm	Extra Heavy Standard: 3x: RB: Clear Stem min. 200cm
Sorbus torminalis	14-16cm	400-450cm	Extra Heavy Standard: 3x: RB: Clear Stem min. 200cm
Sorbus torminalis	16-18cm	400-450cm	Extra Heavy Standard: 3x: RB: Clear Stem min. 200cm
Tilia cordata	14-16cm	400-450cm	Extra Heavy Standard: 3x: RB: Clear Stem min. 200cm
Tilia cordata	16-18cm	400-450cm	Extra Heavy Standard: 3x: RB: Clear Stem min. 200cm
Tilia cordata	12-14cm	350-425cm	Extra Heavy Standard: 3x: RB: Clear Stem min. 200cm
Tilia x europaea 'Pallida'	16-18cm	400-450cm	Extra Heavy Standard: 3x: RB: Clear Stem min. 200cm
Ulmus 'Sapporo Autumn Gold'	16-18cm	400-450cm	Extra Heavy Standard: 3x: RB: Clear Stem min. 200cm
Ulmus 'New Horizon'	60-70cm	700-800cm	Semi-Mature :5x :Clear Stem min. 2m :RB

Hedge

Species	Height	Specification	Density
Fagus sylvatica	100-125cm	1+2 : Transplant - seed raised :B	0.3Ctr Double Staggered at 0.175m offset

Conifers

Species	Specification	Height
Pinus sylvestris	5x :Leader & laterals :RB	350-400cm

Native Hedgerow

Species	Specification	Height	Density	Mix %
Cornus sanguinea	1+1 :Transplant - seed raised ; :Branched :2 brks ;B	100-125cm	0.3Ctr Double Staggered at 0.5m offset	10%
Corylus avellana	1+1 :Transplant - seed raised :Branched :2 brks :B	100-125cm	0.3Ctr Double Staggered at 0.5m offset	15%
Crataegus monogyna	1+1 :Transplant - seed raised :Branched :2 brks :B	100-125cm	0.3Ctr Double Staggered at 0.5m offset	40%
Ilex aquifolium	Leaders with Laterals :RB	100-125cm	0.3Ctr Double Staggered at 0.5m offset	5%
Rosa arvensis	1+1 :Transplant - seed raised ; :Branched :2 brks ;B	100-125cm	0.3Ctr Double Staggered at 0.5m offset	10%
Rosa canina	1+1 :Transplant - seed raised ; :Branched :2 brks ;B	100-125cm	0.3Ctr Double Staggered at 0.5m offset	5%
Salix nigra	1+1 :Transplant - seed raised ; :Branched :2 brks ;B	100-125cm	0.3Ctr Double Staggered at 0.5m offset	5%
Viburnum opulus	1+1 :Transplant - seed raised ; :Branched :2 brks ;B	100-125cm	0.3Ctr Double Staggered at 0.5m offset	10%

Native Woodland Core Mix

Species	Specification	Height	Density	Mix %
Acer campestre	1+1 :Transplant - seed raised :B	60-80cm	1Ctr	5%
Acer campestre	Standard: 3 brks: 2x: Clear Stem 175-200cm :B	250-300cm	1Ctr	5%
Betula pendula	1+1 :Transplant - seed raised: B	60-80cm	1Ctr	5%
Betula pubescens	Feathered: 5 brks: 2x: B	125-150cm	1Ctr	5%
Crataegus monogyna	1+1 :Transplant - seed raised: B	60-80cm	1Ctr	15%
Ilex aquifolium	Leader with Laterals :2L :C	40-60cm	1Ctr	15%
Pinus sylvestris	3X: Leader & laterals :B	80-100cm	1Ctr	15%
Populus tremula	1+1 :Seed raised :Transplant :B	60-70cm	1Ctr	5%
Prunus spinosa	1+1 :Transplant - seed raised:branched :2 breaks :B	60-80cm	1Ctr	5%
Quercus robur	2x: Standard; clear stem 175-200cm; 3 breaks :B	250-300cm	1Ctr	5%
Quercus robur	1+2 :Transplant - seed raised :B	60-80cm	1Ctr	5%
Sorbus torminalis	1+1 :Seed raised :Transplant :B	60-70cm	1Ctr	5%
Ulmus glabra	1+1 :Seed raised :Transplant :B	60-70cm	1Ctr	5%

Native Woodland Edge Mix

Species	Specification	Height	Density	Mix %
Acer campestre	2x :Light Standard :clear stem 150-175cm :3 breaks :B	250-300cm	1Ctr	4%
Acer campestre	1+1 :Transplant - seed raised: B	60-80cm	1Ctr	4%
Betula pendula	1+1 :Transplant - seed raised: B	60-80cm	1Ctr	4%
Cornus sanguinea	1+1 :Transplant - seed raised: Branched: 3 brks: B	60-80cm	1Ctr	5%
Corylus avellana	1+1 :Transplant - seed raised: B	60-80cm	1Ctr	4%
Crataegus monogyna	2x :Light Standard :clear stem 150-175cm :3 breaks :B	250-300cm	1Ctr	4%
Crataegus monogyna	1+1 :Transplant - seed raised: B	60-80cm	1Ctr	4%
Ilex aquifolium	Leader with laterals :2L :C	60-80cm	1Ctr	5%
Juniperus communis	3x :Leader & laterals :C	60-80cm	1Ctr	4%
Ligustrum vulgare	0/2: Cutting: Branched: 3 brks: B	60-80cm	1Ctr	4%
Malus sylvestris	1+1 :Transplant :Seed Raised :B	60-80cm	1Ctr	4%
Malus sylvestris	2x :Light Standard :clear stem 150-175cm :3 breaks :B	250-300cm	1Ctr	4%
Prunus avium	1+1 :Seed raised :Transplant :B	60-70cm	1Ctr	5%
Prunus padus	2x :Light Standard :clear stem 150-175cm :3 breaks :B	250-300cm	1Ctr	4%
Prunus padus	1+1 :Transplant :Seed Raised :B	60-80cm	1Ctr	5%
Prunus spinosa	1+1 :Seed Raised :Transplant :B	60-70cm	1Ctr	5%
Rosa arvensis	1+1 :Transplant - seed raised: Branched: 3 brks: B	60-80cm	1Ctr	4%
Salix caprea	1+1 :Seed raised :Transplant :B	60-70cm	1Ctr	5%
Salix cinerea	1+1 :Seed raised :Transplant :B	60-70cm	1Ctr	5%
Salix viminalis	1+1 :Seed raised :Transplant :B	60-70cm	1Ctr	5%
Taxus baccata	3x :Transplant :Leader & laterals :RB	60-80cm	1Ctr	4%
Ulmus glabra	Transplant : Seed Raised :B	60-80cm	1Ctr	4%
Viburnum opulus	1+2: Transplant - seed raised: Branched: 3 brks: B	60-80cm	1Ctr	4%

Screening Woodland Core Mix

Species	Specification	Height	Density	Mix %
Acer campestre	2x :Light Standard :clear stem 150-175cm :3 breaks :B	250-300cm	1Ctr	5%
Acer campestre	1+1 :Transplant - seed raised: B	60-80cm	1Ctr	5%
Betula pendula	1+1 :Transplant - seed raised: B	60-80cm	1Ctr	5%
Betula pubescens	1+1 :Transplant - seed raised: B	60-80cm	1Ctr	5%
Crataegus monogyna	1+1 :Transplant - seed raised: B	60-80cm	1Ctr	20%
Ilex aquifolium	Leader with laterals :2L :C	60-80cm	1Ctr	10%
Larix sibirica	2+1 :Leader & laterals :B	125-150cm	1Ctr	5%
Picea abies	2+1 :Leader & laterals :RB	125-150cm	1Ctr	5%
Pinus sylvestris	1+1 :Leader & laterals :B	60-80cm	1Ctr	10%
Prunus spinosa	1+1 :Seed raised :B	60-80cm	1Ctr	20%
Quercus robur	1+1 :Transplant - seed raised: B	60-80cm	1Ctr	5%
Quercus robur	2x :Standard :Clear Stem min. 200 :3 brks :B	100-125cm	1Ctr	5%

Screening Woodland Edge Mix

Species	Specification	Height	Density	Mix %
Betula pendula	1+1: Transplant - seed raised: B	60-80cm	1Ctr	5%
Corylus avellana	1+1: Transplant - seed raised: B	60-80cm	1Ctr	5%
Crataegus monogyna	1+1: Transplant - seed raised: B	60-80cm	1Ctr	5%
Crataegus monogyna	2x :Light Standard :clear stem 150-175cm :3 breaks :B	250-300cm	1Ctr	5%
Ilex aquifolium	Leader with laterals :2L :C	60-80cm	1Ctr	5%
Juniperus communis	Leader & laterals :C	30-40cm	1Ctr	5%
Ligustrum vulgare	0/2: Cutting: Branched: 3 brks: B	60-80cm	1Ctr	5%
Malus sylvestris	1+1 :Transplant :Seed Raised :B	60-80cm	1Ctr	5%
Malus sylvestris	2x :Light Standard :clear stem 150-175cm :3 breaks :B	250-300cm	1Ctr	4%
Picea abies	Leader & laterals :C	60-80cm	1Ctr	10%
Prunus insititia	1+1 :Seed raised :B	60-70cm	1Ctr	5%
Prunus padus	1+1 :Transplant :Seed Raised :B	60-80cm	1Ctr	5%
Prunus padus	2x :Light Standard :clear stem 150-175cm :3 breaks :B	250-300cm	1Ctr	4%
Ribes odoratum	1+1 :Branched :3 brks :C	40-60cm	1Ctr	5%
Rosa arvensis	1+1 :Transplant - seed raised: Branched: 3 brks: B	60-80cm	1Ctr	5%
Sambucus nigra	Branched :3/6 brks :C	60-80cm	1Ctr	5%
Sorbus aucuparia	1+1 :Seedlings :Transplant :B	60-70cm	1Ctr	5%
Taxus baccata	3x :Transplant :Leader & laterals :RB	60-80cm	1Ctr	4%
Ulmus glabra	Transplant : Seed Raised :B	60-80cm	1Ctr	4%
Viburnum opulus	1+2: Transplant - seed raised: Branched: 3 brks: B	60-80cm	1Ctr	4%

Amenity Mix 1

Species	Specification	Height	Density	Pot Size	Mix %
Carex oshimensis 'Evergold'	Full Pot :C		4/m ²	5L	10%
Choisya ternata	Bushy :7 brks :C	40-60cm	4/m ²	10L	5%
Cornus sanguinea 'Midwinter Fire'	Bushy :5 brks :Branched :5 brks :C	60-80cm	4/m ²	5L	5%
Euonymus fortunei 'Emerald 'n' Gold'	Bushy :6/9 brks :C	20-30cm	4/m ²	5L	25%
Hebe 'Mrs Winder'	Bushy :5 brks :C	30-40cm	4/m ²	5L	25%
Hypericum androsaemum	Bushy :7 brks :C	30-40cm	4/m ²	5L	20%
Rudbeckia fulgida sullivantii 'Goldsturm'	Full Pot :C		4/m ²	5-7.5L	10%

Amenity Mix 2

Species	Specification	Height	Density	Pot Size	Mix %
Carex oshimensis 'Evergold'	Full Pot :C		4/m ²	5L	10%
Euonymus fortunei 'Silver Queen'	Bushy :7 brks :C	20-30cm	4/m ²	5L	25%
Hebe 'Red Edge'	Bushy :5/7 brks :C		4/m ²	5L	25%
Lavandula angustifolia 'Hidcote'	Bushy :7 brks :C	20-30cm	4/m ²	5L	20%
Miscanthus sinensis 'Morning Light'	Full Pot :C		4/m ²	10L	5%
Rudbeckia mollis	Full Pot :C		4/m ²	5L	10%
Veronicastrum virginicum 'Fascination'	Full Pot :C		4/m ²	5L	5%

Ornamental Mix 1

Species	Specification	Height	Density	Pot Size	Mix %
Berberis thunbergii 'Atropurpurea'	Branched :5 brks :C	40-60cm	4/m ²	5L	5%
Dryopteris filix-mas	Full Pot :C		4/m ²		5%
Fatsia japonica 'Variegata'	Branched :4 brks :C	60-80cm	4/m ²	10L	5%
Geranium macrorrhizum	Full Pot :C		4/m ²	10L	5%
Hakonechloa macra 'Aureola'	Full Pot :C		4/m ²	5L	10%
Helleborus orientalis	Full Pot :C		4/m ²	10L	5%
Heuchera 'Fireworks'	Full Pot :C		4/m ²		5%
Hyacinthus orientalis	Full Pot :C		4/m ²	10L	15%
Pachysandra terminalis 'Green Carpet'	Branched :5 brks :Several shoots :6/9 brks :C		4/m ²	5L	15%
Pinus mugo	Bushy :C	40-60cm	4/m ²	10L	5%
Polystichum setiferum	Full Pot :C		4/m ²	10L	5%
Sambucus nigra Black Lace	Branched :4 brks :C	60-80cm	4/m ²	10L	5%
Stipa arundinacea	Full Pot :C		4/m ²	10L	10%
Viburnum davidii	Bushy :4 brks :C	30-40cm	4/m ²	5L	5%

Ornamental Mix 2

Species	Specification	Height	Density	Pot Size	Mix %
Allium 'Purple Sensation'	Grade 12/+		4/m ²		10%
Calamagrostis acutiflora 'Karl Foerster'	Full Pot :C		4/m ²	5L	10%
Carex comans 'Bronze'	Full Pot :C		4/m ²	5L	15%
Cornus alba 'Elegantissima'	Branched :4 brks :C	80-100cm	4/m ²	10L	5%
Deschampsia cespitosa	Full Pot :C		4/m ²	5L	10%
Hebe 'Green Globe'	Bushy :4 brks :C		4/m ²	5L	15%
Lonicera pileata	Branched :4 brks :C		4/m ²	5L	15%
Sarcococca hookerana humilis	Bushy :5/6 brks :C		4/m ²	5L	15%
Verbena bonariensis	Full Pot :C		4/m ²	5L	5%

Pond Planting Mix 1

Species	Specification	Density	Mix %
<i>Alisma plantago-aquatica</i>	7cm Root; Trainer plug :Native British Origin	8/m ²	5%
<i>Butomus umbellatus</i>	7cm Root; Trainer plug :Native British Origin	8/m ²	15%
<i>Callitriche stagnalis</i>	7cm Root; Trainer plug :Native British Origin	8/m ²	5%
<i>Caltha palustris</i>	7cm Root; Trainer plug :Native British Origin	8/m ²	10%
<i>Carex pseudocyperus</i>	7cm Root; Trainer plug :Native British Origin	8/m ²	5%
<i>Carex riparia</i>	7cm Root; Trainer plug :Native British Origin	8/m ²	5%
<i>Filipendula ulmaria</i>	7cm Root; Trainer plug :Native British Origin	8/m ²	5%
<i>Iris pseudacorus</i>	7cm Root; Trainer plug :Native British Origin	8/m ²	10%
<i>Juncus effusus</i>	7cm Root; Trainer plug :Native British Origin	8/m ²	5%
<i>Juncus inflexus</i>	7cm Root; Trainer plug :Native British Origin	8/m ²	5%
<i>Lemna minor</i>	7cm Root; Trainer plug :Native British Origin	8/m ²	5%
<i>Lythrum salicaria</i>	7cm Root; Trainer plug :Native British Origin	8/m ²	5%
<i>Mentha cervina</i>	7cm Root; Trainer plug :Native British Origin	8/m ²	5%
<i>Myosotis scorpioides</i>	7cm Root; Trainer plug :Native British Origin	8/m ²	5%
<i>Nymphaea 'Albatross'</i>	7cm Root; Trainer plug :Native British Origin	8/m ²	5%
<i>Ranunculus lingua</i>	7cm Root; Trainer plug :Native British Origin	8/m ²	5%

Swale Planting Mix

Species	Specification	Density	Mix %
<i>Alisma plantago-aquatica</i>	7cm Root; Trainer plug :Native British Origin	8/m ²	5%
<i>Butomus umbellatus</i>	7cm Root; Trainer plug :Native British Origin	8/m ²	15%
<i>Caltha palustris</i>	7cm Root; Trainer plug :Native British Origin	8/m ²	10%
<i>Carex pseudocyperus</i>	7cm Root; Trainer plug :Native British Origin	8/m ²	10%
<i>Carex riparia</i>	7cm Root; Trainer plug :Native British Origin	8/m ²	10%
<i>Filipendula ulmaria</i>	7cm Root; Trainer plug :Native British Origin	8/m ²	5%
<i>Iris pseudacorus</i>	7cm Root; Trainer plug :Native British Origin	8/m ²	10%
<i>Juncus effusus</i>	7cm Root; Trainer plug :Native British Origin	8/m ²	5%
<i>Juncus inflexus</i>	7cm Root; Trainer plug :Native British Origin	8/m ²	10%
<i>Lythrum salicaria</i>	7cm Root; Trainer plug :Native British Origin	8/m ²	5%
<i>Mentha cervina</i>	7cm Root; Trainer plug :Native British Origin	8/m ²	5%
<i>Myosotis scorpioides</i>	7cm Root; Trainer plug :Native British Origin	8/m ²	5%
<i>Ranunculus lingua</i>	7cm Root; Trainer plug :Native British Origin	8/m ²	5%

BMD



E: info@bradleymurphydesign.co.uk
W: www.bradleymurphydesign.co.uk
T: 01926 676496