

LOCATION PLAN 1:5000

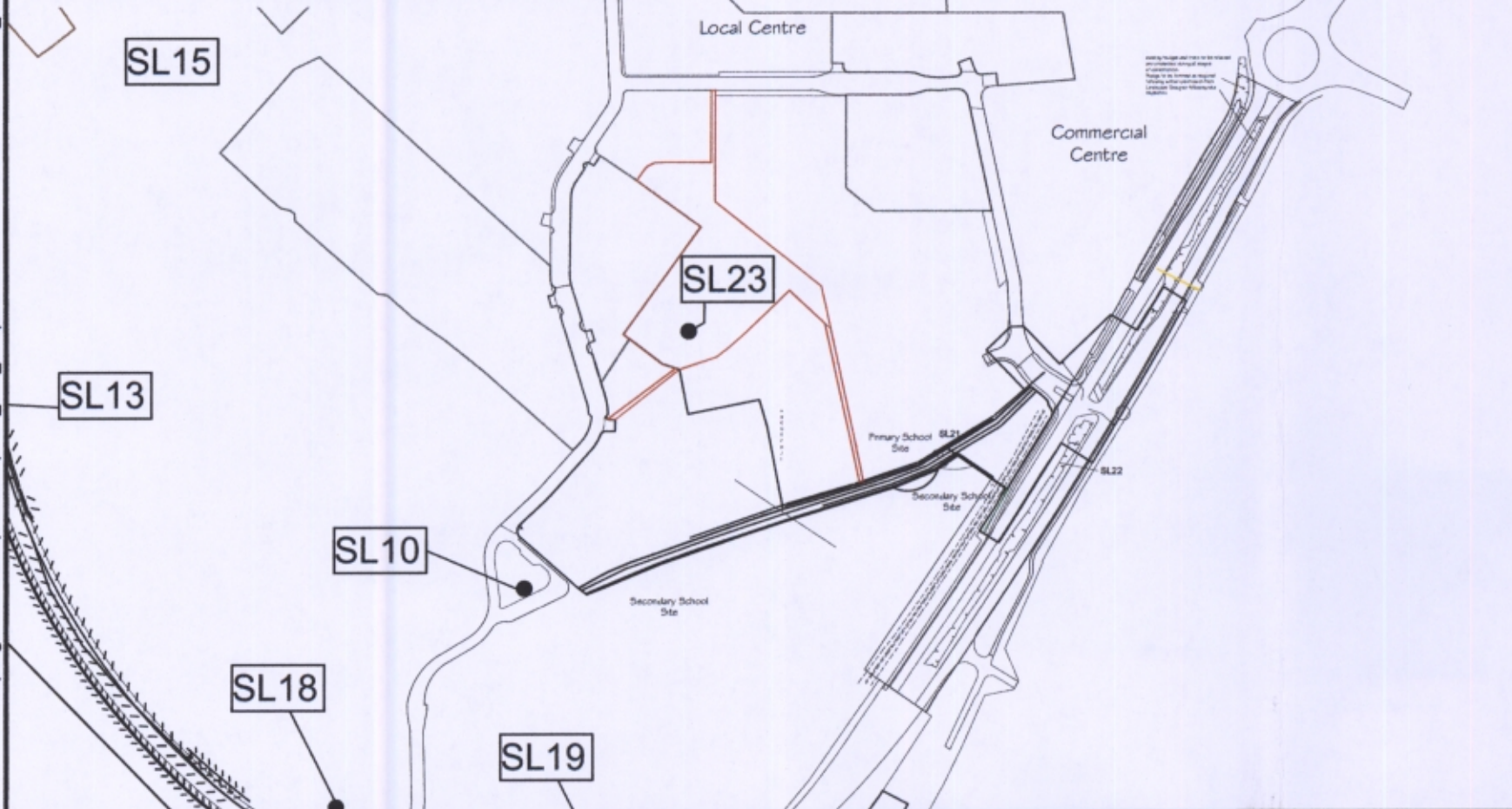

KEY

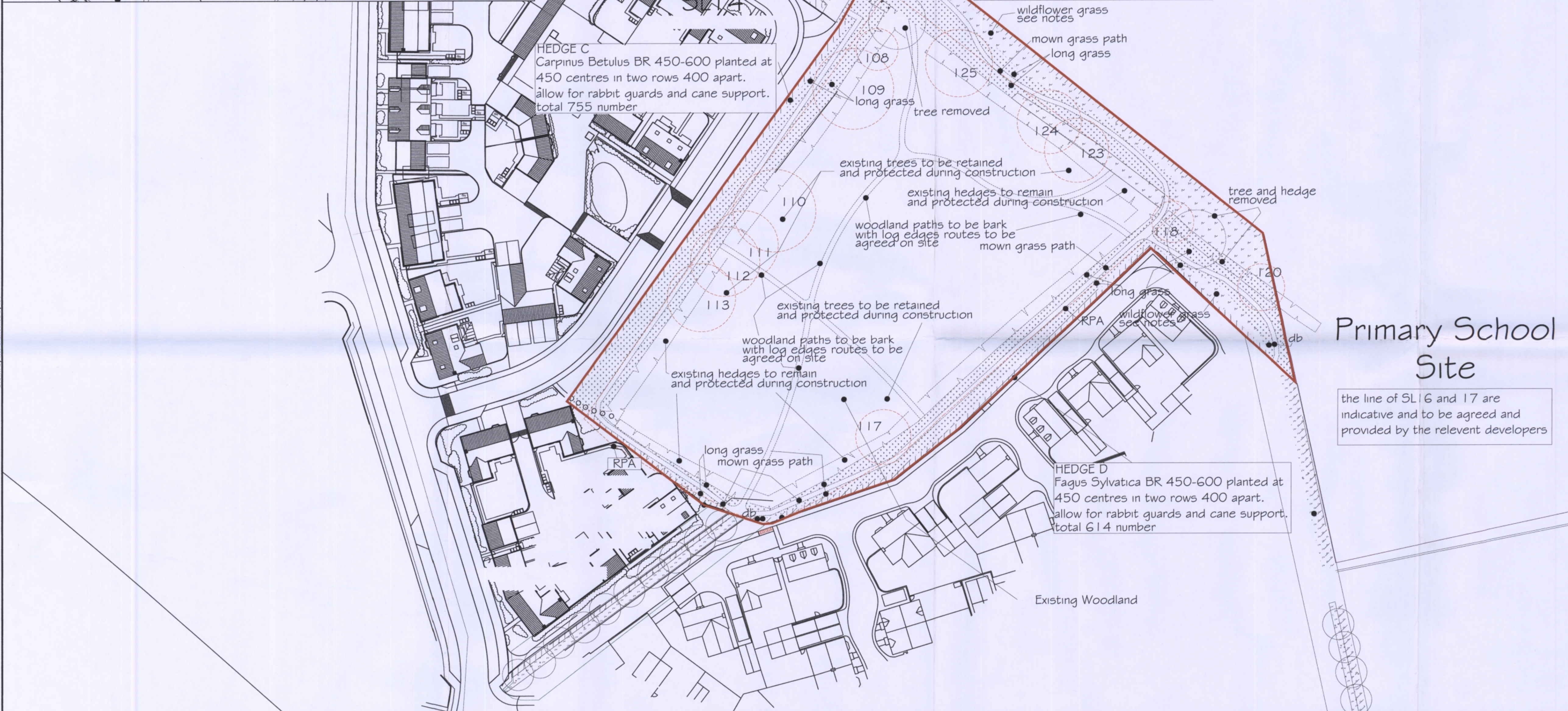
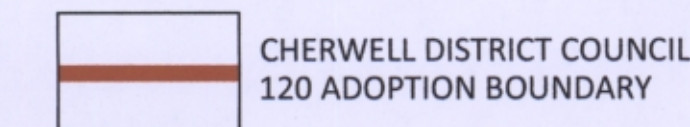

Primary School Site

the line of SL 16 and 17 are indicative and to be agreed and provided by the relevant developers

- Notes
- Drawing based on David Fountain Design Landscaping Details SL23 ref; DFD/BIC/L22 Rev P
 - Adoption boundaries based on DFD/BIC/L22 Rev P and WSP s38 Adoption Areas

Rev	Date	Description

Drawing Status

DAVID JARVIS ASSOCIATES

DAVID JARVIS ASSOCIATES LIMITED
 1 Tenbyon Street Swindon Wiltshire SN1 5DT
 Tel: 01793 612173 Fax: 01793 613625
 Email: mail@davidjarvis.biz

Client
COUNTRYSIDE PROPERTIES (UK) Ltd

Project
KINGSMERE - CHERWELL DISTRICT COUNCIL ADOPTION AREAS

Drawing Title
SL23

Scale 1:500	Sheet Size A1	Date FEB 2015
-----------------------	-------------------------	-------------------------

Drawing No. 2226/020	Revision -
--------------------------------	---------------

- Wildflower mix : from BSH tel 01522 868714
 www.bshamenity.com
 seed mix type RE 1
- | | |
|---------------------------------|---------------------------|
| Festuca rubra ssp litoralis 36% | Achillea millefolium 1.5% |
| Cynosurus cristatus 24% | Centaurea nigra 1.5% |
| Agrostis capillans 14% | Galium verum 1.5% |
| Trisetum Flavescence 6% | Leucanthemum vulgare 1.5% |
| Anthoxanthum odoratum 2% | Leontodon hispidus 1% |
| Plantago lanceolata 2% | Agrimonia eupatorium 1% |
| Prunella vulgaris 1.5% | Rhinanthus minor 1% |
| Ranunculus acris 1.5% | Lotus corniculatus 0.5% |
| Filipendula ulmaria 1.5% | Sanguisorba minor 0.5% |
| Ranunculus bulbosus 1.5% | |

- existing trees to remain and be protected
- existing hedges and trees removed see Arb report
- new single species hedges
- Long grass to be cut 4 times a year, selective weed killed throughout year seed mix type A19 from BSH tel 01522 868714 www.bshamenity.com

Woodland to be deadwooded as per the approved Arboncultural Report and recommendations, Existing regeneration including all Sycamore saplings to be cleared and the shrub layer within the woodland replaced with additional planting to include equal quantities of *Illex Aquifolium*, *Corylus Avellana*, and *Crataegus Monogyna* planted 450 - 600 bare root at 2.1m centres with cane and rabbit guards and left clear of existing hedge by 4m. The 4m margin between the regeneratin planting and the existing hedge to be planted with equal mix of *Illex Aquifolium*, *Corylus Avellana*, *Crataegus Monogyna*, *Acer Campestre*, *Quercus Petraea*, *Populus Tremula*, *Viburnum Lantana*, *Cornus Sanguinea*, *Ulmus Glabra*, all planted at 2.1m centres with cane and rabbit guards. The existing hedgerow to be infilled with an equal mix of *Ulmus Glabra*, *Quercus Illex*, *Acer Campestre* and *Crataegus Monogyna* 600-900 bareroot planted at 1m centres with cane and rabbit guards. All of the above to be in accordance with the Approved Ecology management Plan.

