

COPYRIGHT RAMBOLL UK LIMITED. ALL RIGHTS RESERVED. THIS DOCUMENT IS ISSUED FOR THE PARTY WHO COMMISSIONED IT AND FOR THE SPECIFIC PURPOSE CONNECTED WITH THE PROJECT ONLY. IT SHOULD NOT BE RELIED UPON BY ANY OTHER PARTY OR USED FOR ANY OTHER PURPOSE. RAMBOLL ACCEPTS NO RESPONSIBILITY OR LIABILITY WHICH MAY ARISE FROM RELIANCE OR USE OF THIS DOCUMENT OR THE DATA CONTAINED HEREIN BY ANY OTHER PARTY OR FOR ANY OTHER PURPOSE.

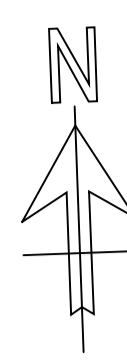

- Notes
- THIS DRAWING IS NOT TO BE SCALED.
 - THIS DRAWING IS TO BE READ IN CONJUNCTION WITH ALL RELEVANT ARCHITECTURAL, STRUCTURAL AND M&E DRAWINGS.
 - THIS IS NOT AN INSTALLATION DRAWING NOR A CO-ORDINATION DRAWING.
 - INDICATIVE BELOW GROUND DRAINAGE STRATEGY SUBJECT TO FURTHER DESIGN DEVELOPMENT AND COORDINATION.
 - THIS DRAWING IS BASED ON:
 - NBS3 SITE LAYOUT RECEIVED ON 02.09.2021
 - HISTORIC SITE INFO RECEIVED ON 22.03.2021
 - LANDSCAPE DRAWING RECEIVED ON 25.08.2021
 - FIRA LP2264-FIRA-MP-ST-P-LA-W5
 - ARCHITECT DRAWING RECEIVED ON 02.09.2021

- KEY:
- SITE BOUNDARY
 - PROPOSED FOUL WATER DRAIN
 - PROPOSED CHEMICAL FOUL WATER DRAIN
 - PROPOSED CHEMICAL FOUL WATER MANHOLE
 - PROPOSED FOUL WATER MANHOLE
 - EXISTING UTILITIES ZONE
 - EXISTING FOUL WATER DRAIN
 - EXISTING CHEMICAL FOUL WATER DRAIN
 - EXISTING FOUL WATER MANHOLE
 - FLOOR GULLY
 - DP

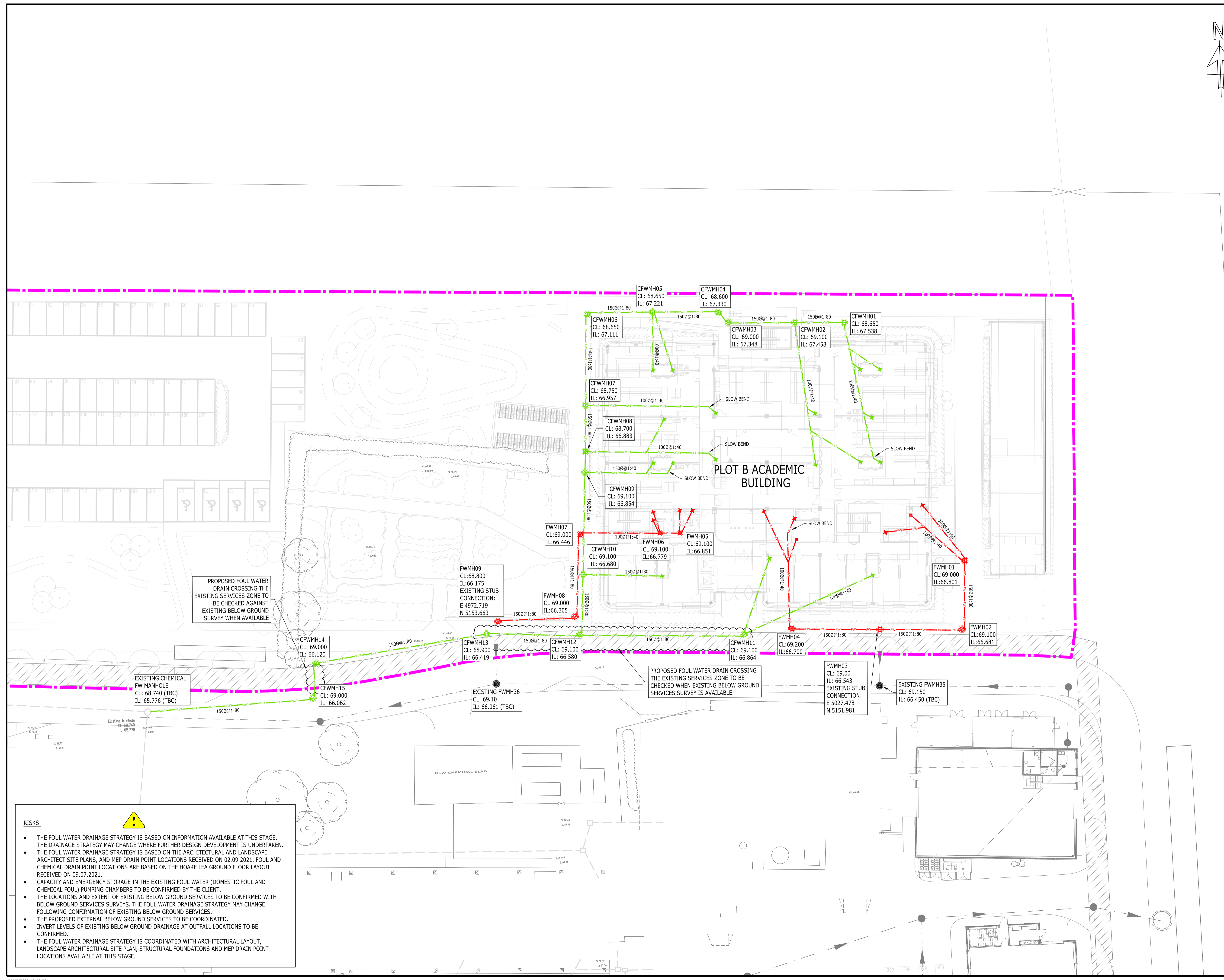
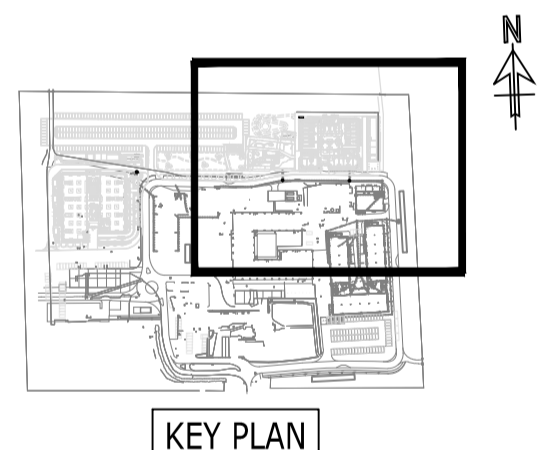

PROPOSED FOUL WATER DRAIN CROSSING THE EXISTING SERVICES ZONE TO BE CHECKED AGAINST EXISTING BELOW GROUND SURVEY WHEN AVAILABLE

PROPOSED FOUL WATER DRAIN CROSSING THE EXISTING SERVICES ZONE TO BE CHECKED WHEN EXISTING BELOW GROUND SERVICES SURVEY IS AVAILABLE

FWMH09 CL: 68.800
IL: 66.175
EXISTING STUB CONNECTION:
E 4972.719
N 5153.663

FWMH03 CL: 69.000
IL: 66.543
EXISTING STUB CONNECTION:
E 5027.478
N 5151.981

- RISKS:**
- THE FOUL WATER DRAINAGE STRATEGY IS BASED ON INFORMATION AVAILABLE AT THIS STAGE. THE DRAINAGE STRATEGY MAY CHANGE WHERE FURTHER DESIGN DEVELOPMENT IS UNDERTAKEN.
 - THE FOUL WATER DRAINAGE STRATEGY IS BASED ON THE ARCHITECTURAL AND LANDSCAPE ARCHITECT SITE PLANS, AND MEP DRAIN POINT LOCATIONS RECEIVED ON 02.09.2021. FOUL AND CHEMICAL DRAIN POINT LOCATIONS ARE BASED ON THE HOARE LEA GROUND FLOOR LAYOUT RECEIVED ON 09.07.2021.
 - CAPACITY AND EMERGENCY STORAGE IN THE EXISTING FOUL WATER (DOMESTIC FOUL AND CHEMICAL FOUL) PUMPING CHAMBERS TO BE CONFIRMED BY THE CLIENT.
 - THE LOCATIONS AND EXTENT OF EXISTING BELOW GROUND SERVICES TO BE CONFIRMED WITH BELOW GROUND SERVICES SURVEYS. THE FOUL WATER DRAINAGE STRATEGY MAY CHANGE FOLLOWING CONFIRMATION OF EXISTING BELOW GROUND SERVICES.
 - THE PROPOSED EXTERNAL BELOW GROUND SERVICES TO BE COORDINATED.
 - INVERT LEVELS OF EXISTING BELOW GROUND DRAINAGE AT OUTFALL LOCATIONS TO BE CONFIRMED.
 - THE FOUL WATER DRAINAGE STRATEGY IS COORDINATED WITH ARCHITECTURAL LAYOUT, LANDSCAPE ARCHITECTURAL SITE PLAN, STRUCTURAL FOUNDATIONS AND MEP DRAIN POINT LOCATIONS AVAILABLE AT THIS STAGE.

P02	STAGE 3 ISSUE	10.09 2021	BG LF	LS
P01	STAGE 2 ISSUE	28.05 2021	BG JS	MS
Rev	Description	Date	By Chk	App

STAGE 3

BEGBROOKE SCIENCE PARK ACADEMIC BUILDING

RAMBOLL

tel 020 7631 5291 london@ramboll.co.uk www.ramboll.co.uk

INDICATIVE FOUL WATER DRAINAGE LAYOUT ZONE B

Project No:	Scale (BA1):	Drawn:	Date:
1620011508	1:250	MES	MAY 2021
Drawing No:	Rev:		
BBSR-RAMB-ZZ-XX-DR-C-000102	P02		