

Basin 1 - Scale 1:200

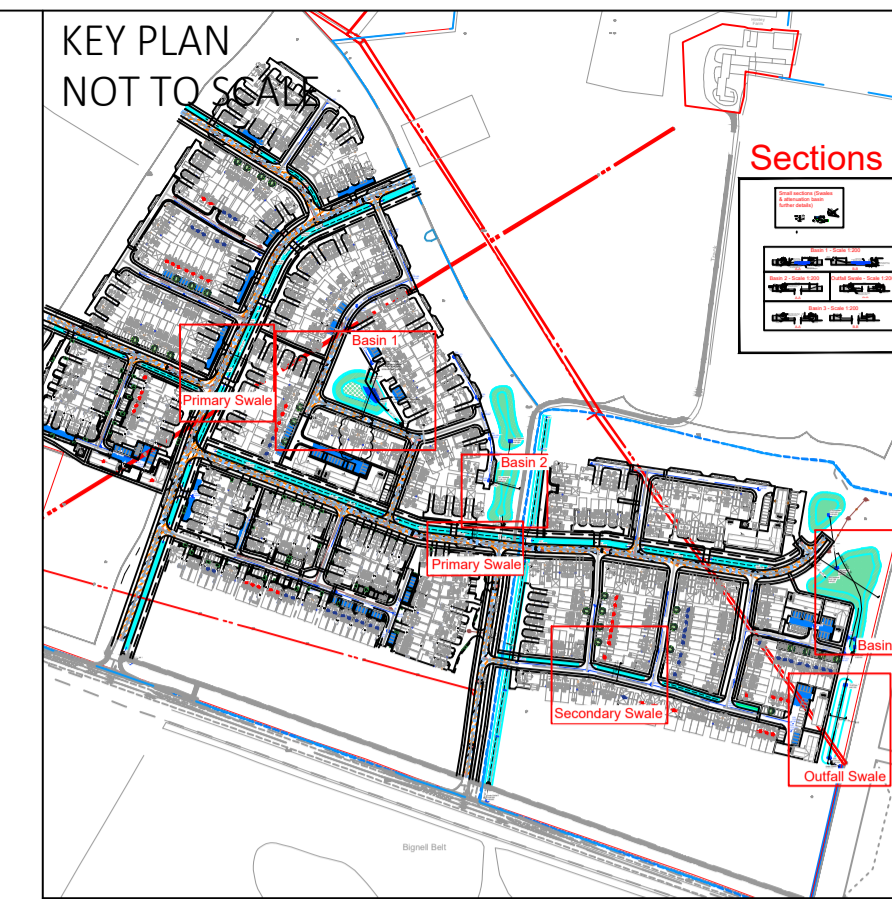

Basin 2 - Scale 1:200

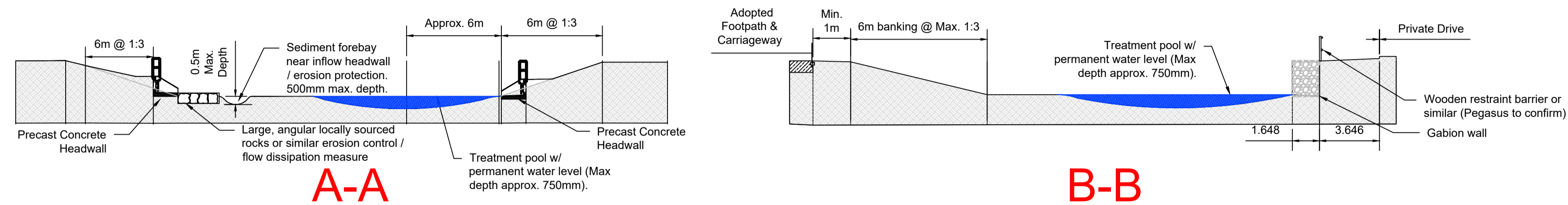
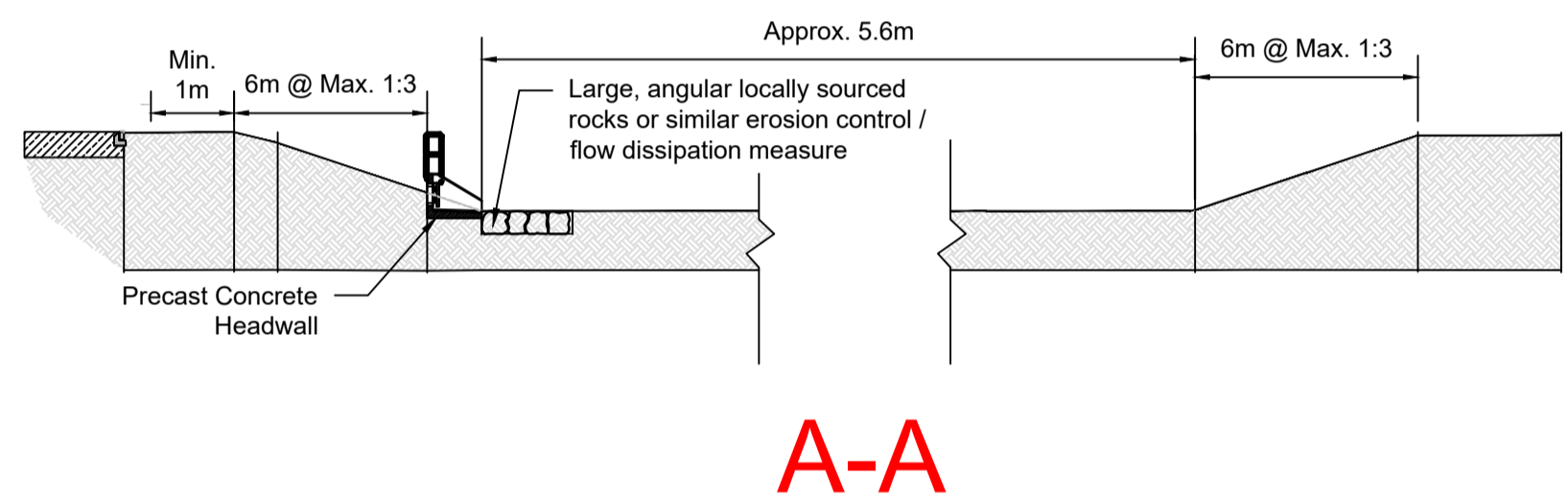

Outfall Swale - Scale 1:200

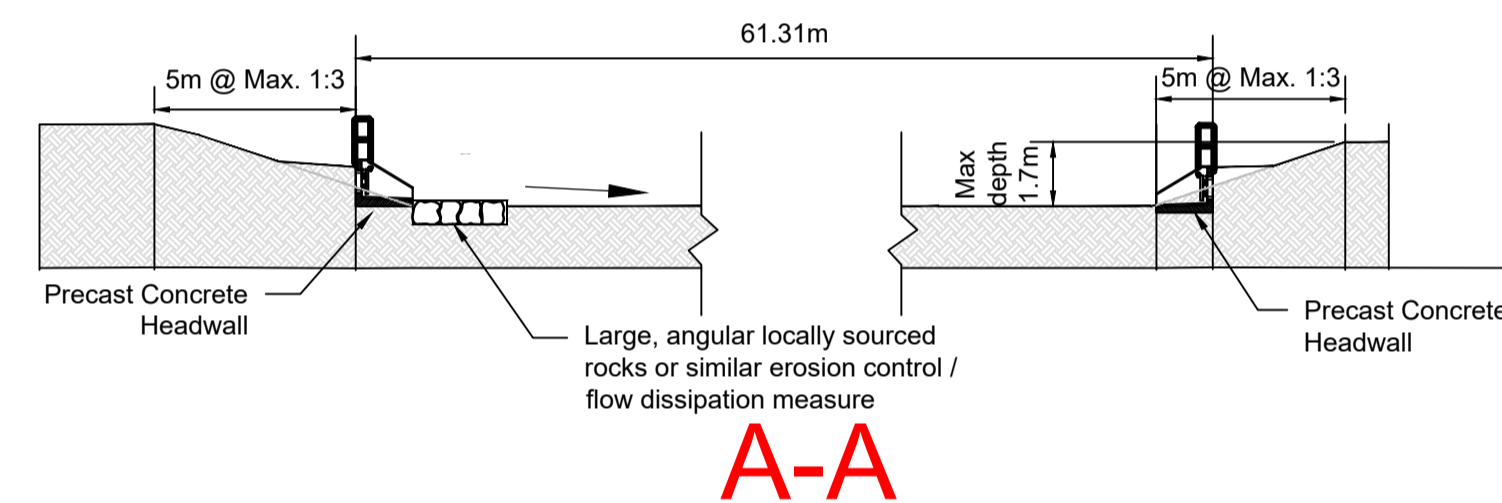

Basin 3 - Scale 1:200

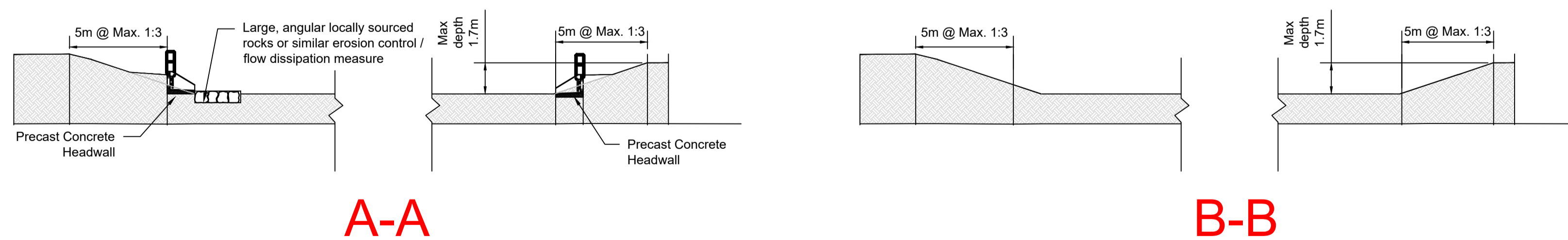

REVISIONS

P01 31/05/23 First Issue. JL BT BT

Rev	Date	Description	By	Ckd	App

Hydrock OVER COURT BARNES
OVER LANE
BRISTOL
BS32 4DF
T: +44 (0) 1454 619533
e: bristol@hydrock.com

CLIENT
CALA HOMES

PROJECT
HIMLEY VILLAGE, BICESTER

TITLE
BASIN & SWALE SECTIONS
SHEET 3

HYDROCK PROJECT NO. C-27141-C	SCALE @ A1 NTS	STATUS S2
STATUS DESCRIPTION INFORMATION	DRAWING NO. (PROJECT CODE-ORIGINATOR-ZONE-LEVEL-TYPE-ROLE-NUMBER) 27141-HYD-XX-XX-DR-C-2152	REVISION P01