

NOTES

1. This drawing is to be read in conjunction with all relevant Architects and Bailey Johnson Hayes drawings and specifications.
2. Do not scale. Work only to figured dimensions.
3. All dimensions to be confirmed on site prior to commencement of work.
4. Topographical Survey by MK Surveys: Drawing Ref: 33239 Rev 1
5. All works subject to agreement by Oxfordshire County Council (OCC) Road Agreements department.
6. This document contains OS data © Crown copyright 2017.

SCALE

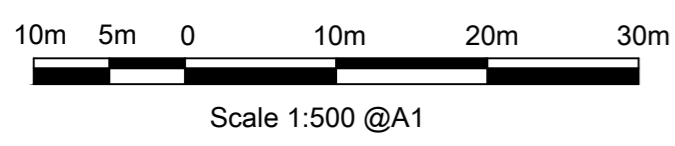

KEY

- OCC Highway Boundary - Purple
- Application Boundary - Red
- Vision Splays - Magenta
- Proposed Carriageway - Light Grey
- Proposed Shared Use - Mid Grey
- Proposed Footway - Dark Grey
- Proposed Tactile Paving - Buff
- Proposed Grassed Verge - Green
- Proposed Planting - Dark Green
- Vegetation Clearance - Red

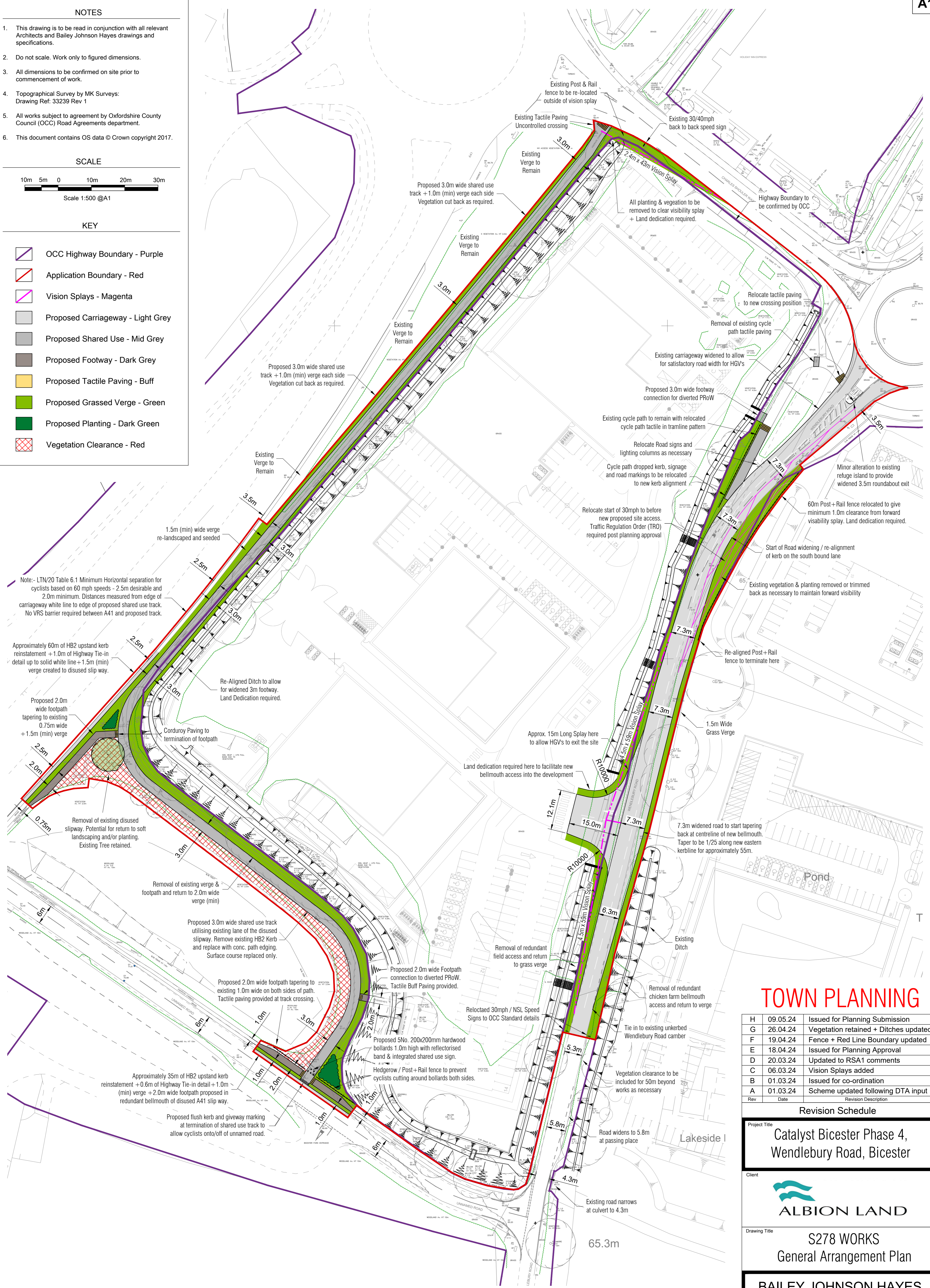

TOWN PLANNING

H	09.05.24	Issued for Planning Submission
G	26.04.24	Vegetation retained + Ditches updated
F	19.04.24	Fence + Red Line Boundary updated
E	18.04.24	Issued for Planning Approval
D	20.03.24	Updated to RSA1 comments
C	06.03.24	Vision Splays added
B	01.03.24	Issued for co-ordination
A	01.03.24	Scheme updated following DTA input
Rev	Date	Revision Description

Revision Schedule

Project Title
Catalyst Bicester Phase 4, Wendlebury Road, Bicester

Client
ALBION LAND

Drawing Title
**S278 WORKS
General Arrangement Plan**

BAILEY JOHNSON HAYES
Consulting Engineers
ST.ALBANS: Suite 4, Phoenix House, 63 Campfield Rd, ST.ALBANS, Herts AL1 5FL

Scale: 1:500 @A1
Date: 21.02.24
Drawn: JNG

Drawing Number
S1502-S278-01 H



General Arrangement Plan 1:500