

Trees highlighted in grey hatch have either fallen or are recommended for removal and root protection not required

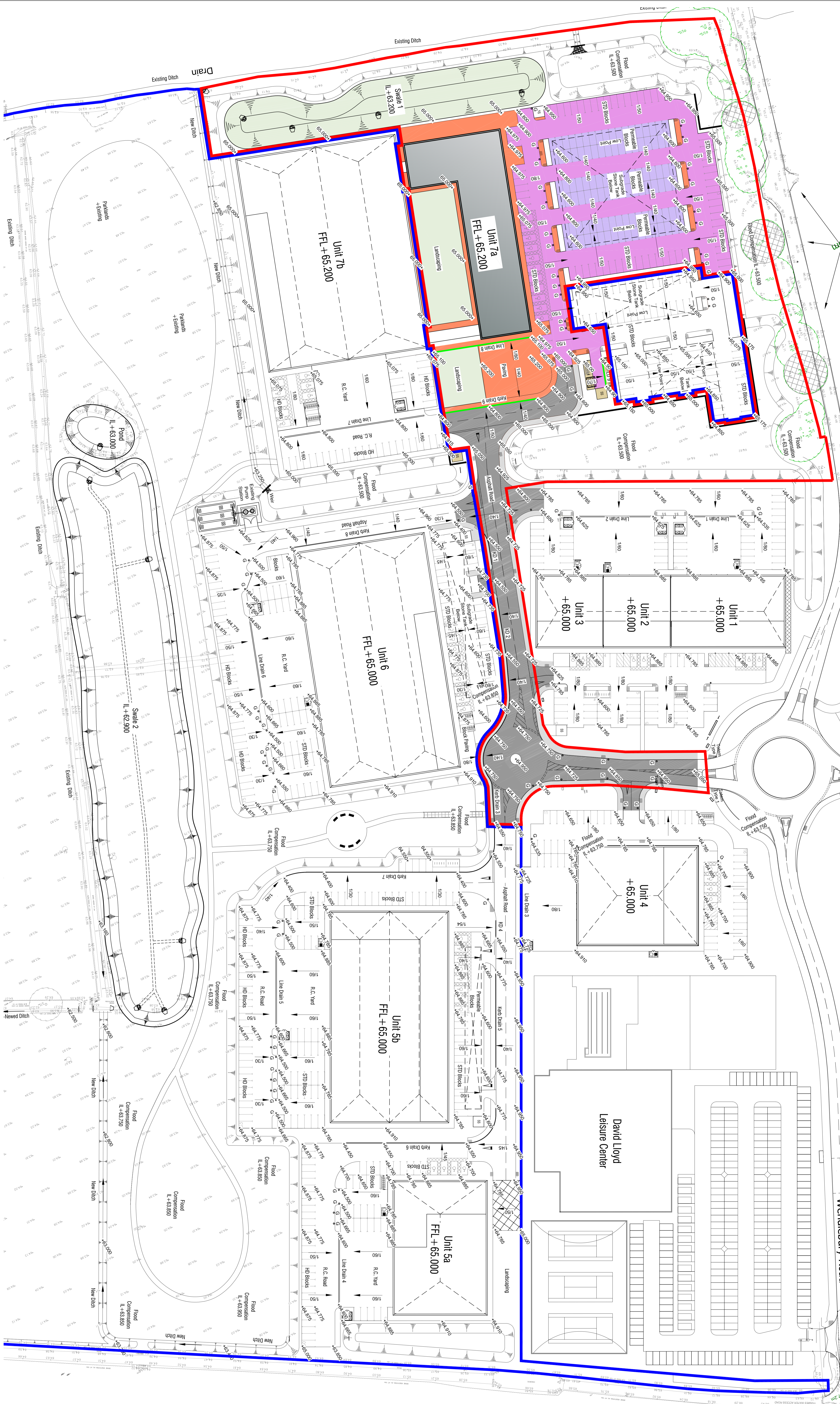

Full App External Works Layout 1:500

Application Boundary
Other Land In Control of the Applicant

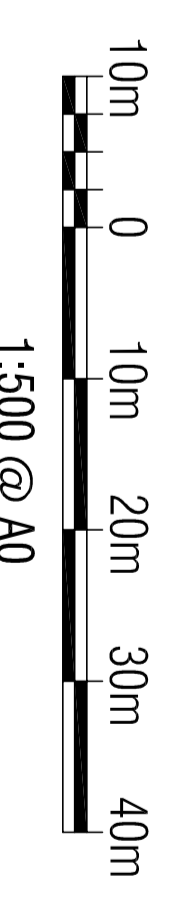

- RC Yard Kerb Detail 1:25
- Heavy Duty Block Paving 1:25
- Standard Block Paving 1:25
- Permeable Block Paving 1:25
- Asphalt Kerb Detail 1:25
- Block Paving Footpath 1:25
- Bitmac Footpath 1:25
- Perimeter Gravel Strip Detail 1:25

NOTE: LANDSCAPING SCHEME TO BE AGREED WITH ARCHITECT

NOTE: SITE LAYOUT & FINISHES TO BE AGREED WITH ARCHITECT

- Key:**
- New Office/Production Building
 - New Swale SUDS Feature
 - 200mm thick RC Yard Slab
 - 80mm HD Block Paving
 - 60mm Standard Block Paving
 - 60mm Permeable Block Paving
 - 60mm Footpath Block Paving
 - Asphalt Estate Road
 - Bitmac Footpaths
 - Ground Guard Fire Path

FULL APP

TOWN PLANNING

ALBION LAND

FULL APPLICATION
External Works & Levels

BAILEY JOHNSON HAYES
Consulting Engineers

ST ALBANS, Suite 4, Fossil Works, 63 Campbell Rd, ST ALBANS, Herts, AL1 5LX
MANCHESTER, Cherry Row, 2nd Floor, 200, MANCHESTER, M2 9PW

Scale: 1:500 @ A0
Date: 11.03.22
Drawing Number: S1358-Ext-76

Project Title: **Catalyst Biocaster**
Wendlebury Road, Biocaster

Revision Schedule

Rev: _____ Date: _____ Description: _____

Client: **ALBION LAND**