

- DW 18/08/21: First Issue
- Rev 01 DW 25/08/21: Drawing status for Planning; general updates to design layout to reflect design development
- 02 RS 10/09/21 Issued for stage 3
- 03 DW 12/09/23 Issued for Planning NMA. Amendments to gas store layout.

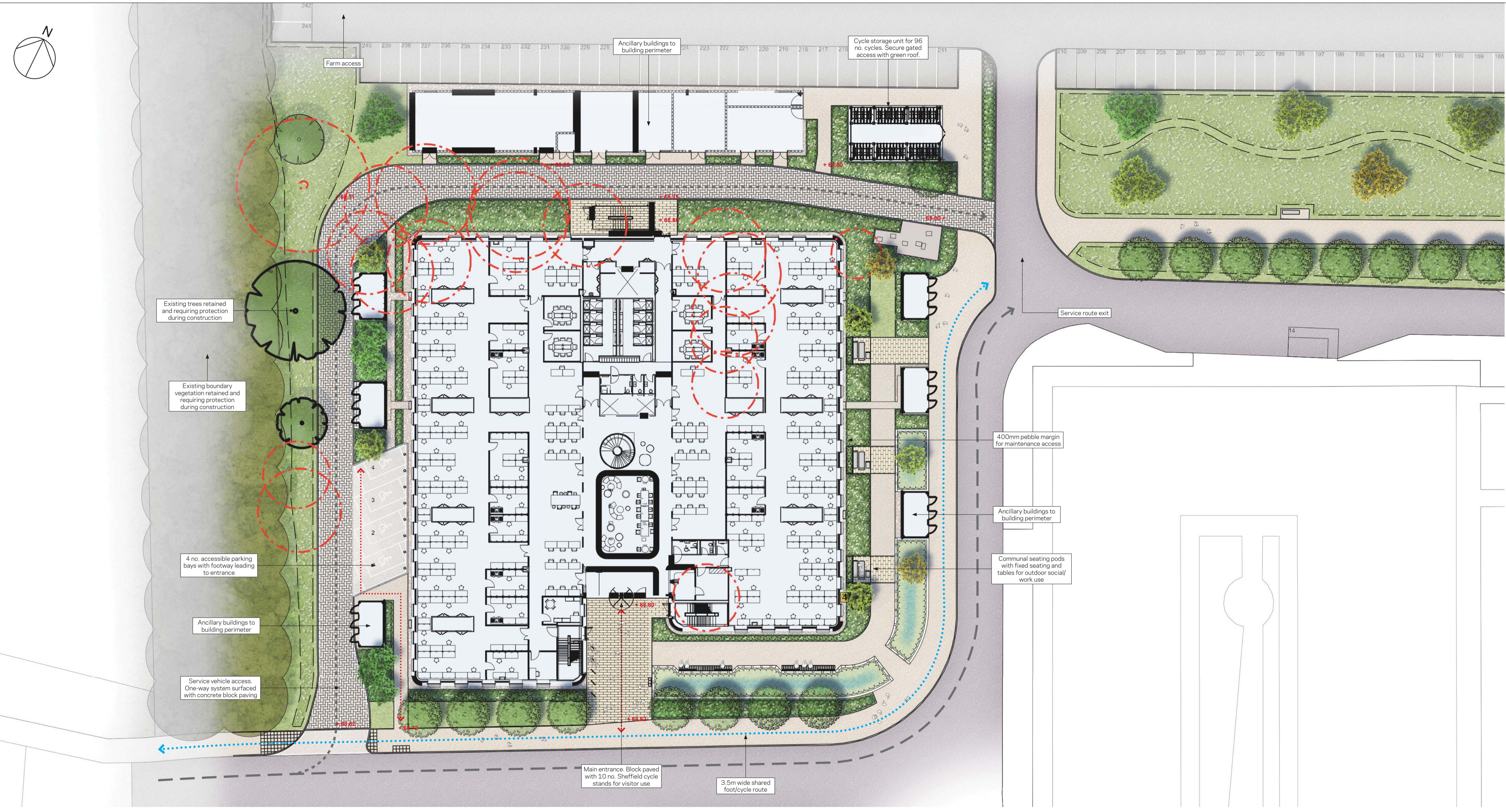

Hard Landscape

- Entrance paving: exposed aggregate concrete block paving
- Service routes: herringbone exposed aggregate concrete block paving
- Roads: standard bituminous macadam surface
- bituminous macadam seeded with buff aggregate to foot/cycle paths
- Naturally durable hardwood benches with powder coated steel sides
- Benches, chairs and tables for pocket gardens / social work spaces
- Cycle store: 96 no. per store with Sheffield stands at grade and storage racks above
- Cycle hoops to main entrances (10 spaces for Commercial Building, 4 spaces for Academic Building)
- Gas stores with naturally durable hardwood screen to building elevation. Mesh panel to remaining elevations

Soft Landscape

- Existing woodland belt to be retained and protected during construction
- Existing trees and hedges on site to be retained and protected during construction
- Proposed avenue trees: 20-25cm girth
- Multistem trees: 3.5m-4m
- Lawn areas
- Species rich meadow grasses with mown paths

- Rain gardens
- Attenuation basin and semi dry/wet species mixes
- Shrub planting: 6 plants per m² minimum
- Clipped formal hedges
- Existing trees to be removed

Movement

- Key pedestrian connections (minimum width 1.8m)
- Shared pedestrian cycleway (width varies 3.0-3.5m)
- Vehicular circulation
- Service vehicle routes

PLANNING

project:
Begbroke Science Park

job number:
LP2264

drawing title:
Reserved Matters Commercial Building Landscape General Arrangement

drawing number:
LP2264-FIR-00-ZZ-DR-L-0004

revision	scale	date
03	1:250 @ A1	18/08/21
	drawn	auth
for information	RS	VP
for construction		18/08/21

