

Remediation Plan - Western Half of Plot C

(Reproduced from a plan provided by the Client, Not to Scale)

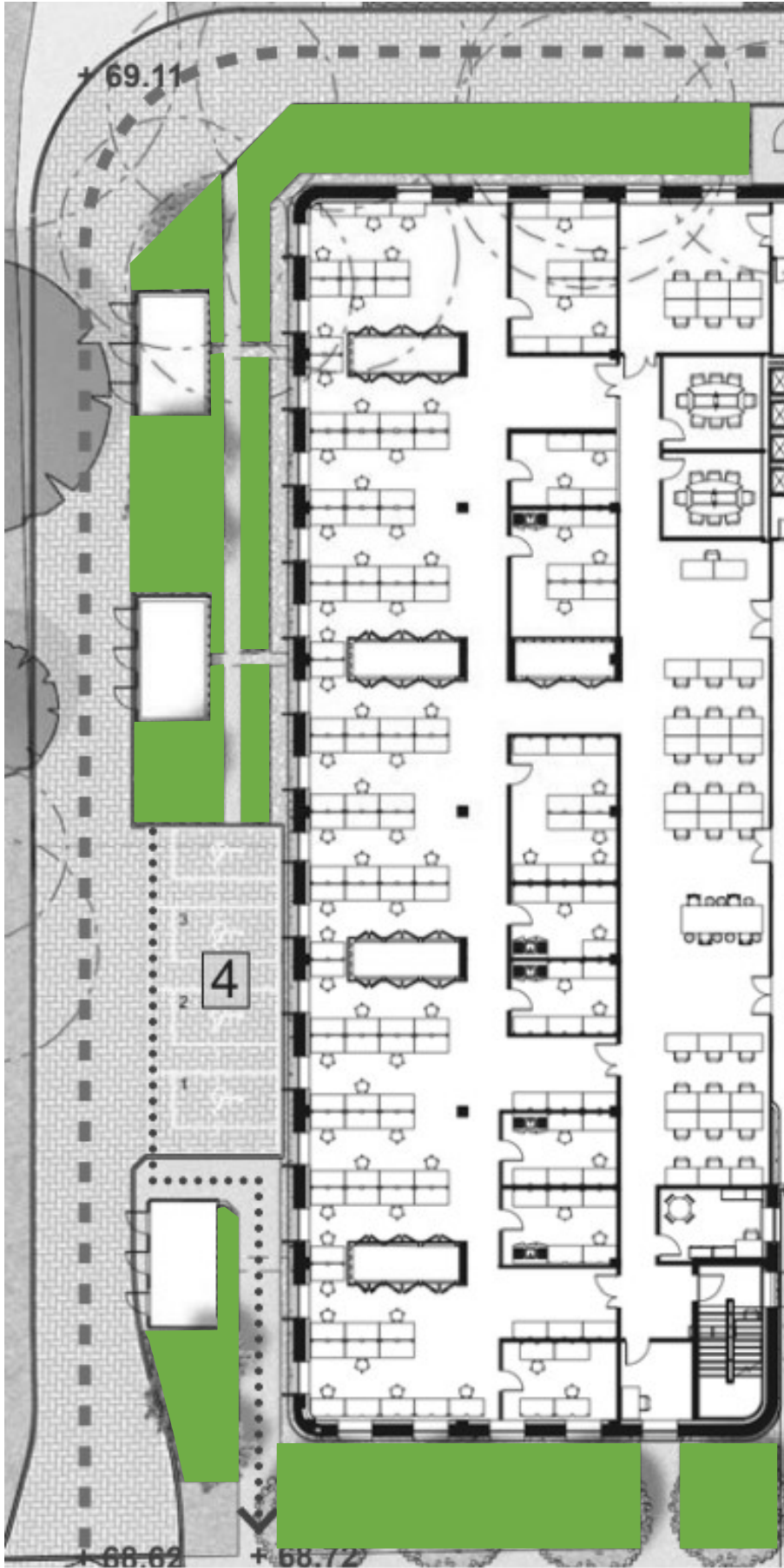

Key and Details

Areas to be remediated with 0.40m thick capping layer of clean imported topsoil =

For the creation of soft landscaping (coloured green), the made ground shall be removed to a minimum depth of 0.40m and replaced with an equivalent thickness of clean inert soil.

All other areas of the site (not highlighted green) are proposed to comprise permanent hardstanding/paving or building floors where no remediation of soils is necessary - as end users would not be expected to penetrate these layers and come into contact with soils containing elevated concentrations of soil contaminants. Following the importation and placement of the imported soil, the thickness and suitability of the imported soils shall be verified by Ground Engineering Limited. Eight Samples of the imported and placed soil shall be obtained by a Geo-environmental Engineer using hand auger equipment from across these areas.

These samples will be chemically tested (by a UKAS accredited laboratory) to confirm that the imported soil is suitable for use. The testing shall include for total concentrations of arsenic, cadmium, chromium, lead, mercury, selenium, nickel and benzo[a]pyrene, together with speciated polyaromatic hydrocarbons (PAH), boron, copper and zinc, phenols, total and free cyanide, hexavalent chromium, sulphate, sulphide, pH, organic content and total petroleum hydrocarbons (TPH). The soil samples shall also be screened for the presence/absence of asbestos using laboratory microscopy. The findings and available supporting evidence shall be then be presented in a validation report that will be submitted to the Local Authority.

Project: Begbroke Science Park, Kidlington

Client: Buro Four

**GROUND
ENGINEERING
LIMITED**
Peterborough

Tel : 01733 566566

Project No.

C15633