

NETWORK RAIL (EAST WEST  
RAIL WESTERN SECTION PHASE 2)

NOTES:

1. THIS DRAWING IS NOT TO BE SCALED.
2. ALL DIMENSIONS ARE IN METRES (m) UNLESS SHOWN OTHERWISE.
3. THIS DRAWING IS TO BE READ IN CONJUNCTION WITH THE HIGHWAY DESIGN PACKAGE OF DRAWINGS AND DOCUMENTS.
4. WHEREVER REQUIRED, ROAD MARKINGS ARE TO BE LAID IN ACCORDANCE WITH THE TRAFFIC SIGN REGULATIONS AND GENERAL DIRECTIONS 2016 & TRAFFIC SIGNS MANUAL CHAPTER 5 (2003).

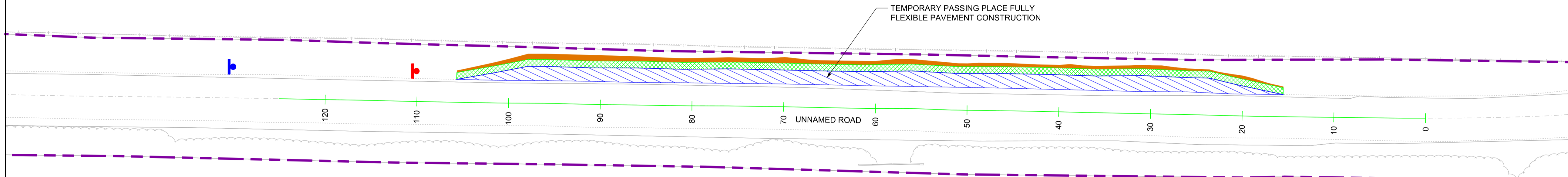

Rev	Date	Description of Revisions	Desd	Chkd	Appr	Suitability
B01	23/09/19	FOR INFORMATION				N.T. L.T. S.A.
Status						SHARED - for Information S2



Project  
**East West Rail  
(Western Section)  
Phase 2**

Drawing Title  
**PASSING PLACE A2\_P\_8  
GENERAL ARRANGEMENT**

Designed	Nagoth Thomas Ravi Kumar	Signed	N. T. R. Kumar	Date	06/09/19
Drawn	Ravikumar KN	Signed	R. KN	Date	22/01/19
Checked	Lisa Taylor	Signed	L. Taylor	Date	12/09/19
Approved	Stephen Abe	Signed	S. Abe	Date	12/09/19

Scale(s)	1:250	ELR - Project Chainage (Miles/Yards)	OXD -
Design Package Risk Classification	Normal	Sheet	1 of 1
Alternative Reference		Revision	B01

Drawing Number  
133735\_2A-EWR-OXD-A2\_P\_8-DR-CH-010001

**KEY:**

	HIGHWAY BOUNDARY
	EXISTING ROAD EDGE
	PROPOSED ROAD EDGE
	NEW PAVEMENT
	GRASS VERGE
	PROPOSED EARTHWORKS
	PROPOSED TRAFFIC SIGN
	RELOCATED TRAFFIC SIGN

**SAFETY, HEALTH AND ENVIRONMENTAL INFORMATION**

THE WORKS ARE TO BE UNDERTAKEN BY A COMPETENT DELIVERY TEAM, AND THEREFORE ONLY EXCEPTIONAL RISKS RELATING TO THE WORKS ASSOCIATED WITH THIS DRAWING ARE IDENTIFIED BELOW. FOR FURTHER DETAILS AND PROPOSED SAFETY MEASURES REFER "EWR PHASE 2 HAZARD LOG WORKING COPY" EB DOC. REF: 133735-NWR-RSA-SSD-000001.

ID	HAZARD DESCRIPTION
NONE	NONE

INDICATES PROJECT RISKS (EWR2-DRIS- .....)  
 INDICATES H&S RISKS (EWR2-HAZ- .....)

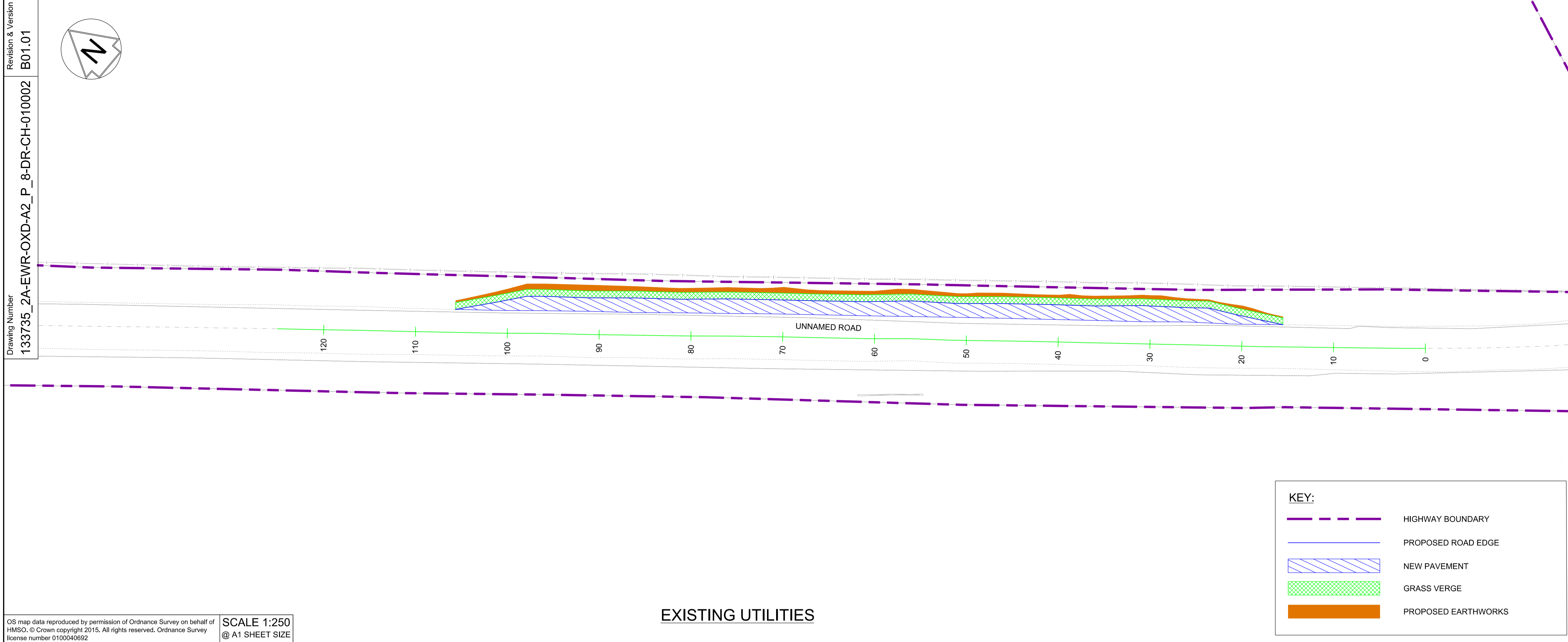
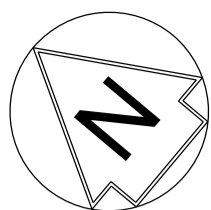

**EXISTING UTILITIES**

OS map data reproduced by permission of Ordnance Survey on behalf of HMSO. © Crown copyright 2015. All rights reserved. Ordnance Survey license number 0100040692

SCALE 1:250  
@ A1 SHEET SIZE

**KEY:**

	HIGHWAY BOUNDARY
	PROPOSED ROAD EDGE
	NEW PAVEMENT
	GRASS VERGE
	PROPOSED EARTHWORKS

**NETWORK RAIL (EAST WEST RAIL WESTERN SECTION PHASE 2)**

**NOTES:**

1. THIS DRAWING IS NOT TO BE SCALED.
2. ALL DIMENSIONS ARE IN METRES (m) UNLESS SHOWN OTHERWISE.
3. THIS DRAWING IS TO BE READ IN CONJUNCTION WITH THE HIGHWAY DESIGN PACKAGE OF DRAWINGS AND DOCUMENTS.
4. THE EXACT LOCATION AND EXTENT OF BURIED SERVICES SHALL BE VERIFIED ON SITE PRIOR TO COMMENCEMENT OF THE WORKS. AGREEMENT WITH PRIVATE LANDOWNERS SHALL BE OBTAINED PRIOR TO WORKS WHERE ACCESS TO PRIVATE LAND IS REQUIRED.
5. THIS DRAWING SHOWS THE POSITION OF UTILITY COMPANIES APPARATUS KNOWN TO OPERATE IN THE AREA IMMEDIATELY ADJACENT TO AND WITHIN THE LAND TAKE BOUNDARY FOR EAST WEST RAIL.
6. THE POSITIONS INDICATED FOR THE APPARATUS ARE BASED ON RECORDS PROVIDED BY NETWORK RAIL. THE ACCURACY OF THE DRAWING IS THEREFORE LIMITED BY THE ACCURACY OF THE RECORDS MAINTAINED BY THE UTILITY COMPANIES. THE METHODS AVAILABLE TO PROCESS / REPRODUCE THIS INFORMATION IN THE DRAWINGS AND THE AGE OF THE INFORMATION. THERE IS THE POSSIBILITY THAT APPARATUS HAS BEEN ADDED OR REMOVED SINCE THE RECORDS WERE PROVIDED.
7. ALL SEARCHES MUST BE VERIFIED AND ESTABLISHED ON SITE BEFORE WORK COMMENCES. IT IS THE RESPONSIBILITY OF THE EWR ALLIANCE TO IDENTIFY AND LOCATE UTILITY PLANT PRIOR TO WORK GOING AHEAD.
8. PRIOR TO THE COMMENCEMENT OF WORKS, A SUITABLY QUALIFIED ECOLOGIST SHALL INSPECT THE SITE FOR THE PRESENCE OF PROTECTED SPECIES AND HABITAT. THE ECOLOGIST SHALL THEN ADVISE EWR ALLIANCE ON THE REQUIRED PRECAUTIONARY METHODS AND AREAS OF EXCLUSION.
9. WHERE SITE CLEARANCE WORKS HAVE THE POTENTIAL TO IMPACT TREES OR HEDGES WHICH ARE TO BE RETAINED, AN ARBORICULTURALIST SHALL BE PRESENT TO ADVISE ON ROOT PROTECTION ZONE EXTENTS, ROOT PRUNING AND CROWN RAISING. WORKS SHALL BE CARRIED OUT IN ACCORDANCE WITH BS3998:2010.
10. SITE CLEARANCE, WHERE THERE IS PROXIMITY TO HABITAT OF PROTECTED SPECIES, SHALL BE CARRIED OUT UNDER THE SUPERVISION OF A SUITABLY QUALIFIED ECOLOGIST.
11. THE EXTENTS OF ALL SITE CLEARANCE WORKS SHALL BE RECORDED IN THE AS-BUILT SITE CLEARANCE DRAWINGS AND SHALL ALSO BE RECORDED, WITH PHOTOGRAPHS OF FEATURES PRIOR TO REMOVAL, IN THE SITE CLEARANCE REGISTER. THE SITE CLEARANCE REGISTER SHALL BE MAINTAINED BY EWR ALLIANCE AND WILL INFORM REINSTATEMENT DETERMINATION.
12. IN LOCATIONS WHERE EXISTING TREES OVERHANG THE PASSING PLACE CROWN LIFTING, TO GIVE 5m CLEARANCE ABOVE GROUND LEVEL, SHALL BE UNDERTAKEN TO THE BACK OF THE PROPOSED VERGE. THIS SHALL BE UNDERTAKEN UNDER THE SUPERVISION OF AN ARBORICULTURIST.
13. FOR CLARITY ONLY THE TRUNKS OF EXISTING TREES ARE SHOWN, FOR CANOPY EXTENTS THE TREE SURVEY MODEL AND MASTER SCHEDULE ARE TO BE REFERRED TO.
14. NO UTILITIES ARE PASSING AT THIS PASSING PLACE.

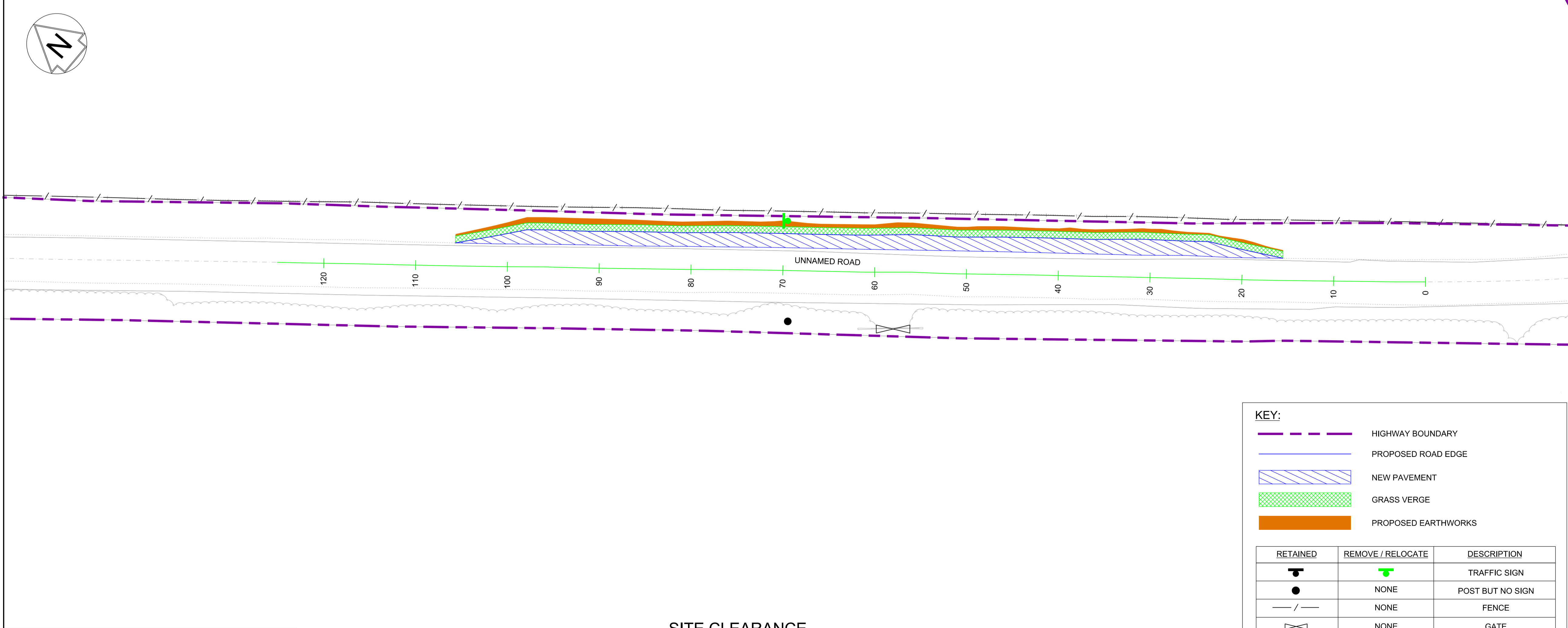

**SITE CLEARANCE**

OS map data reproduced by permission of Ordnance Survey on behalf of HMSO. © Crown copyright 2015. All rights reserved. Ordnance Survey license number 0100040692

SCALE 1:250  
@ A1 SHEET SIZE

**KEY:**

	HIGHWAY BOUNDARY
	PROPOSED ROAD EDGE
	NEW PAVEMENT
	GRASS VERGE
	PROPOSED EARTHWORKS

RETAINED	REMOVE / RELOCATE	DESCRIPTION
		TRAFFIC SIGN
	NONE	POST BUT NO SIGN
	NONE	FENCE
	NONE	GATE



B01	23/09/19	FOR INFORMATION	N.T.	L.T.	S.A.
Rev	Date	Description of Revisions	Dend	Chkd	Appr
Status					

SHARED - for Information S2



Project  
**East West Rail (Western Section) Phase 2**

Drawing Title  
**PASSING PLACE A2\_P\_8 EXISTING UTILITIES AND SITE CLEARANCE**

Designed	Nagoth Thomas Ravi Kumar	Signed	N. T. R. Kumar	Date	06/09/19
Drawn	Ravikumar KN	Signed	R. KN	Date	22/01/19
Checked	Lisa Taylor	Signed	L. Taylor	Date	12/09/19
Approved	Stephen Abe	Signed	S. Abe	Date	12/09/19

Scale(s)  
1:250  
ELR - Project Chainage (Miles Yards)  
OXD -

Design Package Risk Classification  
**Normal**

Alternative Reference  
Sheet  
1 of 1

Drawing Number  
133735\_2A-EWR-OXD-A2\_P\_8-DR-CH-010002  
Revision  
B01

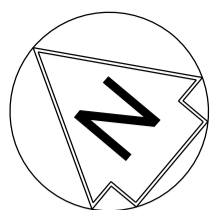

NETWORK RAIL (EAST WEST  
 RAIL WESTERN SECTION PHASE 2)

NOTES:

1. THIS DRAWING IS NOT TO BE SCALED.
2. ALL DIMENSIONS ARE IN METRES (m) UNLESS SHOWN OTHERWISE.
3. THIS DRAWING IS TO BE READ IN CONJUNCTION WITH THE HIGHWAY DESIGN PACKAGE OF DRAWINGS AND DOCUMENTS.

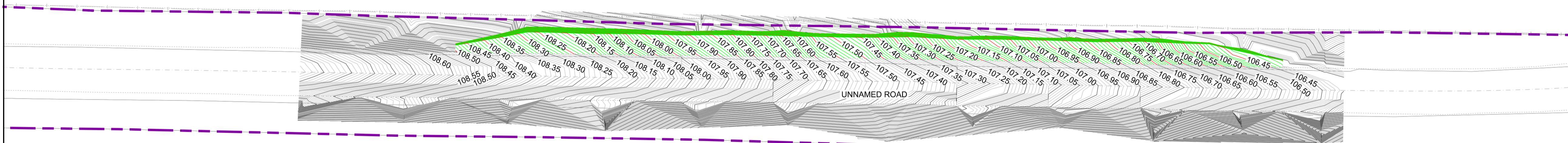

Rev	Date	Description of Revisions	Desd	Chkd	Appr	Suitability
B01	23/09/19	FOR INFORMATION		N.T.	L.T.	S.A.
Status						S2



Project  
 East West Rail  
 (Western Section)  
 Phase 2

Drawing Title  
 PASSING PLACE A2\_P\_8  
 EXISTING AND PROPOSED  
 CONTOURS

Designed	Nagoth Thomas Ravi Kumar	Signed	N. T. R. Kumar	Date	06/09/19
Drawn	Ravikumar KN	Signed	R. KN	Date	22/01/19
Checked	Lisa Taylor	Signed	L. Taylor	Date	12/09/19
Approved	Stephen Abe	Signed	S. Abe	Date	12/09/19

Scale(s)	1:250	ELR - Project Chainage (Miles Yards)	OXD -
Design Package Risk Classification	Normal	Sheet	1 of 1
Alternative Reference		Revision	B01

**KEY:**

	HIGHWAY BOUNDARY
	EXISTING CONTOUR MAJOR @ 0.05m INTERVALS
	EXISTING CONTOUR MINOR @ 0.01m INTERVALS
	PROPOSED CONTOUR MAJOR @ 0.05m INTERVALS
	PROPOSED CONTOUR MINOR @ 0.01m INTERVALS

NETWORK RAIL (EAST WEST)  
RAIL WESTERN SECTION PHASE 2

NOTES:

1. THIS DRAWING IS NOT TO BE SCALED.
2. ALL DIMENSIONS ARE IN METRES (m) UNLESS SHOWN OTHERWISE.
3. THIS DRAWING IS TO BE READ IN CONJUNCTION WITH THE HIGHWAY DESIGN PACKAGE OF DRAWINGS AND DOCUMENTS.
4. CHAINAGES SHOWN ON THIS DRAWING ARE ALONG THE ROAD CENTRELINE AS SEEN ON GENERAL ARRANGEMENT DRAWING.

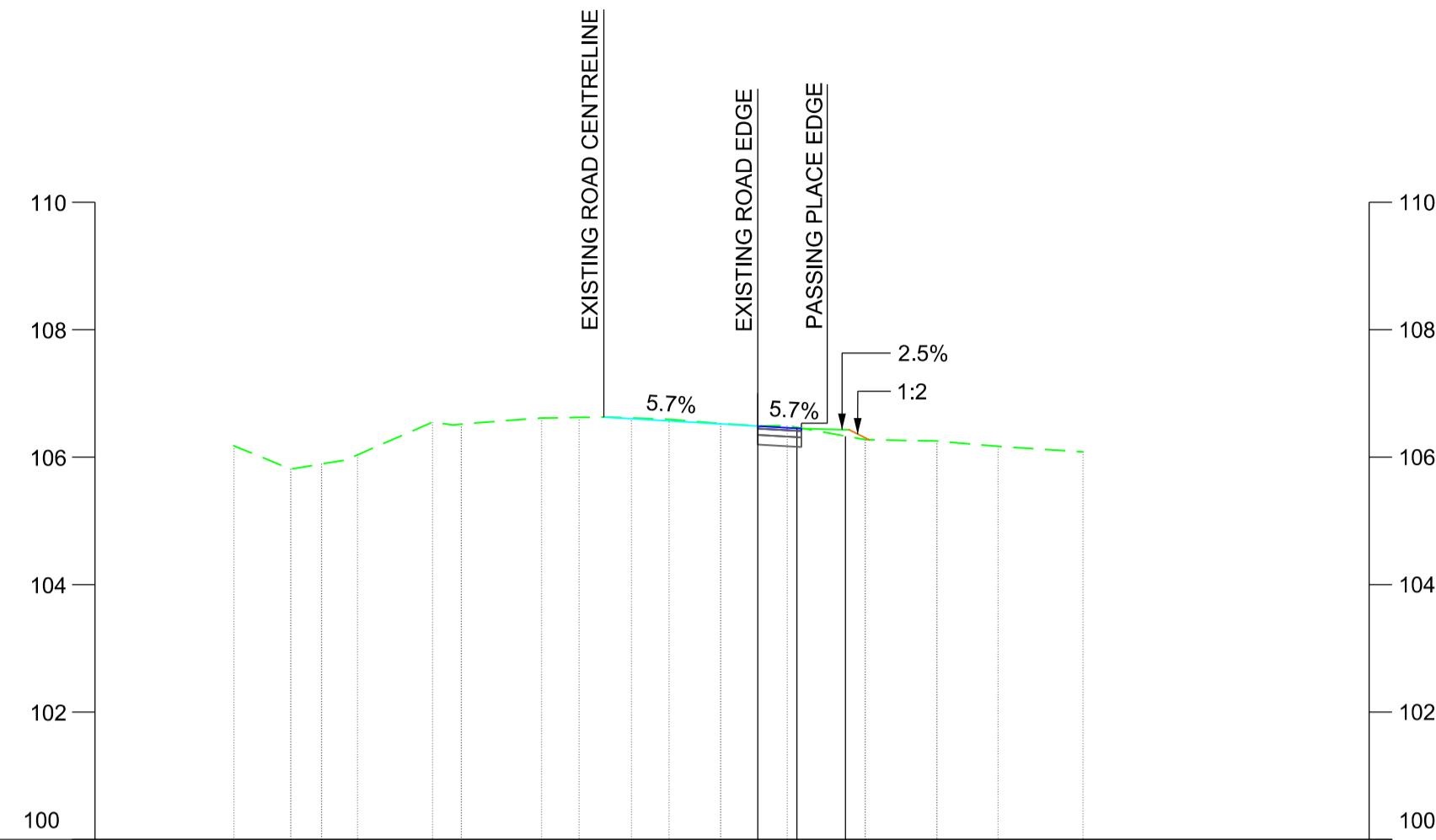

DESIGN LEVELS	
EXISTING LEVELS	106.177, 105.812, 105.893, 106.036, 106.547, 106.517, 106.614, 106.624, 106.615, 106.594, 106.527, 106.488, 106.485, 106.453, 106.431, 106.273, 106.252, 106.169, 106.081
DESIGN OFFSET	2.406, 3.019, 3.782

CHAINAGE - 19.0000

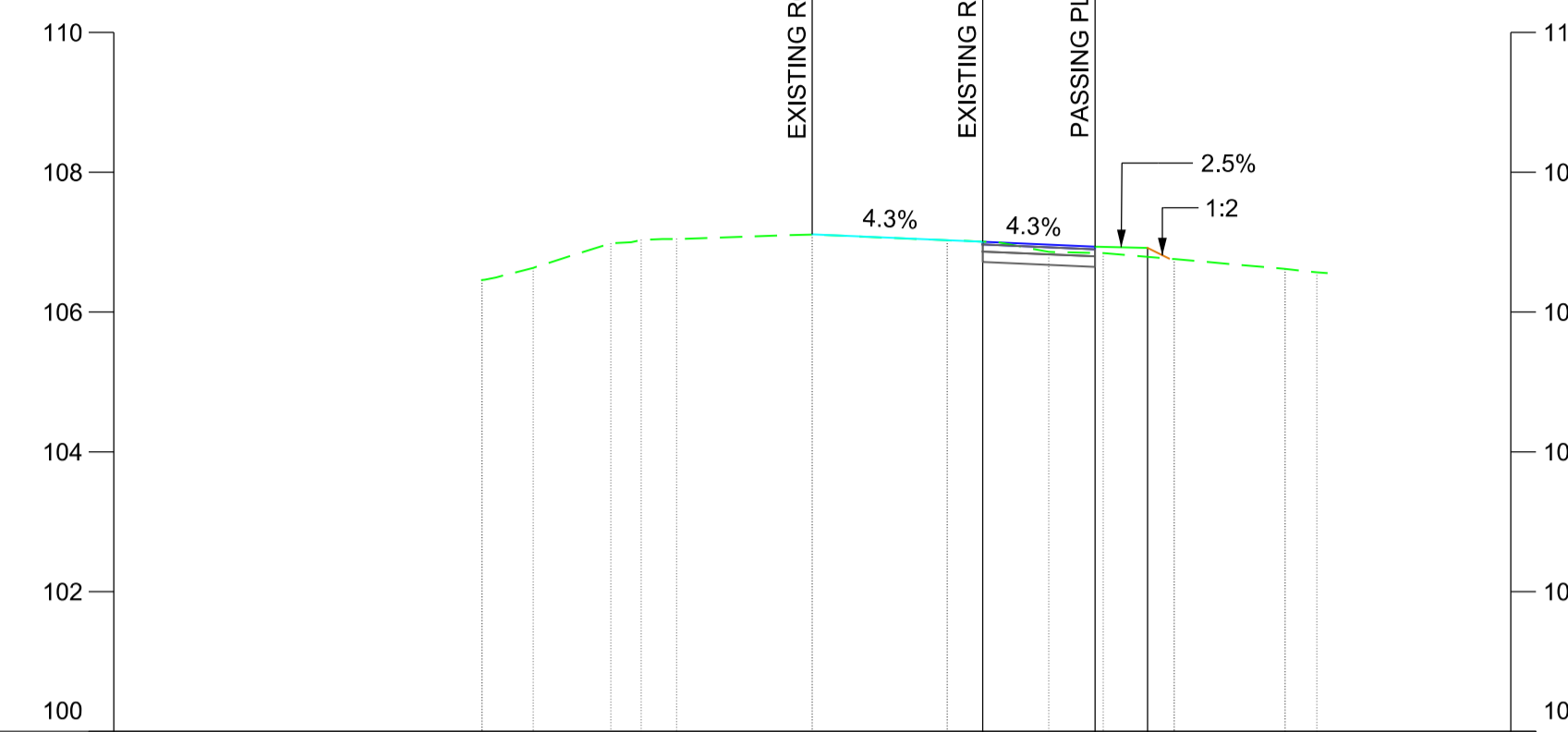

DESIGN LEVELS	
EXISTING LEVELS	106.457, 106.632, 106.684, 107.030, 107.045, 107.109, 107.025, 107.005, 106.860, 106.844, 106.757, 106.616, 106.587
DESIGN OFFSET	2.439, 4.049, 4.799

CHAINAGE - 40.0000

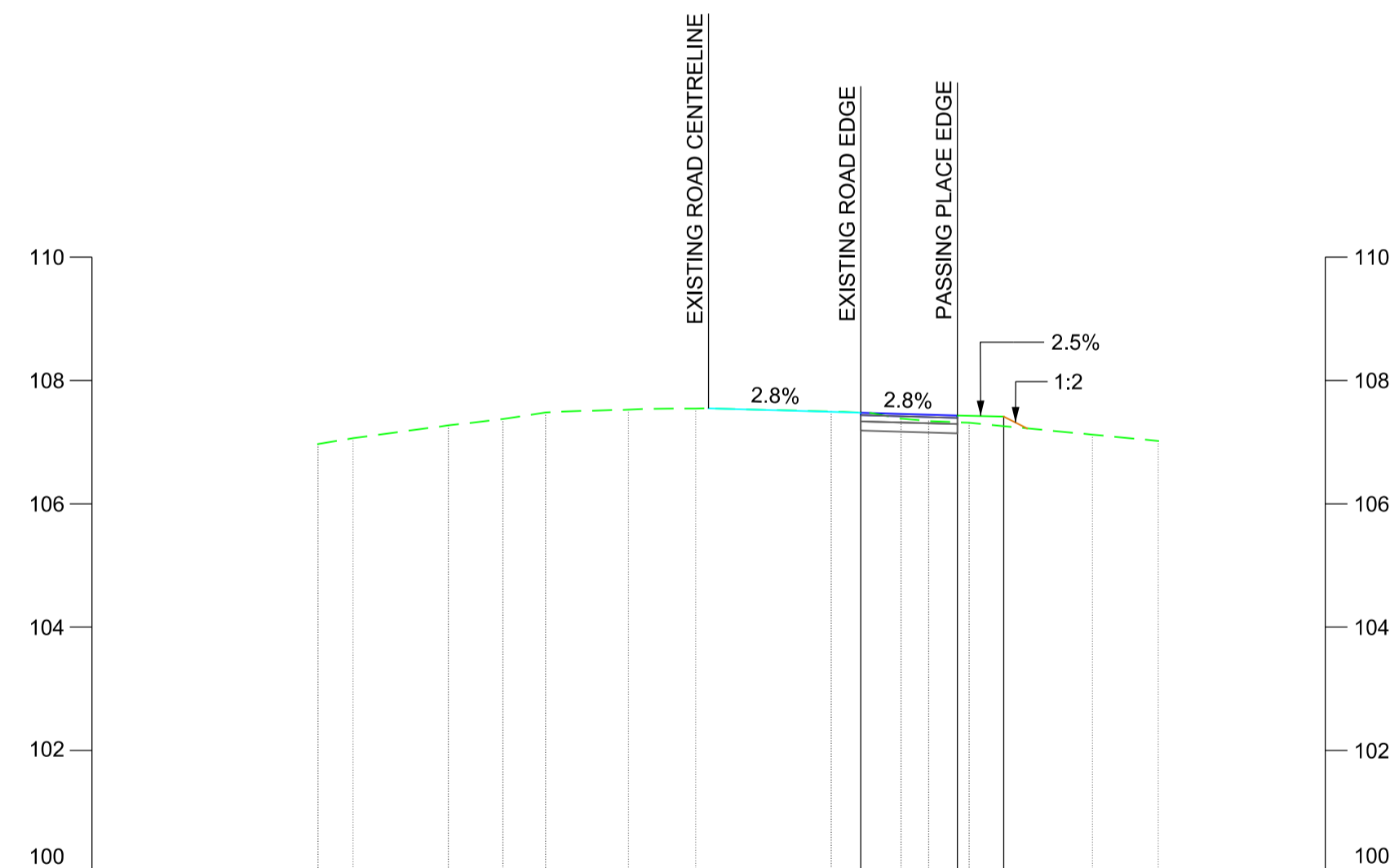

DESIGN LEVELS	
EXISTING LEVELS	106.967, 107.064, 107.271, 107.373, 107.479, 107.526, 107.545, 107.496, 107.476, 107.381, 107.341, 107.313, 107.431, 107.413, 107.121, 107.018
DESIGN OFFSET	2.467, 4.035, 4.785

CHAINAGE - 60.0000

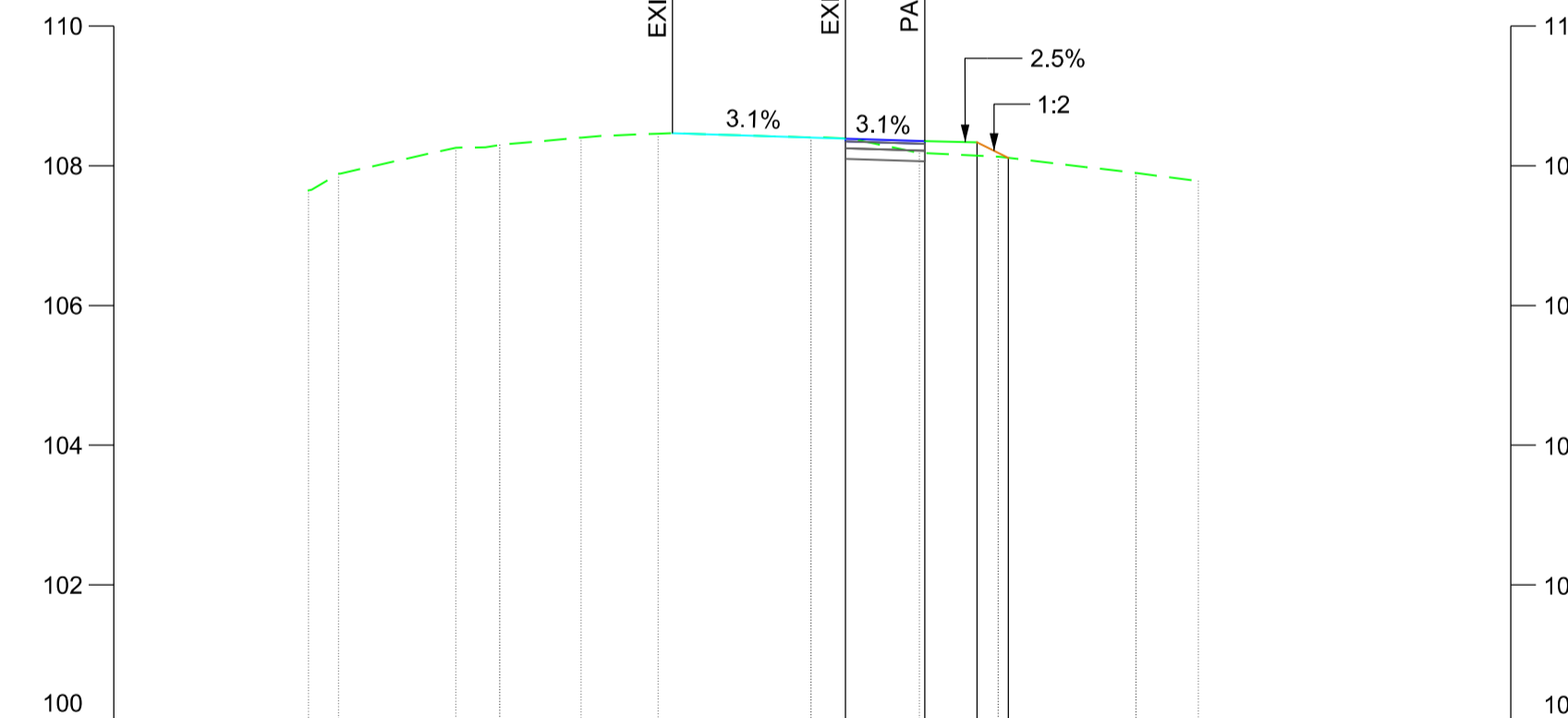

DESIGN LEVELS	
EXISTING LEVELS	107.646, 107.893, 108.257, 108.298, 108.402, 108.458, 108.404, 108.388, 108.183, 108.334, 108.128, 107.896, 107.781
DESIGN OFFSET	2.476, 3.610, 4.360, 4.806

CHAINAGE - 100.0000

**KEY:**

- EXISTING GROUND
- EXISTING CARRIAGEWAY
- PROPOSED CARRIAGEWAY
- PROPOSED ROAD PAVEMENT
- PROPOSED GRASS VERGE
- PROPOSED EARTHWORKS



B01	23/09/19	FOR INFORMATION	N.T.	L.T.	S.A.
Rev	Date	Description of Revisions	Dsnd	Chkd	Appr
Status	SHARED - for Information				S2



Project  
**East West Rail  
(Western Section)  
Phase 2**

Drawing Title  
**PASSING PLACE A2\_P\_8  
CROSS-SECTIONS**

Designed	Nagoth Thomas Ravi Kumar	Signed	N. T. R. Kumar	Date	06/09/19
Drawn	Ravikumar KN	Signed	R. KN	Date	22/01/19
Checked	Lisa Taylor	Signed	L. Taylor	Date	12/09/19
Approved	Stephen Abe	Signed	S. Abe	Date	12/09/19

Scale(s)	ELR - Project Chainage (Miles Yards)	Sheet	1 of 1
AS SHOWN	OXD -	Design Package Risk Classification	Normal
Alternative Reference		Revision	B01
Drawing Number	133735_2A-EWR-OXD-A2_P_8-DR-CH-030001		