

Revision & Version
B01.03
Drawing Number
133735_RW-EWR-XX-A1-DR-DH-001101

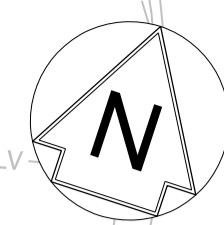

PRECAST CONCRETE HEADWALL & FLAP VALVE REFER TO COMPOUND MANHOLE SCHEDULE

FINISHED LEVELS AROUND THE PROPOSED HEADWALL TO BE NEATLY GRADED AND TRIMMED TO IE-IN EXISTING LEVELS
EXCEEDANCE FLOWS FROM THE ATTENUATION BASIN (FOR EVENTS IN EXCESS OF THE 1 IN 100 YEAR + 5% CLIMATE CHANGE) SHALL FOLLOW THE SITE TOPOGRAPHY, ADJACENT TO THE EXISTING HIGHWAYS DITCH. EXCEEDANCE FLOWS WILL DISCHARGE INTO THE HIGHWAY DRAINAGE DITCH AND ULTIMATELY DRAIN INTO LANGFORD BROOK.

ATTENUATION BASIN REFER TO STANDARD DETAIL 133735_RW-EWR-XX-DR-DH-050000 FOR FLOW SHUT OFF DETAILS
PROPOSED ATTENUATION BASIN TO BE CONSTRUCTED WITH A DEPTH OF 1.5m BELOW GROUND LEVEL, WITH A BASE AREA OF 29.15m² TO PROVIDE A TOTAL STORAGE VOLUME OF 167.5m³ FOR ALL EVENTS UP TO AND INCLUDING THE 1 IN 100 YEAR (+5%cc). HAYBALES TO BE PROVIDED REFER TO DRAWING 133735_RW-EWR-XX-DR-DH-050003 AND SCHEDULE FOR SETTING OUT.
INDICATIVE POSITION OF CONTROL PANEL

PROPOSED LOCATION OF PUMPING CHAMBER. SELECT TO PROVIDE A PACKAGED PUMPING STATION COMPRISING OF PUMPS IN A DUTY STANDBY ARRANGEMENT WHICH ARE ACTIVATED BY FLOAT SWITCHES. PUMPS SHALL BE CONNECTED TO A CONTROL PANEL ADJACENT TO THE PUMPING CHAMBER AND SHALL BE FITTED WITH A BEACON WARNING SYSTEM SHOULD FAILURE OF THE PUMPS OCCUR. THE CONTROL PANEL SHALL HAVE A PERMANENT POWER SUPPLY FROM THE COMPOUND SUBSTATION AND PROVISION FOR AUXILIARY GENERATOR INPUT IS REQUIRED IN THE EVENT FAILURE OF THE MAIN SITE POWER SUPPLY.
PUMPS SHALL BE LIMITED TO A MAXIMUM FLOW RATE OF 1.5l/s
INDICATIVE ALIGNMENT OF PUMPING MAINS 2No. OF 63mm DIAMETER (DESIGN BY SELECT SEE NOTE 8)
POND IL 69.431
POND COVER LEVEL 70.931

STILLING CHAMBER. SELECT TO INSTALL PUMPING MAINS INTO CHAMBER

PROPOSED FOUL WATER TANK TO BE SPECIFIED AND SUPPLIED BY SELECT. TANK TO BE PERIODICALLY EMPTIED BY TANKER IN ACCORDANCE WITH COMPOUND MANAGEMENT PLAN.

FINAL LOCATION OF SUBSTATION AND ASSOCIATED CABLING TO BE COORDINATED WITH PROPOSED DRAINAGE DESIGN

EXISTING HIGHWAY DRAINAGE CULVERT NOT TO BE MODIFIED BY THE PROJECT

FOR DETAILS OF PIPE FITTINGS REFER TO DRAWING 133735_RW-EWR-XX-DR-DH-050002 AND SCHEDULE

PROPOSED SITE OFFICES & WELFARE FACILITIES

REFER TO DITCH AND PIPE CONNECTION DETAIL ON DRAWING 133735_RW-EWR-XX-DR-DH-050002

MATCHLINE - FOR CONTINUATION SEE DRAWING 133735_RW-EWR-XX-A1-DR-DH-001102

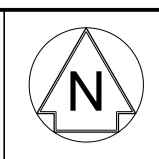

LOCATION PLAN

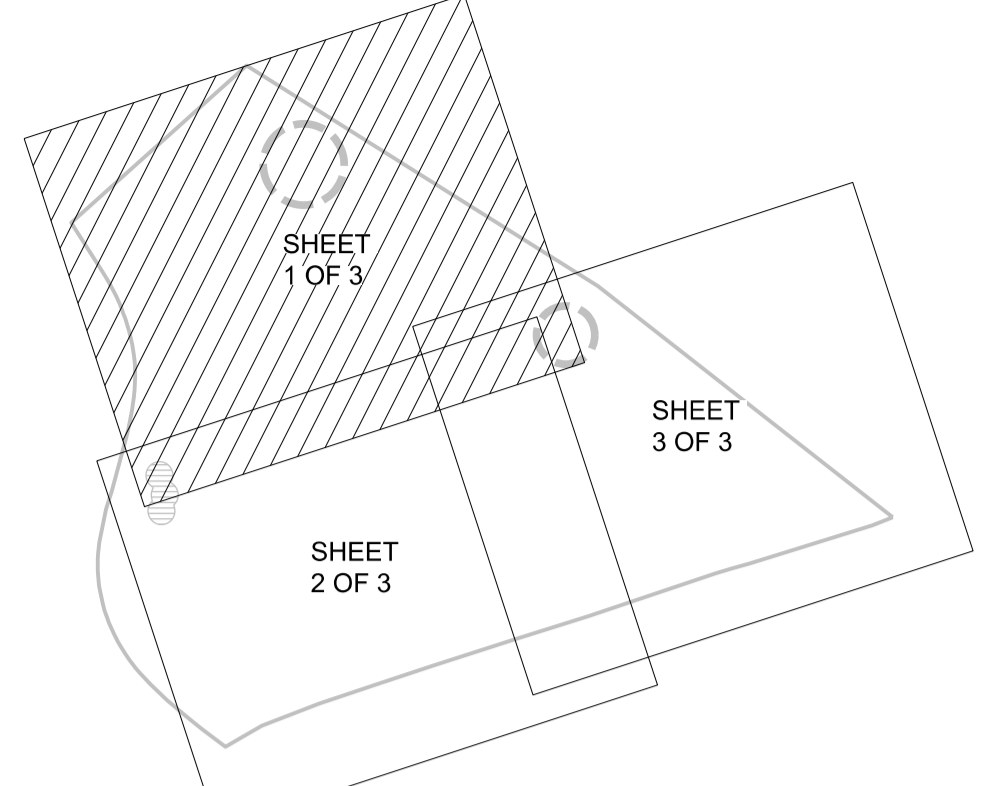

- NOTES
- THIS DRAWING IS NOT TO BE SCALED. ALL DIMENSIONS ARE IN METRES UNLESS OTHERWISE STATED. ALL LEVELS ARE IN mAOD. ALL COORDINATES ARE BASED ON EWR2 SNAKEGRID.
 - THIS DRAWING SHOULD BE READ IN CONJUNCTION WITH MANHOLE SCHEDULE 133735_RW-EWR-XX-A1-SH-DH-001100 AND STANDARD DETAIL DRAWINGS 133735_RW-EWR-XX-XX-M3-G-050000 SERIES DRAWINGS.
 - DRAINAGE SHALL BE CONSTRUCTED IN ACCORDANCE WITH SPECIFICATION 133735_RW-EWR-XX-XX-SP-DR-000001.
 - EXISTING LEVELS ARE BASED ON TOPOGRAPHICAL SURVEY DATA UNLESS STATED OTHERWISE (ADD MODEL REFERENCE NO FOR TOPO SURVEY) 133735_RW-EWR-XX-XX-M3-G-000049.
 - FOR HAZARDS REFER TO EWR2 PHASE 2 HAZARD LOG 133735-EWR-LOG-SSD-000004.
 - BURIED SERVICES DATA IS PROVIDED FOR INFORMATION ONLY AND IS BASED UPON AVAILABLE RECORDS WHICH MAY BE INCOMPLETE. FOR BURIED SERVICES RECORDS REFER TO DOCUMENT 133735_RW-EWR-EWL-XXXXXXXX-M2-U-010001_B01-03_S1. THE CONTRACTOR MUST NOT RELY ON THE ACCURACY OF THIS INFORMATION AND SHALL IDENTIFY THE LINE, LEVEL AND TYPE OF ALL SERVICES AND UNDERTAKE AN APPROPRIATELY DETAILED RISK ASSESSMENT BEFORE UNDERTAKING ANY WORKS THAT MAY CAUSE DAMAGE TO PROPERTY OR RISK TO HEALTH AND SAFETY.
 - SILT FENCES WILL BE CONSTRUCTED TO INTERCEPT SEDIMENT SUSPENDED IN RUNOFF. REFER TO STANDARD DETAIL 133735_RW-EWR-XX-AL-DR-DH-050001.
 - REFER TO SCHEDULE 133735_RW-EWR-XX-A1-SH-DH-001100 FOR PUMPING STATION TECHNICAL REQUIREMENTS.

KEY:

- TEMPORARY BOUNDARY
- EXISTING WATERCOURSE
- EXISTING LOW VOLTAGE ELECTRICITY CABLE (UNDERGROUND)
- EXISTING MEDIUM PRESSURE GAS MAIN
- EXISTING HIGH PRESSURE GAS MAIN
- EXISTING HIGH VOLTAGE ELECTRICITY CABLE (UNDERGROUND)
- PROPOSED CARRIER DRAIN
- PROPOSED FILTER DRAIN
- PROPOSED HEADWALL
- PROPOSED DITCH (1 IN 1 SLOPE)
- SETTING OUT POINT
- CATCHPIT / MANHOLE
- PROPOSED SILT FENCE (NOTE 7)
- PROPOSED HAYBALES INSIDE THE ATTENUATION BASIN
- PROPOSED PUMPING MAIN (NOTE 8)
- HAZARD

Rev	Date	Description of Revisions	Desd	Chkd	Appr	Status
B01	14/02/20	For Information				MA P.L. A.R.
SHARED - for Information						S2



Project
East West Rail (Western Section) Phase 2

Drawing Title
**CIVIL ENGINEERING DRAINAGE
TEMPORARY DRAINAGE
COMPOUND A1 DRAINAGE
GENERAL ARRANGEMENT**

Designed	Muhammad Amin Ibrahim	Signed	M. A. Ibrahim	Date	14/02/20
Drawn	Rama Sastry	Signed	R. Sastry	Date	07/11/19
Checked	Paul Lawrence	Signed	P. Lawrence	Date	14/02/20
Approved	Adrian Rose	Signed	A. Rose	Date	14/02/20

Scale(s)	1:250	ELR - Project Chainage (Miles Yards)	XX - A1	Sheet	1 of 3
Design Package Risk Classification	Normal	Revision	B01		
Alternative Reference		Drawing Number	133735_RW-EWR-XX-A1-DR-DH-001101		

Safety, Health and Environmental Information
The works are to be undertaken by a competent contractor, and therefore only exceptional risks relating to the works associated with this drawing are identified below. For further details and proposed safety measures refer "EWR CDM PHASE 2 HAZARD LOG" eB doc. Ref: 133735-EWR-LOG-SSD-000004.

ID	Hazard description
EWR2-HAZ-3556	BURIED SERVICES

OS map data reproduced by permission of Ordnance Survey on behalf of HMSO. © Crown copyright 2015. All rights reserved. Ordnance Survey licence number 0100040692

