

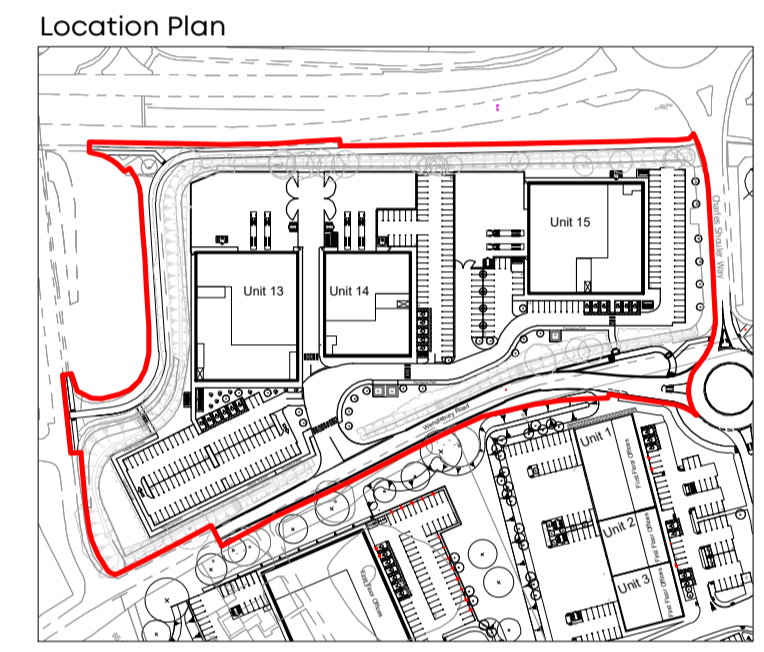

- Application Boundary
- Retained Trees and Vegetation
- Removed Vegetation
- Root Protection Areas
- Proposed Tree
- Proposed Specimen shrub
- Proposed Native Shrub Planting
- Proposed Native Hedgerow
- Proposed Ornamental Hedgerow
- Proposed Amenity Grassland
- Proposed Wildflower Grassland Seed Mix
- Open Areas - Emorsgate EM2
- Under Canopies - Emorsgate EH1
- Ditches - Emorsgate EM8
- Proposed Amenity Planting
- Public Right of Way - Amenity Grass
- Archeological Protection Area Boundary
- Mounds with Gradient at 1:3 and Height not Exceeding 0.6m Above Adjacent Ground Level. Horizontal Root Barriers to be included at Base for Archeological Area Protection

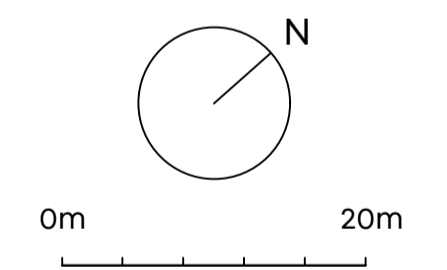

| Rev | Comment | Date |
|-----|-----------------------------|----------|
| c | Grassland Update | 13.05.24 |
| b | Layout Update - Final Issue | 09.05.24 |
| a | Layout Update - Draft Issue | 19.03.24 |
| Rev | | Date |



LAIRD BAILEY LANDSCAPE ARCHITECTS
 t: 0330 043 4883
 e: hello@lba.co.uk
 Costwolds | Somerset | South Wales

Client:
Albion Land

Project Title:
Catalyst Phase 4

Drawing Title:
Detailed Soft Landscape Proposal (Sheet 1 of 6)

Date: 8 March 2024
 Drawing Number: LB467_D01
 Scale: 1:500 at A1
 Status: Final

Drawn By: MS
 Checked by: AL
 Revision: C
 Use: Planning

- Notes**
- Do not scale from this plan
 - All information outside red line boundary shown for contextual purpose only.
 - All hatch patterns are indicative only unless stated otherwise.
 - Any discrepancies in the design information are to be brought to the attention of Laird Bailey Landscape Architects, in writing.
 - Refer to other consultants' drawings and specifications for the following design information:
 - Levels & Drainage design and infrastructure
 - Lighting and ducting
 - Existing & proposed utilities
 - Plant quantities are to suit site areas in accordance with scheduled plant densities.
 - Any proposed plant substitution shall be agreed with the landscape architect prior to ordering.
 - Drawings are for planning purposes only.
 - For further details, consult relevant planting schedules

Unit 13

Unit 14

- Application Boundary
- Retained Trees and Vegetation
- Removed Vegetation
- Root Protection Areas
- Proposed Tree
- Proposed Specimen Shrub
- Proposed Native Shrub Planting
- Proposed Native Hedgerow
- Proposed Ornamental Hedgerow
- Proposed Amenity Grassland
- Proposed Wildflower Grassland Seed Mix
Open Areas - Emorsgate EM2
Under Canopies - Emorsgate EH1
Ditches - Emorsgate EM8
- Proposed Amenity Planting
- Native Bulb Planting - Under Tree Canopies
- Native Bulb Planting - Open Areas
- Public Right of Way - Amenity Grass
- Archeological Protection Area Boundary

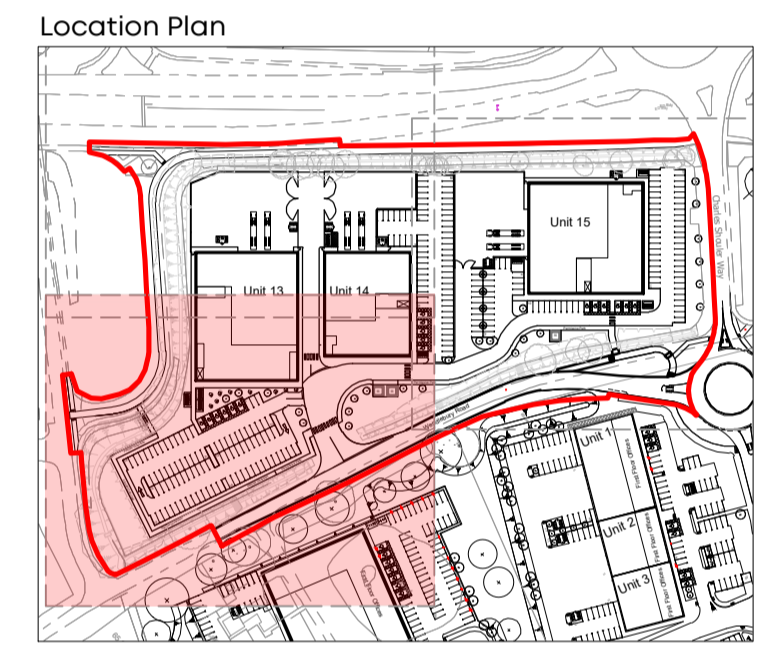

| Rev | Comment | Date |
|-----|-----------------------------|----------|
| c | Grassland Update | 13.05.24 |
| b | Layout Update - Final Issue | 09.05.24 |
| a | Layout Update - Draft Issue | 19.03.24 |

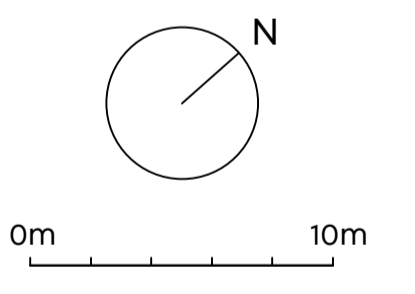

LAIRD BAILEY LANDSCAPE ARCHITECTS
 t: 0330 043 4883
 e: hello@lba.co.uk
 Costwolds | Somerset | South Wales

Client:
Albion Land

Project Title:
Catalyst Phase 4

Drawing Title:
Detailed Soft Landscape Proposal (Sheet 2 of 6)

Date: 8 March 2024
 Drawing Number: LB467_D01
 Scale: 1:250 at A1
 Status: Final

Drawn By: MS
 Checked By: AL
 Revision: C
 Use: Planning

- Notes**
1. Do not scale from this plan
 2. All information outside red line boundary shown for contextual purpose only.
 3. All hatch patterns are indicative only unless stated otherwise.
 4. Any discrepancies in the design information are to be brought to the attention of Laird Bailey Landscape Architects, in writing.
 5. Refer to other consultants' drawings and specifications for the following design information:
 - Levels & Drainage design and infrastructure
 - Lighting and ducting
 - Existing & proposed utilities
 6. Plant quantities are to suit site areas in accordance with scheduled plant densities.
 7. Any proposed plant substitution shall be agreed with the landscape architect prior to ordering.
 8. Drawings are for planning purposes only.
 9. For further details, consult relevant planting schedules

- Notes**
1. Do not scale from this plan
 2. All information outside red line boundary shown for contextual purpose only.
 3. All hatch patterns are indicative only unless stated otherwise.
 4. Any discrepancies in the design information are to be brought to the attention of Laird Bailey Landscape Architects, in writing.
 5. Refer to other consultants' drawings and specifications for the following design information:
 - Levels & Drainage design and infrastructure
 - Lighting and ducting
 - Existing & proposed utilities
 6. Plant quantities are to suit site areas in accordance with scheduled plant densities.
 5. Any proposed plant substitution shall be agreed with the landscape architect prior to ordering.
 6. Drawings are for planning purposes only.
 7. For further details, consult relevant planting schedules

- Application Boundary
- Retained Trees and Vegetation
- Removed Vegetation
- Root Protection Areas
- Proposed Tree
- Proposed Specimen Shrub
- Proposed Native Shrub Planting
- Proposed Native Hedgerow
- Proposed Ornamental Hedgerow
- Proposed Amenity Grassland
- Proposed Wildflower Grassland Seed Mix
 - Open Areas - Emorsgate EM2
 - Under Canopies - Emorsgate EH1
 - Ditches - Emorsgate EM8
- Proposed Amenity Planting
- Native Bulb Planting - Under Tree Canopies
- Native Bulb Planting - Open Areas
- Public Right of Way - Amenity Grass
- Archeological Protection Area Boundary

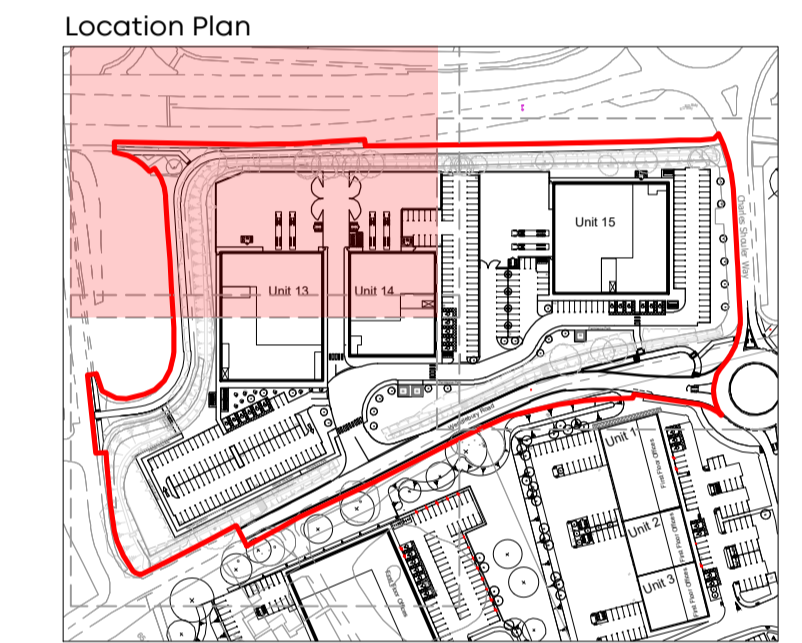

| Rev | Comment | Date |
|-----|-----------------------------|----------|
| c | Grassland Update | 13.05.24 |
| b | Layout Update - Final Issue | 09.05.24 |
| a | Layout Update - Draft Issue | 19.03.24 |

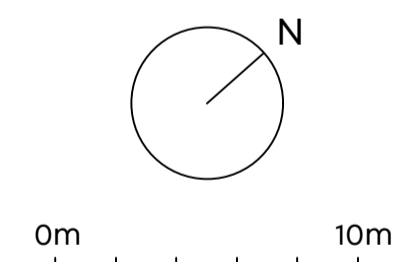

LAIRD BAILEY LANDSCAPE ARCHITECTS
 t: 0330 043 4885
 e: hello@lba.co.uk
 Costwolds | Somerset | South Wales

Client:
Albion Land

Project Title:
Catalyst Phase 4

Drawing Title:
Detailed Soft Landscape Proposal (Sheet 3 of 6)

Date: 8 March 2024
 Drawing Number: LB467_D01
 Scale: 1:250 at A1
 Status: Final

Drawn By: MS
 Checked By: AL
 Revision: C
 Use: Planning

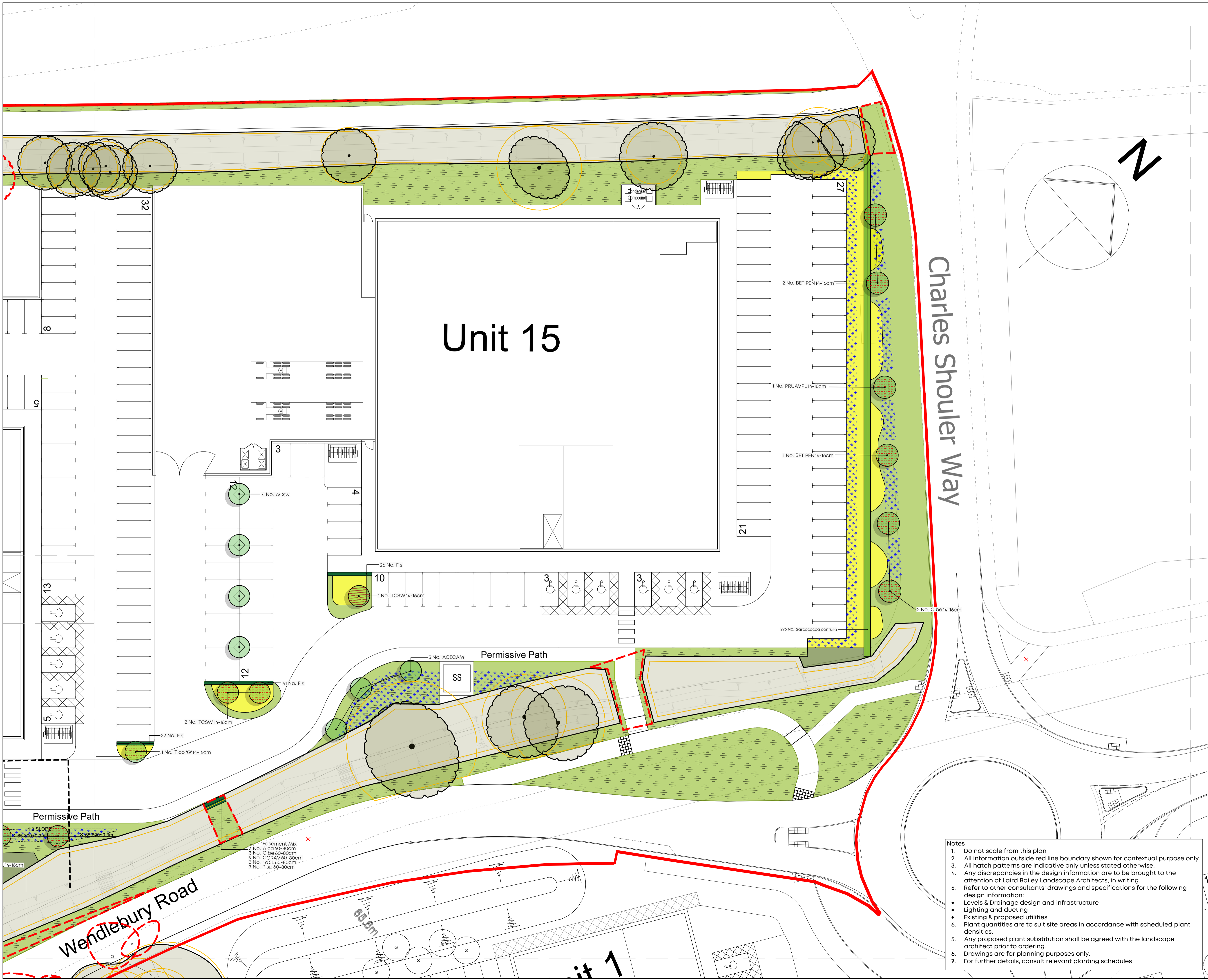

- Application Boundary
- Retained Trees and Vegetation
- Removed Vegetation
- Root Protection Areas
- Proposed Tree
- Proposed Specimen Shrub
- Proposed Native Shrub Planting
- Proposed Native Hedgerow
- Proposed Ornamental Hedgerow
- Proposed Amenity Grassland
- Proposed Wildflower Grassland Seed Mix
- Open Areas - Emorsgate EM2
- Under Canopies - Emorsgate EM1
- Ditches - Emorsgate EM8
- Proposed Amenity Planting
- Native Bulb Planting - Under Tree Canopies
- Native Bulb Planting - Open Areas
- Public Right of Way - Amenity Grass
- Archaeological Protection Area Boundary

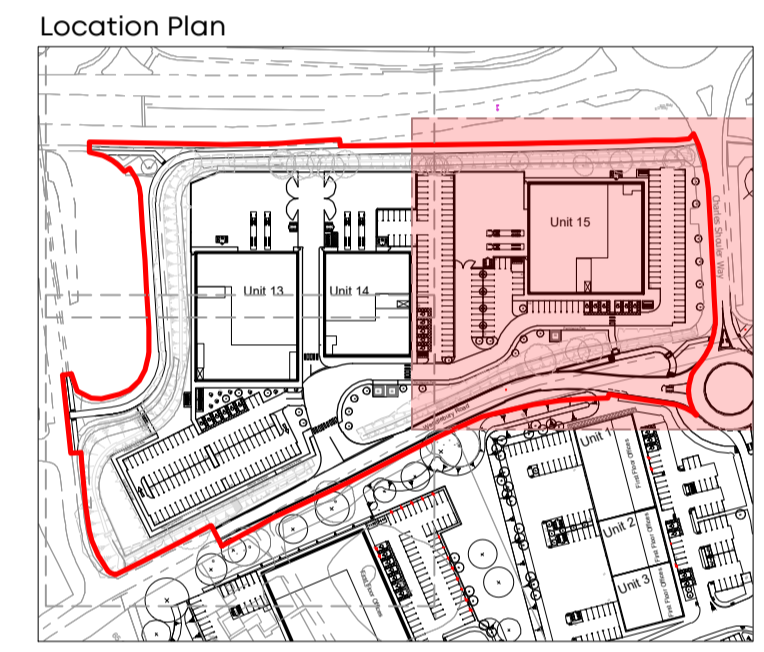
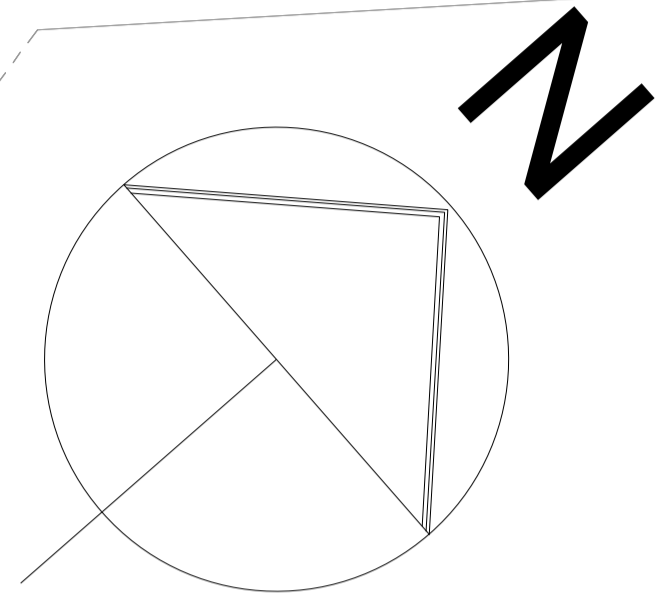

| Rev | Comment | Date |
|-----|-----------------------------|----------|
| c | Grassland Update | 13.05.24 |
| b | Layout Update - Final Issue | 09.05.24 |
| a | Layout Update - Draft Issue | 19.03.24 |

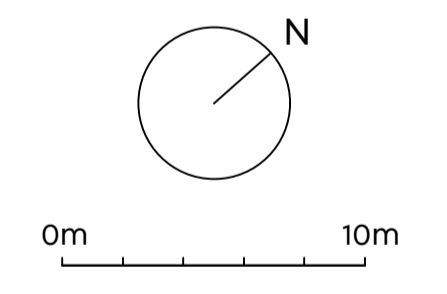

LAIRD BAILEY LANDSCAPE ARCHITECTS
 t: 0330 043 4885
 e: hello@lba.co.uk
 Costwolds | Somerset | South Wales

Client:
Albion Land

Project Title:
Catalyst Phase 4

Drawing Title:
Detailed Soft Landscape Proposal (Sheet 4 of 6)

Date: 8 March 2024
 Drawing Number: LB467_D01
 Scale: 1:250 at A1
 Status: Final

Drawn By: MS
 Checked by: AL
 Revision: C
 Use: Planning

Charles Shouler Way

Unit 15

- Notes**
- Do not scale from this plan
 - All information outside red line boundary shown for contextual purpose only.
 - All hatch patterns are indicative only unless stated otherwise.
 - Any discrepancies in the design information are to be brought to the attention of Laird Bailey Landscape Architects, in writing.
 - Refer to other consultants' drawings and specifications for the following design information:
 - Levels & Drainage design and infrastructure
 - Lighting and ducting
 - Existing & proposed utilities
 - Plant quantities are to suit site areas in accordance with scheduled plant densities.
 - Any proposed plant substitution shall be agreed with the landscape architect prior to ordering.
 - Drawings are for planning purposes only.
 - For further details, consult relevant planting schedules

- Easement Mix**
- 3 No. A ca60-80cm
 - 3 No. C be60-80cm
 - 9 No. COIRAV 60-80cm
 - 3 No. I aSL 60-80cm
 - 7 No. P sp60-80cm

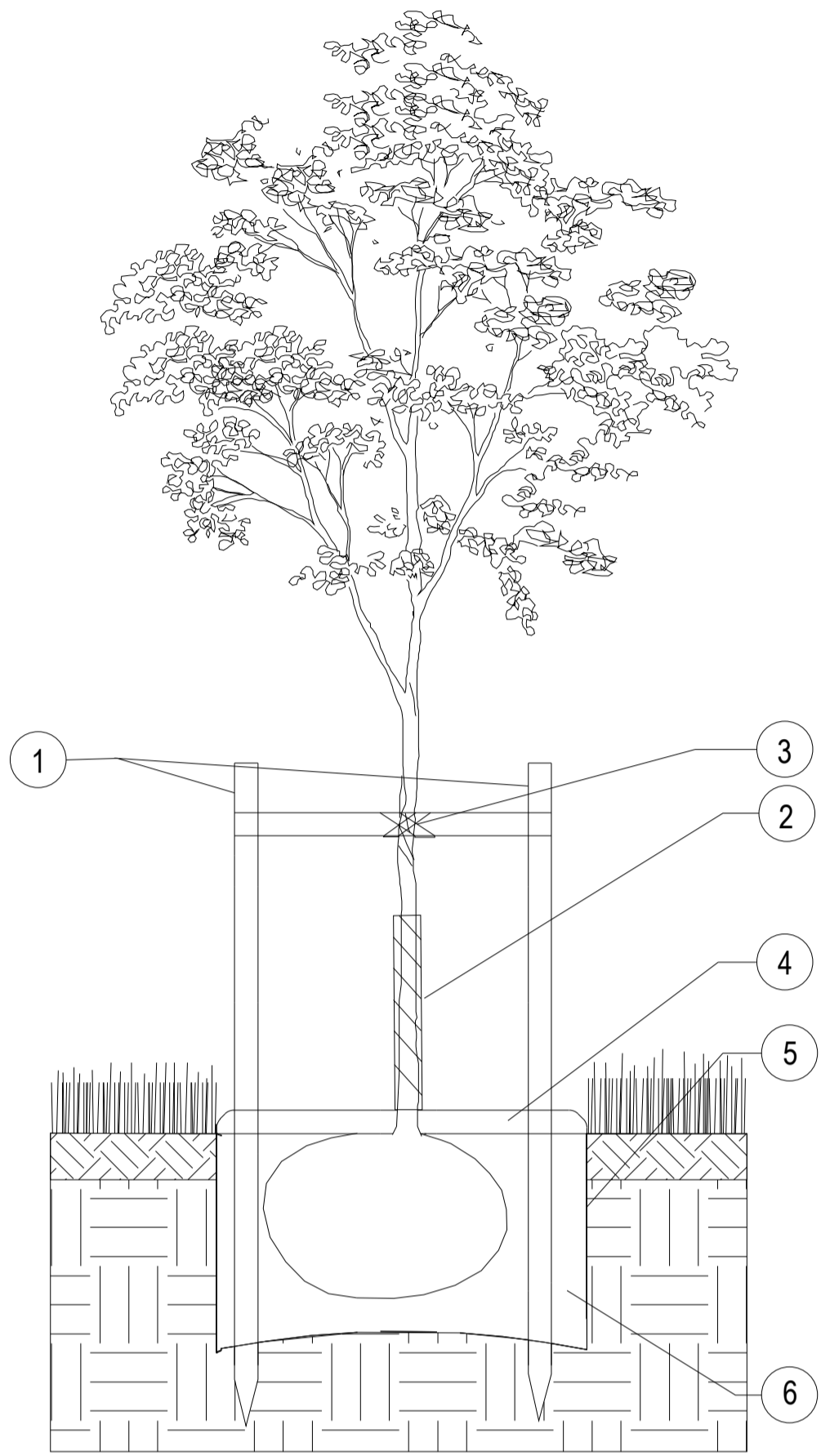

Tree Pit Detail 2 - Trees in Open Space (Scale: 1:20)

1. 2x tanalised timber tree stakes 2m, 75mm ϕ and crossbar driven into backfilled pit to provide support to the tree.
2. Clear spiral guard to be fitted to trunk to protect against animal browsing.
3. Use 2x Tree Ties GLB25A with GLPFA spacer sleeves or similar to secure tree to support post.
4. 75mm deep bark mulch layer to be spread evenly over a circular area 1000mm ϕ around the tree to prevent weed growth and retain moisture. Alternatively, a suitable mulch mat can be used covering the same area.
5. Excavate tree pit to sufficient size to accommodate tree root ball. Loosen any compaction in base of excavated pit to aid drainage. The tree should be planted at a depth where the root flare is still visible, just breaching the soil surface, following backfilling.
6. Backfill tree pit with subsoil and topsoil excavated from pit if this is regarded as of sufficient quality to promote the healthy establishment of the tree. If either the top soil or sub soil excavated from the pit is of poor quality, then soil ameliorants may be used sparingly or imported topsoil compliant with BS3882 should be used.

Immediately after planting, water the tree, saturating the tree pit to field capacity. Allow for a strimmer guard for all trees in open space.

The notes above are intended as a basic guide only. For further guidance on tree planting refer to BS 8545:2014 Section 10.

Products underlined above are available from Green Blue Urban (<http://greenblueurban.com/>).

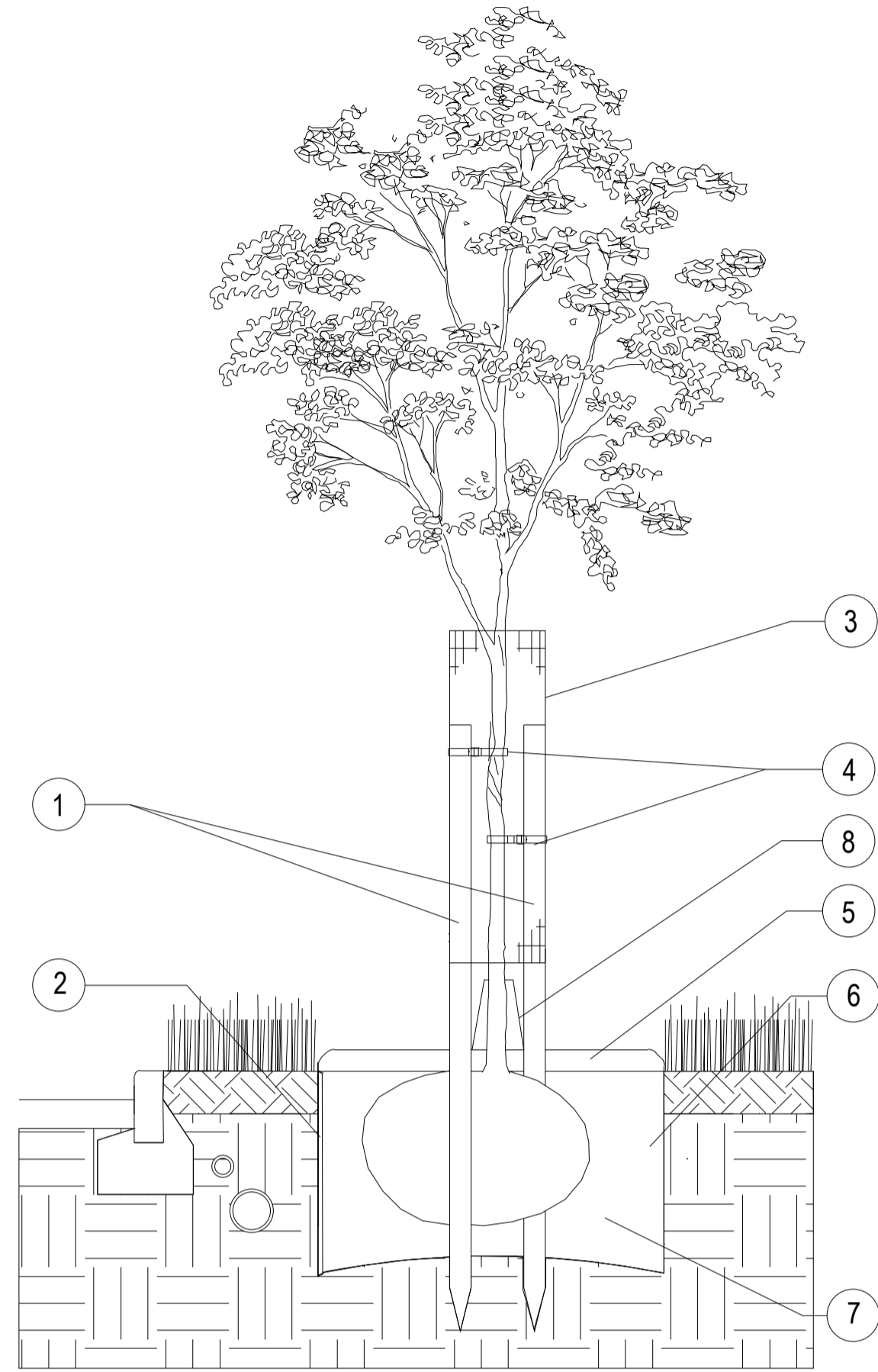

Tree Pit Detail 3 - for Trees in Proximity to Hard Landscaping and/or Services (Scale: 1:20)

1. 2x tanalised timber tree stakes 2m, 75mm ϕ driven into backfilled pit to provide support to the tree.
2. ReRoot root barrier with root deflecting ribs installed between tree root ball and hard surfaces/services where there is a risk of root damage as the tree grows outward. As a general rule, root barriers should be installed in locations where hard surfaces and/or services are located within three metres of the tree stem. Install closer to the paving/service than the tree, to allow space for the tree roots to grow into the space available, with the ribs facing the tree. Note this may mean not placing the barrier within the tree pit, but further away within its own trench. Root barriers must extend a minimum of 2m lengthways beyond the expected canopy of the mature tree. The top of the root barrier should be set as close to the soil surface as possible without being visible.
3. Tubex Treeguard Mesh Roll or similar approved. 12mm mesh roll cut to size and bent in circle 320mm ϕ and tied to tree stake to protect tree from damage by people and animals. Bottom of mesh should be 300mm above ground level to allow strimmer guard to be fitted and prevent litter and grass/weeds building up around the base of the tree. Top of mesh should be below the first lateral branch.
4. Use 2x Tree Ties GLB25A with GLPFA spacer sleeves or similar to secure tree to support post.
5. 75mm deep bark mulch layer to be spread evenly over a circular area 1000mm ϕ around the tree to prevent weed growth and retain moisture. Alternatively, a suitable mulch mat can be used covering the same area.
6. Excavate tree pit to sufficient size to accommodate tree root ball. Loosen any compaction in base of excavated pit to aid drainage. The tree should be planted at a depth where the root flare is still visible, just breaching the soil surface, following backfilling.
7. Backfill tree pit with subsoil and topsoil excavated from pit if this is regarded as of sufficient quality to promote the healthy establishment of the tree. If either the top soil or sub soil excavated from the pit is of poor quality, then soil ameliorants may be used sparingly or imported topsoil compliant with BS3882 should be used.
8. Strimmer guard by Arbotech or similar to be fitted around base of tree to protect from damage by grass maintenance machinery primarily, but also to provide an additional layer of defense against animal browsing.

Immediately after planting, water the tree, saturating the tree pit to field capacity.

The notes above are intended as a basic guide only. For further guidance on tree planting refer to BS8545:2014 Section 10.

Products suggested in italics above are available from Green Blue Urban (<http://greenblueurban.com/>) and Arbotech (www.arbotech.co.uk).

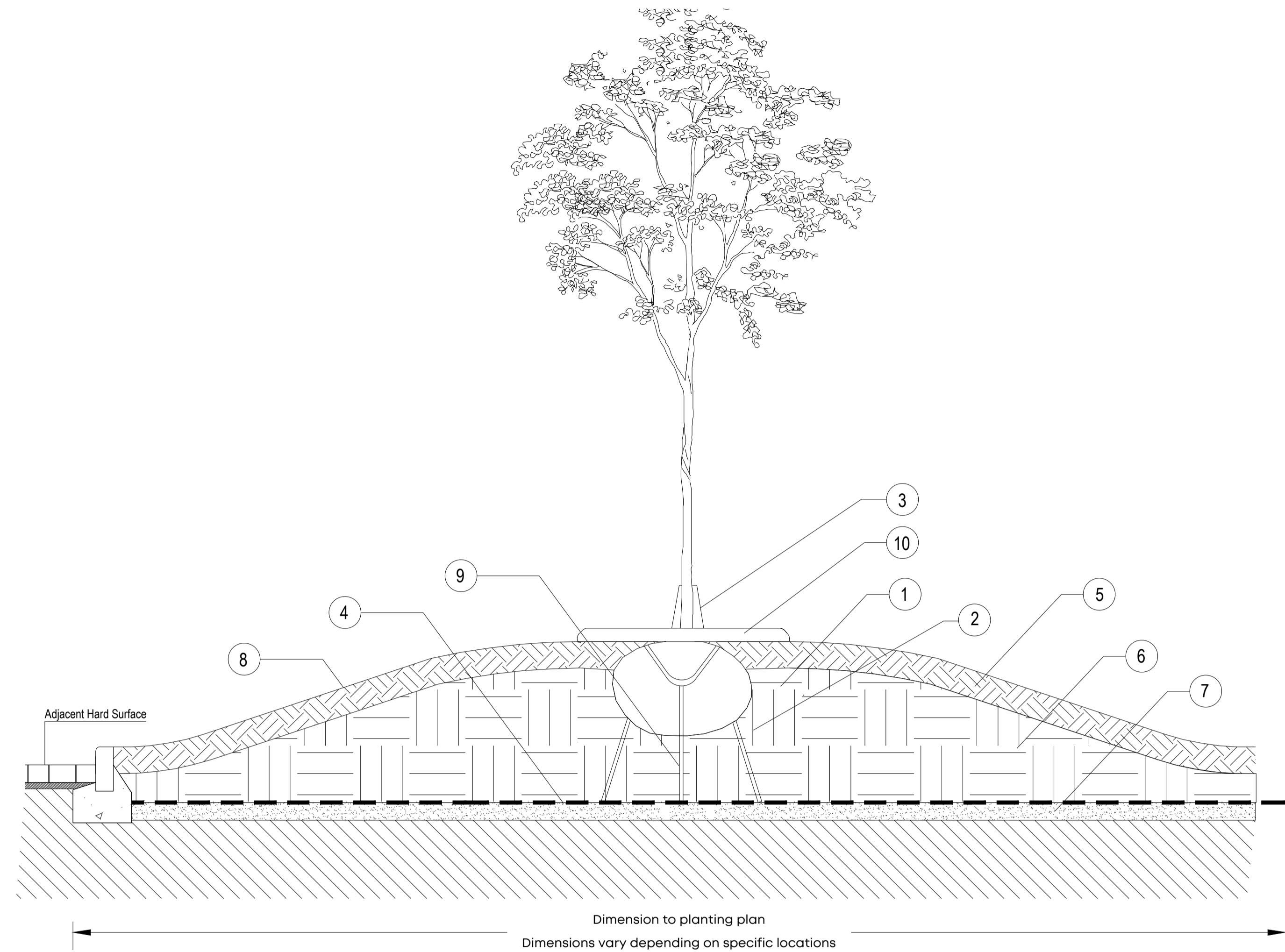

Tree pit detail 4 - Trees in Mounded Areas (Scale: 1:20)

1. Following construction of mounding. Excavate tree pit to sufficient size to accommodate tree root ball. Loosen any compaction in base of excavated pit to aid drainage. The tree should be planted at a depth where the root flare is still visible, just breaching the soil surface, following backfilling.
2. Backfill tree pit with subsoil (600mm) and topsoil (300mm) excavated from the mound. If either the top soil or sub soil excavated from the pit is of poor quality, then soil ameliorants may be used sparingly or imported topsoil compliant with BS3882 should be used.
3. Strimmer guard by Arbotech or similar to be fitted around base of tree to protect from damage by grass maintenance machinery primarily, but also to provide an additional layer of defense against animal browsing.
4. Proposed Horizontal Root Barrier (min depth of 900mm, exact depth to vary depending on location)
5. Approved BS3882:2015 topsoil to min 150mm for amenity grassed areas and min 900mm depth to tree planting areas.
6. Approved BS8601:2013 subsoil under proposed topsoil
7. 100mm Granular Drainage Layer, to engineering specification
8. Amenity grass areas set on 1:3 slope or less
9. Tree rootball secured using an underground guying system - Arborguy SAS-L strap anchor system c/w ground anchors (or similar approved)
10. 75mm deep bark mulch layer to be spread evenly over a circular area 1000mm around the tree to prevent weed growth and retain moisture.

Immediately after planting, water the tree, saturating the tree pit to field capacity.

The notes above are intended as a basic guide only. For further guidance on tree planting refer to BS8545:2014 Section 10.

Products suggested in italics above are available from Green Blue Urban (<http://greenblueurban.com/>) and Arbotech (www.arbotech.co.uk).

- Notes**
1. Do not scale from this plan
 2. All information outside red line boundary shown for contextual purpose only.
 3. All hatch patterns are indicative only unless stated otherwise.
 4. Any discrepancies in the design information are to be brought to the attention of Laird Bailey Landscape Architects, in writing.
 5. Refer to other consultants' drawings and specifications for the following design information:
 - Levels & Drainage design and infrastructure
 - Lighting and ducting
 - Existing & proposed utilities
 6. Plant quantities are to suit site areas in accordance with scheduled plant densities.
 7. Any proposed plant substitution shall be agreed with the landscape architect prior to ordering.
 8. Drawings are for planning purposes only.
 9. For further details, consult relevant planting schedules

| Rev | Comment | Date |
|-----|-----------------------------|----------|
| c | Grassland Update | 13.05.24 |
| b | Layout Update - Final Issue | 09.05.24 |
| a | Layout Update - Draft Issue | 19.03.24 |



LAIRD BAILEY LANDSCAPE ARCHITECTS
t: 0330 043 4883
e: hello@lba.co.uk
Costwolds | Somerset | South Wales

Client:

Albion Land

Project Title:

Catalyst Phase 4

Drawing Title:

Detailed Soft Landscape Proposal (Sheet 6 of 6)

Date: 8 March 2024
Drawing Number: LB467_D01
Scale: See Details
Status: Final

Drawn By: MS
Checked By: AL
Revision: C
Use: Planning