

HAUL ROAD CROSSING CONSTRUCTION ADJACENT TO MAINTENANCE WORKS

HAUL ROAD CROSSING-3

OS map data reproduced by permission of Ordnance Survey on behalf of HMSO. © Crown copyright 2015. All rights reserved. Ordnance Survey license number 0100040692

SCALE 1:250
@ A1 SHEET SIZE

HAUL ROAD CROSSING CONSTRUCTION ADJACENT TO MAINTENANCE WORKS

HAUL ROAD CROSSING CONSTRUCTION ADJACENT TO MAINTENANCE WORKS

IN CONTINUATION SEE FROM TOP RIGHT

OS map data reproduced by permission of Ordnance Survey on behalf of HMSO. © Crown copyright 2015. All rights reserved. Ordnance Survey license number 0100040692

SCALE 1:250
@ A1 SHEET SIZE

KEY:

	HIGHWAY BOUNDARY		GRASS VERGE
	EXISTING ROAD EDGE		PROPOSED EARTHWORKS
	PROPOSED ROAD EDGE		BULL NOSED KERB
	PROPOSED WHITE ROAD MARKING		PROPOSED POST & WIRE FENCE
	PROPOSED YELLOW ROAD MARKING		PROPOSED TRAFFIC SIGNALS
	NEW PAVEMENT		

SAFETY, HEALTH AND ENVIRONMENTAL INFORMATION
THE WORKS ARE TO BE UNDERTAKEN BY A COMPETENT DELIVERY TEAM, AND THEREFORE ONLY EXCEPTIONAL RISKS RELATING TO THE WORKS ASSOCIATED WITH THIS DRAWING ARE IDENTIFIED BELOW. FOR FURTHER DETAILS AND PROPOSED SAFETY MEASURES REFER "EWR PHASE 2 HAZARD LOG WORKING COPY" EB DOC. REF: 133735-NWR-RSA-SSD-000001.

ID	HAZARD DESCRIPTION
EWR2-HAZ-02510	PRESENCE OF HIGH PRESSURE GAS PIPELINE
EWR2-HAZ-02511	PRESENCE OF BURIED SERVICES/ UTILITIES

INDICATES PROJECT RISKS (EWR2-DRIS-)
 INDICATES H&S RISKS (EWR2-HAZ-)

- NETWORK RAIL (EAST WEST RAIL WESTERN SECTION PHASE 2)**
- NOTES:**
- THIS DRAWING IS NOT TO BE SCALED.
 - ALL DIMENSIONS ARE IN METRES (m) UNLESS SHOWN OTHERWISE.
 - THIS DRAWING IS TO BE READ IN CONJUNCTION WITH THE HIGHWAY DESIGN PACKAGE OF DRAWINGS AND DOCUMENTS.
 - WHEREVER REQUIRED, ROAD MARKINGS ARE TO BE LAID IN ACCORDANCE WITH THE TRAFFIC SIGN REGULATIONS AND GENERAL DIRECTIONS 2016 & TRAFFIC SIGNS MANUAL CHAPTER 5 (2003).
 - WHERE A FENCE IS PROPOSED IT SHALL TIE-IN TO THE EXISTING HEDGEROW OR BOUNDARY TREATMENT TO PROVIDE A SECURE BOUNDARY.
 - FOR POSITIONS OF UTILITY COMPANIES APPARATUS REFER TO DRAWING No.S 133735_2A-EWR-OXD-HRC_3-DR-CH-010003.
 - THIS DRAWING IS TO BE READ IN CONJUNCTION WITH STANDARD DETAILS DRAWING No.S 133735_RW-EWR-XX-XX-DR-CH-000122, 141, 142 & 212.
 - REFER TO DRAWING No. 133735_2A-EWR-OXD-XX-DR-CH-010255 FOR OFFLINE HIGHWAYS SIGNAGE STRATEGY.
 - FOR DETAILS OF SIGN FACES, POSTS AND FOUNDATIONS, SEE SIGNAGE STRATEGY SCHEDULE DRAWINGS 133735_RW-EWR-XX-XX-DR-CH-000302 - 133735_RW-EWR-XX-XX-DR-CH-000306.

Rev	Date	Description of Revisions	Desd	Chkd	Appr
B01	11/06/20	FOR INFORMATION			

SHARED - for Content Check S1



Project
East West Rail (Western Section) Phase 2

Drawing Title
HAUL ROAD CROSSING HRC_3 GENERAL ARRANGEMENT

Designed	Nagoth Thomas Ravi Kumar	Signed	N. T. R. Kumar	Date	11/06/20	
Drawn	Ravikumar KN	Signed	R. KN	Date	10/06/19	
Checked	Lisa Taylor	Signed	L. Taylor	Date	11/06/20	
Approved	Gareth Johnston	Signed	G. Johnston	Date	11/06/20	
Scale(s)	1:250 (ELR - Project Chainage (Miles/Yards))					
Design Package Risk Classification	OXD - Normal				Sheet	1 of 1
Alternative Reference					Revision	B01
Drawing Number	133735_2A-EWR-OXD-HRC_3-DR-CH-010001					

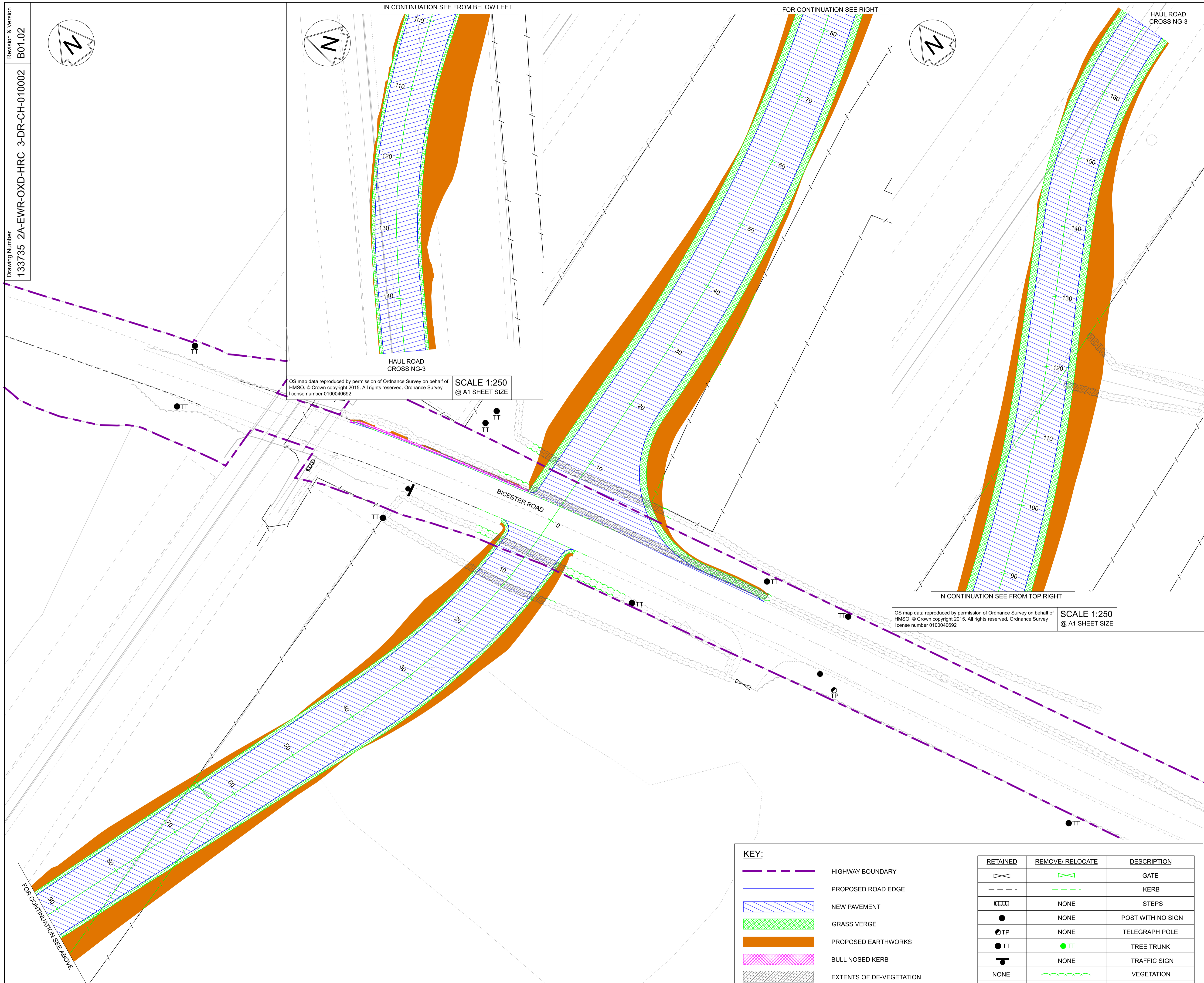
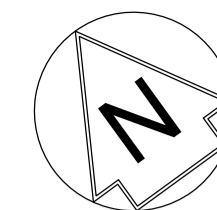
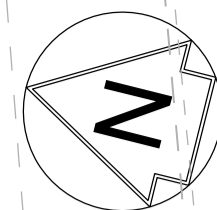
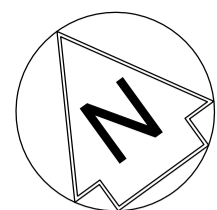

OS map data reproduced by permission of Ordnance Survey on behalf of HMSO. © Crown copyright 2015. All rights reserved. Ordnance Survey license number 0100040692

SCALE 1:250
@ A1 SHEET SIZE

OS map data reproduced by permission of Ordnance Survey on behalf of HMSO. © Crown copyright 2015. All rights reserved. Ordnance Survey license number 0100040692

SCALE 1:250
@ A1 SHEET SIZE

NETWORK RAIL (EAST WEST RAIL WESTERN SECTION PHASE 2)

- NOTES:**
1. THIS DRAWING IS NOT TO BE SCALED.
 2. ALL DIMENSIONS ARE IN METRES (m) UNLESS SHOWN OTHERWISE.
 3. THIS DRAWING IS TO BE READ IN CONJUNCTION WITH THE HIGHWAY DESIGN PACKAGE OF DRAWINGS AND DOCUMENTS.
 4. PRIOR TO THE COMMENCEMENT OF WORKS, A SUITABLY QUALIFIED ECOLOGIST SHALL INSPECT THE SITE FOR THE PRESENCE OF PROTECTED SPECIES AND HABITAT. THE ECOLOGIST SHALL THEN ADVISE EWR ALLIANCE ON THE REQUIRED PRECAUTIONARY METHODS AND AREAS OF EXCLUSION.
 5. WHERE SITE CLEARANCE WORKS HAVE THE POTENTIAL TO IMPACT TREES OR HEDGES WHICH ARE TO BE RETAINED, AN ARBORICULTURALIST SHALL BE PRESENT TO ADVISE ON ROOT PROTECTION ZONE EXTENTS, ROOT PRUNING AND CROWN RAISING. WORKS SHALL BE CARRIED OUT IN ACCORDANCE WITH BS3998:2010.
 6. SITE CLEARANCE, WHERE THERE IS PROXIMITY TO HABITAT OF PROTECTED SPECIES, SHALL BE CARRIED OUT UNDER THE SUPERVISION OF A SUITABLY QUALIFIED ECOLOGIST.
 7. THE EXTENTS OF ALL SITE CLEARANCE WORKS SHALL BE RECORDED IN THE AS-BUILT SITE CLEARANCE DRAWINGS AND SHALL ALSO BE RECORDED, WITH PHOTOGRAPHS OF FEATURES PRIOR TO REMOVAL, IN THE SITE CLEARANCE REGISTER. THE SITE CLEARANCE REGISTER SHALL BE MAINTAINED BY EWR ALLIANCE AND WILL INFORM REINSTATEMENT DETERMINATION.
 8. IN LOCATIONS WHERE EXISTING TREES OVERHANG THE PASSING PLACE CROWN LIFTING, TO GIVE 5m CLEARANCE ABOVE GROUND LEVEL, SHALL BE UNDERTAKEN TO THE BACK OF THE PROPOSED VERGE. THIS SHALL BE UNDERTAKEN UNDER THE SUPERVISION OF AN ARBORICULTURIST.
 9. THE VEGETATION CLEARANCE SHOWN HERE ON THE DRAWING IS INDICATIVE ONLY. THE SITE TEAM NEEDS TO ASCERTAIN THE REQUIRED CLEARANCE BASED ON THE VISIBILITY SPLAY, INTERVISIBILITY ZONE AND OR WORKS REQUIRED FOR THIS SITE.
 10. FOR CLARITY ONLY THE TRUNKS OF EXISTING TREES ARE SHOWN, FOR CANOPY EXTENTS THE TREE SURVEY MODEL AND MASTER SCHEDULE ARE TO BE REFERRED TO.

Rev	Date	Description of Revisions	Desd	Chkd	Appr
B01	11/06/20	FOR INFORMATION			

SHARED - for Content Check S1



Project
East West Rail (Western Section) Phase 2

Drawing Title
HAUL ROAD CROSSING HRC_3 SITE CLEARANCE

Designed	Nagoth Thomas Ravi Kumar	Signed	N. T. R. Kumar	Date	11/06/20
Drawn	Ravikumar KN	Signed	R. KN	Date	10/06/19
Checked	Lisa Taylor	Signed	L. Taylor	Date	11/06/20
Approved	Gareth Johnston	Signed	G. Johnston	Date	11/06/20

Scale(s)
1:250
ELR - Project Chainage (Miles Yards)
OXD -

Design Package Risk Classification
Normal

Alternative Reference
Drawing Number
133735_2A-EWR-OXD-HRC_3-DR-CH-010002

KEY:		RETAINED	REMOVE/ RELOCATE	DESCRIPTION
	HIGHWAY BOUNDARY			GATE
	PROPOSED ROAD EDGE			KERB
	NEW PAVEMENT			STEPS
	GRASS VERGE			POST WITH NO SIGN
	PROPOSED EARTHWORKS			TELEGRAPH POLE
	BULL NOSED KERB			TREE TRUNK
	EXTENTS OF DE-VEGETATION			TRAFFIC SIGN
				VEGETATION
				FENCE

OS map data reproduced by permission of Ordnance Survey on behalf of HMSO. © Crown copyright 2015. All rights reserved. Ordnance Survey license number 0100040692

SCALE 1:250
@ A1 SHEET SIZE

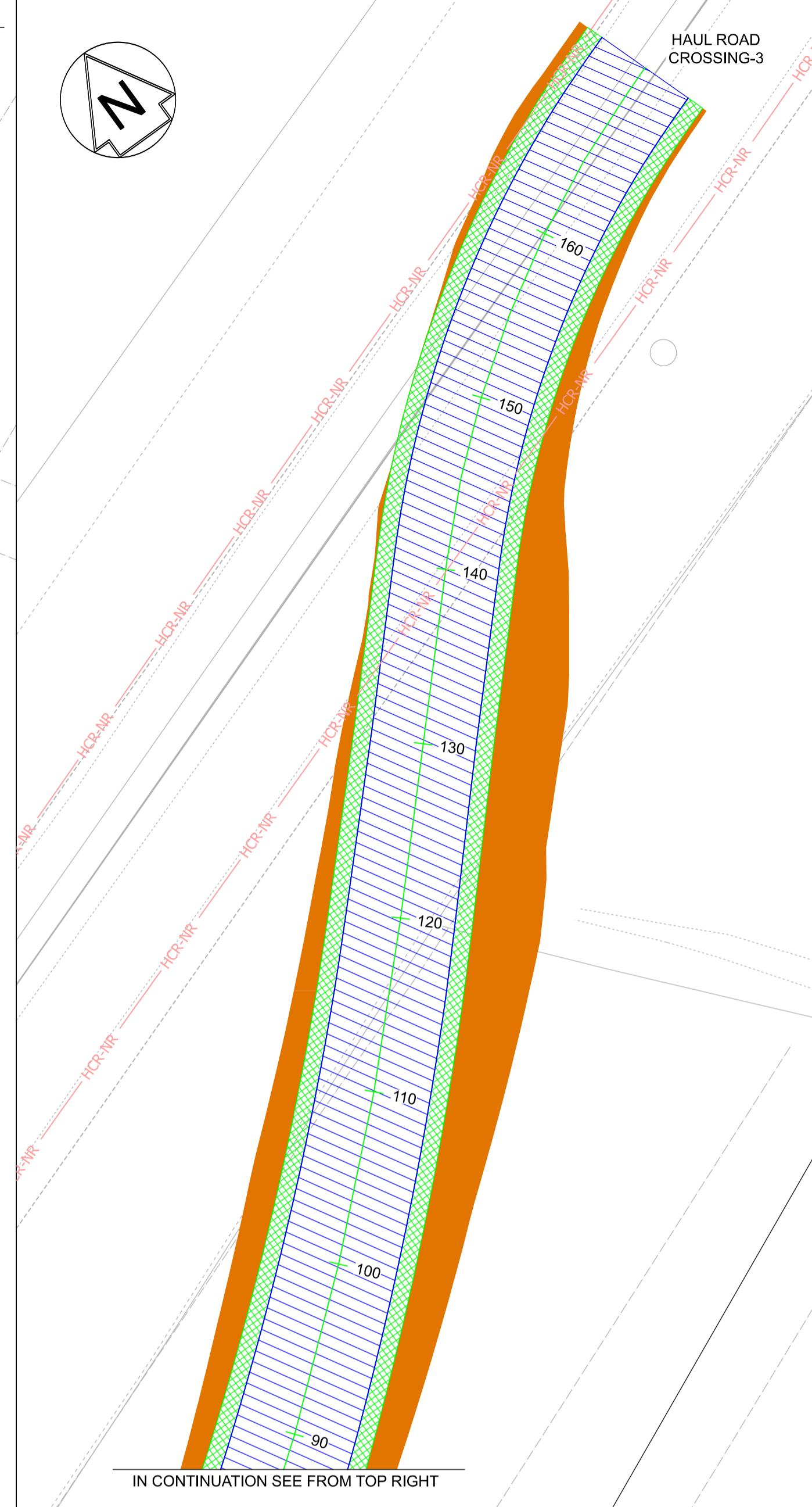
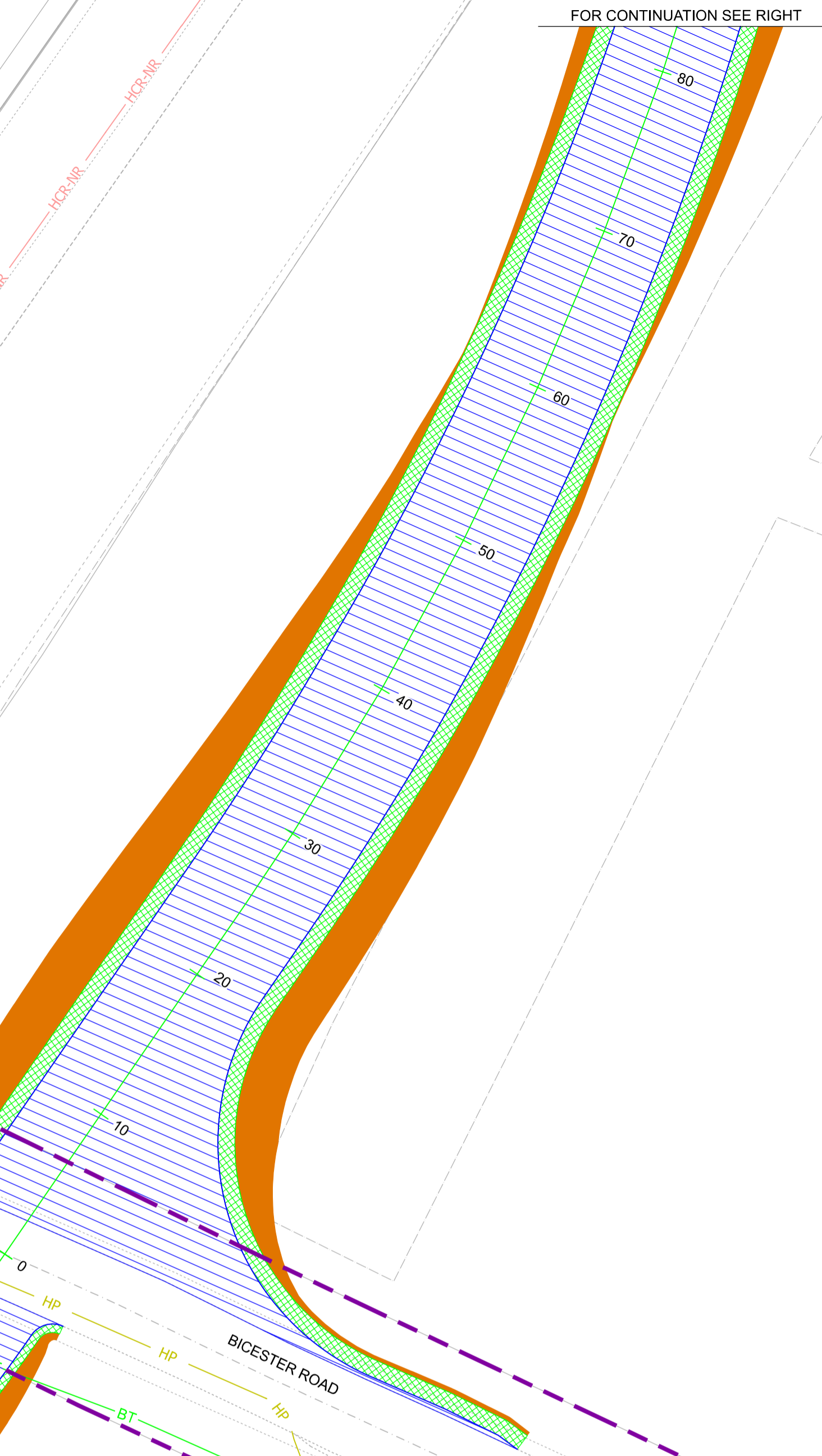
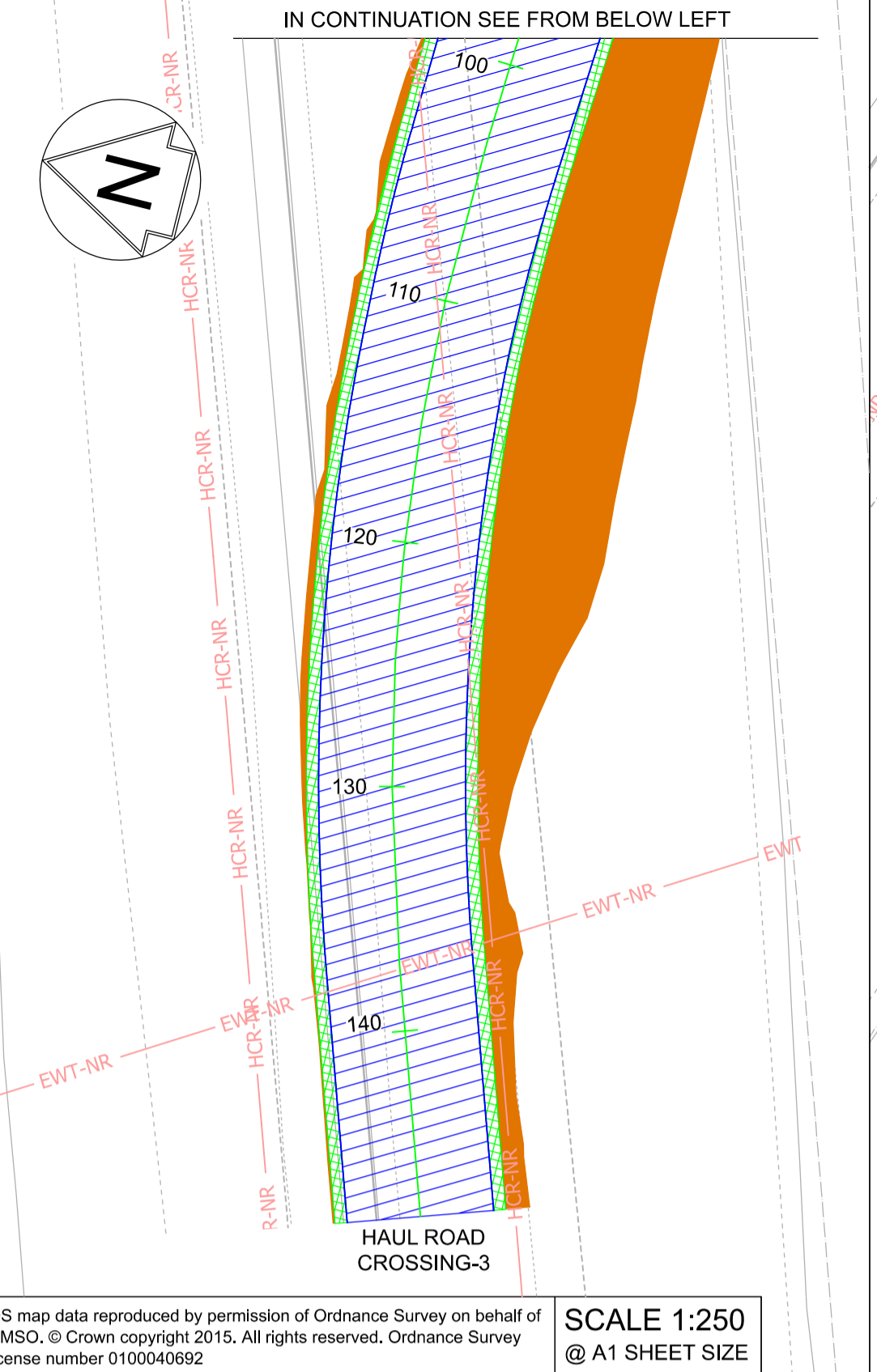
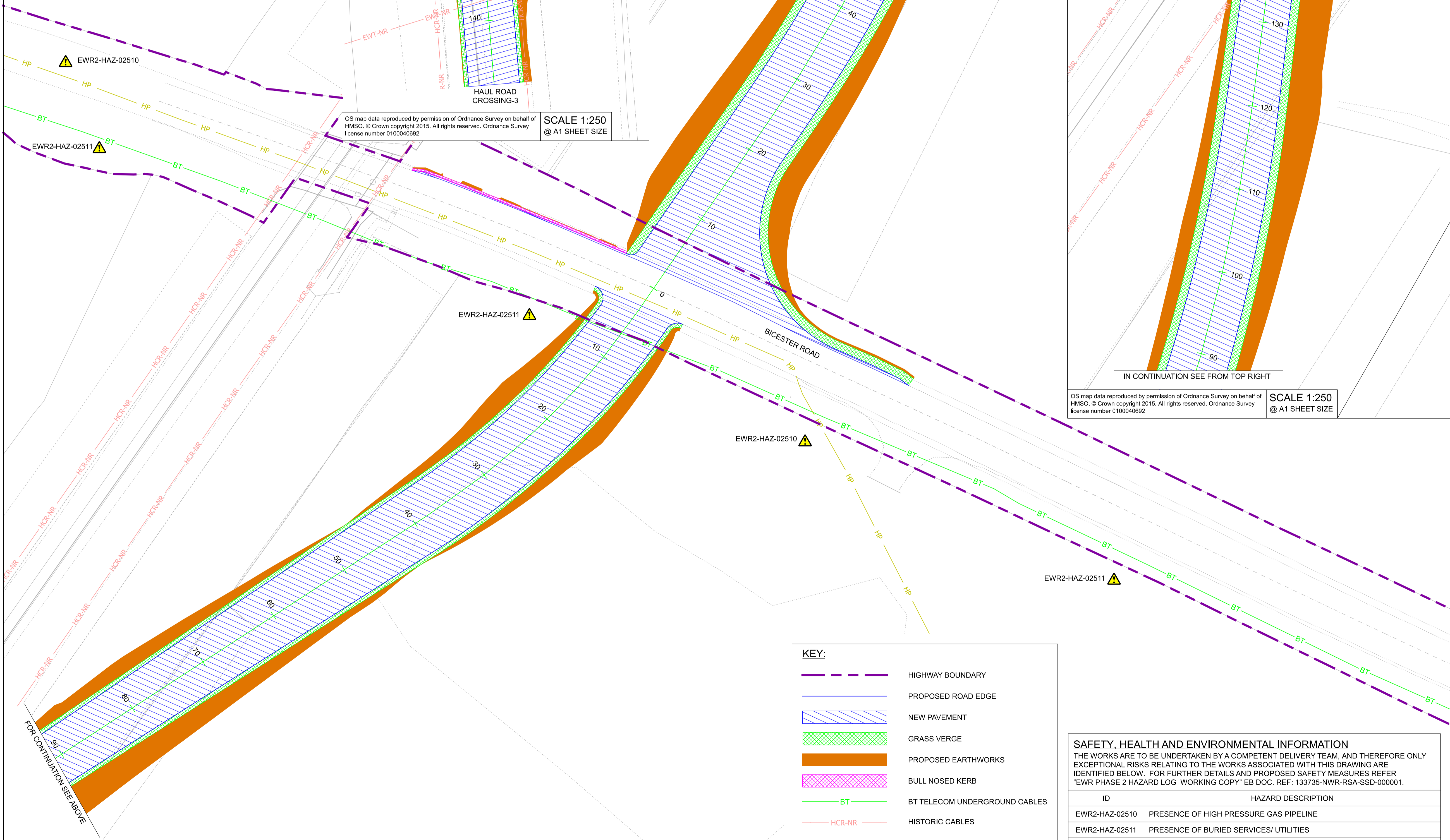

OS map data reproduced by permission of Ordnance Survey on behalf of HMSO. © Crown copyright 2015. All rights reserved. Ordnance Survey license number 0100040692
SCALE 1:250
@ A1 SHEET SIZE

OS map data reproduced by permission of Ordnance Survey on behalf of HMSO. © Crown copyright 2015. All rights reserved. Ordnance Survey license number 0100040692
SCALE 1:250
@ A1 SHEET SIZE

OS map data reproduced by permission of Ordnance Survey on behalf of HMSO. © Crown copyright 2015. All rights reserved. Ordnance Survey license number 0100040692
SCALE 1:250
@ A1 SHEET SIZE

KEY:

	HIGHWAY BOUNDARY
	PROPOSED ROAD EDGE
	NEW PAVEMENT
	GRASS VERGE
	PROPOSED EARTHWORKS
	BULL NOSED KERB
	BT TELECOM UNDERGROUND CABLES
	HISTORIC CABLES
	HIGH PRESSURE GAS

SAFETY, HEALTH AND ENVIRONMENTAL INFORMATION
THE WORKS ARE TO BE UNDERTAKEN BY A COMPETENT DELIVERY TEAM, AND THEREFORE ONLY EXCEPTIONAL RISKS RELATING TO THE WORKS ASSOCIATED WITH THIS DRAWING ARE IDENTIFIED BELOW. FOR FURTHER DETAILS AND PROPOSED SAFETY MEASURES REFER "EWR PHASE 2 HAZARD LOG WORKING COPY" EB DOC. REF: 133735-NWR-RSA-SSD-000001.

ID	HAZARD DESCRIPTION
EWR2-HAZ-02510	PRESENCE OF HIGH PRESSURE GAS PIPELINE
EWR2-HAZ-02511	PRESENCE OF BURIED SERVICES/ UTILITIES

INDICATES PROJECT RISKS (EWR2-DRIS-)
 INDICATES H&S RISKS (EWR2-HAZ-)

- NETWORK RAIL (EAST WEST RAIL WESTERN SECTION PHASE 2)**
- NOTES:**
1. THIS DRAWING IS NOT TO BE SCALED.
 2. ALL DIMENSIONS ARE IN METRES (m) UNLESS SHOWN OTHERWISE.
 3. THIS DRAWING IS TO BE READ IN CONJUNCTION WITH THE HIGHWAY DESIGN PACKAGE OF DRAWINGS AND DOCUMENTS.
 4. THE EXACT LOCATION AND EXTENT OF BURIED SERVICES SHALL BE VERIFIED ON SITE PRIOR TO COMMENCEMENT OF THE WORKS. AGREEMENT WITH PRIVATE LANDOWNERS SHALL BE OBTAINED PRIOR TO WORKS WHERE ACCESS TO PRIVATE LAND IS REQUIRED.
 5. THIS DRAWING SHOWS THE POSITION OF UTILITY COMPANIES APPARATUS KNOWN TO OPERATE IN THE AREA IMMEDIATELY ADJACENT TO AND WITHIN THE LAND TAKE BOUNDARY FOR EAST WEST RAIL.
 6. THE POSITIONS INDICATED FOR THE APPARATUS ARE BASED ON RECORDS PROVIDED BY NETWORK RAIL. THE ACCURACY OF THE DRAWING IS THEREFORE LIMITED BY THE ACCURACY OF THE RECORDS MAINTAINED BY THE UTILITY COMPANIES, THE METHODS AVAILABLE TO PROCESS / REPRODUCE THIS INFORMATION IN THE DRAWINGS AND THE AGE OF THE INFORMATION. THERE IS THE POSSIBILITY THAT APPARATUS HAS BEEN ADDED OR REMOVED SINCE THE RECORDS WERE PROVIDED.
 7. ALL SEARCHES MUST BE VERIFIED AND ESTABLISHED ON SITE BEFORE WORK COMMENCES. IT IS THE RESPONSIBILITY OF THE EWR ALLIANCE TO IDENTIFY AND LOCATE UTILITY PLANT PRIOR TO WORK GOING AHEAD.

B01	11/06/20	FOR INFORMATION	N.T.	L.T.	G.J.
Rev	Date	Description of Revisions	Dsnd	Chkd	Appr
Status	SHARED - for Content Check				S1



Project
East West Rail (Western Section) Phase 2

Drawing Title
HAUL ROAD CROSSING HRC_3 EXISTING UTILITIES

Designed	Nagoth Thomas Ravi Kumar	Signed	N. T. R. Kumar	Date	11/06/20
Drawn	Ravikumar KN	Signed	R. KN	Date	10/06/19
Checked	Lisa Taylor	Signed	L. Taylor	Date	11/06/20
Approved	Gareth Johnston	Signed	G. Johnston	Date	11/06/20
Scale(s)	1:250				
Design Package Risk Classification	ELR - Project Chainage (Miles/Yards) OXD -				Sheet
Alternative Reference	Normal				1 of 1
Drawing Number	133735_2A-EWR-OXD-HRC_3-DR-CH-010003				Revision B01

OS map data reproduced by permission of Ordnance Survey on behalf of HAMS. © Crown copyright 2015. All rights reserved. Ordnance Survey license number 0100040692

SCALE 1:250
@ A1 SHEET SIZE

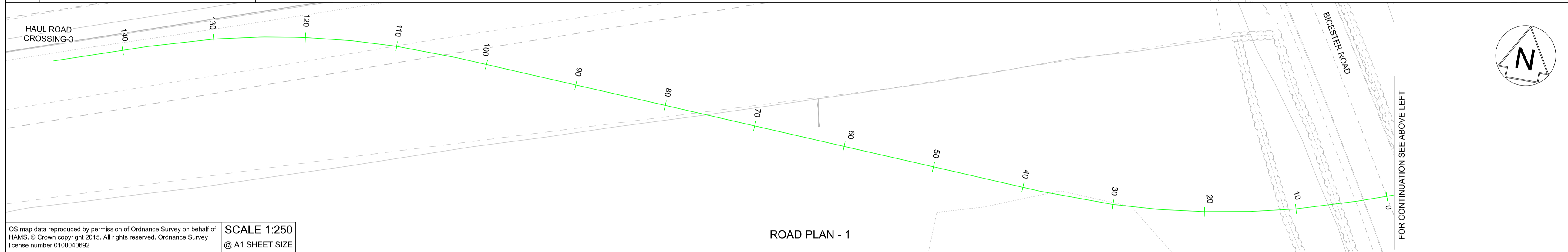
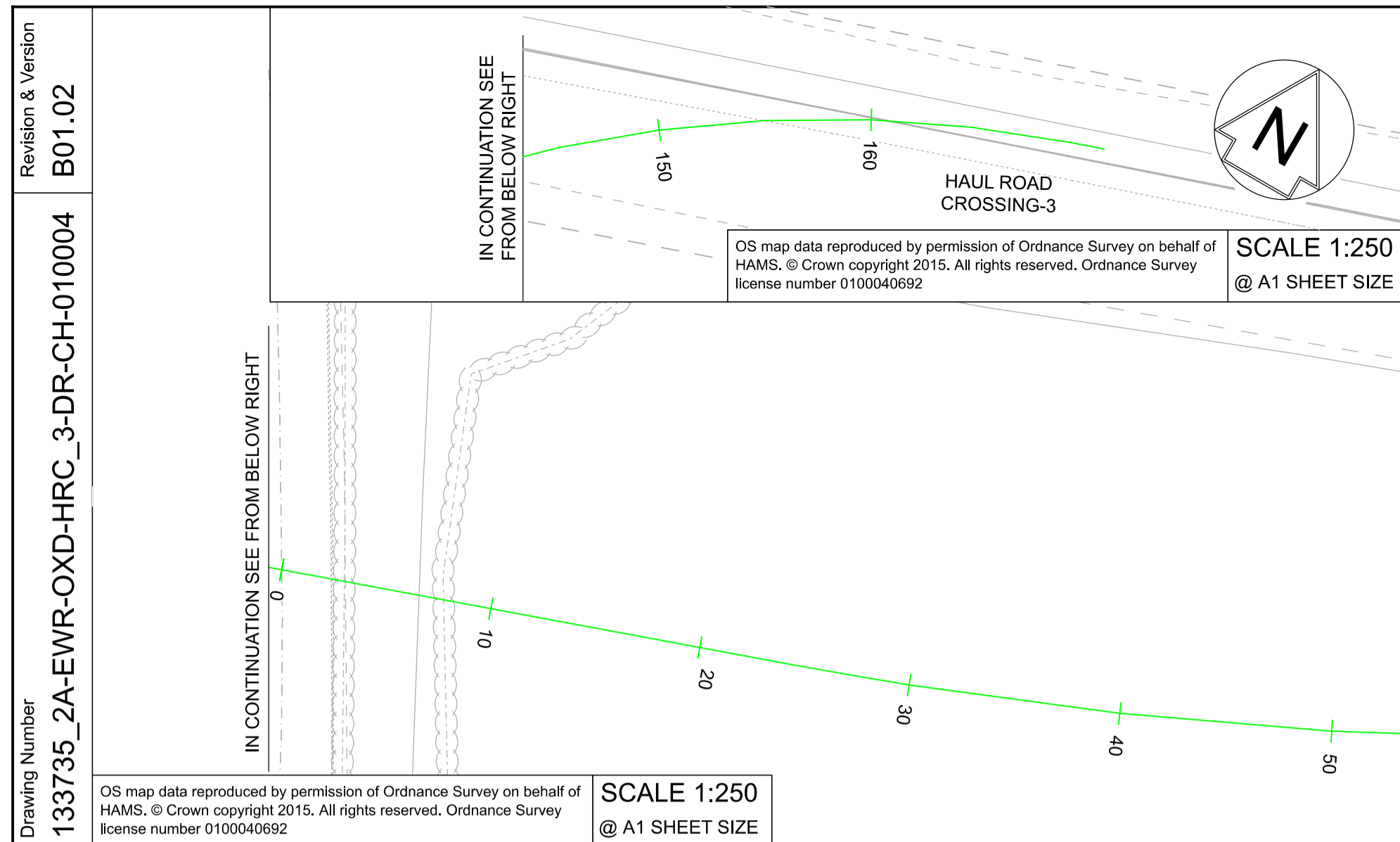

OS map data reproduced by permission of Ordnance Survey on behalf of HAMS. © Crown copyright 2015. All rights reserved. Ordnance Survey license number 0100040692

SCALE 1:250
@ A1 SHEET SIZE

KEY:
 NEW ROAD EDGE LEVEL
 EXISTING SURFACE LEVEL

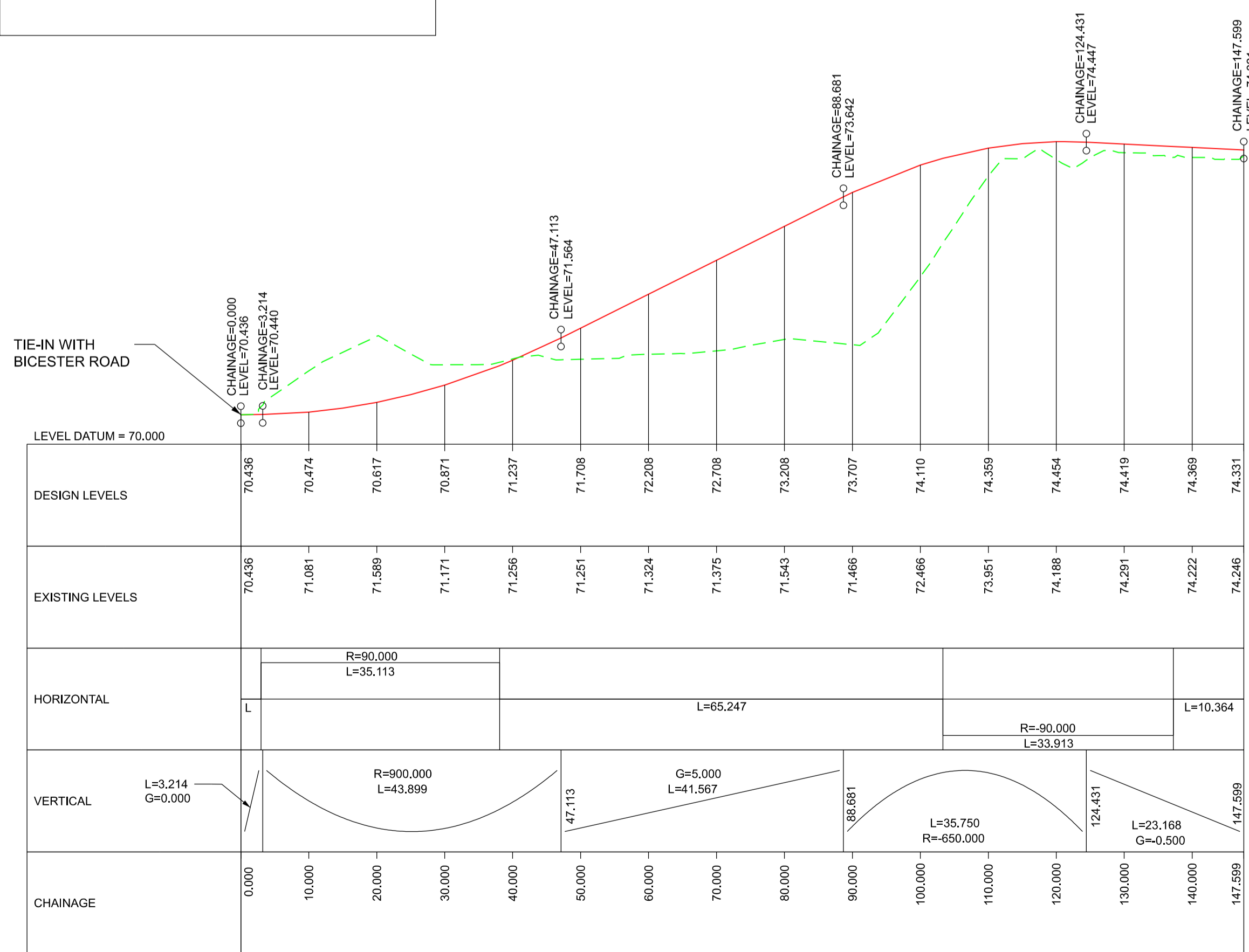

ROAD PROFILE WEST - 1
SCALE = H - 1:500
V - 1:50

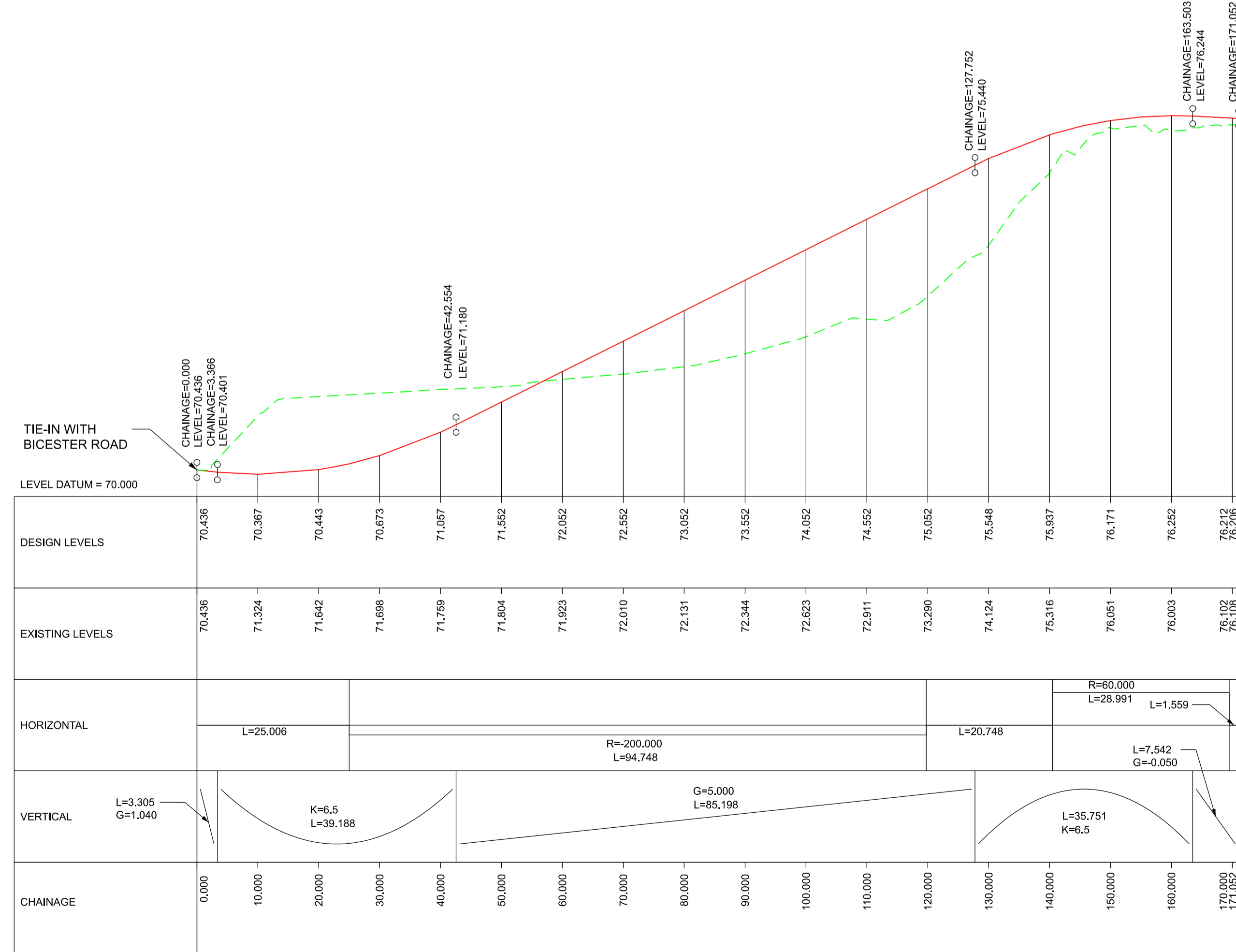

ROAD PROFILE EAST - 2
SCALE = H - 1:500
V - 1:50

SCALE : AS SHOWN
@ A1 SHEET SIZE

NETWORK RAIL (EAST WEST RAIL WESTERN SECTION PHASE 2)

NOTES:

1. THIS DRAWING IS NOT TO BE SCALED.
2. ALL DIMENSIONS AND LEVELS ARE IN METRES (m) UNLESS SHOWN OTHERWISE.
3. THIS DRAWING IS TO BE READ IN CONJUNCTION WITH THE HIGHWAY DESIGN PACKAGE OF DRAWINGS AND DOCUMENTS.

Rev	Date	Description of Revisions	Dsnd	Chkd	Appr	
B01	11/06/20	FOR INFORMATION		N.T.	L.T.	G.J.

SHARED - for Content Check S1



Project
East West Rail (Western Section) Phase 2

Drawing Title
HAUL ROAD CROSSING HRC_3 ROAD PLAN AND PROFILE

Designed	Checked	Approved	Signed	Date
Nagoth Thomas Ravi Kumar	Lisa Taylor	Gareth Johnston	N. T. R. Kumar R. KN L. Taylor G. Johnston	11/06/20 10/06/19 11/06/20 11/06/20

Scale(s) ELR - Project Chainage (Miles Yards)
AS SHOWN OXD -

Design Package Risk Classification Normal Sheet 1 of 1

Alternative Reference Revision B01

Drawing Number 133735_2A-EWR-OXD-HRC_3-DR-CH-010004

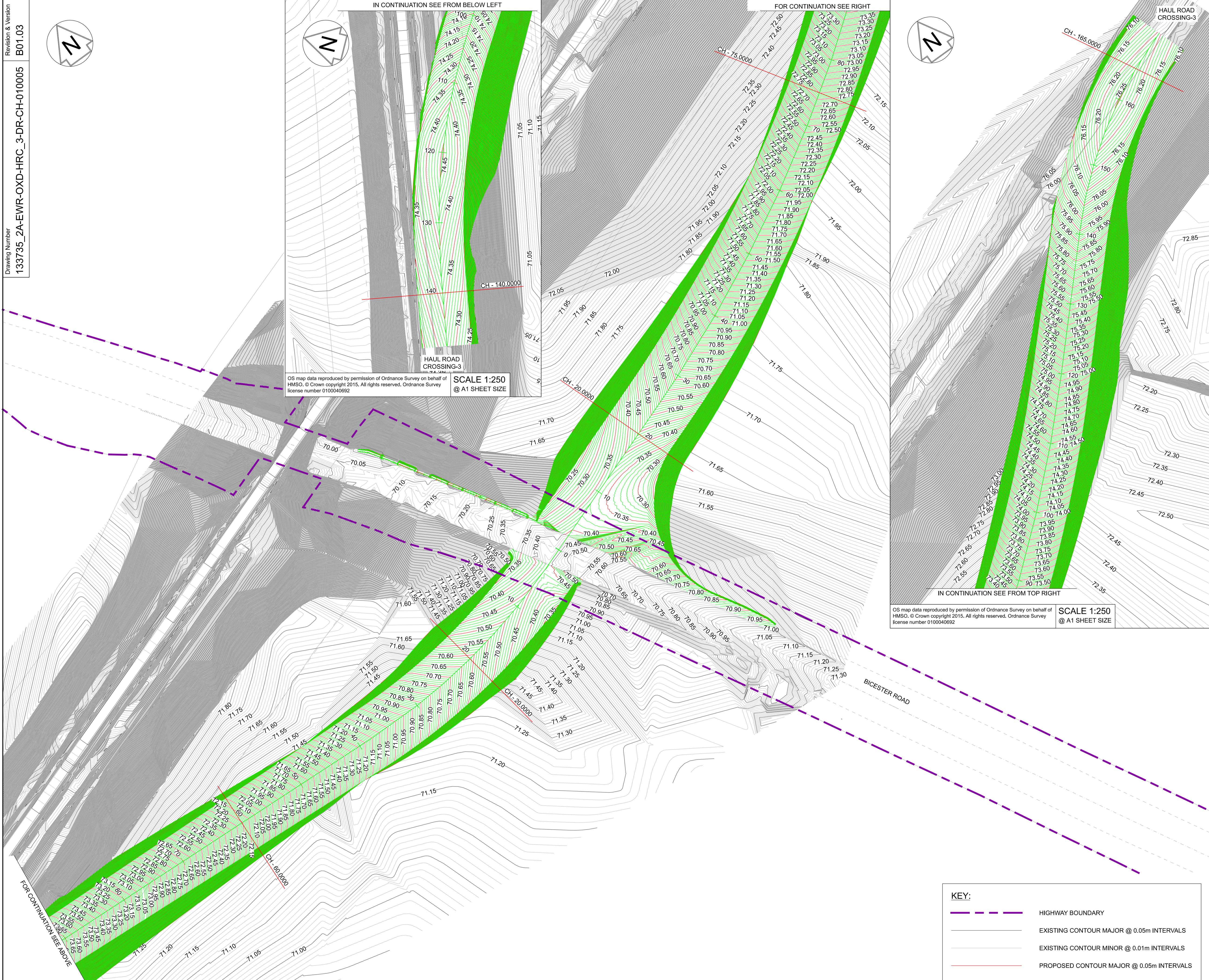
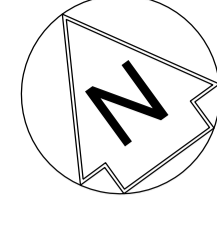
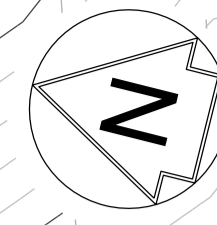
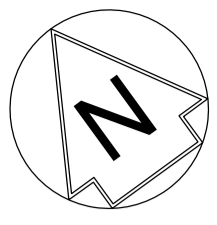

OS map data reproduced by permission of Ordnance Survey on behalf of HMSO. © Crown copyright 2015. All rights reserved. Ordnance Survey license number 0100040692
SCALE 1:250
@ A1 SHEET SIZE

OS map data reproduced by permission of Ordnance Survey on behalf of HMSO. © Crown copyright 2015. All rights reserved. Ordnance Survey license number 0100040692
SCALE 1:250
@ A1 SHEET SIZE

OS map data reproduced by permission of Ordnance Survey on behalf of HMSO. © Crown copyright 2015. All rights reserved. Ordnance Survey license number 0100040692
SCALE 1:250
@ A1 SHEET SIZE

KEY:

	HIGHWAY BOUNDARY
	EXISTING CONTOUR MAJOR @ 0.05m INTERVALS
	EXISTING CONTOUR MINOR @ 0.01m INTERVALS
	PROPOSED CONTOUR MAJOR @ 0.05m INTERVALS
	PROPOSED CONTOUR MINOR @ 0.01m INTERVALS

- NOTES:**
1. THIS DRAWING IS NOT TO BE SCALED.
 2. ALL DIMENSIONS ARE IN METRES (m) UNLESS SHOWN OTHERWISE.
 3. THIS DRAWING IS TO BE READ IN CONJUNCTION WITH THE HIGHWAY DESIGN PACKAGE OF DRAWINGS AND DOCUMENTS.
 4. ALL WORKS TO BE IN ACCORDANCE WITH THE MANUAL OF CONTRACT DOCUMENTS FOR HIGHWAYS WORKS VOL 1 (SPECIFICATION FOR HIGHWAY WORKS) AND STANDARD CONSTRUCTION DETAILS.
 5. THE DELIVERY TEAM IS TO VERIFY DIMENSIONS ON SITE AND ADVISE OF ANY INFORMATION DISCREPANCIES. TIE-IN POINTS SHOULD BE VERIFIED ON SITE WITH THE ENGINEER PRIOR TO CONSTRUCTION.

Rev	Date	Description of Revisions	Desd	Chkd	Appr
B01	11/06/20	FOR INFORMATION	N.T.	L.T.	G.J.

SHARED - for Content Check S1



Project
**East West Rail
(Western Section)
Phase 2**

Drawing Title
**HAUL ROAD CROSSING HRC_3
EXISTING AND PROPOSED
CONTOURS**

Designed	Nagoth Thomas Ravi Kumar	Signed	N. T. R. Kumar	Date	11/06/20
Drawn	Ravikumar KN	Signed	R. KN	Date	10/06/19
Checked	Lisa Taylor	Signed	L. Taylor	Date	11/06/20
Approved	Gareth Johnston	Signed	G. Johnston	Date	11/06/20

Scale(s)
1:250
ELR - Project Chainage (Miles Yards)
OXD -

Design Package Risk Classification
Normal

Alternative Reference
Drawing Number
133735_2A-EWR-OXD-HRC_3-DR-CH-010005

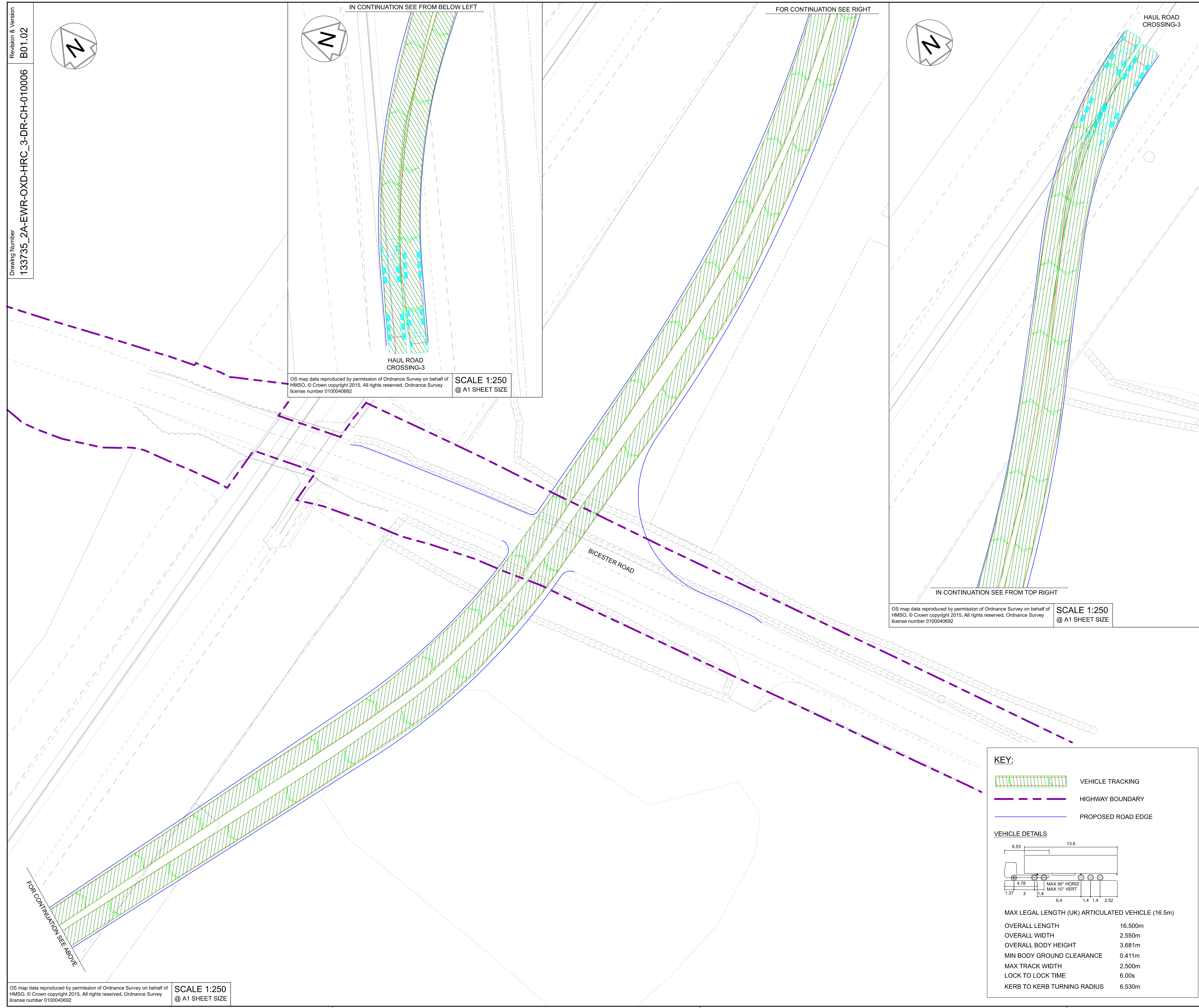
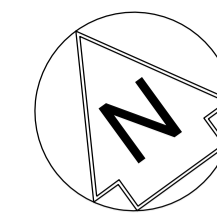
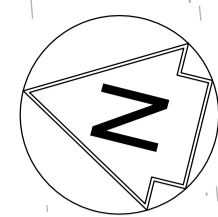
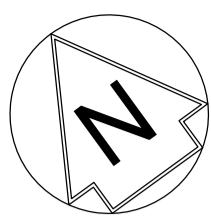

OS map data reproduced by permission of Ordnance Survey on behalf of HMSO. © Crown copyright 2015. All rights reserved. Ordnance Survey license number 0100040692

SCALE 1:250
@ A1 SHEET SIZE

OS map data reproduced by permission of Ordnance Survey on behalf of HMSO. © Crown copyright 2015. All rights reserved. Ordnance Survey license number 0100040692

SCALE 1:250
@ A1 SHEET SIZE

- NETWORK RAIL (EAST WEST RAIL WESTERN SECTION PHASE 2)**
- NOTES:**
1. THIS DRAWING IS NOT TO BE SCALED.
 2. ALL DIMENSIONS ARE IN METRES (m) UNLESS SHOWN OTHERWISE.
 3. VEHICLE TRACKING IS UNDERTAKEN WITH COMPUTER MODELLING SOFTWARE AND IS BASED ON IDEAL SITUATIONS WHERE REAL WORLD OBSTRUCTIONS ON THE ROAD NETWORK SUCH AS PARKING OR LOADING ACTIVITY WOULD NOT HAVE BEEN FORESEEN.
 4. THE MODELLING IS BASED IN 2D PLAN WHERE SWEEP PATHS ARE INFLUENCED BY ANTICIPATED MOVEMENTS AND THEREFORE LEAD TO IDEAL APPROACH ANGLES, WHICH MIGHT NOT BE OBVIOUS IN REALITY.
 5. APPROACH SPEEDS, APPROACH ANGLES, ROAD SURFACE, WEATHER CONDITIONS AND TYRE WEAR ARE ALL FACTORS THAT WILL INFLUENCE VEHICLE PATHS.

Rev	Date	Description of Revisions	Desd	Chkd	Appr	
B01	11/06/20	FOR INFORMATION		N.T.	L.T.	G.J.

SHARED - for Content Check S1



Project
East West Rail (Western Section) Phase 2

Drawing Title
HAUL ROAD CROSSING HRC_3 VEHICLE SWEEP PATH ANALYSIS

Designed	Nagoth Thomas Ravi Kumar	Signed	N. T. R. Kumar	Date	11/06/20
Drawn	Ravikumar KN	Signed	R. KN	Date	10/06/19
Checked	Lisa Taylor	Signed	L. Taylor	Date	11/06/20
Approved	Gareth Johnston	Signed	G. Johnston	Date	11/06/20

Scale(s)
1:250
ELR - Project Chainage (Miles Yards)
OXD -

Design Package Risk Classification
Normal

Alternative Reference
Revision
B01

Drawing Number
133735_2A-EWR-OXD-HRC_3-DR-CH-010006

KEY:

- VEHICLE TRACKING
- HIGHWAY BOUNDARY
- PROPOSED ROAD EDGE

VEHICLE DETAILS

MAX LEGAL LENGTH (UK) ARTICULATED VEHICLE (16.5m)

OVERALL LENGTH	16.500m
OVERALL WIDTH	2.550m
OVERALL BODY HEIGHT	3.681m
MIN BODY GROUND CLEARANCE	0.411m
MAX TRACK WIDTH	2.500m
LOCK TO LOCK TIME	6.00s
KERB TO KERB TURNING RADIUS	6.530m

OS map data reproduced by permission of Ordnance Survey on behalf of HMSO. © Crown copyright 2015. All rights reserved. Ordnance Survey license number 0100040692

SCALE 1:250
@ A1 SHEET SIZE

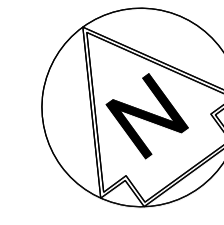
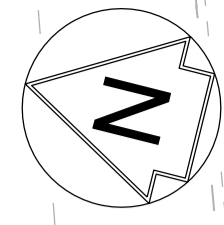
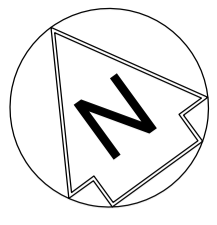

IN CONTINUATION SEE FROM BELOW LEFT

FOR CONTINUATION SEE RIGHT

HAUL ROAD CROSSING-3

HAUL ROAD CROSSING-3

OS map data reproduced by permission of Ordnance Survey on behalf of HMSO. © Crown copyright 2015. All rights reserved. Ordnance Survey license number 0100040692

SCALE 1:250
@ A1 SHEET SIZE

OS map data reproduced by permission of Ordnance Survey on behalf of HMSO. © Crown copyright 2015. All rights reserved. Ordnance Survey license number 0100040692

SCALE 1:250
@ A1 SHEET SIZE

SEE NOTE 5

IN CONTINUATION SEE FROM TOP RIGHT

BICESTER ROAD

FOR CONTINUATION SEE ABOVE

OS map data reproduced by permission of Ordnance Survey on behalf of HMSO. © Crown copyright 2015. All rights reserved. Ordnance Survey license number 0100040692

SCALE 1:250
@ A1 SHEET SIZE

NETWORK RAIL (EAST WEST)
RAIL WESTERN SECTION PHASE 2)

NOTES:

1. THIS DRAWING IS NOT TO BE SCALED.
2. ALL DIMENSIONS ARE IN METRES (m) UNLESS SHOWN OTHERWISE.
3. THE SITE TEAM NEEDS TO ASCERTAIN THE REQUIRED CLEARANCE BASED ON THE VISIBILITY SPLAY INTERVISIBILITY ZONE AND OR WORKS REQUIRED FOR THIS SITE.
4. WHEREVER REQUIRED, ROAD MARKINGS ARE TO BE LAID IN ACCORDANCE WITH 'THE TRAFFIC SIGN REGULATIONS AND GENERAL DIRECTIONS 2016' & 'TRAFFIC SIGNS MANUAL CHAPTER 5 (2003)'.
5. JUNCTION INTERVISIBILITY ZONE AS PER DMRB TD 50.

Rev	Date	Description of Revisions	Desd	Chkd	Appr
B01	11/06/20	FOR INFORMATION			

SHARED - for Content Check S1

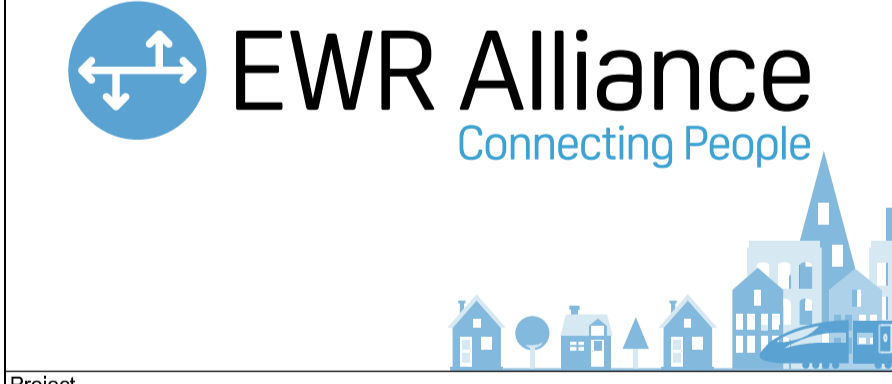

Project
**East West Rail
(Western Section)
Phase 2**

Drawing Title
**HAUL ROAD CROSSING HRC_3
INTERVISIBILITY ZONE**

Designed	Nagoth Thomas Ravi Kumar	Signed	N. T. R. Kumar	Date	11/06/20
Drawn	Ravikumar KN	Signed	R. KN	Date	10/06/19
Checked	Lisa Taylor	Signed	L. Taylor	Date	11/06/20
Approved	Gareth Johnston	Signed	G. Johnston	Date	11/06/20

Scale(s)
1:250
ELR - Project Chainage (Miles Yards)
OXD -

Design Package Risk Classification
Normal

Alternative Reference
Drawing Number
133735_2A-EWR-OXD-HRC_3-DR-CH-010007

KEY:

	INTERVISIBILITY ZONE
	HIGHWAY BOUNDARY
	PROPOSED ROAD EDGE
	PROPOSED WHITE ROAD MARKING
	PROPOSED YELLOW ROAD MARKING
	PROPOSED TRAFFIC SIGNALS

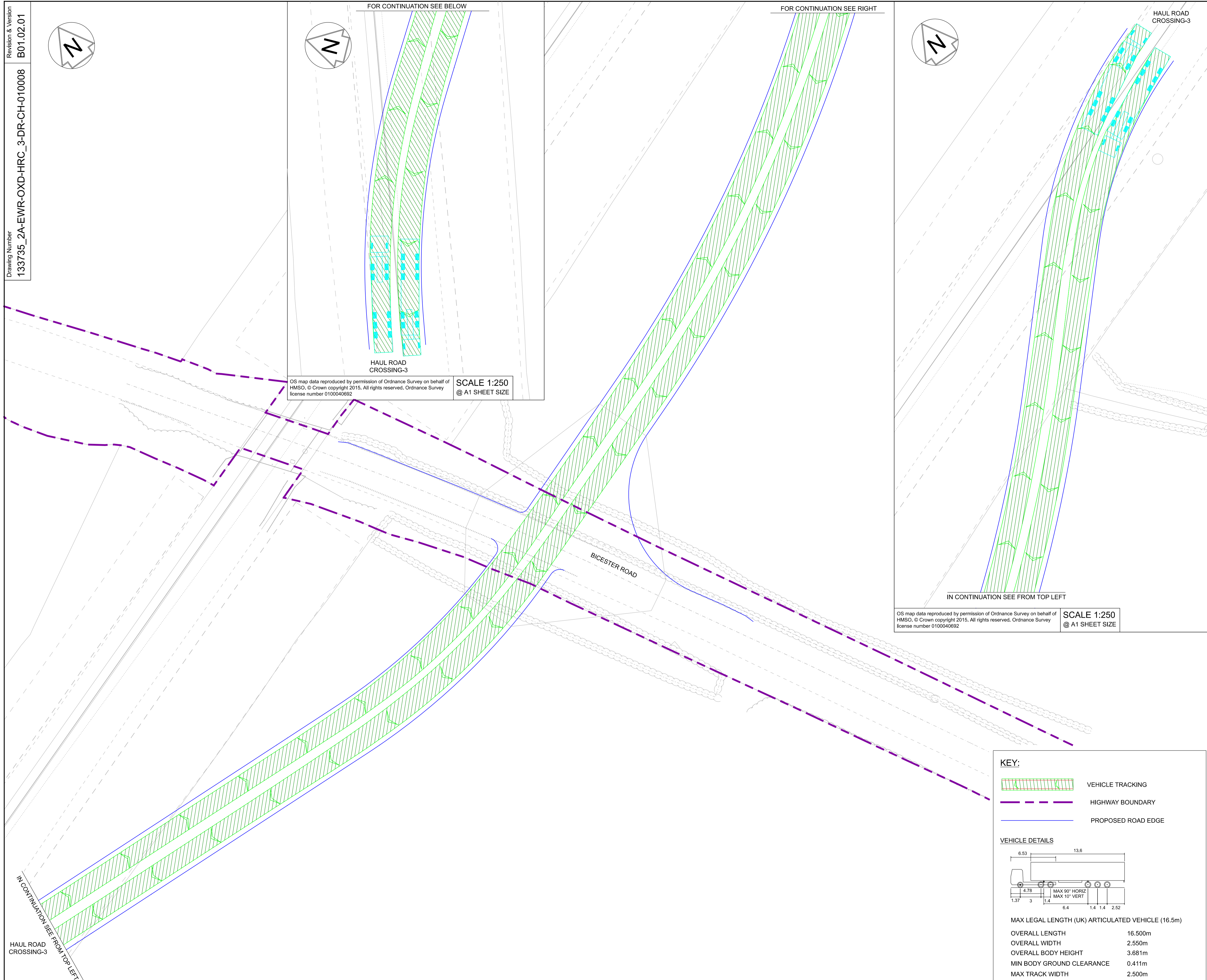
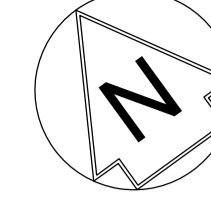
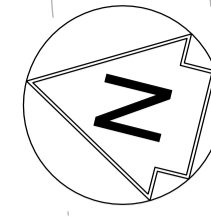
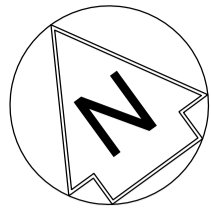

OS map data reproduced by permission of Ordnance Survey on behalf of HMSO. © Crown copyright 2015. All rights reserved. Ordnance Survey license number 0100040692

SCALE 1:250
@ A1 SHEET SIZE

OS map data reproduced by permission of Ordnance Survey on behalf of HMSO. © Crown copyright 2015. All rights reserved. Ordnance Survey license number 0100040692

SCALE 1:250
@ A1 SHEET SIZE

- NETWORK RAIL (EAST WEST RAIL WESTERN SECTION PHASE 2)**
- NOTES:**
1. THIS DRAWING IS NOT TO BE SCALED.
 2. ALL DIMENSIONS ARE IN METRES (m) UNLESS SHOWN OTHERWISE.
 3. VEHICLE TRACKING IS UNDERTAKEN WITH COMPUTER MODELLING SOFTWARE AND IS BASED ON IDEAL SITUATIONS WHERE REAL WORLD OBSTRUCTIONS ON THE ROAD NETWORK SUCH AS PARKING OR LOADING ACTIVITY WOULD NOT HAVE BEEN FORESEEN.
 4. THE MODELLING IS BASED IN 2D PLAN WHERE SWEEPED PATHS ARE INFLUENCED BY ANTICIPATED MOVEMENTS AND THEREFORE LEAD TO IDEAL APPROACH ANGLES, WHICH MIGHT NOT BE OBVIOUS IN REALITY.
 5. APPROACH SPEEDS, APPROACH ANGLES, ROAD SURFACE, WEATHER CONDITIONS AND TYRE WEAR ARE ALL FACTORS THAT WILL INFLUENCE VEHICLE PATHS.

Rev	Date	Description of Revisions	Desd	Chkd	Appr
B01	07/04/20	WIP - DESIGN	--	--	--

WIP - Design

EWR Alliance
Connecting People



Project
East West Rail (Western Section) Phase 2

Drawing Title
HAUL ROAD CROSSING HRC_3 VEHICLE SWEEPED PATH ANALYSIS

Designed	---	Signed	---	Date	---
Drawn	Ravikumar KN	Signed	R. KN	Date	27/08/19
Checked	---	Signed	---	Date	---
Approved	---	Signed	---	Date	---

Scale(s)
1:250

Design Package Risk Classification
Normal

Alternative Reference

Drawing Number
133735_2A-EWR-OXD-HRC_3-DR-CH-010008

Sheet
2 of 3

Revision
B01

KEY:

- VEHICLE TRACKING
- HIGHWAY BOUNDARY
- PROPOSED ROAD EDGE

VEHICLE DETAILS

MAX LEGAL LENGTH (UK) ARTICULATED VEHICLE (16.5m)

OVERALL LENGTH	16.500m
OVERALL WIDTH	2.550m
OVERALL BODY HEIGHT	3.681m
MIN BODY GROUND CLEARANCE	0.411m
MAX TRACK WIDTH	2.500m
LOCK TO LOCK TIME	6.00s
KERB TO KERB TURNING RADIUS	6.530m

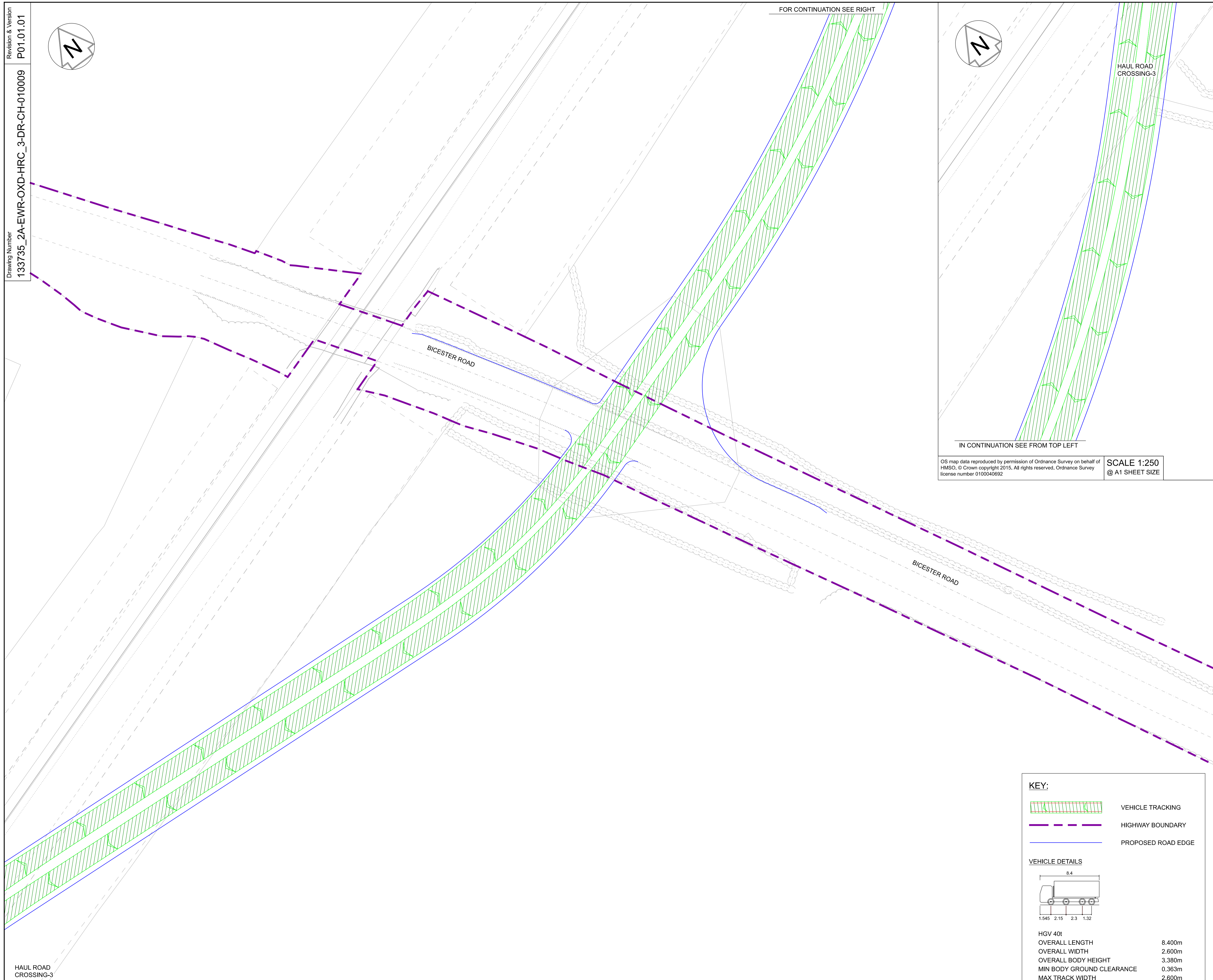
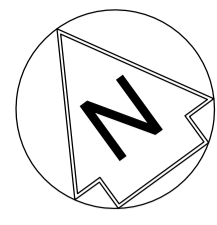

OS map data reproduced by permission of Ordnance Survey on behalf of HMSO. © Crown copyright 2015. All rights reserved. Ordnance Survey license number 0100040692

SCALE 1:250
@ A1 SHEET SIZE

NETWORK RAIL (EAST WEST
RAIL WESTERN SECTION PHASE 2)

- NOTES:**
1. THIS DRAWING IS NOT TO BE SCALED.
 2. ALL DIMENSIONS ARE IN METRES (m) UNLESS SHOWN OTHERWISE.
 3. VEHICLE TRACKING IS UNDERTAKEN WITH COMPUTER MODELLING SOFTWARE AND IS BASED ON IDEAL SITUATIONS WHERE REAL WORLD OBSTRUCTIONS ON THE ROAD NETWORK SUCH AS PARKING OR LOADING ACTIVITY WOULD NOT HAVE BEEN FORESEEN.
 4. THE MODELLING IS BASED IN 2D PLAN WHERE SWEEPED PATHS ARE INFLUENCED BY ANTICIPATED MOVEMENTS AND THEREFORE LEAD TO IDEAL APPROACH ANGLES, WHICH MIGHT NOT BE OBVIOUS IN REALITY.
 5. APPROACH SPEEDS, APPROACH ANGLES, ROAD SURFACE, WEATHER CONDITIONS AND TYRE WEAR ARE ALL FACTORS THAT WILL INFLUENCE VEHICLE PATHS.

Rev	Date	Description of Revisions	Desd	Chkd	Appr
P01	27/08/19	WIP - DESIGN	--	--	--
Status					S0



Project
**East West Rail
(Western Section)
Phase 2**

Drawing Title
**HAUL ROAD CROSSING HRC_3
VEHICLE SWEEPED PATH ANALYSIS**

Designed	---	Signed	---	Date	---
Drawn	Ravikumar KN	Signed	R. KN	Date	27/08/19
Checked	---	Signed	---	Date	---
Approved	---	Signed	---	Date	---

Scale(s)	1:250	ELR - Project Chainage (Miles/Yards)	OXD -
Design Package Risk Classification	Normal	Sheet	3 of 3
Alternative Reference		Revision	P01

Drawing Number
133735_2A-EWR-OXD-HRC_3-DR-CH-010009

KEY:

- VEHICLE TRACKING
- HIGHWAY BOUNDARY
- PROPOSED ROAD EDGE

VEHICLE DETAILS

HGV 40t
OVERALL LENGTH 8.400m
OVERALL WIDTH 2.600m
OVERALL BODY HEIGHT 3.380m
MIN BODY GROUND CLEARANCE 0.363m
MAX TRACK WIDTH 2.600m
LOCK TO LOCK TIME 6.00s
KERB TO KERB TURNING RADIUS 11.550m

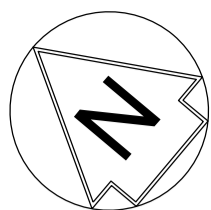

OS map data reproduced by permission of Ordnance Survey on behalf of HMSO. © Crown copyright 2015. All rights reserved. Ordnance Survey license number 0100040692

SCALE 1:500
@ A1 SHEET SIZE

160.00m
SOUTH BOUND APPROACH VISIBILITY

SIGNAL HEAD

BICESTER ROAD

SIGNAL HEAD

KEY:

- VISIBILITY LINE
- PROPOSED ROAD EDGE
- PROPOSED TRAFFIC SIGNALS

- NETWORK RAIL (EAST WEST RAIL WESTERN SECTION PHASE 2)**
- NOTES:**
- THIS DRAWING IS NOT TO BE SCALED.
 - ALL DIMENSIONS ARE IN METRES (m) UNLESS SHOWN OTHERWISE.
 - THIS DRAWING IS TO BE READ IN CONJUNCTION WITH THE HIGHWAY DESIGN PACKAGE OF DRAWINGS AND DOCUMENTS.
 - THE VISIBILITY ENVELOPE DEVELOPED IS AS PER DMRB TD50.

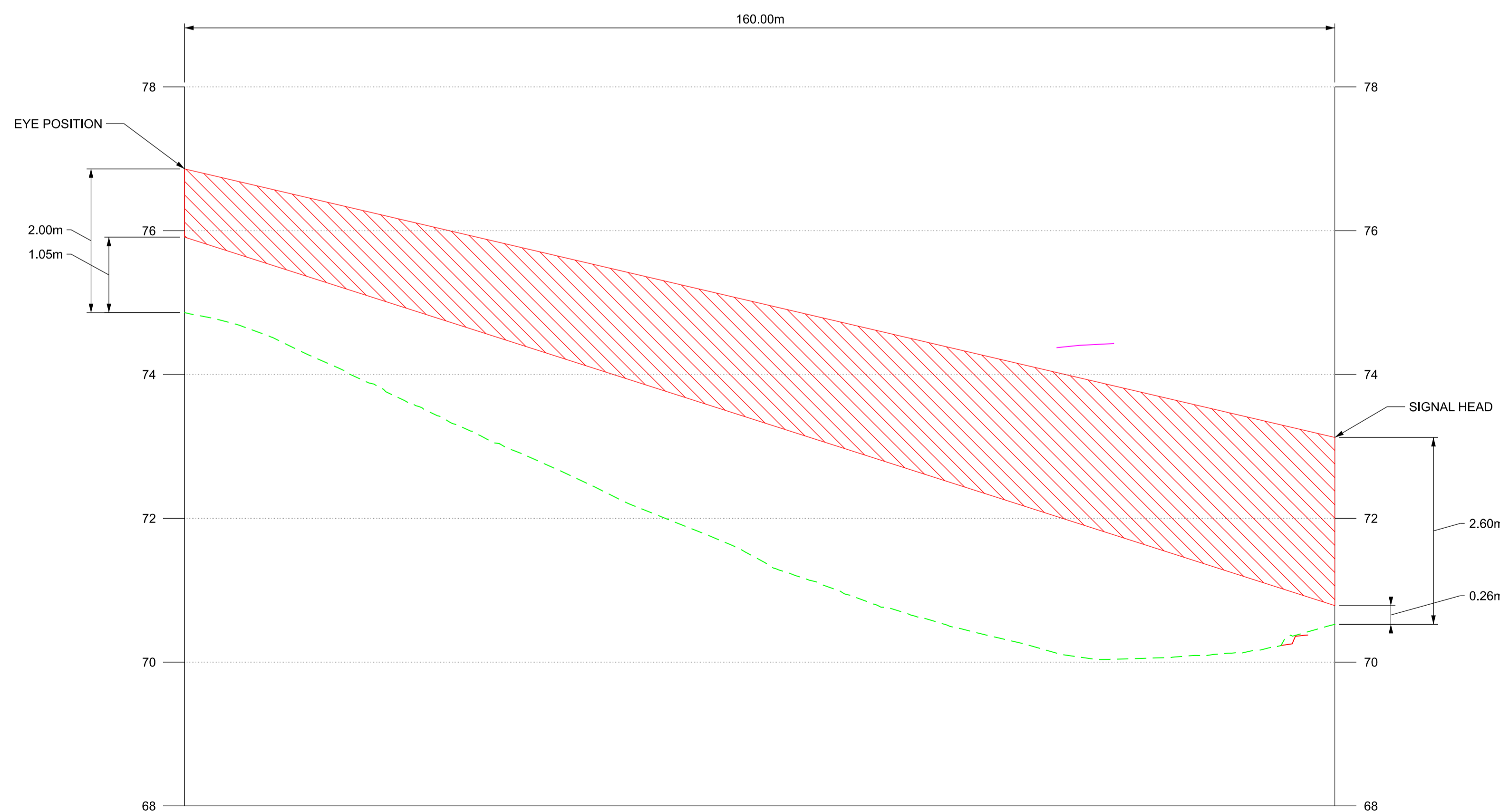

VISIBILITY ENVELOPE ON SOUTH BOUND APPROACH TO SIGNAL HEAD 160.00m

KEY:

- VISIBILITY ENVELOPE
- - - EXISTING GROUND PROFILE
- PROPOSED FRL
- RUB SOFFIT

SCALE H - 1:100
V - 1:10
@ A1 SHEET SIZE

Rev	Date	Description of Revisions	Desd	Chkd	Appr
B01	11/06/20	FOR INFORMATION	N.T.	L.T.	G.J.

Status: SHARED - for Content Check | S1



Project
East West Rail (Western Section) Phase 2

Drawing Title
HAUL ROAD CROSSING HRC_3 SIGNAL HEADS VISIBILITY

Designed	Nagoth Thomas Ravi Kumar	Signed	N. T. R. Kumar	Date	11/06/20
Drawn	Ravikumar KN	Signed	R. KN	Date	11/11/19
Checked	Lisa Taylor	Signed	L. Taylor	Date	11/06/20
Approved	Gareth Johnston	Signed	G. Johnston	Date	11/06/20

Scale(s)
AS SHOWN | ELR - Project Chainage (Miles/Yards)
OXD -

Design Package Risk Classification
Normal

Alternative Reference
Sheet 1 of 2

Drawing Number
Revision B01

133735_2A-EWR-OXD-HRC_3-DR-CH-010011

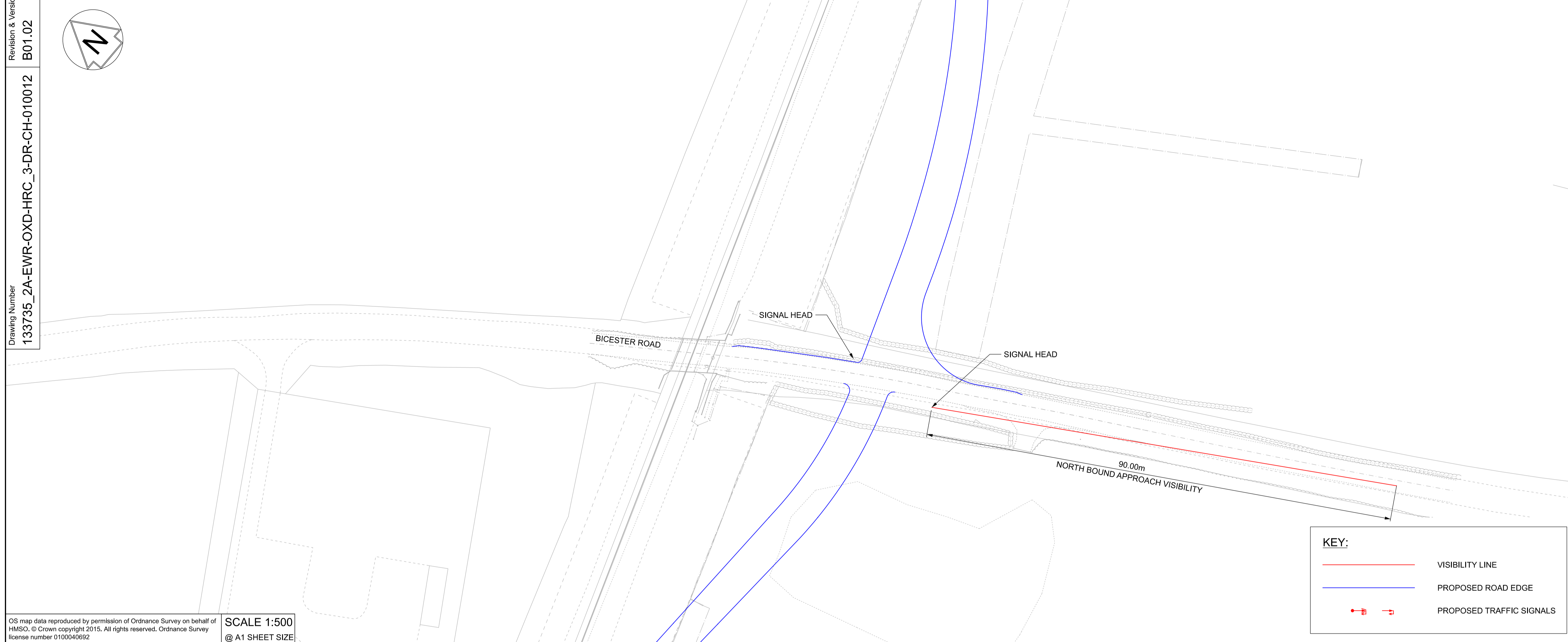
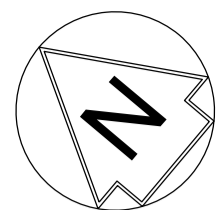

OS map data reproduced by permission of Ordnance Survey on behalf of HMSO. © Crown copyright 2015. All rights reserved. Ordnance Survey license number 0100040692
 SCALE 1:500
 @ A1 SHEET SIZE

- NETWORK RAIL (EAST WEST RAIL WESTERN SECTION PHASE 2)**
- NOTES:**
1. THIS DRAWING IS NOT TO BE SCALED.
 2. ALL DIMENSIONS ARE IN METRES (m) UNLESS SHOWN OTHERWISE.
 3. THIS DRAWING IS TO BE READ IN CONJUNCTION WITH THE HIGHWAY DESIGN PACKAGE OF DRAWINGS AND DOCUMENTS.
 4. THE VISIBILITY ENVELOPE DEVELOPED IS AS PER DMRB TD50.

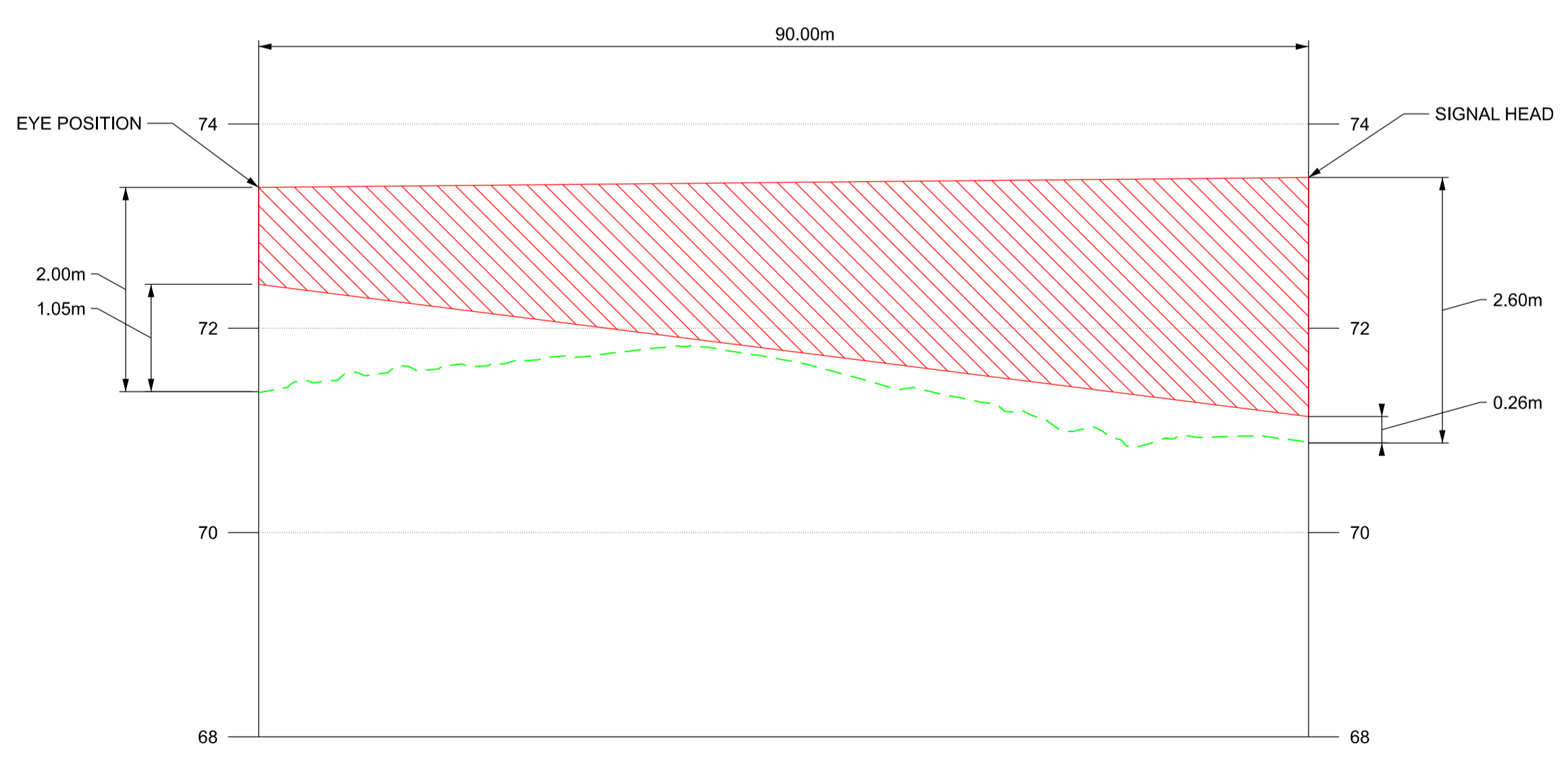

VISIBILITY ENVELOPE ON NORTH BOUND APPROACH TO SIGNAL HEAD 90.00m

SCALE H - 1:100
 V - 1:10
 @ A1 SHEET SIZE

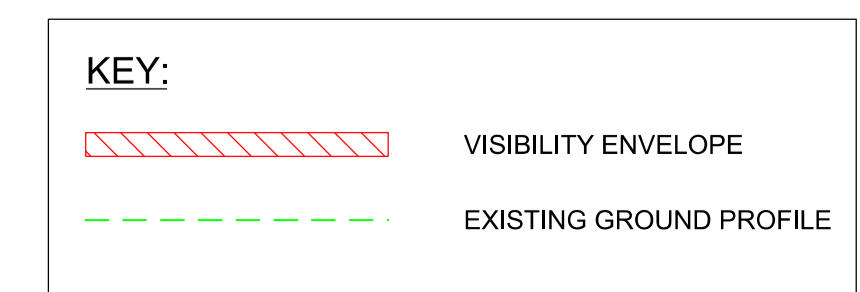

Rev	Date	Description of Revisions	Desd	Chkd	Appr	Suitability
B01	11/06/20	FOR INFORMATION		N.T.	L.T.	G.J.

SHARED - for Content Check S1

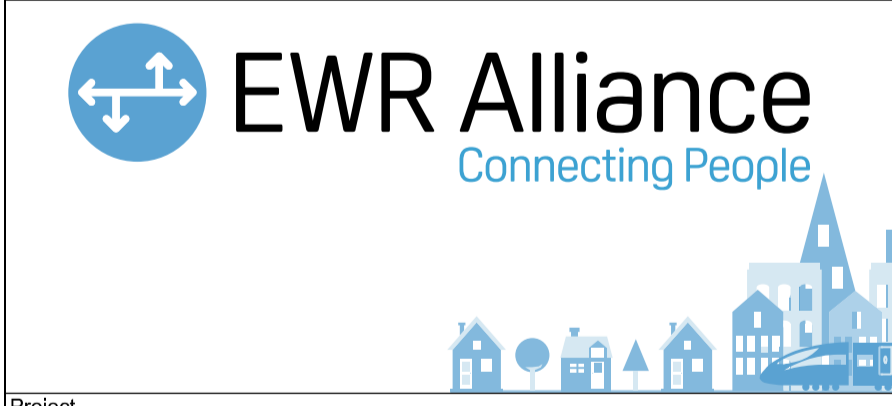

Project
East West Rail (Western Section) Phase 2

Drawing Title
HAUL ROAD CROSSING HRC_3 SIGNAL HEADS VISIBILITY

Designed	Nagoth Thomas Ravi Kumar	Signed	N. T. R. Kumar	Date	11/06/20
Drawn	Ravikumar KN	Signed	R. KN	Date	11/11/19
Checked	Lisa Taylor	Signed	L. Taylor	Date	11/06/20
Approved	Gareth Johnston	Signed	G. Johnston	Date	11/06/20

Scale(s)
 AS SHOWN OXD -

Design Package Risk Classification
 Normal

Alternative Reference
 B01

Drawing Number
 133735_2A-EWR-OXD-HRC_3-DR-CH-010012

Sheet
 2 of 2

NETWORK RAIL (EAST WEST
RAIL WESTERN SECTION PHASE 2)

- NOTES:
1. THIS DRAWING IS NOT TO BE SCALED.
 2. ALL DIMENSIONS ARE IN METRES (m) UNLESS SHOWN OTHERWISE.
 3. THIS DRAWING IS TO BE READ IN CONJUNCTION WITH THE HIGHWAY DESIGN PACKAGE OF DRAWINGS AND DOCUMENTS.
 4. THIS DRAWING IS TO BE READ IN CONJUNCTION WITH NOTES ON DRAWINGS No.S 133735_RW-EWR-XX-XX-DR-CH-000108 & 147.

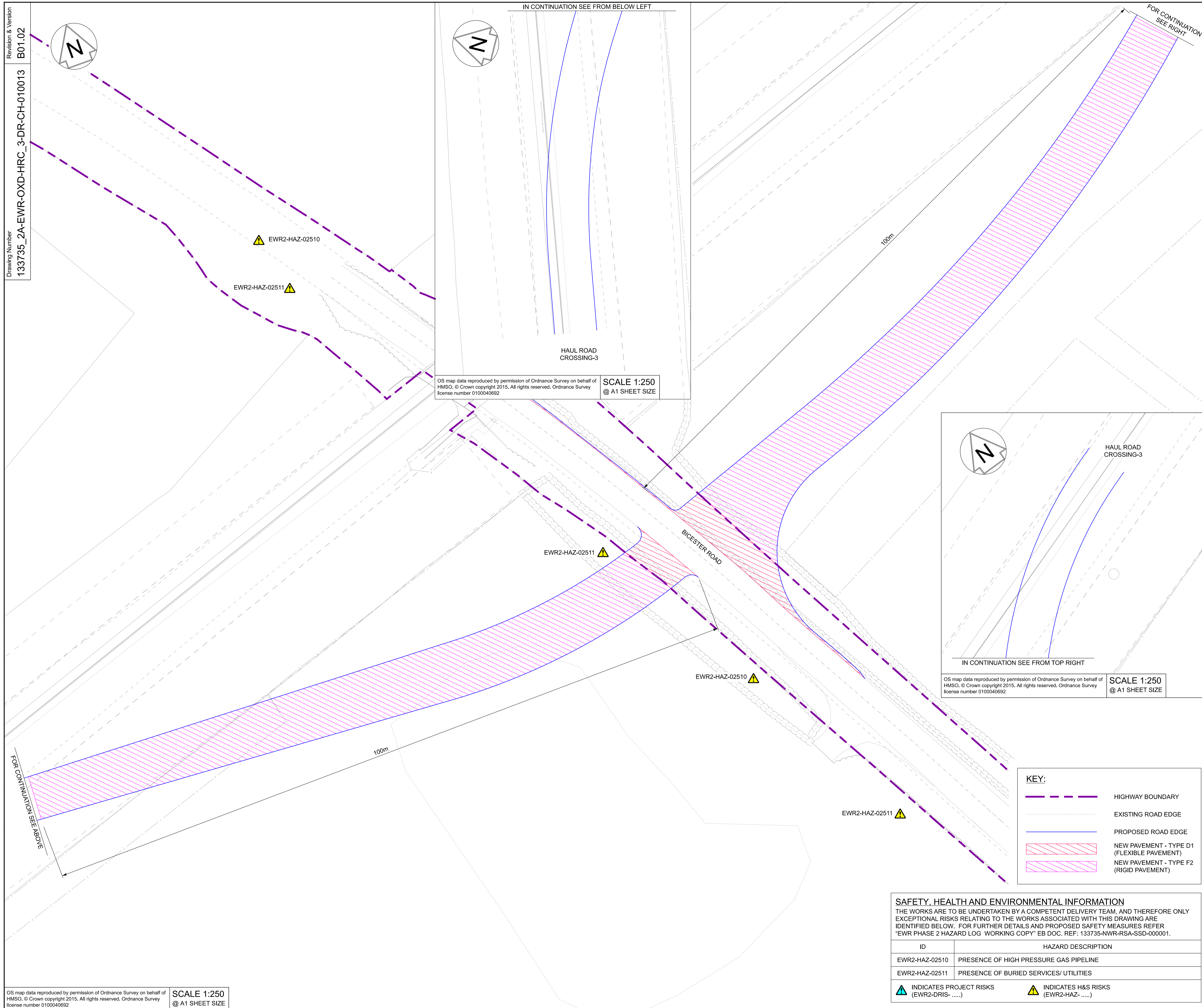

OS map data reproduced by permission of Ordnance Survey on behalf of HMSO. © Crown copyright 2015. All rights reserved. Ordnance Survey license number 0100040692
SCALE 1:250
@ A1 SHEET SIZE

OS map data reproduced by permission of Ordnance Survey on behalf of HMSO. © Crown copyright 2015. All rights reserved. Ordnance Survey license number 0100040692
SCALE 1:250
@ A1 SHEET SIZE

KEY:

	HIGHWAY BOUNDARY
	EXISTING ROAD EDGE
	PROPOSED ROAD EDGE
	NEW PAVEMENT - TYPE D1 (FLEXIBLE PAVEMENT)
	NEW PAVEMENT - TYPE F2 (RIGID PAVEMENT)

SAFETY, HEALTH AND ENVIRONMENTAL INFORMATION
THE WORKS ARE TO BE UNDERTAKEN BY A COMPETENT DELIVERY TEAM, AND THEREFORE ONLY EXCEPTIONAL RISKS RELATING TO THE WORKS ASSOCIATED WITH THIS DRAWING ARE IDENTIFIED BELOW. FOR FURTHER DETAILS AND PROPOSED SAFETY MEASURES REFER "EWR PHASE 2 HAZARD LOG WORKING COPY" EB DOC. REF: 133735-NWR-RSA-SSD-000001.

ID	HAZARD DESCRIPTION
EWR2-HAZ-02510	PRESENCE OF HIGH PRESSURE GAS PIPELINE
EWR2-HAZ-02511	PRESENCE OF BURIED SERVICES/ UTILITIES

INDICATES PROJECT RISKS (EWR2-DRIS-)
 INDICATES H&S RISKS (EWR2-HAZ-)

OS map data reproduced by permission of Ordnance Survey on behalf of HMSO. © Crown copyright 2015. All rights reserved. Ordnance Survey license number 0100040692
SCALE 1:250
@ A1 SHEET SIZE

Rev	Date	Description of Revisions	Desd	Chkd	Appr	Suitability
B01	11/06/20	FOR INFORMATION		N.T.	L.T.	G.J.

SHARED - for Content Check S1



Project
East West Rail (Western Section) Phase 2

Drawing Title
HAUL ROAD CROSSING HRC_3 PAVEMENT LAYOUT

Designed	Nagoth Thomas Ravi Kumar	Signed	N. T. R. Kumar	Date	11/06/20	
Drawn	Tamsin Leaman-Hewitt	Signed	T. Leaman-Hewitt	Date	22/01/20	
Checked	Lisa Taylor	Signed	L. Taylor	Date	11/06/20	
Approved	Gareth Johnston	Signed	G. Johnston	Date	11/06/20	
Scale(s)	1:250 ELR - Project Chainage (Miles/Yards)					
Design Package Risk Classification	OXD - Normal				Sheet	1 of 1
Alternative Reference					Revision	B01
Drawing Number	133735_2A-EWR-OXD-HRC_3-DR-CH-010013					