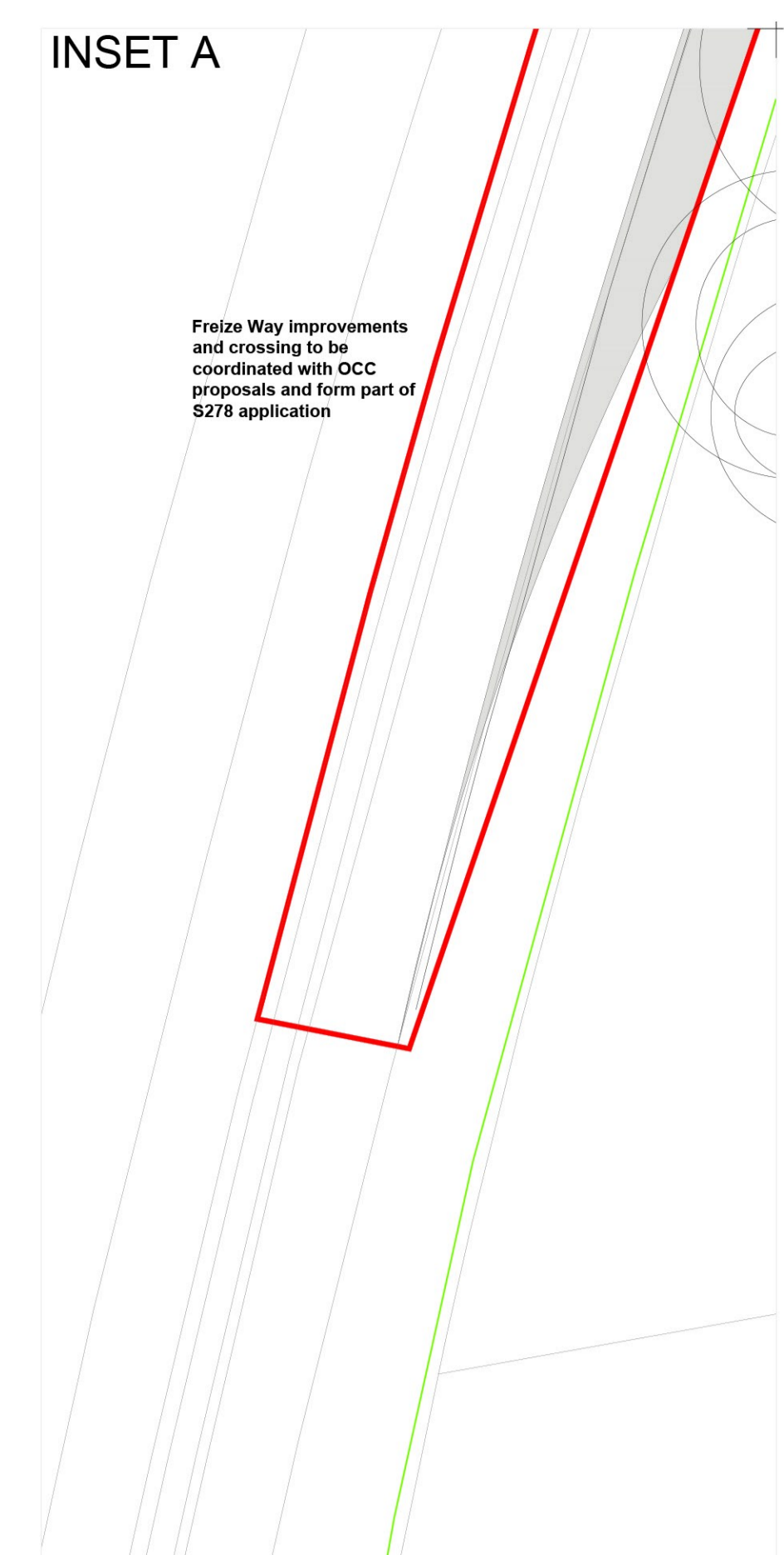
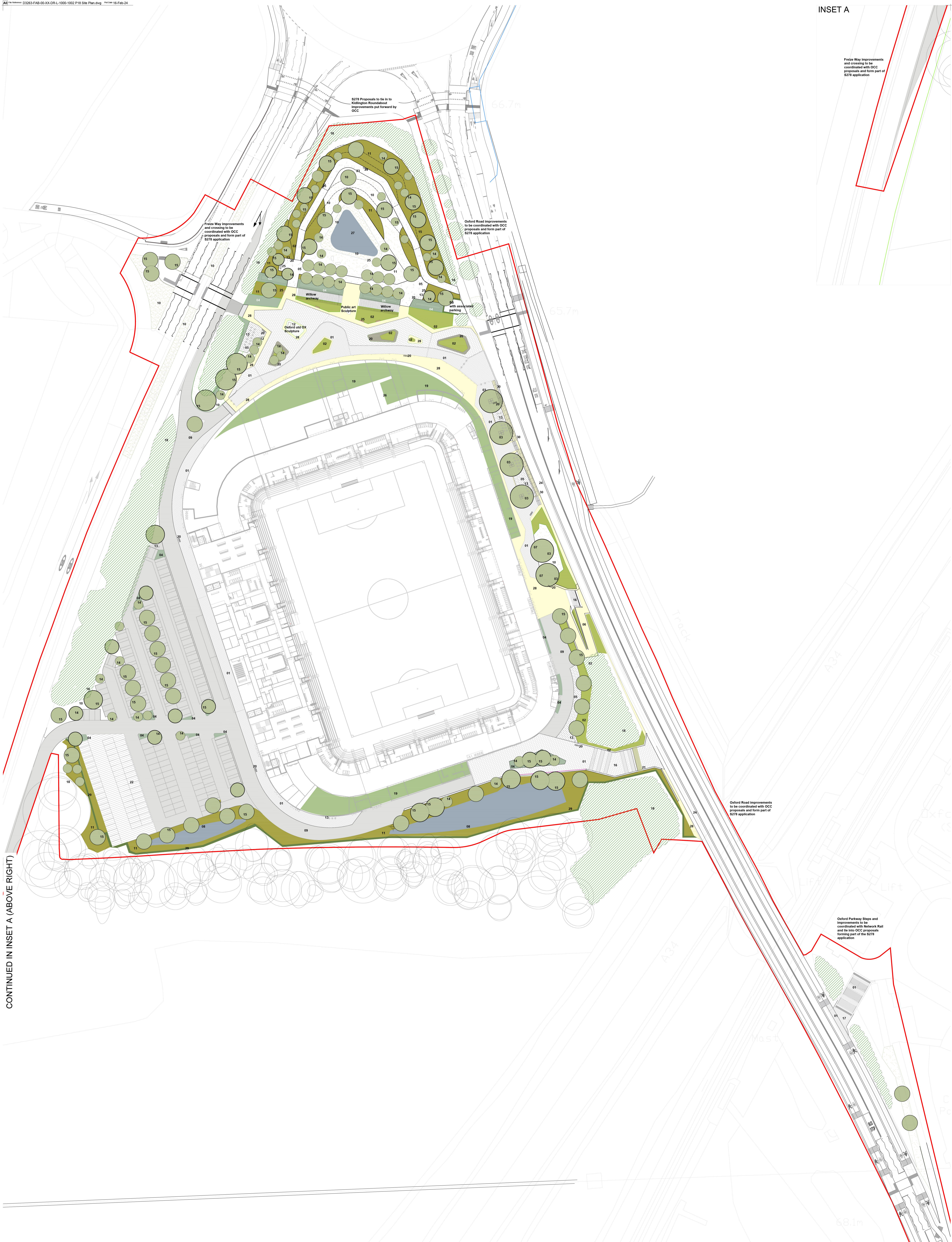

Figure 4.7 - Landscape Site Wide GA Plan



CONTINUED IN INSET A (ABOVE RIGHT)

BOUNDARY

Site Boundary	01
---------------	----

LEGEND

01	Concrete block paving
02	Planting beds (variety of typologies Inc suds)
03	Biodiverse trees
04	Rain-gardens (exact size to be confirmed with Engineers)
05	Hoggin compacted gravel
06	1.22 access router ramp (tarmac with fairfaced concrete wall edge)
07	Entrance feature trees crown raised to create green arch
08	Attenuation basins (to be confirmed with Engineers)
09	Tarmac
10	Wildflower planting, various typologies
11	Circle planting
12	Flowering lawn area within village plaza
13	Cycle rack (50 in total, providing 100 spaces on site)
14	Proposed tree planting (below extra heavy standard size 62 in total)
15	Proposed trees (30cm girth and above - 61 in total)
16	Stepped access (concrete, with hand rails and wall)
17	8m wide steps (as part of S278 to be confirmed with NR)

18	Existing vegetation retained
19	Biodiverse roof (location to be coordinated with Engineers Plant)
20	Double filter and recycling bins
21	The minor arch feature (to be coordinated with Architects)
22	Overflow area, with reinforced grasscrete vehicular outside surfacing
23	Earthworks mound with look out point
24	Combined cycleway (As part of S278 in coordination with OCC)
25	Biobase wall
26	Natural pond with terraces for increased planting opportunities (on deep in deepest part, with safety ropes provided)
27	Natural coloured reduced carbon concrete circle
28	(With nichings at key locations)
29	Native hedge with standard tree planting and eco-edge edge planting
30	Seating slip wall (boundary edge dealing with level change)
31	Substation location

NOTES:

- Section 278 proposals to be delivered in coordination with OCC and Network Rail as part of a separate planning application.
- Botanic/heritage locations and security measures to be confirmed with security consultant recommendations.
- Lighting design to be coordinated with Engineers.
- Public art strategy to be developed during the next phase to form part of the wayfinding strategy.
- No tree/ hedge planting within 3m of utilities without the use of a root protection system and to be fully coordinated to avoid clashes.

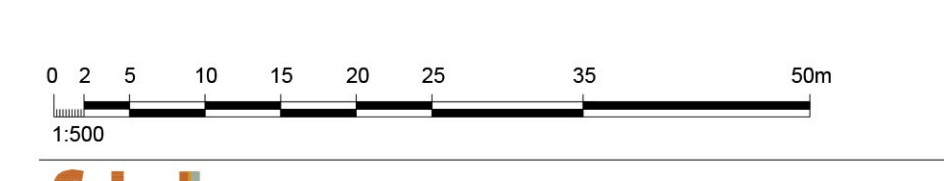

fabik landscape architects
 128th Street | 111 12th Street | New York | 10014-1945
 T: +1 212 693 1111 | E: info@fabik.com | www.fabik.com

Project: The Triangle, Oxford
 Client: Oxford UTDT
 Title: Landscape General Arrangement Plan
 Issue: 00
 Date: 15/08/2023
 Scale: 1:500 @ A0
 Author: sjs
 Checked: sg
 Date of issue: Aug | 2023

Project Number	Client	Date	Version	Scale	Author	Checked	Date of Issue
OUFUC	FAB	00	XX	DR	L	1001	P18