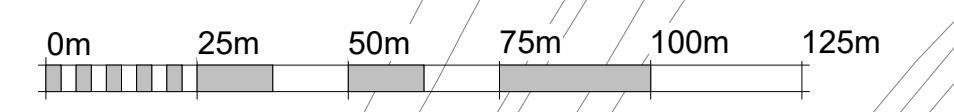
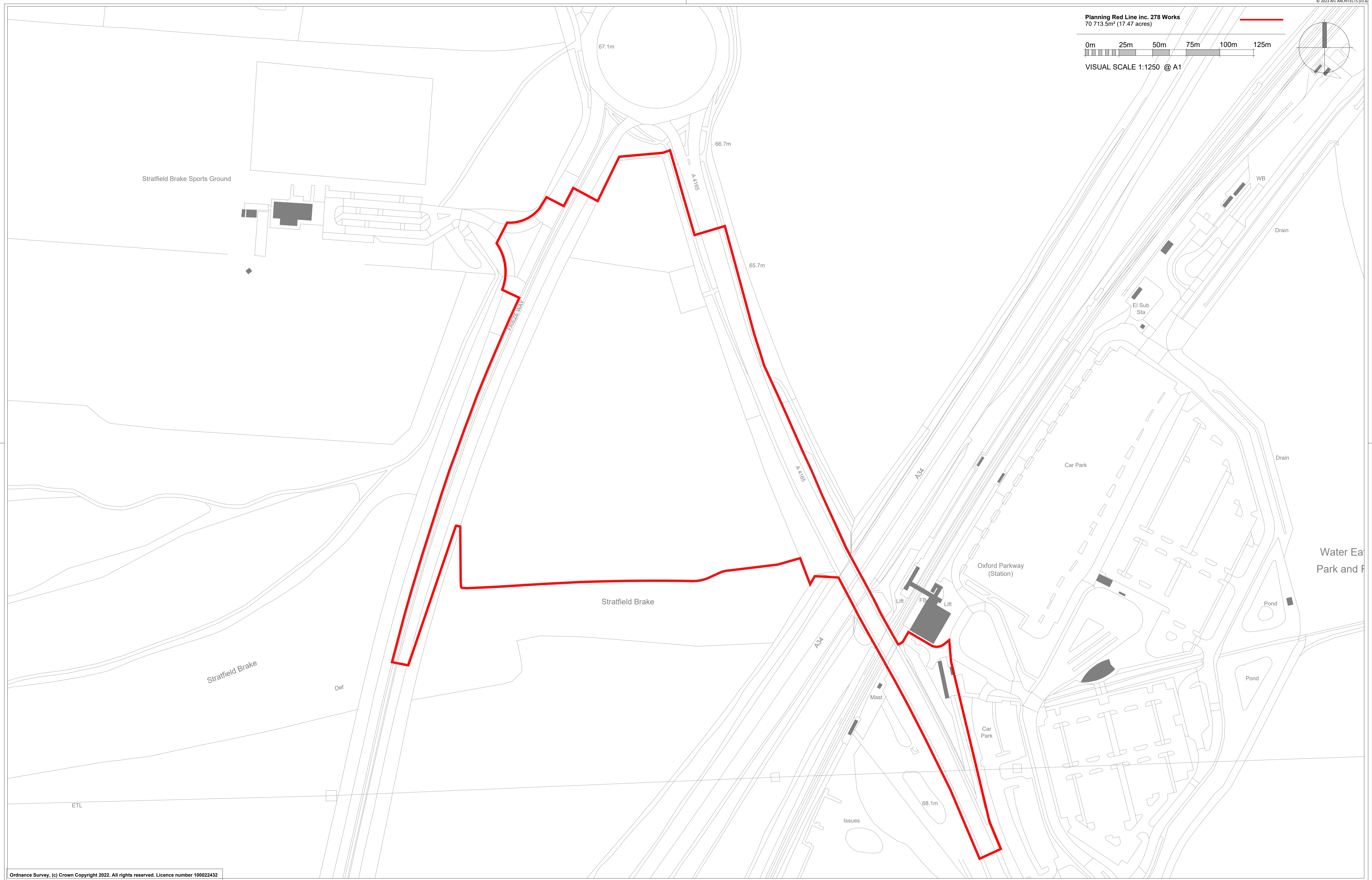
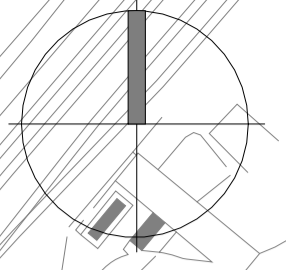

Figure 3.1 – Site Location Plan

Planning Red Line inc. 278 Works
70 713.5m² (17.47 acres)



VISUAL SCALE 1:1250 @ A1



Ordnance Survey, (c) Crown Copyright 2022. All rights reserved. Licence number 100022432

NOTES
All dimensions and levels to be checked on site
Any discrepancies are to be reported to the Architect before any work commences
This drawing shall not be scaled to ascertain any dimensions, work to figured dimensions only
This drawing shall not be reproduced without express written permission from AFL Architects Ltd.

DISCLAIMER
When this drawing is issued in CAD, it is an uncontrolled version issued for information only, to enable the recipient to prepare their own documents/drawings for which they are solely responsible.

SOFTWARE INTEROPERABILITY
AFL prepared this drawing using Autodesk REVIT Architecture.
AFL does not accept liability for any loss or degradation of any information held in the drawing resulting from the translation from the original file format to any other file format or from the recipient's reading of it in any other programme.

PO9	14/12/23	JA	Final Issue for Planning
rev no.	rev date	rev by	description

client	Oxford United Football Club
AFL Architects	1st Floor, St Georges House 56 Peter Street, Manchester UK M2 3NQ
t: +44(0)161 236 6263	w: www.afl-architects.com
f: +44(0)161 236 6484	e: mail@afl-uk.com
	twitter.com/AFLArchitects



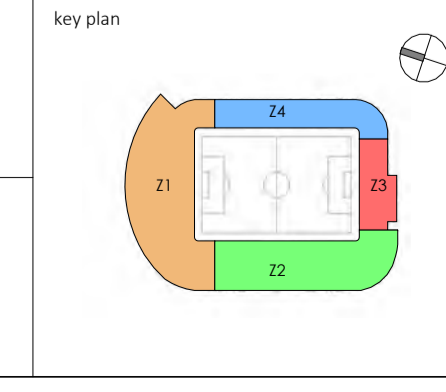

project
Oxford United Football Club

location
Oxford

drawing title
Site Location Plan

AFL job number	scale @ A1	drawn JN	checked MR
221524	1 : 1250	rev date	14/12/23
dwg purpose	status	rev	
PLANNING	S2	P09	
bim project	origin	zone	level
O UFC-AFL-ZZ-00-DR-A-000001			