

- Dimensions are in millimeters, unless stated otherwise.
 - Scaling of this drawing is not recommended.
 - It is the recipient's responsibility to print this document to the correct scale.
 - All relevant drawings and specifications should be read in conjunction with this drawing.

Note:
 Refer to separate specialist consultant drawings and information for scope of services related works.
 Refer to Civil Engineer's drawings & information for scope of external works, drainage & levels.

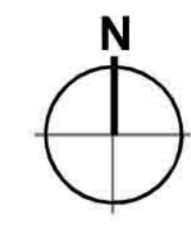

- 1) Full height over-clad façade. Existing glazing to warehouse will be replaced with translucent panels. Guarantee to be confirmed. Engineer to assess the capacity of existing structure.
- 2) Existing offices to be refurbished.
- 3) External cat ladder to be replaced (roof access strategy to be reviewed)
- 4) Existing loading doors & dock levellers to be removed & replaced.
- 5) Existing canopy to be over-clad & made good
- 6) External concrete hardstanding to be extended. Existing landscape bund to be repositioned.
- 7) External yard to be reinstated as concrete.
- 8) Existing wheel guides to be retained and repainted.
- 9) Existing vehicle wash and housing to be removed. Adjacent landscaping to be removed and replaced with hardstanding, to suit Civil Engineer's details.
- 10) Gatehouse island only to be installed. Services to gatehouse to be reviewed.
- 11) Remove existing landscape and replace with hardstanding to 3 no. new level access doors.
- 12) Existing internal slab to be made good.
- 13) Existing windows to the pod to be removed and over-clad, with new windows added.
- 14) Extend hard surfacing and alter levels to create car park area.
- 15) Amend vehicular & pedestrian route configurations.
- 16) Option for white masonry paint to internal blockwork walls.
- 17) Roof to be assessed to receive watertight membrane over entirety.
- 18) Substation to be demolished with services capped & new services provided as per specialist consultant drawings & information.
- 19) Sprinkler tank and pump house to be installed if required.
- 20) New offices to be installed at first floor, with ground floor core.
- 21) Existing dock levellers to be removed and over clad, external levels adjusted to suit new car park, including new ramp to entrance.
- 22) All existing personnel escape doors to be replaced with Hörmann steel personnel escape doors with single hand escape ironmongery. Panels to be removed & replaced with insulated steel panels, to be over-clad.
- 23) Battered landscaped slope.
- 24) 7 no. cycle shelters and 1 no. smoking shelter added.
- 25) 2 no. electric charging points to be installed to serve 4 no. spaces. Allow for ducting for additional 4 no. charging points to serve an additional 8 no. spaces

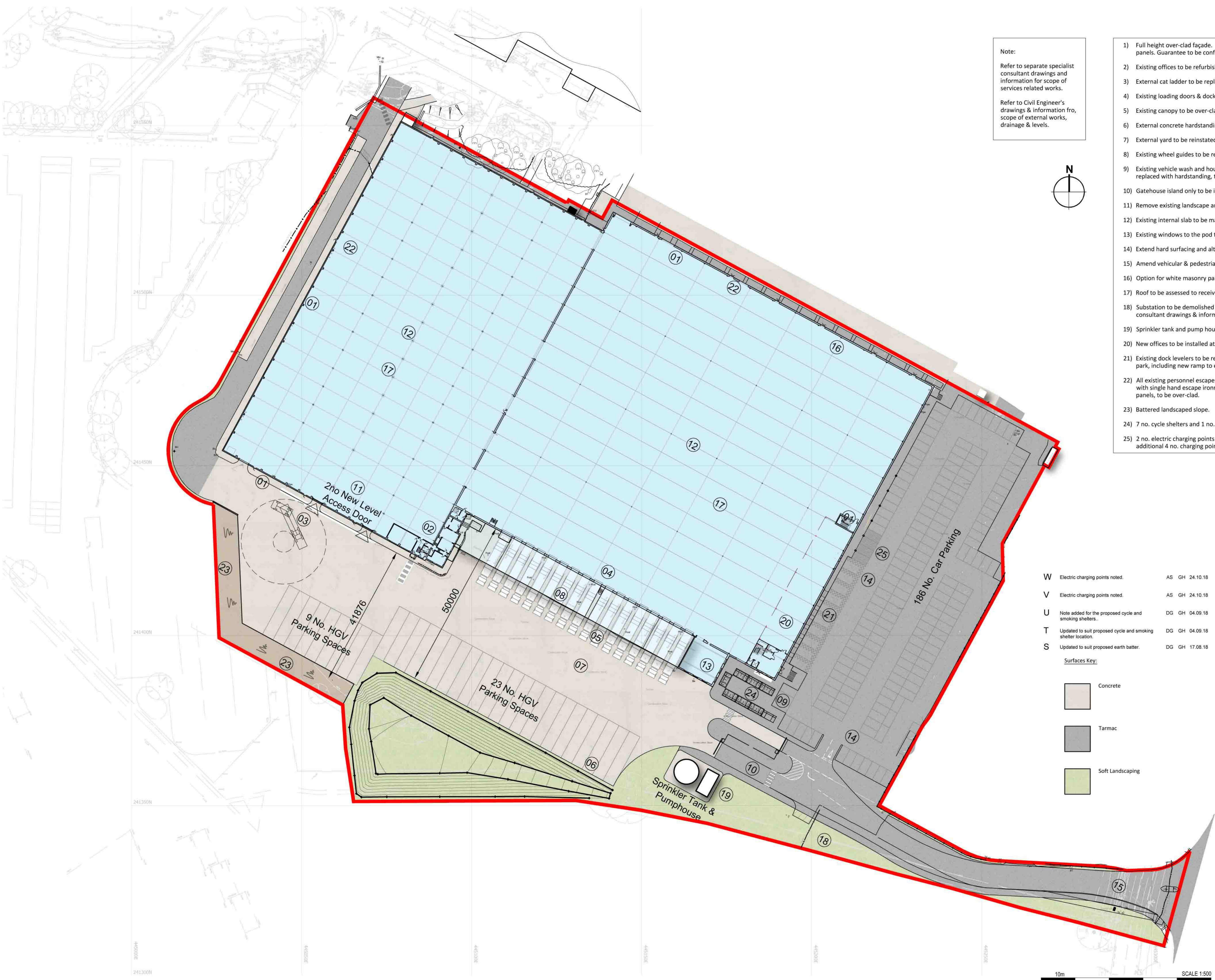

W	Electric charging points noted.	AS	GH	24.10.18
V	Electric charging points noted.	AS	GH	24.10.18
U	Note added for the proposed cycle and smoking shelters.	DG	GH	04.09.18
T	Updated to suit proposed cycle and smoking shelter location.	DG	GH	04.09.18
S	Updated to suit proposed earth batter.	DG	GH	17.08.18

Surfaces Key:

	Concrete
	Tarmac
	Soft Landscaping

R	Windows to transport office updated.	DG	GH	25.07.18
Q	Ground floor offices updated and key amended.	KF	GH	11.07.18
P	Entrance ramp and stairs added to site plan to suit latest level information. Car parking amended to suit.	KF	GH	10.07.18
N	Gabion Basket retaining wall updated. HGV parking amended to suit. Positioning of proposed level access doors also updated.	KF	GH	05.07.18
M	Car parking total updated	GM	GH	02.07.18
L	Car parking updated	GM	GH	29.06.18
K	Landscaping area added and positioning of accessible parking bays amended.	KF	GH	28.06.18
J	Hatching reinstated.	KF	GH	27.06.18
H	Offices added.	DG	GH	26.06.18
G	Pedestrian access crossing added to top of Southam Road access	GM	GH	25.06.18
F	Amended to suit decisions from site visit 22.05.18 & subsequent correspondence.	DG	GH	18.06.18
E	Entrance hatching clarified.	DG	GH	26.03.18
D	Yard area changed to concrete.	DG	GH	02.03.18
C	SW red line boundary amended. Parking and yard updated to suit.	AS	GH	22.02.18
B	Revised road, footway added as required and HGV parking spaces updated to suit.	DG	GH	12.02.18
A	Proposed surfacing types amended to allow consistency.	DG	GH	30/01/18

rev | amendments | by | ckd | date

**Banbury 200 Unit,
 Southam Road, Banbury**
 Proposed Site Plan



Newark Beacon Innovation Centre, Calferton Way, Newark, Nottinghamshire NG24 2TN t +44 (0)1636 653027 f +44 (0)1636 653010 e info@umcarchitects.com	
Drawing Status:	Planning
Drawn / Checked:	DG / GH
Date:	13/10/17
Scale:	1:500 A1
Drawing no:	Revision:
16083 P003	W