

- X - Dead, replace
- M - Missing, replace
- R - Poor/dying, replace
- ⊙ - Replace into new location
- L - Leaning, straighten and re-stake

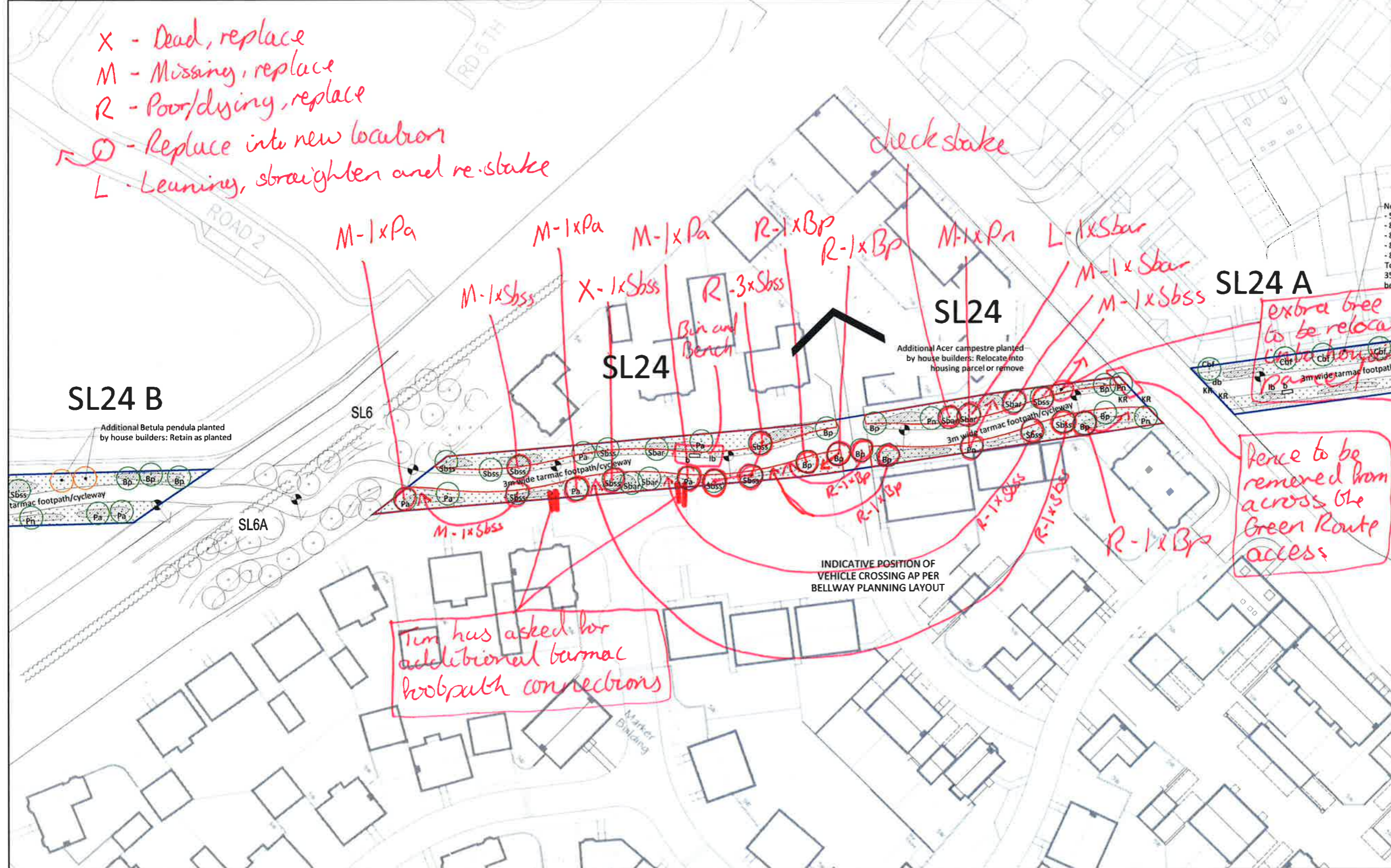

- KEY**
- Adoption Boundary
 - Strategic Landscape Area
 - Long Grass
 - Mown Grass
 - Bulb Planting
Bluebell, Wild Daffodils, Snowdrops,
planted equal amounts at 14 bulbs/m²
Supplier: www.reallywildflowers.co.uk
 - Woodscape timber bollard
 - Iroka traditional arched bench
with flat arms
 - Iroka Woolbrook Litter Bin
 - Broxap Dog K-Nine mounted dog waste
bin ref BX45 2580 PM
 - 600 high knee rail staggered to protect
pedestrian to road
- TREES**
- Trees located as per approved
planning drawing
 - Lighting columns with 5m offset

Notes

- Drawing based on David Fountain Designs Ltd. drawing DFD/BIC/L17 Rev L Landscaping details to green route SL24, SL24A, SL24B dated 12th May 2014

Drawing Revision

A	27/02/19	Revised to show proposed re-location for tree replacements and omit vehicular crossing from adoption area
---	----------	---

ISSUED FOR INFORMATION

DAVID JARVIS ASSOCIATES

DAVID JARVIS ASSOCIATES LIMITED
1 Fenny Stratford Street, Sandhills, Milton Keynes MK11 1JF
Tel: 01908 512175
Email: david.jarvis@jarvis.co.uk
www.jarvisassociates.co.uk

Client
COUNTRYSIDE PROPERTIES (UK) LTD.

Project
KINGSMERE, BICESTER

Drawing Title
GREEN ROUTE SL24 - ADOPTION AREA

Scale	Sheet Size	Date
1:500	A2	FEB 2019
Drawing No.	Revision	
2226/040	A	

- Replacements**
- Betula pendula - 5
 - Pinus nigra 'Maritima' - 1
 - Prunus avium - 3
 - Sorbus aria - 1
 - Sorbus aucuparia 'Sheerwater Seedling' - 9
- To be cut** - 19

Tree and Hedge Specification as per drawing DFD/BIC/L17

Code	Species	Specification
Bp	Betula pendula	Girth 14-16cm BR
Cbf	Carpinus betulus 'Fastigiata'	Girth 14-16cm
Fgs	Fagus sylvatica	Height 100-120cm BR
Pn	Pinus nigra 'Maritima'	Container 75L
Pa	Prunus avium	Girth 14-16cm BR
Qp	Quercus petraea	Girth 18-20cm RB
Sbar	Sorbus aria	Girth 14-16cm BR
Sbss	Sorbus aucuparia 'Sheerwater Seedling'	Girth 14-16cm RB

Tree codes
B = Bare root, C = Container Grown, RB = Root Balled



Woodscape timber bollard



Iroka traditional arched bench with flat arms



Iroka Woolbrook Litter Bin



Broxap Dog K-Nine mounted dog waste bin ref BX45 2580 PM

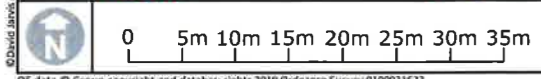

SL24 - DJA - 01/03/2019