

**PUBLIC RIGHTS\_OF\_WAY**

**STATUS**

- Public Footpath
- Public Bridleway
- Restricted Byway
- Byway Open to all Traffic
- SWIFT\_RECORDS
- PROTECTED\_AND\_NOTABLE\_SPECIES
- PROTECTED\_SPECIES\_BUFFER
- ROAD\_VERGE\_NATURE\_RESERVES
- EIL\_TEXT
- ASSETS\_OF\_COMMUNITY\_VALUE

- Area TPOs
- Group TPOs
- TPO Trees
- Woodland TPOs

**LISTED BUILDINGS**

**GRADE**

- I
- II\*
- II
- DL
- CURTLAGE LISTING
- LOCALLY\_LISTED\_BUILDINGS
- ARTICLE\_4
- ARCHAEOLOGICAL\_CONSTRAINT\_PRIORITY\_AREAS
- SCHEDULED\_ANCIENT\_MONUMENT
- EIL\_REGIONS
- PONDS\_MAPPING (INCLUDING GREAT CRESTED NEWTS)
- NERC ACT S41 Habitats (Previously UKBAP PRIORITY HABITATS)
- REGISTERED\_COMMON\_LAND
- SPECIAL\_SITES\_OF\_SCIENTIFIC\_INTEREST
- SPECIAL\_AREAS\_OF\_CONSERVATION
- ANCIENT\_WOODLAND
- CONSERVATION\_AREAS
- DISTRICT\_WILDLIFE\_SITES
- LOCAL\_WILDLIFE\_SITES
- PROPOSED\_NEW\_LWS\_AND\_EXTENSIONS\_LWS
- LOCAL\_NATURE\_RESERVE
- PARKS\_AND\_GARDENS
- AREAS\_OF\_OUTSTANDING\_NATURAL\_BEAUTY
- RAILWAY\_TUNNEL
- HIGH\_PRESSURE\_GAS\_PIPELINES
- LGS\_POINTS

**LGS\_POLYGONS**

**POTENTIALLY CONTAMINATED LAND**

**Buffer Distance**

- 0
- 50

**EA LANDFILL\_SITES**

**Buffer Distance**

- 0
- 250

**HISTORIC\_LANDFILL\_SITES\_10K**

**BANK\_TOP\_WIDTH\_PLANNING**

**CRT\_HOUSEHOLD\_AND\_MINOR\_SCALE\_DEVELOPMENTS**

**CRT\_EIA\_AND\_MAJOR\_SCALE\_DEVELOPMENTS**

**Flood Zone 3**

**Flood Zone 2**

**NAT\_FSA**

**NAT\_DEFENCES**

**NAT\_AREAS\_BENEFIT**

**NAT\_CENTRELINES**

**HS2 SAFEGUARDING\_ZONES**

**Type**

- Safeguarding Limits
- Sub-Surface
- Surface

**NATURALLY\_ELEVATED\_ARSENIC**

**GREEN BELT**

**CONSERVATION\_TARGET\_AREAS**

**MINERAL\_CONSULTATION\_AREAS**

**MINERAL\_CONSULTATION\_REGION**

**Neighbourhood Development Plans**

**Details**

- Neighbourhood Plan Area
- Important Amenity Green Spaces
- Local Green Spaces
- NATIONAL\_GRID\_REFERENCE
- WARDS
- PARISHES

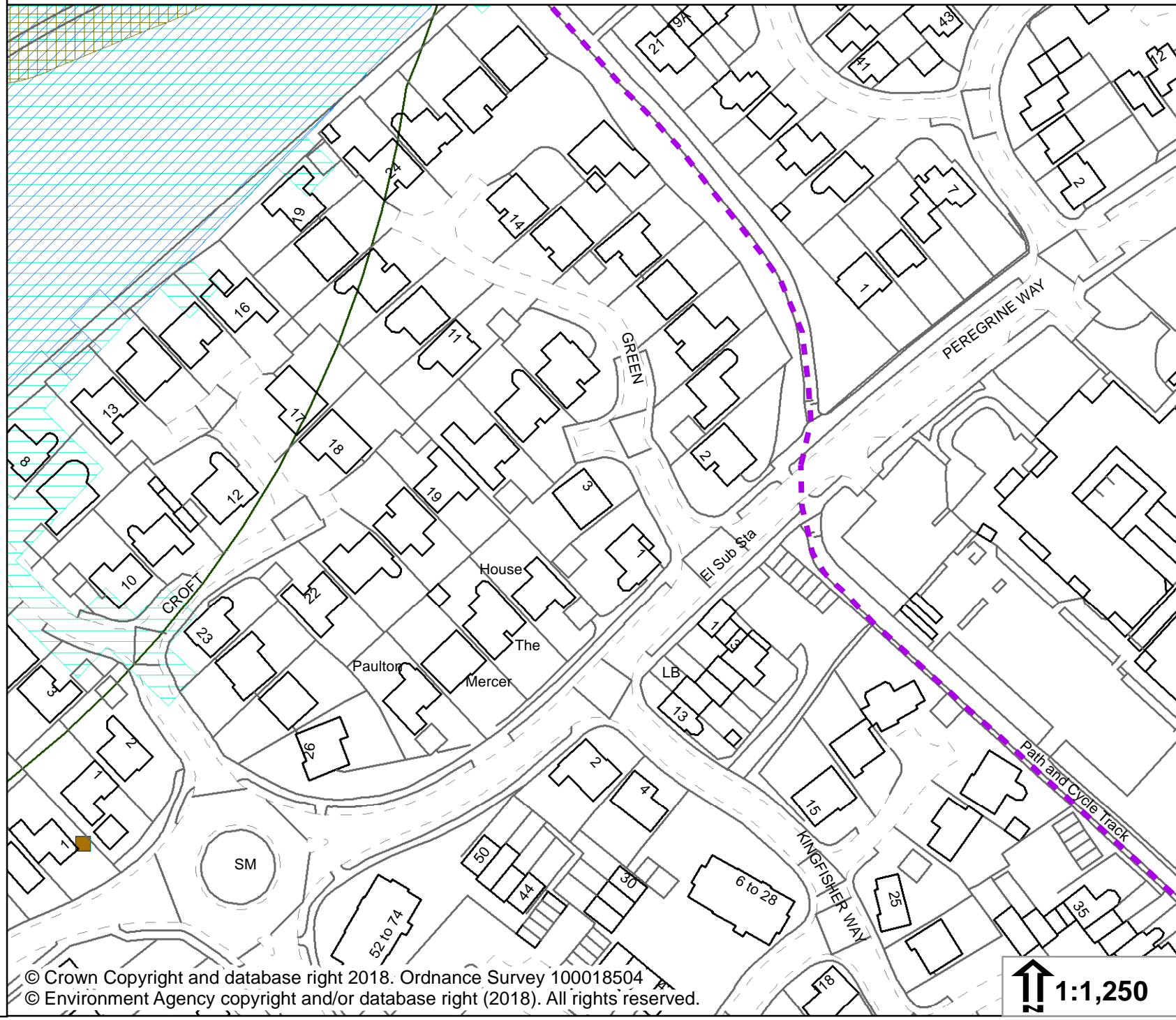

© Crown Copyright and database right 2018. Ordnance Survey 100018504  
© Environment Agency copyright and/or database right (2018). All rights reserved.

↑ 1:1,250