

- Dimensions are in millimeters, unless stated otherwise.  
 - Scaling of this drawing is not recommended.  
 - It is the recipient's responsibility to print this document to the correct scale.  
 - All relevant drawings and specifications should be read in conjunction with this drawing.

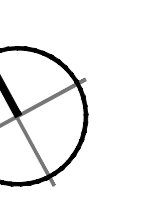

**Note:**  
 - Refer to existing elevations for all existing colours & elevational finishes.

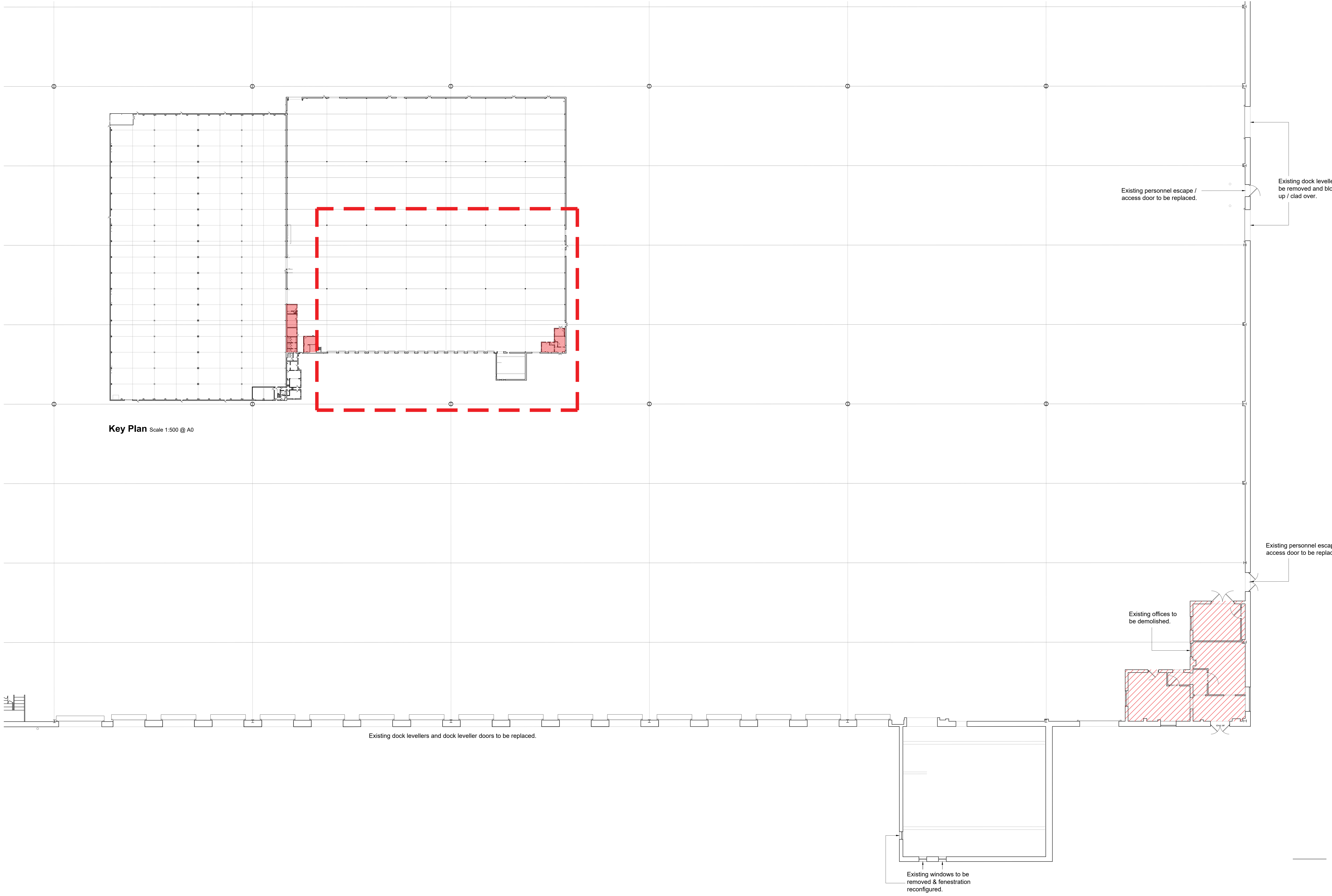

**Key Plan** Scale 1:500 @ A0

Existing dock levellers and dock leveller doors to be replaced.

Existing personnel escape / access door to be replaced.

Existing dock levellers to be removed and blocked up / clad over.

Existing personnel escape / access door to be replaced.

Existing offices to be demolished.

Existing windows to be removed & fenestration reconfigured.

|     |               |    |     |          |
|-----|---------------|----|-----|----------|
| A   | Initial Issue | DG | GH  | 23.07.18 |
| rev | amendments    | by | ckd | date     |

**Banbury 200 Unit,**  
 Southam Road, Banbury  
 Existing Floor Plan (4 of 4)



Newark, Essex Innovation Centre, Calfertis Way, Newark, Nottinghamshire NG24 2TN  
 +44 (0)1636 852027 T +44 (0)1636 852010 E info@umcarchitects.com

|                  |           |
|------------------|-----------|
| Drawing Status:  | Planning  |
| Drawn / Checked: | DG / GH   |
| Date:            | 23.07.18  |
| Scale:           | 1:100 A0  |
| Drawing no:      | Revision: |
| 16083 P014       | A         |



**Existing Ground Floor Plan (4 of 4)** Scale 1:100 @ A0