

Revisions :	Date :	By :
Revision A - Apartment parking and refuse / recycling indicated and boundary treatment shown.	02.11.17	SP
Revision B - Lockable bollards for residential units shown	07.11.17	SP
Revision C - Cycle parking for residential units shown	04.02.18	SP

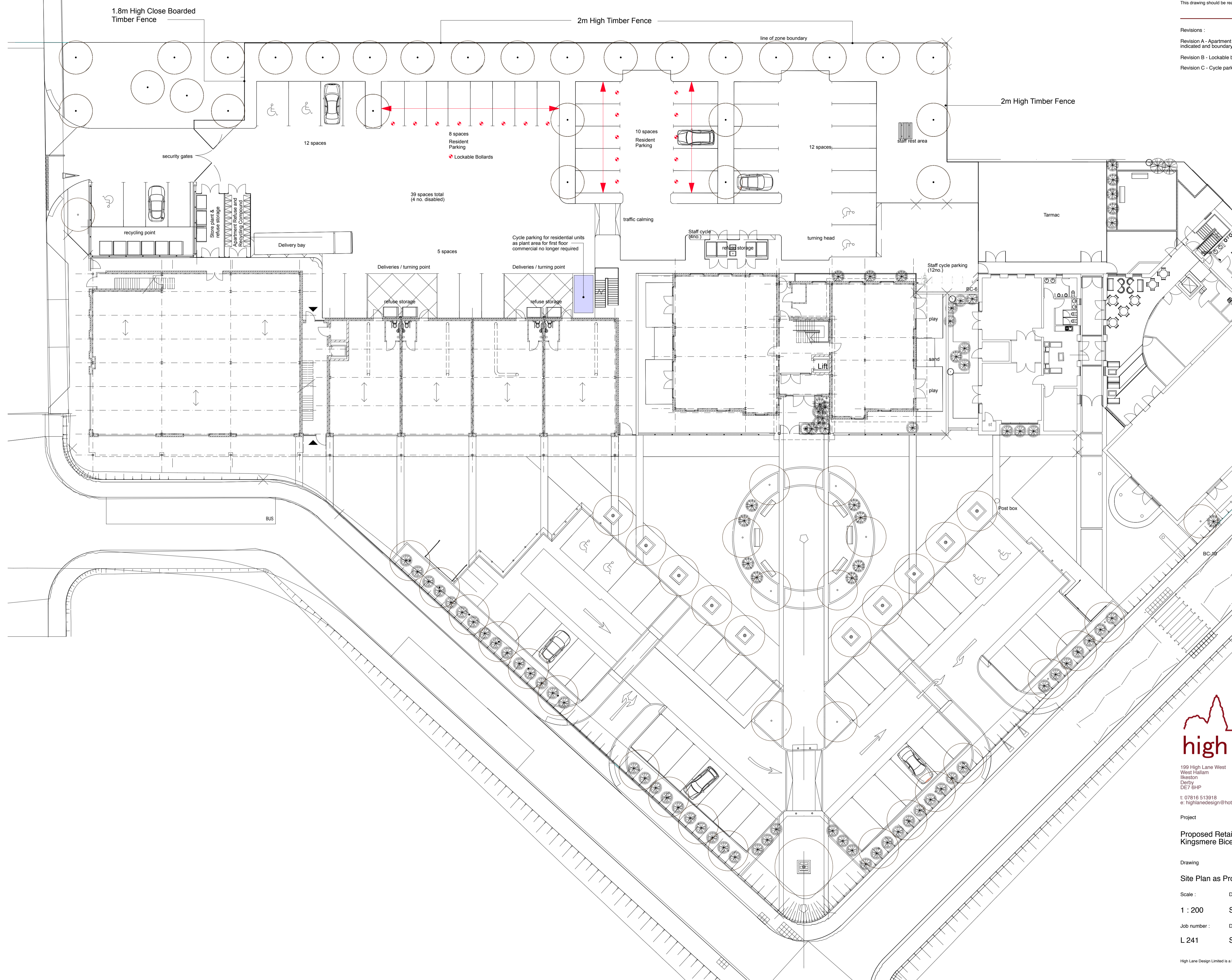

199 High Lane West
 West Hallam
 Ilkeston
 Derby
 DE7 6HP
 t: 07816 513918
 e: highlanedesign@hotmail.com

Project
**Proposed Retail Development
 Kingsmere Bicester**

Drawing
Site Plan as Proposed

Scale :	Date :	Drawn by :	Checked by :
1 : 200	Sept'17	SP	
Job number :	Drawing number :	Revision:	
L 241	SP01	C	