

- KEY TO LAYOUT**
- WALLS**
- FORTERRA KIMBOLTON RED MULTI BRICK
 - ANCASTER LIMESTONE
- ROOF**
- SLATE TYPE
- ADDITIONAL FEATURES**
- CHIMNEYS
 - ALL RAINWATER GOODS TO BE BLACK WITH HALF ROUND GUTTERS AND ROUND DOWNPIPES
 - ALL WINDOWS, REAR DOORS, GARAGE DOORS, FASCIAS, SOFFITS AND BARGEBOARDS TO BE WHITE UPVC.
 - PLOT 2 BARGEBOARDS AND FASCIAS TO BE BLACK UPVC.
 - ⊕ COTTAGE STYLE WINDOWS
 - ALL GARAGE DOORS TO BE BLACK
- ENTRANCE DOOR**
- ▲ BLACK UPVC
 - ▲ GREEN UPVC
 - ▲ RED UPVC

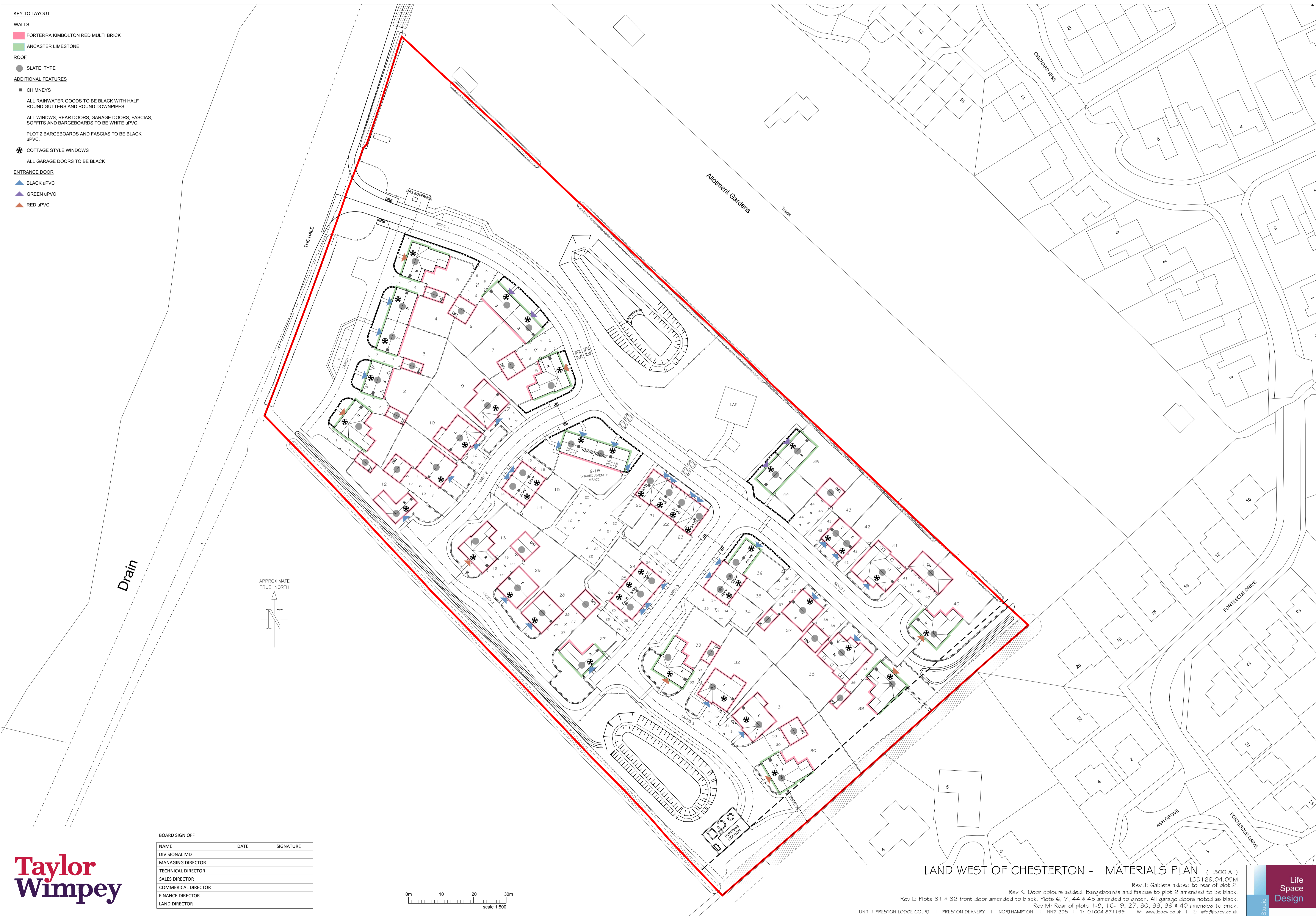

BOARD SIGN OFF

NAME	DATE	SIGNATURE
DIVISIONAL MD		
MANAGING DIRECTOR		
TECHNICAL DIRECTOR		
SALES DIRECTOR		
COMMERCIAL DIRECTOR		
FINANCE DIRECTOR		
LAND DIRECTOR		

Taylor Wimpey

LAND WEST OF CHESTERTON - MATERIALS PLAN (1:500 A1)

LSDI 29.04.05M
 Rev J: Gablets added to rear of plot 2.
 Rev K: Door colours added. Bargeboards and fascias to plot 2 amended to be black.
 Rev L: Plots 31 & 32 front door amended to black. Plots 6, 7, 44 & 45 amended to green. All garage doors noted as black.
 Rev M: Rear of plots 1-8, 16-19, 27, 30, 33, 39 & 40 amended to brick.
 UNIT | PRESTON LODGE COURT | PRESTON DEANERY | NORTHAMPTON | NN7 2DS | T: 01604 871199 | W: www.lsddev.co.uk | E: info@lsdev.co.uk

