

Figures

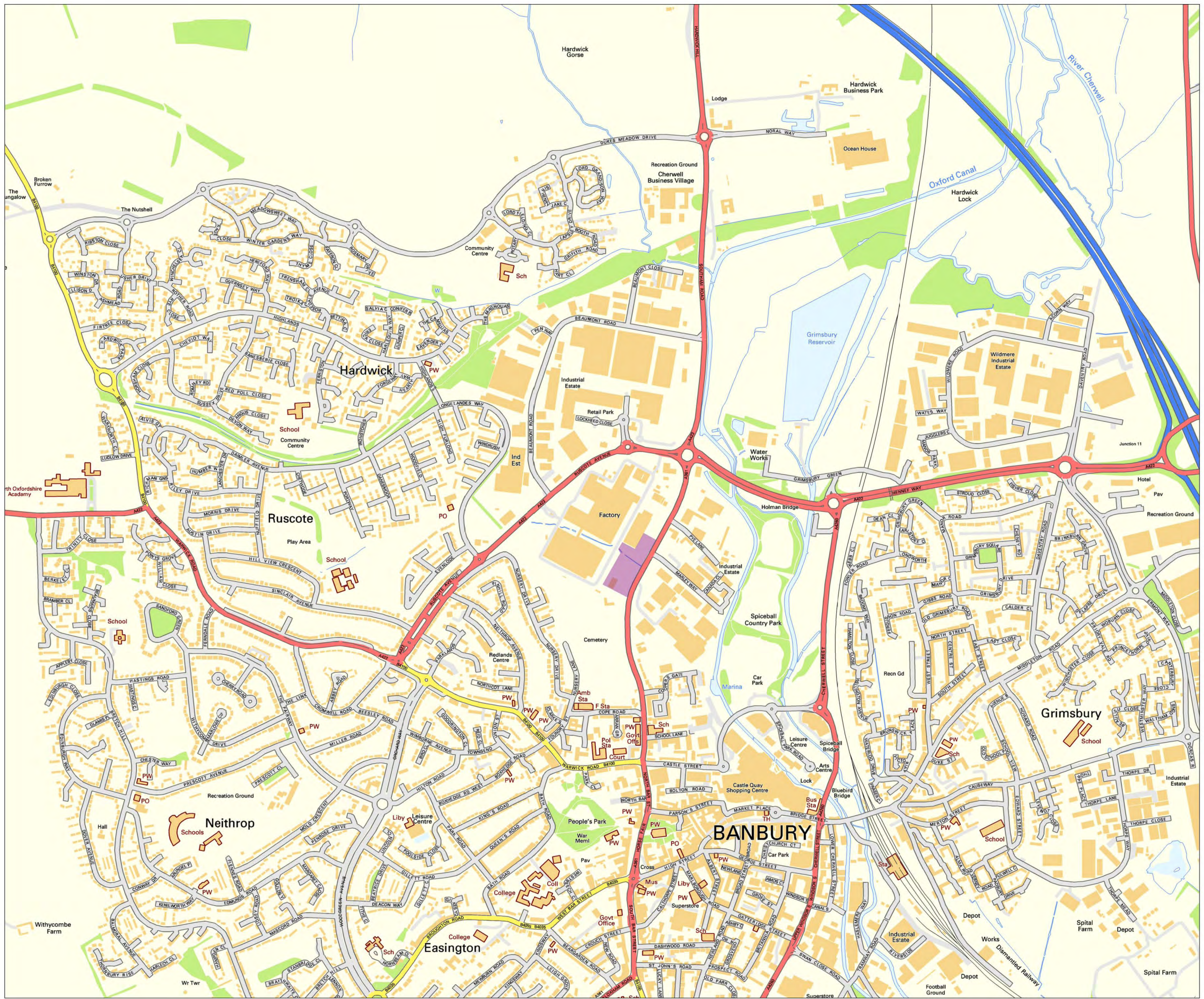

NOTE
 Reproduced from Ordnance Survey digital data with the permission of the Controller of Her Majesty's Stationery Office, Crown copyright (AL814229).



KEY
 Site location

Rev.	Description	Date	Chkd
------	-------------	------	------

 **Glanville**
 Cornerstone House
 62 Foxhall Road, Didcot
 Oxon, OX11 7AD
 Tel: (01235) 515550 Fax: (01235) 817799
 postbox@glanvillegroup.com www.glanvillegroup.com

Client : **Waitrose**

Project : **Waitrose Banbury**

Title : **Site Location Plan**

Project Engineer : T. Hart Scale : As Shown @ A3

Project Director : P. Whitehead Date : April 2017

Status :
 Drawing No. **Figure 1** Rev

1KM

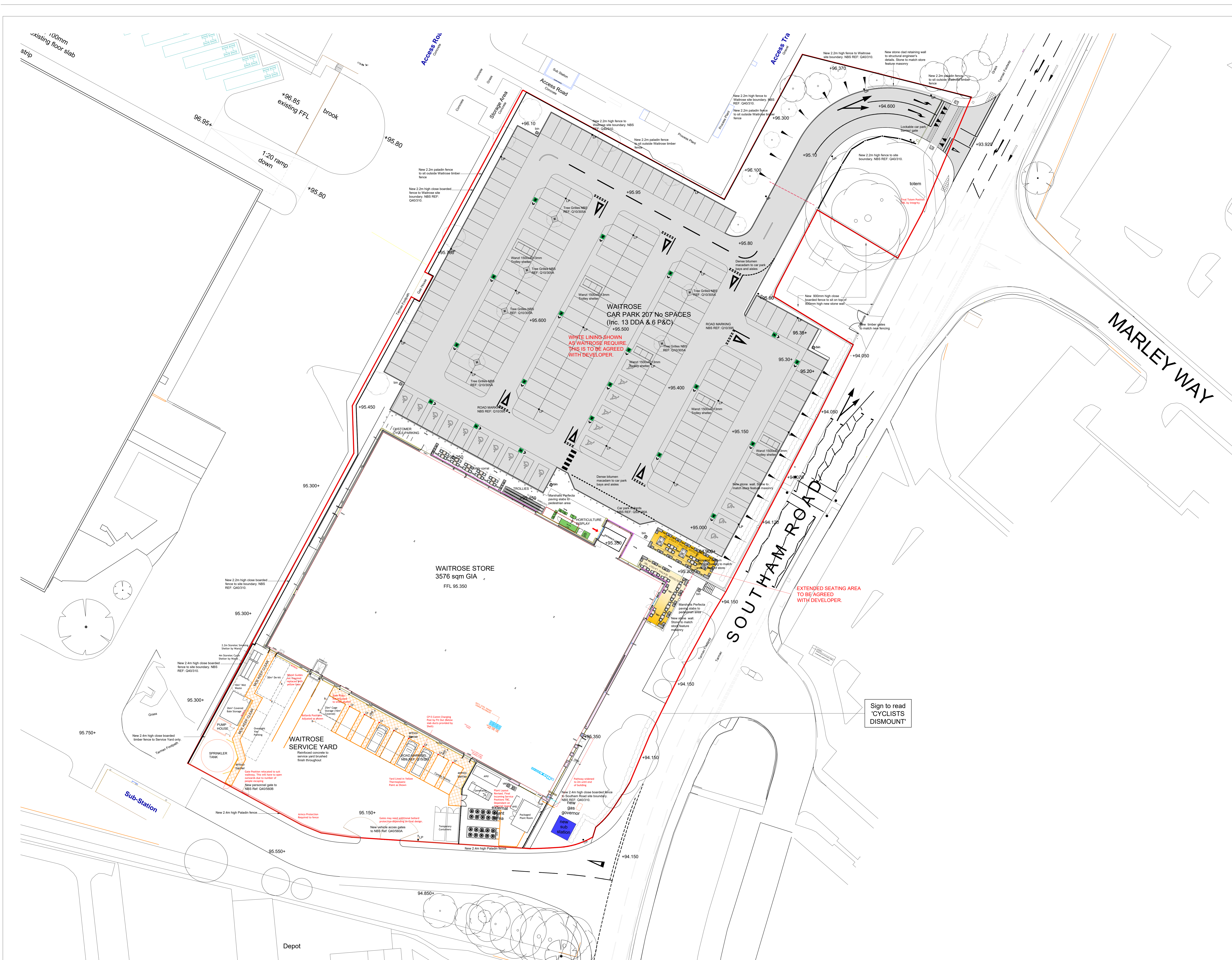

FARRELL & CLARK LLP ©
Do not scale this drawing
C.A.D Ref. - 174-79 BASEPLAN.dwg

Rev	Description	Date	By
-	Preliminary Issue	31/08/16	GA
A	Site Plan updated to Shell drawing 14334-6000 revH with Sub Station. Waitrose external elements shown as Merch Plan Feas. 4	31/10/16	GA
B	Car Park updated to relocate 3 No. DDA spaces for external seating area and add end zones to aisle. Total Spaces reduced from 220 to 207	15/11/16	GA
C	Car Park Symbols and trolley updated to WES. Curved Dashed line added to entry aisle.	15/11/16	GA
D	External Seating and trolley updated to Merch Plan BAN-FEAS/SLTY16	24/11/16	GA
E	External Seating area updated	01/12/16	GA
F	External Plant Area updated to Sverny Drawing. Trolley removed - Fixed Postion TTK by Integrity	01/02/17	GA
G	Site plan updated to 14334-6000-revJ	08/03/17	GA

Construction Design Management Regulations 2015
CDM2015

Client: John Lewis Property Services
Project: Waitrose Banbury
Title: Site Plan
Drawing No.: 174-79-AZ-01 Rev.: G
Status: Preliminary
Scale: 1:250 @ A0 Date: Aug 2016
Drawn: GA Check: GA

Farrell & Clark Architects
Leeds: 0113 259 0922
London: 020 7380 9210
www.farrellandclark.co.uk

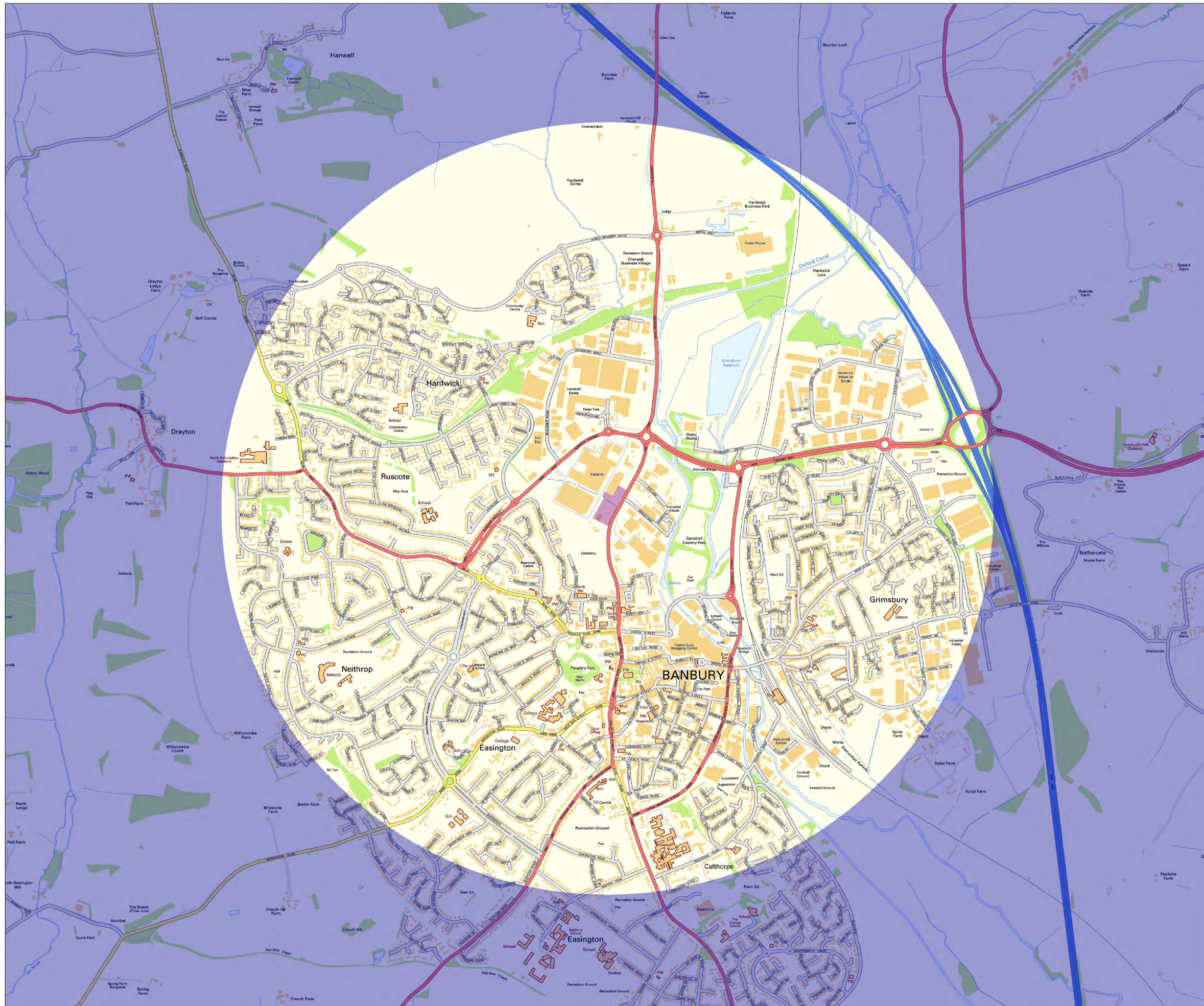

NOTE

Reproduced from Ordnance Survey digital data with the permission of the Controller of Her Majesty's Stationary Office, Crown copyright (AL814229).



KEY

- Site location
- Approximate area within acceptable walking distance

2KM

Rev.	Description	Date	Chkd
------	-------------	------	------

Glanville
 Cornerstone House
 62 Foxhall Road, Didcot
 Oxon, OX11 7AD
 Tel: (01235) 515550 Fax: (01235) 817799
 postbox@glanvillegroup.com www.glanvillegroup.com

Client : **Waitrose**

Project : **Waitrose
Banbury**

Title : **Potential Walking Catchment Area (2km)**

Project Engineer : T. Hart Scale : As Shown @ A3
 Project Director : P. Whitehead Date : April 2017
 Status :

Drawing No. Figure 3	Rev
-----------------------------	-----