

SCALE 1:1000
@A2

- NOTES
1. This drawing has been prepared in accordance with the scope of RPS's appointment with its client and is subject to the terms and conditions of that appointment. RPS accepts no liability for any use of this document other than by its client and only for the purposes for which it was prepared and provided.
 2. If received electronically it is the recipient's responsibility to print to correct scale. Only written dimensions should be used.
 3. This drawing should be read in conjunction with all other relevant drawings and specifications.
 4. Refer to Cole Easdon Consultants design drawings for S278 detailed design.

KEY

	Highway Boundary
--	------------------

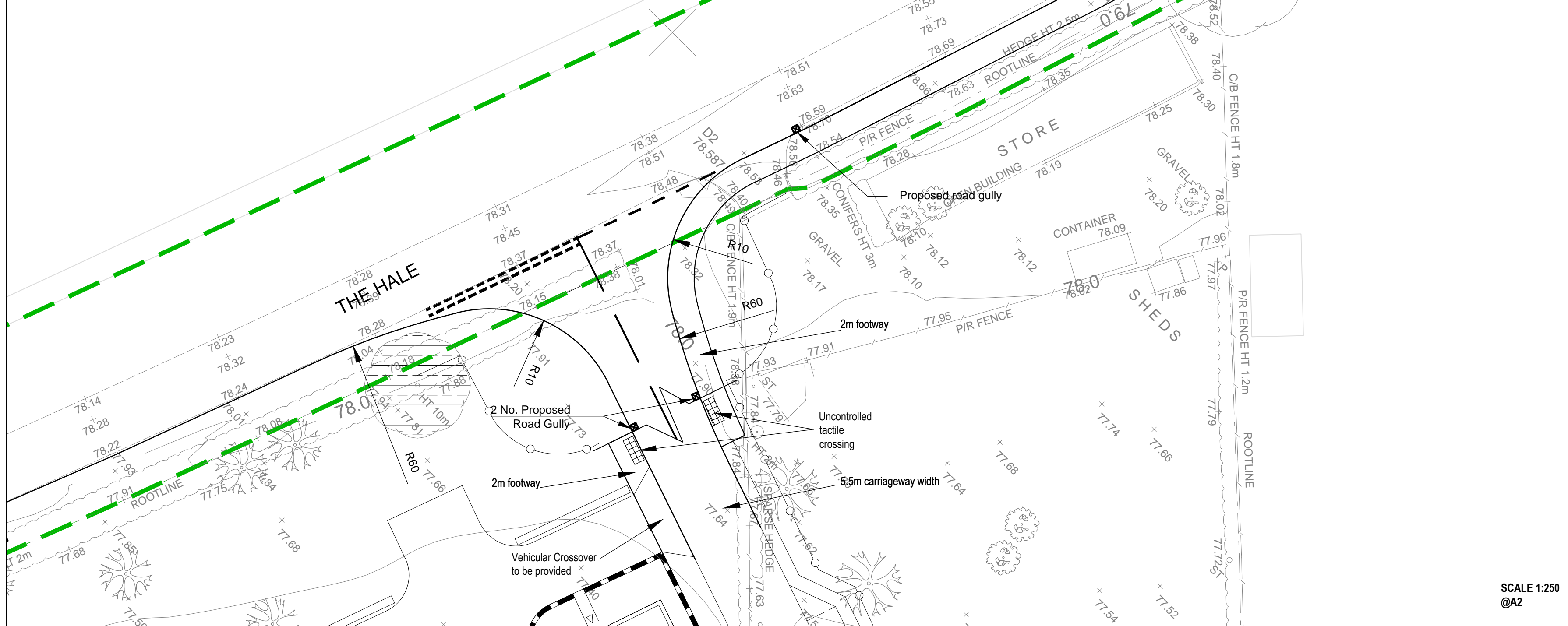

SCALE 1:250
@A2

Rev	Description	Date	Initial	Checked
E	Speed limit road signs added. Road gullies added. Note 4 added.	25/01/17	CA	HSS
D	Internal layout updated	08/04/16	HSS	SF
C	Internal layout updated	12/01/16	HSS	JR
B	Drawing frame amended. Notes amended. Ped crossing moved west. Kerb radii added. Fence type at site access amended.	18/12/15	HSS	RC
A	Ped crossing relocated west to suit latest layout. Complete highway boundary shown	21/10/15	HSS	SF

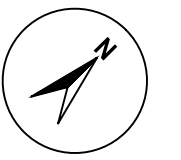

20 Milton Park
Abingdon, Oxfordshire, OX14 4SH.
T: +44(0)1235 432 190 E: transport@rpsgroup.com F: +44(0)1235 834 698

Client **Taylor Wimpey**

Project **Land North of Green Lane, Chesterton**

Title **Proposed Site Access Arrangements**

Status	Drawn By	Checked by
PRELIMINARY	SM	CF
Project Number	Scale @ A2	Date Created
JNY8140	As shown	30/09/2014

Drawing Number	Rev
JNY8140-05	E