

LAPSET PRODUCTS

160016 SECTOR CAROUSEL

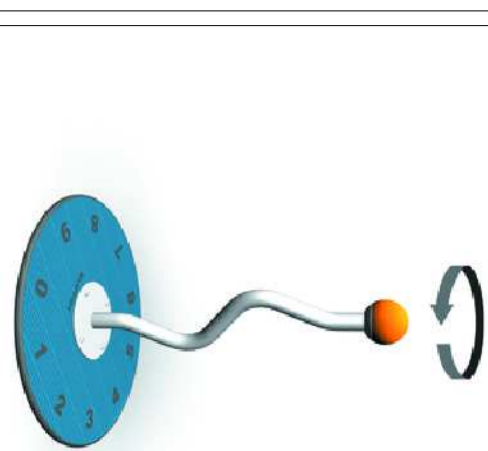

138033M FINNO PARROTS TREE



NF2456* PARK LITTER BIN

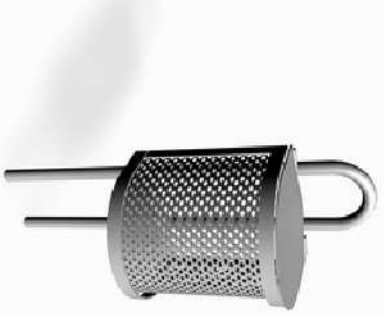

000656-16 PARK BOULEVARD PARK BENCH

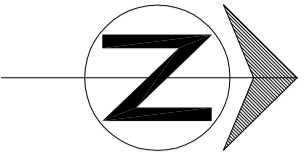
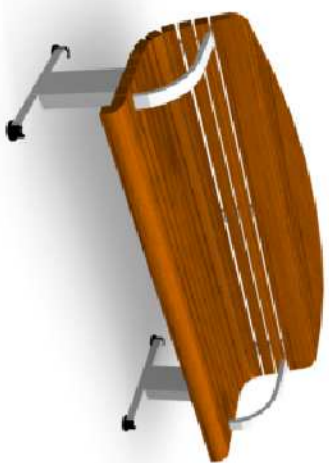

LANDSCAPING LAYOUTS SHOULD BE USED FOR

Proposed private soft works
Proposed public hard and soft works unless
cross referenced to other drawings

LANDSCAPING LAYOUTS SHOULD NOT BE USED FOR

Fencing and drive positions or materials
Private stabling paths and positions
House types and positions
Clearance of existing vegetation (see Tree Survey Plan)

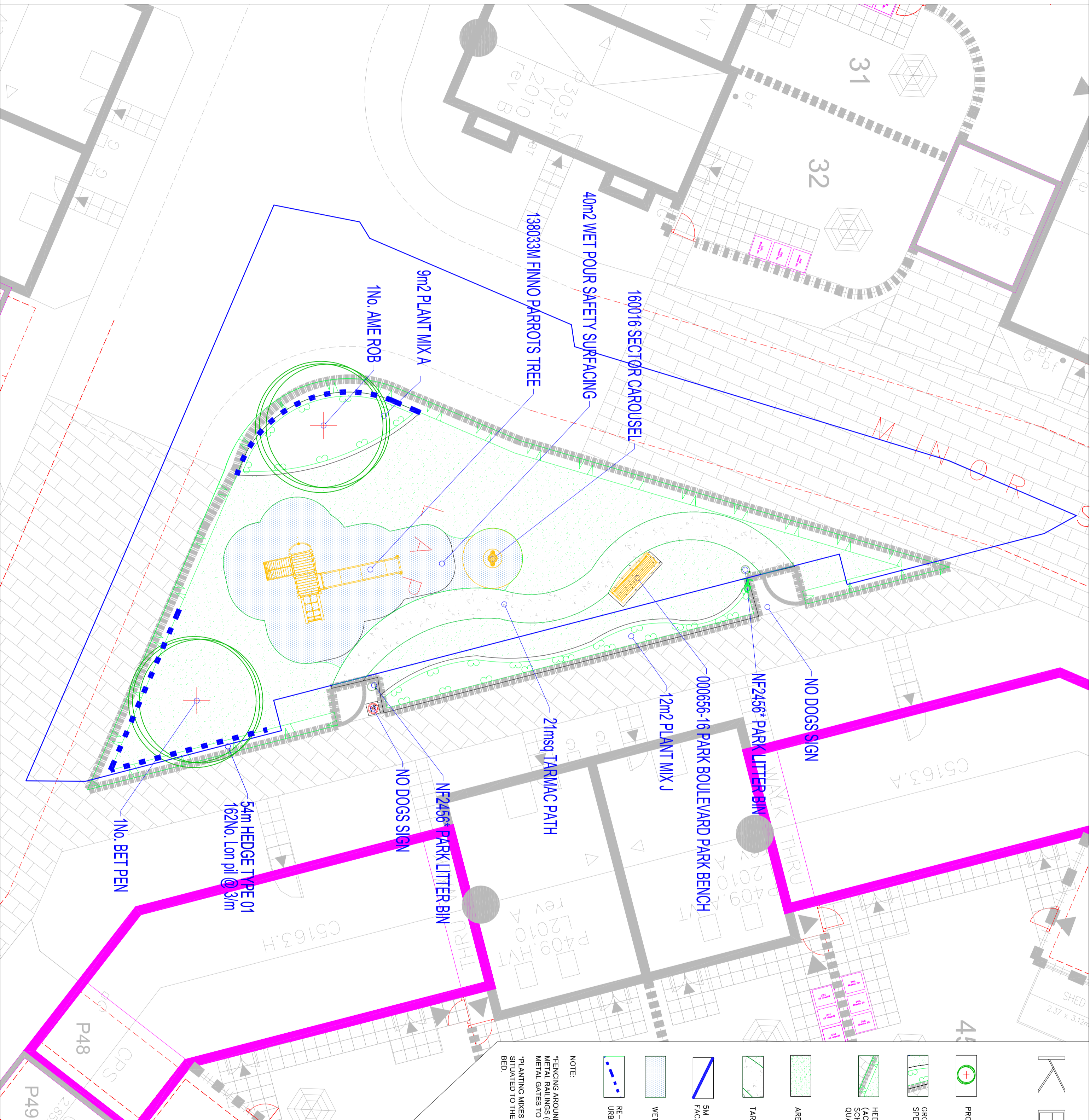

KEY

- PROPOSED TREES
- GROUND COVER MIX – SEE SCHEDULE AND SPECIFICATIONS
- HEDGE PLANTING, INCLUDING SHEET/BARK MULCH (ACCORDING TO SPECIFICATION). REFER TO HEDGE SCHEDULES ON PLAN AND THE SCHEDULE OF QUANTITIES.
- AREA TO BE TURFED
- TARMAC FOOTPATH
- 5M OFFSET FOR PLAY EQUIPMENT TO NEAREST FACADES FROM LAP
- WET POUR SAFETY SURFACING
- RE-ROOT 600 BARRIER SUPPLIED BY GREENBLUE URBAN

NOTE:
-FENCING AROUND THE PLAY AREA IS 900 HIGH BALL TOPPED HIGH METAL RAILINGS (PAINTED BLACK) WITH 2ND 900 HIGH BALL TOP METAL GATES TO OPEN OUTWARDS (BOTH PAINTED BLACK)
-PLANTING MIXES TO BE PLANTED TO HAVE LARGER SHRUBS SITUATED TO THE BACK AND SMALLER ONES TO THE FRONT OF THE BED.

<p>Drainage Authority Approval Date: _____ Highway Authority Approval Date: _____</p>	
<p>Do not scale from this drawing. The written dimensions only shall govern interpretation. All dimensions shall be given in millimetres unless otherwise stated. All dimensions shall be given in millimetres unless otherwise stated. All dimensions shall be given in millimetres unless otherwise stated.</p>	
<p>Rev. No. Details</p>	<p>By: _____ Date: _____</p>
<p>Site: KINGSMERE BICESTER</p>	
<p>Drawing Title: KM-4 LAP DESIGN</p>	
<p>Drawn By: AU</p>	<p>Date: 25/06/2014</p>
<p>Scale: 1:100 AT A2</p>	<p>Checked/Date: _____</p>
<p>DRAMA NO. KM4.102</p>	
<p>KEY E</p>	

BOWIS HOMES

Bovis Homes Central Region
Bromwich Court
Highway Point
Gorseley Lane
Coleshill
B46 1JU

Tel: 01675 437 000
Fax: 01675 437 094
DX: 728340 Coleshill 2