

LAPSET PRODUCTS

160016 SECTOR CAROUSEL

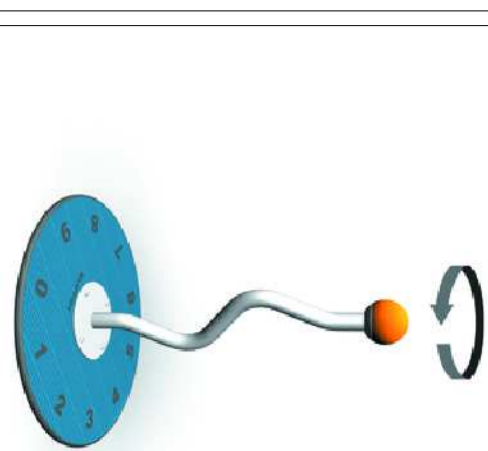

138033M FINNO PARROTS TREE



NF2456\* PARK LITTER BIN

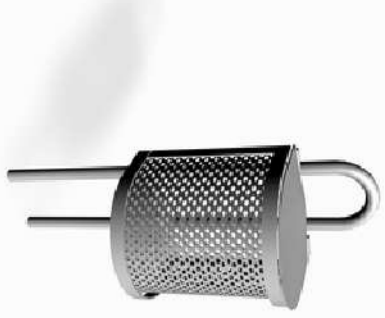

000656-16 PARK BOULEVARD PARK BENCH

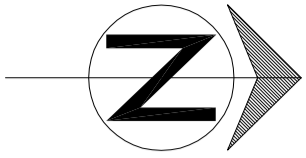
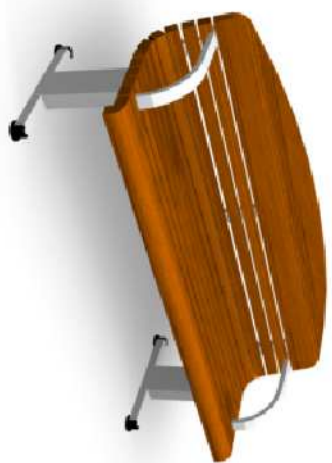

LANDSCAPING LAYOUTS SHOULD BE USED FOR

Proposed private soft works  
Proposed public hard and soft works unless  
cross referenced to other drawings

LANDSCAPING LAYOUTS SHOULD NOT BE USED FOR

Fencing and drive positions or materials  
Private stabling paths and patios  
House types and positions  
Clearance of existing vegetation (see Tree Survey Plan)

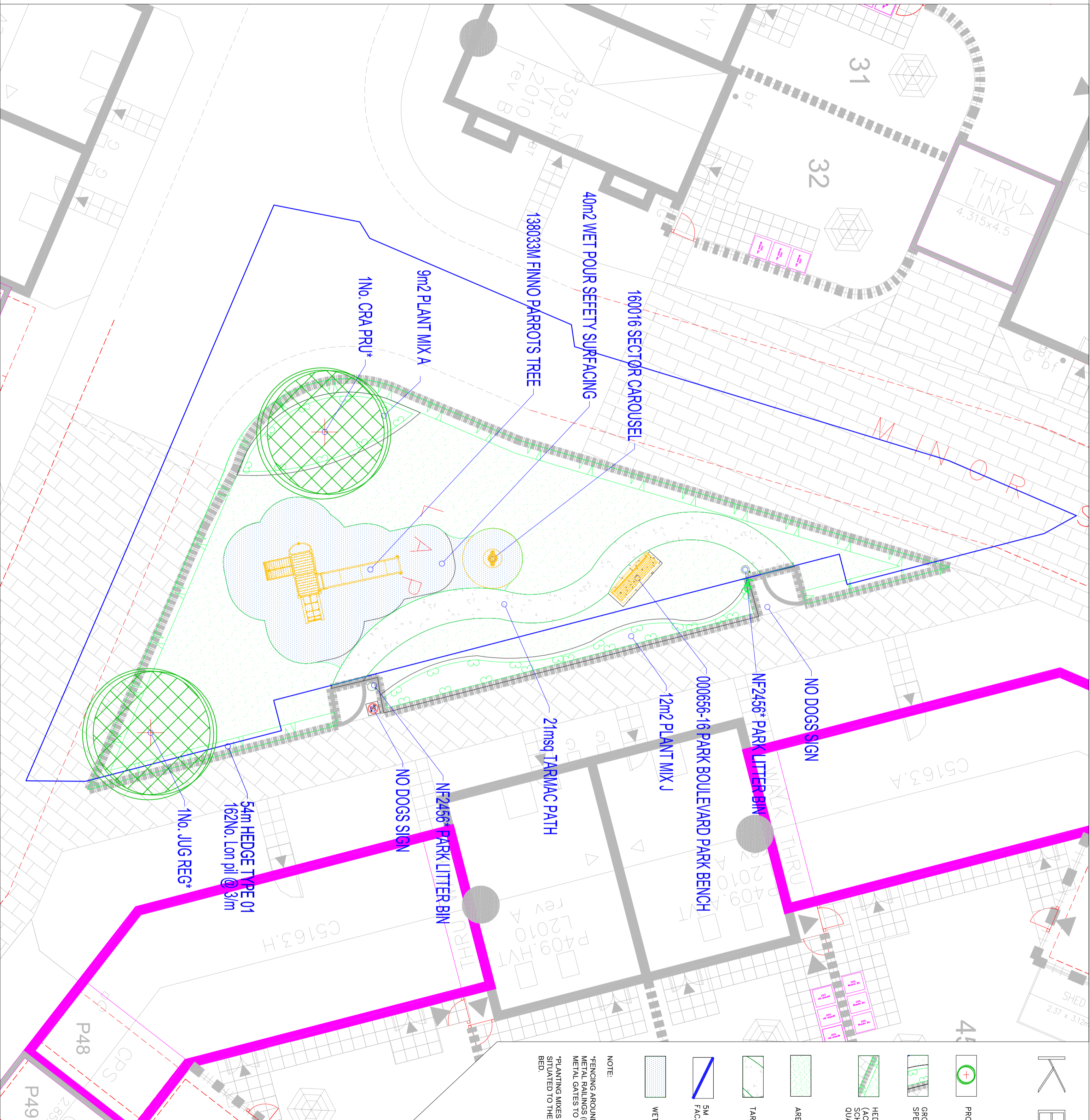

KEY

- PROPOSED TREES
- GROUND COVER MIX - SEE SCHEDULE AND SPECIFICATIONS
- HEDGE PLANTING, INCLUDING SHEET/BARK MULCH (ACCORDING TO SPECIFICATION). REFER TO HEDGE SCHEDULES ON PLAN AND THE SCHEDULE OF QUANTITIES.
- AREA TO BE TURFED
- TARMAC FOOTPATH
- 5M OFFSET FOR PLAY EQUIPMENT TO NEAREST FACADES FROM LAP
- WET POUR SAFETY SURFACING

NOTE:  
 -FENCING AROUND THE PLAY AREA IS 900 HIGH BALL TOPPED HIGH METAL RAILINGS (PAINTED BLACK) WITH 2ND 900 HIGH BALL TOP METAL GATES TO OPEN OUTWARDS (BOTH PAINTED BLACK)  
 -PLANTING MIXES TO BE PLANTED TO HAVE LARGER SHRUBS SITUATED TO THE BACK AND SMALLER ONES TO THE FRONT OF THE BED.

<p>Drainage Authority Approval Date: _____                  Highway Authority Approval Date: _____</p>	
<p>Rev. Date: _____                  Details: _____</p>	<p>By: _____                  AU: _____                  PW: _____</p>
<p>© 19/08/16 PLANT MIX AND TREES CHANGED                  B 24/10/14 AMENDMENTS IN ACCORDANCE WITH PLANNERS COMMENTS                  A 17/09/14 AMENDMENTS IN ACCORDANCE WITH PLANNERS COMMENTS</p>	
<p>Do not scale from this drawing. Use written dimensions only. When shown relationships between the lines of a drawing are not to be used as dimensions. All dimensions are given in millimetres unless otherwise stated. The drawing is the copyright of Bowls Homes Ltd.</p>	
<p><b>BOWLS HOMES</b>                  Kingsmere                  Bicester</p>	
<p>Bowls Homes Central Region                  Bromwich Court                  Highway Point                  Gossey Lane                  Colleshill                  B46 1JU                  Tel: 01675 437 000                  Fax: 01675 437 094                  DX: 728340 Colleshill 2</p>	
<p>DRAWING TITLE: KM-4                  DRAWN BY: AU                  DATE: 23/06/2014                  SCALE: 1:100 AT A2</p>	<p>LAP DESIGN                  DRAWING NO.: KM4.102                  CHECKED/DATE: _____                  KEY: C</p>