

The copyright of this drawing is vested with Corstorphine + Wright Ltd and must not be copied or reproduced without the consent of the company.
Figured dimensions only to be taken from this drawing. DO NOT SCALE.
All dimensions and notations are subject to the architect's discretion and any discrepancies prior to any manufacture or construction work.
NOTES

WALL DETAIL

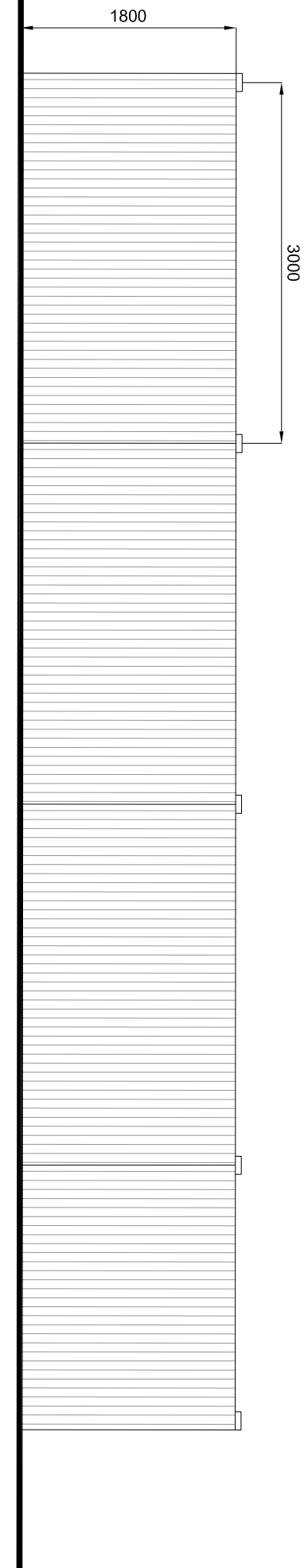

External wall detail @ 1:50

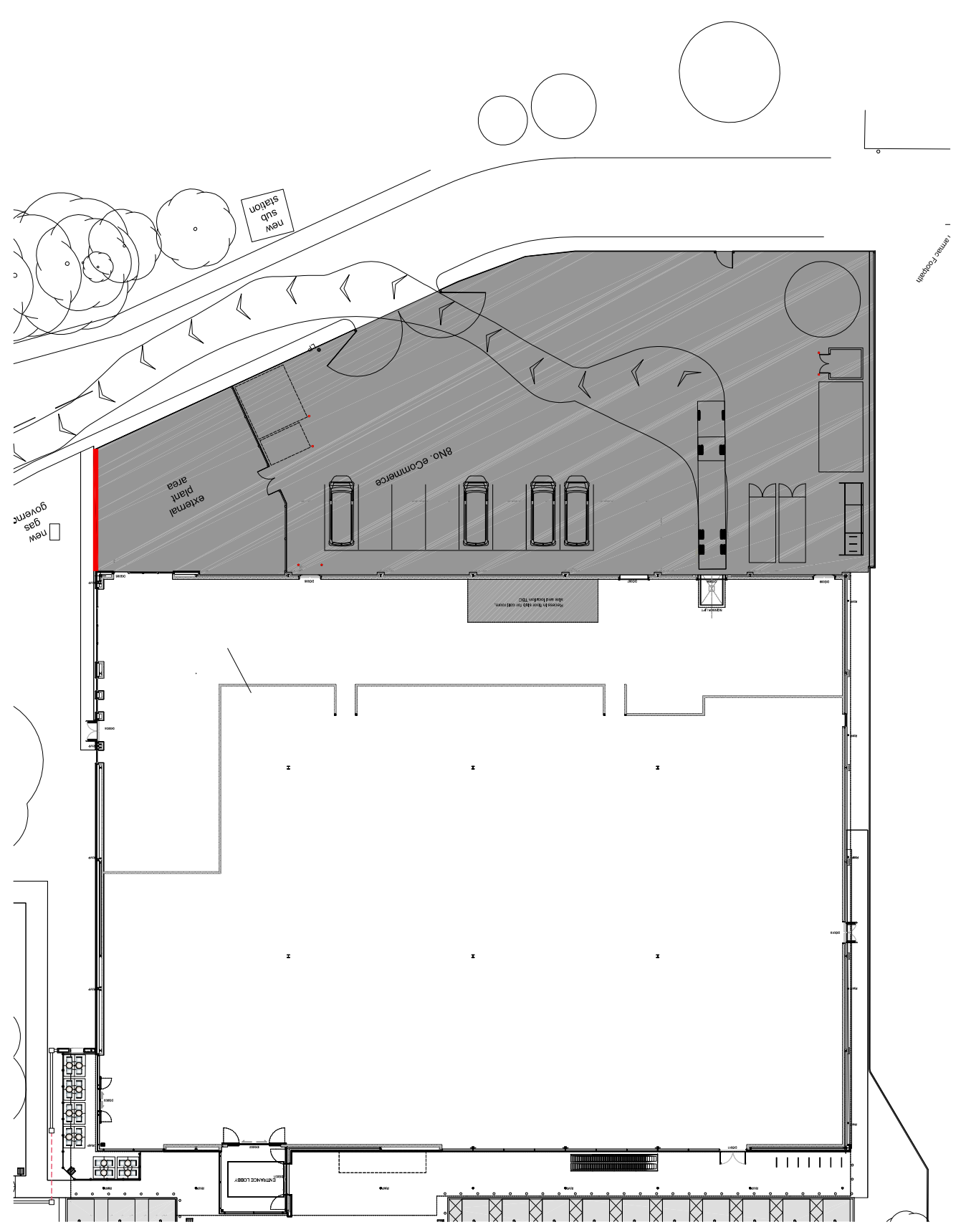

Site plan @ 1:500

REV	A	27.04.18	TENDER ISSUE 11	CHK	OK
DATE	NOTES				
Client	BARWOOD CAPITAL and MONDELEZ INTERNATIONAL				
Project	NEW WAITROSE STORE SOUTHAM ROAD BANBURY				
Drawing Title	PROPOSED EXTERNAL WALL DETAIL 5				
Drawn	Checked	Paper Size	Scale	Date	Revision
DS	WC	A1	1:50 / 1:500	APRIL 16	A
Project No.	Drawing No.	Revision			
14334	6015	A			

CORSTORPHINE + WRIGHT ARCHITECTS

Warwick
Birmingham
Manchester
Newcastle
Canterbury
Dublin
Brook Hall Brook Street Warwick CV34 4PL
Tel. 01925 665444 www.corstorphine-wright.com